



west virginia department of environmental protection

Office of Oil and Gas
601 57th Street, S.E.
Charleston, WV 25304
(304) 926-0450
fax: (304) 926-0452

Harold D. Ward, Cabinet Secretary
www.dep.wv.gov

Monday, July 17, 2023
PERMIT MODIFICATION APPROVAL
Horizontal 6A / New Drill

EQT PRODUCTION COMPANY
625 LIBERTY AVE., SUITE 1700

PITTSBURGH, PA 15222

Re: Permit Modification Approval for CASH 1H
47-103-03398-00-00

Lateral Extension

EQT PRODUCTION COMPANY

The Office of Oil and Gas has reviewed the attached permit modification for the above referenced permit. The attached modification has been approved and well work may begin. Please be reminded that the oil and gas inspector is to be notified twenty-four (24) hours before permitted well work is commenced.

If there are any questions, please feel free to contact me at (304) 926-0450.

James A. Martin
Chief

Operator's Well Number: CASH 1H
Farm Name: JOHN R. & PHYLLIS R. BOHRER
U.S. WELL NUMBER: 47-103-03398-00-00
Horizontal 6A New Drill
Date Modification Issued: 7/17/2023

Promoting a healthy environment.

07/21/2023

STATE OF WEST VIRGINIA
DEPARTMENT OF ENVIRONMENTAL PROTECTION, OFFICE OF OIL AND GAS
WELL WORK PERMIT APPLICATION

1) Well Operator: EQT Production Company 306686 Wetzel Center Littleton
Operator ID County District Quadrangle

2) Operator's Well Number: 1H Well Pad Name: Cash

3) Farm Name/Surface Owner: John R. & Phyllis R. Bohrer Public Road Access: CR-8 Low Gap Run Road

4) Elevation, current ground: 1,488' (built) Elevation, proposed post-construction: 1,488' (built)

5) Well Type (a) Gas Oil _____ Underground Storage _____

Other _____

(b) If Gas Shallow Deep _____

Horizontal

6) Existing Pad: Yes or No Yes

7) Proposed Target Formation(s), Depth(s), Anticipated Thickness and Expected Pressure(s):
Marcellus, 7,575', 48', 2,620 PSI

8) Proposed Total Vertical Depth: 7,575'

9) Formation at Total Vertical Depth: Marcellus

10) Proposed Total Measured Depth: 20,299'

11) Proposed Horizontal Leg Length: 12,322'

12) Approximate Fresh Water Strata Depths: 170'

13) Method to Determine Fresh Water Depths: Offset Wells - 47-103-02399, 47-103-01974

14) Approximate Saltwater Depths: 2,122'

15) Approximate Coal Seam Depths: 1,183'-1,186', 1,285'-1,291'

16) Approximate Depth to Possible Void (coal mine, karst, other): N/A

17) Does Proposed well location contain coal seams directly overlying or adjacent to an active mine? Yes _____ No

(a) If Yes, provide Mine Info: Name: _____
Depth: _____
Seam: _____
Owner: _____

RECEIVED
Office Of Oil and Gas
JUN 27 2023
WV Department of
Environmental Protection

18) **CASING AND TUBING PROGRAM**

TYPE	Size (in)	New or Used	Grade	Weight per ft. (lb/ft)	FOOTAGE: For Drilling (ft)	INTERVALS: Left in Well (ft)	CEMENT: Fill-up (Cu. Ft.)/CTS
Conductor	26	New	A252 GR 3	85.6	40	40 ✓	49 ft ³ / CTS
Fresh Water	13 3/8	New	J-55	54.5	1341	1341 ✓	1208 ft ³ / CTS ✓
Coal							
Intermediate	9 5/8	New	J-55	36	2773	2773 ✓	1065 ft ³ / CTS
Production	6	New	P-110	24	20299	20299 ✓	500' above intermediate casing
Tubing							
Liners							

TYPE	Size (in)	Wellbore Diameter (in)	Wall Thickness (in)	Burst Pressure (psi)	Anticipated Max. Internal Pressure (psi)	Cement Type	Cement Yield (cu. ft./k)
Conductor	26	30	0.312	1000	18	Class A/L ✓	1.04 - 1.20
Fresh Water	13 3/8	17 1/2	0.380	2730	2184	Class A/L	1.04 - 1.20
Coal							
Intermediate	9 5/8	12 3/8	0.352	3520	2816	Class A/L	1.04 - 1.20
Production	6	8 1/2	0.400	14580 ✓	11664	Class A/H/L	1.04 - 2.10
Tubing							
Liners							

PACKERS

Kind:				
Sizes:				
Depths Set:				

19) Describe proposed well work, including the drilling and plugging back of any pilot hole:

Continue drilling and complete a new horizontal well in the Marcellus Formation. Drill the lateral in the Marcellus. Cement casing. This well has been drilled vertically to 6,845' MD.

20) Describe fracturing/stimulating methods in detail, including anticipated max pressure and max rate:

Hydraulic fracturing is completed in accordance with state regulations using water recycled from previously fractured wells and obtained from freshwater sources. This water is mixed with sand and a small percentage (less than 0.1%) of chemicals (including 15% Hydrochloric acid, friction reducer, biocide, and scale inhibitor), referred to in the industry as a "slickwater" completion. Maximum anticipated internal casing pressure is expected to be approximately 10,000 psi, maximum anticipated treating rates are expected to average approximately 100 bpm. Stage lengths vary from 150 to 300 feet. Average approximately 350,000 gallons of water per stage. Sand sizes vary from 100 mesh to 20/40 mesh. Average approximately 200,000-600,000 pounds of proppant per stage.

21) Total Area to be disturbed, including roads, stockpile area, pits, etc., (acres): 27.91 (built)

22) Area to be disturbed for well pad only, less access road (acres): 7.83 (built)

23) Describe centralizer placement for each casing string:

- Surface: Bow spring centralizers – One centralizer at the shoe and one spaced every 500'.
- Intermediate: Bow spring centralizers– One centralizer at the shoe and one spaced every 500'.
- Production: One solid body centralizer spaced every other joint from production casing shoe to landing point. One solid body centralizer spaced every joint from landing point to planned top of cement.

24) Describe all cement additives associated with each cement type:

Conductor: No additives
Surface: Calcium Chloride. Used to speed the setting of cement slurries
Intermediate: Calcium Chloride. Used to speed the setting of cement slurries.
Production: Calcium Carbonate, Fluid Loss, Extender, Dispersent, Viscosifier, Defoamer, POZ, Bonding Agent, Retarder, Anti-Settling/Suspension Agent

25) Proposed borehole conditioning procedures:

Surface: Circulate hole clean while rotating & reciprocating the drill string until cuttings diminish at surface.
Intermediate: Circulate hole clean while rotating & reciprocating the drill string until cuttings diminish at surface.
Production: Perform a cleanup cycle by pumping 3-8 bottoms up or until the shakers are clean. Check volume of cuttings coming across the shakers every 15 minutes.

*Note: Attach additional sheets as needed.

EQT Production

Wellbore Diagram

Well: Cash 1H
Pad: Cash
Elevation: 1488' GL 1516' KB

County: Wetzell
State: West Virginia

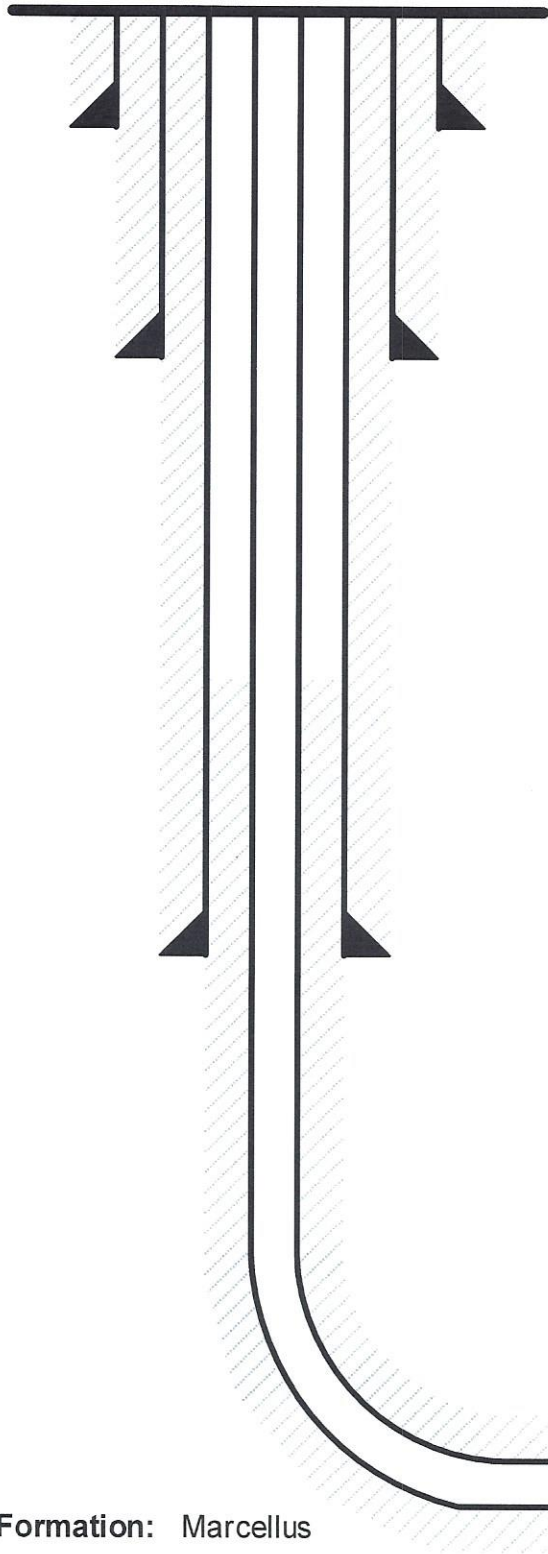

Conductor @ 40'

26", 85.6#, A252 GR3, cement to surface w/ Class A/L

Surface @ 1,341'

13-3/8", 54.5#, J-55, cement to surface w/ Class A/L

Intermediate @ 2,773'

9-5/8", 36#, J-55, cement to surface w/ Class A/L

Production @ 20,299' MD / 7,575' TVD

6", 24#, P-110, cement to 500' inside 9-5/8" w/ Class A/H/L

RECEIVED
Office Of Oil and Gas

JUN 27 2023

WV Department of
Environmental Protection

Formation: Marcellus

Stephen
Mccoy

Digitally signed by Stephen
Mccoy
Date: 2023.06.21 09:48:55
-04'00'

NOT TO SCALE
07/21/2023

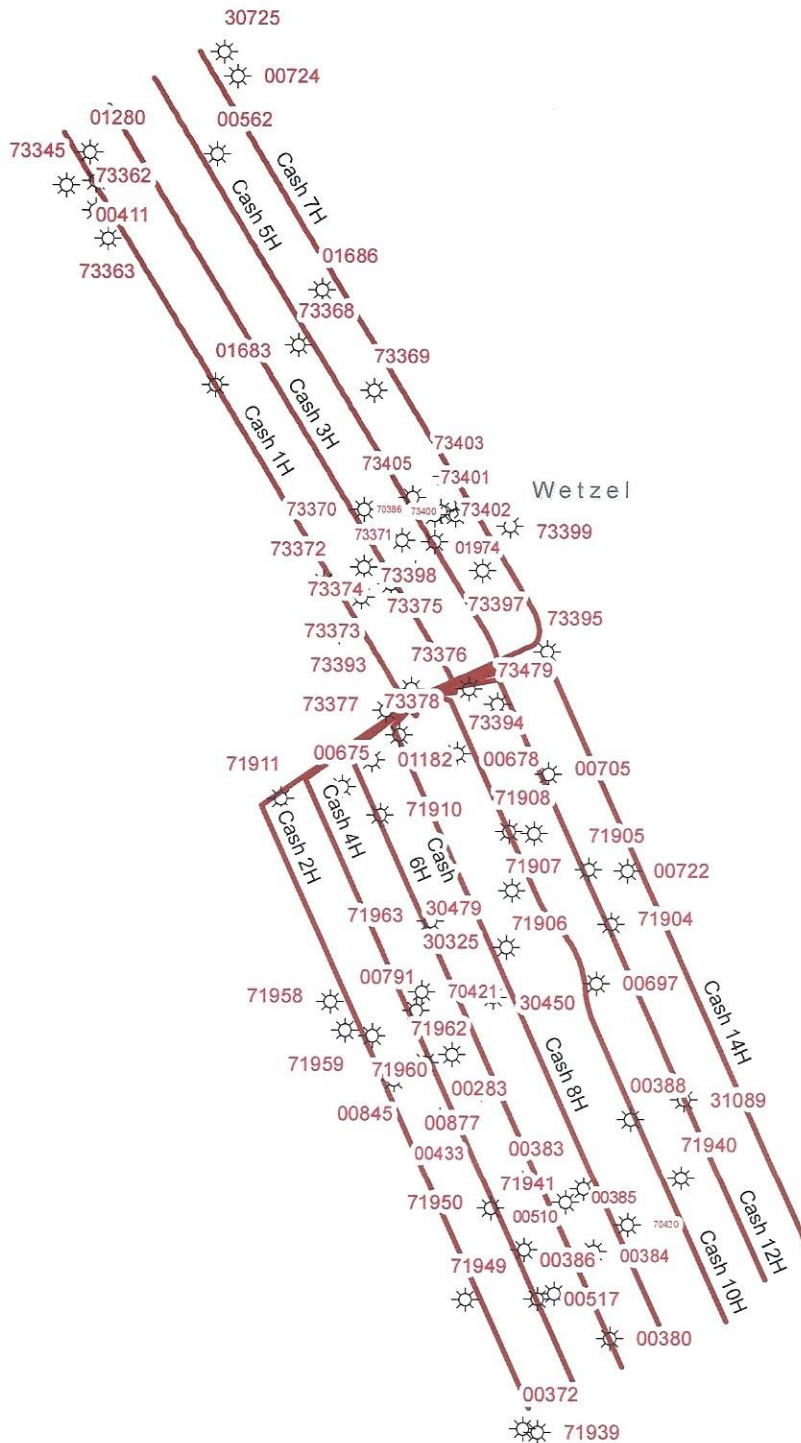

Wetzel

EQT Corporation
625 Liberty Avenue
Pittsburgh, PA 15222

Cash
Vertical Offsets and Foreign Laterals within 500'

Legend
☀ Foreign_Offset_Wells
Well Lateral_FM Formation
— Geneseo
— Marcellus
— Utica

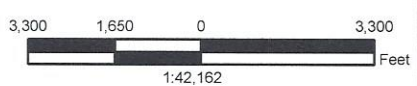

Disclaimer:
This map is confidential and is to be used only for the express informational purposes for which it was created. Unauthorized use, copying, or dissemination is strictly prohibited. EQT does not warrant the accuracy of the location of any items shown on this map, including, but not limited to, any structures, well or pipeline facilities, property boundaries, topography, roadways, or waterways. The items shown on the map may not have been placed on the map using survey lines or GPS coordinates. The specific location of any of the map items should be determined by a field survey performed by a licensed surveyor upon consultation with EQT.



07/21/2023

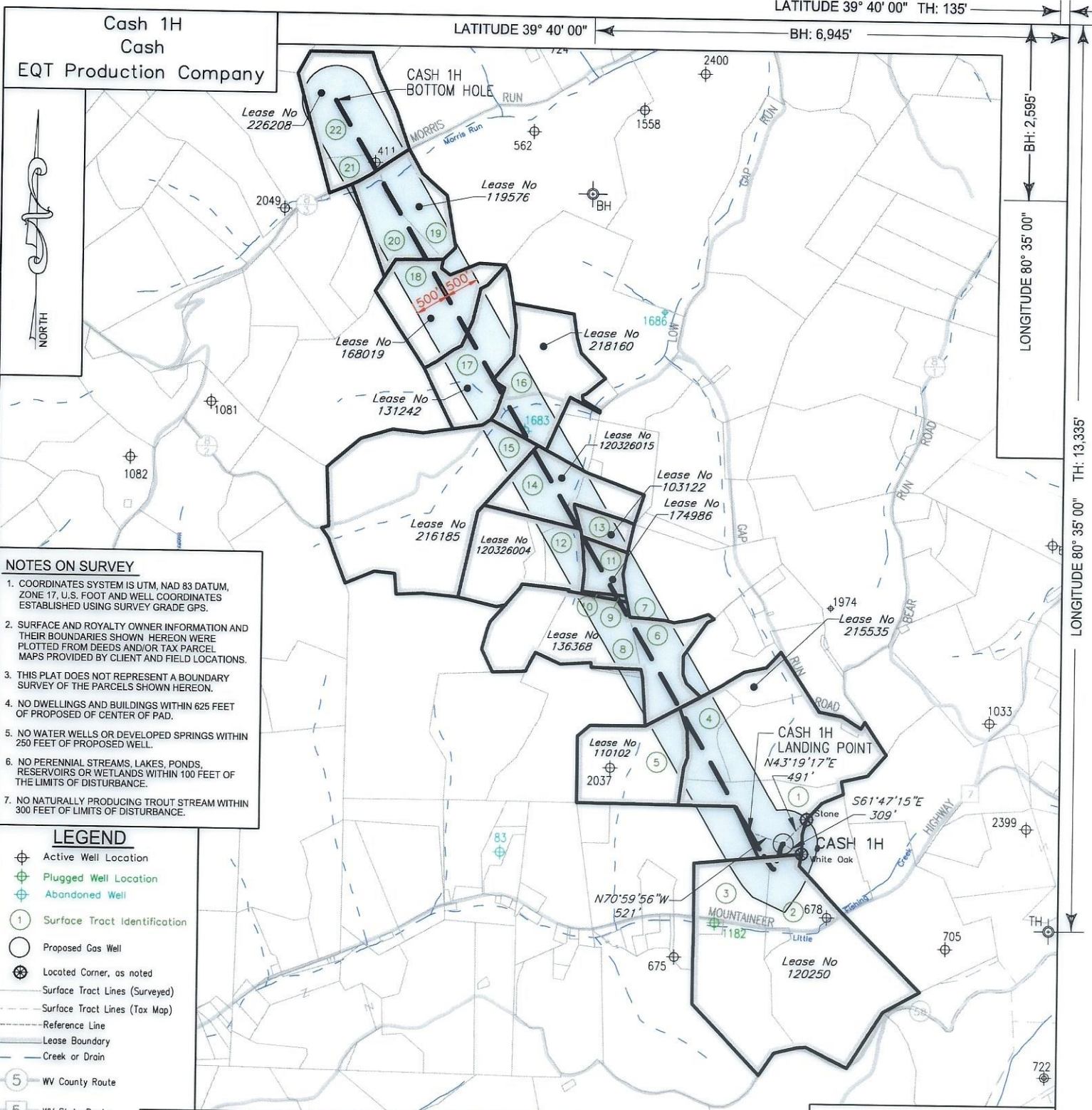

NOTES ON SURVEY

- COORDINATES SYSTEM IS UTM, NAD 83 DATUM, ZONE 17, U.S. FOOT AND WELL COORDINATES ESTABLISHED USING SURVEY GRADE GPS.
- SURFACE AND ROYALTY OWNER INFORMATION AND THEIR BOUNDARIES SHOWN HEREON WERE PLOTTED FROM DEEDS AND/OR TAX PARCEL MAPS PROVIDED BY CLIENT AND FIELD LOCATIONS.
- THIS PLAT DOES NOT REPRESENT A BOUNDARY SURVEY OF THE PARCELS SHOWN HEREON.
- NO DWELLINGS AND BUILDINGS WITHIN 625 FEET OF PROPOSED OF CENTER OF PAD.
- NO WATER WELLS OR DEVELOPED SPRINGS WITHIN 250 FEET OF PROPOSED WELL.
- NO PERENNIAL STREAMS, LAKES, PONDS, RESERVOIRS OR WETLANDS WITHIN 100 FEET OF THE LIMITS OF DISTURBANCE.
- NO NATURALLY PRODUCING TROUT STREAM WITHIN 300 FEET OF LIMITS OF DISTURBANCE.

- LEGEND**
- ⊕ Active Well Location
 - ⊕ Plugged Well Location
 - ⊕ Abandoned Well
 - ① Surface Tract Identification
 - Proposed Gas Well
 - ⊗ Located Corner, as noted
 - Surface Tract Lines (Surveyed)
 - Surface Tract Lines (Tax Map)
 - Reference Line
 - Lease Boundary
 - Creek or Drain
 - ⑤ WV County Route
 - ⑤ WV State Route

(⊕) Denotes Location of Well on United States Topographic Maps



I, the undersigned, hereby certify that this plat is correct to the best of my knowledge and belief and shows all the information required by law and the regulations issued and prescribed by the Department of Environmental Protection.

Thomas C. Smit
L. L. S. 687

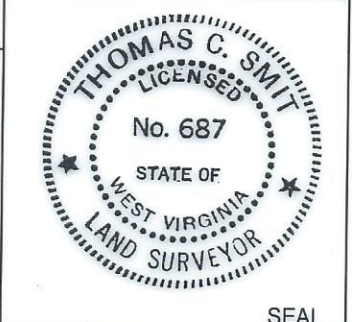

FILE NO: _____
DRAWING NO: _____
SCALE: 1" = 2000'
MINIMUM DEGREE OF ACCURACY: 1:2500
PROVEN SOURCE OF ELEVATION: NGS CORS Station

STATE OF WEST VIRGINIA
DEPARTMENT OF ENVIRONMENTAL PROTECTION
OIL AND GAS DIVISION

DATE: JUNE 21 20 23
OPERATORS WELL NO: Cash 1H
API WELL NO: 47 - 103 - 03398
STATE COUNTY PERMIT

WELL TYPE: OIL GAS LIQUID INJECTION WASTE DISPOSAL
(IF GAS) PRODUCTION: STORAGE DEEP SHALLOW

LOCATION ELEVATION: 1488' WATERSHED: Little Fishing Creek QUADRANGLE: Littleton
DISTRICT: Center COUNTY: Wetzel

SURFACE OWNER: John R. & Phyllis R. Bohrer ACREAGE: 121.18±
ROYALTY OWNER: Green Dot Farm, Inc., et al. LEASE NO: 215535 ACREAGE: 121.18±

PROPOSED WORK: DRILL CONVERT DRILL DEEPER FRACTURE OR STIMULATE PLUG OFF OLD FORMATION
 PERFORATE NEW FORMATION OTHER PHYSICAL CHANGE IN WELL (SPECIFY)

PLUG AND ABANDON CLEAN OUT AND REPLUG TARGET FORMATION: Marcellus ESTIMATED DEPTH: 7,575'

WELL OPERATOR: EQT Production Company DESIGNATED AGENT: Joseph C Mallow
ADDRESS: 400 Woodcliff Drive ADDRESS: 427 Midstate Drive
Canonsburg, PA 15317 Clarksburg, WV 26301

07/21/2023

Cash 1H
Cash
EQT Production Company

Tract ID.	Tax Map No.	Parcel No.	County	District	Surface Tract Owner	Acres
1	15	58.0	Wetzel	Center	John R. & Phyllis R. Bohrer	52.95
2	19	8.0	Wetzel	Center	Charles O. & Sherlene J. Phillips	89.94
3	19	7.0	Wetzel	Center	Brandi L. Briggs & Sharon Sue Long	67.11
4	15	45.0	Wetzel	Center	No Info	17.94
5	15	44.0	Wetzel	Center	John R. & Phyllis R. Bohrer	43.80
6	15	30.0	Wetzel	Center	Owen E. & Saloma D. Schmucker	25.75
7	15	17.0	Wetzel	Center	Jonathan W White	41.50
8	15	28.0	Wetzel	Center	Owen E. & Saloma D. Schmucker	29.00
9	15	14.0	Wetzel	Center	Owen E. & Saloma D. Schmucker	1.00
10	15	13.0	Wetzel	Center	Owen E. & Saloma D. Schmucker	0.44
11	15	15.0	Wetzel	Center	Owen E. & Saloma D. Schmucker	10.12
12	15	11.0	Wetzel	Center	Owen E. & Saloma D. Schmucker	9.80
13	15	9.0	Wetzel	Center	Kenneth R. McCall	8.02
14	15	8.0	Wetzel	Center	David W. & Rachel M. Morris	25.00
15	14	10.0	Wetzel	Center	Johnny Kenneth & Debrah K. Greathouse	122.00
16	11	29.0	Wetzel	Center	Edward M., II & Judith Q. Kauffman, Jeffrey M. Kauffman and Jennifer M. Stake	42.50
17	11	28.0	Wetzel	Center	Patrick L Morris	36.90
18	10	57.0	Wetzel	Center	Patrick L Morris	38.00
19	10	44.0	Wetzel	Center	Danny C. Briggs and Diana L. Briggs	22.20
20	10	43.0	Wetzel	Center	Louise Maxine & Jack Morris	22.76
21	10	30.1	Wetzel	Center	Patrick J & Cinthia E Anderson	6.51
22	10	30.0	Wetzel	Center	Noel Anderson	43.49

Lease	Owner	Acres
215535	Green Dot Farm, Inc., etal.	121.18 ac
120250	Jeanne Anne Lambert etal.	150 ac
110102	Acropolis, Inc., etal.	43.8 ac
136368	Owen E. Schmucker and Saloma D. Schmucker, etal.	77.41875 ac
120326004	Owen E. Schmucker and Saloma D. Schmucker, etal.	52.45 ac
174986	Ronald Richard Morris, Sr., etal.	10.122 ac
103122	William B. Francik and Pamela S. Francik, Trustees of the William B. and Pamela S. Francik Joint Revocable Living Trust dated 2/12/2018, etal.	8.9 ac
120326015	Mary Colleen Olson, etal.	125.1625 ac
216185	Drilling Appalachian Corporation, etal.	122 ac
218160	Green Dot Farm, Inc.	45.14 ac
131242	Green Dot Farm, Inc., etal.	36.9 ac
168019	Green Dot Farm, Inc., etal.	38 ac
119576	Green Dot Farm, Inc., etal.	47.5 ac
226208	Dewey David Kushaney, etal.	50 ac

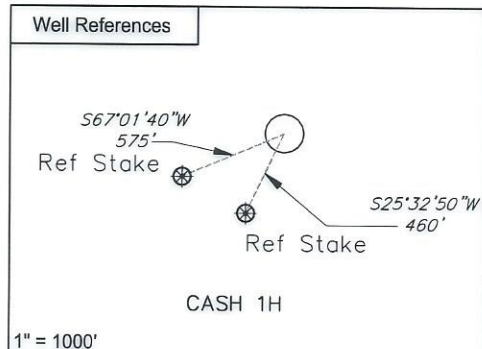
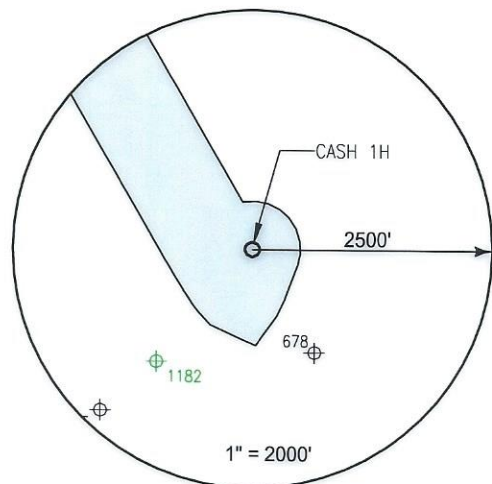

Notes:
 CASH 1H coordinates are
 NAD 27 N: 413,402.914 E: 1,694,689.297
 NAD 27 Lat: 39.629973 Long: -80.583995
 NAD 83 UTM N: 4,386,781.032 E: 535,717.278

CASH 1H Landing Point coordinates are
 NAD 27 N: 413,572.682 E: 1,694,196.636
 NAD 27 Lat: 39.630423 Long: -80.585752
 NAD 83 UTM N: 4,386,830.244 E: 535,566.319

CASH1H Bottom Hole coordinates are
 NAD 27 N: 424,227.608 E: 1,688,008.391
 NAD 27 Lat: 39.659466 Long: -80.608187
 NAD 83 UTM N: 4,390,044.853 E: 533,626.899

West Virginia Coordinates system of 1927 (North Zone)
 based upon Differential GPS Measurements
 Plat orientation, Corner and well ties are based upon
 the grid north meridian
 Well location references are based upon the grid north
 meridian.
 UTM coordinates are NAD83, Zone 17, Meters.

CASH PAD

- CASH 12H
- CASH 10H
- CASH 8H
- CASH 6H
- CASH 4H
- CASH 2H
- CASH 7H 47-103-03522
- CASH 5H 47-103-03523
- CASH 3H 47-103-03524
- CASH 1H 47-103-03398



I, the undersigned, hereby certify that this plat is correct to the best of my knowledge and belief and shows all the information required by law and the regulations issued and prescribed by the Department of Environmental Protection.

Thomas C. Smit
 L. L. S. 687



SEAL

FILE NO: _____
 DRAWING NO: _____
 SCALE: 1" = 1000'
 MINIMUM DEGREE OF ACCURACY:
 1:2500
 PROVEN SOURCE OF ELEVATION:
 NGS CORS Station

STATE OF WEST VIRGINIA
 DEPARTMENT OF ENVIRONMENTAL PROTECTION
 OIL AND GAS DIVISION



DATE: JUNE 21 20 23
 OPERATORS WELL NO: Cash 1H
 API WELL NO
 47 - 103 - 03398
 STATE COUNTY PERMIT

WELL TYPE: OIL GAS LIQUID INJECTION WASTE DISPOSAL
 (IF GAS) PRODUCTION: STORAGE DEEP SHALLOW

LOCATION ELEVATION: 1488' WATERSHED: Little Fishing Creek QUADRANGLE: Littleton
 DISTRICT: Center COUNTY: Wetzel

SURFACE OWNER: John R. & Phyllis R. Bohrer ACREAGE: 52.95 ±
 ROYALTY OWNER: Green Dot Farm, Inc., etal. LEASE NO: 215535 ACREAGE: 121.18 ±

PROPOSED WORK: DRILL CONVERT DRILL DEEPER FRACTURE OR STIMULATE PLUG OFF OLD FORMATION
 PERFORATE NEW FORMATION OTHER PHYSICAL CHANGE IN WELL (SPECIFY) _____

PLUG AND ABANDON CLEAN OUT AND REPLUG TARGET FORMATION: Marcellus ESTIMATED DEPTH: 7,575'

WELL OPERATOR: EQT Production Company DESIGNATED AGENT: Joseph C Mallow
 ADDRESS: 400 Woodcliff Drive ADDRESS: 427 Midstate Drive
 Canonsburg, PA 15317 Clarksburg, WV 26301

07/21/2023

**INFORMATION SUPPLIED UNDER WEST VIRGINIA CODE
Chapter 22, Article 6A, Section 5(a)(5)
IN LIEU OF FILING LEASE(S) AND OTHER CONTINUING CONTRACT(S)**

Under the oath required to make the verification on page 1 of this Notice and Application, I depose and say that I am the person who signed the Notice and Application for the Applicant, and that –

- (1) the tract of land is the same tract described in this Application, partly or wholly depicted in the accompanying plat, and described in the Construction and Reclamation Plan;
- (2) the parties and recordation data (if recorded) for lease(s) or other continuing contract(s) by which the Applicant claims the right to extract, produce or market the oil or gas are as follows:

Lease Name or Number	Grantor, Lessor, etc.	Grantee, Lessee, etc.	Royalty	Book/Page
-------------------------	-----------------------	-----------------------	---------	-----------

See Attachment

**Acknowledgement of Possible Permitting/Approval
In Addition to the Office of Oil and Gas**

The permit applicant for the proposed well work addressed in this application hereby acknowledges the possibility of the need for permits and/or approvals from local, state, or federal entities in addition to the DEP, Office of Oil and Gas, including but not limited to the following:

- WV Division of Water and Waste Management
- WV Division of Natural Resources WV Division of Highways
- U.S. Army Corps of Engineers
- U.S. Fish and Wildlife Service
- County Floodplain Coordinator

RECEIVED
Office Of Oil and Gas

JUN 27 2023

WV Department of
Environmental Protection

The applicant further acknowledges that any Office of Oil and Gas permit in no way overrides, replaces, or nullifies the need for other permits/approvals that may be necessary and further affirms that all needed permits/approvals should be acquired from the appropriate authority before the affected activity is initiated.

Well Operator: EQT Production Company
 By: John Zavatchan
 Its: Project Specialist - Permitting

Lease No.	Grantor, Lessor, etc.	Acres	Grantee, Lessee, etc.	Royalty	Book/Page
<u>215535</u>	<u>Green Dot Farm, Inc., et al.</u> Green Dot Farm, Inc.	121.18 ac	EQT Production Company	"at least 1/8th per WV Code 22-6-8"	OG 274A/387
<u>120250</u>	<u>Jeanne Anne Lambert, et al.</u> Daniel Lambert and M. J. Lambert, his wife South Penn Oil Company Tri-State Gas Company South Penn Oil Company Hope Natural Gas Company Consolidated Gas Supply Corporation Consolidated Gas Transmission Corporation CNG Transmission Corporation Eastern States Oil & Gas, Inc. Blazer Energy Corp. Eastern States Oil & Gas, Inc. Eastern States, Inc. Equitable Production-Eastern States, Inc. Equitable Production Company	150 ac	South Penn Oil Company Tri-State Gas Company South Penn Oil Company Hope Natural Gas Company Consolidated Gas Supply Corporation Consolidated Gas Transmission Corporation CNG Transmission Corporation Eastern States Oil & Gas, Inc. Blazer Energy Corp. Eastern States Oil & Gas, Inc. Eastern States, Inc. Equitable Production-Eastern States, Inc. Equitable Production Company EQT Production Company	"at least 1/8th per WV Code 22-6-8"	DB 53/380 DB 59/425 DB 73/310 DB 96/296 DB 233/387 DB 311/184 Corp. Book 13/151 OG 76A/232 Corp. Book 12/253 Corp. Book 12/259 WV SOS WV SOS WV SOS Corp. Book 13/14
<u>110102</u>	<u>Acropolis, Inc., et al.</u> Acropolis, Inc., et al. Drilling Appalachian Corporation Grenadier Energy Partners, LLC Drilling Appalachian Corporation Statoil USA Onshore Properties Inc., et al	43.8 ac	Drilling Appalachian Corporation Grenadier Energy Partners, LLC Statoil USA Onshore Properties Inc. Statoil USA Onshore Properties Inc. EQT Production Company	"at least 1/8th per WV Code 22-6-8"	OG 82A/176 OG 124A/9 & 136A/538 OG 138A/1 OG 138A/54 OG 175A/707
<u>136368</u>	<u>Owen E. Schmucker and Saloma D. Schmucker, et al.</u> Owen E. Schmucker and Saloma D. Schmucker, husband and wife Antero Resources Corporation	77.41875 ac	Antero Resources Corporation EQT Production Company	"at least 1/8th per WV Code 22-6-8"	OG 201A/896 OG 231A/59
<u>120326004</u>	<u>Owen E. Schmucker and Saloma D. Schmucker, et al.</u> Owen E. Schmucker and Saloma D. Schmucker, husband and wife Antero Resources Corporation	52.45 ac	Antero Resources Corporation EQT Production Company	"at least 1/8th per WV Code 22-6-8"	OG 189A/408 OG 231A/59

<u>174986</u>	<u>Ronald Richard Morris, Sr., et al.</u> Ronald Richard Morris, Sr., a widower Antero Resources Corporation	10.122 ac	Antero Resources Corporation EQT Production Company	"at least 1/8th per WV Code 22-6-8"	OG 213A/872 OG 269A/533
<u>103122</u>	<u>William B. Francik and Pamela S. Francik, Trustees of the William B. and Pamela S. Francik Joint Revocable Living Trust dated 2/12/2018, et al.</u> William B. Francik & Pamela S. Francik, husband and wife Statoil USA Onshore Properties Inc., et al	8.9 ac	Statoil USA Onshore Properties Inc. EQT Production Company	"at least 1/8th per WV Code 22-6-8"	OG 164A/268 OG 175A/707
<u>120326015</u>	<u>Mary Colleen Olson, et al.</u> Mary C. Olson, a widow Antero Resources Corporation	125.1625 ac	Antero Resources Corporation EQT Production Company	"at least 1/8th per WV Code 22-6-8"	OG 208A/512 OG 269A/533
<u>216185</u>	<u>Drilling Appalachian Corporation, et al.</u> Drilling Appalachian Corporation	122 ac	EQT Production Company	"at least 1/8th per WV Code 22-6-8"	OG 276A/602
<u>218160</u>	<u>Green Dot Farm, Inc.</u> Green Dot Farm, Inc.	45.14 ac	EQT Production Company	"at least 1/8th per WV Code 22-6-8"	OG 283A/526
<u>131242</u>	<u>Green Dot Farm, Inc., et al.</u> Green Dot Farm, Inc.	36.9 ac	EQT Production Company	"at least 1/8th per WV Code 22-6-8"	OG 284A/275
<u>168019</u>	<u>Green Dot Farm, Inc., et al.</u> Green Dot Farm, Inc.	38 ac	EQT Production Company	"at least 1/8th per WV Code 22-6-8"	OG 283A/501
<u>119576</u>	<u>Green Dot Farm, Inc., et al.</u> Green Dot Farm, Inc.	47.5 ac	EQT Production Company	"at least 1/8th per WV Code 22-6-8"	OG 283A/571
<u>226208</u>	<u>Dewey David Kushaney, et al.</u> Jack Anderson, et al. L&M Oil and Gas, Inc. Charles E. Horner Delorse A. Horner John M. Horner	50 ac	L&M Oil & Gas, Inc. Charles E. Horner John M. Horner Delorse A. Horner EQT Production Company	"at least 1/8th per WV Code 22-6-8"	OG 71A/182 OG 79A/239 WB 84/668 OG 313A/170



June 22, 2023

Mr. Taylor Brewer
West Virginia Department of Environmental Protection
Office of Oil and Gas
601 57th Street SE
Charleston, WV 25304

Re: Cash 1H 6A1 Addendum

Dear Mr. Brewer,

This letter and supporting documentation serve as EQT Production Company's addendum to the WW-6A1 form associated with this well. The lease included on this addendum is a lease in which EQT "claims the right to extract, produce or market the oil or gas", but does not propose to encounter the lease with the proposed wellbore. EQT would like to report this lease as part of our Well Work Permit Application, as it is located within 50' of our proposed permitted wellbore.

If EQT does encounter this lease, an application for a permit modification will be filed with the West Virginia DEP, Office of Oil and Gas.

If you have any questions, please do not hesitate to contact me at 724-746-9073.

Sincerely,

A handwritten signature in blue ink, appearing to read 'J. Zavatchan'.

John Zavatchan
Project Specialist - Permitting

Enc.

07/21/2023



CASH 1H

5'

1-15-58
Lease No
215535

1-15-58
1-15-56
Lease No
106813

DRAWING NO: 1H ADDENDUM A

DRAWING NO:

SCALE: 1" = 100'

Date: JUNE 14, 2023

DRAWN BY: HB

SHEET 1 of 1



32 East Main Street
Carnegie, PA 15106
412 278-2100

07/21/2023



1-15-17

Lease No
217153

26'

1-15-30
Lease No
136368

CASH 1H

1-15-28
Lease No
136368

DRAWING NO: 1H ADDENDUM B
 DRAWING NO: _____
 SCALE: 1" = 100'
 Date: JUNE 14, 2023
 DRAWN BY: HB
 SHEET 1 of 1

KEYSTONE
 CONSULTANTS, LLC
 32 East Main Street
 Carnegie, PA 15106
 412-278-2100

07/21/2023

WW-6A1 addendum attachment

Operator's Well No.

Cash 1H Addendum

Lease No.	Grantor, Lessor, etc.	Acres	Grantee, Lessee, etc.	Royalty	Book/Page
✓ 106813	<u>Country Roads Minerals, LLC, et al.</u> Judy Jackson, aka, Judith K. Jackson, a married woman dealing in her sole and separate property	72.0875 ac	EQT Production Company	"at least 1/8th per WV Code 22-6-8"	OG 270A/327
✓ 217153	<u>Venable Royalty, LTD. and V14, LP</u> Venable Royalty, Ltd. and V14, LP	47.144 ac	EQT Production Company	"at least 1/8th per WV Code 22-6-8"	OG 282A/859

07/21/2023

Cash

Surface Owners:

- Robert E. Dorsey, Sr. and Brenda S. Dorsey
2052 Miller Run Rd.
Littleton, WV 26581
01-15-46 / 01-15-46.1
- Michael D. and Amber N. Amos
21299 Mountaineer HWY.
Littleton, WV 26581
01-15-59.1
- Charles O. and Sherlene Phillips
21228 Mountaineer HWY.
Wileyville, WV 26581
01-19-8
- John R. and Phyllis R. Bohrer
121 Barnhart St.
Weirton, WV 26062
01-15-58
- Sharon Sue Long and Diana Briggs
19324 Mountaineer HWY.
Wileyville, WV 26581
01-19-7

ORIGIN ID: PTA (724) 271-7516
OLIVIA PISHONERI
EQ1
400 WOODCLIFF DRIVE
CANONSBURG, PA 15317
UNITED STATES US
SHIP DATE: 21 JUN 23
ACTW/GT: 0.50 LB
CAD: 106107062INET4610

BILL SENDER

TO ROBERT E. SR. AND BRENDA S. DORSEY

2052 MILLER RUN RD.

LITTLETON WV 26581

REF: (724) 746-9073
INV: PO: S001035 G1 8151 8040
DEPT: OPISHONERI

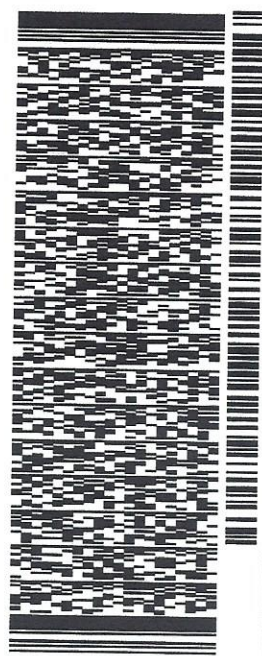

TRK# 7725 2439 1469
0201

FRI - 23 JUN 4:30P
** 2DAY **

6L MGWA

26581
PIT
WV-US

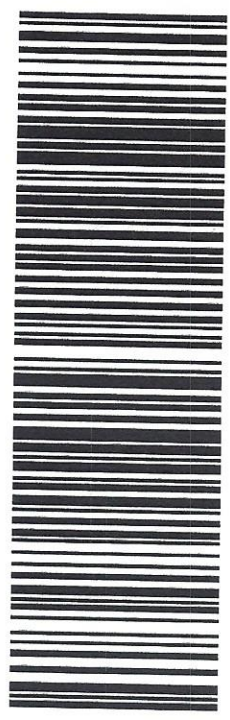

583J2I29AB/FE2D

After printing this label:

1. Use the 'Print' button on this page to print your label to your laser or inkjet printer.
2. Fold the printed page along the horizontal line.
3. Place label in shipping pouch and affix it to your shipment so that the barcode portion of the label can be read and scanned.

Warning: Use only the printed original label for shipping. Using a photocopy of this label for shipping purposes is fraudulent and could result in additional billing charges, along with the cancellation of your FedEx account number.

Use of this system constitutes your agreement to the service conditions in the current FedEx Service Guide, available on fedex.com. FedEx will not be responsible for any claim in excess of \$100 per package, whether the result of loss, damage, delay, non-delivery, misdelivery, or misinformation, unless you declare a higher value, pay an additional charge, document your actual loss and file a timely claim. Limitations found in the current FedEx Service Guide apply. Your right to recover from FedEx for any loss, including intrinsic value of the package, loss of sales, income interest, profit, attorney's fees, costs, and other forms of damage whether direct, incidental, consequential, or special is limited to the greater of \$100 or the authorized declared value. Recovery cannot exceed actual documented loss. Maximum for items of extraordinary value is \$1,000, e.g. jewelry, precious metals, negotiable instruments and other items listed in our Service Guide. Written claims must be filed within strict time limits, see current FedEx Service Guide.

ORIGIN ID: PITA (724) 271-7516
OLIVIA PISHONERI
EQ1
400 WOODCLIFF DRIVE
CANONSBURG, PA 15317
UNITED STATES US

SHIP DATE: 21 JUN 23
ACTWGT: 0.50 LB
CAD: 106107062/NET/4610

BILL SENDER

TO MICHAEL D. AND AMBER N. AMOS

21299 MOUNTAINEER HWY.

LITTLETON WV 26581

(724) 746-9073

REF:

P.O.: S001036, G1 8151, 8040

DEPT: OPISHONERI

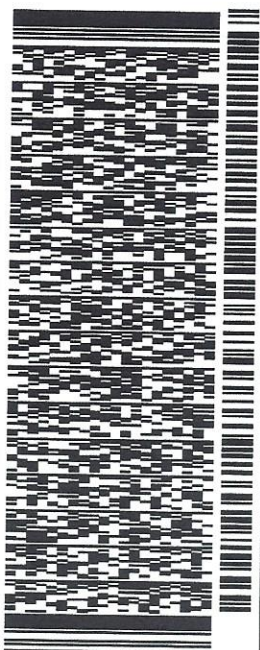

J232023040501LW

FRI - 23 JUN 4:30P

** 2DAY **

TRK# 7725 2439 2844
0201

6L MGWA

26581
PIT
WV-US

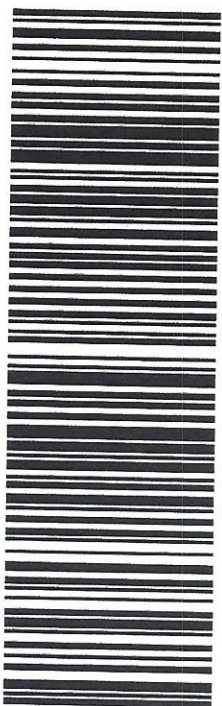

583J2/29AB/FE2D

After printing this label:

1. Use the 'Print' button on this page to print your label to your laser or inkjet printer.
2. Fold the printed page along the horizontal line.
3. Place label in shipping pouch and affix it to your shipment so that the barcode portion of the label can be read and scanned.

Warning: Use only the printed original label for shipping. Using a photocopy of this label for shipping purposes is fraudulent and could result in additional billing charges, along with the cancellation of your FedEx account number.

Use of this system constitutes your agreement to the service conditions in the current FedEx Service Guide, available on fedex.com. FedEx will not be responsible for any claim in excess of \$100 per package, whether the result of loss, damage, delay, non-delivery, misdelivery, or misinformation, unless you declare a higher value, pay an additional charge, document your actual loss and file a timely claim. Limitations found in the current FedEx Service Guide apply. Your right to recover from FedEx for any loss, including intrinsic value of the package, loss of sales, income interest, profit, attorney's fees, costs, and other forms of damage whether direct, incidental, consequential, or special is limited to the greater of \$100 or the authorized declared value. Recovery cannot exceed actual documented loss. Maximum for items of extraordinary value is \$1,000, e.g. jewelry, precious metals, negotiable instruments and other items listed in our Service Guide. Written claims must be filed within strict time limits, see current FedEx Service Guide.

07/21/2023

ORIGIN ID: PTA (724) 271-7516
OLIVIA PISHONERI
EQ1
400 WOODCLIFF DRIVE
CANONSBURG, PA 15317
UNITED STATES US

SHIP DATE: 21 JUN 23
ACTWGT: 0.50 LB
CAD: 106107062/INNET4610
BILL SENDER

TO CHARLES O. AND SHERLENE PHILLIPS

21228 MOUNTAINEER HWY.

WILEYVILLE WV 26581

(724) 746-9073
REF:
PO: S001036 G1 8151 8040

DEPT: OPHISONERI

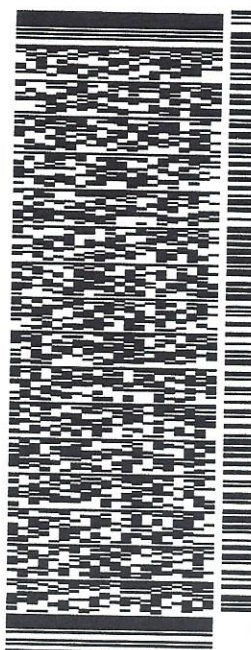

J232023040501uv

583J2/29AB/FE2D

TRK# 7725 2439 4870
0201

FRI - 23 JUN 4:30P
** 2DAY **

6L MGWA

26581
PIT
WV-US

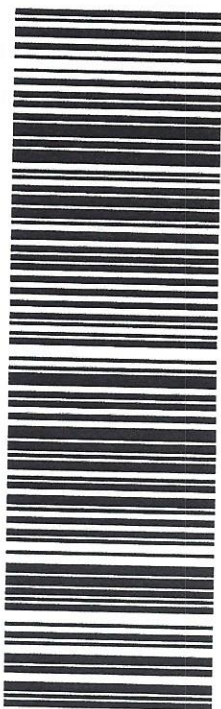

After printing this label:

1. Use the 'Print' button on this page to print your label to your laser or inkjet printer.
2. Fold the printed page along the horizontal line.
3. Place label in shipping pouch and affix it to your shipment so that the barcode portion of the label can be read and scanned.

Warning: Use only the printed original label for shipping. Using a photocopy of this label for shipping purposes is fraudulent and could result in additional billing charges, along with the cancellation of your FedEx account number.

Use of this system constitutes your agreement to the service conditions in the current FedEx Service Guide, available on fedex.com. FedEx will not be responsible for any claim in excess of \$100 per package, whether the result of loss, damage, delay, non-delivery, misdelivery, or misinformation, unless you declare a higher value, pay an additional charge, document your actual loss and file a timely claim. Limitations found in the current FedEx Service Guide apply. Your right to recover from FedEx for any loss, including intrinsic value of the package, loss of sales, income interest, profit, attorney's fees, costs, and other forms of damage whether direct, incidental, consequential, or special is limited to the greater of \$100 or the authorized declared value. Recovery cannot exceed actual documented loss. Maximum for items of extraordinary value is \$1,000, e.g. jewelry, precious metals, negotiable instruments and other items listed in our Service Guide. Written claims must be filed within strict time limits, see current FedEx Service Guide.

07/21/2023

ORIGIN ID: PITA (724) 271-7516
OLIVIA PISHONERI
EQI
400 WOODCLIFF DRIVE
CANNONSBURG, PA 15317
UNITED STATES US

SHIP DATE: 21 JUN 23
ACTW/GT: 0.50 LB
CAD: 106107062/INET4610
BILL SENDER

TO JOHN R. AND PHYLLIS R. BOHRER

121 BARNHART ST.

WEIRTON WV 26062

(724) 746-9073 REF:
INV:
P.O. S0010365.G1 8151.8040

DEPT: OPTIONERI

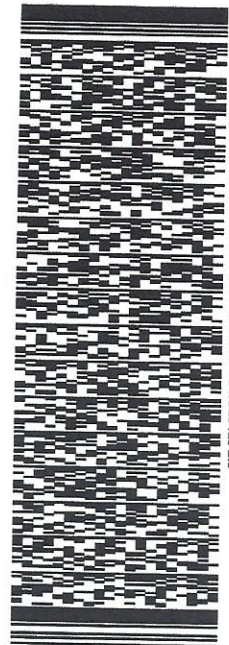

TRK# 7725 2439 9492
0201

FRI - 23 JUN 4:30P
** 2DAY **

65 PITA

26062
PIT
WV-US

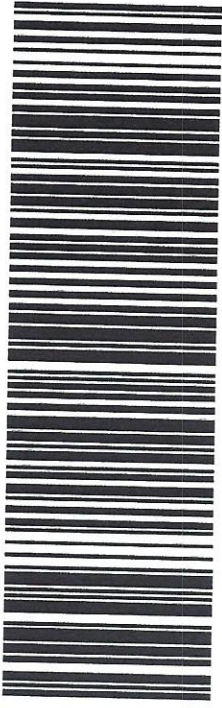

583J2/29AB/FE2D

After printing this label:

1. Use the 'Print' button on this page to print your label to your laser or inkjet printer.
2. Fold the printed page along the horizontal line.
3. Place label in shipping pouch and affix it to your shipment so that the barcode portion of the label can be read and scanned.

Warning: Use only the printed original label for shipping. Using a photocopy of this label for shipping purposes is fraudulent and could result in additional billing charges, along with the cancellation of your FedEx account number.

Use of this system constitutes your agreement to the service conditions in the current FedEx Service Guide, available on fedex.com. FedEx will not be responsible for any claim in excess of \$100 per package, whether the result of loss, damage, delay, non-delivery, misdelivery, or misinformation, unless you declare a higher value, pay an additional charge, document your actual loss and file a timely claim. Limitations found in the current FedEx Service Guide apply. Your right to recover from FedEx for any loss, including intrinsic value of the package, loss of sales, income interest, profit, attorney's fees, costs, and other forms of damage whether direct, incidental, consequential, or special is limited to the greater of \$100 or the authorized declared value. Recovery cannot exceed actual documented loss. Maximum for items of extraordinary value is \$1,000, e.g. jewelry, precious metals, negotiable instruments and other items listed in our Service Guide. Written claims must be filed within strict time limits, see current FedEx Service Guide.

07/21/2023

ORIGIN ID: PITA (724) 271-7516
OLYIA PISHONERI
EQT
400 WOODCLIFF DRIVE

SHIP DATE: 21 JUN 23
ACTWGT: 0.50 LB
CAD: 106107062/NET/4610

CANONSBURG, PA 15317
UNITED STATES US

BILL SENDER

TO SHARON SUE LONG AND DIANA BRIGGS

19324 MOUNTAINEER HWY.

WILEYVILLE WV 26581

REF: (724) 746-9073

PO: S001035.G1.8151.9040

DEPT: OPISHONERI

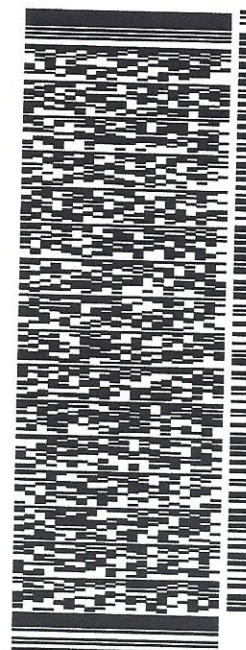

J232023040501uv

TRK# 7725 2440 4955
0201

FRI - 23 JUN 4:30P
** 2DAY **

6L MGWA

26581
WV-US
PIT

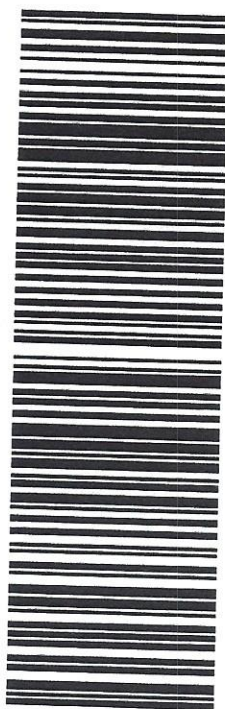

After printing this label:

1. Use the 'Print' button on this page to print your label to your laser or inkjet printer.
2. Fold the printed page along the horizontal line.
3. Place label in shipping pouch and affix it to your shipment so that the barcode portion of the label can be read and scanned.

Warning: Use only the printed original label for shipping. Using a photocopy of this label for shipping purposes is fraudulent and could result in additional billing charges, along with the cancellation of your FedEx account number.

Use of this system constitutes your agreement to the service conditions in the current FedEx Service Guide, available on fedex.com. FedEx will not be responsible for any claim in excess of \$100 per package, whether the result of loss, damage, delay, non-delivery, misdelivery, or misinformation, unless you declare a higher value, pay an additional charge, document your actual loss and file a timely claim. Limitations found in the current FedEx Service Guide apply. Your right to recover from FedEx for any loss, including intrinsic value of the package, loss of sales, income interest, profit, attorney's fees, costs, and other forms of damage whether direct, incidental, consequential, or special is limited to the greater of \$100 or the authorized declared value. Recovery cannot exceed actual documented loss. Maximum for items of extraordinary value is \$1,000, e.g. jewelry, precious metals, negotiable instruments and other items listed in our Service Guide. Written claims must be filed within strict time limits, see current FedEx Service Guide.

07/21/2023



June 26, 2023

Via FedEx Delivery

West Virginia Department of Environmental Protection
Office of Oil and Gas
601 57th Street, SE
Charleston, WV 25304-2345

RE: Well Work Permit and Above Ground Storage Tank Modification
Cash Well Site
Center District
Wetzel County, WV

Dear DEP Recipients:

Enclosed please find well work permit modification applications for the following wells:

- Cash 1H – Permit Number 47-103-03398
- Cash 3H – Permit Number 47-103-03524
- Cash 5H – Permit Number 47-103-03523
- Cash 7H – Permit Number 47-103-03522

The following modifications are being made with these applications:

- Lateral extensions on all four wells
- The addition of two new sources on the Water Management Plan
- The proposed addition of a 13/15k barrel AST on the location. Proof of notification for this addition has been included in each modification package.

RECEIVED
Office Of Oil and Gas

JUN 27 2023

WV Department of
Environmental Protection

Please note that the lateral extensions did not require notification of the surface owners. The notifications were provided to add the AST to the site. The revised site plan and Water Management Plan are included on the disk provided.

If you have any questions regarding this information, please feel free to contact me.

Best Regards,

John Zavatchan
Project Specialist – Permitting
jzavatchan@eqt.com
412-584-3132

Handwritten note:
CASH 578228
Amt \$2500
Date 6/15/23

07/21/2023



June 26, 2023

Via FedEx Overnight Delivery

West Virginia Department of Environmental Protection
Office of Oil and Gas
601 57th Street, S.E.
Charleston, WV 25304

RE: Horizontal Well Work Permit Application Modification
Cash 1H
Permit Number 47-103-03398
Center District, Wetzell County, WV

WVDEP Recipient,

Attached please find the Well Work Permit Application for the well referenced above. You will find the following included with this submittal:

- Check in the amount \$2,500.00 for the permit fee
- Completed WW-6B and supporting documents, approved by the O&G Inspector
- Well Location Plat
- Completed Form WW-6A1 and supporting documentation including Addendum
- Notification Information (AST Modification)
- Hydraulic Fracturing Monitoring Plan
- Offset Well Map and Table
- DVD containing the revised Water Management Plan and Site Plans including AST

EQT is proposing to extend the lateral from the previously permitted length as well as adding an AST.

EQT Production trusts that if any portion of the submitted documentation is found to be inadequate for processing the permit, notification will be made to our Permitting department at your earliest convenience. It is EQT Production's intent to cooperate fully to provide any additional requested documentation and clarification in a timely manner such that permitting proceeds in a predictable and logical manner.

Best Regards,

John Zavatchan
Project Specialist – Permitting
jzavatchan@eqt.com
724-746-9073

RECEIVED
Office Of Oil and Gas

JUN 27 2023

WV Department of
Environmental Protection

07/21/2023