

1,591' to Top Hole

7,690' to Bottom Hole

LATITUDE 39 - 35 - 00

LONGITUDE 80 - 45 - 00

Antero Resources
Well No. Busch 1H
As-Drilled
Antero Resources Corporation

Sheet 1 of 3

Busch Unit 1H
Bottom Hole

BTM Hole
7.5' Spot

See Detail
Page 2



Top Hole Coordinates, As-drilled data, and information was provided by Antero Resources Corporation. Allegheny Surveys Inc. (ASI) is not certifying the data and information provided. ASI is not responsible for any errors or inaccuracies with the data and information that has been provided.

I, the undersigned, hereby certify that this plat is correct to the best of my knowledge and belief and shows all the information required by law and the rules issued and prescribed by the Department of Environmental Protection.

Bradley D. Miller, P.S. 2167



SEAL

Note: 1 water well was found within 2000' of proposed well. No occupied dwellings or buildings 2,500 square feet or larger used to house or shelter dairy cattle or poultry husbandry are located within 625' of the center of the well pad.

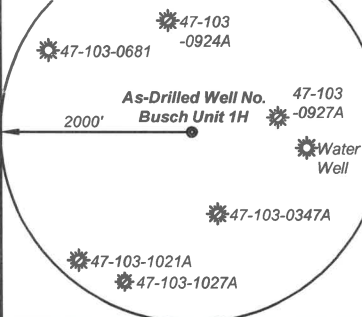

	Bearing	Dist.
L1	S 40°07' E	2,550.9'
L2	S 46°17' W	1,557.2'
L3	N 66°16' W	1,034.1'
L4	N 41°11' W	863.6'

Legend

- Proposed gas well
- Monument, as noted
- Existing Well, as noted
- Digitized Well, as noted
- Creek or Drain
- Road
- Surface boundary (approx.)
- Interior surface tracts (approx.)
- Railroad Right-of-Way

Busch Unit 1H As-Drilled
POE Coordinates
West Virginia
Coordinate System
of 1927, North Zone
N: 384,431.66'
E: 1,644,017.37'
Latitude: 39°32'55.04"
Longitude: 80°45'44.77"
UTM Zone 17, NAD 1983
N: 4,377,696.515m
E: 520,426.396m

Wellhead Layout (NTS)

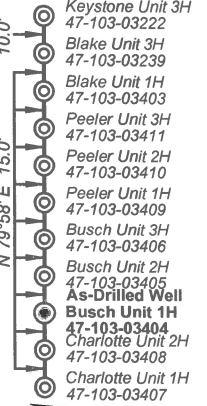

Notes
West Virginia Coordinate System of 1927, North Zone based upon Differential GPS Measurements. Well No. Busch Unit 1H Top Hole coordinates are N: 384,871.79' Latitude: 39°32'59.66" E: 1,645,939.77' Longitude: 80°45'20.31" Bottom Hole coordinates are N: 396,670.25' Latitude: 39°34'55.43" E: 1,640,004.65' Longitude: 80°46'38.22" UTM Zone 17, NAD 1983 Top Hole Coordinates Bottom Hole Coordinates N: 4,377,840.396m N: 4,381,404.657m E: 521,009.834m E: 519,141.792m Plat orientation and corner and well references are based upon the grid north meridian. Well location references are based upon the magnetic meridian.

FILE NO: 235-34-G-17
DRAWING NO: Busch 1H As-Drilled
SCALE: 1" = 1500'
MINIMUM DEGREE OF ACCURACY: Submeter
PROVEN SOURCE OF ELEVATION: CORS, Monroe County, OH

STATE OF WEST VIRGINIA
DEPARTMENT OF ENVIRONMENTAL PROTECTION
OIL AND GAS DIVISION

DATE: March 16 2022
OPERATOR'S WELL NO. Busch Unit 1H
API WELL NO
47 - 103 - 03404
STATE COUNTY PERMIT

WELL TYPE: OIL GAS LIQUID INJECTION WASTE DISPOSAL
(IF GAS) PRODUCTION: STORAGE DEEP SHALLOW
LOCATION: ELEVATION: As-Built 1,223.8' WATERSHED: Fishing Creek QUADRANGLE: Porter Falls
DISTRICT: Green William L. & SURFACE OWNER: Delores J. Gadd COUNTY: Wetzel
ROYALTY OWNER: Shiben Estates, Inc.; Gladys E. Conley Trust; Chesapeake Appalachia, LLC. LEASE NO: ACREAGE: 60.5
PROPOSED WORK: DRILL CONVERT DRILL DEEPER FRACTURE OR STIMULATE PLUG OFF OLD FORMATION
 PERFORATE NEW FORMATION OTHER PHYSICAL CHANGE IN WELL (SPECIFY) As-Drilled
 PLUG AND ABANDON CLEAN OUT AND REPLUG TARGET FORMATION: Marcellus Shale ESTIMATED DEPTH: 20,345' MD

WELL OPERATOR: Antero Resources Corporation DESIGNATED AGENT: Dianna Stamper - CT Corporation System
ADDRESS: 1615 Wynkoop Street ADDRESS: 5400 D Big Tyler Road
Denver, CO 80202 Charleston, WV 25313

Antero Resources
Well No. Busch 1H
As-Drilled
 Antero Resources Corporation



Leases	
A	Shiben Estates, Inc.
B	BRC Appalachian Minerals I LLC
C	John W. Bertram
D	David A. Dickey
E	Sandra Rose Conley
F	Richard Lee Tennant, et ux
G	Harry I. Elson
H	Chesapeake Appalachia, LLC
I	Gladys E. Conley Trust
J	Mildred Caseman
K	Sielger Family Trust
L	Chesapeake Appalachia, LLC
M	Loretta Paulette Ueltschy
N	Donald E. Dawson, et ux
O	Lee & Hall Royalties
P	Richard B. Dallison, et ux
Q	Paul H. Abel
R	Ridgetop Royalties, LLC
S	Ridgetop Royalties, LLC
T	Leslie A. Lively
U	Bounty Minerals, LLC
V	Robert D. Loy, et ux
W	Beulah I. Snider
X	Emma Ruth Taylor
Y	Leslie A. Lively
Z	Antero Minerals
AA	Richards Resources
AB	WVDNR
AC	San-Dee N. Stradley
AD	Michelle R. Mason
AE	OPEN
AF	Phillip Wiley
AG	Antero Minerals
AH	Jeffrey J. Ellis
AI	Joyce Cain
AJ	Barbara Sue Thomas
AK	SanDee Nieboer Stradley
AL	Roberta Lyn Sommerville
AM	Steven J. Melott
AN	Joyce Cain
AO	OPEN
AP	Allen G. Cain, et ux
AQ	Rodney Dale Weekley, et ux
AR	Jodie J. Dawson
AS	Raymond E. Lasure, et ux
AT	Kimberly A. Miller
AU	Rodney Dale Weekley, et ux
AV	Amelia Ann Booher & Roy L. Vancamp
AW	Lee E. Bassett, et ux
AX	David Wilson
AY	Peggy Ann Dawson Supplemental Needs Trust
AZ	John R. Morgan
BA	James David Alawine
BB	Elwood L. & Carmen Y. Blake
BC	John R. Morgan
BD	Michelle R. Mason
BE	Allen G. Morgan
BF	CSX Transportation
BG	David E. Bowyer
BH	CSX Transportation

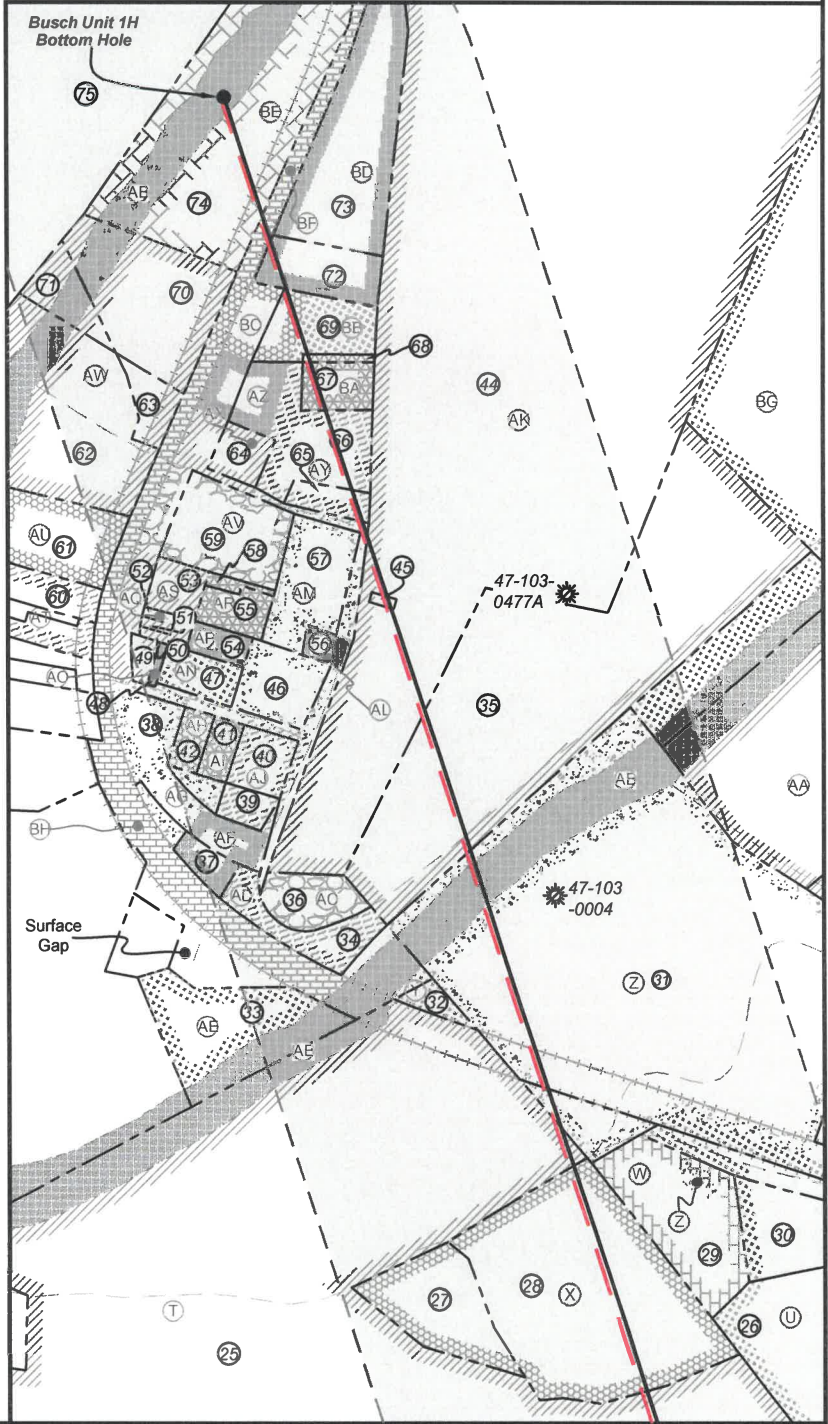

FILE NO: 235-34-G-17
 DRAWING NO: Busch 1H As-Drilled
 SCALE: 1" = 1500'
 MINIMUM DEGREE OF ACCURACY: Submeter
 PROVEN SOURCE OF ELEVATION: CORS, Monroe County, OH

STATE OF WEST VIRGINIA
 DEPARTMENT OF ENVIRONMENTAL PROTECTION
OIL AND GAS DIVISION

DATE: March 16 2022
 OPERATOR'S WELL NO. Busch Unit 1H
 API WELL NO
47 - 103 - 03404
 STATE COUNTY PERMIT

WELL TYPE: OIL GAS LIQUID INJECTION WASTE DISPOSAL
 (IF GAS) PRODUCTION: STORAGE DEEP SHALLOW

LOCATION: ELEVATION: As-Built 1,223.8' WATERSHED: Fishing Creek QUADRANGLE: Porter Falls
 DISTRICT: Green William L. & SURFACE OWNER: Delores J. Gadd COUNTY: Wetzel ACREAGE: 60.5
 ROYALTY OWNER: Shiben Estates, Inc.; Gladys E. Conley Trust; Chesapeake Appalachia, LLC; LEASE NO: _____ ACREAGE: _____
 PROPOSED WORK: DRILL CONVERT DRILL DEEPER FRACTURE OR STIMULATE PLUG OFF OLD FORMATION
 PERFORATE NEW FORMATION OTHER PHYSICAL CHANGE IN WELL (SPECIFY) As-Drilled
 PLUG AND ABANDON CLEAN OUT AND REPLUG TARGET FORMATION: Marcellus Shale ESTIMATED DEPTH: 20,345' MD

WELL OPERATOR: Antero Resources Corporation DESIGNATED AGENT: Dianna Stamper - CT Corporation System
 ADDRESS: 1615 Wynkoop Street ADDRESS: 5400 D Big Tyler Road
Denver, CO 80202 Charleston, WV 25313

08/12/2022



ID	TM/Par	Owner	Bk/Pg	Acres	ID	TM/Par	Owner	Bk/Pg	Acres
1	16-22	William L. & Delores J. Gadd	348/169	60.50	40	31-16	Barbara Sue Thomas	457/139	0.30
2	16-31	William L. & Delores J. Gadd	348/169	2.65	41	31-15	Carl J. Lancaster Est.	WB66/516	0.17
3	16-23	Kenneth E. Butler	331/110	50.97	42	31-14	Jeffrey J. Ellis	466/868	0.17
4	16-30	William L. & Delores J. Gadd	348/169	14.00	43	12-11	Timothy L. & Michael A. McDiffitt	385/189	131.34
5	16-47	William M. Greenawalt & Lee A. Niezgoda	387/1	12.00	44	7-53	Easterling Trust	446/376	32.98
					45	31-9	Columbia Gas Trans Corp.	263/164	0.02
6	16-38	Silas Tennant	137/85	15.50	46	31-11	Steven J. Melott	420/137	---
7	16-37	Garrett S. Estate	316/248	61.00	47	31-28	Carl J. Lancaster Est.	WB66/516	0.28
8	16-21.1	Mildred E. Caseman	WB45/396	15.00	48	31-26.1	Michael or Melissa Scyoc	461/681	0.06
9	16-21	Mildred E. Caseman	WB45/396	40.00	49	31-26	Raymond E. & Catherine H. Lasure	249/435	0.09
10	16-21.2	Mildred E. Caseman	WB45/396	20.06	50	31-25	Raymond E. & Catherine H. Lasure	258/151	0.03
11	16-20	Bonita Andrich, et al	WB70/243	79.03	51	31-24	Raymond E. & Catherine H. Lasure	249/435	0.03
12	16-8	Wilbur B. Dawson & Loretta P. Ueltschy	408/192	75.75	52	31-12	Rodney Dale Weekley	302/779	0.03
13	16-21.3	Mildred E. Caseman	WB45/396	12.00	53	31-12.2	Raymond E. & Catherine H. Lasure	249/435	0.28
14	16-21.4	Mildred E. Caseman	WB45/396	1.00	54	31-12.3	Allen G. & Joyce E. Cain	316/133	0.16
15	16-3	Wilbur B. Dawson & Loretta P. Ueltschy	408/192	49.80	55	31-12.1	Jody J. Dawson	344/149	0.25
16	16-3.1	Donald E. & Carolyn L. Dawson	332/114	10.00	56	31-10	M E Church	134/457	0.08
17	12-55	Bradley W. Ueltschy	330/37	100.00	57	31-8	Steven J. Melott	420/400	0.75
18	12-49	John W. & Rosalie M. Ueltschey	362/403	86.55	58	31-7.1	Jody J. Dawson	344/149	0.06
19	12-50	Richard B. & Jaynee C. Dallison	399/288	37.00	59	31-7	Danny R. & Christina F. Booher	285/134	0.80
20	12-39	Martin E. Rodgers	421/621	60.00	60	31-27.1	Kimberly A. Miller	406/527	0.15
21	12-26	Martin E. Rodgers	419/493	50.40	61	31-27	Rodney D. Weekley	302/779	1.40
22	12-40	Martin E. Rodgers	421/621	60.00	62	31-23	Lee E. & Charlotte D. Bassett	395/29	1.42
23	12-30	Martin E. Rogers	363/413	51.08	63	31-22	Lee E. & Charlotte D. Bassett	395/29	0.50
24	12-27	Martin E. Rogers	363/413	3.08	64	31-6	The Peggy Ann Dawson Supplemental Needs Trust	471/214	0.23
25	12-18	Leslie A. Lively	387/229	39.63	65	31-5	The Peggy Ann Dawson Supplemental Needs Trust	471/214	0.25
26	12-20.1	Jerome E. II & Benita K. Staley	415/329	13.34	66	31-4	The Peggy Ann Dawson Supplemental Needs Trust	471/214	0.98
27	12-18.2	Charles A. Loy	331/320	1.18	67	31-4.1	James David Alawine	479/448	0.50
28	12-18.1	Martha R. Campbell	254/495	3.37	68	31-4.3	James David Alawine	479/448	0.05
29	12-19	Beulah I. Snider	WB45/396	1.30	69	31-4.2	Elwood & Carman Y. Blake	371/617	0.58
30	12-20	Bonnie Ueltschy	WB70/248	0.75	70	31-21	Lee E. & Charlotte D. Bassett	395/29	2.50
31	12-5	Columbia Gas Trans Corp.	263/164	11.70	71	31-23.1	Lee E. & Charlotte D. Bassett	395/29	0.33
32	31-20	B&O RR Co.	---	0.14	72	31-1	Elwood & Carman Y. Blake	371/649	0.39
33	31-35	Kenneth Scyoc, et al	AP10/559	1.10	73	7-52	Ronnie Lee Powers	340/248	1.00
34	31-19	Paul Abel Trust	328/377	0.66	74	7-51	Shawn C. Stackpole	406/622	4.12
35	12-4	Easterling Trust	446/376	7.16	75	7-50	Bradley W. & Kimberly Ueltschy	342/710	79.78
36	12-3	Easterling Trust	446/376	0.50					
37	31-18	Phillip Wiley	379/245	0.33					
38	31-13	Clair Phillip Dawson, Jr.	471/210	0.25					
39	31-17	Barbara Sue Thomas	457/139	0.17					

FILE NO: 235-34-G-17
 DRAWING NO: Busch 1H As-Drilled
 SCALE: 1" = 1500'
 MINIMUM DEGREE OF ACCURACY:
Submeter
 PROVEN SOURCE OF ELEVATION:
CORS, Monroe County, OH

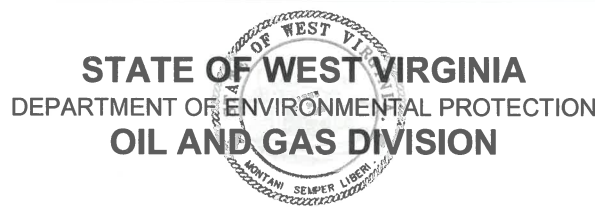

DATE: March 16 2022
 OPERATOR'S WELL NO. Busch Unit 1H
 API WELL NO
47 - 103 - 03404
 STATE COUNTY PERMIT

WELL TYPE: OIL GAS LIQUID INJECTION WASTE DISPOSAL
 (IF GAS) PRODUCTION: STORAGE DEEP SHALLOW

LOCATION: ELEVATION: As-Built 1,223.8' WATERSHED: Fishing Creek QUADRANGLE: Porter Falls
 DISTRICT: Green William L. & SanDee Nieboer Stradley; Michelle R. Mason; WVDNR; CSX Transportation, Inc.; COUNTY: Wetzel **08/12/2022**
 SURFACE OWNER: Delores J. Gadd James David Alawine; John R. Morgan; Elwood L. & Carmen Y. Blake; Allen G. Morgan; ACREAGE: 60.5
 ROYALTY OWNER: Shiben Estates, Inc.; Gladys E. Conley Trust; Chesapeake Appalachia, LLC; Emma Ruth Taylor; Steven J. Melott; Peggy Ann Dawson Supplemental Needs Trust; LEASE NO: _____ ACREAGE: _____
Paul H. Abel; Ridgetop Royalties, LLC (2); Leslie A. Lively; Lee & Hall Royalties; Antero Minerals; Donald E. Dawson, et ux; Loretta Paulette Ueltschy;

PROPOSED WORK: DRILL CONVERT DRILL DEEPER FRACTURE OR STIMULATE PLUG OFF OLD FORMATION
 PERFORATE NEW FORMATION OTHER PHYSICAL CHANGE IN WELL (SPECIFY) As-Drilled 6,934' TVD
 PLUG AND ABANDON CLEAN OUT AND REPLUG TARGET FORMATION: Marcellus Shale ESTIMATED DEPTH: 20,345' MD

WELL OPERATOR: Antero Resources Corporation DESIGNATED AGENT: Dianna Stamper - CT Corporation System
 ADDRESS: 1615 Wynkoop Street ADDRESS: 5400 D Big Tyler Road
Denver, CO 80202 Charleston, WV 25313