

Antero Resources
Well No. Charlotte 1H
 Antero Resources Corporation

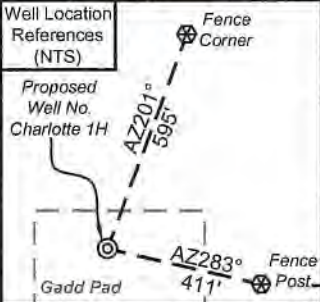

I, the undersigned, hereby certify that this plat is correct to the best of my knowledge and belief and shows all the information required by law and the rules issued and prescribed by the Department of Environmental Protection.

Bradley D. Miller
 Bradley D. Miller, P.S. 2167



SEAL

Note: 1 water well was found within 2000' of proposed well. No occupied dwellings or buildings 2,500 square feet or larger used to house or shelter dairy cattle or poultry husbandry are located within 625' of the center of the well pad.

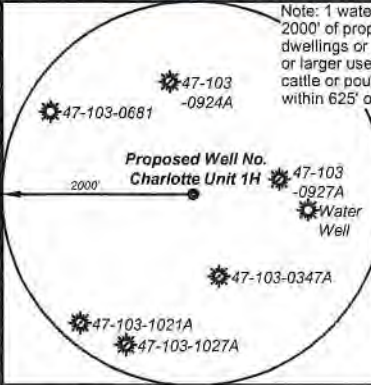

Legend	
	Proposed gas well
	Monument, as noted
	Existing Well, as noted
	Digitized Well, as noted
	Creek or Drain
	Road
	Surface boundary (approx.)
	Interior surface tracts (approx.)
	Railroad

11,695' to Bottom Hole
 1,620' to Top Hole
TOP HOLE LATITUDE 39 - 35 - 00
BTM HOLD LATITUDE 39 - 32 - 30

Notes
 West Virginia Coordinate System of 1927, North Zone based upon Differential GPS Measurements.
 Well No. Charlotte Unit 1H Top Hole coordinates are
 N: 384,866.49' Latitude: 39°32'59.60"
 E: 1,645,910.51' Longitude: 80°45'20.68"
 Bottom Hole coordinates are
 N: 373,753.10' Latitude: 39°31'09.98"
 E: 1,647,435.81' Longitude: 80°44'59.24"
 UTM Zone 17, NAD 1983
 Top Hole Coordinates: Bottom Hole Coordinates
 N: 4,377,838.633m N: 4,374,460.619m
 E: 521,000.947m E: 521,522.020m
 Plat orientation and corner and well references are based upon the grid north meridian.
 Well location references are based upon the magnetic meridian.

Notes:
 Well No. Charlotte Unit 1H UTM Zone 17, NAD 1927
 Top Hole Coordinates
 N: 14,362,243.59'
 E: 1,709,269.21'
 Point of Entry Coordinates
 N: 14,361,357.23'
 E: 1,707,434.53'
 Bottom Hole Coordinates
 N: 14,351,160.94'
 E: 1,710,979.22'

	Bearing	Dist.
L1	S 39°32' E	2,536.2'
L2	S 46°53' W	1,582.1'
L3	N 67°10' W	1,058.9'
L4	N 42°51' W	879.2'
L5	S 65°10' W	2,038.3'

GRID NORTH

TOP HOLE LONGITUDE 80 - 45 - 00
 BTM HOLE LONGITUDE 80 - 42 - 30
 8,096' to Bottom Hole

12,182' to Top Hole

STATE OF WEST VIRGINIA
 DEPARTMENT OF ENVIRONMENTAL PROTECTION
OIL AND GAS DIVISION

FILE NO: 323-34-G-17
 DRAWING NO: Charlotte 1H Well Plat
 SCALE: 1" = 1500'
 MINIMUM DEGREE OF ACCURACY: Submeter
 PROVEN SOURCE OF ELEVATION: CORS, Monroe County, OH

DATE: April 28 2021
 OPERATOR'S WELL NO. Charlotte Unit 1H
 API WELL NO. HGA
 47 - 103 - 03407
 STATE COUNTY PERMIT

WELL TYPE: OIL GAS LIQUID INJECTION WASTE DISPOSAL
 (IF GAS) PRODUCTION: STORAGE DEEP SHALLOW

LOCATION: ELEVATION: As-Built 1,223.8' WATERSHED: Fishing Creek QUADRANGLE: Porter Falls
 DISTRICT: Green William L. & Christenson Family Trust; Harry I Elson; Howard M. Henderson; Suzann Marie Sloehr, et al; David A. Dickey; H. Dorn Higginbotham; Sally Lou Anderson; Jim R. McHenry; Susie T. Grimm; Kevin S. Goff, et ux; Chesapeake Appalachia, LLC (2);
 SURFACE OWNER: Delores J. Gadd
 COUNTY: Wetzel
 ACRES: 60.5
 ROYALTY OWNER: Shiben Estates, Inc. (2); Gladys E. Conley Trust; Richard Lee Tennant, et ux; LEASE NO: ACRES: 25.2875; 80;
 PROPOSED WORK: DRILL CONVERT DRILL DEEPER FRACTURE OR STIMULATE PLUG OFF OLD FORMATION
 PERFORATE NEW FORMATION OTHER PHYSICAL CHANGE IN WELL (SPECIFY)
 PLUG AND ABANDON CLEAN OUT AND REPLUG TARGET FORMATION: Marcellus Shale ESTIMATED DEPTH: 7,500' TVD
 21,500' MD

WELL OPERATOR: Antero Resources Corporation DESIGNATED AGENT: Dianna Stamper - CT Corporation System
 ADDRESS: 1615 Wynkoop Street ADDRESS: 5400 D Big Tyler Road
 Denver, CO 80202 Charleston, WV 25313

06/18/2021

Antero Resources
Well No. Charlotte 1H
 Antero Resources Corporation



Leases	
A	Shiben Estates, Inc.
B	Ellen W. & Mark L. VanDyne
C	John W. Bertram
D	BRC Appalachian Minerals I, LLC
E	Mildred Caseman
F	Gladys E. Conley Trust
G	Sandra Rose Conley
H	Chesapeake Appalachia, LLC
I	Harry I. Elson
J	Richard Lee Tennant, et ux
K	Michael Tennant
L	Shiben Estates, Inc.
M	Susie T. Grimm
N	Thomas M. Stackhouse
O	Kevin S. Goff, et ux
P	David A. Dickey
Q	Chesapeake Appalachia, LLC
R	Joyce E. Henry
S	Ronald Hall
T	Chesapeake Appalachia, LLC
U	H. Dorn Higginbotham
V	Perry Dale Thorne, Jr., et ux
W	Betty S. Burns
X	Black Gold Group, LTD
Y	Sally Lou Anderson
Z	Jim R. McHenry
AA	Christenson Family Trust
AB	Boyd Muzzy, et ux
AC	Howard M. Henderson
AD	Suzann Marie Stoehr, et al
AE	NO LEASE

ID	TMPar	Owner	Bk/Pg	Acres
1	16-22	William L. & Delores J. Gadd	348/169	60.50
2	16-31	William L. & Delores J. Gadd	348/169	2.65
3	16-23	Kenneth E. Butler	331/110	50.97
4	16-30	William L. & Delores J. Gadd	348/169	14.00
5	16-21	Mildred E. Caseman	WB45/396	40.00
6	16-21.2	Mildred E. Caseman	WB45/396	20.06
7	16-20	Bonita Andrich, et al	WB70/243	79.03
8	16-21.1	Mildred E. Caseman	WB45/396	15.00
9	16-37	Garrett S. Estate	316/248	61.00
10	16-47	William M. Greenwalt & Lee A. Niezgoda	387/1	12.00
11	16-38	Silas Tennant	137/85	15.50
12	16-39	Silas & William A. Tennant	WB27/97	23.30
13	16-45	James E. Newman	400/234	18.50
14	16-55	James E. Newman	400/234	4.00
15	16-56	James L. & Martha Jo Stewart	288/330	23.33
16	16-59.2	James L. & Martha Jo Stewart	288/330	4.50
17	16-59	Mark & Patti Goldstein	305/586	34.97
18	16-61	Michael L. & Tina M. Adams	444/427	67.96
19	16-61.1	Church of Christ	218/337	0.42
20	16-61.2	Harry K. Eastham	299/450	0.38
21	19-61.3	Michael L. & Tina M. Adams	346/443	3.83
22	19-61.4	Michael L. & Tina M. Adams	377/309	7.91
23	19-8.4	Ronald Hall	385/65	2.17
24	19-17.2	Timothy J. Horner	444/381	2.76
25	19-16	Richard R. & Mary J. Scyoc	443/336	73.96
26	19-17	John R. & Mary Ann Horner	416/853	47.55
27	19-16.1	Richard R. & Mary J. Scyoc	445/20	2.74
28	19-25	Perry Dale, Jr. & Martha Jo Thorne	348/298	5.34
29	19-17.1	Zachary M. & Jessica N. Pittman	421/145	1.83
30	19-33	John A. Earnest	401/357	9.30
31	19-34	Sharon M. & Ronald L. Christenson	439/373	2.00
32	19-35	Sharon M. & Ronald L. Christenson	439/373	20.00
33	19-36	Perry Dale, Jr. & Martha Jo Thorne	348/298	20.00
34	19-41	Sharon M. & Ronald L. Christenson	439/373	18.50
35	19-42	Sharon M. & Ronald L. Christenson	363/101	22.50
36	19-44	Boyd & Karen Muzzy	330/264	8.50
37	19-46	Sharon M. & Ronald L. Christenson	439/373	25.28
38	19-45	Sharon M. & Ronald L. Christenson	439/373	2.20
39	19-47	Suzann M. Stoehr, et al	WB48/422	80.00
40	18-1.1	Montana Sue & Lakota James Morris	WB51/364	25.73
41	18-1	William H. & Joclare Eastham	378/603	97.06
42	19-50	Ronald H. Eastham, et al	424/70	40.00

FILE NO: 323-34-G-17
 DRAWING NO: Charlotte 1H Well Plat
 SCALE: 1" = 1500'
 MINIMUM DEGREE OF ACCURACY:
 Submeter
 PROVEN SOURCE OF ELEVATION:
 CORS, Monroe County, OH

STATE OF WEST VIRGINIA
 DEPARTMENT OF ENVIRONMENTAL PROTECTION
OIL AND GAS DIVISION

DATE: April 28 2021
 OPERATOR'S WELL NO. Charlotte Unit 1H
 API WELL NO **H64**
 47 - 103 - 03407
 STATE COUNTY PERMIT

WELL TYPE: OIL GAS LIQUID INJECTION WASTE DISPOSAL
 (IF GAS) PRODUCTION: STORAGE DEEP SHALLOW

LOCATION: ELEVATION: As-Built 1,223.8' WATERSHED: Fishing Creek QUADRANGLE: Porter Falls
 DISTRICT: Green William L. & COUNTY: Wetzel
 SURFACE OWNER: Delores J. Gadd Christenson Family Trust; Harry I Elson; Howard M. Henderson; Suzann Marie Stoehr, et al; David A. Dickey; H. Dorn Higginbotham; Sally Lou Anderson; Jim R. McHenry; Susie T. Grimm; Kevin S. Goff, et ux; Chesapeake Appalachia, LLC (2);
 ROYALTY OWNER: Shiben Estates, Inc. (2); Gladys E. Conley Trust; Richard Lee Tennant, et ux; LEASE NO: ACREAGE: 60.5
 4.50;
 15.5; 61; 18.75; 12.2;
 4.75; 105; 76.675;
 45.72; 20; 18.5; 22.5;
 25.2875; 80;

PROPOSED WORK: DRILL CONVERT DRILL DEEPER FRACTURE OR STIMULATE PLUG OFF OLD FORMATION
 PERFORATE NEW FORMATION OTHER PHYSICAL CHANGE IN WELL (SPECIFY)
 PLUG AND ABANDON CLEAN OUT AND REPLUG TARGET FORMATION: Marcellus Shale ESTIMATED DEPTH: 7,500' TVD 21,500' MD

WELL OPERATOR: Antero Resources Corporation DESIGNATED AGENT: Dianna Stamper - CT Corporation System
 ADDRESS: 1615 Wynkoop Street ADDRESS: 5400 D Big Tyler Road
 Denver, CO 80202 Charleston, WV 25313