

Antero Resources
Well No. Peeler 3H
BHL MOD
 Antero Resources Corporation

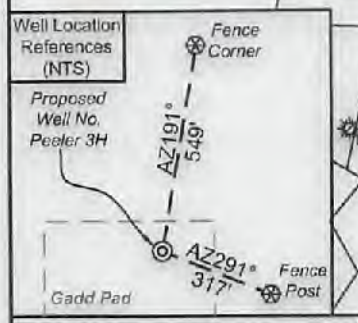

I, the undersigned, hereby certify that this plat is correct to the best of my knowledge and belief and shows all the information required by law and the rules issued and prescribed by the Department of Environmental Protection.

Kevin S. James

Kevin S. James, P.S. 2305

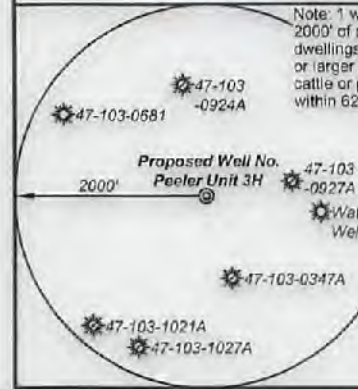

Legend

- ⊙ Proposed gas well
- ⊗ Monument, as noted
- ⊛ Existing Well, as noted
- ⊙ Digitized Well, as noted
- Creek or Drain
- Road
- Surface boundary (approx.)
- Interior surface tracts (approx.)
- Railroad

8,486' to Bottom Hole

1,514' to Top Hole

TOP HOLE LATITUDE 39 - 35 - 00

BTM HOLD LATITUDE 39 - 32 - 30

Notes

West Virginia Coordinate System of 1927, North Zone

based upon Differential GPS Measurements.

Well No. Peeler Unit 3H Top Hole coordinates are

N: 384,884.80' Latitude: 39°32'59.80"

E: 1,648,013.90' Longitude: 80°45'19.37"

Bottom Hole coordinates are

N: 374,527.40' Latitude: 39°31'18.07"

E: 1,650,653.43' Longitude: 80°44'18.32"

UTM Zone 17, NAD 1983

Top Hole Coordinates Bottom Hole Coordinates

N: 4,377,844.738m N: 4,374,712.905m

E: 521,032.352m E: 522,488.467m

Plat orientation and corner and well references are based upon the grid north meridian.

Well location references are based upon the magnetic meridian.

Notes:

Well No. Peeler Unit 3H

UTM Zone 17, NAD 1927

Top Hole Coordinates

N: 14,362,263.62'

E: 1,709,372.25'

Point of Entry Coordinates

N: 14,362,556.75'

E: 1,710,524.53'

Bottom Hole Coordinates

N: 14,351,988.55'

E: 1,714,182.39'

	Bearing	Dist.
L1	S 41°33' E	2,589.5'
L2	S 44°41' W	1,495.2'
L3	N 63°48' W	972.4'
L4	N 36°44' W	827.1'
L5	N 76°42' E	1,189.0'

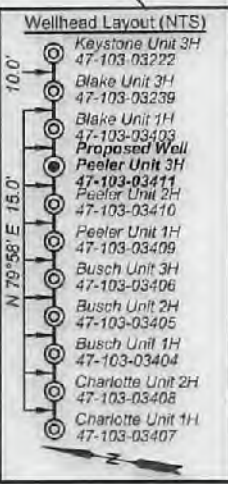

FILE NO: 326-34-G-17

DRAWING NO: Peeler 3H Well Plat

SCALE: 1" = 1500'

MINIMUM DEGREE OF ACCURACY: Submeter

PROVEN SOURCE OF ELEVATION: CORS, Monroe County, OH

STATE OF WEST VIRGINIA

DEPARTMENT OF ENVIRONMENTAL PROTECTION

OIL AND GAS DIVISION

DATE: July 15 20 21

OPERATOR'S WELL NO. Peeler Unit 3H

API WELL NO MOD

47 - 103 - 03411

STATE COUNTY PERMIT

WELL TYPE: OIL GAS LIQUID INJECTION WASTE DISPOSAL

(IF GAS) PRODUCTION: STORAGE DEEP SHALLOW

LOCATION: ELEVATION: As-Built 1,223.8' WATERSHED: Fishing Creek

DISTRICT: Green William L. & Acropolis Inc.; Deborah A. Beaver; Edwin D. Michael, et ux

SURFACE OWNER: Delores J. Gadd Relta Jane Hall; Clyde Robert Kennedy; David E. Bowyer; Shiben Estates, Inc.; BRC Appalachian Minerals I, LLC (S);

ROYALTY OWNER: Ellen W. & Mark L. VanDyne; Gordon Cummings; Nancy Tice; John W. Bertram; LEASE NO: ACREAGE: 66; 75.5; 50; 8;

PROPOSED WORK: DRILL CONVERT DRILL DEEPER FRACTURE OR STIMULATE PLUG OFF OLD FORMATION

PERFORATE NEW FORMATION OTHER PHYSICAL CHANGE IN WELL (SPECIFY) BHL MOD

PLUG AND ABANDON CLEAN OUT AND REPLUG TARGET FORMATION: Marcellus Shale ESTIMATED DEPTH: 7,500' TVD

20,900' MD

WELL OPERATOR: Antero Resources Corporation DESIGNATED AGENT: Dianna Stamper - CT Corporation System

ADDRESS: 1615 Wynkoop Street ADDRESS: 5400 D Big Tyler Road

Denver, CO 80202 Charleston, WV 25313

08/06/2021



ID	TMP/Par	Owner	Bk/Pg	Acres
1	16-22	William L. & Delores J. Gadd	348/169	60.50
2	16-30	William L. & Delores J. Gadd	348/169	14.00
3	16-31	William L. & Delores J. Gadd	348/169	2.65
4	16-10	Loren & Shirley Haught	444/434	100.48
5	16-23	Kenneth E. Butler	331/110	50.97
6	16-23.1	Wetzel County Public Service District 1	433/851	0.23
7	16-10.1	Harry Eastham	474/876	3.05
8	16-24	Antero Resources Corporation	474/713	20.60
9	16-25	Antero Resources Corporation	474/713	39.00
10	16-33	William M. Greenawalt & Lee A. Niezgoda	387/1	11.80
11	16-41	James C. Henthorne	367/673	46.00
12	16-47	William M. Greenawalt & Lee A. Niezgoda	387/1	12.00
13	16-48	George D. Cain	372/388	5.30
14	16-58	Mark & Michael Difiore	406/241	97.80
15	16-65	George D. Cain	372/388	30.80
16	16-71	Michael L. & Tina M. Adams	437/722	30.50
17	20-1	Paul E. & Janet K. Tracy	428/254	3.15
18	19-8.1	Edwin D. & Jane C. Michael	275/42	36.84
19	19-9	Paul E. & Janet K. Tracy	385/56	13.20
20	19-8.2	Edwin D. & Jane C. Michael	275/42	22.00
21	19-18.1	Edwin D. & Jane Michael	364/585	8.00
22	19-19	Paul E. & Janet K. Tracy	428/254	21.20
23	19-8.3	Edwin D. & Jane C. Michael	275/42	24.50
24	19-18	Ronald L. & Sharon Christenson Family Trust	439/377	30.00
25	19-20	Paul E. & Janet K. Tracy	428/254	11.4
26	19-28	Ronald L. & Sharon Christenson Family Trust	439/377	28.25
27	19-29	Gary B. Shanholtzer	408/530	11.80
28	20-11	Kathy L. Wright	WB75/551	10.75
29	20-16	Coastal Forest Resources Co.	444/105	75.50
30	19-48.1	Teresa & Michael L. Bassett	423/982	2.00
31	19-48	Teresa & Michael L. Bassett	423/982	51.00
32	19-49	Michael L. & Teresa Bassett	366/315	32.25
33	20-30	Sandra D. Derby	384/585	21.50
34	20-23	Michael L. & Teresa Bassett	386/315	33.30

Leases	
A	Shiben Estates, Inc.
B	Ellen W. & Mark L. VanDyne
C	John W. Bertram
D	Gordon Cummings
E	BRC Appalachian Minerals I, LLC
F	James K. Eastham
G	Nancy Tice
H	BRC Appalachian Minerals I, LLC
I	Reita Jane Hall
J	Acropolis, Inc.
K	Clyde Robert Kennedy
L	William R. Stainaker
M	BRC Appalachian Minerals I, LLC
N	BRC Appalachian Minerals I, LLC
O	David E. Bowyer
P	Sandra K. Sife
Q	Stone Hill Minerals Holdings, LLC
R	Edwin D. & Jane C. Michael
S	Edwin D. Michael, et ux
T	Acropolis Inc.
U	Thomas J. Iacoboni Revocable Trust Agreement
V	Faye Ann Skinner, et al
W	BRC Appalachian Minerals I, LLC
X	Deborah A. Beaver
Y	BRC Appalachian Minerals I, LLC
Z	Sandra D. Derby

FILE NO: 326-34-G-17
 DRAWING NO: Peeler 3H Well Plat
 SCALE: 1" = 1500'
 MINIMUM DEGREE OF ACCURACY:
 Submeter
 PROVEN SOURCE OF ELEVATION:
 CORS, Monroe County, OH

STATE OF WEST VIRGINIA
 DEPARTMENT OF ENVIRONMENTAL PROTECTION
OIL AND GAS DIVISION

DATE: July 15 2021
 OPERATOR'S WELL NO. Peeler Unit 3H
 API WELL NO MOD
 47 - 103 - 03411
 STATE COUNTY PERMIT

WELL TYPE: OIL GAS LIQUID INJECTION WASTE DISPOSAL
 (IF GAS) PRODUCTION: STORAGE DEEP SHALLOW

LOCATION: ELEVATION: As-Built 1,223.8' WATERSHED: Fishing Creek QUADRANGLE: Top Hole: Porter Falls
 BTM Hole: Pine Grove
 DISTRICT: Green William L. & Acropolis Inc.; Deborah A. Beaver; Edwin D. Michael, et ux COUNTY: We 08/06/2021
 SURFACE OWNER: Delores J. Gadd Reita Jane Hall; Clyde Robert Kennedy; David E. Bowyer; 2.65; 50.97; 36.5;
 Shiben Estates, Inc.; BRC Appalachian Minerals I, LLC (3); ACREAGE: 14 51.25; 52.9; 30.5; 40;
 ROYALTY OWNER: Ellen W. & Mark L. VanDyne; Gordon Cummings; Nancy Tice; John W. Bertram; LEASE NO: ACREAGE: 66; 75.5; 50; 8;
 PROPOSED WORK: DRILL CONVERT DRILL DEEPER FRACTURE OR STIMULATE PLUG OFF OLD FORMATION
 PERFORATE NEW FORMATION OTHER PHYSICAL CHANGE IN WELL (SPECIFY) BHL MOD 7,500' TVD
 PLUG AND ABANDON CLEAN OUT AND REPLUG TARGET FORMATION: Marcellus Shale ESTIMATED DEPTH: 20,900' MD

WELL OPERATOR: Antero Resources Corporation DESIGNATED AGENT: Dianna Stamper - CT Corporation System
 ADDRESS: 1615 Wynkoop Street ADDRESS: 5400 D Big Tyler Road
 Denver, CO 80202 Charleston, WV 25313

8,486' to Bottom Hole

1,514' to Top Hole

TOP HOLE LATITUDE 39 - 35 - 00
BTM HOLE LATITUDE 39 - 32 - 30

TOP HOLE LONGITUDE 80 - 45 - 00
BTM HOLE LONGITUDE 80 - 42 - 30

12,162' to Top Hole

7,279' to Bottom Hole

Antero Resources
Well No. Peeler 3H
BHL MOD
Antero Resources Corporation



Notes
West Virginia Coordinate System of 1927, North Zone
based upon Differential GPS Measurements.
Well No. Peeler Unit 3H Top Hole coordinates are
N: 384,884.80' Latitude: 39°32'59.80"
E: 1,646,013.90' Longitude: 80°45'19.37"
Bottom Hole coordinates are
N: 374,527.40' Latitude: 39°31'18.07"
E: 1,650,653.43' Longitude: 80°44'18.32"
UTM Zone 17, NAD 1983
Top Hole Coordinates: Bottom Hole Coordinates
N: 4,377,844.738m N: 4,374,712.905m
E: 521,032.352m E: 522,498.467m
Plat orientation and corner and well references are based upon the grid north meridian.
Well location references are based upon the magnetic meridian

Notes:
Well No. Peeler Unit 3H
UTM Zone 17, NAD 1927
Top Hole Coordinates
N: 14,362,263.62'
E: 1,709,372.25'
Point of Entry Coordinates
N: 14,362,556.75'
E: 1,710,524.53'
Bottom Hole Coordinates
N: 14,351,988.55'
E: 1,714,182.39'

	Bearing	Dist.
L1	S 41°33' E	2,589.5'
L2	S 44°41' W	1,495.2'
L3	N 63°48' W	972.4'
L4	N 36°44' W	827.1'
L5	N 76°42' E	1,189.0'

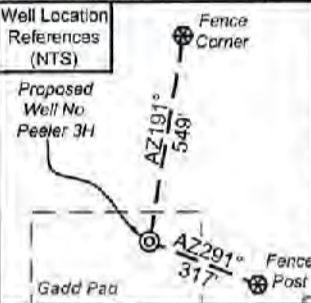

I, the undersigned, hereby certify that this plat is correct to the best of my knowledge and belief and shows all the information required by law and the rules issued and prescribed by the Department of Environmental Protection

Kevin S. James

Kevin S. James, P.S. 2305



Note: 1 water well was found within 2000' of proposed well. No occupied dwellings or buildings 2,500 square feet or larger used to house or shelter dairy cattle or poultry husbandry are located within 625' of the center of the well pad.

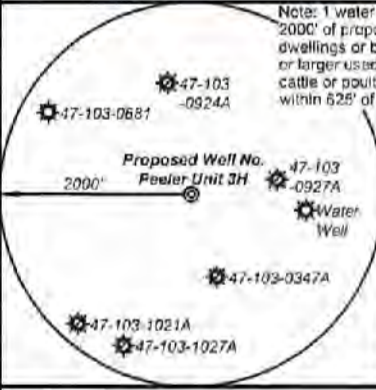

Legend

- Proposed gas well
- Monument, as noted
- Existing Well, as noted
- Digitized Well, as noted
- Creek or Drain
- Road
- Surface boundary (approx.)
- Interior surface tracts (approx.)
- Railroad

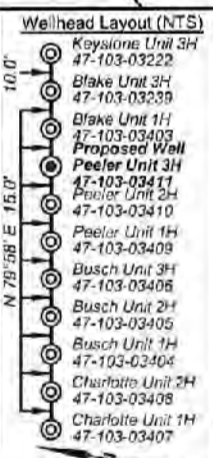

FILE NO: 326-34-G-17
DRAWING NO: Peeler 3H Well Plat
SCALE: 1" = 1500'
MINIMUM DEGREE OF ACCURACY: Submeter
PROVEN SOURCE OF ELEVATION: CORS, Monroe County, OH

STATE OF WEST VIRGINIA
DEPARTMENT OF ENVIRONMENTAL PROTECTION
OIL AND GAS DIVISION

DATE: July 15 2021
OPERATOR'S WELL NO. Peeler Unit 3H
API WELL NO MOD
47 - 103 - 03411
STATE COUNTY PERMIT

WELL TYPE: OIL GAS LIQUID INJECTION WASTE DISPOSAL
(IF GAS) PRODUCTION: STORAGE DEEP SHALLOW

LOCATION: ELEVATION: As-Built 1,223.6' WATERSHED: Fishing Creek QUADRANGLE: BTM Hole; Pine Grove
DISTRICT: Green William L. & Acropolis Inc.; Deborah A. Beaver; Edwin D. Michael, et ux
SURFACE OWNER: Delores J. Gadd Reita Jane Hall; Clyde Robert Kennedy; David E. Bowyer; Shiban Estates, Inc.; BRC Appalachian Minerals I, LLC (3);
ROYALTY OWNER: Ellen W. & Mark L. VanDyne; Gordon Cummings; Nancy Tice; John W. Bertram; LEASE NO: ACREAGE: 14 51.25; 52.9; 30.5; 40; 66; 75.5; 50; 8;
PROPOSED WORK: DRILL CONVERT DRILL DEEPER FRACTURE OR STIMULATE PLUG OFF OLD FORMATION
 PERFORATE NEW FORMATION OTHER PHYSICAL CHANGE IN WELL (SPECIFY) BHL MOD
 PLUG AND ABANDON CLEAN OUT AND REPLUG TARGET FORMATION: Marcellus Shale ESTIMATED DEPTH: 7,500' TVD 20,900' MD

WELL OPERATOR: Antero Resources Corporation DESIGNATED AGENT: Dianna Stamper - CT Corporation System
ADDRESS: 1615 Wynkoop Street ADDRESS: 5400 D Big Tyler Road
Denver, CO 80202 Charleston, WV 25313



ID	TM/Par	Owner	Bk/Pg	Acres
1	16-22	William L. & Delores J. Gadd	348/169	60.50
2	16-30	William L. & Delores J. Gadd	348/169	14.00
3	16-31	William L. & Delores J. Gadd	348/169	2.65
4	16-10	Loren & Shirley Haught	444/434	100.48
5	16-23	Kenneth E. Butler	331/110	50.97
6	16-23.1	Wetzel County Public Service District 1	433/851	0.23
7	16-10.1	Harry Eastham	474/676	3.05
8	16-24	Antero Resources Corporation	474/713	20.60
9	16-25	Antero Resources Corporation	474/713	39.00
10	16-33	William M. Greenawalt & Lee A. Niezgoda	387/1	11.80
11	16-41	James C. Henthorne	367/673	46.00
12	16-47	William M. Greenawalt & Lee A. Niezgoda	387/1	12.00
13	16-48	George D. Cain	372/388	5.30
14	16-58	Mark & Michael Difiore	406/241	97.80
15	16-65	George D. Cain	372/388	30.80
16	16-71	Michael L. & Tina M. Adams	437/722	30.50
17	20-1	Paul E. & Janet K. Tracy	428/254	3.15
18	19-8.1	Edwin D. & Jane C. Michael	275/42	36.84
19	19-9	Paul E. & Janet K. Tracy	385/56	13.20
20	19-8.2	Edwin D. & Jane C. Michael	275/42	22.00
21	19-10.1	Edwin D. & Jane Michael	364/565	8.00
22	19-19	Paul E. & Janet K. Tracy	428/254	21.20
23	19-8.3	Edwin D. & Jane C. Michael	275/42	24.50
24	19-18	Ronald L. & Sharon Christenson Family Trust	439/377	30.00
25	19-20	Paul E. & Janet K. Tracy	428/254	11.4
26	19-28	Ronald L. & Sharon Christenson Family Trust	439/377	28.25
27	19-29	Gary B. Shanholtzer	408/530	11.80
28	20-11	Kathy L. Wright	WB75/551	10.75
29	20-16	Coastal Forest Resources Co.	444/105	75.50
30	19-48.1	Teresa & Michael L. Bassett	423/982	2.00
31	19-48	Teresa & Michael L. Bassett	423/982	51.00
32	19-49	Michael L. & Teresa Bassett	386/315	32.25
33	20-30	Sandra D. Derby	384/585	21.50
34	20-23	Michael L. & Teresa Bassett	386/315	33.30

Leases	
A	Shiben Estates, Inc.
B	Ellen W. & Mark L. VanDyne
C	John W. Bertram
D	Gordon Cummings
E	BRC Appalachian Minerals I, LLC
F	James K. Eastham
G	Nancy Tice
H	BRC Appalachian Minerals I, LLC
I	Reita Jane Hall
J	Acropolis, Inc.
K	Clyde Robert Kennedy
L	William R. Stalnaker
M	BRC Appalachian Minerals I, LLC
N	BRC Appalachian Minerals I, LLC
O	David E. Bowyer
P	Sandra K. Sife
Q	Stone Hill Minerals Holdings, LLC
R	Edwin D. & Jane C. Michael
S	Edwin D. Michael, et ux
T	Acropolis Inc.
U	Thomas J. Iacoboni Revocable Trust Agreement
V	Faye Ann Skinner, et al
W	BRC Appalachian Minerals I, LLC
X	Deborah A. Beaver
Y	BRC Appalachian Minerals I, LLC
Z	Sandra D. Derby

RECEIVED
 Office of Oil and Gas
 JUL 21 2021
 WV Department of Environmental Protection
 RECEIVED
 Office of Oil and Gas
 JUL 21 2021



FILE NO: 326-34-G-17
 DRAWING NO: Peeler 3H Well Plat
 SCALE: 1" = 1500'
 MINIMUM DEGREE OF ACCURACY:
 Submeter
 PROVEN SOURCE OF ELEVATION:
 CORS, Monroe County, OH

DATE: July 15 2021
 OPERATOR'S WELL NO. Peeler Unit 3H
 API WELL NO MOD
 47 - 103 - 03411
 STATE COUNTY PERMIT

WELL TYPE: OIL GAS LIQUID INJECTION WASTE DISPOSAL
 (IF GAS) PRODUCTION: STORAGE DEEP SHALLOW
 LOCATION: ELEVATION: As-Built 1,223.8' WATERSHED: Fishing Creek QUADRANGLE: Top Hole: Porter Falls
 Bottom Hole: Pine Grove
 DISTRICT: Green William L. & Acropolis Inc.; Deborah A. Beaver; Edwin D. Michael, et ux COUNTY: West Virginia
 SURFACE OWNER: Delores J. Gadd Reita Jane Hall; Clyde Robert Kennedy; David E. Bowyer; ACREAGE: 14 2.65; 50.97; 36.5;
 Shiben Estates, Inc.; BRC Appalachian Minerals I, LLC (3); 51.25; 52.9; 30.5; 40;
 ROYALTY OWNER: Ellen W. & Mark L. VanDyne; Gordon Cummings; Nancy Tice; John W. Bertram; LEASE NO: ACREAGE: 66; 75.5; 50; 8;
 PROPOSED WORK: DRILL CONVERT DRILL DEEPER FRACTURE OR STIMULATE PLUG OFF OLD FORMATION
 PERFORATE NEW FORMATION OTHER PHYSICAL CHANGE IN WELL (SPECIFY) BHL MOD 7,500' TVD
 PLUG AND ABANDON CLEAN OUT AND REPLUG TARGET FORMATION: Marcellus Shale ESTIMATED DEPTH: 20,900' MD

WELL OPERATOR: Antero Resources Corporation DESIGNATED AGENT: Dianna Stamper - CT Corporation System
 ADDRESS: 1615 Wynkoop Street ADDRESS: 5400 D Big Tyler Road
 Denver, CO 80202 Charleston, WV 25313