

- Proposed Gas Well
- Located Corner, as noted
- Surface Tract Lines
- - - Reference Line
- Lease Boundary
- Creek or Drain
- Ⓢ WV County Route
- Ⓜ WV State Route

(⊙) Denotes Location of Well on United States Topographic Maps



I, the undersigned, hereby certify that this plat is correct to the best of my knowledge and belief and shows all the information required by law and the regulations issued and prescribed by the Department of Environmental Protection.

Ben R. Singleton

P.S. 2092

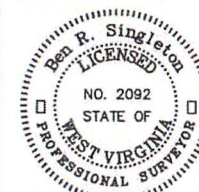

SEAL

FILE NO: 246-18
 DRAWING NO: BIG245 106H
 SCALE: 1" = 2000'
 MINIMUM DEGREE OF ACCURACY: 1:2500
 PROVEN SOURCE OF ELEVATION: NGS CORS Station

STATE OF WEST VIRGINIA
 DEPARTMENT OF ENVIRONMENTAL PROTECTION
 OIL AND GAS DIVISION

DATE: June 29 20 22
 OPERATOR'S WELL NO.: BIG245 106H
 API WELL NO
 47 - 103 - 03442
 STATE COUNTY PERMIT

WELL TYPE: OIL GAS LIQUID INJECTION WASTE DISPOSAL
 (IF GAS) PRODUCTION: STORAGE DEEP SHALLOW
 LOCATION: ELEVATION: 1430' WATERSHED Rockcamp Run of Willey Fork QUADRANGLE: Big Run
 DISTRICT: Grant COUNTY: Wetzel
 SURFACE OWNER: ET Blue Grass LLC ACREAGE: 138.93
 ROYALTY OWNER: Shiben Estates, Inc., et al. LEASE NO: 125397 ACREAGE: 140
 PROPOSED WORK: DRILL CONVERT DRILL DEEPER FRACTURE OR STIMULATE PLUG OFF OLD FORMATION
 PERFORATE NEW FORMATION OTHER PHYSICAL CHANGE IN WELL (SPECIFY)
 PLUG AND ABANDON CLEAN OUT AND REPLUG TARGET FORMATION: Marcellus ESTIMATED DEPTH: 7,548'

WELL OPERATOR: EQT Production Company DESIGNATED AGENT: Joseph C. Mallow
 ADDRESS: 400 Woodcliff Drive ADDRESS: 115 Professional Place PO Box 280
 Canonsburg, PA 15317 Bridgeport, WV 26330

02/16/2024

RECEIVED
 State of Oil and Gas
 JAN 22 2024
 WV Department of
 Environmental Protection

BIG245 106H
BIG245
EQT Production Company

Tract I.D.	Tax Map No.	Parcel No.	County	District	Surface Tract Owner	Acres
1	8	22	Wetzel	Grant	ET Blue Grass LLC	138.93
2	8	21	Wetzel	Grant	Ikey Joe Willey	78.27
3	8	24	Wetzel	Grant	H. Dorn Higginbotham	7.10
4	8	39	Wetzel	Grant	H. Dorn Higginbotham	23.62
5	8	83	Wetzel	Grant	H. Dorn Higginbotham	138.21
6	13	17	Wetzel	Grant	Mary Higginbotham	112.00
7	13	9	Wetzel	Grant	Mary Higginbotham	30.10
8	8	14	Wetzel	Grant	Uli Neal	51.06
9	8	13.1	Wetzel	Grant	Duane M. Goodrich	3.56
10	8	7	Wetzel	Grant	James E. & Martin A. Stonking	18.12
11	8	8	Wetzel	Grant	Wanda L. Byard	59.18
12	8	15	Wetzel	Grant	John Michael Byard	71.80
13	8	22	Wetzel	Grant	James A. Yoho	17.80
14	8	29	Wetzel	Grant	Mary Jane Byard	16.00
15	8	28	Wetzel	Grant	James A. Yoho	81.00
16	8	25	Wetzel	Grant	James A. Yoho	6.25
17	8	28	Wetzel	Grant	James A. Yoho	23.25
18	8	31	Wetzel	Grant	James A. Yoho	3.00
19	8	30	Wetzel	Grant	James A. Yoho	7.80
20	8	11	Wetzel	Grant	Bonnie M. Hawthorne	63.50
21	8	23	Wetzel	Grant	Dale K. Dulaney, et al.	70.81
22	8	36	Wetzel	Grant	Dale K. & Sherry L. Dulaney	28.82
23	8	27	Wetzel	Grant	James A. Yoho	21.75
24	8	82	Wetzel	Grant	Henry E. Willey	0.28
25	8	61	Wetzel	Grant	Henry E. Willey	2.34
26	8	66	Wetzel	Grant	Marsel L. McDuffie, et al.	9.25
27	13	7	Wetzel	Grant	Marsel L. McDuffie, et al.	51.80
28	13	8	Wetzel	Grant	Robert Cole	36.00
29	8	40	Wetzel	Grant	James A. Yoho	0.50
30	8	41	Wetzel	Grant	H. Dorn Higginbotham	0.45
31	8	32	Wetzel	Grant	Joe Pigg	62.40
32	8	28	Wetzel	Grant	Sheryl Snider	55.52
33	8	64	Wetzel	Grant	Sheryl Snider	20.00
34	14	7	Wetzel	Grant	Norman Darby	83.00
35	13	27.1	Wetzel	Grant	Jeremy Collins	148.70
36	8	12	Wetzel	Grant	Shirley A. Tius	41.90

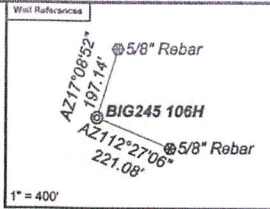

As Drilled Well Information:
BIG245 106H coordinates are
NAD 27 N: 400,723.70 E: 1,898,765.26
NAD 83 UTM N: 4,382,939.03 E: 537,029.52
BIG245 106H Kick Out Point coordinates are
NAD 27 N: 400,727.46 E: 1,898,785.08
NAD 83 UTM N: 4,382,940.17 E: 537,029.44
BIG245 106H Landing Point coordinates are
NAD 27 N: 399,756.53 E: 1,898,006.69
NAD 83 UTM N: 4,382,640.41 E: 536,797.83
BIG245 106H Bottom Hole coordinates are
NAD 27 N: 393,629.68 E: 1,701,674.89
NAD 83 UTM N: 4,380,792.47 E: 537,945.88
West Virginia Coordinate system of 1927 (North Zone)
based upon Differential GPS Measurements.
Plat orientation, corner and well ties are based upon
the grid north meridian.
Well location references are based upon the grid north
meridian.
UTM coordinates are NAD83, Zone 17, Meters.

- BIG245
- ⊙ BIG245 114H
 - ⊙ BIG245 112H
 - ⊙ BIG245 110H
 - ⊙ BIG245 108H
 - ⊙ BIG245 106H
 - ⊙ BIG245 104H
 - ⊙ BIG245 102H
 - ⊙ 47-103-03235
 - ⊙ 47-103-03236
- 47-103-03234 ⊙

Lease No.	Owner	Acres
102836	Shiben Estates, Inc., et al.	192
994581	Carolyn J. Ferguson, et al.	6.25
125386	Thomas Scott Lovett, III, et al.	27
125374	Jordan Zachary Pigg, et al.	100
125421	H. Dorn Higginbotham and Lavena Jane Higginbotham	73
125445	PA Mineral Group II, LLC, et al.	121

RECEIVED
Office of Oil and Gas
JAN 22 2024
WV Department of
Environmental Protection

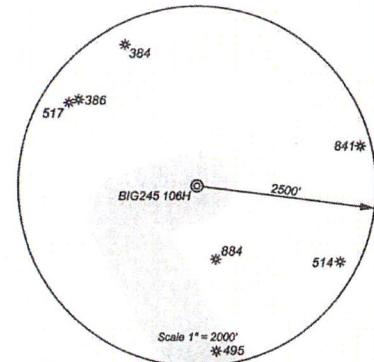

I, the undersigned, hereby certify that this plat is correct to the best of my knowledge and belief and shows all the information required by law and the regulations issued and prescribed by the Department of Environmental Protection.

Ben R. Singleton
P.S. 2092

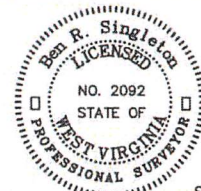

SEAL

FILE NO: 246-18
DRAWING NO: BIG245 106H
SCALE: 1" = 2000'
MINIMUM DEGREE OF ACCURACY: 1:2500
PROVEN SOURCE OF ELEVATION: NGS CORS Station



DATE: June 29 20 22
OPERATOR'S WELL NO.: BIG245 106H
API WELL NO
47 - 103 - 03442
STATE COUNTY PERMIT

WELL TYPE: OIL GAS LIQUID INJECTION WASTE DISPOSAL
(IF GAS) PRODUCTION: STORAGE DEEP SHALLOW
LOCATION: ELEVATION: 1430' WATERSHED: Rockcamp Run of Willey Fork QUADRANGLE: Big Run
DISTRICT: Grant COUNTY: Wetzel
SURFACE OWNER: ET Blue Grass LLC ACREAGE: 138.93
ROYALTY OWNER: Shiben Estates, Inc., et al. LEASE NO: 125397 ACREAGE: 140
PROPOSED WORK: DRILL CONVERT DRILL DEEPER FRACTURE OR STIMULATE PLUG OFF OLD FORMATION
 PERFORATE NEW FORMATION OTHER PHYSICAL CHANGE IN WELL (SPECIFY)
 PLUG AND ABANDON CLEAN OUT AND REPLUG TARGET FORMATION: Marcellus ESTIMATED DEPTH: 7,548'
WELL OPERATOR: EQT Production Company DESIGNATED AGENT: Joseph C. Mallow
ADDRESS: 400 Woodcliff Drive ADDRESS: 115 Professional Place PO Box 280
Canonsburg, PA 15317 Bridgeport, WV 26330

02/16/2024