

RECEIVED
Office of Oil and Gas
JAN 22 2024
WV Department of Environmental Protection

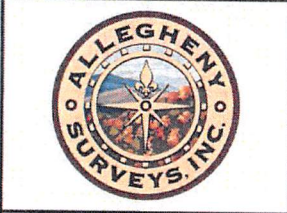

I, the undersigned, hereby certify that this plat is correct to the best of my knowledge and belief and shows all the information required by law and the regulations issued and prescribed by the Department of Environmental Protection.

Ben R. Singleton
P.S. 2092

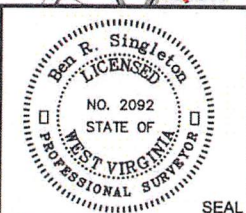

FILE NO: 246-18
DRAWING NO: BIG245 108H
SCALE: 1" = 2000'
MINIMUM DEGREE OF ACCURACY: 1:2500
PROVEN SOURCE OF ELEVATION: NGS CORS Station

STATE OF WEST VIRGINIA
DEPARTMENT OF ENVIRONMENTAL PROTECTION
OIL AND GAS DIVISION

DATE: August 05 20 21
OPERATOR'S WELL NO.: BIG245 108H
API WELL NO
47 - 103 - 03343
STATE COUNTY PERMIT

WELL TYPE: OIL GAS LIQUID INJECTION WASTE DISPOSAL
(IF GAS) PRODUCTION: STORAGE DEEP SHALLOW
LOCATION: ELEVATION: 1430' WATERSHED Rockcamp Run of Willey Fork QUADRANGLE: Big Run
DISTRICT: Grant COUNTY: Wetzel
SURFACE OWNER: ET Blue Grass LLC ACREAGE: 138.93
ROYALTY OWNER: Shiben Estates, Inc., et al. LEASE NO: 125397 ACREAGE: 140
PROPOSED WORK: DRILL CONVERT DRILL DEEPER FRACTURE OR STIMULATE PLUG OFF OLD FORMATION
 PERFORATE NEW FORMATION OTHER PHYSICAL CHANGE IN WELL (SPECIFY)
 PLUG AND ABANDON CLEAN OUT AND REPLUG TARGET FORMATION: Marcellus ESTIMATED DEPTH: 7.549'

WELL OPERATOR: EQT Production Company DESIGNATED AGENT: Joseph C. Mallow
ADDRESS: 400 Woodcliff Drive ADDRESS: 427 Midstate Drive
Canonsburg, PA 15317 Clarksburg, WV 26301

02/16/2024

BH: 9853' LAT: 39-35-00

RECEIVED
Office of Oil and Gas
JAN 22 2024
WV Department of Environmental Protection

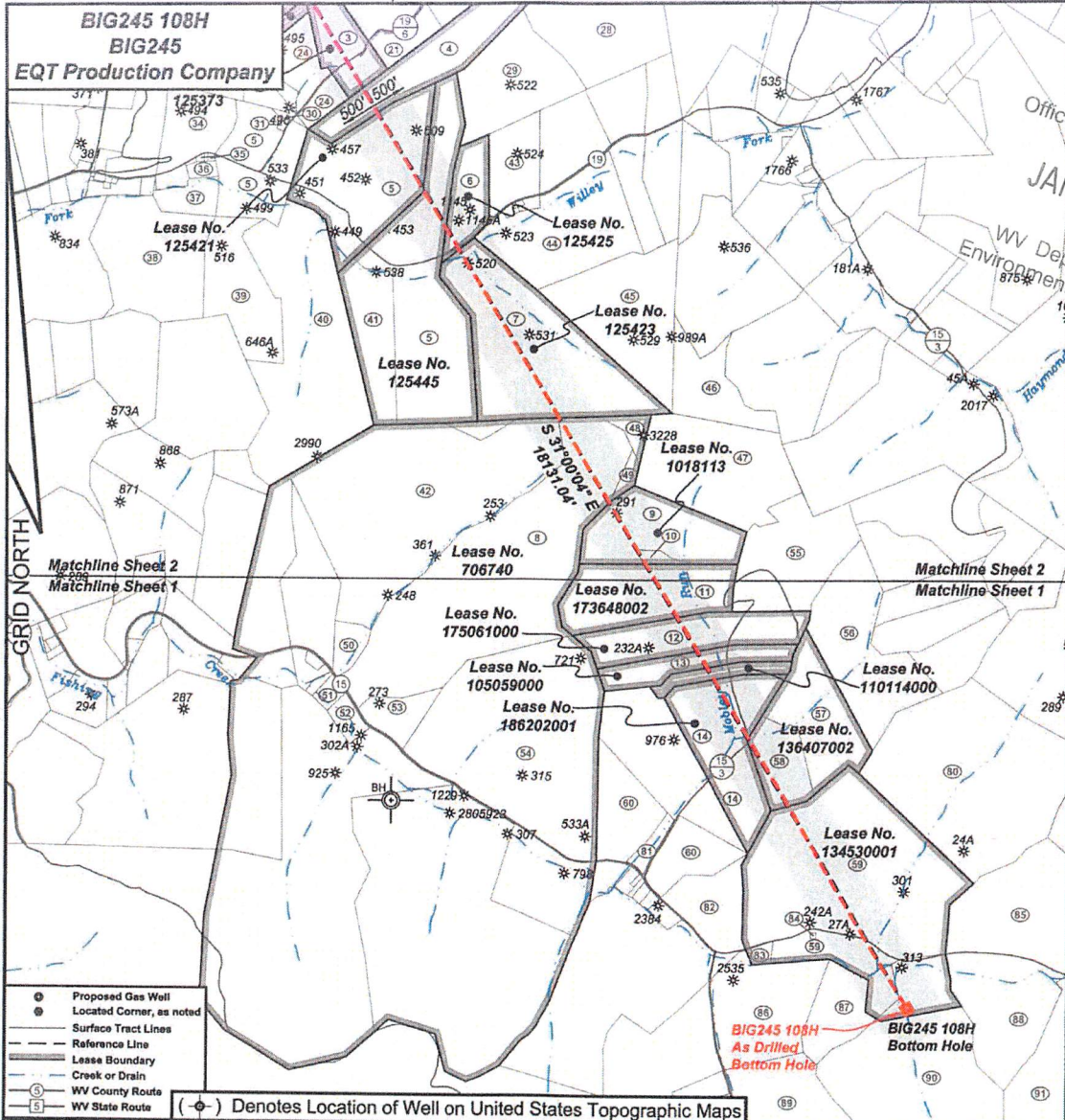

BH: 11486' LONG: 80-30-00

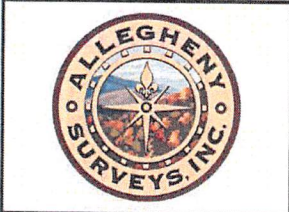

I, the undersigned, hereby certify that this plat is correct to the best of my knowledge and belief and shows all the information required by law and the regulations issued and prescribed by the Department of Environmental Protection.

Ben R. Singleton
P.S. 2092

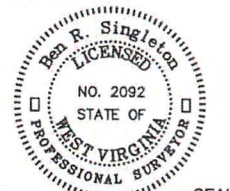

SEAL

FILE NO: 246-18
DRAWING NO: BIG245 108H
SCALE: 1" = 2000'
MINIMUM DEGREE OF ACCURACY: 1:2500
PROVEN SOURCE OF ELEVATION: NGS CORS Station



DATE: August 05 20 21
OPERATOR'S WELL NO.: BIG245 108H
API WELL NO
47 - 103 - 03343
STATE COUNTY PERMIT

WELL TYPE: OIL GAS LIQUID INJECTION WASTE DISPOSAL
(IF GAS) PRODUCTION: STORAGE DEEP SHALLOW
LOCATION: ELEVATION: 1430' WATERSHED Rockcamp Run of Willey Fork QUADRANGLE: Big Run
DISTRICT: Grant COUNTY: Wetzel
SURFACE OWNER: ET Blue Grass LLC ACREAGE: 138.93
ROYALTY OWNER: Shiben Estates, Inc., et al. LEASE NO: 125397 ACREAGE: 140
PROPOSED WORK: DRILL CONVERT DRILL DEEPER FRACTURE OR STIMULATE PLUG OFF OLD FORMATION
 PERFORATE NEW FORMATION OTHER PHYSICAL CHANGE IN WELL (SPECIFY)
 PLUG AND ABANDON CLEAN OUT AND REPLUG TARGET FORMATION: Marcellus ESTIMATED DEPTH: 7,549'

WELL OPERATOR: EQT Production Company DESIGNATED AGENT: Joseph C. Mallow
ADDRESS: 400 Woodcliff Drive ADDRESS: 427 Midstate Drive
Canonsburg, PA 15317 Clarksburg, WV 26301

02/16/2024

Tract I.D.	Tax Map No.	Parcel No.	County	District	Surface Tract Owner	Acres
1	8	22	Wetzel	Grant	ET Blue Grass LLC	138.83
2	8	25	Wetzel	Grant	James A. Yoho	8.25
3	8	27	Wetzel	Grant	James A. Yoho	21.75
4	8	32	Wetzel	Grant	Joe Pigg	82.40
5	8	53	Wetzel	Grant	H. Dom Higginbotham	196.21
6	8	54	Wetzel	Grant	Sherlyn Snider	20.00
7	14	7	Wetzel	Grant	Norman Derby	85.00
8	13	45	Wetzel	Grant	Coastal Forest Resources Company	158.18
9	14	22	Wetzel	Grant	John W. Wycoff & Carolyn S. McGill	48.00
10	14	21	Wetzel	Grant	John W. Wycoff & Carolyn S. McGill	2.50
11	14	28	Wetzel	Grant	EQT Production Company	80.50
12	14	37	Wetzel	Grant	EQT Production Company	38.50
13	14	37	Wetzel	Grant	EQT Production Company	37.90
14	14	36	Wetzel	Grant	EQT Production Company	100.00
15	8	13.1	Wetzel	Grant	Duane M. Goodrich	3.58
16	8	7	Wetzel	Grant	James E. & Martin A. Stonking	19.12
17	8	8	Wetzel	Grant	Wanda L. Byard	58.18
18	8	15	Wetzel	Grant	John Michael Byard	71.90
19	9	22	Wetzel	Grant	James A. Yoho	17.00
20	8	28	Wetzel	Grant	Mary Jane Byard	15.00
21	8	28	Wetzel	Grant	James A. Yoho	61.00
22	8	29	Wetzel	Grant	Dale K. Duley, et al.	70.81
23	8	11	Wetzel	Grant	Bonnie N. Hawthorne	63.50
24	8	25	Wetzel	Grant	James A. Yoho	23.28
25	9	13	Wetzel	Grant	James A. Yoho	27.00
26	9	17	Wetzel	Grant	Lesale Wetton	30.08
27	9	23	Wetzel	Grant	Stephen B. & Carolyn M. Gantz	118.00
28	9	26	Wetzel	Grant	William & Margaret Schneider	47.90
29	9	28	Wetzel	Grant	Sherlyn Snider	55.52
30	8	40	Wetzel	Grant	James A. Yoho	0.50
31	8	41	Wetzel	Grant	H. Dom Higginbotham	0.45
32	8	30	Wetzel	Grant	James A. Yoho	7.50
33	8	24	Wetzel	Grant	H. Dom Higginbotham	7.10
34	8	39	Wetzel	Grant	H. Dom Higginbotham	23.62
35	8	52	Wetzel	Grant	Henry E. Wiley	0.28
36	8	51	Wetzel	Grant	Henry E. Wiley	2.34
37	8	55	Wetzel	Grant	Marcel L. McDowell, et al.	8.28
38	13	7	Wetzel	Grant	Marcel L. McDowell, et al.	51.02
39	13	8	Wetzel	Grant	Robert Cox	36.00
40	13	17	Wetzel	Grant	Mary Higginbotham	112.00
41	13	9	Wetzel	Grant	Mary Higginbotham	30.10
42	13	27.1	Wetzel	Grant	Jeremy Coble	148.70
43	9	40.1	Wetzel	Grant	Donald J. Dulaney	22.00
44	9	52	Wetzel	Grant	Norman Derby	61.51
45	14	8	Wetzel	Grant	Ethel R. Coen	88.50
46	14	10	Wetzel	Grant	John W. Wycoff & Carolyn S. McGill	29.00
47	14	18	Wetzel	Grant	John W. Wycoff & Carolyn S. McGill	66.70
48	14	17	Wetzel	Grant	John W. Wycoff & Carolyn S. McGill	8.20
49	14	16	Wetzel	Grant	John W. Wycoff & Carolyn S. McGill	1.60
50	13	27	Wetzel	Grant	Teresa D. Gump Life Estate	8.07
51	13	50	Wetzel	Grant	Gary D. & Julia A. Wetton	2.37
52	13	45.1	Wetzel	Grant	Gary D. & Julia A. Wetton	5.00
53	13	51	Wetzel	Grant	James & Debra Lippincott	11.70
54	15	12.1	Wetzel	Grant	Liberty Midstream & Resources LLC	200.00
55	14	23	Wetzel	Grant	Equithem LP	91.00
56	14	38	Wetzel	Grant	Dale C. Eastham, et al.	67.00
57	14	39.3	Wetzel	Grant	Dale C. Eastham, et al.	38.05
58	14	39	Wetzel	Grant	Mountain Valley Pipeline LLC	17.81
59	19	7	Wetzel	Grant	Florence E. Kiboye	157.09
60	19	5	Wetzel	Grant	Roger K. & Shirley K. Hinerman	45.17
61	19	4	Wetzel	Grant	Donald J. Dulaney, Jr.	131.00
62	19	6	Wetzel	Grant	Equitable Gas Company	9.20
63	19	6.1	Wetzel	Grant	Marshall Liberty Midstream & Resources LLC	21.50
64	19	7.1	Wetzel	Grant	Mobility Community Educational Outreach Service	45.17
65	19	7.1	Wetzel	Grant	S. J. Kiboye Cemetery	0.23
66	19	8	Wetzel	Grant	Donald J. Dulaney, Jr.	71.50
67	19	17	Wetzel	Grant	Edward L. Tibbs	45.50
68	19	15	Wetzel	Grant	Florence E. Kiboye	8.87
69	19	8.1	Wetzel	Grant	EQT Production Company	53.00
70	19	26	Wetzel	Grant	Timothy S. & Shannon L. Branner	135.48
71	19	27	Wetzel	Grant	Florence Kiboye	201.00

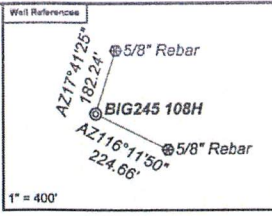

As Drilled Well Information:
 BIG245 108H coordinates are
 NAD 27 N: 400,738.44 E: 1,698,788.01
 NAD 83 UTM N: 4,382,943.53 E: 537,030.28
 BIG245 108H Kick Out Point coordinates are
 NAD 27 N: 400,744.15 E: 1,698,781.02
 NAD 83 UTM N: 4,382,945.24 E: 537,028.12
 BIG245 108H Landing Point coordinates are
 NAD 27 N: 400,155.41 E: 1,698,943.52
 NAD 83 UTM N: 4,382,786.70 E: 537,080.62
 BIG245 108H Bottom Hole coordinates are
 NAD 27 N: 384,770.93 E: 1,708,178.30
 NAD 83 UTM N: 4,378,126.66 E: 539,972.18
 West Virginia Coordinate system of 1927 (North Zone)
 based upon Differential GPS Measurements.
 Plat orientation, corner and well ties are based upon
 the grid north meridian.
 Well location references are based upon the grid north
 meridian.
 UTM coordinates are NAD83, Zone 17, Meters.

- BIG245
- ◎ BIG245 114H
 - ◎ BIG245 112H
 - ◎ BIG245 110H
 - ◎ BIG245 108H
 - ◎ BIG245 106H
 - ◎ BIG245 104H
 - ◎ BIG245 102H
 - ◎ 47-103-03235
 - ◎ 47-103-03236
- 47-103-03234◎

Lessee No.	Owner	Acres
994581	Kenneth R. Mason and Jennifer L. Mason, et al.	6.25
125373	Jim Yoho, et al.	22
125374	Jordan Zachary Pigg, et al.	100
125421	H. Dom Higginbotham and Lavena Jane Higginbotham	73
125445	Ory USA Inc., et al.	121
125425	Sherlyn Louise Snider, et al.	20
125423	AMP Fund III, LP, et al.	85
706740	EQT Production Company	1003.75
1018113	Tamara L. Donohue f/k/a Tamara Lynn Hixbaugh, et al.	50.50
173648002	The William B. and Pamela S. Franck Joint Revocable Living Trust dated 2/12/2018, et al.	40 of 31,151.881
175061000	New Opic, Inc., et al.	26.50
105059000	Jamie Joe Prine	10
110114000	Lloyd Joe Prine	64
186202001	Ridgeloop Appalachia, LLC, et al.	57
136407002	Ridgeloop Royalties, LLC, et al.	180
134530001	John W. Kiboye Jr., et al.	

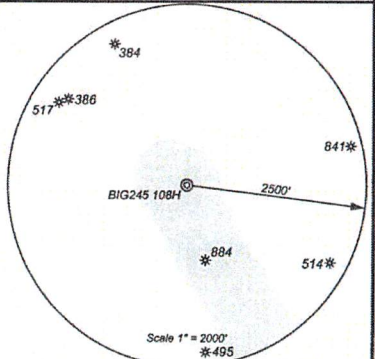

RECEIVED
 Office of Oil and Gas
 JAN 22 2024
 WV Department of
 Environmental Protection



I, the undersigned, hereby certify that this plat is correct to the best of my knowledge and belief and shows all the information required by law and the regulations issued and prescribed by the Department of Environmental Protection.

Ben R. Singleton
 P.S. 2092

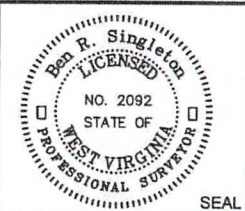

FILE NO: 246-18
 DRAWING NO: BIG245 108H
 SCALE: 1" = 2000'
 MINIMUM DEGREE OF ACCURACY: 1:2500
 PROVEN SOURCE OF ELEVATION: NGS CORS Station

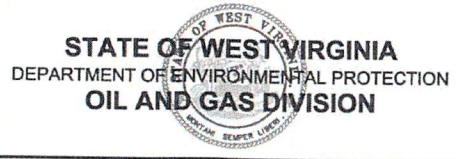

DATE: August 05 20 22
 OPERATOR'S WELL NO.: BIG245 108H
 API WELL NO
 47 - 103 - 03343
 STATE COUNTY PERMIT

WELL TYPE: OIL GAS LIQUID INJECTION WASTE DISPOSAL
 (IF GAS) PRODUCTION: STORAGE DEEP SHALLOW
 LOCATION: ELEVATION: 1430' WATERSHED Rockcamp Run of Willey Fork QUADRANGLE: Big Run
 DISTRICT: Grant COUNTY: Wetzel
 SURFACE OWNER: ET Blue Grass LLC ACREAGE: 138.93
 ROYALTY OWNER: Shiben Estates, Inc., et al. LEASE NO: 125397 ACREAGE: 140
 PROPOSED WORK: DRILL CONVERT DRILL DEEPER FRACTURE OR STIMULATE PLUG OFF OLD FORMATION
 PERFORATE NEW FORMATION OTHER PHYSICAL CHANGE IN WELL (SPECIFY)
 PLUG AND ABANDON CLEAN OUT AND REPLUG TARGET FORMATION: Marcellus ESTIMATED DEPTH: 7,549'

WELL OPERATOR: EQT Production Company DESIGNATED AGENT: Joseph C. Mallow
 ADDRESS: 400 Woodcliff Drive ADDRESS: 427 Midstate Drive
 Canonsburg, PA 15317 Clarksburg, WV 26301

02/16/2024