

- ⊙ Proposed Gas Well
- ⊙ Located Corner, as noted
- Surface Tract Lines
- Reference Line
- Lease Boundary
- Creek or Drain
- Ⓢ WV County Route
- Ⓢ WV State Route

(⊙) Denotes Location of Well on United States Topographic Maps



I, the undersigned, hereby certify that this plat is correct to the best of my knowledge and belief and shows all the information required by law and the regulations issued and prescribed by the Department of Environmental Protection.

Ben R. Singleton
P.S. 2092

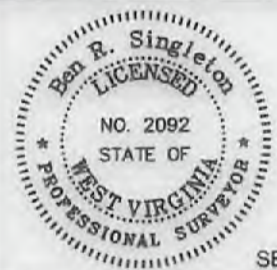

SEAL

FILE NO: 246-18
DRAWING NO: BIG245 112H
SCALE: 1" = 2000'
MINIMUM DEGREE OF ACCURACY: 1:2500
PROVEN SOURCE OF ELEVATION: NGS CORS Station

STATE OF WEST VIRGINIA
DEPARTMENT OF ENVIRONMENTAL PROTECTION
OIL AND GAS DIVISION

DATE: February 11 20 22
OPERATOR'S WELL NO.: BIG245 112H
API WELL NO M00
47 - 103 - 03445
STATE COUNTY PERMIT

WELL TYPE: OIL GAS LIQUID INJECTION WASTE DISPOSAL
(IF GAS) PRODUCTION: STORAGE DEEP SHALLOW
LOCATION: ELEVATION: 1430' WATERSHED: Rockcamp Run of Willey Fork QUADRANGLE: Big Run
DISTRICT: Grant COUNTY: Wetzel
SURFACE OWNER: ET Blue Grass LLC ACREAGE: 138.93
ROYALTY OWNER: Shiben Estates, Inc., et al. LEASE NO: 125397 ACREAGE: 140
PROPOSED WORK: DRILL CONVERT DRILL DEEPER FRACTURE OR STIMULATE PLUG OFF OLD FORMATION
 PERFORATE NEW FORMATION OTHER PHYSICAL CHANGE IN WELL (SPECIFY)
 PLUG AND ABANDON CLEAN OUT AND REPLUG TARGET FORMATION: Marcellus ESTIMATED DEPTH: 7.549'

WELL OPERATOR: EQT Production Company DESIGNATED AGENT: Joseph C. Mallow
ADDRESS: 400 Woodcliff Drive ADDRESS: 427 Midstate Drive
Canonsburg, PA 15317 Clarksburg, WV 26301

03/04/2022

BIG245 112H
BIG245
EQT Production Company

Tract I.D.	Tax Map No.	Parcel No.	County	District	Surface Tract Owner	Acres
1	8	22	Wetzel	Grant	ET Blue Grass LLC	138.03
2	8	15	Wetzel	Grant	John Michael Byard	71.60
3	8	28	Wetzel	Grant	James A. Yoho	61.00
4	8	29	Wetzel	Grant	Mary Jane Byard	15.00
5	8	32	Wetzel	Grant	Joe Plog	82.40
6	9	28	Wetzel	Grant	Sherilyn Snider	55.52
7	9	40	Wetzel	Grant	Sherilyn Snider	24.00
8	9	52	Wetzel	Grant	Norman Derby	81.51
9	14	8	Wetzel	Grant	Esther R. Coen	58.50
10	14	10	Wetzel	Grant	John W. Wycoff & Carolyn S. McGill	29.00
11	14	18	Wetzel	Grant	John W. Wycoff & Carolyn S. McGill	66.70
12	14	23	Wetzel	Grant	Equitrans LP	51.00
13	14	36	Wetzel	Grant	Dale C. Eastham, et al.	57.00
14	8	10,1	Wetzel	Grant	Duane M. Goodrich	3.90
15	8	7	Wetzel	Grant	James E. & Martin A. Stonking	19.12
16	8	8	Wetzel	Grant	Wanda L. Byard	59.18
17	9	22	Wetzel	Grant	James A. Yoho	17.60
18	8	25	Wetzel	Grant	James A. Yoho	6.25
19	8	23	Wetzel	Grant	Dale K. Dulaney, et al.	79.81
20	8	11	Wetzel	Grant	Boazie M. Herdome	63.50
21	9	53	Wetzel	Grant	Mary E. Wright, et al.	48.00
22	8	27	Wetzel	Grant	James A. Yoho	21.75
23	9	13	Wetzel	Grant	James A. Yoho	27.00
24	9	17	Wetzel	Grant	Lossie Watson	20.08
25	9	23	Wetzel	Grant	Stephen D. & Carolyn M. Gantz	119.00
26	9	29	Wetzel	Grant	William & Margaret Schleicher	47.50
27	9	53	Wetzel	Grant	H. Don Higginbotham	109.21
28	8	20	Wetzel	Grant	James A. Yoho	23.25
29	8	40	Wetzel	Grant	Sherilyn Snider	24.00
30	8	84	Wetzel	Grant	Sherilyn Snider	20.00
31	9	53	Wetzel	Grant	Norman R. & Vivian L. Derby	32.90
32	9	52,1	Wetzel	Grant	Norman R. & Vivian L. Derby	1.60
33	9	05	Wetzel	Grant	Terri L. & Jason D. Baxly	6.51
34	14	7	Wetzel	Grant	Norman Derby	83.00
35	9	54	Wetzel	Grant	Jack L. & Leanna C. Barmette	17.40
36	14	9	Wetzel	Grant	Leonard Rice	55.00
37	14	11	Wetzel	Grant	Thomas J. Parks, et al.	54.44
38	14	99	Wetzel	Grant	Coastal Forest Resources Company	138.89
39	14	17	Wetzel	Grant	John W. Wycoff & Carolyn S. McGill	6.26
40	14	18	Wetzel	Grant	John W. Wycoff & Carolyn S. McGill	1.59
41	14	22	Wetzel	Grant	John W. Wycoff & Carolyn S. McGill	48.00
42	14	25	Wetzel	Grant	Cara Snodgrass	35.88
43	14	24	Wetzel	Grant	EQT Production Company	19.20
44	14	28	Wetzel	Grant	EQT Production Company	50.59
45	14	37	Wetzel	Grant	EQT Production Company	26.59
46	14	29	Wetzel	Grant	ET Blue Grass, LLC	17.00
47	14	30	Wetzel	Grant	Equitrans LP	20.50
48	14	39,3	Wetzel	Grant	Dale C. Eastham, et al.	38.05
49	14	31	Wetzel	Grant	Donald D'Lusky Jr.	19.00
50	14	40	Wetzel	Grant	Donald D'Lusky Jr.	131.00

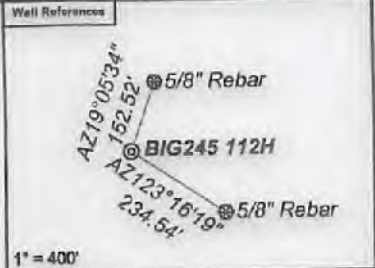

Notes:
BIG245 112H coordinates are
NAD 27 N: 400,767.94 E: 1,698,793.49
NAD 27 Lat: 39.595421 Long: -80.568891
NAD 83 UTM N: 4,382,952.65 E: 537,031.80
BIG245 112H Landing Point coordinates are
NAD 27 N: 401,339.59 E: 1,700,552.72
NAD 27 Lat: 39.597048 Long: -80.562673
NAD 83 UTM N: 4,383,135.67 E: 537,564.88
BIG245 112H Bottom Hole coordinates are
NAD 27 N: 390,840.01 E: 1,706,861.76
NAD 27 Lat: 39.568426 Long: -80.539854
NAD 83 UTM N: 4,379,968.98 E: 539,540.29
West Virginia Coordinate system of 1927 (North Zone)
based upon Differential GPS Measurements.
Plat orientation, corner and well ties are based upon
the grid north meridian.
Well location references are based upon the grid north
meridian.
UTM coordinates are NAD83, Zone 17, Meters.

- BIG245**
- ⊙ BIG245 114H
 - ⊙ BIG245 112H
 - ⊙ BIG245 110H
 - ⊙ BIG245 108H
 - ⊙ BIG245 106H
 - ⊙ BIG245 104H
 - ⊙ BIG245 102H
 - ⊙ 47-103-03235
 - ⊙ 47-103-03236
- 47-103-03234⊙

Lease No.	Owner	Acres
169210000	Liberty Holding Company, Inc.	71.5
125372	Ryan C. Radtka, et al.	61
125362	Mary Jane Wright, et al.	15
125374	Jordan Zachary Plog, et al.	100
125424	Sherilyn Snider	80
125375	Jacob Francis Shreve III aka Jacob F. Shreve, et al.	62
125394	Esther R. Coen, et al.	60
125459	Randel J. Hartman, et al.	693
125466	Bounty Minerals LLC	67
1009318	Thomas L. Lewis, et al.	51

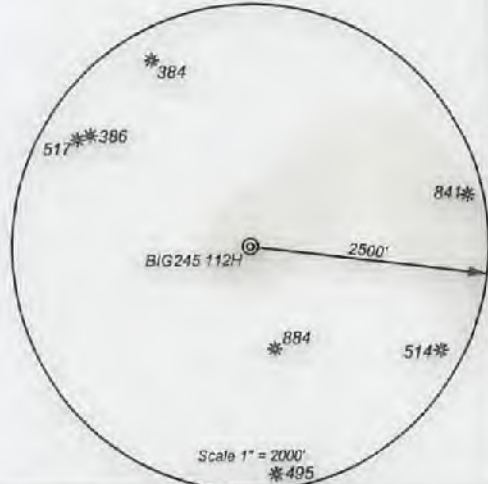

I, the undersigned, hereby certify that this plat is correct to the best of my knowledge and belief and shows all the information required by law and the regulations issued and prescribed by the Department of Environmental Protection.

Ben R. Singleton
P.S. 2092

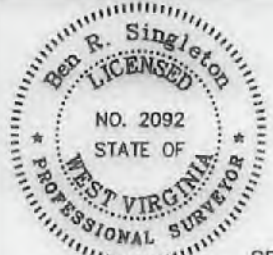

SEAL

FILE NO: 246-18
DRAWING NO: BIG245 112H
SCALE: 1" = 2000'
MINIMUM DEGREE OF ACCURACY: 1:2500
PROVEN SOURCE OF ELEVATION: NGS CORS Station



DATE: February 11 20 22
OPERATOR'S WELL NO.: BIG245 112H
API WELL NO **MOO**
47 - 103 - 03445
STATE COUNTY PERMIT

WELL TYPE: OIL GAS LIQUID INJECTION WASTE DISPOSAL
(IF GAS) PRODUCTION: STORAGE DEEP SHALLOW
LOCATION: ELEVATION: 1430' WATERSHED Rockcamp Run of Willey Fork QUADRANGLE: Big Run
DISTRICT: Grant COUNTY: Wetzel **03/04/2022**
SURFACE OWNER: ET Blue Grass LLC ACREAGE: 138.93
ROYALTY OWNER: Shiben Estates, Inc., et al. LEASE NO: 125397 ACREAGE: 140
PROPOSED WORK: DRILL CONVERT DRILL DEEPER FRACTURE OR STIMULATE PLUG OFF OLD FORMATION
 PERFORATE NEW FORMATION OTHER PHYSICAL CHANGE IN WELL (SPECIFY) _____
 PLUG AND ABANDON CLEAN OUT AND REPLUG TARGET FORMATION: Marcellus ESTIMATED DEPTH: 7.549'

WELL OPERATOR: EQT Production Company DESIGNATED AGENT: Joseph C. Mallow
ADDRESS: 400 Woodcliff Drive ADDRESS: 427 Midstate Drive
Canonsburg, PA 15317 Clarksburg, WV 26301