

I, the undersigned, hereby certify that this plat is correct to the best of my knowledge and belief and shows all the information required by law and the regulations issued and prescribed by the Department of Environmental Protection.

Ben R. Singleton
P.S. 2092

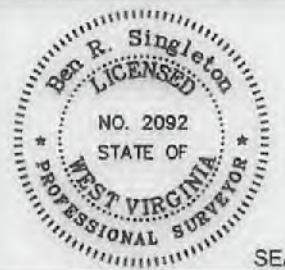

SEAL

FILE NO: 246-18
DRAWING NO: BIG245 114H
SCALE: 1" = 2000'
MINIMUM DEGREE OF ACCURACY: 1:2500
PROVEN SOURCE OF ELEVATION: NGS CORS Station

STATE OF WEST VIRGINIA
DEPARTMENT OF ENVIRONMENTAL PROTECTION
OIL AND GAS DIVISION

DATE: July 08 20 21
OPERATOR'S WELL NO.: BIG245 114H
API WELL NO 47-103-03446
STATE COUNTY PERMIT

WELL TYPE: OIL GAS LIQUID INJECTION WASTE DISPOSAL
(IF GAS) PRODUCTION: STORAGE DEEP SHALLOW
LOCATION: ELEVATION: 1430' WATERSHED Rockcamp Run of Willey Fork QUADRANGLE: Big Run
DISTRICT: Grant COUNTY: Wetzel
SURFACE OWNER: ET Blue Grass LLC ACREAGE: 138.93
ROYALTY OWNER: Shiben Estates, Inc., et al. LEASE NO: 125397 ACREAGE: 140
PROPOSED WORK: DRILL CONVERT DRILL DEEPER FRACTURE OR STIMULATE PLUG OFF OLD FORMATION
 PERFORATE NEW FORMATION OTHER PHYSICAL CHANGE IN WELL (SPECIFY)
 PLUG AND ABANDON CLEAN OUT AND REPLUG TARGET FORMATION: Marcellus ESTIMATED DEPTH: 7,548'

WELL OPERATOR: EQT Production Company DESIGNATED AGENT: Joseph C. Mallow
ADDRESS: 400 Woodcliff Drive ADDRESS: 115 Professional Place PO Box 280
Canonsburg, PA 15317 Bridgeport, WV 26330

08/20/2021

BIG245 114H
BIG245
EQT Production Company

Tract I.D.	Tax Map No.	Parcel No.	County	District	Surface Tract Owner	Acres
1	8	22	Wetzel	Grant	ET Blue Grass LLC	138.93
2	8	18	Wetzel	Grant	John Michael Byard	71.00
3	8	25	Wetzel	Grant	James A. Yoho	81.00
4	8	25	Wetzel	Grant	Mary Jane Byard	15.00
5	8	32	Wetzel	Grant	Joe Pigg	82.40
6	8	26	Wetzel	Grant	Shedlyn Snider	35.52
7	9	40	Wetzel	Grant	Shedlyn Snider	24.00
8	8	52	Wetzel	Grant	Norman Derby	51.51
9	14	8	Wetzel	Grant	Esther R. Cain	58.50
10	14	10	Wetzel	Grant	John W. Wycoff & Carolyn S. McGill	28.00
11	14	18	Wetzel	Grant	John W. Wycoff & Carolyn S. McGill	66.70
12	14	22	Wetzel	Grant	Equitans LP	51.00
13	14	38	Wetzel	Grant	Dale C. Eastham, et al	57.00
14	8	13.1	Wetzel	Grant	Duane M. Goodrich	3.58
15	8	7	Wetzel	Grant	James E. & Martin A. Stenking	59.12
16	8	8	Wetzel	Grant	Wanda L. Byard	58.18
17	8	22	Wetzel	Grant	James A. Yoho	17.60
18	8	25	Wetzel	Grant	James A. Yoho	8.25
19	8	23	Wetzel	Grant	Dale K. Dulensky, et al	70.81
20	8	11	Wetzel	Grant	Bernice M. Heathome	63.50
21	9	63	Wetzel	Grant	Mary E. Wright, et al	45.00
22	8	27	Wetzel	Grant	James A. Yoho	21.75
23	9	13	Wetzel	Grant	James A. Yoho	27.00
24	9	17	Wetzel	Grant	Leslie Watson	20.58
25	9	23	Wetzel	Grant	Stephen B. & Carolyn M. Gantz	119.00
26	8	29	Wetzel	Grant	William & Margaret Schlicher	47.90
27	8	53	Wetzel	Grant	H. Don Higginbotham	160.21
28	8	28	Wetzel	Grant	James A. Yoho	23.25
29	8	65	Wetzel	Grant	Mary E. Wright, et al	4.25
30	8	9	Wetzel	Grant	Mary E. Wright, et al	24.00
31	9	53	Wetzel	Grant	Norman R. & Vivian L. Derby	32.00
32	4	13	Wetzel	Grant	Oliver Marie Utz	15.17
33	9	8	Wetzel	Grant	James A. Yoho	45.08
34	9	9	Wetzel	Grant	Wanda Willey, et al	11.30
35	9	54	Wetzel	Grant	Jack L. & Leanna C. Barretto	17.40
36	14	9	Wetzel	Grant	Leonard Rice	55.00
37	14	11	Wetzel	Grant	Thomas J. Parks, et al	54.44
38	14	10	Wetzel	Grant	Coastal Forest Resources Company	128.88
39	9	15	Wetzel	Grant	Oval Stenking Estate	8.52
40	9	41	Wetzel	Grant	William Schlicher	11.56
41	14	22	Wetzel	Grant	John W. Wycoff & Carolyn S. McGill	48.00
42	14	25	Wetzel	Grant	Clara Shodgrass	35.88
43	14	24	Wetzel	Grant	EQT Production Company	59.20
44	14	28	Wetzel	Grant	EQT Production Company	58.50
45	14	37	Wetzel	Grant	EQT Production Company	36.50
46	14	29	Wetzel	Grant	ET Blue Grass, LLC	17.00
47	9	42	Wetzel	Grant	Jack L. & Leanna C. Barretto	2.09
48	9	43	Wetzel	Grant	Norman R. & Vivian L. Derby	14.40
49	9	45	Wetzel	Grant	Dewayne & Patricia L. Motts	19.85
50	9	55	Wetzel	Grant	Jack L. & Leanna C. Barretto	18.40
51	8	58	Wetzel	Grant	Leonard E. & Edwin C. Rice	16.50
52	14	1	Wetzel	Grant	Leonard E. & Edwin C. Rice	21.55
53	14	12	Wetzel	Grant	Thomas J. Parks, et al	18.00
54	14	19.1	Wetzel	Grant	Thomas J. Parks, et al	18.82
55	14	14	Wetzel	Grant	Mary Yost, et al	21.90
56	14	13	Wetzel	Grant	Coastal Forest Resources Company	2.58
57	14	15	Wetzel	Grant	Coastal Forest Resources Company	28.60
58	14	28	Wetzel	Grant	Mary J. Byard	14.50
59	3	31	Wetzel	Grant	Ralph D. Thacker, et al	27.96

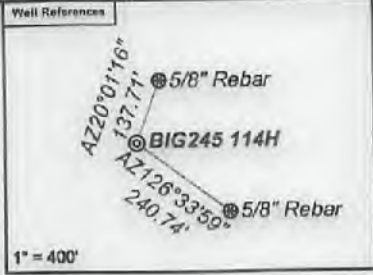

Notes:
BIG245 114H coordinates are
NAD 27 N: 400,782.68 E: 1,598,796.24
NAD 27 Lat: 39.595462 Long: -80.568882
NAD 83 UTM N: 4,382,957.05 E: 537,032.56
BIG245 114H Landing Point coordinates are
NAD 27 N: 401,854.60 E: 1,701,409.84
NAD 27 Lat: 39.598490 Long: -80.559653
NAD 83 UTM N: 4,383,296.94 E: 537,823.40
BIG245 114H Bottom Hole coordinates are
NAD 27 N: 400,764.37 E: 1,702,064.94
NAD 27 Lat: 39.595518 Long: -80.557283
NAD 83 UTM N: 4,382,968.12 E: 538,028.52
West Virginia Coordinate system of 1927 (North Zone) based upon Differential GPS Measurements. Plat orientation, corner and well ties are based upon the grid north meridian. Well location references are based upon the grid north meridian. UTM coordinates are NAD83, Zone 17, Meters.

Lease No.	Owner	Acres
169210000	Liberty Holding Company, Inc.	71.5
125385	Kathy Lee Longwell, et al.	61
125371	Joseph F. Kiger, et al.	46

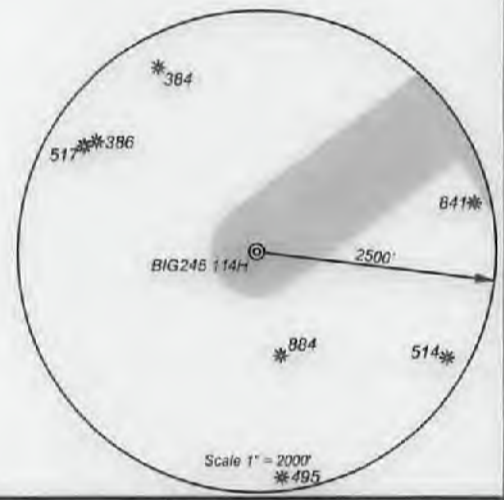

I, the undersigned, hereby certify that this plat is correct to the best of my knowledge and belief and shows all the information required by law and the regulations issued and prescribed by the Department of Environmental Protection.

Ben R. Singleton
P.S. 2092

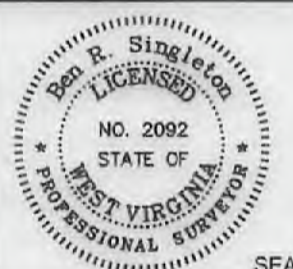

FILE NO: 246-18
DRAWING NO: BIG245 114H
SCALE: 1" = 2000'
MINIMUM DEGREE OF ACCURACY: 1:2500
PROVEN SOURCE OF ELEVATION: NGS CORS Station



DATE: July 08 20 21
OPERATOR'S WELL NO.: BIG245 114H
API WELL NO: 47-103-03446
STATE COUNTY PERMIT

WELL TYPE: OIL GAS LIQUID INJECTION WASTE DISPOSAL
(IF GAS) PRODUCTION: STORAGE DEEP SHALLOW
LOCATION: ELEVATION: 1430' WATERSHED: Rockcamp Run of Willey Fork QUADRANGLE: Big Run
DISTRICT: Grant COUNTY: Wetzel
SURFACE OWNER: ET Blue Grass LLC ACREAGE: 138.93
ROYALTY OWNER: Shiben Estates, Inc., et al. LEASE NO: 125397 ACREAGE: 140
PROPOSED WORK: DRILL CONVERT DRILL DEEPER FRACTURE OR STIMULATE PLUG OFF OLD FORMATION
 PERFORATE NEW FORMATION OTHER PHYSICAL CHANGE IN WELL (SPECIFY)
 PLUG AND ABANDON CLEAN OUT AND REPLUG TARGET FORMATION: Marcellus ESTIMATED DEPTH: 7,548'

WELL OPERATOR: EQT Production Company DESIGNATED AGENT: Joseph C. Mallow
ADDRESS: 400 Woodcliff Drive ADDRESS: 115 Professional Place PO Box 280
Canonsburg, PA 15317 Bridgeport, WV 26330

