



west virginia department of environmental protection

Office of Oil and Gas
601 57th Street, S.E.
Charleston, WV 25304
(304) 926-0450
fax: (304) 926-0452

Harold D. Ward, Cabinet Secretary
www.dep.wv.gov

Monday, September 26, 2022
PERMIT MODIFICATION APPROVAL
Horizontal 6A / New Drill

ANTERO RESOURCES CORPORATION
1615 WYNKOOP STREET

DENVER, CO 80202

Re: Permit Modification Approval for ECKLEBERRY 2H
47-103-03493-00-00

Lateral Extension

ANTERO RESOURCES CORPORATION

The Office of Oil and Gas has reviewed the attached permit modification for the above referenced permit. The attached modification has been approved and well work may begin. Please be reminded that the oil and gas inspector is to be notified twenty-four (24) hours before permitted well work is commenced.

If there are any questions, please feel free to contact me at (304) 926- 0450.

A blue ink signature of James A. Martin is written over a circular stamp. The signature is cursive and stylized. Below the signature, the name 'James A. Martin' and the title 'Chief' are printed in a blue, sans-serif font.

James A. Martin
Chief

Operator's Well Number: ECKLEBERRY 2H
Farm Name: JAMES ALLEN SELL
U.S. WELL NUMBER: 47-103-03493-00-00
Horizontal 6A New Drill
Date Modification Issued: 09/26/2022

Promoting a healthy environment.

09/30/2022

47 10 303 493



Antero Resources
1615 Wynkoop Street
Denver, CO 80202
Office 303.357.7310
Fax 303.357.7315

September 2, 2022

West Virginia Department of Environmental Protection
Office of Oil and Gas
Attn: Mr. Taylor Brewer
601 57th Street
Charleston, WV 25304

RECEIVED
Office of Oil and Gas

SEP 7 2022

WV Department of
Environmental Protection

Mr. Brewer:

Antero Resources Corporation (Antero) would like to submit the following permit modification for approved well on the existing Furbee Pad; Eckleberry Unit 2H.

Attached you will find the following:

- Revised Forms WW-6B
- Revised Forms WW-6A1
- Revised Mylar Plats
- AORs

If you have any questions please feel free to contact me at (303) 357-7182.

Thank you in advance for your consideration.

Sincerely,

Mallory Stanton
Permitting Manager
Antero Resources Corporation

Enclosures

*OK # 40/2202
Amt 52500
Date 8/9/22*

09/30/2022

STATE OF WEST VIRGINIA
DEPARTMENT OF ENVIRONMENTAL PROTECTION, OFFICE OF OIL AND GAS
WELL WORK PERMIT APPLICATION

1) Well Operator: Antero Resources Corporation 494507062 013-Wetzel Green Pine Grove 7.5'
Operator ID County District Quadrangle

2) Operator's Well Number: Eckleberry Unit 2H MOD Well Pad Name: Furbee Pad

3) Farm Name/Surface Owner: James Allen Sell Public Road Access: Furbee Ridge Road

4) Elevation, current ground: 1240' Elevation, proposed post-construction: ~1212'

5) Well Type (a) Gas Oil Underground Storage

Other

(b) If Gas Shallow Deep

Horizontal

6) Existing Pad: Yes or No No

7) Proposed Target Formation(s), Depth(s), Anticipated Thickness and Expected Pressure(s):
Marcellus Shale: 7600' TVD, Anticipated Thickness- 55 feet, Associated Pressure- 2850#

8) Proposed Total Vertical Depth: 7600' TVD

9) Formation at Total Vertical Depth: Marcellus

10) Proposed Total Measured Depth: 29100' MD

11) Proposed Horizontal Leg Length: 17160.4'

12) Approximate Fresh Water Strata Depths: 575'

13) Method to Determine Fresh Water Depths: 47103308970000

14) Approximate Saltwater Depths: 2284'

15) Approximate Coal Seam Depths: 973'

16) Approximate Depth to Possible Void (coal mine, karst, other): None Anticipated

17) Does Proposed well location contain coal seams directly overlying or adjacent to an active mine? Yes No

RECEIVED
Office of Oil and Gas
SEP 7 2022

(a) If Yes, provide Mine Info: Name: _____
Depth: _____
Seam: _____
Owner: _____
WV Department of Environmental Protection

18)

CASING AND TUBING PROGRAM

TYPE	Size (in)	New or Used	Grade	Weight per ft. (lb/ft)	FOOTAGE: For Drilling (ft)	INTERVALS: Left in Well (ft)	CEMENT: Fill-up (Cu. Ft.)/CTS
Conductor	20"	New	H-40	79#	80	80	CTS, 77 Cu. Ft.
Fresh Water	13-3/8"	New	J/K-55	54.5#	625	625	CTS, 651 Cu. Ft.
Coal	9-5/8"	New	J/K-55	36#	2500	2500	CTS, 1018 Cu. Ft.
Intermediate							
Production	5-1/2"	New	P-110CY	20#	29100	29100	CTS, 5967 Cu. Ft.
Tubing	2-3/8"	New	N-80	4.7#			
Liners							

Kenneth L. Reynolds
9-22-22

TYPE	Size (in)	Wellbore Diameter (in)	Wall Thickness (in)	Burst Pressure (psi)	Anticipated Max. Internal Pressure (psi)	Cement Type	Cement Yield (cu. ft./k)
Conductor	20"	24"	0.375"	2250	50	Class A	~1.18
Fresh Water	13-3/8"	17-1/2"	0.38"	2730	1000	Class A	~1.18
Coal	9-5/8"	12-1/4"	0.352"	3520	1500	Class A	~1.18
Intermediate							
Production	5-1/2"	8-3/4" & 8-1/2"	0.415"	14,360	2500	Class G/H	~1.18
Tubing	2-3/8"	4.778"	0.19"	11,200			
Liners							

PACKERS

Kind:	N/A			
Sizes:	N/A			
Depths Set:	N/A			

19) Describe proposed well work, including the drilling and plugging back of any pilot hole:

Drill, perforate, fracture a new horizontal shallow well and complete Marcellus Shale.

*Antero will be air drilling the fresh water string which makes it difficult to determine when fresh water is encountered. Therefore, we have built in a buffer for the casing setting depth which helps to ensure that all fresh water zones are covered.

20) Describe fracturing/stimulating methods in detail, including anticipated max pressure and max rate:

Antero plans to pump Slickwater into the Marcellus Shale formation in order to ready the well for production. The fluid will be comprised of approximately 99 percent water and sand, with less than 1 percent special-purpose additives as shown in the attached "List of Anticipated Additives Used for Fracturing or Stimulating Well."

Anticipated Max Pressure - 9300 lbs
Anticipated Max Rate - 80 bpm

21) Total Area to be disturbed, including roads, stockpile area, pits, etc., (acres): 30.09 acres

22) Area to be disturbed for well pad only, less access road (acres): 13.86 acres

23) Describe centralizer placement for each casing string:

Conductor: no centralizers

Surface Casing: one centralizer 10' above the float shoe, one on the insert float collar and one every 4th joint spaced up the hole to surface.

Intermediate Casing: one centralizer above float joint, one centralizer 5' above float collar and one every 4th collar to surface.

Production Casing: one centralizer at shoe joint and one every 3 joints to top of cement in intermediate casing.

24) Describe all cement additives associated with each cement type:

Conductor: no additives, Class A cement.

Surface: Class A cement with 2-3% calcium chloride and 1/4 lb of flake

Intermediate: Class A cement with 1/4 lb of flake, 5 gallons of clay treat

Production: Lead cement- 50/50 Class H/Poz + 1.5% salt + 1% C-45 + 0.5% C-16a + 0.2% C-12 + 0.45% C-20 + 0.05% C-51

Production: Tail cement- Class H + 45 PPS Calcium Carbonate + 1.0% FL-160 + 0.2% ACGB-47 + 0.05% ACSA-51 + 0.2% ACR-20

25) Proposed borehole conditioning procedures:

Conductor: blowhole clean with air, run casing, 10 bbls fresh water.

Surface: blowhole clean with air, trip to conductor shoe, trip to bottom, blowhole clean with air, trip out, run casing, circulate pipe capacity + 40 bbls fresh water followed by 25 bbls bentonite mud, 10 bbls fresh water spacer.

Intermediate: blowhole clean with air, trip to surface casing shoe, trip to bottom, blowhole clean with air, trip out, run casing, circulate 40 bbls brine water followed by 10 bbls fresh water and 25 bbls bentonite mud, pump 10 bbls fresh water.

Production: circulate with 14 lb/gal NaCl mud, trip to middle of lateral, circulate, pump high viscosity sweep, trip to base of curve, pump high viscosity sweep, trip to top of curve, trip to bottom, circulate, pump high viscosity sweep, trip out, run casing, circulate 10 bbls fresh water, pump 48 bbls barite pill, pump 10 bbls fresh water followed by 48 bbls mud flush and 10 bbls water.

*Note: Attach additional sheets as needed.

47 10 303 493

LEGEND

- ⊙ Proposed gas well
- ☼ Existing Well, as noted
- ☼ Digitized Well, as noted



The orientation of this survey is Grid North, and its coordinate base is the West Virginia Coordinate System of 1927, North Zone

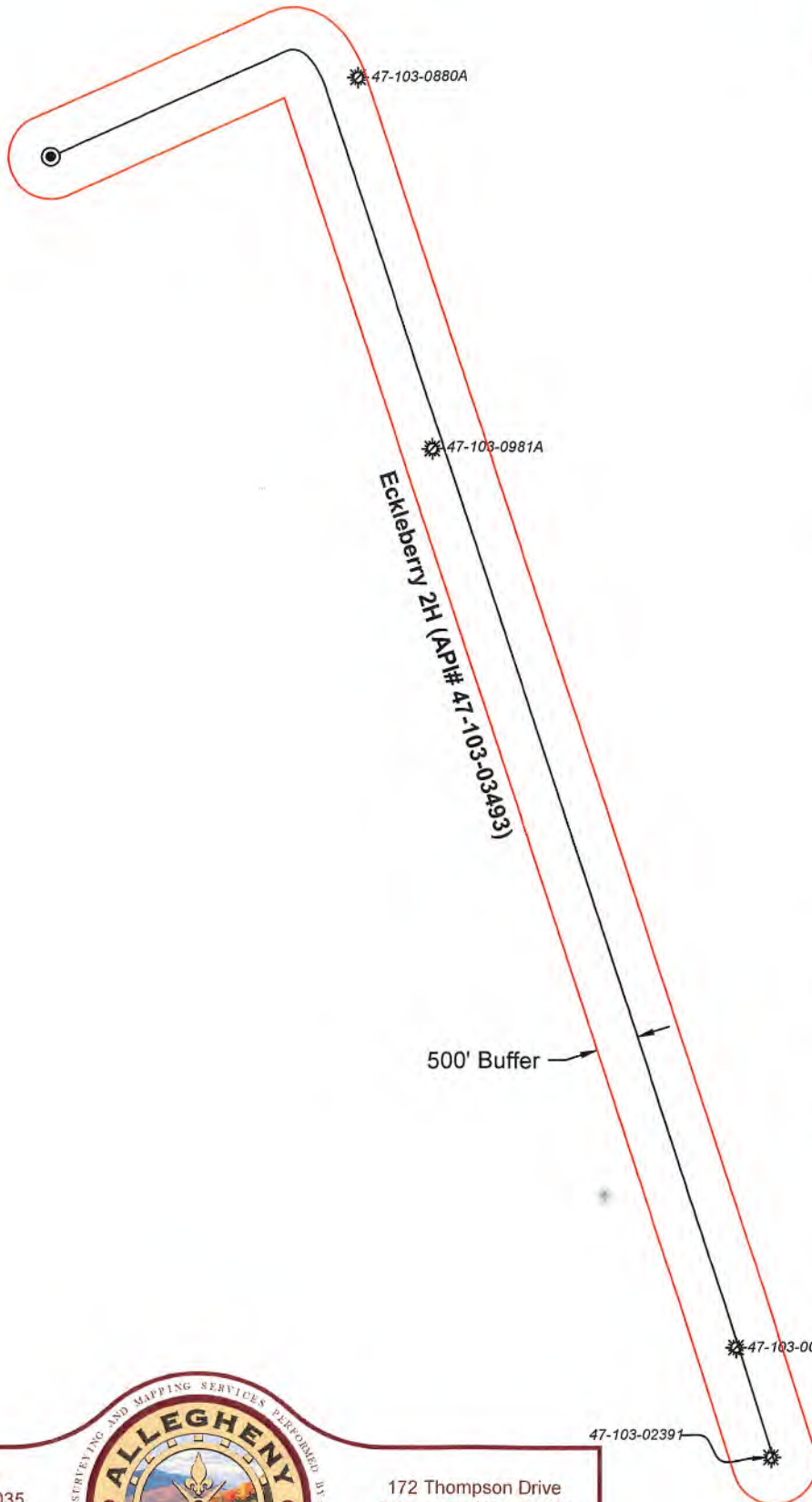

RECEIVED
Office of Oil and Gas
SEP 7 2022
WV Department of
Environmental Protection



Bridgeport Office
Phone: (304) 848-5035
Fax: (304) 848-5037

172 Thompson Drive
Bridgeport, WV 26330

PARTY CHIEF: C. Lynch	DRAWN BY: J. Smith
RESEARCH: J. Miller	PREPARED: August 8, 2022
SURVEYED: Dec. 2016	PROJECT NO: 120-34-G-18
FIELD CREW: C.L., K.M.	DRAWING NO: Eckleberry 2H BHLM AOR

Sheet 1 of 1



Scale: 1 inch = 2000 feet

09/30/2022

UWI (APINum)	Well Name	Well Number	Operator	Historical Operator	TD	Perforated Interval (shallowest, deepest)	Perforated Formation(s)	Producibile Formation(s) not perf'd
4710330880000	C A LONG	5442	HOPE NATURAL GAS	HOPE NATURAL GAS	2,805		Big Injun, Gordon	Weir, Benson, Alexander
47103309810000	LOT MARTIN 1	1343	MANUFACT LIGHT & HEAT	MANUFACT LIGHT & HEAT	2,508		Gordon	Weir, Benson, Alexander
47103006480000	JOSEPHINE BRAST	6	DIVERSIFIED PROD LLC	CONSOL GAS SUPPLY CRP	2,830		Big Injun, Gordon	Weir, Benson, Alexander
47103023910000	MILLER ISRAEL	7	ASCENT RESOURCES-MAR	EAST RESOURCES	3,260	2975 - 2986	Gordon, Fourth, Fifth, Bayard	Weir, Benson, Alexander

Antero Resources
Well No. Eckleberry 2H
BHL MOD
 Antero Resources Corporation

Page 1 of 2



Proposed Well No. Eckleberry Unit 2H

6,524' to Top Hole
 9,507' to Bottom Hole
 TOP HOLE LATITUDE 39 - 35 - 00
 BTM HOLE LATITUDE 39 - 32 - 30

Notes
 West Virginia Coordinate System of 1927, North Zone based upon Differential GPS Measurements.
 Well No. Eckleberry Unit 2H Top Hole coordinates are
 N: 387,463.73' Latitude: 39°33'26.21"
 E: 1,652,791.57' Longitude: 80°43'53.30"
 Bottom Hole coordinates are
 N: 371,957.91' Latitude: 39°30'54.11"
 E: 1,661,355.59' Longitude: 80°42'01.32"
 UTM Zone 17, NAD 1983
 Top Hole Coordinates Bottom Hole Coordinates
 N: 4,378,664.953m N: 4,373,984.589m
 E: 523,084.160m E: 525,771.958m
 Plat orientation and corner and well references are based upon the grid north meridian.
 Well location references are based upon the magnetic meridian.

TOP HOLE LONGITUDE 80 - 42 - 30
 BTM HOLE LONGITUDE 80 - 40 - 00

Well Location References (NTS)

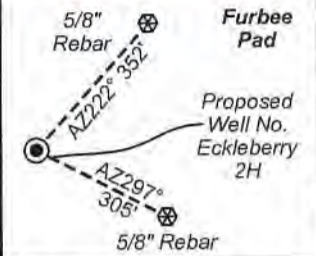

I, the undersigned, hereby certify that this plat is correct to the best of my knowledge and belief and shows all the information required by law and the rules issued and prescribed by the Department of Environmental Protection.

Bradley D. Miller
 Bradley D. Miller, P.S. 2167

Notes:
 Well No. Eckleberry Unit 2H UTM Zone 17, NAD 1927
 Top Hole Coordinates
 N: 14,364,954.42'
 E: 1,716,103.67'
 Point of Entry Coordinates
 N: 14,365,827.66'
 E: 1,719,362.77'
 Bottom Hole Coordinates
 N: 14,349,598.83'
 E: 1,724,922.34'

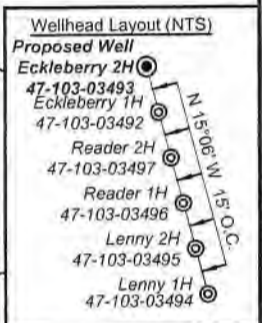

	Bearing	Dist.
L1	S 76°07' W	1,921.2'
L2	N 82°15' W	2,102.6'
L3	N 73°51' E	1,559.4'
L4	N 79°07' E	1,559.2'
L5	N 75°57' E	3,375.2'

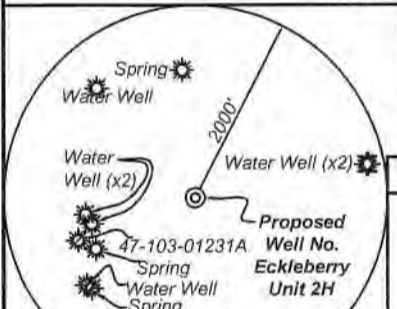

Note: 6 water wells and 3 springs were found within 2000' of proposed well. No occupied dwellings or buildings 2,500 square feet or larger used to house or shelter dairy cattle or poultry husbandry are located within 625' of the center of the well pad.

- Legend**
- Proposed gas well
 - ⊗ Monument, as noted
 - ⊙ Existing Well, as noted
 - ⊙ Digitized Well, as noted
 - Creek or Drain
 - Road
 - Railroad Right-of-Way
 - Surface boundary (approx.)
 - Interior surface tracts (approx.)

FILE NO: 120-34-G-18
 DRAWING NO: Eckleberry Unit 2H Well Plat
 SCALE: 1" = 2000'
 MINIMUM DEGREE OF ACCURACY: Submeter
 PROVEN SOURCE OF ELEVATION: WVDOT, Harrisville, WV

STATE OF WEST VIRGINIA
 DEPARTMENT OF ENVIRONMENTAL PROTECTION
OIL AND GAS DIVISION

DATE: August 9 20 22
 OPERATOR'S WELL NO. Eckleberry Unit 2H
 API WELL NO
 47 - 103 - 03493
 STATE COUNTY PERMIT

WELL TYPE: OIL GAS LIQUID INJECTION WASTE DISPOSAL
 (IF GAS) PRODUCTION: STORAGE DEEP SHALLOW
 LOCATION: ELEVATION: Proposed 1212' Existing 1240' WATERSHED: Fishing Creek QUADRANGLE: Pine Grove
 DISTRICT: Green James COUNTY: Wetzel
 SURFACE OWNER: A. Sell Robert G. Bassett, et ux; Josephine Brast, et al; Israel Miller, et ux; 25.6; 75; 500; 123.5;
 ROYALTY OWNER: James Allen Sell; Marilyn Hatley Seeley; Linda Darlene Straight; Marcella K. Harrison; LEASE NO: ACREAGE: 203.163; 257; 300
 PROPOSED WORK: DRILL CONVERT DRILL DEEPER FRACTURE OR STIMULATE PLUG OFF OLD FORMATION
 PERFORATE NEW FORMATION OTHER PHYSICAL CHANGE IN WELL (SPECIFY) BHL_MOD 7,600' TVD
 PLUG AND ABANDON CLEAN OUT AND REPLUG TARGET FORMATION: Marcellus Shale ESTIMATED DEPTH: 29,100' MD

WELL OPERATOR: Antero Resources Corporation DESIGNATED AGENT: Dianna Stamper - CT Corporation System
 ADDRESS: 1615 Wynkoop Street ADDRESS: 5400 D Big Tyler Road
 Denver, CO 80202 Charleston, WV 25313

09/30/2022

Antero Resources
Well No. Eckleberry 2H
BHL MOD
 Antero Resources Corporation

Page 1 of 2



Proposed Well No. Eckleberry Unit 2H
 Conc. Mons.
 L1
 L2
 L3

Well Location References (NTS)

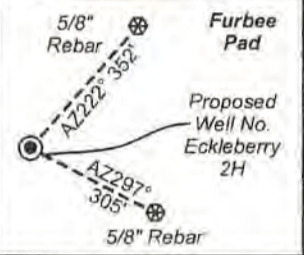

I, the undersigned, hereby certify that this plat is correct to the best of my knowledge and belief and shows all the information required by law and the rules issued and prescribed by the Department of Environmental Protection.

Bradley D. Miller
 Bradley D. Miller, P.S. 2167



	Bearing	Dist.
L1	S 76°07' W	1,921.2'
L2	N 82°15' W	2,102.6'
L3	N 73°51' E	1,559.4'
L4	N 79°07' E	1,559.2'
L5	N 75°57' E	3,375.2'

- Legend**
- Proposed gas well
 - ⊙ Monument, as noted
 - ⊛ Existing Well, as noted
 - ⊛ Digitized Well, as noted
 - Creek or Drain
 - Road
 - Railroad Right-of-Way
 - Surface boundary (approx.)
 - Interior surface tracts (approx.)

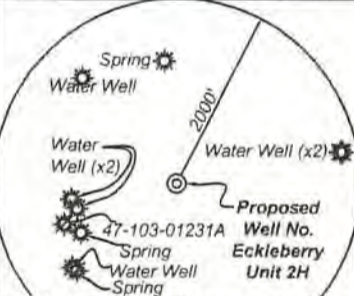

Note: 6 water wells and 3 springs were found within 2000' of proposed well. No occupied dwellings or buildings 2,500 square feet or larger used to house or shelter dairy cattle or poultry husbandry are located within 625' of the center of the well pad.

FILE NO: 120-34-G-18
 DRAWING NO: Eckleberry Unit 2H Well Plat
 SCALE: 1" = 2000'
 MINIMUM DEGREE OF ACCURACY: Submeter
 PROVEN SOURCE OF ELEVATION: WVDOT, Harrisville, WV

STATE OF WEST VIRGINIA
 DEPARTMENT OF ENVIRONMENTAL PROTECTION
OIL AND GAS DIVISION

DATE: August 9 20 22
 OPERATOR'S WELL NO. Eckleberry Unit 2H
 API WELL NO
 47 - 103 - 03493
 STATE COUNTY PERMIT

WELL TYPE: OIL GAS LIQUID INJECTION WASTE DISPOSAL
 (IF GAS) PRODUCTION: STORAGE DEEP SHALLOW

LOCATION: ELEVATION: Existing 1240' Proposed 1212' WATERSHED: Fishing Creek QUADRANGLE: Pine Grove 264.75; 100;
 DISTRICT: Green James COUNTY: Wetzel 58.1; 83.8; 14.89;
 SURFACE OWNER: A. Sell Robert G. Bassett, et ux; Josephine Brast, et al; Israel Miller, et ux; 25.6; 9.50; 22.4
 ROYALTY OWNER: James Allen Sell, Marilyn Halley Seeley, Linda Darlene Straight, Marcella K. Harrison; LEASE NO: ACREAGE: 58.1 109.83125; 140.3333;
 PROPOSED WORK: DRILL CONVERT DRILL DEEPER FRACTURE OR STIMULATE PLUG OFF OLD FORMATION
 PERFORATE NEW FORMATION OTHER PHYSICAL CHANGE IN WELL (SPECIFY) BHL_MOD ESTIMATED DEPTH: 29,100' MD
 PLUG AND ABANDON CLEAN OUT AND REPLUG TARGET FORMATION: Marcellus Shale 7,600' TVD

WELL OPERATOR: Antero Resources Corporation DESIGNATED AGENT: Dianna Stamper - CT Corporation System
 ADDRESS: 1615 Wynkoop Street ADDRESS: 5400 D Big Tyler Road
 Denver, CO 80202 Charleston, WV 25313

6,524' to Top Hole
 9,507' to Bottom Hole
 TOP HOLE LATITUDE 39 - 35 - 00
 BTM HOLE LATITUDE 39 - 32 - 30
Notes
 West Virginia Coordinate System of 1927, North Zone
 based upon Differential GPS Measurements.
 Well No. Eckleberry Unit 2H Top Hole coordinates are
 N: 387,463.73' Latitude: 39°33'26.21"
 E: 1,652,791.57' Longitude: 80°43'53.30"
 Bottom Hole coordinates are
 N: 371,957.91' Latitude: 39°30'54.11"
 E: 1,661,355.59' Longitude: 80°42'01.32"
 UTM Zone 17, NAD 1983
 Top Hole Coordinates Bottom Hole Coordinates
 N: 4,378,664.953m N: 4,373,984.589m
 E: 523,084.160m E: 525,771.958m
 Plat orientation and corner and well references are based upon the grid north meridian.
 Well location references are based upon the magnetic meridian.

Notes
 Well No. Eckleberry Unit 2H
 UTM Zone 17, NAD 1927
 Top Hole Coordinates
 N: 14,364,954.42'
 E: 1,716,103.67'
 Point of Entry Coordinates
 N: 14,365,827.66'
 E: 1,719,362.77'
 Bottom Hole Coordinates
 N: 14,349,598.83'
 E: 1,724,922.34'

Wellhead Layout (NTS)
 Proposed Well
 Eckleberry 2H
 47-103-03493
 Eckleberry 1H
 47-103-03492
 Reader 2H
 47-103-03497
 Reader 1H
 47-103-03496
 Lenny 2H
 47-103-03495
 Lenny 1H
 47-103-03494

226 9-22-22



ID	TM-Par	Owner	Bk/Pg	Acres
1	17-12	James Allen Sell	370/148	58.10
2	17-60	Ross Bucher	411/765	79.00
3	17-1	James Allen Sell	370/148	15.35
4	13-71	Charles R. & Kay L. Blair	387/577	63.11
5	17-71.1	Clarence L. & Carol J. Lancaster	387/266	19.19
6	17-3.1	Bradford D. Highley	386/607	1.00
7	17-2	Clarence & Carol Lancaster	287/357	0.50
8	17-3	Bradford Highley	386/607	17.00
9	17-4	James Straight	223/193	10.80
10	13-73	James Straight, et al	W57/427	14.60
11	13-74	Linda D. Straight	W67/427	0.29
12	13-65.4	Raye Anne Lloyd	445/660	2.99
13	13-65	Raye Anne Lloyd	445/660	18.01
14	13-78	Sebastian, Jr. & Marcella Harrison	281/94	25.37
15	17-5	Coastal Forest Resources	444/105	90.00
16	17-20	Heartland Forest Land Fund VII LP	431/936	123.50
17	17-19	Donna Bassett	299/614	19.10
18	17-29	Leslie & Georgia Bassett	319/394	66.00
19	17-31	Heartland Forest Land Fund VII,LP	431/936	120.33
20	17-40	Heartland Forest Land Fund VII,LP	431/936	120.00
21	17-49	Heartland Forest Land Fund VII, LP	431/936	20.90
22	17-50	EIP III, West Virginia LLC	463/193	69.00
23	20-14	Robert Bassett	371/32	126.74
24	20-46	Sara Ruth Cool & Peggy Ann Dawson Supplemental Needs Trust	471/207	107.10
25	20-14.4	Matthew D. Bassett, et al	421/365	97.18
26	20-14.2	Coastal Forest Resources Co.	444/105	37.40
27	20-14.1	Coastal Forest Resources Co.	444/105	49.25
28	20-15	Coastal Forest Resources Co.	444/105	198.00
29	20-21	Coastal Forest Resources Co.	444/105	29.00
30	20-37	Coastal Forest Resources Co.	444/105	246.84
31	20-37.1	Douglas & Debra Williams	472/115	6.26
32	21-15	Douglas & Debra Williams	385/159	57.06
33	20-49	Douglas & Debra Williams	472/115	2.00
34	23-1	Israel Miller Estate	417/744	100.00

Leases	
A	James Allen Sell
B	William R. Stalnaker
C	Marilyn Halley Seeley
D	Tribune Resources Minerals, LLC
E	Linda Darlene Straight
F	Marcella K. Harrison
G	Tribune Resources Minerals, LLC
H	Shiben Estates, Inc.
I	AMP Fund II, LP
J	Thomas Cunningham, et ux
K	Tribune Resources Minerals, LLC
L	Robert G. Bassett, et ux
M	Tribune Resources Minerals, LLC
N	Shiben Estates, Inc.
O	Josephine Brast, et al
P	Shiben Estates, Inc.
Q	Israel Miller, et ux

FILE NO: 120-34-G-18
 DRAWING NO: Eckleberry Unit 2H Well Plat
 SCALE: 1" = 2000'
 MINIMUM DEGREE OF ACCURACY:
 Submeter
 PROVEN SOURCE OF ELEVATION:
 WVDOT, Harrisville, WV

STATE OF WEST VIRGINIA
 DEPARTMENT OF ENVIRONMENTAL PROTECTION
OIL AND GAS DIVISION

DATE: August 9 20 22
 OPERATOR'S WELL NO, Eckleberry Unit 2H
 API WELL NO
 47 - 103 - 03493
 STATE COUNTY PERMIT

WELL TYPE: OIL GAS LIQUID INJECTION WASTE DISPOSAL
 (IF GAS) PRODUCTION: STORAGE DEEP SHALLOW
 Proposed 1212'
 LOCATION: ELEVATION: Existing 1240' WATERSHED: Fishing Creek QUADRANGLE: Pine Grove
 DISTRICT: Green James COUNTY: Wetzel 264.75; 100-
 SURFACE OWNER: A. Sell Robert G. Bassett, et ux; Josephine Brast, et al; Israel Miller, et ux; 25.6; 75; 500; 123.5;
 ROYALTY OWNER: James Allen Sell; Marilyn Halley Seeley; Linda Darlene Straight; Marcella K. Harrison; LEASE NO: ACREAGE: 58.1 109.83125; 140.3333;
 PROPOSED WORK: DRILL CONVERT DRILL DEEPER FRACTURE OR STIMULATE PLUG OFF OLD FORMATION
 PERFORATE NEW FORMATION OTHER PHYSICAL CHANGE IN WELL (SPECIFY) BHL_MOD 7,600' TVD
 PLUG AND ABANDON CLEAN OUT AND REPLUG TARGET FORMATION: Marcellus Shale ESTIMATED DEPTH: 29,100' MD

WELL OPERATOR: Antero Resources Corporation DESIGNATED AGENT: Dianna Stamper - CT Corporation System
 ADDRESS: 1615 Wynkoop Street ADDRESS: 5400 D Big Tyler Road
 Denver, CO 80202 Charleston, WV 25313

WW-6A1

Operator's Well Number Eckleberry Unit 2H MOD

INFORMATION SUPPLIED UNDER WEST VIRGINIA CODE
Chapter 22, Article 6A, Section 5(a)(5)
IN LIEU OF FILING LEASE(S) AND OTHER CONTINUING CONTRACT(S)

Under the oath required to make the verification on page 1 of this Notice and Application, I depose and say that I am the person who signed the Notice and Application for the Applicant, and that –

- (1) the tract of land is the same tract described in this Application, partly or wholly depicted in the accompanying plat, and described in the Construction and Reclamation Plan;
- (2) the parties and recordation data (if recorded) for lease(s) or other continuing contract(s) by which the Applicant claims the right to extract, produce or market the oil or gas are as follows:

Grantor, lessor, etc.	Grantee, lessee, etc.	Royalty	Book/Page
<u>A: James Allen Sell Lease</u> James Allen Sell	Antero Resources Corporation	1/8+	258A/0467
<u>C: Marilyn Halley Seeley Lease</u> Marilyn Halley Seeley EQT Production Company	EQT Production Company Antero Resources Corporation	1/8 Assignment	148A/0831 230A/0801
<u>D: Tribune Resources Minerals, LLC Lease</u> Tribune Resources Minerals, LLC Tribune Resources, LLC	Tribune Resources, LLC Antero Resources Corporation	1/8 Assignment	218A/0791 219A/0322
<u>E: Linda Darlene Straight Lease</u> Linda Darlene Straight	Antero Resources Corporation	1/8+	179A/0867
<u>F: Marcella K. Harrison Lease</u> Marcella K. Harrison	Antero Resources Corporation	1/8+	274A/0761
<u>G: Tribune Resources Minerals, LLC Lease</u> Tribune Resources Minerals, LLC	Antero Resources Corporation	1/8+	248a/0634
<u>H: Shiben Estates, Inc Lease</u> Shiben Estates, Inc.	Antero Resources Corporation	1/8+	202A/0238
<u>I: AMP Fund II, LP Lease</u> AMP Fund II, LP	Antero Resources Corporation	1/8+	255A/0685
<u>L: Robert G. Bassett, et ux Lease</u> Robert G. Bassett, et ux	Antero Resources Corporation	1/8+	212A/0094
<u>M: Tribune Resources Minerals, LLC Lease</u> Tribune Resources Minerals, LLC Tribune Resources, LLC	Tribune Resources, LLC Antero Resources Corporation	1/8+ Assignment	218A/0803 219A/0322
<u>O: Josephine Brast, et al Lease</u> Josephine Brast, et al South Penn Oil Co. Hope Natural Gas Company Consolidated Gas Supply Corporation Consolidated Gas Transmission Corporation CNG Transmission Corporation Eastern States Oil & Gas Inc Equitable Production-Eastern States Inc Equitable Production Company EQT Production Company	South Penn Oil Co. Hope Natural Gas Company Consolidated Gas Supply Corporation Consolidated Gas Transmission Corporation CNG Transmission Corporation Eastern States Oil & Gas Inc Equitable Production-Eastern States Inc Equitable Production Company EQT Production Company Tribune Resources, LLC	1/8 Assignment Assignment Assignment Name Change Assignment Name Change Merger Name Change Assignment	0049/0591 009A/0230 0233/0387 066A/0069 0013/0151 076A/0232 0013/0014 0013/0014 0013/0014 0013/0014 079A/0693

09/30/2022

WW-6A1

Operator's Well Number Eckleberry Unit 2H MOD

INFORMATION SUPPLIED UNDER WEST VIRGINIA CODE
Chapter 22, Article 6A, Section 5(a)(5)
IN LIEU OF FILING LEASE(S) AND OTHER CONTINUING CONTRACT(S)

Under the oath required to make the verification on page 1 of this Notice and Application, I depose and say that I am the person who signed the Notice and Application for the Applicant, and that –

(1) the tract of land is the same tract described in this Application, partly or wholly depicted in the accompanying plat, and described in the Construction and Reclamation Plan;

(2) the parties and recordation data (if recorded) for lease(s) or other continuing contract(s) by which the Applicant claims the right to extract, produce or market the oil or gas are as follows:

Grantor, lessor, etc.	Grantee, lessee, etc.	Royalty	Book/Page
Tribune Resources, LLC	Antero Resources Corporation	Assignment	219A/0322
<u>N: Shibden Estates, Inc. Lease</u> Shibden Estates, Inc.	Antero Resources Corporation	1/8+	198A/0540
<u>O: Josephine Brast, et al Lease</u> Josephine Brast, et al South Penn Oil Co. Hope Natural Gas Company Consolidated Gas Supply Corporation Consolidated Gas Transmission Corporation CNG Transmission Corporation Eastern States Oil & Gas Inc Equitable Production-Eastern States Inc Equitable Production Company	South Penn Oil Co. Hope Natural Gas Company Consolidated Gas Supply Corporation Consolidated Gas Transmission Corporation CNG Transmission Corporation Eastern States Oil & Gas Inc Equitable Production-Eastern States Inc Equitable Production Company EQT Production Company	1/8 Assignment Assignment Assignment Name Change Assignment Name Change Merger Name Change	0049/0591 009A/0230 0233/0387 066A/0069 0013/0151 076A/0232 0013/0014 0013/0014 0013/0014
<u>P: Shibden Estates, Inc. Lease</u> Shibden Estates, Inc.	Antero Resources Corporation	1/8+	198A/0540

WW-6A1
(5/13)

Operator's Well No. Eckleberry Unit 2H MOD

**INFORMATION SUPPLIED UNDER WEST VIRGINIA CODE
Chapter 22, Article 6A, Section 5(a)(5)
IN LIEU OF FILING LEASE(S) AND OTHER CONTINUING CONTRACT(S)**

Under the oath required to make the verification on page 1 of this Notice and Application, I depose and say that I am the person who signed the Notice and Application for the Applicant, and that –

- (1) the tract of land is the same tract described in this Application, partly or wholly depicted in the accompanying plat, and described in the Construction and Reclamation Plan;
- (2) the parties and recordation data (if recorded) for lease(s) or other continuing contract(s) by which the Applicant claims the right to extract, produce or market the oil or gas are as follows:

Lease Name or Number	Grantor, Lessor, etc.	Grantee, Lessee, etc.	Royalty	Book/Page
Q: Israel Miller, et ux Lease				
	Israel Miller, et al	South Penn Oil Co.	1/8	0049/052
	South Penn Oil Co.	Hope Natural Gas Company	Assignment	009A/0230
	Hope Natural Gas Company	Consolidated Gas Supply Corporation	Assignment	0233/0387
	Consolidated Gas Supply Corporation	Consolidated Gas Transmission Corporation	Assignment	066A/0069
	Consolidated Gas Transmission Corporation	CNG Transmission Corporation	Name Change	0013/0151
	CNG Transmission Corporation	Eastern States Oil & Gas Inc	Assignment	076A/0232
	Eastern States Oil & Gas Inc	Equitable Production-Eastern States Inc	Name Change	0013/0014
	Equitable Production-Eastern States Inc	Equitable Production Company	Merger	0013/0014
	Equitable Production Company	EQT Production Company	Name Change	0013/0014
	EQT Production Company	Tribune Resources, LLC	Assignment	179A/0653
	Tribune Resources, LLC	Antero Resources Corporation	Permission to Permit	Attached

*Partial Assignments to Antero Resources Corporation include 100% rights to extract, produce and market the oil and gas from the Marcellus and any other formations completed with this well.

- WV Division of Water and Waste Management
- WV Division of Natural Resources WV Division of Highways
- U.S. Army Corps of Engineers
- U.S. Fish and Wildlife Service
- County Floodplain Coordinator

RECEIVED
Office of Oil and Gas

SEP 7 2022

WV Department of
Environmental Protection

The applicant further acknowledges that any Office of Oil and Gas permit in no way overrides, replaces, or nullifies the need for other permits/approvals that may be necessary and further affirms that all needed permits/approvals should be acquired from the appropriate authority before the affected activity is initiated.

Well Operator: Antero Resources Corporation
 By: Tim Rady
 Its: Senior Vice President - Land

Execution Version

September 1, 2022

Mike Lipari
Tribune Resources, LLC
Tribune Resources Minerals, LLC
3861 Ambassador Caffery Parkway, Suite 600
Lafayette, Louisiana 70503

RE: Permission to Permit and Drill

Wetzel County, West Virginia

Dear Mr. Lipari,

Antero Resources Corporation ("**Antero**") hereby requests permission from Tribune Resources, LLC ("**Tribune Resources**") and Tribune Resources Minerals, LLC ("**Tribune Minerals**," and together with Tribune Resources, "**Tribune**") to proceed with Antero's plans to drill one or more horizontal wells in, under, and through certain properties subject to oil and gas interests owned or controlled by Tribune located in Wetzel County, West Virginia, as more particularly described on Exhibit A to this letter agreement (the "**O&G Interests**"), and insofar and only insofar as such O&G Interests are located within the Units as more particularly described on Exhibit B (the "**Units**") and further insofar and only insofar as to the Marcellus Leasehold Rights (the "**Properties**"), pursuant to the terms and conditions of this letter agreement. Antero and Tribune are currently parties to an Acreage Trade Agreement dated December 20, 2021 (as amended from time to time, the "**Trade Agreement**"), which includes the Properties. Capitalized terms not otherwise defined herein shall have the meanings ascribed to them in the Trade Agreement.

In order to generate mutual goodwill between Tribune and Antero, and for one hundred dollars (\$100.00) and other good and valuable consideration, the receipt and sufficiency of which are hereby acknowledged, subject to the terms and conditions of this letter agreement and the Trade Agreement, Tribune hereby grants Antero the right to apply for and obtain all applicable governmental permits for the drilling of one or more wellbore laterals in, under, and through the Properties (collectively, "**Wells**") and to drill, complete and produce such Wells.

Antero hereby agrees to release, protect, indemnify, defend and hold harmless Tribune from and against any claims, expenses, damages, injuries, claims or obligations or liabilities (including reasonable attorneys' fees) that may be brought by any third party against Tribune or its Affiliates to the extent arising out of Antero's drilling or other operations pursuant to this letter agreement and that arise on or after the date of this letter agreement through the Expiration Date (as defined below). This paragraph shall survive (a) the Closing and the assignment or lease, as applicable, related to the Properties, or (b) any termination of all or any part of this letter agreement.

RECEIVED
Office of Oil and Gas

SEP 7 2022

WV Department of
Environmental Protection

09/30/2022

Nothing in this letter agreement will diminish any current or future rights of Tribune in the Properties or other properties. This letter agreement and the rights and obligations of Tribune and Antero hereunder will terminate (on a Property-by-Property basis) upon the earliest of (I) if and when Antero and Tribune consummate the Closing of the Trade Agreement with respect to such Property and (II) the date this letter agreement terminates with respect to such Property as provided in the Trade Agreement. ("*Expiration Date*").

If the above meets your approval, please execute in the space provided below and return one signed copy to the letterhead address. Should you have any questions, please contact Jared Hurst at (303) 357-6835.

[*Signature Pages Follow.*]

RECEIVED
Office of Oil and Gas

SEP 7 2022

WV Department of
Environmental Protection

Sincerely,

ANTERO RESOURCES CORPORATION

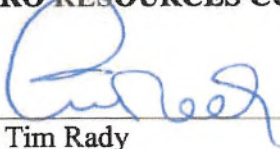
By:  _____ JcH
Name: Tim Rady
Title: Senior Vice President - Land

RECEIVED
Office of Oil and Gas
SEP 7 2022
WV Department of
Environmental Protection

AGREED TO AND ACCEPTED:

TRIBUNE RESOURCES, LLC

By: 
Name: Richard G. Zepernick, Jr.
Title: President & CEO

TRIBUNE RESOURCES MINERALS, LLC

By: 
Name: Richard G. Zepernick, Jr.
Title: President & CEO

RECEIVED
Office of Oil and Gas
SEP 7 2022
WV Department of
Environmental Protection

47 10 303493

**EXHIBIT A
PROPERTIES**

[See attached.]

RECEIVED
Office of Oil and Gas
SEP 7 2022
WV Department of
Environmental Protection

Exhibit A

Lessor	Lessee	Lease Date	Lease Gross Acres	State	County	District	Book	Page	TMP
Israel Miller and Elizabeth Miller, his wife	South Penn Oil	9/1/1896	100.00000	WV	Wetzel	Center	49	32	5-23-1
Shiben Estates, Inc.	Antero Resources Corporation	10/17/2017	264.75000	WV	Wetzel	Center	198A	540	p/o 5-20-37, 5-20-37.1
Josephine Brast, et al	South Penn Oil	12/15/1896	300.00000	WV	Wetzel	Green	49	591	p/o 5-20-37
M. A. Brast	South Penn Oil	6/18/1897	300.00000	WV	Wetzel	Green	53	204	p/o 5-20-37

RECEIVED
 Office of Oil and Gas
 SEP 7 2022
 WV Department of
 Environmental Protection

4710303493

**EXHIBIT B
UNITS**

Operator	Unit Name	Pooling Declaration (Book/Page)
Antero Resources Corporation	Eckleberry Unit	289A/51

RECEIVED
Office of Oil and Gas

SEP 7 2022

WV Department of
Environmental Protection



Stansberry, Wade A <wade.a.stansberry@wv.gov>

Modification Horizontal H6A Well Work Permits API: (47-103-03493)

1 message

Stansberry, Wade A <wade.a.stansberry@wv.gov>

Mon, Sep 26, 2022 at 3:10 PM

To: Mallory Stanton <mstanton@anteroresources.com>, Diane Blair <dblair@anteroresources.com>, Dani DeVito <ddevito@shalepro.com>, "Greynolds, Kenneth L" <kenneth.l.greynolds@wv.gov>, "Blevins, Cragin" <cragin.blevins@wv.gov>

I have attached a copy of the newly issued well [permit](#) numbers:

47-103-03493 - ECKLEBERRY 2H

These will serve as your copy.

Thank you,

Wade A. Stansberry

Environmental Resource Specialist 3

West Virginia Department of Environmental Protection

Office of Oil & Gas

601 57th St. SE

Charleston, WV 25304

(304) 926-0499 ext. 41115

(304) 926-0452 fax

Wade.A.Stansberry@wv.gov

2 attachments

 **IR-26 Blank.pdf**
169K

 **47-103-03493 - Copy.pdf**
1432K

09/30/2022