

State of West Virginia  
Department of Environmental Protection - Office of Oil and Gas  
Well Operator's Report of Well Work

RECEIVED  
Office Of Oil and Gas

OCT 02 2024

WV Department of  
Environmental Protection

API 47-103-03536 County Wetzel District Proctor  
Quad Glen Easton 7.5' Pad Name Elmer Field/Pool Name N/A  
Farm name Elnora Tuttle HRS. Well Number Elmer N-15HU-RD (L027979)  
Operator (as registered with the OOG) EQT Production Company  
Address 400 Woodcliff Drive City Canonsburg State PA Zip 15317

As Drilled location NAD 83/UTM Attach an as-drilled plat, profile view, and deviation survey  
Top hole Northing 4,393,814.39 Easting 522,496.06  
Landing Point of Curve Northing 4,393,793.27 Easting 522,180.25  
Bottom Hole Northing 4,398,238.93 Easting 519,603.94

Elevation (ft) 1277' GL Type of Well  New  Existing Type of Report  Interim  Final  
Permit Type  Deviated  Horizontal  Horizontal 6A  Vertical Depth Type  Deep  Shallow  
Type of Operation  Convert  Deepen  Drill  Plug Back  Redrilling  Rework  Stimulate  
Well Type  Brine Disposal  CBM  Gas  Oil  Secondary Recovery  Solution Mining  Storage  Other \_\_\_\_\_  
Type of Completion  Single  Multiple Fluids Produced  Brine  Gas  NGL  Oil  Other \_\_\_\_\_  
Drilled with  Cable  Rotary

Drilling Media Surface hole  Air  Mud  Fresh Water Intermediate hole  Air  Mud  Fresh Water  Brine  
Production hole  Air  Mud  Fresh Water  Brine

Mud Type(s) and Additive(s)

Synthetic Oil Based Mud 14.57 ppg barium sulfate, sodium chloride, xanthan gum, polyanionic cellulose, modified starch, sodium hydroxide, phosphonates and alkyl phosphates, glutaraldehyde solution, calcium hydroxide, partially hydrolyzed polyacrylamide/polyacrylate, potassium chloride, sodium carbonate, ground walnut shells, alcohol and modified fatty acid, ferrochrome lignosulfonate, calcium carbonate, fibrous cellulose

Date permit issued 10/24/2022 Date drilling commenced 10/24/2022 Date drilling ceased 11/14/2023  
Date completion activities began 05/11/2024 Date completion activities ceased 07/03/2024  
Verbal plugging (Y/N) N Date permission granted N/A Granted by N/A

Please note: Operator is required to submit a plugging application within 5 days of verbal permission to plug

Freshwater depth(s) ft 1003' Open mine(s) (Y/N) depths N  
Salt water depth(s) ft 2097' Void(s) encountered (Y/N) depths N  
Coal depth(s) ft 563', 906', 999' Cavern(s) encountered (Y/N) depths N  
Is coal being mined in area (Y/N) N

Reviewed by: [Signature]  
11/13/2024  
12/13/2024

API 47-103 - 03536 Farm name Elnora Tuttle HRS. Well number Elmer N-15HU-RD (L027979)

CASING STRINGS	Hole Size	Casing Size	Depth (GL)	New or Used	Grade wt/ft	Basket Depth(s) (GL)	Did cement circulate (Y/N) * Provide details below*
Conductor	38", 36"	30"	120'	NEW	A-500 118.65#	N/A	Y
Surface	26"	20"	1108'	NEW	J-55 106.5#	N/A	Y
Coal							
Intermediate 1	17-1/2"	13-3/8"	2930'	NEW	J-55 54.5#	N/A	Y
Intermediate 2	12-3/8"; 12-1/4"	9-5/8"	10,573'	NEW	P-110-IC 47#	N/A	Y
Intermediate 3							
Production	8-1/2"	5-1/2"	29,102'	NEW	P-110 23#	N/A	N
Tubing							
Packer type and depth set							

Comment Details Production cmt has calculated TOC of 4392'GL, which is greater than 500'TVD above the producing formation. No issues during cement job.

CEMENT DATA	Class/Type of Cement	Number of Sacks	Slurry wt (ppg)	Yield (ft <sup>3</sup> /sks)	Volume (ft <sup>3</sup> )	Cement Top (GL)	WOC (hrs)
Conductor	CLASS A	382	15.6	1.21	462	0	8+
Surface	CLASS A	2050	15.6	1.18	2419	0	8
Coal							
Intermediate 1	CLASS A	2236	15.6	1.18	2638	0	8
Intermediate 2	CLASS A	4027	14.5	1.33	5356	0	8
Intermediate 3							
Production	CLASS A	5515	17.0	1.05	5791	4392'	8+
Tubing							

Drillers TD (ft) 29,133' Loggers TD (ft) N/A  
Deepest formation penetrated POINT PLEASANT Plug back to (ft) N/A

Plug back procedure 10/15/2022: Run in the hole with 1 jt of drill pipe and install top entry pump sub into drill pipe; Mix and pump 488 bbls (2,266 sks) of class A cement for the 1st stage pf plug back. Mix and pump 300 bbls (1,680 sks) of class A cement for the 2nd stage pf plug back; Pump 63 bbls Class A Cement to Surface No U Tube

Kick off depth (ft) 4,410'

Check all wireline logs run  caliper  density  deviated/directional  induction  
 neutron  resistivity  gamma ray  temperature

Well cored  Yes  No  Conventional  Sidewall Were cuttings collected  Yes  No

DESCRIBE THE CENTRALIZER PLACEMENT USED FOR EACH CASING STRING \_\_\_\_\_

CONDUCTOR- NONE \_\_\_\_\_

SURFACE- ON SHOE TRACK AND EVERY 500' TO SURFACE \_\_\_\_\_

INTERMEDIATE: ON SHOE TRACK AND EVERY 500' FEET TO SURFACE \_\_\_\_\_

PRODUCTION: ON SHOE TRACK AND EVERY OTHER JOINT TO 12,265', EVERY JOINT TO 10,670' AND EVERY OTHER JOINT TO 19' \_\_\_\_\_

WAS WELL COMPLETED AS SHOT HOLE  Yes  No DETAILS \_\_\_\_\_

WAS WELL COMPLETED OPEN HOLE?  Yes  No DETAILS \_\_\_\_\_

WERE TRACERS USED  Yes  No TYPE OF TRACER(S) USED \_\_\_\_\_

RECEIVED  
Office Of Oil and Gas  
OCT 02 2024  
sonic  
Department of Environmental Protection

12/13/2024

API 47- 103 - 03536 Farm name Elnora Tuttle HRS. Well number Elmer N-15HU-RD (L027979)

**PERFORATION RECORD**

Stage No.	Perforation date	Perforated from MD ft.	Perforated to MD ft.	Number of Perforations	Formation(s)
	<b>See Attached</b>				

RECEIVED  
Office Of Oil and Gas  
**OCT 02 2024**  
WV Department of  
Environmental Protection

Please insert additional pages as applicable.

**STIMULATION INFORMATION PER STAGE**

Complete a separate record for each stimulation stage.

Stage No.	Stimulations Date	Ave Pump Rate (BPM)	Ave Treatment Pressure (PSI)	Max Breakdown Pressure (PSI)	ISIP (PSI)	Amount of Proppant (lbs)	Amount of Water (bbls)	Amount of Nitrogen/other (units)
	<b>See</b>	<b>Attached</b>						

Please insert additional pages as applicable.

12/13/2024 

API 47- 103 - 03536 Farm name Elnora Tuttle HRS. Well number Elmer N-15HU-RD (L027979)

PRODUCING FORMATION(S)

DEPTHS

<u>Utica</u>	<u>11,641-11,679</u> TVD	<u>12,014-23,133</u> MD
_____	_____	_____
_____	_____	_____
_____	_____	_____

RECEIVED  
Office Of Oil and Gas  
OCT 02 2024  
WV Department of  
Environmental Protection

Please insert additional pages as applicable.

GAS TEST  Build up  Drawdown  Open Flow OIL TEST  Flow  Pump

SHUT-IN PRESSURE Surface 7273 psi Bottom Hole \_\_\_\_\_ psi DURATION OF TEST 24 hrs

OPEN FLOW Gas 16332 mcfpd Oil 0 bpd NGL 0 bpd Water 599 bpd

GAS MEASURED BY  Estimated  Orifice  Pilot

LITHOLOGY/ FORMATION	TOP DEPTH IN FT	BOTTOM DEPTH IN FT	TOP DEPTH IN FT	BOTTOM DEPTH IN FT	DESCRIBE ROCK TYPE AND RECORD QUANTITY AND TYPE OF FLUID (FRESHWATER, BRINE, OIL, GAS, H <sub>2</sub> S, ETC)
	NAME TVD	TVD	MD	MD	

	<u>0</u>		<u>0</u>		

Please insert additional pages as applicable.

Drilling Contractor Nabors Drilling Technologies USA, INC.

Address 515 West Greens Road, Suite 1200 City Houston State TX Zip 77067

Logging Company Baker Hughes

Address 400 Technology Dr Suite 100 City Canonsburg State PA Zip 15317

Cementing Company Halliburton

Address 121 Champion Way Suite 110 City Canonsburg State PA Zip 15317

Cementing Company American Cementing

Address 1717 S Boulder Ave City Tulsa State OK Zip 74119

Please insert additional pages as applicable.

Completed by Jacob Caplan

Telephone 412-215-2723

Signature 

Title Mgr Completions Engr

Date 2024-09-20

12/13/2024 

API 47- 103 - 03536 Farm name Elnora Tuttle HRS. Well number Elmer N-15HU-RD (L027979)

Drilling Contractor Falcon (Rig 29)  
Address 1120 US-119 City Indiana State PA Zip 15701

Logging Company Nzone Guidance, LLC  
Address 140 Falcon Lane City Liberty Hill State TX Zip 78642

Logging Company \_\_\_\_\_  
Address \_\_\_\_\_ City \_\_\_\_\_ State \_\_\_\_\_ Zip \_\_\_\_\_

Drilling Contractor \_\_\_\_\_  
Address \_\_\_\_\_ City \_\_\_\_\_ State \_\_\_\_\_ Zip \_\_\_\_\_

RECEIVED  
Office Of Oil and Gas  
OCT 02 2024  
WV Department of  
Environmental Protection

# Perforation Data

RECEIVED  
Office of Oil and Gas  
OCT 02 2024  
WV Department of  
Environmental Protection

Stage No.	Perforation Date	Stage Perforated From TMD Ft.	Stage Perforated To TMD Ft.	# of Perforations/Stage	Formation(s)
2	05/11/2024	29009	28833	48	Utica
3	05/12/2024	28809	28633	48	Utica
4	05/12/2024	28609	28433	48	Utica
5	05/12/2024	28409	28233	48	Utica
6	05/12/2024	28209	28033	48	Utica
7	05/13/2024	28009	27833	48	Utica
8	05/14/2024	27809	27633	48	Utica
9	05/14/2024	27609	27433	48	Utica
10	05/16/2024	27409	27233	48	Utica
11	05/16/2024	27209	27033	48	Utica
12	05/17/2024	27009	26833	48	Utica
13	05/17/2024	26809	26633	48	Utica
14	05/18/2024	26609	26433	48	Utica
15	05/18/2024	26409	26233	48	Utica
16	05/18/2024	26209	26033	48	Utica
17	05/19/2024	26009	25833	48	Utica
18	05/19/2024	25809	25633	48	Utica
19	05/20/2024	25609	25433	48	Utica
20	05/20/2024	25409	25233	48	Utica
21	05/20/2024	25209	25033	48	Utica
22	05/21/2024	25009	24833	48	Utica
23	05/21/2024	24809	24633	48	Utica
24	05/22/2024	24609	24433	48	Utica
25	05/23/2024	24409	24233	48	Utica
26	05/23/2024	24209	24033	48	Utica
27	05/24/2024	24009	23833	48	Utica
28	05/24/2024	23809	23633	48	Utica
29	05/24/2024	23609	23433	48	Utica
30	05/24/2024	23409	23233	48	Utica
31	05/25/2024	23209	23033	48	Utica
32	05/26/2024	23009	22833	48	Utica
33	05/26/2024	22809	22633	48	Utica
34	05/26/2024	22609	22433	48	Utica
35	05/26/2024	22409	22233	48	Utica
36	05/27/2024	22209	22033	48	Utica
37	05/27/2024	22009	21833	48	Utica
38	05/27/2024	21809	21633	48	Utica
39	05/28/2024	21609	21433	48	Utica
40	05/28/2024	21409	21233	48	Utica
41	05/28/2024	21209	21033	48	Utica
42	05/28/2024	21009	20833	48	Utica
43	05/29/2024	20809	20633	48	Utica

RECEIVED  
Office Of Oil and Gas

OCT 02 2024

WV Department of  
Environmental Protection

12/13/2024



44	05/29/2024	20609	20433	48	Utica
45	05/29/2024	20409	20233	48	Utica
46	05/30/2024	20209	20033	48	Utica
47	05/30/2024	20009	19833	48	Utica
48	05/30/2024	19809	19633	48	Utica
49	05/31/2024	19609	19433	48	Utica
50	05/31/2024	19409	19233	48	Utica
51	05/31/2024	19209	19033	48	Utica
52	06/01/2024	19009	18833	48	Utica
53	06/01/2024	18809	18633	48	Utica
54	06/01/2024	18609	18433	48	Utica
55	06/01/2024	18409	18233	48	Utica
56	06/01/2024	18209	18033	48	Utica
57	06/02/2024	18009	17833	48	Utica
58	06/02/2024	17809	17633	48	Utica
59	06/02/2024	17609	17433	48	Utica
60	06/02/2024	17409	17233	48	Utica
61	06/02/2024	17209	17033	48	Utica
62	06/03/2024	17009	16833	48	Utica
63	06/03/2024	16809	16633	48	Utica
64	06/03/2024	16609	16433	48	Utica
65	06/03/2024	16409	16233	48	Utica
66	06/04/2024	16209	16033	48	Utica
67	06/04/2024	16009	15833	48	Utica
68	06/04/2024	15809	15633	48	Utica
69	06/05/2024	15609	15433	48	Utica
70	06/05/2024	15409	15233	48	Utica
71	06/05/2024	15209	15033	48	Utica
72	06/05/2024	15009	14833	48	Utica
73	06/06/2024	14809	14633	48	Utica
74	06/06/2024	14609	14433	48	Utica
75	06/06/2024	14409	14233	48	Utica
76	06/07/2024	14209	14033	48	Utica
77	06/07/2024	14009	13833	48	Utica
78	06/07/2024	13809	13633	48	Utica
79	06/07/2024	13609	13433	48	Utica
80	06/08/2024	13409	13233	48	Utica
81	06/08/2024	13209	13033	48	Utica
82	06/08/2024	13009	12833	48	Utica
83	06/08/2024	12809	12633	48	Utica
84	06/09/2024	12609	12433	48	Utica
85	06/09/2024	12409	12233	48	Utica
86	06/09/2024	12209	12083	36	Utica

RECEIVED  
Office Of Oil and Gas  
OCT 02 2024  
WV Department of  
Environmental Protection

12/13/2024



# Stimulation Data

RECEIVED  
Office Of Oil and Gas  
OCT 02 2024  
WV Department of  
Environmental Protection

12/13/2024

Stage #	Stimulation Date	Ave Pump Rate (BPM)	Ave Treatment Pressure (PSI)	Max Breakdown Pressure (PSI)	ISIP (PSI)	Amount of Proppant (lbs)	Amount of Water (bbls)	Amount of Nitrogen/other (units)
1	05/11/2024	82	11352	10529	7352	250015	6841.000	
2	05/12/2024	91	11516	8126	7590	500219	10137.000	
3	05/12/2024	89	11552	8075	7718	500258	11015.000	
4	05/12/2024	92	11677	8880	8418	500411	10243.000	
5	05/13/2024	88	11585	8334	8300	500457	10243.000	
6	05/13/2024	89	11553	8193	8539	500509	10936.000	
7	05/14/2024	90	11620	8254	8062	500115	10291.000	
8	05/14/2024	90	11592	8164	8160	500314	10659.000	
9	05/16/2024	90	11547	6060	7539	500455	10238.000	
10	05/16/2024	86	11629	8879	8150	500381	10287.000	
11	05/17/2024	88	11659	8015	7657	500359	10259.000	
12	05/18/2024	89	11622	8380	8118	501218	10249.000	
13	05/18/2024	93	11666	11589	7698	500177	10240.000	
14	05/18/2024	91	11552	7165	8059	500681	10176.000	
15	05/19/2024	95	11694	11295	7488	500300	10443.000	
16	05/19/2024	88	11533	6955	8361	500416	10410.000	
17	05/19/2024	90	11623	7382	8026	500435	10240.000	
18	05/20/2024	90	11611	8175	8052	500294	10328.000	
19	05/20/2024	92	11557	7758	7416	500335	10268.000	
20	05/20/2024	95	11402	11046	8206	100315	10336.000	
21	05/21/2024	86	11479	8610	7673	502157	10253.000	
22	05/21/2024	84	11402	6306	7771	500473	10175.000	
23	05/22/2024	88	11629	8894	7971	500624	10187.000	
24	05/22/2024	86	11597	7247	11598	500193	10181.000	
25	05/23/2024	88	11542	7378	8218	500085	10136.000	
26	05/24/2024	90	11767	8081	8430	500521	10180.000	
27	05/24/2024	90	11581	8184	8224	500161	10153.000	
28	05/24/2024	88	11672	7779	7935	501051	9554.000	
29	05/25/2024	90	11743	8084	8028	503625	10206.000	
30	05/25/2024	87	11546	9010	8063	500352	10120.000	
31	05/26/2024	91	11660	7826	8302	505291	10204.000	
32	05/26/2024	88	11665	8821	7684	500277	9534.000	
33	05/26/2024	86	11607	7362	8001	500371	10116.000	
34	05/27/2024	89	11625	8278	8174	500514	10086.000	
35	05/27/2024	87	11681	11440	7898	500309	9525.000	
36	05/27/2024	88	11591	8017	8187	500409	10037.000	
37	05/28/2024	89	11707	7457	8304	500461	10045.000	
38	05/28/2024	88	11641	10178	7998	500143	10078.000	
39	05/28/2024	89	11635	8668	7966	500186	10042.000	
40	05/28/2024	86	11639	8527	7826	500165	9989.000	
41	05/29/2024	88	11603	8897	8076	500217	10048.000	
42	05/29/2024	92	11648	8967	8399	500085	10042.000	

RECEIVED  
Office Of Oil and Gas  
OCT 02 2024  
WV Department of  
Environmental Protection

12/13/2024 

43	05/29/2024	88	11644	7959	8806	500218	10022.000
44	05/29/2024	85	11640	9486	8421	500434	9988.000
45	05/30/2024	84	11579	8748	8396	500364	9990.000
46	05/30/2024	87	11721	9309	8635	500058	10083.000
47	05/30/2024	90	11751	9754	8418	500109	9953.000
48	05/31/2024	92	11708	8140	8206	500494	9949.000
49	05/31/2024	91	11742	8194	8382	500657	9955.000
50	05/31/2024	89	11686	9555	8391	500154	9950.000
51	06/01/2024	90	11665	8633	8544	499993	10553.000
52	06/01/2024	89	11556	10404	8513	500062	10335.000
53	06/01/2024	91	11587	9965	8416	499967	9832.000
54	06/01/2024	96	11661	9248	8554	500213	9934.000
55	06/02/2024	90	11513	9291	8902	500193	9872.000
56	06/02/2024	92	11594	10250	8332	500357	9775.000
57	06/02/2024	95	11672	7930	8588	500183	9793.000
58	06/02/2024	95	11601	9123	8581	500246	9851.000
59	06/03/2024	92	11471	10017	8502	500300	9778.000
60	06/03/2024	90	11391	9702	8583	502345	9850.000
61	06/03/2024	95	11572	8893	8714	500167	9812.000
62	06/03/2024	95	11690	10346	8743	500104	9798.000
63	06/04/2024	89	11458	9550	8610	500183	9805.000
64	06/04/2024	89	11381	10342	8794	500613	9813.000
65	06/04/2024	94	11592	6073	8927	500109	9787.000
66	06/04/2024	91	11524	9025	8657	500034	9799.000
67	06/05/2024	90	11357	10771	8636	500334	9752.000
68	06/05/2024	87	11468	10847	8805	489790	9647.000
69	06/05/2024	95	11513	10871	8816	500164	9782.000
70	06/05/2024	94	11511	9537	8867	500300	9730.000
71	06/06/2024	90	11435	11016	8670	500014	9521.000
72	06/06/2024	90	11326	10124	8677	500580	9741.000
73	06/06/2024	90	11108	9658	9068	500069	9833.000
74	06/06/2024	95	11453	10801	8984	500546	9725.000
75	06/07/2024	94	11521	9818	8827	500715	9695.000
76	06/07/2024	95	11222	9204	8758	500464	9774.000
77	06/07/2024	94	11454	9589	8892	500458	9722.000
78	06/08/2024	92	11468	10798	8875	500000	9431.875
79	06/08/2024	96	11456	9142	8816	500469	9679.000
80	06/08/2024	92	11400	9246	8534	500143	9683.000
81	06/08/2024	95	11297	10712	8932	500027	9627.000
82	06/09/2024	96	11375	10130	8429	500408	9633.000
83	06/09/2024	94	11414	10849	9208	500448	9641.000
84	06/09/2024	95	11142	10208	8799	500619	9673.000
85	06/09/2024	93	11289	10723	8761	500499	9592.000
86	06/10/2024	93	11290	10742	8972	369602	7201.000

RECEIVED  
Office Of Oil and Gas  
OCT 02 2024  
WV Department of  
Environmental Protection

12/13/2024

ELMER LEASE WELL N-15HU 513.0901± ACRES

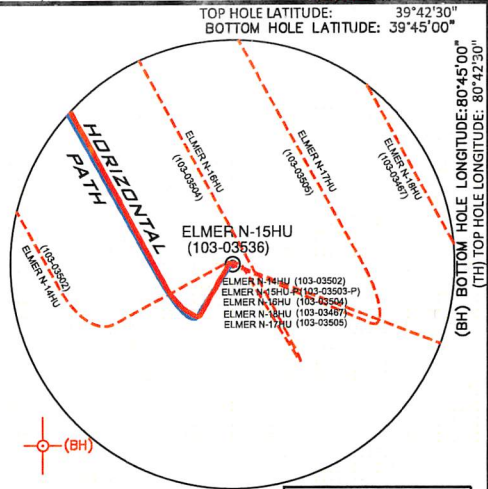
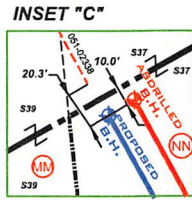
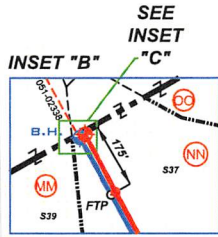

INSET "A"

NOTE: L.P. 1 and L.T.P. are same point.

(+) DENOTES LOCATION ON UNITED STATES TOPOGRAPHIC MAPS

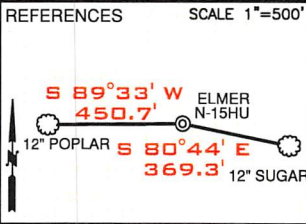
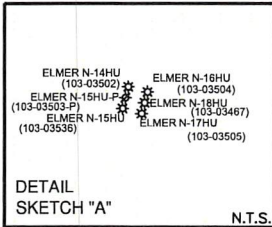

SURFACE HOLE UTM. NAD83, ZONE 17 IN METERS N) 4,393,814.39 E) 522,496.06

LANDING POINT 1 UTM. NAD83, ZONE 17 IN METERS N) 4,393,793.27 E) 522,180.25

Table with columns: CURVE, CHORD, BEARING, CHORD LENGTH, RADIUS, ARC LENGTH. Lists curves C1 through C4.

- NOTES: 1. BORE PATH BASED ON GRID NORTH. 2. NO WATER WELLS WITHIN 250' OF WELL WERE FOUND...

LEGEND: LEASE TRACTS, SURFACE TRACTS, WELL LATERAL, POINT PLEASANT LEGS, UNIT BOUNDARY, LEASE #, BORE PATH OFFSET, WELL BORE OFFSET, PROPOSED FIRST TAKE POINT, PROPOSED LAST TAKE POINT, FORCED POOL TRACT.

SURFACE HOLE UTM. NAD83, ZONE 17 IN METERS N) 4,393,814.39 E) 522,496.06

LANDING POINT 1 UTM. NAD83, ZONE 17 IN METERS N) 4,393,786.21 E) 522,184.25

BOTTOM HOLE UTM. NAD83, ZONE 17 IN METERS N) 4,398,236.31 E) 519,599.77

Table with columns: LINE, BEARING, DISTANCE. Lists lines L1 through L4.

FILE NUMBER, DRAWING NUMBER (ELMER\_N-15HU\_REV1), SCALE (1"=2000'), MINIMUM DEGREE OF ACCURACY (1/200), PROVEN SOURCE OF ELEVATION (SUBMETER MAPPING, GRADE GPS).

I, THE UNDERSIGNED, HEREBY CERTIFY THAT THIS PLAN IS CORRECT TO THE BEST OF MY KNOWLEDGE AND BELIEF AND SHOWS ALL THE INFORMATION REQUIRED BY LAW AND THE RULES ISSUED AND PRESCRIBED BY THE DEPARTMENT OF ENVIRONMENTAL PROTECTION

Signature of David L Jackson

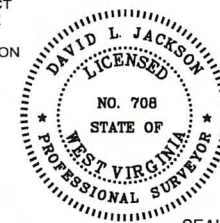

WVDEP OFFICE OF OIL & GAS 601 57TH STREET, SE CHARLESTON, WV 25304



JACKSON SURVEYING INC. P.O. Box 1460 Clarksburg, WV 26302 304-623-5851

DATE: NOVEMBER 20, 2023 OPERATORS WELL NO. ELMER N-15HU API WELL NO. 47-103-03536 STATE COUNTY PERMIT

LOCATION ELEVATION 1276.50' WATERSHED (HUC 10) PROCTOR CREEK OF FRENCH CREEK - OHIO RIVER (HUC-10) DISTRICT PROCTOR COUNTY WETZEL QUADRANGLE WILEYVILLE 7.5' LEASE NUMBER SEE WW-6A1 FORM

SURFACE OWNER ELMORA TUTTLE HRS ACREAGE 39.19 OIL & GAS ROYALTY OWNER HENRY & NANCY GARNER - SEE WW-6A1 LEASE ACREAGE 39.19 PROPOSED WORK: DRILL CONVERT DRILL DEEPER REDRILL FRACTURE OR STIMULATE PLUG OFF OLD FORMATION PERFORATE NEW FORMATION OTHER PHYSICAL CHANGE (SPECIFY) ASDRILLED

TARGET FORMATION POINT PLEASANT ESTIMATED DEPTH TVD: 11,712' TMD: 29,166'

WELL OPERATOR EQT PRODUCTION COMPANY DESIGNATED AGENT JOSEPH C. MALLOW ADDRESS 400 WOODCLIFF DRIVE CANONSBURG, PA 15317 ADDRESS 427 MIDSTATE DRIVE CLARKSBURG, WV 25301

12/13/2024

RECEIVED Office of Oil and Gas OCT 02 2024 WV Department of Environmental Protection

form: wwf6

# ELMER LEASE WELL N-15HU 513.0901± ACRES

**LEGEND**

- LEASE TRACTS
- SURFACE TRACTS
- WELL LATERAL
- POINT PLASANT LEGS
- UNIT BOUNDARY
- (A) LEASE # [SEE 6A1 FORM]
- 400' BORE PATH OFFSET
- 500' WELL BORE OFFSET
- (F)TP PROPOSED FIRST TAKE POINT
- (L)TP PROPOSED LAST TAKE POINT
- FORCED POOL TRACT

SCALE 1" = 2000'

--- ASDRILLED LEG  
--- PERMITTED LEG

Note: Tracts F & T are forced pooled tracts.

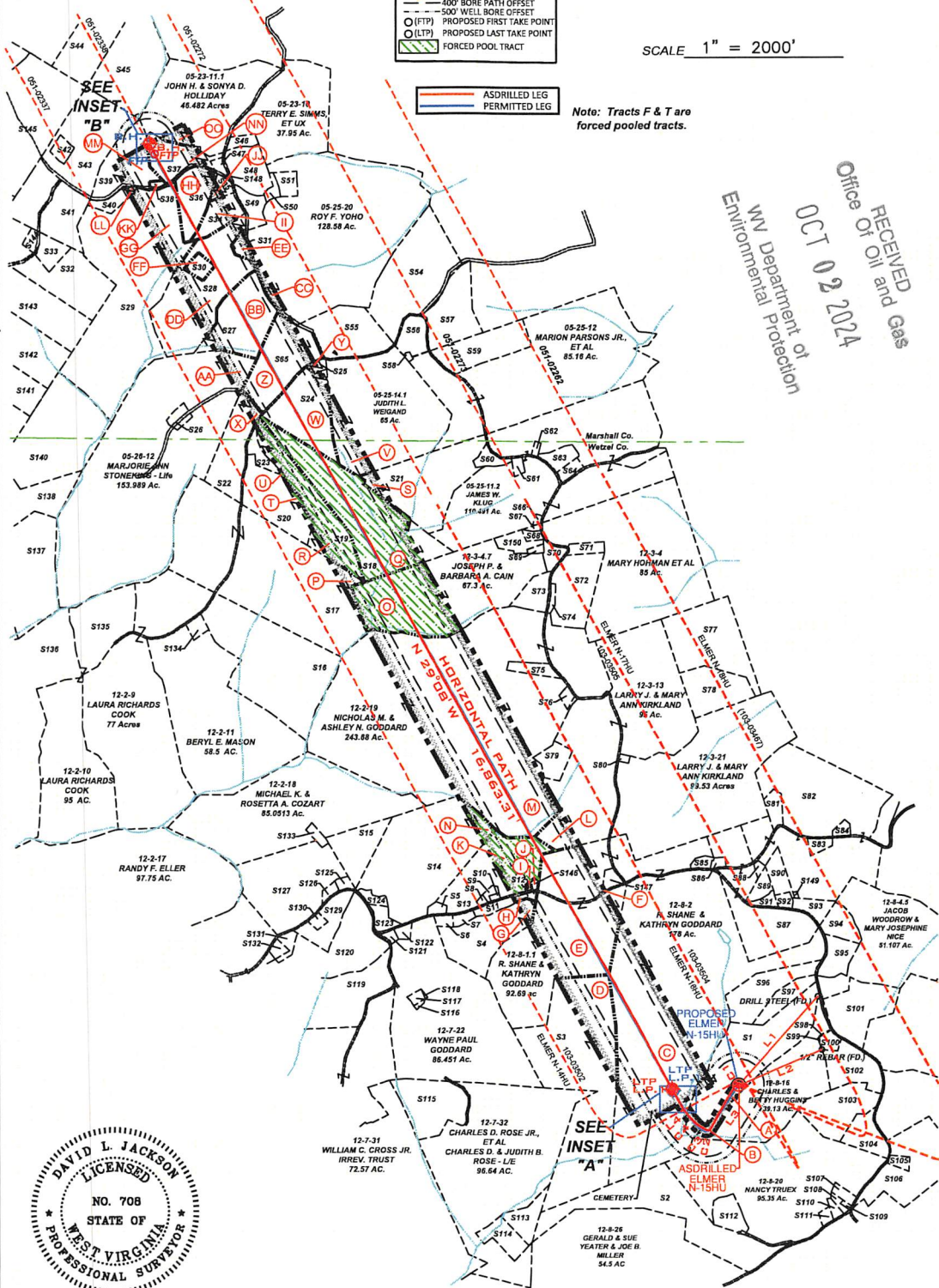

RECEIVED  
Office Of Oil and Gas  
OCT 02 2024  
WV Department of  
Environmental Protection



P.S. David L Jackson  
708

OPERATOR'S  
WELL #: ELMER N-15HU  
DISTRICT: Proctor  
COUNTY: Wetzel  
STATE: WV  
API #: 47-103-03536

WELL PLAT  
PAGE 2 OF 4  
DATE: 11/20/2023



12/13/2024

form wv6

**ELMER LEASE  
WELL N-15HU  
513.0901 ± ACRES**

\* FORCED POOLED TRACTS ARE HIGHLIGHTED

Tags	Number	Tax Map - Parcel	Surface Owner	Acres
A	S1	12-8-15	ELNORA TUTTLE HRS	39.19
	S2	12-8-20.5	JOE MILLER, GERALD & SUE YEATER	44.85
D	S3	12-8-1	R. SHANE & KATHRYN GODDARD	77
G	S4	12-7-13.1	WAYNE PAUL GODDARD	18
	S5	12-2-22.2	DAVID A. & MANDY L. TRUEX	1.186
	S6	12-7-11	JOSEPH R. VILLERS	1.5
	S7	12-7-12	JOSEPH R. VILLERS	1.6
	S8	12-2-23.4	SHARON HOWELL ET AL: GLORIA A. NICE - L/E	0.422
	S9	12-2-23.3	KENNETH W. GODDARD	0.766
	S10	12-2-23.1	KENNETH W. GODDARD	0.36
H	S11	12-3-26.1	JOSEPH MARK KLUG	3.242
I	S12	12-3-27	CATHY A. PURPURA	0.227
K	S13	12-2-23	DAVID A. NICE	21.7
N	S14	12-2-22.1	DAVID A. NICE	54.66
	S15	12-2-21	MICHAEL KENNETH & ROSETTA ANNETTE COZART	11.4
	S16	12-2-12	BERYL E. MASON	59.9
P	S17	12-2-13	JAY S. BOOTH; DANIEL T. BOOTH & DIANE BETH OVERDORFF	100
Q	S18	12-2-14	DAVID L. CUNNINGHAM	56.23
R	S19	12-2-14.2	JOHN G. JR & GERALD NE M. ROGERS	22.007
T	S20	12-2-14.1	SAMMY J. GREATHOUSE JR. : SAMMY J. GREATHOUSE SR. - L/E	18.67
S	S21	05-25-11.4	EDWARD W. KLUG, ETUX	32.787
X	S22	05-25-15	ROBERTS S. KELLER, ETAL	15.073
U	S23	12-2-14.3	QUEENNA BENNETT	3.093
W	S24	05-25-16.1	DAVID L. CUNNINGHAM	6.34
Y	S25	05-25-16.2	RODNEY I. LOY	1.087
	S26	05-26-12.1	ALVIN F. JR. & KRISTA R. STONEKING	2.011
BB	S27	05-25-17	CRAIG & ASHLEY FERRELL	22.79
DD	S28	05-25-18	JOSEPH JOHNSON, ETUX - LIFE	37.746
GG	S29	05-26-11	MARK A. YOHO	89.25
FF	S30	05-25-18.1	PAMELA JOAN FERRELL, ET VIR	2.491
EE	S31	05-25-19	JOSEPH JOHNSON ET UX - LIFE	1.973
	S32	05-26-8	RICHARD J. OTTE	18.27
	S33	05-26-20	RICHARD J. OTTE	4.2
II	S34	05-23-11.5	ZACHARY R. STEVEN	7
JJ	S35	05-23-11.8	ROY F. YOHO	2.25
HH	S36	05-23-11.3	COLIN R. YOHO	11.29
NW	S37	05-23-11.4	EVELYN L. HUDSON	10.879
KK	S38	05-23-13.1	JAMES R. & PAMELA J. FERRELL	0.7625
MM	S39	05-23-13	LINDA D. GREATHOUSE	14.24
LL	S40	05-23-12	MARK A. YOHO	3.05
	S41	05-23-9.1	JOHN W. VAN ORDEN, ETUX	23.376
	S42	05-23-9.4	JACKSON R. DAVIS, JR.	2.087
	S43	05-23-9.2	LINDA D. GREATHOUSE	25.58
	S44	05-23-8	CARL DAVID & SUZANNE L. GUSEMAN	29.5
	S45	05-23-9.3	LINDA D. GREATHOUSE	17.5
	S46	05-23-11.6	T.H. EXPLORATION II, LLC	0.094
	S47	05-23-11.2	EVELYN HUDSON	1.154
	S48	05-23-11	ROY F. YOHO	7
	S49	05-25-20.3	JAMES A. & JO C. ESTEP	4.49
	S50	05-25-20.2	JAMES M. ZAMBOTTI	1.347
	S51	05-25-20.1	JAMES M. ZAMBOTTI	2.746
	S54	05-25-1	MICHAEL L. MASON	35.43
	S55	05-25-14	ROY F. YOHO	23
	S56	05-25-13.2	DAVID A. KLUG	5.89
	S57	05-25-13	WILLIAM M. FERDA, JR., ETAL	16.014
	S58	05-25-13.4	PARSONS CEMETERY	0.382
	S59	05-25-12.1	KENT & BETTY MASON	15
	S60	05-25-11.1	EDWARD W. & DIANNA KLUG	2.343
	S61	12-3-44	JAMES A. & JO C. ESTEP	1.1
	S62	12-3-47	WETZEL CO. EMERGENCY AMBULANCE	0.5
	S63	12-3-49	LOGAN & AMY TAYLOR	3.814
	S64	12-3-43	ADAM W. FERRELL & BRITANNY M. LOY	1.97
Z	S65	05-25-16	CRAIG R. & ASHLEY FERRELL	23.5
	S66	12-3-1	JAMES W. KLUG	0.375
	S67	12-3-4.5	HAZEL M. BLAIR	0.451
	S68	12-3-4.6	STEVEN P. WAYMAN	1.009

Tags	Number	Tax Map - Parcel	Surface Owner	Acres
	S59	12-3-4.8	ERIN HUBBS	0.621
	S70	12-3-4.3	JOSEPH P. & BARBARA A. CAIN	3.619
	S71	12-3-2	ROBERT LEE & DIANA G. SMITH	2.48
	S72	12-3-3.1	DIANA & ROBERT L. SMITH	15.78
	S73	12-3-4.2	DEREK L. BAKER	5.21
	S74	12-3-3	ANITA LARELL SLOUGH	1.12
	S75	12-3-12	RODNEY DEAN JACKSON	3.625
	S76	12-3-48	RONALD W. & JUUE A. NICE	1
	S77	12-3-14	ROBERT W. BAXTER, FREDERICK J. BAXTER & ANN C. LINGER	27
	S78	12-3-14.1	MATTHEW D. HALL	13
	S79	12-3-13.1	ZACHARY J. KIRKLAND	5
	S80	12-3-21.1	LARRY J. & MARY ANN KIRKLAND	0.47
	S81	12-3-29	FRIEND V. ESTEP - RAYMOND F. ESTEP - L/E	2.9
	S82	12-3-30.4	FRIEND V. ESTEP, MICHAEL & JOAN ESTEP & DOUGLAS & JOAN ESTEP (RAYMOND ESTEP - L/E)	81.82
	S83	12-3-30.2	APRIL ROSE & DONALD ALLEN POSTLETHWAIT	1.67
	S84	12-3-30	MARY ROSE YOHO - L/E APRIL ROSE POSTLETHWAIT	0.48
	S85	12-3-28	ANTIOCH CHURCH	1
	S86	12-3-45	ANTIOCH CHURCH	0.774
	S87	12-8-3	R. SHANE & KATHRYN GODDARD	31.13
	S88	12-3-30.3	TIMOTHY L. SUMMERS	0.61
	S89	12-3-32	TIMOTHY L. SUMMERS	2.32
	S90	12-3-39	FRIEND V. ESTEP, MICHAEL & JOAN ESTEP & DOUGLAS & JOAN ESTEP (RAYMOND ESTEP - L/E)	4.69
	S91	12-3-32.1	TIMOTHY L. & LEA ANN SUMMERS	1.78
	S92	12-3-39.1	WILLIAM NICE	1.31
	S93	12-3-31	DOUGLAS & SUZANNA ESTEP	3.25
	S94	12-8-4.3	BRADY G. & SHARON L. HOWELL	5.59
	S95	12-8-4.1	MARY JOSEPHINE & JACOB WOODROW NICE	6.171
	S96	12-8-13	EDWARD C. & SANDRA K. MURRINER	15
	S97	12-8-14	EDWARD C. & SANDRA K. MURRINER	5.33
	S98	12-8-16.1	BRENT A. & KIMBERLY J. EDDY	0.06
	S99	12-8-4.4	CHARLES & BETTY HUGGINS	0.69
	S100	12-8-4.2	BRENT A. & KIMBERLY J. EDDY	1.861
	S101	12-8-4	JACOB WOODROW & MARY JOSEPHINE NICE	20.893
	S102	12-8-21	EDUARDO C. & SONYA R. DEGUZMAN	11.51
	S103	12-8-21.1	LINDA M. STOUT	15.26
	S104	12-8-22.1	BARRY C. KIRKLAND	7.401
	S105	12-8-32.6	CHARLES W. THOMAS JR.	1.309
	S106	12-8-32	CHARLES M. THOMAS, DAVID TODD & CINDY L. BATES	27.287
	S107	12-8-20.1	PAUL J. BLAKE	1.5
	S108	12-8-20.9	JOSHUA M. & COURTNEY R. NEFF	0.4
	S109	12-8-20.3	PAUL J. BLAKE	0.25
	S110	12-8-20.8	JOSHUA M. & COURTNEY R. NEFF	0.99
	S111	12-8-20.6	JOHN G. & DEBRA D. THROCKMORTON	1.046
	S112	12-8-20.7	RON JR. & SHANA CAMPBELL	5.44
	S113	12-8-18	CHARLES D. ROSE JR., ETAL CHARLES & JUDITH ROSE - L/E	6.4
	S114	12-7-33	CHARLES D. ROSE JR., ETAL CHARLES & JUDITH ROSE - L/E	5.75
	S115	12-7-32.1	CHARLES D. ROSE JR., ETAL CHARLES & JUDITH ROSE - L/E	18
	S116	12-7-22.3	TIMOTHY ROGER FERGUSON	0.239
	S117	12-7-22.2	TIMOTHY ROGER FERGUSON	0.908
	S118	12-7-22.4	WAYNE PAUL GODDARD	0.084
	S119	12-7-9	MICHAEL J. & ALENA R. FAYAD	22.526
	S120	12-7-9.1	JAMES T. EDDY	17.47
	S121	12-7-22.1	NANCY C. MURPHY - L/E KARI KIM CLARK	0.82
	S122	12-7-10	WAYNE PAUL GODDARD	1.5
	S123	12-2-32	MARY JOSEPHINE NICE	2.95
	S124	12-2-22.3	DAVID L. & KIMBERLY L. NICE	1.65
	S125	12-2-20.2	MICHAEL K. COZART	1.025
	S126	12-2-20.1	SHIRLEY L. & KENNETH L. HAUGHT	1
	S127	12-2-20	MICHAEL K. & ROSETTA A. COZART	34.063
	S128	12-8-1.2	JOSH GODDARD	1.81
	S129	12-7-8.1	BRIAN & CHRISTINE L. NICE	7.628
	S130	12-7-8	MARK E. ELLER	1.012
	S131	12-7-7.5	MARK E. ELLER	1.94
	S132	12-7-7.1	MARK E. ELLER	1.41
	S133	12-2-25	MICHAEL K. & ROSETTA A. COZART	1.265
	S134	12-2-11.1	BERYL E. MASON	1.7
	S135	12-2-9	LAURA RICHARDS COOK	77
	S136	12-2-10	LAURA RICHARDS COOK	95
	S137	12-2-5	CUFFORD W. & ALBERTA B. JOHNSON	75.96
	S138	12-2-6	CUFFORD W. & ALBERTA B. JOHNSON	36
	S139	12-3-46	CATHY A. PURPURA	0.514
	S140	05-26-13	MARJORIE ANN STONEKING - LIFE	40
	S141	05-26-14	THERESA H. WALTON, AS TRUSTEE OF THE ROBERT D. & BONNIE L. OLIVER TRUST	27.56
	S142	05-26-10	THERESA H. WALTON, AS TRUSTEE OF THE ROBERT D. & BONNIE L. OLIVER TRUST	24.94
	S143	05-26-9	THERESA H. WALTON, AS TRUSTEE OF THE ROBERT D. & BONNIE L. OLIVER TRUST	21.75
	S144	05-26-21	RICHARD JOSEPH OTTE	1.25
	S145	05-23-14	DOMINION ENERGY TRANSMISSION, INC.	59.5
I	S146	12-3-46	CATHY A. PURPURA	3.242
F	S147	12-8-1.2	JOSH GODDARD	1.81
	S148	05-23-11.8	ROY F. YOHO	2.25
	S149	p/o 12-3-39 & 12-3-30.4	DOUGLAS & SUZANNE ESTEP	0.145
	S150	p/o 12-3-4.7 & 12-3-4.3	JOSHUA D. LEMASTERS & ERIN LEMASTERS	3.602

RECEIVED  
Office Of Oil and Gas

OCT 02 2024

WV Department of  
Environmental Protection

P.S.  
708

*David L Jackson*



OPERATOR'S  
WELL #: ELMER N-15HU  
DISTRICT: Proctor  
COUNTY: Wetzel  
STATE: WV  
API #: 47-103-03536

WELL PLAT  
PAGE 3 OF 4  
DATE: 11/20/2023

12/13/2024

form wwg

**ELMER LEASE  
WELL N-15HU  
513.0901± ACRES**

Lease ID	TMP	Tag	Grantor, Lessor, Etc.	Deed Book/Page	
10*31435	12-8-15	A	HENRY AND NANCY GARNER	55	394
10*31435	12-8-16	B	HENRY AND NANCY GARNER	55	394
10*31435	12-8-2	C	HENRY AND NANCY GARNER	55	394
10*31435	12-8-1	D	HENRY AND NANCY GARNER	55	394
10*31435	12-8-1.1	E	HENRY AND NANCY GARNER	55	394
10*31435	12-8-1.2	F	HENRY AND NANCY GARNER	55	394
10*31435	12-7-13.1	G	HENRY AND NANCY GARNER	55	394
10*31435	12-3-26.1	H	HENRY AND NANCY GARNER	55	394
10*31435	12-3-27	I	HENRY AND NANCY GARNER	55	394
10*31435	12-3-46	J	HENRY AND NANCY GARNER	55	394
10*21035	12-2-23	K	THOMAS E GARNER AND BILLIE J GARNER, ET AL	200A	385
10*21643	12-2-23	K	LARRY D GARNER	200A	393
10*31435	12-2-23	K	HENRY AND NANCY GARNER	55	394
10*22229	12-3-13	L	MURIEL A MILLER, ET AL	204A	150
10*21681	12-2-19	M	DOROTHY J HAAS, ET AL	214A	358
**FORCE POOL**	12-2-22.1	N	THOMAS E GARNER, ET AL	166A	436
10*39463	12-3-4.7	O	J P COOPER ET AL	56	245
10*40304	12-2-13	P	DANIEL T BOOTH, ET AL	292A	309
10*18205	12-2-14	Q	MELUSSA PAINTER AND SHAUN PAINTER, ET AL	927 205A	639 891
10*18205	12-2-14.2	R	MELUSSA PAINTER AND SHAUN PAINTER, ET AL	927 205A	639 891
10*22494	5-25-11.4	S	EDWARD W KLUG & DIANNA KLUG JTWROS	920	109
10*27897	12-2-14.1	T	CAROL VASS, ET AL	1063 232A	605 346
10*39461	12-2-14.3	U	JAMES M PARSONS	73	195
10*19727	5-25-14.1	V	S RICHARD MELLON, ET AL	944	465
10*18205	5-25-16.1	W	MELUSSA PAINTER AND SHAUN PAINTER, ET AL	927 205A	639 891
10*18205	5-25-15	X	MELUSSA PAINTER AND SHAUN PAINTER, ET AL	927 205A	639 891
10*18205	5-25-16.2	Y	MELUSSA PAINTER AND SHAUN PAINTER, ET AL	927 205A	639 891
10*18205	5-25-16	Z	MELUSSA PAINTER AND SHAUN PAINTER, ET AL	927 205A	639 891
10*31441	5-26-12	AA	JASON AND S M PARSONS	59	3
10*14786	5-25-17	BB	TWILA O WHIPKEY, ET AL	799	61
10*14786	5-25-20	CC	TWILA O WHIPKEY, ET AL	799	61
10*14786	5-25-18	DD	TWILA O WHIPKEY, ET AL	799	61
10*14786	5-25-19	EE	TWILA O WHIPKEY, ET AL	799	61
10*14786	5-25-18.1	FF	TWILA O WHIPKEY, ET AL	799	61
10*14786	5-26-11	GG	TWILA O WHIPKEY, ET AL	799	61
10*14786	5-23-11.3	HH	TWILA O WHIPKEY, ET AL	799	61
10*14786	5-23-11.5	II	TWILA O WHIPKEY, ET AL	799	61
10*14786	5-23-11.8	JJ	TWILA O WHIPKEY, ET AL	799	61
10*14786	5-23-13.1	KK	TWILA O WHIPKEY, ET AL	799	61
10*14969	5-23-12	LL	REBECCA S WORD, ET AL	872	219
10*14786	5-23-13	MM	TWILA O WHIPKEY, ET AL	799	61
10*14786	5-23-11.4	NN	TWILA O WHIPKEY, ET AL	799	61
10*14786	5-23-11.1	OO	TWILA O WHIPKEY, ET AL	799	61

RECEIVED  
Office Of Oil and Gas

OCT 02 2024

WV Department of  
Environmental Protection

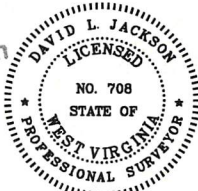

P.S.  
708

*David L Jackson*



OPERATOR'S  
WELL #: ELMER N-15HU  
DISTRICT: Proctor  
COUNTY: Wetzel  
STATE: WV  
API #: 47-103-03536

**WELL PLAT**  
**PAGE 4 OF 4**  
**DATE: 11/20/2023**

**12/13/2024**

**ELMER LEASE  
WELL N-15HU  
513.0901 ± ACRES**

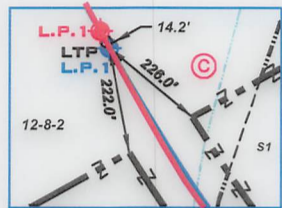
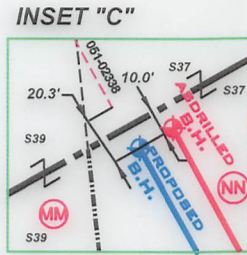
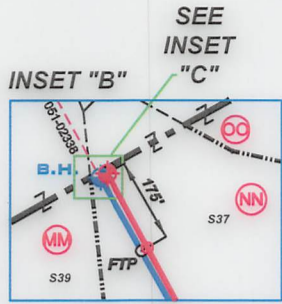

NOTE: L.P.1 and LTP are same point.

(+) DENOTES LOCATION ON UNITED STATES TOPOGRAPHIC MAPS

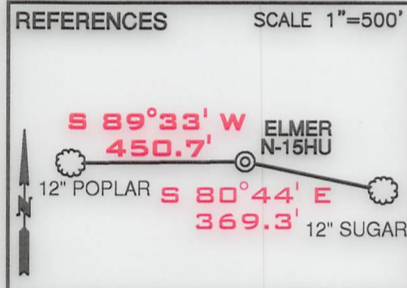

**SURFACE HOLE**  
UTM. NAD83, ZONE 17  
IN METERS  
**N) 4,393,814.39**  
**E) 522,496.06**

**LANDING POINT 1**  
UTM. NAD83, ZONE 17  
IN METERS  
**N) 4,393,793.27**  
**E) 522,180.25**

**BOTTOM HOLE**  
UTM. NAD83, ZONE 17  
IN METERS  
**N) 4,398,238.93**  
**E) 519,603.94**

- NOTES**
- BORE PATH BASED ON GRID NORTH.
  - NO WATER WELLS WITHIN 250' OF WELL WERE FOUND, NO DWELLINGS WITHIN 825' OF PAD CENTER WERE FOUND.
  - OWNERSHIP TAKEN FROM PUBLIC RECORDS OF WETZEL COUNTY, WV IN JULY, 2022.
  - COORDINATES AND WELL TIES BASED UPON DIFFERENTIAL GPS MEASUREMENTS.
  - WELL LOCATION REFERENCES ARE BASED UPON THE MAGNETIC MERIDIAN.
  - ALL DEEP WELLS WITHIN 1,000' ARE SHOWN ON THIS PLAT.
  - BOUNDARIES ALONG ROADWAYS ARE BASED UPON MEMORANDUM BY DICKIE, MCCAMEY & CHILCOTE, P.C. FILE 0058304.0401147

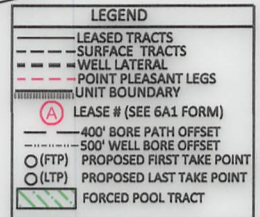

**SURFACE HOLE**  
UTM. NAD83, ZONE 17  
IN METERS  
**N) 4,393,814.39**  
**E) 522,496.06**

**LANDING POINT 1**  
UTM. NAD83, ZONE 17  
IN METERS  
**N) 4,393,786.21**  
**E) 522,184.25**

**BOTTOM HOLE**  
UTM. NAD83, ZONE 17  
IN METERS  
**N) 4,398,236.31**  
**E) 519,599.77**

Deep Wells Within 2400' of Proposed Well's Surface Location and/or 500' of Well Lateral

API	OPERATOR
47-051-02338	Tug Hill Operating, LLC
47-103-03467	Tug Hill Operating, LLC
47-103-03502	Tug Hill Operating, LLC
47-103-03504	Tug Hill Operating, LLC
47-103-03505	Tug Hill Operating, LLC

CURVE	CHORD BEARING	CHORD LENGTH	RADIUS	ARC LENGTH
C1	S 80°38' W	60.15'	55.42'	63.58'
C2	S 78°52' W	65.23'	54.58'	69.91'
C3	N 50°40' W	399.70'	759.26'	404.47'
C4	N 32°09' W	258.78'	1949.33'	256.97'

LINE	BEARING	DISTANCE
L1	N 42°09' E	1,867.27'
L2	N 67°02' E	1,425.00'
L3	S 29°44' W	763.41'
L4	N 28°54' W	185.59'

FILE NUMBER \_\_\_\_\_

DRAWING NUMBER ELMER\_N-15HU\_REV1

SCALE 1" = 2000'

MINIMUM DEGREE OF ACCURACY 1/200

PROVEN SOURCE OF ELEVATION SUBMETER MAPPING  
GRADE GPS

I, THE UNDERSIGNED, HEREBY CERTIFY THAT THIS PLAT IS CORRECT TO THE BEST OF MY KNOWLEDGE AND BELIEF AND SHOWS ALL THE INFORMATION REQUIRED BY LAW AND THE RULES ISSUED AND PRESCRIBED BY THE DEPARTMENT OF ENVIRONMENTAL PROTECTION

P.S. 708

*David L Jackson*



JACKSON SURVEYING INC.  
P.O. Box 1460  
Clarksburg, WV 26302  
304-623-5851

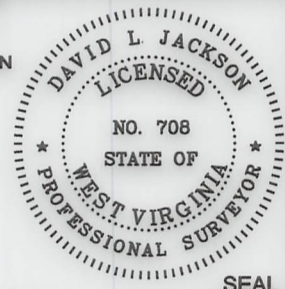

WVDEP  
OFFICE OF OIL & GAS  
601 57TH STREET, SE  
CHARLESTON, WV 25304

DATE: NOVEMBER 20, 2023

OPERATORS WELL NO. ELMER N-15HU

API WELL NO. 47-103-03536

STATE WV COUNTY WETZEL PERMIT 12/13/2024

WELL TYPE: OIL  GAS  LIQUID INJECTION  WASTE DISPOSAL   
(IF "GAS") PRODUCTION  STORAGE  DEEP  SHALLOW

LOCATION ELEVATION 1276.50' WATERSHED (HUC 10) PROCTOR CREEK OF FRENCH CREEK - OHIO RIVER (HUC-10)

DISTRICT PROCTOR COUNTY WETZEL

QUADRANGLE WILEYVILLE 7.5' LEASE NUMBER SEE WW-6A1 FORM

SURFACE OWNER ELNORA TUTTLE HRS ACREAGE 39.19

OIL & GAS ROYALTY OWNER HENRY & NANCY GARNER - SEE WW-6A1 LEASE ACREAGE 39.19

PROPOSED WORK: DRILL  CONVERT  DRILL DEEPER  REDRILL  FRACTURE OR STIMULATE  PLUG OFF OLD FORMATION   
PERFORATE NEW FORMATION  OTHER PHYSICAL CHANGE (SPECIFY) ASDRILLED

TARGET FORMATION POINT PLEASANT ESTIMATED DEPTH TVD: 11,712' TMD: 29,166'

WELL OPERATOR EQT PRODUCTION COMPANY DESIGNATED AGENT JOSEPH C. MALLOW

ADDRESS 400 WOODCLIFF DRIVE CANONSBURG, PA 15317 ADDRESS 427 MIDSTATE DRIVE CLARKSBURG, WV 25301

COUNTY NAME  
PERMIT



# ELMER LEASE WELL N-15HU 513.0901± ACRES

**LEGEND**

- LEASED TRACTS
- - - SURFACE TRACTS
- - - WELL LATERAL
- - - POINT PLEASANT LEGS
- - - UNIT BOUNDARY
- (A) LEASE # (SEE 6A1 FORM)
- 400' BORE PATH OFFSET
- - - 500' WELL BORE OFFSET
- (FTP) PROPOSED FIRST TAKE POINT
- (LTP) PROPOSED LAST TAKE POINT
- ▨ FORCED POOL TRACT

SCALE 1" = 2000'

- ASDRILLED LEG
- PERMITTED LEG

Note: Tracts F & T are forced pooled tracts.

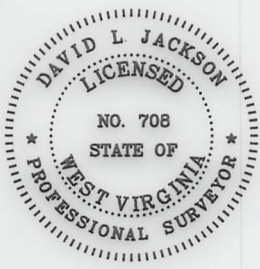
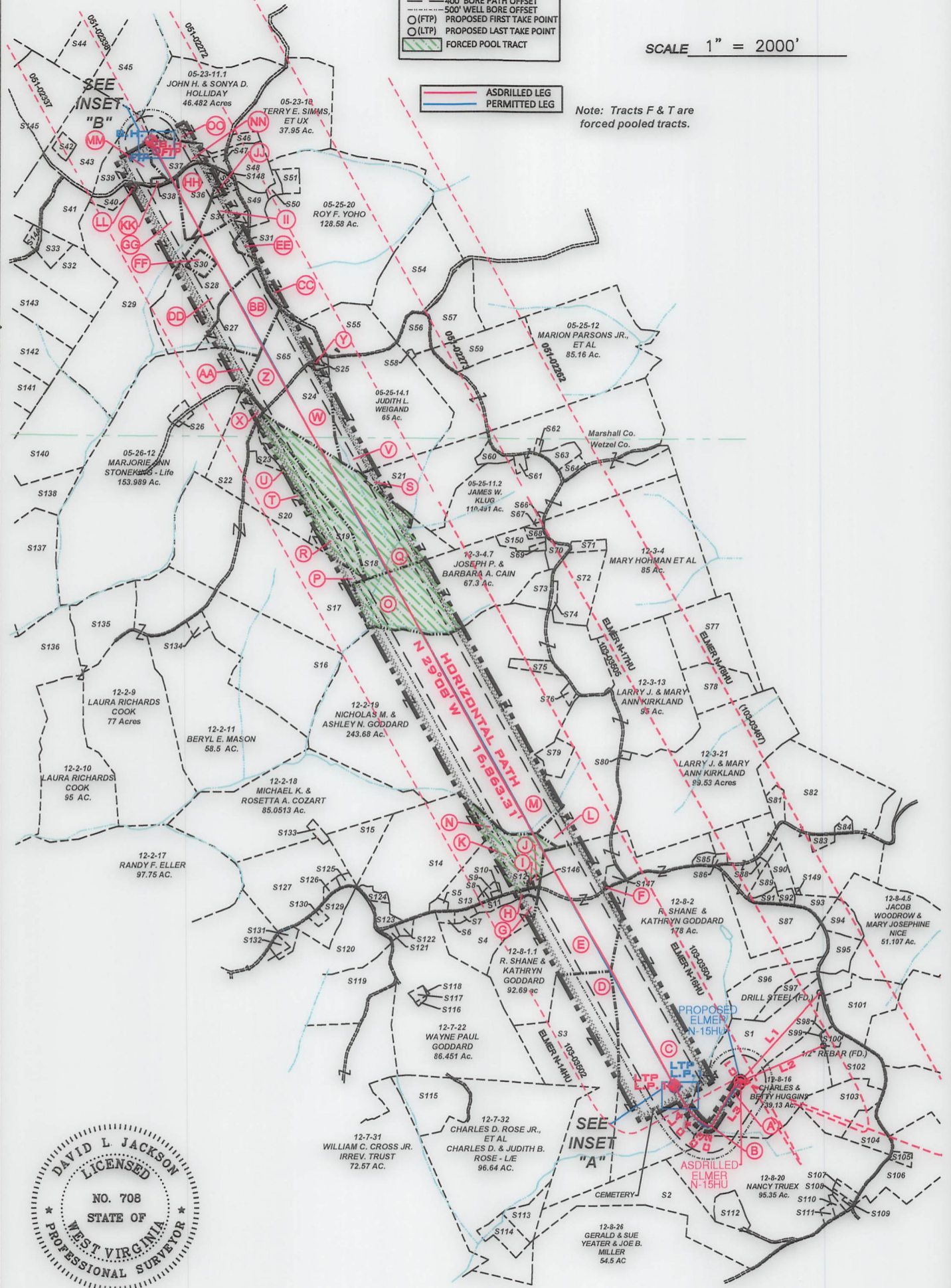

P.S. 708 *David L Jackson*

12/13/2024

	OPERATOR'S	WELL PLAT
	WELL #: <u>ELMER N-15HU</u>	PAGE 2 OF 4
	DISTRICT: <u>Proctor</u>	DATE: <u>11/20/2023</u>
	COUNTY: <u>Wetzel</u>	
	STATE: <u>WV</u>	
API #: <u>47-103-03536</u>		

form wv6

**ELMER LEASE  
WELL N-15HU  
513.0901 ± ACRES**

Tags	Number	Tax Map -Parcel	Surface Owner	Acres
A	S1	12-8-15	ELNORA TUTTLE HRS	39.19
	S2	12-8-20.5	JOE MILLER, GERALD & SUE YEATER	44.85
D	S3	12-8-1	R. SHANE & KATHRYN GODDARD	77
G	S4	12-7-13.1	WAYNE PAUL GODDARD	18
	S5	12-2-22.2	DAVID A. & MANDY L. TRUOX	1.186
	S6	12-7-11	JOSEPH R. VILLERS	1.5
	S7	12-7-12	JOSEPH R. VILLERS	1.6
	S8	12-2-23.4	SHARON HOWELL ET AL: GLORIA A. NICE - L/E	0.422
	S9	12-2-23.3	KENNETH W. GODDARD	0.766
	S10	12-2-23.1	KENNETH W. GODDARD	0.36
H	S11	12-3-26.1	JOSEPH MARK KLUG	3.242
I	S12	12-3-27	CATHY A. PURPURA	0.227
K	S13	12-2-23	DAVID A. NICE	21.7
N	S14	12-2-22.1	DAVID A. NICE	54.66
	S15	12-2-21	MICHAEL KENNETH & ROSETTA ANNETTE COZART	11.4
	S16	12-2-12	BERYL E. MASON	59.9
P	S17	12-2-13	JAY S. BOOTH; DANIEL T. BOOTH & DIANE BETH OVERDORFF	100
Q	S18	12-2-14	DAVID L. CUNNINGHAM	56.23
R	S19	12-2-14.2	JOHN G. JR & GERALDINE M. ROGERS	22.007
T	S20	12-2-14.1	SAMMY J. GREATHOUSE JR. : SAMMY J. GREATHOUSE SR. - L/E	18.67
S	S21	05-25-11.4	EDWARD W. KLUG, ETUX	32.787
X	S22	05-25-15	ROBERT S. KELLER, ETAL	15.073
U	S23	12-2-14.3	QUENNA BENNETT	3.093
W	S24	05-25-16.1	DAVID L. CUNNINGHAM	6.34
Y	S25	05-25-16.2	RODNEY J. LOY	1.087
	S26	05-26-12.1	ALVIN F. JR. & KRISTA R. STONEKING	2.011
BB	S27	05-25-17	CRAIG & ASHLEY FERRELL	22.79
DD	S28	05-25-18	JOSEPH JOHNSON, ETUX - LIFE	37.746
GG	S29	05-26-11	MARK A. YOHO	89.25
FF	S30	05-25-18.1	PAMELA JOAN FERRELL, ET VIR	2.491
EE	S31	05-25-19	JOSEPH JOHNSON ET UX - LIFE	1.973
	S32	05-26-8	RICHARD J. OTTE	18.27
	S33	05-26-20	RICHARD J. OTTE	4.2
II	S34	05-23-11.5	ZACHARY R. STEVEN	7
JJ	S35	05-23-11.8	ROY F. YOHO	2.25
HH	S36	05-23-11.3	COLIN R. YOHO	11.29
NN	S37	05-23-11.4	EVELYN L. HUDSON	10.879
KK	S38	05-23-13.1	JAMES R. & PAMELA J. FERRELL	0.7625
MM	S39	05-23-13	LINDA D. GREATHOUSE	14.24
LL	S40	05-23-12	MARK A. YOHO	3.05
	S41	05-23-9.1	JOHN W. VAN ORDEN, ETUX	23.376
	S42	05-23-9.4	JACKSON R. DAVIS, JR.	2.087
	S43	05-23-9.2	LINDA D. GREATHOUSE	25.58
	S44	05-23-8	CARL DAVID & SUZANNE L. GUSEMAN	29.5
	S45	05-23-9.3	LINDA D. GREATHOUSE	17.5
	S46	05-23-11.6	T.H. EXPLORATION II, LLC	0.094
	S47	05-23-11.2	EVELYN HUDSON	1.154
	S48	05-23-11	ROY F. YOHO	7
	S49	05-25-20.3	JAMES A. & JO C. ESTEP	4.49
	S50	05-25-20.2	JAMES M. ZAMBOTTI	1.347
	S51	05-25-20.1	JAMES M. ZAMBOTTI	2.746
	S54	05-25-1	MICHAEL L. MASON	35.43
	S55	05-25-14	ROY F. YOHO	23
	S56	05-25-13.2	DAVID A. KLUG	5.89
	S57	05-25-13	WILLIAM M. FERDA, JR., ETAL	16.014
	S58	05-25-13.4	PARSONS CEMETERY	0.382
	S59	05-25-12.1	KENT & BETTY MASON	15
	S60	05-25-11.1	EDWARD W. & DIANNA KLUG	2.343
	S61	12-3-44	JAMES A. & JO C. ESTEP	1.1
	S62	12-3-47	WETZEL CO. EMERGENCY AMBULANCE	0.5
	S63	12-3-49	LOGAN & AMY TAYLOR	3.814
	S64	12-3-43	ADAM W. FERRELL & BRITTANY M. LOY	1.97
Z	S65	05-25-16	CRAIG R. & ASHLEY FERRELL	23.5
	S66	12-3-1	JAMES W. KLUG	0.375
	S67	12-3-4.5	HAZEL M. BLAIR	0.451
	S68	12-3-4.6	STEVEN P. WAYMAN	1.009

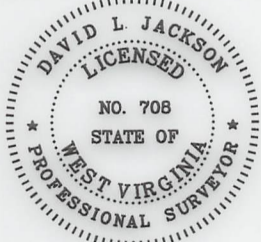

P.S. 708

*David L Jackson*



\* FORCED POOLED TRACTS ARE HIGHLIGHTED

Tags	Number	Tax Map -Parcel	Surface Owner	Acres
	S69	12-3-4.8	ERIN HUBBS	0.621
	S70	12-3-4.3	JOSEPH P. & BARBARA A. CAIN	3.619
	S71	12-3-2	ROBERT LEE & DIANA G. SMITH	2.48
	S72	12-3-3.1	DIANA & ROBERT L. SMITH	15.78
	S73	12-3-4.2	DEREK L. BAKER	5.21
	S74	12-3-3	ANITA LARELL SLOUGH	1.12
	S75	12-3-12	RODNEY DEAN JACKSON	3.625
	S76	12-3-48	RONALD W. & JULIE A. NICE	1
	S77	12-3-14	ROBERT W. BAXTER, FREDERICK J. BAXTER & ANN C. LINGER	27
	S78	12-3-14.1	MATTHEW D. HALL	13
	S79	12-3-13.1	ZACHARY J. KIRKLAND	5
	S80	12-3-21.1	LARRY J. & MARY ANN KIRKLAND	0.47
	S81	12-3-29	FRIEND V. ESTEP : RAYMOND F. ESTEP - L/E	2.9
	S82	12-3-30.4	FRIEND V. ESTEP, MICHAEL & JOAN ESTEP & DOUGLAS & JOAN ESTEP (RAYMOND ESTEP - L/E)	81.82
	S83	12-3-30.2	APRIL ROSE & DONALD ALLEN POSTLETHWAIT	1.67
	S84	12-3-30	MARY ROSE YOHO - L/E: APRIL ROSE POSTLETHWAIT	0.48
	S85	12-3-28	ANTIOCH CHURCH	1
	S86	12-3-45	ANTIOCH CHURCH	0.774
	S87	12-8-3	R. SHANE & KATHRYN GODDARD	31.13
	S88	12-3-30.3	TIMOTHY L. SUMMERS	0.61
	S89	12-3-32	TIMOTHY L. SUMMERS	2.32
	S90	12-3-39	FRIEND V. ESTEP, MICHAEL & JOAN ESTEP & DOUGLAS & JOAN ESTEP (RAYMOND ESTEP - L/E)	4.69
	S91	12-3-32.1	TIMOTHY L. & LEA ANN SUMMERS	1.78
	S92	12-3-39.1	WILLIAM NICE	1.31
	S93	12-3-31	DOUGLAS & SUZANNA ESTEP	3.25
	S94	12-8-4.3	BRADY G. & SHARON L. HOWELL	5.59
	S95	12-8-4.1	MARY JOSEPHINE & JACOB WOODROW NICE	6.171
	S96	12-8-13	EDWARD C. & SANDRA K MURRINER	15
	S97	12-8-14	EDWARD C. & SANDRA K MURRINER	5.33
	S98	12-8-16.1	BRENT A. & KIMBERLY J. EDDY	0.06
	S99	12-8-4.4	CHARLES & BETTY HUGGINS	0.69
	S100	12-8-4.2	BRENT A. & KIMBERLY J. EDDY	1.861
	S101	12-8-4	JACOB WOODROW & MARY JOSEPHINE NICE	20.893
	S102	12-8-21	EDUARDO C. & SONYA R. DEGUZMAN	11.51
	S103	12-8-21.1	LINDA M. STOUT	15.26
	S104	12-8-22.1	BARRY C. KIRKLAND	7.401
	S105	12-8-32.6	CHARLES W. THOMAS JR.	1.309
	S106	12-8-32	CHARLES M. THOMAS, DAVID TODD & CINDY L. BATES	27.287
	S107	12-8-20.1	PAUL J. BLAKE	1.5
	S108	12-8-20.9	JOSHUA M. & COURTNEY R. NEFF	0.4
	S109	12-8-20.3	PAUL J. BLAKE	0.25
	S110	12-8-20.8	JOSHUA M. & COURTNEY R. NEFF	0.99
	S111	12-8-20.6	JOHN G. & DEBRA D. THROCKMORTON	1.046
	S112	12-8-20.7	RON JR. & SHANA CAMPBELL	5.44
	S113	12-8-18	CHARLES D. ROSE JR., ETAL: CHARLES & JUDITH ROSE - L/E	6.4
	S114	12-7-33	CHARLES D. ROSE JR., ETAL: CHARLES & JUDITH ROSE - L/E	5.75
	S115	12-7-32.1	CHARLES D. ROSE JR., ETAL: CHARLES & JUDITH ROSE - L/E	18
	S116	12-7-22.3	TIMOTHY ROGER FERGUSON	0.239
	S117	12-7-22.2	TIMOTHY ROGER FERGUSON	0.908
	S118	12-7-22.4	WAYNE PAUL GODDARD	0.084
	S119	12-7-9	MICHAEL J. & ALENA R. FAYAD	22.526
	S120	12-7-9.1	JAMES T. EDDY	17.47
	S121	12-7-22.1	NANCY C. MURPHY - LE: KARI KIM CLARK	0.82
	S122	12-7-10	WAYNE PAUL GODDARD	1.5
	S123	12-2-22	MARY JOSEPHINE NICE	2.95
	S124	12-2-22.3	DAVID L. & KIMBERLY L. NICE	1.65
	S125	12-2-20.2	MICHAEL K. COZART	1.025
	S126	12-2-20.1	SHIRLEY L. & KENNETH L. HAUGHT	1
	S127	12-2-20	MICHAEL K. & ROSETTA A. COZART	34.063
	S128	12-8-1.2	JOSH GODDARD	1.81
	S129	12-7-8.1	BRIAN & CHRISTINE L. NICE	7.628
	S130	12-7-8	MARK E. ELLER	1.012
	S131	12-7-7.5	MARK E. ELLER	1.94
	S132	12-7-7.1	MARK E. ELLER	1.41
	S133	12-2-25	MICHAEL K. & ROSETTA A. COZART	1.265
	S134	12-2-11.1	BERYL E. MASON	1.7
	S135	12-2-9	LAURA RICHARDS COOK	77
	S136	12-2-10	LAURA RICHARDS COOK	95
	S137	12-2-5	CLIFFORD W. & ALBERTA B. JOHNSON	75.96
	S138	12-2-6	CLIFFORD W. & ALBERTA B. JOHNSON	36
	S139	12-3-46	CATHY A. PURPURA	0.514
	S140	05-26-13	MARJORIE ANN STONEKING - LIFE	40
	S141	05-26-14	THERESA H. WALTON, AS TRUSTEE OF THE ROBERT D. & BONNIE L. OLIVER TRUST	27.56
	S142	05-26-10	THERESA H. WALTON, AS TRUSTEE OF THE ROBERT D. & BONNIE L. OLIVER TRUST	24.94
	S143	05-26-9	THERESA H. WALTON, AS TRUSTEE OF THE ROBERT D. & BONNIE L. OLIVER TRUST	21.75
	S144	05-26-21	RICHARD JOSEPH OTTE	1.25
	S145	05-23-14	DOMINION ENERGY TRANSMISSION, INC.	59.5
J	S146	12-3-46	CATHY A. PURPURA	3.242
F	S147	12-8-1.2	JOSH GODDARD	1.81
	S148	05-23-11.8	ROY F. YOHO	2.25
	S149	p/o 12-3-39 & 12-3-30.4	DOUGLAS & SUZANNE ESTEP	0.145
	S150	p/o 12-3-4.7 & 12-3-4.3	JOSHUA D. LEMASTERS & TRACY LEMASTERS	602

12/15/2024

OPERATOR'S WELL #:	<u>ELMER N-15HU</u>	WELL PLAT	<u>PAGE 3 OF 4</u>
DISTRICT:	<u>Proctor</u>	DATE:	<u>11/20/2023</u>
COUNTY:	<u>Wetzel</u>		
STATE:	<u>WV</u>		
API #:	<u>47-103-03536</u>		

form ww6

**ELMER LEASE  
WELL N-15HU  
513.0901 ± ACRES**

Lease ID	TMP	Tag	Grantor, Lessor, Etc.	Deed Book/Page	
10*31435	12-8-15	A	HENRY AND NANCY GARNER	55	394
10*31435	12-8-16	B	HENRY AND NANCY GARNER	55	394
10*31435	12-8-2	C	HENRY AND NANCY GARNER	55	394
10*31435	12-8-1	D	HENRY AND NANCY GARNER	55	394
10*31435	12-8-1.1	E	HENRY AND NANCY GARNER	55	394
10*31435	12-8-1.2	F	HENRY AND NANCY GARNER	55	394
10*31435	12-7-13.1	G	HENRY AND NANCY GARNER	55	394
10*31435	12-3-26.1	H	HENRY AND NANCY GARNER	55	394
10*31435	12-3-27	I	HENRY AND NANCY GARNER	55	394
10*31435	12-3-46	J	HENRY AND NANCY GARNER	55	394
10*21035	12-2-23	K	THOMAS E GARNER AND BILLIE J GARNER, ET AL	200A	385
10*21643	12-2-23	K	LARRY D GARNER	200A	393
10*31435	12-2-23	K	HENRY AND NANCY GARNER	55	394
10*22229	12-3-13	L	MURIEL A MILLER, ET AL	204A	150
10*21681	12-2-19	M	DOROTHY J HAAS, ET AL	214A	358
**FORCE					
POOL**	12-2-22.1	N	THOMAS E GARNER, ET AL	166A	436
10*39463	12-3-4.7	O	J P COOPER ET AL	56	245
10*40304	12-2-13	P	DANIEL T BOOTH, ET AL	292A	309
				927	639
10*18205	12-2-14	Q	MELISSA PAINTER AND SHAUN PAINTER, ET AL	205A	891
				927	639
10*18205	12-2-14.2	R	MELISSA PAINTER AND SHAUN PAINTER, ET AL	205A	891
10*22494	5-25-11.4	S	EDWARD W KLUG & DIANNA KLUG JTWROS	920	109
				1063	605
10*27897	12-2-14.1	T	CAROL VASS, ET AL	232A	346
10*39461	12-2-14.3	U	JAMES M PARSONS	73	195
10*19727	5-25-14.1	V	S RICHARD MELLON, ET AL	944	465
				927	639
10*18205	5-25-16.1	W	MELISSA PAINTER AND SHAUN PAINTER, ET AL	205A	891
				927	639
10*18205	5-25-15	X	MELISSA PAINTER AND SHAUN PAINTER, ET AL	205A	891
				927	639
10*18205	5-25-16.2	Y	MELISSA PAINTER AND SHAUN PAINTER, ET AL	205A	891
				927	639
10*18205	5-25-16	Z	MELISSA PAINTER AND SHAUN PAINTER, ET AL	205A	891
10*31441	5-26-12	AA	JASON AND S M PARSONS	59	3
10*14786	5-25-17	BB	TWILA O WHIPKEY, ET AL	799	61
10*14786	5-25-20	CC	TWILA O WHIPKEY, ET AL	799	61
10*14786	5-25-18	DD	TWILA O WHIPKEY, ET AL	799	61
10*14786	5-25-19	EE	TWILA O WHIPKEY, ET AL	799	61
10*14786	5-25-18.1	FF	TWILA O WHIPKEY, ET AL	799	61
10*14786	5-26-11	GG	TWILA O WHIPKEY, ET AL	799	61
10*14786	5-23-11.3	HH	TWILA O WHIPKEY, ET AL	799	61
10*14786	5-23-11.5	II	TWILA O WHIPKEY, ET AL	799	61
10*14786	5-23-11.8	JJ	TWILA O WHIPKEY, ET AL	799	61
10*14786	5-23-13.1	KK	TWILA O WHIPKEY, ET AL	799	61
10*14969	5-23-12	LL	REBECCA S WORD, ET AL	872	219
10*14786	5-23-13	MM	TWILA O WHIPKEY, ET AL	799	61
10*14786	5-23-11.4	NN	TWILA O WHIPKEY, ET AL	799	61
10*14786	5-23-11.1	OO	TWILA O WHIPKEY, ET AL	799	61

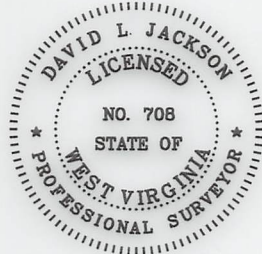

P.S.  
708

*David L Jackson*

12/13/2024



OPERATOR'S  
WELL #: ELMER N-15HU  
DISTRICT: Proctor  
COUNTY: Wetzel  
STATE: WV  
API #: 47-103-03536

WELL PLAT  
PAGE 4 OF 4  
DATE: 11/20/2023

# Hydraulic Fracturing Fluid Product Component Information Disclosure

Job Start Date:	05/11/2024
Job End Date:	06/10/2024
State:	West Virginia
County:	Wetzel
API Number:	47-103-03536-00-00
Operator Name:	EQT Production
Well Name and Number:	Elmer N-15HU RD
Latitude:	39.693877
Longitude:	-80.737624
Datum:	NAD83
Federal Well:	NO
Indian Well:	NO
True Vertical Depth:	11712.33
Total Base Water Volume (gal)*:	35871774.75
Total Base Non Water Volume:	0



Water Source	Percent
--------------	---------

RECEIVED  
Office Of Oil and Gas

OCT 02 2024

WV Department of  
Environmental Protection

## Hydraulic Fracturing Fluid Composition:

Trade Name	Supplier	Purpose	Ingredients	Chemical Abstract Service Number (CAS #)	Maximum Ingredient Concentration in Additive (% by mass)**	Maximum Ingredient Concentration in HF Fluid (% by mass)**	Comments
Water	EQT	Carrier/Base Fluid					
			Water	7732-18-5	100.00000	87.62034	None
Sand (Proppant)	EQT	Proppant					
			Silica Substrate	14808-60-7	100.00000	12.21988	None
Clearal 268	ChemStream	Biocide					
			Non-hazardous substances	Proprietary	80.00000	0.00890	None
StimSTREAM FR 9800	ChemStream	Friction Reducer					
			Copolymer of 2-propanamide	Proprietary	30.00000	0.00874	None
StimSTREAM SC-398	ChemStream	Scale Inhibitor					
			Non-hazardous substances	Proprietary	90.00000	0.00752	None
StimSTREAM	ChemStream	Friction					

12/13/2024

FR 9800		Reducer					
			Petroleum Distillate	64742-47-8	20.00000	0.00388	None
Enviro-Syn HCR-7000-WL	Fluid Energy Group Ltd.	Synthetic Acid					
			Proprietary	Proprietary	20.00000	0.00158	None
Clearal 268	ChemStream	Biocide					
			Glutaraldehyde	111-30-8	20.00000	0.00056	None
Enviro-Syn HCR-7000-WL	Fluid Energy Group Ltd.	Synthetic Acid					
			Proprietary	Proprietary	10.00000	0.00040	None
StimSTREAM SC-398	ChemStream	Scale Inhibitor					
			Bis(HexaMethylene Triamine Penta(Methylene Phosphonic Acid) (BHMT)	34690-00-1	10.00000	0.00009	None
StimSTREAM FR 9800	ChemStream	Friction Reducer					
			Oleic Acid Diethanolamide	93-83-4	2.00000	0.00004	None
StimSTREAM FR 9800	ChemStream	Friction Reducer					
			Alcohols, C12-16, ethoxylated	68551-12-2	2.00000	0.00004	None
Clearal 268	ChemStream	Biocide					
			Quaternary Ammonium Compounds	68424-85-1	3.00000	0.00001	None
Clearal 268	ChemStream	Biocide					
			Didecyl dimethyl ammonium chloride	7173-51-5	3.00000	0.00001	None
StimSTREAM FR 9800	ChemStream	Friction Reducer					
			Ammonium chloride ((NH4)Cl)	12125-02-9	1.00000	0.00001	None
Clearal 268	ChemStream	Biocide					
			Ethanol	64-17-5	1.50000	0.00000	None

Ingredients shown above are subject to 29 CFR 1910.1200(i) and appear on Material Safety Data Sheets (MSDS). Ingredients shown below are Non-MSDS

Office Of Oil and Gas

\* Total Water Volume sources may include various types of water including fresh water, produced water, and recycled water

\*\* Information is based on the maximum potential for concentration and thus the total may be over 100%

OCT 02 2024

Note: For Field Development Products (products that begin with FDP), MSDS level only information has been provided.

Ingredient information for chemicals subject to 29 CFR 1910.1200(i) and Appendix D are obtained from suppliers Material Safety Data Sheets (MSDS)

WV Department of  
Environmental Protection

12/13/2024

Well # ELMER N-15HU-RD (L027979) Final Formations API# 47-103-03536				
Formation Name	Drill Top MD (ftGRD)	Drill Top (TVD) (ftGRD)	Drill Btm MD (ftGRD)	Drill Btm (TVD) (ftGRD)
Sand/Shale	1	1	564	563
Washington Coal	564	563	566	565
Sand/Shale	566	565	907	906
Sewickley Coal	907	906	910	909
Sand/Shale	910	909	1,000	999
Pittsburgh Coal	1,000	999	1,004	1,003
Sand/Shale	1,004	1,003	2,343	2,342
Big Lime	2,343	2,342	2,474	2,473
Big Injun	2,474	2,473	2,620	2,619
Sand/Shale	2,620	2,619	2,788	2,787
Weir	2,788	2,787	2,976	2,975
Sand/Shale	2,976	2,975	3,178	3,177
Gordon	3,178	3,177	3,309	3,308
Sand/Shale	3,309	3,308	5,632	5,631
Alexander	5,632	5,631	6,224	6,223
Rhinestreet	6,224	6,223	6,651	6,650
Middlesex	6,651	6,650	6,706	6,705
Sand/Shale	6,706	6,705	6,726	6,725
Geneseo	6,726	6,725	6,753	6,751
Tully	6,753	6,751	6,787	6,785
Hamilton	6,787	6,785	6,831	6,829
Marcellus	6,831	6,829	6,883	6,881
Onondaga	6,883	6,881	7,114	7,112
Oriskany	7,114	7,112	7,221	7,219
Helderberg	7,221	7,219	7,585	7,583
Sand/Shale	7,585	7,583	7,565	7,563
Salina	7,565	7,563	8,412	8,391
Sand/Shale	8,412	8,391	8,645	8,616
Lockport	8,645	8,616	9,001	8,961
Rose Hill	9,001	8,961	9,277	9,226
Packer Shell	9,277	9,226	9,479	9,421
Clinton	9,479	9,421	9,585	9,523
Queenston	9,585	9,523	10,362	10,272
Sand/Shale	10,362	10,272	10,364	10,274
Reedsville	10,364	10,274	11,756	11,528
Utica	11,756	11,528	12,014	11,641
Point Pleasant	12,014	11,641	23,133	11,679

RECEIVED  
Office Of Oil and Gas  
OCT 02 2024  
WV Department of  
Environmental Protection

12/13/2024