



# SWN PRODUCTION COMPANY, LLC



Location: Wetzel County, WV  
 Field: Wetzel  
 Facility: William Ritchea WTZ Pad

Slot: 210H  
 Well: William Ritchea WTZ 210H  
 Wellbore: William Ritchea WTZ 210H AWB

Plot reference wellpath is William Ritchea WTZ 210H awp Proj: 18738	Grid System: NAD83 / UTM Zone 17 North, US feet
True vertical depths are referenced to SDC 41 (KB)	North Reference: Grid north
Reference wellpath measured depths are referenced to SDC 41 (KB)	Scale: True distance
SDC 41 (KB) to Mean Sea Level: 1589.1 feet	Coordinates are in feet referenced to Slot
Mean Sea Level to Ground level (At Slot: 210H): -1563.1 feet	Depths are in feet
Offset wellpath MDs are referenced to each path's default MD datum	Created by: tranlam on 2023-07-11; Database: WA_MPL_EASTERNUS_Defn

### Location Information

Facility Name			Grid East (US ft)	Grid North (US ft)	Latitude	Longitude
William Ritchea WTZ Pad			1736263.630	14406607.520	39°40'10.5672"N	80°39'33.7968"W
Slot	Local N (ft)	Local E (ft)	Grid East (US ft)	Grid North (US ft)	Latitude	Longitude
210H	-22.64	-16.17	1736247.470	14406584.890	39°40'10.3441"N	80°39'34.0046"W
SDC 41 (KB) to Ground level (At Slot: 210H)					26ft	
Mean Sea Level to Ground level (At Slot: 210H)					-1563.1ft	
SDC 41 (KB) to Mean Sea Level					1589.1ft	

### Bottom Hole Location

MD (ft)	Inc (")	Az (")	TVD (ft)	Local N (ft)	Local E (ft)	Grid East (US ft)	Grid North (US ft)	Latitude	Longitude
18738.00	89.230	131.270	7707.92	-7401.75	9169.49	1745413.37	14399186.04	39°38'56.8339"N	80°37'37.1378"W

API: 47103035750000  
 BH JOB: 11848193  
 DURATION: 07.02.2023 to 07.10.2023  
 RIG; SDC 41



HDGM2023 (1800.0 to 2024.0) Dip: 86.35° Field: 51726.9 nT  
 Magnetic North is 3.24 degrees West of True North (at 01/25/2023)  
 Grid North is 0.22 degrees East of True North  
 To correct azimuth from True to Grid subtract 0.22 degrees  
 To correct azimuth from Magnetic to Grid subtract 8.46 degrees

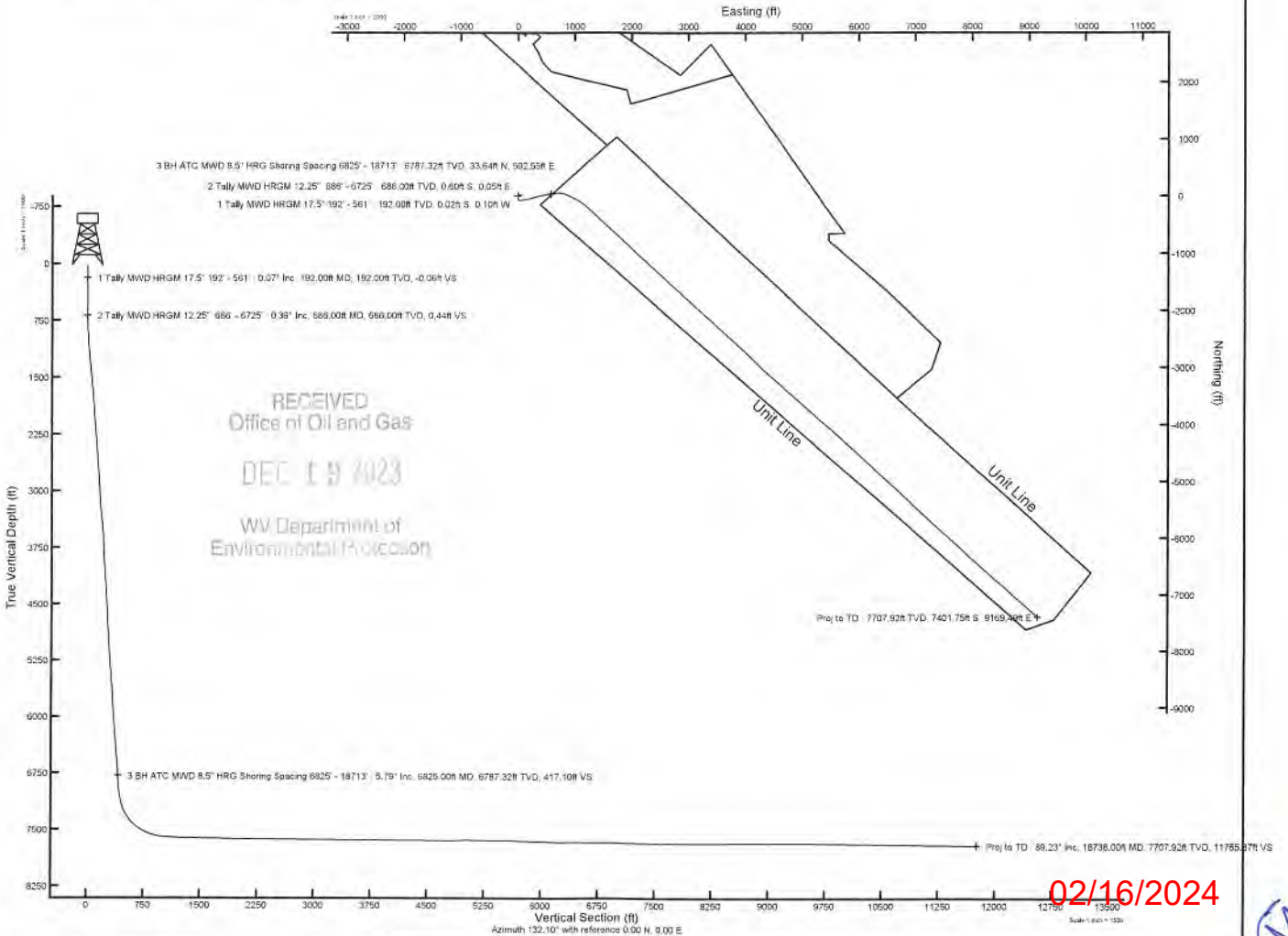

RECEIVED  
 Office of Oil and Gas  
 DEC 19 2023  
 WV Department of  
 Environmental Protection

23

REFERENCE WELLPATH IDENTIFICATION			
Operator	SWN PRODUCTION COMPANY, LLC	Well	William Ritchea WTZ 210H
Field	Wetzel	API	47103035760000
Facility	William Ritchea WTZ Pad	Wellbore	William Ritchea WTZ 210H AWB
Slot	210H		

REPORT SETUP INFORMATION			
Projection System	NAD83 / UTM Zone 17 North, US feet	Software System	WellArchitect® 6.0
North Reference	Grid	User	Tranlam
Scale	0.999611	Report Generated	7/11/2023 at 2:29:12 PM
Convergence at slot	0.22° East	Database	WA_MPL_EASTERNUS_Defn

WELLPATH LOCATION						
	Local coordinates		Grid coordinates		Geographic coordinates	
	North[ft]	East[ft]	Easting[US ft]	Northing[US ft]	Latitude	Longitude
Slot Location	-22.64	-16.17	1736247.47	14406584.89	39°40'10.3441"N	80°39'34.0046"W
Facility Reference Pt			1736263.63	14406607.52	39°40'10.5672"N	80°39'33.7968"W
Field Reference Pt			0.00	0.00	0°00'0.0000"	85°29'19.4780"W

WELLPATH DATUM			
Calculation method	Minimum curvature	SDC 41 (KB) to Facility Vertical Datum	1589.10ft
Horizontal Reference Pt	Slot	SDC 41 (KB) to Mean Sea Level	1589.10ft
Vertical Reference Pt	SDC 41 (KB)	SDC 41 (KB) to Ground Level at Slot (210H)	26.00ft
MD Reference Pt	SDC 41 (KB)	Section Origin	N 0.00, E 0.00 ft
Field Vertical Reference	Mean Sea Level	Section Azimuth	132.10°

RECEIVED  
Office of Oil and Gas  
DEC 19 2023  
WV Department of  
Environmental Protection

REFERENCE WELLPATH IDENTIFICATION			
Operator	SWN PRODUCTION COMPANY, LLC	Well	William Ritchea WTZ 210H
Field	Wetzel	API	47103035760000
Facility	William Ritchea WTZ Pad	Wellbore	William Ritchea WTZ 210H AWB
Slot	210H		

**WELLPATH DATA (205 stations)** † = interpolated, ‡ = extrapolated station

MD [ft]	Inclination [°]	Azimuth [°]	TVD [ft]	Vert Sect [ft]	North [ft]	East [ft]	Grid East [US ft]	Grid North [US ft]	Latitude	Longitude	Closure Dist [ft]	Closure Dir [°]	DLS [°/100ft]
0.00†	0.000	256.730	0.00	0.00	0.00	0.00	1736247.47	14406584.89	39°40'10.3441"N	80°39'34.0046"W	0.00	0.000	0.00
26.00	0.000	256.730	26.00	0.00	0.00	0.00	1736247.47	14406584.89	39°40'10.3441"N	80°39'34.0046"W	0.00	0.000	0.00
192.00	0.070	256.730	192.00	-0.06	-0.02	-0.10	1736247.37	14406584.87	39°40'10.3439"N	80°39'34.0059"W	0.10	256.730	0.04
237.00	0.130	234.660	237.00	-0.08	-0.06	-0.17	1736247.30	14406584.83	39°40'10.3435"N	80°39'34.0068"W	0.18	250.517	0.16
329.00	0.110	229.840	329.00	-0.12	-0.18	-0.32	1736247.15	14406584.71	39°40'10.3424"N	80°39'34.0087"W	0.37	241.108	0.02
419.00	0.020	3.700	419.00	-0.14	-0.22	-0.38	1736247.09	14406584.67	39°40'10.3420"N	80°39'34.0096"W	0.44	240.635	0.14
510.00	0.090	112.450	510.00	-0.08	-0.23	-0.32	1736247.15	14406584.66	39°40'10.3419"N	80°39'34.0087"W	0.39	234.340	0.11
561.00	0.130	76.220	561.00	-0.01	-0.23	-0.22	1736247.25	14406584.66	39°40'10.3418"N	80°39'34.0075"W	0.32	224.370	0.15
686.00	0.390	160.840	686.00	0.44	-0.60	0.05	1736247.52	14406584.29	39°40'10.3382"N	80°39'34.0040"W	0.60	174.940	0.32
778.00	1.520	177.040	777.98	1.58	-2.11	0.22	1736247.69	14406582.78	39°40'10.3232"N	80°39'34.0019"W	2.12	174.088	1.25
868.00	2.980	177.100	867.91	4.08	-5.64	0.40	1736247.87	14406579.25	39°40'10.2883"N	80°39'33.9998"W	5.65	175.957	1.62
959.00	4.580	176.140	958.71	8.36	-11.63	0.76	1736248.23	14406573.27	39°40'10.2292"N	80°39'33.9954"W	11.65	176.246	1.76
1050.00	5.960	176.080	1049.32	14.37	-19.97	1.33	1736248.80	14406564.93	39°40'10.1467"N	80°39'33.9886"W	20.01	176.188	1.52
1142.00	7.170	172.660	1140.72	22.17	-30.43	2.39	1736249.86	14406554.47	39°40'10.0433"N	80°39'33.9755"W	30.52	175.508	1.38
1237.00	6.890	175.410	1235.01	30.82	-41.99	3.60	1736251.07	14406542.92	39°40'9.9290"N	80°39'33.9606"W	42.14	175.094	0.46
1327.00	6.600	170.380	1324.38	38.81	-52.47	4.90	1736252.37	14406532.44	39°40'9.8254"N	80°39'33.9445"W	52.70	174.664	0.73
1418.00	6.340	156.590	1414.81	47.49	-62.24	7.77	1736255.24	14406522.68	39°40'9.7288"N	80°39'33.9083"W	62.72	172.883	1.73
1509.00	6.050	138.980	1505.29	56.82	-70.47	12.91	1736260.38	14406514.45	39°40'9.6472"N	80°39'33.8429"W	71.64	169.614	2.10
1600.00	5.310	120.030	1595.85	65.70	-76.19	19.71	1736267.17	14406508.73	39°40'9.5904"N	80°39'33.7563"W	78.70	165.497	2.20
1691.00	5.470	96.200	1686.46	73.34	-78.77	27.67	1736275.13	14406506.15	39°40'9.5646"N	80°39'33.6546"W	83.49	160.646	2.45
1782.00	6.200	82.410	1776.99	80.03	-78.59	36.85	1736284.31	14406506.33	39°40'9.5661"N	80°39'33.5372"W	86.80	154.877	1.73
1873.00	7.090	78.490	1867.38	86.54	-76.82	47.22	1736294.68	14406508.10	39°40'9.5832"N	80°39'33.4044"W	90.17	148.418	1.10
1963.00	6.980	78.660	1956.70	93.09	-74.63	58.03	1736305.48	14406510.29	39°40'9.6043"N	80°39'33.2662"W	94.54	142.134	0.12
2058.00	7.080	78.890	2050.98	100.04	-72.37	69.43	1736316.88	14406512.55	39°40'9.6263"N	80°39'33.1202"W	100.29	136.186	0.11
2148.00	7.680	79.400	2140.24	107.00	-70.20	80.79	1736328.23	14406514.72	39°40'9.6474"N	80°39'32.9749"W	107.02	130.987	0.67
2239.00	6.980	79.150	2230.49	114.02	-68.04	92.19	1736339.63	14406516.88	39°40'9.6683"N	80°39'32.8289"W	114.58	126.426	0.77
2329.00	7.240	77.570	2319.80	120.61	-65.79	103.10	1736350.53	14406519.13	39°40'9.6901"N	80°39'32.6893"W	122.30	122.540	0.36
2421.00	6.590	77.740	2411.13	127.05	-63.42	113.92	1736361.35	14406521.50	39°40'9.7131"N	80°39'32.5508"W	130.39	119.103	0.71
2511.00	5.710	82.200	2500.61	132.94	-61.71	123.41	1736370.83	14406523.20	39°40'9.7296"N	80°39'32.4295"W	137.98	116.568	1.11
2602.00	5.400	83.140	2591.19	138.67	-60.59	132.14	1736379.56	14406524.33	39°40'9.7404"N	80°39'32.3177"W	145.37	114.631	0.36

RECEIVED  
 Department of  
 Oil and Gas  
 9/20/23

REFERENCE WELLPATH IDENTIFICATION			
Operator	SWN PRODUCTION COMPANY, LLC	Well	William Ritchea WTZ 210H
Field	Wetzel	API	47103035760000
Facility	William Ritchea WTZ Pad	Wellbore	William Ritchea WTZ 210H AWB
Slot	210H		

WELLPATH DATA (205 stations)													
MD [ft]	Inclination [°]	Azimuth [°]	TVD [ft]	Vert Sect [ft]	North [ft]	East [ft]	Grid East [US ft]	Grid North [US ft]	Latitude	Longitude	Closure Dist [ft]	Closure Dir [°]	DLS [°/100ft]
2692.00	6.040	82.210	2680.74	144.50	-59.44	141.04	1736388.45	14406525.47	39°40'9.7514"N	80°39'32.2039"W	153.05	112.852	0.72
2783.00	6.340	80.190	2771.21	150.68	-57.93	150.73	1736398.14	14406526.98	39°40'9.7659"N	80°39'32.0798"W	161.48	111.024	0.41
2924.00	6.040	77.110	2911.39	159.74	-54.95	165.64	1736413.04	14406529.96	39°40'9.7948"N	80°39'31.8891"W	174.51	108.354	0.32
3070.00	5.180	70.590	3056.69	167.29	-51.05	179.34	1736426.74	14406533.86	39°40'9.8329"N	80°39'31.7137"W	186.46	105.889	0.73
3163.00	6.480	79.410	3149.21	172.47	-48.69	188.46	1736435.86	14406536.22	39°40'9.8558"N	80°39'31.5970"W	194.65	104.486	1.69
3254.00	8.610	82.900	3239.41	180.04	-46.90	200.27	1736447.66	14406538.01	39°40'9.8731"N	80°39'31.4459"W	205.69	103.181	2.39
3344.00	9.120	80.550	3328.34	188.88	-44.90	213.99	1736461.37	14406540.01	39°40'9.8923"N	80°39'31.2703"W	218.65	101.850	0.69
3435.00	8.490	81.460	3418.27	197.62	-42.72	227.75	1736475.13	14406542.19	39°40'9.9134"N	80°39'31.0943"W	231.72	100.623	0.71
3525.00	6.980	89.820	3507.45	205.88	-41.71	239.79	1736487.16	14406543.19	39°40'9.9229"N	80°39'30.9402"W	243.39	99.869	2.09
3617.00	5.500	77.670	3598.90	212.58	-40.75	249.68	1736497.06	14406544.15	39°40'9.9320"N	80°39'30.8136"W	252.99	99.270	2.15
3709.00	5.980	61.020	3690.45	216.70	-37.49	258.18	1736505.55	14406547.41	39°40'9.9639"N	80°39'30.7048"W	260.89	98.262	1.88
3799.00	6.200	70.390	3779.94	220.52	-33.59	266.86	1736514.23	14406551.31	39°40'10.0021"N	80°39'30.5936"W	268.97	97.174	1.13
3893.00	6.390	74.230	3873.38	225.71	-30.46	276.68	1736524.04	14406554.44	39°40'10.0327"N	80°39'30.4679"W	278.35	96.283	0.49
3984.00	6.280	68.260	3963.82	230.60	-27.24	286.18	1736533.53	14406557.66	39°40'10.0641"N	80°39'30.3463"W	287.47	95.438	0.73
4073.00	6.480	72.180	4052.27	235.26	-23.90	295.48	1736542.83	14406561.00	39°40'10.0968"N	80°39'30.2272"W	296.44	94.625	0.54
4166.00	6.570	79.850	4144.67	241.15	-21.36	305.71	1736553.06	14406563.54	39°40'10.1215"N	80°39'30.0962"W	306.46	93.997	0.94
4257.00	6.300	82.790	4235.10	247.59	-19.82	315.79	1736563.14	14406565.08	39°40'10.1364"N	80°39'29.9672"W	316.41	93.591	0.47
4348.00	5.800	79.520	4325.59	253.64	-18.35	325.26	1736572.61	14406566.54	39°40'10.1505"N	80°39'29.8460"W	325.78	93.229	0.67
4440.00	6.070	75.050	4417.10	259.11	-16.25	334.54	1736581.87	14406568.64	39°40'10.1709"N	80°39'29.7273"W	334.93	92.781	0.58
4531.00	6.310	73.220	4507.57	264.31	-13.57	343.97	1736591.31	14406571.33	39°40'10.1971"N	80°39'29.6065"W	344.24	92.259	0.34
4624.00	5.690	68.730	4600.06	269.02	-10.42	353.16	1736600.49	14406574.47	39°40'10.2279"N	80°39'29.4889"W	353.31	91.690	0.84
4718.00	5.750	68.830	4693.59	273.23	-7.03	361.89	1736609.22	14406577.86	39°40'10.2610"N	80°39'29.3770"W	361.96	91.113	0.06
4810.00	5.960	70.330	4785.11	277.56	-3.76	370.69	1736618.01	14406581.13	39°40'10.2931"N	80°39'29.2644"W	370.71	90.581	0.28
4900.00	5.560	71.150	4874.65	281.89	-0.78	379.22	1736626.54	14406584.12	39°40'10.3222"N	80°39'29.1552"W	379.22	90.117	0.45
4991.00	6.120	72.890	4965.18	286.51	2.08	388.02	1736635.34	14406586.97	39°40'10.3500"N	80°39'29.0424"W	388.03	89.693	0.65
5082.00	7.390	75.100	5055.55	292.18	5.01	398.32	1736645.63	14406589.90	39°40'10.3786"N	80°39'28.9107"W	398.35	89.280	1.42
5174.00	7.470	79.830	5146.78	299.07	7.59	409.92	1736657.23	14406592.47	39°40'10.4037"N	80°39'28.7621"W	409.99	88.940	0.67
5266.00	6.530	78.830	5238.09	305.85	9.66	420.94	1736668.24	14406594.54	39°40'10.4237"N	80°39'28.6211"W	421.05	88.686	1.03
5357.00	6.060	79.330	5328.54	311.85	11.55	430.74	1736678.04	14406596.43	39°40'10.4420"N	80°39'28.4958"W	430.89	88.464	0.52
5450.00	6.800	87.280	5420.96	318.73	12.72	441.06	1736688.36	14406597.60	39°40'10.4532"N	80°39'28.3637"W	441.24	88.348	1.24

RECEIVED  
 On and Out  
 8/21/23  
 Division of  
 Oil and Gas  
 2023

REFERENCE WELLPATH IDENTIFICATION			
Operator	SWN PRODUCTION COMPANY, LLC	Well	William Ritchea WTZ 210H
Field	Wetzel	API	47103035760000
Facility	William Ritchea WTZ Pad	Wellbore	William Ritchea WTZ 210H AWB
Slot	210H		

WELLPATH DATA (205 stations)													
MD [ft]	Inclination [°]	Azimuth [°]	TVD [ft]	Vert Sect [ft]	North [ft]	East [ft]	Grid East [US ft]	Grid North [US ft]	Latitude	Longitude	Closure Dist [ft]	Closure Dir [°]	DLS [°/100ft]
5540.00	6.220	83.830	5510.38	325.75	13.49	451.23	1736698.52	14406598.38	39°40'10.4605"N	80°39'28.2336"W	451.43	88.287	0.78
5631.00	5.910	81.860	5600.87	332.03	14.69	460.77	1736708.06	14406599.57	39°40'10.4719"N	80°39'28.1115"W	461.00	88.174	0.41
5722.00	6.140	85.140	5691.36	338.35	15.76	470.26	1736717.54	14406600.65	39°40'10.4822"N	80°39'27.9902"W	470.52	88.080	0.45
5815.00	4.830	76.590	5783.94	343.96	17.09	479.02	1736726.30	14406601.98	39°40'10.4950"N	80°39'27.8780"W	479.32	87.956	1.66
5907.00	5.100	74.780	5875.59	348.36	19.06	486.73	1736734.01	14406603.95	39°40'10.5142"N	80°39'27.7793"W	487.11	87.757	0.34
5998.00	6.450	79.610	5966.13	353.66	21.05	495.66	1736742.94	14406605.93	39°40'10.5335"N	80°39'27.6650"W	496.11	87.568	1.58
6090.00	6.960	80.370	6057.50	360.26	22.91	506.24	1736753.51	14406607.79	39°40'10.5515"N	80°39'27.5296"W	506.76	87.409	0.56
6180.00	7.110	84.590	6146.82	367.40	24.35	517.16	1736764.43	14406609.23	39°40'10.5653"N	80°39'27.3899"W	517.74	87.304	0.60
6271.00	6.940	86.950	6237.14	375.08	25.17	528.26	1736775.52	14406610.05	39°40'10.5730"N	80°39'27.2479"W	528.86	87.272	0.37
6362.00	6.900	83.940	6327.48	382.60	26.04	539.19	1736786.45	14406610.92	39°40'10.5812"N	80°39'27.1082"W	539.81	87.235	0.40
6453.00	6.940	81.760	6417.82	389.76	27.41	550.06	1736797.32	14406612.29	39°40'10.5943"N	80°39'26.9690"W	550.75	87.147	0.29
6544.00	7.020	81.350	6508.14	396.79	29.03	561.00	1736808.25	14406613.91	39°40'10.6099"N	80°39'26.8291"W	561.75	87.038	0.10
6635.00	6.660	80.110	6598.49	403.55	30.77	571.70	1736818.94	14406615.65	39°40'10.6267"N	80°39'26.6922"W	572.53	86.919	0.43
6725.00	6.520	83.000	6687.90	410.11	32.29	581.91	1736829.15	14406617.17	39°40'10.6414"N	80°39'26.5615"W	582.81	86.824	0.40
6825.00	5.790	82.530	6787.32	417.10	33.64	592.55	1736839.79	14406618.52	39°40'10.6543"N	80°39'26.4254"W	593.50	86.751	0.73
6917.00	6.540	77.040	6878.79	423.11	35.42	602.25	1736849.49	14406620.30	39°40'10.6715"N	80°39'26.3012"W	603.30	86.634	1.04
7008.00	8.210	78.070	6969.03	429.90	37.93	613.66	1736860.89	14406622.80	39°40'10.6958"N	80°39'26.1552"W	614.83	86.464	1.84
7103.00	15.390	79.040	7061.97	441.47	41.73	632.70	1736879.92	14406626.60	39°40'10.7327"N	80°39'25.9115"W	634.07	86.227	7.56
7195.00	22.500	79.380	7148.93	459.49	47.30	662.03	1736909.24	14406632.17	39°40'10.7867"N	80°39'25.5363"W	663.71	85.913	7.73
7286.00	30.590	87.080	7230.29	486.46	51.70	702.34	1736949.54	14406636.57	39°40'10.8286"N	80°39'25.0205"W	704.24	85.790	9.64
7378.00	36.920	95.900	7306.79	525.37	50.05	753.29	1737000.46	14406634.92	39°40'10.8104"N	80°39'24.3690"W	754.95	86.199	8.69
7469.00	43.340	105.280	7376.39	575.39	38.99	810.71	1737057.87	14406623.86	39°40'10.6989"N	80°39'23.6352"W	811.65	87.247	9.68
7561.00	50.550	111.760	7439.20	636.99	17.46	874.28	1737121.41	14406602.34	39°40'10.4837"N	80°39'22.8234"W	874.45	88.856	9.37
7652.00	57.880	117.650	7492.40	707.38	-13.51	941.17	1737188.27	14406571.39	39°40'10.1751"N	80°39'21.9695"W	941.27	90.822	9.61
7744.00	66.520	120.050	7535.27	786.53	-52.80	1012.35	1737259.42	14406532.11	39°40'9.7842"N	80°39'21.0612"W	1013.72	92.985	9.67
7836.00	72.950	122.270	7567.13	871.22	-97.46	1086.14	1737333.18	14406487.47	39°40'9.3400"N	80°39'20.1198"W	1090.50	95.127	7.35
7927.00	79.290	126.900	7588.96	958.74	-147.60	1158.78	1737405.80	14406437.35	39°40'8.8417"N	80°39'19.1932"W	1168.14	97.259	8.54
8019.00	85.720	133.190	7600.96	1049.80	-206.25	1228.51	1737475.50	14406378.72	39°40'8.2594"N	80°39'18.3044"W	1245.71	99.530	9.73
8110.00	88.370	132.670	7605.65	1140.67	-268.15	1295.05	1737542.01	14406316.85	39°40'7.6452"N	80°39'17.4566"W	1322.52	101.698	2.97
8202.00	88.310	132.300	7608.32	1232.63	-330.26	1362.86	1737609.80	14406254.76	39°40'7.0288"N	80°39'16.5924"W	1402.31	103.622	0.41

RECEIVED  
Department of  
Oil and Gas  
10/20/23  
Initial Production

REFERENCE WELLPATH IDENTIFICATION			
Operator	SWN PRODUCTION COMPANY, LLC	Well	William Ritchea WTZ 210H
Field	Wetzel	API	47103035760000
Facility	William Ritchea WTZ Pad	Wellbore	William Ritchea WTZ 210H AWB
Slot	210H		

WELLPATH DATA (205 stations)													
MD [ft]	Inclination [°]	Azimuth [°]	TVD [ft]	Vert Sect [ft]	North [ft]	East [ft]	Grid East [US ft]	Grid North [US ft]	Latitude	Longitude	Closure Dist [ft]	Closure Dir [°]	DLS [°/100ft]
8293.00	88.650	132.830	7610.73	1323.59	-391.79	1429.86	1737676.77	14406193.25	39°40'6.4181"N	80°39'15.7387"W	1482.57	105.323	0.69
8385.00	88.370	132.220	7613.12	1415.56	-453.95	1497.64	1737744.53	14406131.12	39°40'5.8012"N	80°39'14.8750"W	1564.93	106.863	0.73
8476.00	89.450	133.070	7614.85	1506.53	-515.59	1564.56	1737811.42	14406069.50	39°40'5.1895"N	80°39'14.0222"W	1647.33	108.239	1.51
8568.00	88.800	131.630	7616.26	1598.52	-577.55	1632.55	1737879.38	14406007.56	39°40'4.5745"N	80°39'13.1559"W	1731.70	109.483	1.72
8659.00	89.080	132.940	7617.94	1689.50	-638.77	1699.86	1737946.66	14405946.37	39°40'3.9670"N	80°39'12.2982"W	1815.91	110.595	1.47
8751.00	88.520	132.340	7619.87	1781.48	-701.08	1767.52	1738014.30	14405884.09	39°40'3.3486"N	80°39'11.4361"W	1901.48	111.635	0.89
8842.00	89.170	131.780	7621.70	1872.46	-762.02	1835.07	1738081.82	14405823.16	39°40'2.7437"N	80°39'10.5753"W	1986.99	112.551	0.94
8934.00	89.260	132.600	7622.96	1964.45	-823.80	1903.22	1738149.95	14405761.41	39°40'2.1305"N	80°39'9.7068"W	2073.86	113.405	0.90
9026.00	89.110	133.070	7624.27	2056.43	-886.35	1970.68	1738217.38	14405698.89	39°40'1.5098"N	80°39'8.8472"W	2160.83	114.217	0.54
9117.00	88.770	132.290	7625.96	2147.41	-948.03	2037.57	1738284.24	14405637.24	39°40'0.8977"N	80°39'7.9950"W	2247.32	114.951	0.93
9209.00	88.950	131.560	7627.79	2239.39	-1009.48	2106.00	1738352.65	14405575.80	39°40'0.2877"N	80°39'7.1229"W	2335.45	115.610	0.82
9300.00	89.350	132.940	7629.14	2330.38	-1070.66	2173.35	1738419.97	14405514.65	39°39'59.6806"N	80°39'6.2647"W	2422.76	116.226	1.58
9392.00	89.290	131.950	7630.23	2422.37	-1132.74	2241.24	1738487.83	14405452.59	39°39'59.0644"N	80°39'5.3997"W	2511.23	116.812	1.08
9483.00	89.820	133.030	7630.94	2513.36	-1194.21	2308.34	1738554.90	14405391.15	39°39'58.4544"N	80°39'4.5447"W	2598.95	117.355	1.32
9575.00	90.080	132.460	7631.03	2605.35	-1256.65	2375.90	1738622.44	14405328.73	39°39'57.8347"N	80°39'3.6838"W	2687.76	117.875	0.67
9666.00	89.080	130.290	7631.71	2696.34	-1316.80	2444.18	1738690.69	14405268.61	39°39'57.2376"N	80°39'2.8137"W	2776.32	118.313	2.62
9758.00	89.720	132.040	7632.68	2788.32	-1377.35	2513.43	1738759.92	14405208.08	39°39'56.6366"N	80°39'1.9312"W	2866.08	118.722	2.03
9849.00	89.290	131.720	7633.46	2879.31	-1438.09	2581.18	1738827.64	14405147.36	39°39'56.0336"N	80°39'1.0678"W	2954.76	119.124	0.59
9941.00	90.030	132.530	7634.01	2971.31	-1499.80	2649.42	1738895.85	14405085.68	39°39'55.4211"N	80°39'0.1984"W	3044.47	119.514	1.19
10032.00	90.150	133.130	7633.87	3062.30	-1561.66	2716.15	1738962.56	14405023.84	39°39'54.8072"N	80°38'59.3481"W	3133.09	119.897	0.67
10124.00	89.720	132.580	7633.97	3154.29	-1624.24	2783.60	1739029.98	14404961.29	39°39'54.1862"N	80°38'58.4888"W	3222.82	120.264	0.76
10216.00	89.420	132.190	7634.66	3246.29	-1686.25	2851.55	1739097.90	14404899.30	39°39'53.5707"N	80°38'57.6230"W	3312.82	120.598	0.53
10307.00	89.260	132.490	7635.71	3337.28	-1747.54	2918.81	1739165.13	14404838.03	39°39'52.9624"N	80°38'56.7660"W	3401.96	120.910	0.37
10399.00	89.320	131.570	7636.85	3429.27	-1809.13	2987.14	1739233.44	14404776.47	39°39'52.3511"N	80°38'55.8953"W	3492.27	121.201	1.00
10490.00	89.850	132.460	7637.51	3520.27	-1870.04	3054.74	1739301.02	14404715.59	39°39'51.7465"N	80°38'55.0339"W	3581.69	121.474	1.14
10582.00	89.480	131.810	7638.05	3612.27	-1931.76	3122.97	1739369.21	14404653.89	39°39'51.1339"N	80°38'54.1646"W	3672.14	121.739	0.81
10673.00	89.630	131.750	7638.75	3703.26	-1992.38	3190.82	1739437.05	14404593.29	39°39'50.5321"N	80°38'53.2999"W	3761.78	121.981	0.18
10856.00	89.570	131.980	7640.03	3886.26	-2114.51	3327.11	1739573.27	14404471.21	39°39'49.3199"N	80°38'51.5634"W	3942.18	122.438	0.13
10948.00	90.090	133.250	7640.31	3978.25	-2176.80	3394.81	1739640.95	14404408.94	39°39'48.7017"N	80°38'50.7008"W	4032.76	122.669	1.49
11040.00	89.510	132.560	7640.63	4070.24	-2239.43	3462.20	1739708.31	14404346.34	39°39'48.0801"N	80°38'49.8423"W	4123.33	122.896	0.98

RECEIVED  
10/21/18  
Department of Oil and Gas

REFERENCE WELLPATH IDENTIFICATION				
Operator	SWN PRODUCTION COMPANY, LLC		Well	William Ritchea WTZ 210H
Field	Wetzel		API	47103035760000
Facility	William Ritchea WTZ Pad		Wellbore	William Ritchea WTZ 210H AWB
Slot	210H			

WELLPATH DATA (205 stations)													
MD [ft]	Inclination [°]	Azimuth [°]	TVD [ft]	Vert Sect [ft]	North [ft]	East [ft]	Grid East [US ft]	Grid North [US ft]	Latitude	Longitude	Closure Dist [ft]	Closure Dir [°]	DLS [°/100ft]
11131.00	89.540	132.490	7641.38	4161.23	-2300.94	3529.26	1739775.35	14404284.85	39°39'47.4696"N	80°38'48.9879"W	4213.07	123.103	0.08
11223.00	89.970	131.490	7641.77	4253.23	-2362.48	3597.64	1739843.70	14404223.33	39°39'46.8587"N	80°38'48.1166"W	4303.99	123.292	1.18
11314.00	89.780	132.800	7641.97	4344.23	-2423.54	3665.11	1739911.14	14404162.29	39°39'46.2526"N	80°38'47.2569"W	4393.92	123.475	1.45
11406.00	89.750	132.390	7642.35	4436.23	-2485.81	3732.83	1739978.84	14404100.05	39°39'45.6346"N	80°38'46.3941"W	4484.78	123.661	0.45
11498.00	89.820	132.040	7642.70	4528.22	-2547.63	3800.97	1740046.95	14404038.26	39°39'45.0211"N	80°38'45.5259"W	4575.78	123.832	0.39
11589.00	89.910	132.420	7642.91	4619.22	-2608.79	3868.35	1740114.31	14403977.12	39°39'44.4140"N	80°38'44.6674"W	4665.82	123.995	0.43
11681.00	89.690	132.760	7643.23	4711.22	-2671.05	3936.08	1740182.01	14403914.89	39°39'43.7960"N	80°38'43.8045"W	4756.81	124.161	0.44
11772.00	89.750	132.650	7643.68	4802.21	-2732.77	4002.95	1740248.86	14403853.19	39°39'43.1835"N	80°38'42.9526"W	4846.82	124.321	0.14
11864.00	91.820	134.070	7642.41	4894.17	-2795.92	4069.83	1740315.71	14403790.06	39°39'42.5567"N	80°38'42.1006"W	4937.68	124.489	2.73
11956.00	91.390	132.310	7639.84	4986.12	-2858.86	4136.88	1740382.73	14403727.15	39°39'41.9321"N	80°38'41.2465"W	5028.60	124.647	1.97
12047.00	88.650	135.570	7639.81	5077.05	-2921.99	4202.39	1740448.21	14403664.04	39°39'41.3056"N	80°38'40.4120"W	5118.41	124.812	4.68
12139.00	89.720	134.330	7641.11	5168.92	-2986.98	4267.49	1740513.29	14403599.08	39°39'40.6608"N	80°38'39.5829"W	5208.98	124.990	1.78
12230.00	88.980	134.300	7642.15	5259.85	-3050.55	4332.60	1740578.37	14403535.54	39°39'40.0300"N	80°38'38.7536"W	5298.80	125.149	0.81
12322.00	89.110	132.050	7643.68	5351.81	-3113.48	4399.68	1740645.42	14403472.63	39°39'39.4054"N	80°38'37.8991"W	5389.89	125.286	2.45
12413.00	89.020	131.060	7645.17	5442.80	-3173.84	4467.76	1740713.48	14403412.30	39°39'38.8062"N	80°38'37.0316"W	5480.34	125.389	1.09
12505.00	89.350	131.310	7646.47	5534.78	-3234.41	4536.99	1740782.69	14403351.74	39°39'38.2049"N	80°38'36.1494"W	5571.87	125.485	0.45
12596.00	89.080	129.360	7647.72	5625.72	-3293.30	4606.35	1740852.02	14403292.87	39°39'37.6201"N	80°38'35.2656"W	5662.54	125.563	2.16
12688.00	87.450	131.170	7650.51	5717.62	-3352.73	4676.52	1740922.15	14403233.47	39°39'37.0300"N	80°38'34.3715"W	5754.18	125.638	2.65
12780.00	88.280	131.080	7653.93	5809.55	-3413.20	4745.77	1740991.38	14403173.03	39°39'36.4297"N	80°38'33.4891"W	5845.70	125.724	0.91
12871.00	88.580	130.940	7656.43	5900.50	-3472.89	4814.41	1741060.00	14403113.36	39°39'35.8371"N	80°38'32.6144"W	5936.29	125.805	0.36
12962.00	88.460	130.710	7658.78	5991.44	-3532.36	4883.25	1741128.81	14403053.91	39°39'35.2467"N	80°38'31.7373"W	6026.91	125.881	0.29
13054.00	88.000	131.170	7661.62	6083.38	-3592.62	4952.71	1741198.24	14402993.68	39°39'34.6484"N	80°38'30.8522"W	6118.52	125.957	0.71
13145.00	88.550	130.820	7664.36	6174.32	-3652.29	5021.36	1741266.87	14402934.03	39°39'34.0561"N	80°38'29.9774"W	6209.13	126.030	0.72
13237.00	88.800	131.740	7666.49	6266.29	-3712.97	5090.48	1741335.96	14402873.38	39°39'33.4536"N	80°38'29.0967"W	6300.72	126.107	1.04
13328.00	88.090	130.790	7668.96	6357.24	-3772.96	5158.86	1741404.31	14402813.41	39°39'32.8580"N	80°38'28.2255"W	6391.33	126.180	1.30
13420.00	91.350	134.290	7669.41	6449.21	-3835.14	5226.62	1741472.05	14402751.25	39°39'32.2408"N	80°38'27.3623"W	6482.74	126.270	5.20
13512.00	88.210	129.840	7669.76	6541.17	-3896.76	5294.90	1741540.29	14402689.66	39°39'31.6292"N	80°38'26.4925"W	6574.24	126.351	5.92
13603.00	89.450	130.020	7671.62	6632.09	-3955.15	5364.66	1741610.03	14402631.29	39°39'31.0493"N	80°38'25.6034"W	6665.04	126.400	1.38
13695.00	89.260	129.450	7672.65	6724.00	-4013.96	5435.40	1741680.75	14402572.50	39°39'30.4653"N	80°38'24.7019"W	6756.88	126.445	0.65
13786.00	89.320	131.570	7673.78	6814.96	-4073.06	5504.58	1741749.90	14402513.42	39°39'29.8785"N	80°38'23.8204"W	6847.65	126.499	2.33

REFERENCE WELLPATH IDENTIFICATION			
Operator	SWN PRODUCTION COMPANY, LLC	Well	William Ritchea WTZ 210H
Field	Wetzel	API	47103035760000
Facility	William Ritchea WTZ Pad	Wellbore	William Ritchea WTZ 210H AWB
Slot	210H		

WELLPATH DATA (205 stations)													
MD [ft]	Inclination [°]	Azimuth [°]	TVD [ft]	Vert Sect [ft]	North [ft]	East [ft]	Grid East [US ft]	Grid North [US ft]	Latitude	Longitude	Closure Dist [ft]	Closure Dir [°]	DLS [°/100ft]
13878.00	89.350	133.190	7674.85	6906.95	-4135.07	5572.53	1741817.82	14402451.44	39°39'29.2630"N	80°38'22.9548"W	6939.16	126.577	1.76
13970.00	91.230	132.380	7674.38	6998.93	-4197.56	5640.05	1741885.31	14402388.98	39°39'28.6428"N	80°38'22.0947"W	7030.62	126.658	2.23
14061.00	86.710	129.800	7676.02	7089.87	-4257.34	5708.60	1741953.83	14402329.22	39°39'28.0493"N	80°38'21.2213"W	7121.31	126.715	5.72
14153.00	91.420	132.870	7677.52	7181.82	-4318.07	5777.64	1742022.85	14402268.51	39°39'27.4463"N	80°38'20.3417"W	7212.96	126.774	6.11
14244.00	87.480	130.450	7678.39	7272.78	-4378.54	5845.60	1742090.79	14402208.07	39°39'26.8460"N	80°38'19.4758"W	7303.61	126.834	5.08
14336.00	89.350	131.840	7680.94	7364.73	-4439.04	5914.85	1742160.01	14402147.59	39°39'26.2453"N	80°38'18.5935"W	7395.31	126.888	2.53
14428.00	90.120	133.280	7681.36	7456.72	-4501.26	5982.61	1742227.74	14402085.39	39°39'25.6277"N	80°38'17.7304"W	7486.86	126.957	1.77
14519.00	89.690	133.120	7681.51	7547.71	-4563.56	6048.95	1742294.05	14402023.12	39°39'25.0094"N	80°38'16.8854"W	7577.33	127.032	0.50
14611.00	90.310	133.280	7681.51	7639.69	-4626.54	6116.02	1742361.09	14401960.16	39°39'24.3843"N	80°38'16.0312"W	7668.80	127.106	0.70
14703.00	89.450	132.390	7681.71	7731.68	-4689.08	6183.48	1742428.53	14401897.64	39°39'23.7635"N	80°38'15.1719"W	7760.34	127.174	1.35
14794.00	89.480	133.320	7682.56	7822.67	-4750.97	6250.19	1742495.21	14401835.78	39°39'23.1491"N	80°38'14.3222"W	7850.90	127.240	1.02
14886.00	90.090	134.260	7682.90	7914.62	-4814.64	6316.60	1742561.59	14401772.14	39°39'22.5173"N	80°38'13.4763"W	7942.30	127.315	1.22
14977.00	89.540	133.120	7683.20	8005.59	-4877.50	6382.40	1742627.37	14401709.30	39°39'21.8935"N	80°38'12.6383"W	8032.74	127.387	1.39
15069.00	90.000	133.040	7683.56	8097.57	-4940.33	6449.59	1742694.54	14401646.49	39°39'21.2698"N	80°38'11.7824"W	8124.29	127.452	0.51
15160.00	89.570	132.850	7683.91	8188.56	-5002.33	6516.20	1742761.12	14401584.52	39°39'20.6544"N	80°38'10.9339"W	8214.88	127.513	0.52
15252.00	89.660	132.640	7684.52	8280.55	-5064.77	6583.77	1742828.66	14401522.10	39°39'20.0346"N	80°38'10.0734"W	8306.50	127.570	0.25
15343.00	90.520	132.870	7684.38	8371.55	-5126.55	6650.58	1742895.45	14401460.35	39°39'19.4214"N	80°38'9.2223"W	8397.13	127.627	0.98
15435.00	91.940	132.280	7682.41	8463.52	-5188.78	6718.31	1742963.15	14401398.15	39°39'18.8037"N	80°38'8.3596"W	8488.76	127.680	1.67
15527.00	90.430	132.850	7680.50	8555.49	-5250.99	6786.06	1743030.87	14401335.95	39°39'18.1861"N	80°38'7.4967"W	8580.41	127.732	1.75
15618.00	90.310	132.430	7679.92	8646.49	-5312.63	6853.00	1743097.78	14401274.34	39°39'17.5742"N	80°38'6.6440"W	8671.08	127.784	0.48
15710.00	90.460	133.290	7679.30	8738.48	-5375.21	6920.43	1743165.19	14401211.78	39°39'16.9531"N	80°38'5.7851"W	8762.72	127.837	0.95
15801.00	90.120	133.340	7678.84	8829.45	-5437.64	6986.64	1743231.38	14401149.38	39°39'16.3335"N	80°38'4.9418"W	8853.31	127.893	0.38
15893.00	89.600	133.010	7679.06	8921.44	-5500.58	7053.73	1743298.44	14401086.46	39°39'15.7087"N	80°38'4.0873"W	8944.92	127.948	0.67
15985.00	89.720	132.790	7679.61	9013.43	-5563.21	7121.13	1743365.81	14401023.86	39°39'15.0871"N	80°38'3.2289"W	9036.58	127.998	0.27
16076.00	89.260	133.030	7680.42	9104.41	-5625.16	7187.77	1743432.43	14400961.93	39°39'14.4721"N	80°38'2.3800"W	9127.24	128.047	0.57
16168.00	89.690	132.420	7681.26	9196.40	-5687.58	7255.36	1743499.98	14400899.54	39°39'13.8525"N	80°38'1.5192"W	9218.93	128.093	0.81
16259.00	89.540	131.910	7681.87	9287.40	-5748.67	7322.80	1743567.41	14400838.48	39°39'13.2461"N	80°38'0.6601"W	9309.71	128.133	0.58
16351.00	89.820	131.920	7682.39	9379.40	-5810.12	7391.26	1743635.84	14400777.04	39°39'12.6360"N	80°37'59.7880"W	9401.51	128.170	0.30
16442.00	90.370	131.920	7682.24	9470.40	-5870.92	7458.97	1743703.52	14400716.27	39°39'12.0324"N	80°37'58.9255"W	9492.31	128.206	0.60
16534.00	90.150	130.900	7681.82	9562.39	-5931.77	7527.97	1743772.50	14400655.44	39°39'11.4282"N	80°37'58.0466"W	9584.17	128.237	1.13

APPROVED  
 DATE: 6/19/2018  
 BY: [Signature]  
 TITLE: [Title]



REFERENCE WELLPATH IDENTIFICATION			
Operator	SWN PRODUCTION COMPANY, LLC	Well	William Ritchea WTZ 210H
Field	Wetzel	API	47103035760000
Facility	William Ritchea WTZ Pad	Wellbore	William Ritchea WTZ 210H AWB
Slot	210H		

WELLPATH DATA (205 stations) † = interpolated, ‡ = extrapolated station													
MD [ft]	Inclination [°]	Azimuth [°]	TVD [ft]	Vert Sect [ft]	North [ft]	East [ft]	Grid East [US ft]	Grid North [US ft]	Latitude	Longitude	Closure Dist [ft]	Closure Dir [°]	DLS [°/100ft]
16626.00	88.710	132.560	7682.73	9654.38	-5993.00	7596.62	1743841.12	14400594.24	39°39'10.8203"N	80°37'57.1721"W	9675.99	128.270	2.39
16717.00	89.750	132.180	7683.96	9745.37	-6054.32	7663.85	1743908.32	14400532.94	39°39'10.2116"N	80°37'56.3158"W	9766.75	128.308	1.22
16809.00	89.880	132.510	7684.25	9837.37	-6116.29	7731.84	1743976.29	14400470.99	39°39'9.5964"N	80°37'55.4497"W	9858.52	128.346	0.39
16900.00	89.720	131.590	7684.57	9928.36	-6177.24	7799.42	1744043.83	14400410.07	39°39'8.9913"N	80°37'54.5890"W	9949.33	128.380	1.03
16992.00	89.850	133.300	7684.92	10020.36	-6239.33	7867.30	1744111.69	14400348.01	39°39'8.3750"N	80°37'53.7243"W	10041.10	128.417	1.86
17083.00	88.800	133.160	7685.99	10111.33	-6301.65	7933.60	1744177.96	14400285.71	39°39'7.7564"N	80°37'52.8800"W	10131.77	128.460	1.16
17175.00	89.780	132.460	7687.13	10203.32	-6364.16	8001.09	1744245.42	14400223.22	39°39'7.1358"N	80°37'52.0205"W	10223.50	128.499	1.31
17266.00	88.710	132.320	7688.33	10294.31	-6425.51	8068.29	1744312.60	14400161.90	39°39'6.5268"N	80°37'51.1645"W	10314.28	128.533	1.19
17358.00	89.080	131.060	7690.10	10386.29	-6486.68	8136.98	1744381.26	14400100.75	39°39'5.9194"N	80°37'50.2896"W	10406.13	128.561	1.43
17450.00	89.260	132.050	7691.43	10478.27	-6547.70	8205.81	1744450.07	14400039.75	39°39'5.3136"N	80°37'49.4127"W	10497.99	128.588	1.09
17541.00	89.050	132.070	7692.78	10569.26	-6608.66	8273.37	1744517.60	14399978.82	39°39'4.7084"N	80°37'48.5523"W	10588.81	128.617	0.23
17633.00	89.200	131.950	7694.18	10661.25	-6670.22	8341.72	1744585.92	14399917.28	39°39'4.0972"N	80°37'47.6817"W	10680.64	128.647	0.21
17724.00	89.080	132.010	7695.55	10752.24	-6731.08	8409.36	1744653.54	14399856.44	39°39'3.4930"N	80°37'46.8201"W	10771.48	128.675	0.15
17816.00	89.080	131.810	7697.02	10844.23	-6792.53	8477.82	1744721.97	14399795.02	39°39'2.8830"N	80°37'45.9482"W	10863.32	128.702	0.22
17908.00	89.140	127.490	7698.45	10936.11	-6851.21	8548.63	1744792.75	14399736.36	39°39'2.3001"N	80°37'45.0460"W	10955.28	128.710	4.70
17999.00	89.350	132.250	7699.65	11027.01	-6909.53	8618.44	1744862.54	14399678.07	39°39'1.7210"N	80°37'44.1565"W	11046.23	128.720	5.24
18091.00	89.110	132.540	7700.89	11119.00	-6971.55	8686.38	1744930.45	14399616.07	39°39'1.1052"N	80°37'43.2912"W	11138.03	128.750	0.41
18182.00	89.350	133.620	7702.11	11209.97	-7033.70	8752.84	1744996.88	14399553.95	39°39'0.4883"N	80°37'42.4449"W	11228.76	128.785	1.22
18274.00	89.320	131.310	7703.18	11301.96	-7095.80	8820.70	1745064.72	14399491.87	39°38'59.8717"N	80°37'41.5806"W	11320.56	128.815	2.51
18365.00	89.140	131.150	7704.40	11392.94	-7155.77	8889.13	1745133.12	14399431.92	39°38'59.2763"N	80°37'40.7089"W	11411.47	128.834	0.26
18457.00	89.510	130.170	7705.49	11484.90	-7215.71	8958.92	1745202.88	14399372.00	39°38'58.6810"N	80°37'39.8199"W	11503.42	128.849	1.14
18548.00	89.600	131.840	7706.19	11575.88	-7275.42	9027.58	1745271.52	14399312.32	39°38'58.0882"N	80°37'38.9452"W	11594.35	128.866	1.84
18640.00	89.600	131.890	7706.84	11667.88	-7336.81	9096.10	1745340.01	14399250.95	39°38'57.4786"N	80°37'38.0726"W	11686.22	128.889	0.05
18713.00	89.230	131.270	7707.58	11740.87	-7385.26	9150.70	1745394.59	14399202.52	39°38'56.9976"N	80°37'37.3771"W	11759.14	128.906	0.99
18738.00‡	89.230	131.270	7707.92	11765.87	-7401.75	9169.49	1745413.37	14399186.04	39°38'56.8339"N	80°37'37.1378"W	11784.11	128.911	0.00

RECEIVED  
 Office of Oil and Gas  
 DEC 19 2011  
 WV Department of Environmental Protection

REFERENCE WELLPATH IDENTIFICATION			
Operator	SWN PRODUCTION COMPANY, LLC	Well	William Ritchea WTZ 210H
Field	Wetzel	API	47103035760000
Facility	William Ritchea WTZ Pad	Wellbore	William Ritchea WTZ 210H AWB
Slot	210H		

HOLE & CASING SECTIONS - Ref Wellbore: William Ritchea WTZ 210H AWB Ref Wellpath: William Ritchea WTZ 210H awp Proj: 18738'									
String/Diameter	Start MD [ft]	End MD [ft]	Interval [ft]	Start TVD [ft]	End TVD [ft]	Start N/S [ft]	Start E/W [ft]	End N/S [ft]	End E/W [ft]
13.375in Casing	26.00	615.00	589.00	26.00	615.00	0.00	0.00	-0.28	-0.11

TARGETS								
Name	TVD [ft]	North [ft]	East [ft]	Grid East [US ft]	Grid North [US ft]	Latitude	Longitude	Shape
1st perf-W. Rit. 5H	7434.10	488.12	533.49	1736780.75	14407072.82	39°40'15.1481"N	80°39'27.1585"W	point
William Ritchea WTZ 210H LP rev4	7600.00	-225.92	1243.23	1737490.21	14406359.06	39°40'8.0645"N	80°39'18.1172"W	point
William Ritchea WTZ 210H BHL rev 3	7713.00	-7396.01	9175.46	1745419.34	14399191.78	39°38'56.8903"N	80°37'37.0611"W	point

WELLPATH COMPOSITION - Ref Wellbore: William Ritchea WTZ 210H AWB Ref Wellpath: William Ritchea WTZ 210H awp Proj: 18738'							
Start MD [ft]	End MD [ft]	Positional Uncertainty Model	Log Name/Comment	Wellbore	Survey Date		
26.00	561.00	OWSG MWD rev2 + HRGM	1 Tally MWD HRGM 17.5" 192' - 561'	William Ritchea WTZ 210H AWB	7/2/2023		
561.00	6725.00	OWSG MWD rev2 + HRGM	2 Tally MWD HRGM 12.25" 686' - 6725'	William Ritchea WTZ 210H AWB	7/2/2023		
6725.00	18738.00	BH AutoTrak Curve/eXpress (2019) (HRGM, Short spacing)	3 BH ATC MWD 8.5" HRG Shoring Spacing 6825' - 18713'	William Ritchea WTZ 210H AWB	7/2/2023		

RECEIVED  
 Office of Oil and Gas  
 DEC 19 2023  
 WV Department of  
 Environmental Protection