

Antero Resources Corporation

Appalachian Basin

Furbee Pad

Wetzel County

Quadrangle: Pine Grove
Watershed: Fishing Creek
District: Green
Date: 4-05-2021

07/14/2023

Antero Resources Well No. Gauss 1H

Antero Resources Corporation



See Detail
Page 2

Gauss Unit 1H
Bottom Hole

6,399' to Top Hole

6,971' to Bottom Hole

LATITUDE 39 - 35 - 00

LONGITUDE 80 - 42 - 30

5,438' to Bottom Hole

9,749' to Top Hole

Notes
West Virginia Coordinate System of 1927, North Zone based upon Differential GPS Measurements.
Well No. Gauss Unit 1H Top Hole coordinates are
N: 387,203.02' Latitude: 39°33'23.65"
E: 1,652,912.70' Longitude: 80°43'51.71"
Bottom Hole coordinates are
N: 391,521.26' Latitude: 39°34'06.26"
E: 1,652,398.77' Longitude: 80°43'59.02"
UTM Zone 17, NAD 1983
Top Hole Coordinates Bottom Hole Coordinates
N: 4,378,586.143m N: 4,379,899.113m
E: 523,122.386m E: 522,943.902m
Plat orientation and corner and well references are based upon the grid north meridian.
Well location references are based upon the magnetic meridian.

Notes:
Well No. Gauss Unit 1H
UTM Zone 17, NAD 1927
Top Hole Coordinates
N: 14,364,695.85'
E: 1,716,229.09'
Point of Entry Coordinates
N: 14,365,189.78'
E: 1,716,884.34'
Bottom Hole Coordinates
N: 14,369,003.47'
E: 1,715,643.35'

Well Location References (NTS)

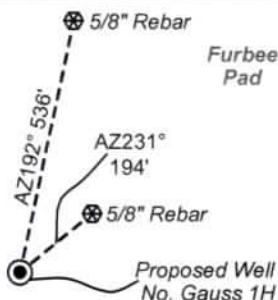

I, the undersigned, hereby certify that this plat is correct to the best of my knowledge and belief and shows all the information required by law and the rules issued and prescribed by the Department of Environmental Protection.

Bradley D. Miller
Bradley D. Miller, P.S. 2167

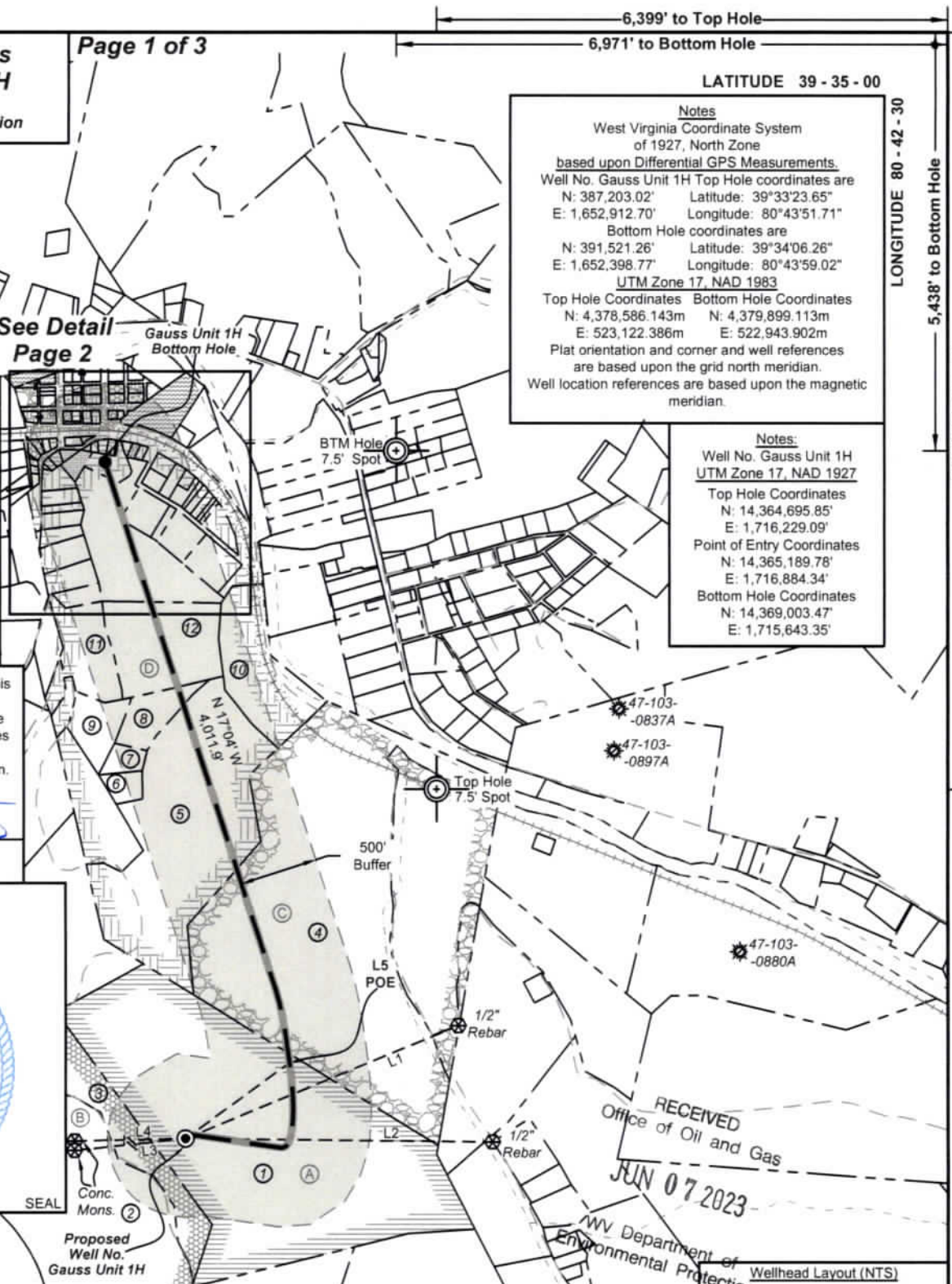

RECEIVED
Office of Oil and Gas
JUN 07 2023

WV Department of Environmental Protection

Wellhead Layout (NTS)

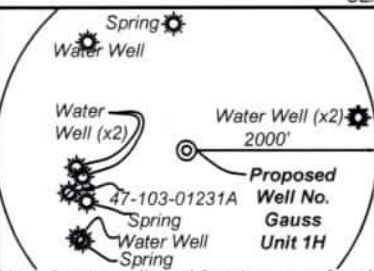

Note: 6 water wells and 3 springs were found within 2000' of proposed well. No occupied dwellings or buildings 2,500 square feet or larger used to house or shelter dairy cattle or poultry husbandry are located within 625' of the center of the well pad.

Legend

- Proposed gas well
- Monument, as noted
- Existing Well, as noted
- Digitized Well, as noted
- Creek or Drain
- Road
- Railroad
- Surface boundary (approx.)
- Interior surface tracts (approx.)

Bearing	Dist.
L1 S 67°31' W	1,887.4'
L2 N 89°20' W	1,962.5'
L3 N 83°54' E	1,628.2'
L4 N 88°50' E	1,652.6'
L5 N 53°57' E	820.8'

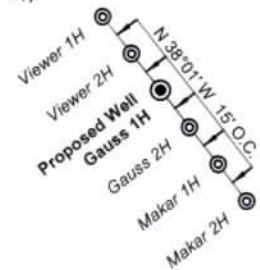

FILE NO: 121-34-G-18
DRAWING NO: Gauss Unit 1H Well Plat
SCALE: 1" = 2000'
MINIMUM DEGREE OF ACCURACY: Submeter
PROVEN SOURCE OF ELEVATION: WV DOT, Harrisville, WV

STATE OF WEST VIRGINIA
DEPARTMENT OF ENVIRONMENTAL PROTECTION
OIL AND GAS DIVISION

DATE: May 31 2023
OPERATOR'S WELL NO. Gauss Unit 1H
API WELL NO
47 - 103 - 03585
STATE COUNTY PERMIT

WELL TYPE: OIL GAS LIQUID INJECTION WASTE DISPOSAL
(IF GAS) PRODUCTION: STORAGE DEEP SHALLOW
LOCATION: ELEVATION: As-Built 1211' WATERSHED: Fishing Creek QUADRANGLE: Pine Grove
DISTRICT: Green COUNTY: Wayne
SURFACE OWNER: Resources Corp. ACREAGE: 58.1 58.1; 83.8;
ROYALTY OWNER: James Allen Sell; Marilyn Halley Seeley; Antero Minerals, LLC; LEASE NO: ACREAGE: 629.58633;
PROPOSED WORK: DRILL CONVERT DRILL DEEPER FRACTURE OR STIMULATE PLUG OFF OLD FORMATION
 PERFORATE NEW FORMATION OTHER PHYSICAL CHANGE IN WELL (SPECIFY) _____ 7,500' TVD
 PLUG AND ABANDON CLEAN OUT AND REPLUG TARGET FORMATION: Marcellus Shale ESTIMATED DEPTH: 13,300' MD

WELL OPERATOR: Antero Resources Corporation DESIGNATED AGENT: Kevin Ellis
ADDRESS: 1615 Wynkoop Street ADDRESS: 535 White Oaks Blvd.
Denver, CO 80202 Bridgeport, WV 26330

**Antero Resources
Well No. Gauss 1H**

Antero Resources Corporation



Leases	
A	James Allen Sell
B	William R. Stalnaker
C	Marilyn Halley Seeley
D	Antero Minerals, LLC
E	Robert P. Willoughby
F	Pearl Lynn Larimore
G	Timothy C. Wilcox
H	Morgan S. Long, et ux
I	Patricia Ruth Cain
J	Dennis G. Haught
K	Antero Minerals, LLC
L	CSX Transportation, Inc.
M	Ricky L. & Amy F. Bassett
N	CSX Transportation, Inc.

Leases	
O	Wavelene Garrison Grantham
P	Gordon F. & Regeena S. Yost
Q	Church of Christ of Reader, WV
R	Donald L. & Cshawn L. Smith
S	Judy Kocher
T	Timothy Lynn & Michael A. McDiffit
U	Daniel S. Brown, et ux
V	Reader Lodge No. 282 IOOF
W	Weldon P. Williams
X	Darla J. Brinker
Y	Donald L., II & Cshawn L. Smith
Z	Thomas S. Haught, et ux
AA	Donald L., II & Cshawn L. Smith

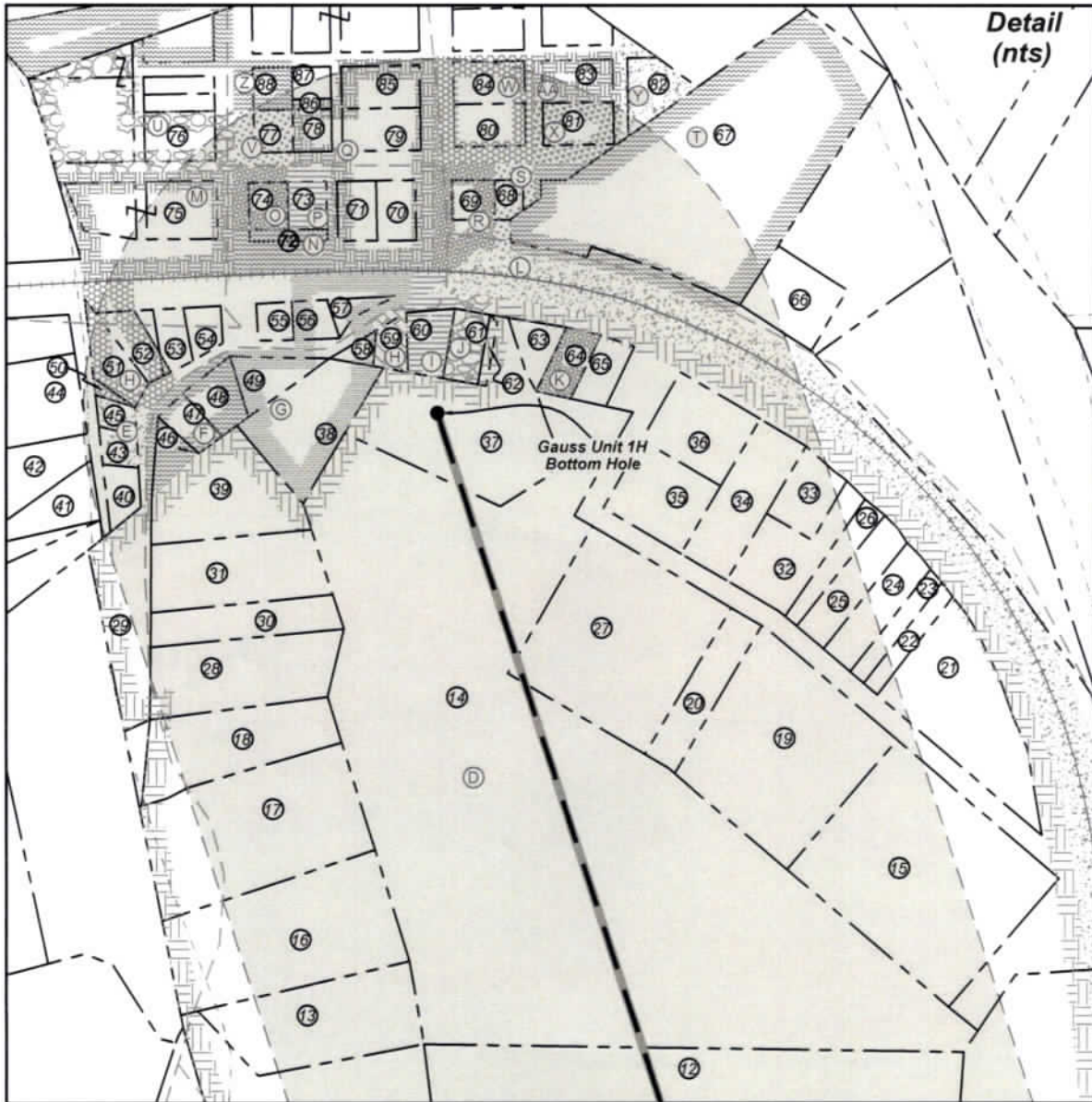

FILE NO: 121-34-G-18
 DRAWING NO: Gauss Unit 1H Well Plat
 SCALE: 1" = 2000'
 MINIMUM DEGREE OF ACCURACY:
Submeter
 PROVEN SOURCE OF ELEVATION:
WVDOT, Harrisville, WV

STATE OF WEST VIRGINIA
 DEPARTMENT OF ENVIRONMENTAL PROTECTION
OIL AND GAS DIVISION

DATE: May 31 2023
 OPERATOR'S WELL NO. Gauss Unit 1H
 API WELL NO
47 - 103 - 03585
 STATE COUNTY PERMIT

WELL TYPE: OIL GAS LIQUID INJECTION WASTE DISPOSAL
 (IF GAS) PRODUCTION: STORAGE DEEP SHALLOW

LOCATION: ELEVATION: As-Built 1211' WATERSHED: Fishing Creek QUADRANGLE: Pine Grove
 DISTRICT: Green COUNTY: West **07/14/2023**
 SURFACE OWNER: Antero Resources Corp. ACREAGE: 58.1 58.1; 83.8;
 ROYALTY OWNER: James Allen Sell; Marilyn Halley Seeley; Antero Minerals, LLC; LEASE NO: _____ ACREAGE: 629.58633;
 PROPOSED WORK: DRILL CONVERT DRILL DEEPER FRACTURE OR STIMULATE PLUG OFF OLD FORMATION
 PERFORATE NEW FORMATION OTHER PHYSICAL CHANGE IN WELL (SPECIFY) _____ 7,500' TVD
 PLUG AND ABANDON CLEAN OUT AND REPLUG TARGET FORMATION: Marcellus Shale ESTIMATED DEPTH: 13,300' MD

WELL OPERATOR: Antero Resources Corporation DESIGNATED AGENT: Kevin Ellis
 ADDRESS: 1615 Wynkoop Street ADDRESS: 535 White Oaks Blvd.
Denver, CO 80202 Bridgeport, WV 26330



ID	TM-Par	Owner	Bk/Pg	Acres
1	17-12	Antero Resources Corp.	483/888	58.10
2	17-60	Ross Bucher	411/765	79.00
3	17-1	Antero Resources Corp.	483/888	15.35
4	13-71	Charles R. & Kay L. Blair	387/577	63.11
5	13-70	Doris Ruth Haught, et al	AP112/912	33.78
6	13-70.2	Cory R. & Mary L. Haught	449/135	1.04
7	13-70.4	Adriene N. Derby	459/95	0.93
8	13-70.3	Tom & Betty C. Haught	303/65	2.59
9	13-70	Doris Ruth Haught, et al	AP112/912	33.78
10	13-47	Charles J. Stillwagoner III	460/921	8.00
11	13-46.1	Douglas A. & Shirley J. Bucher	300/188	4.42
12	29-69.1	Donald L. II & Cshawn L. Smith	350/465	8.80
13	13-46	Carol Knapp Revocable Trust	437/796	0.70
14	29-69	Leroy E. & Virginia R. Derby	278/70	10.20
15	29-96	Brenda Ellen Glasscock	472/33	1.65
16	29-68	Carol Knapp Revocable Trust	437/796	1.30
17	29-67	Carol Knapp Revocable Trust	437/796	1.33
18	29-67.1	Tully S. Vanwinkle	68/379	0.57
19	29-95	Brian Keith Haught	420/216	1.26
20	29-94	Brian Keith Haught	420/216	0.27
21	29-89	Brenda Ellen Glasscock	472/33	0.61
22	29-88	Brian Keith Haught	420/216	0.10
23	29-87	Russell Craig Bates	429/422	0.10
24	29-86	Russell Craig Bates	429/422	0.21
25	29-79	James Stacey Anderson	402/596	0.22
26	29-78	James Stacey Anderson	402/596	0.13
27	29-90	Robert Eugene Eastham	388/59	1.25
28	29-66	Tully S. Vanwinkle	68/379	0.63
29	29-41	Faith Fellowship Ministries	477/796	0.45
30	29-65	Tully S. Vanwinkle	68/379	0.31
31	29-64	Tully S. Vanwinkle	68/379	0.59
32	29-77	Roland Lee & Jo Ann Pittman	333/528	0.32
33	29-76	Roland Lee & Jo Ann Pittman	333/528	0.18
34	29-75	Janet Lea Higginbotham	WB 8/638	0.38
35	29-80	John M. & Robin Lynn Pittman	295/446	0.30
36	29-73	John M. & Robin Lynn Pittman	295/446	0.33
37	29-56	Morgan S. & Chelcie L. Long	440/102	0.87
38	29-63	Timothy C. & Christena Wilcox	445/894	0.42
39	29-61	Pearl Lynn Larrimore	403/430	0.81
40	29-42	Faith Fellowship Ministries	477/796	0.09
41	29-33	Faith Fellowship Ministries	477/796	0.15
42	29-32	David & Debra Lancaster	261/469	0.47
43	29-43	Jami Barnes	442/231	0.06
44	29-31	David & Debra Lancaster	333/167	1.50

ID	TM-Par	Owner	Bk/Pg	Acres
45	29-44	Jami Barnes	442/231	0.06
46	29-60	Pearl Lynn Larrimore	403/430	0.03
47	29-59	Pearl Lynn Larrimore	403/430	0.08
48	29-58	Pearl Lynn Larrimore	403/430	0.12
49	29-57	Timothy C. & Christena Wilcox	445/894	0.14
50	29-45	William Leccese	484/153	0.01
51	29-46	William Leccese	484/153	0.19
52	29-47	William Leccese	484/153	0.12
53	29-47.1	Rhonda Thomas	431/798	0.09
54	29-48	Rhonda Thomas	431/798	0.08
55	29-49	Rusty Thomas	448/834	0.06
56	29-50	Timothy C. & Christena Wilcox	445/894	0.07
57	29-51	Timothy C. & Christena Wilcox	445/894	0.07
58	29-62	Timothy C. & Christena Wilcox	445/894	0.02
59	29-52	Morgan S. & Chelcie L. Long	440/102	0.07
60	29-53	Patricia Ruth Cain	292/649	0.12
61	29-54	Dennis G. Haught	355/427	0.11
62	29-55	Dennis G. Haught	355/427	0.02
63	29-70	Jonathan E. & Alexa R. Mason	440/489	0.13
64	29-71	Jonathan E. & Alexa R. Mason	440/489	0.12
65	29-72	Jonathan E. & Alexa R. Mason	440/489	0.12
66	29-36	Trinity United Methodist	---/---	0.20
67	29-34	Timothy Lynn & Michael Allen McDiffitt	399/54	2.32
68	29-24	Judy Kocher	WB80/936	0.05
69	29-25	Donald L. II & Cshawn Smith	464/819	0.08
70	29-26	Reader Church of Christ	322/452	0.11
71	29-27	Reader Church of Christ	333/123	0.11
72	29-114	B&O RR Co.	---/---	0.04
73	29-28	Gordon F. & Regenna S. Yost	317/17	0.08
74	29-29	Wavelene Garrison Grantham	WB46/458	0.08
75	28-31	Ricky L. & Amy F. Bassett	481/782	0.36
76	28-30	Daniel S. & Leah M. Brown	411/328	0.16
77	29-8	IOOF No. 282	102/514	0.08
78	29-11	Reader Church of Christ	434/275	0.08
79	29-13	Reader Church of Christ	428/429	0.15
80	29-23	Weldon Williams	377/402	0.14
81	29-20	Darla J. Brinker	371/308	0.14
82	29-19	Dillon Leroy Edgell	444/504	0.15
83	29-21	Cathy Brown	399/473	0.14
84	29-22	Weldon Williams	377/402	0.14
85	29-12	Church of Christ	169/109	0.15
86	29-10	Reader Church of Christ	433/886	0.02
87	29-9	Gary White	359/665	0.06
88	29-7	Betty & Thomas Haught	410/850	0.08

FILE NO: 121-34-G-18
 DRAWING NO: Gauss Unit 1H Well Plat
 SCALE: 1" = 2000'
 MINIMUM DEGREE OF ACCURACY:
Submeter
 PROVEN SOURCE OF ELEVATION:
WVDOT, Harrisville, WV



RECEIVED
 Date: May 31 2023
 Office: Oil and Gas
 OPERATOR'S WELL NO. Gauss Unit 1H
 JUN 07 2023
 APPLICANT WELL NO
 WV Department of Environmental Protection
 103 - 09585
 COUNTY PERMIT

WELL TYPE: OIL GAS LIQUID INJECTION WASTE DISPOSAL
 (IF GAS) PRODUCTION: STORAGE DEEP SHALLOW
 LOCATION: ELEVATION: As-Built 1211' WATERSHED: Fishing Creek QUADRANGLE: Pine Grove
 DISTRICT: Green COUNTY: Wetzel
 SURFACE OWNER: Antero Resources Corp. ACREAGE: 58.1 58.1; 83.8;
 ROYALTY OWNER: James Allen Sell; Marilyn Halley Seeley; Antero Minerals, LLC; LEASE NO: _____ ACREAGE: 629.58633;
 PROPOSED WORK: DRILL CONVERT DRILL DEEPER FRACTURE OR STIMULATE PLUG OFF OLD FORMATION
 PERFORATE NEW FORMATION OTHER PHYSICAL CHANGE IN WELL (SPECIFY) _____ 7,500' TVD
 PLUG AND ABANDON CLEAN OUT AND REPLUG TARGET FORMATION: Marcellus Shale ESTIMATED DEPTH: 13,300' MD

WELL OPERATOR: Antero Resources Corporation DESIGNATED AGENT: Kevin Ellis
 ADDRESS: 1615 Wynkoop Street ADDRESS: 535 White Oaks Blvd.
Denver, CO 80202 Bridgeport, WV 26330