

47 10 3-03 59.0

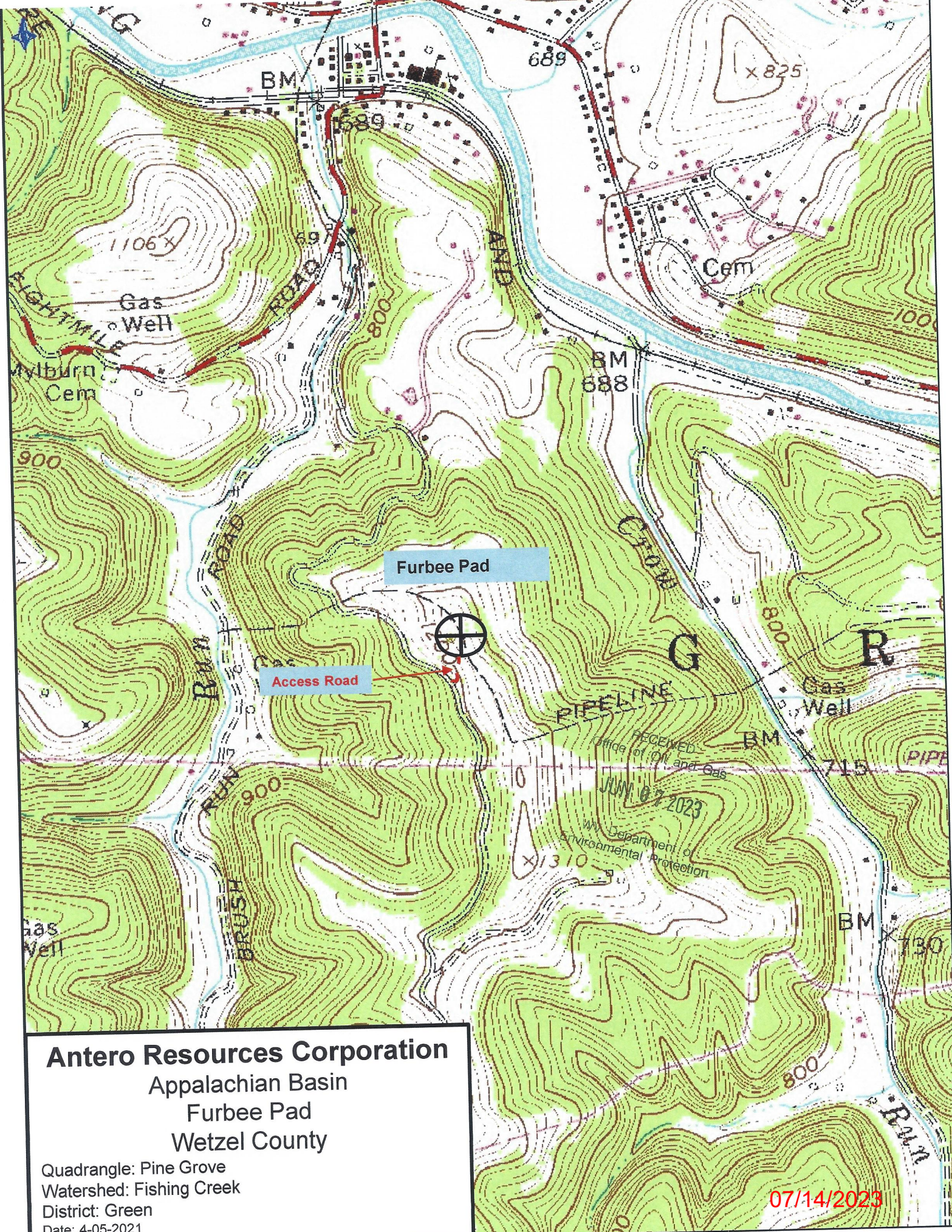

**Antero Resources Corporation**  
 Appalachian Basin  
 Furbee Pad  
 Wetzel County

Quadrangle: Pine Grove  
 Watershed: Fishing Creek  
 District: Green  
 Date: 4-05-2021

07/14/2023



**Antero Resources  
Well No. Viewer 2H**

Antero Resources Corporation

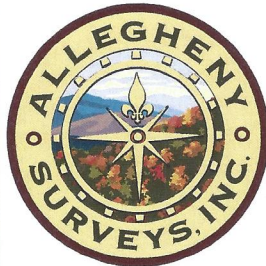

Page 1 of 4

11,066' to Bottom Hole

6,409' to Top Hole

TOP HOLE LATITUDE 39 - 35 - 00  
BTM HOLE LATITUDE 39 - 37 - 30

LONGITUDE 80 - 42 - 30

**Notes**  
West Virginia Coordinate System of 1927, North Zone based upon Differential GPS Measurements.  
Well No. Viewer Unit 2H Top Hole coordinates are  
N: 387,214.84' Latitude: 39°33'23.77"  
E: 1,652,903.46' Longitude: 80°43'51.83"  
Bottom Hole coordinates are  
N: 401,009.87' Latitude: 39°35'39.49"  
E: 1,648,431.37' Longitude: 80°44'51.37"  
UTM Zone 17, NAD 1983  
Top Hole Coordinates Bottom Hole Coordinates  
N: 4,378,589.697m N: 4,382,769.687m  
E: 523,119.511m E: 521,687.037m  
Plat orientation and corner and well references are based upon the grid north meridian.  
Well location references are based upon the magnetic meridian.

**Well Location References (NTS)**

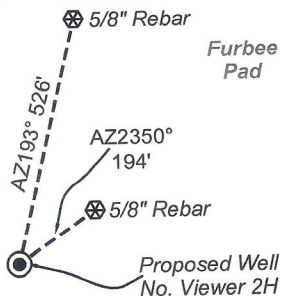

I, the undersigned, hereby certify that this plat is correct to the best of my knowledge and belief and shows all the information required by law and the rules issued and prescribed by the Department of Environmental Protection.

*Bradley D. Miller*  
Bradley D. Miller, P.S. 2167

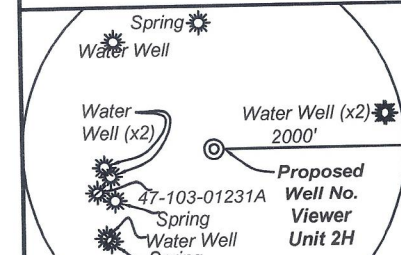
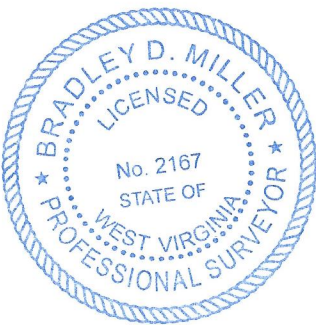

Note: 6 water wells and 3 springs were found within 2000' of proposed well. No occupied dwellings or buildings 2,500 square feet or larger used to house or shelter dairy cattle or poultry husbandry are located within 625' of the center of the well pad.

**Wellhead Layout (NTS)**

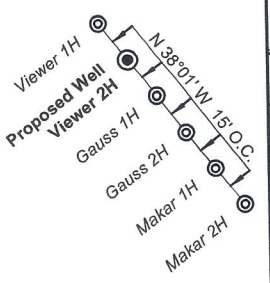

**Legend**

- Proposed gas well
- ⊗ Monument, as noted
- ⊙ Existing Well, as noted
- ⊛ Digitized Well, as noted
- Creek or Drain
- Road
- Railroad Right-of-Way
- Surface boundary (approx.)
- Interior surface tracts (approx.)

**Notes:**  
Well No. Viewer Unit 2H UTM Zone 17, NAD 1927  
Top Hole Coordinates  
N: 14,364,707.51'  
E: 1,716,219.66'  
Point of Entry Coordinates  
N: 14,364,949.15'  
E: 1,716,072.90'  
Bottom Hole Coordinates  
N: 14,378,421.37'  
E: 1,711,519.49'

Bearing	Dist.
L1 S 67°57' W	1,891.4'
L2 N 89°00' W	1,971.9'
L3 N 83°27' E	1,620.4'
L4 N 88°24' E	1,634.7'
L5 N 30°19' W	282.8'

**STATE OF WEST VIRGINIA  
DEPARTMENT OF ENVIRONMENTAL PROTECTION  
OIL AND GAS DIVISION**

FILE NO: 27-34-G-18  
DRAWING NO: Viewer Unit 2H Well Plat  
SCALE: 1" = 2000'  
MINIMUM DEGREE OF ACCURACY: Submeter  
PROVEN SOURCE OF ELEVATION: WVDOT, Harrisville, WV

DATE: May 31 2023  
OPERATOR'S WELL NO. Viewer Unit 2H  
API WELL NO  
47 - 103 - 03590  
STATE COUNTY PERMIT

WELL TYPE:  OIL  GAS  LIQUID INJECTION  WASTE DISPOSAL  
(IF GAS) PRODUCTION:  STORAGE  DEEP  SHALLOW

LOCATION: ELEVATION: As-Built 1,211' WATERSHED: Fishing Creek QUADRANGLE: Pine Grove 0.18720; 0.5; 0.125; 0.48210; 0.950; 0.91802; 1.96875; 1.1590; 79.46;  
DISTRICT: Green COUNTY: Wayne 14; 75.6; 62.50; 32; 42.11;  
SURFACE OWNER: Resources Corp. Antero ACREAGE: 58.1 4.6875; 48.00; 453; 6; 42; 23.95; 85.5; 39.398;  
ROYALTY OWNER: James Allen Sell; William R. Stalnaker; George Neason Myers, et ux; Antero Minerals, LLC (2); LEASE NO: ACREAGE: 3.58; 11.86; 49.25; 9.79;

PROPOSED WORK:  DRILL  CONVERT  DRILL DEEPER  FRACTURE OR STIMULATE  PLUG OFF OLD FORMATION  
 PERFORATE NEW FORMATION  OTHER PHYSICAL CHANGE IN WELL (SPECIFY) 7,500' TVD  
 PLUG AND ABANDON  CLEAN OUT AND REPLUG TARGET FORMATION: Marcellus Shale ESTIMATED DEPTH: 22,800' MD

WELL OPERATOR: Antero Resources Corporation DESIGNATED AGENT: Kevin Ellis  
ADDRESS: 1615 Wynkoop Street ADDRESS: 535 White Oaks Blvd.  
Denver, CO 80202 Bridgeport, WV 26330



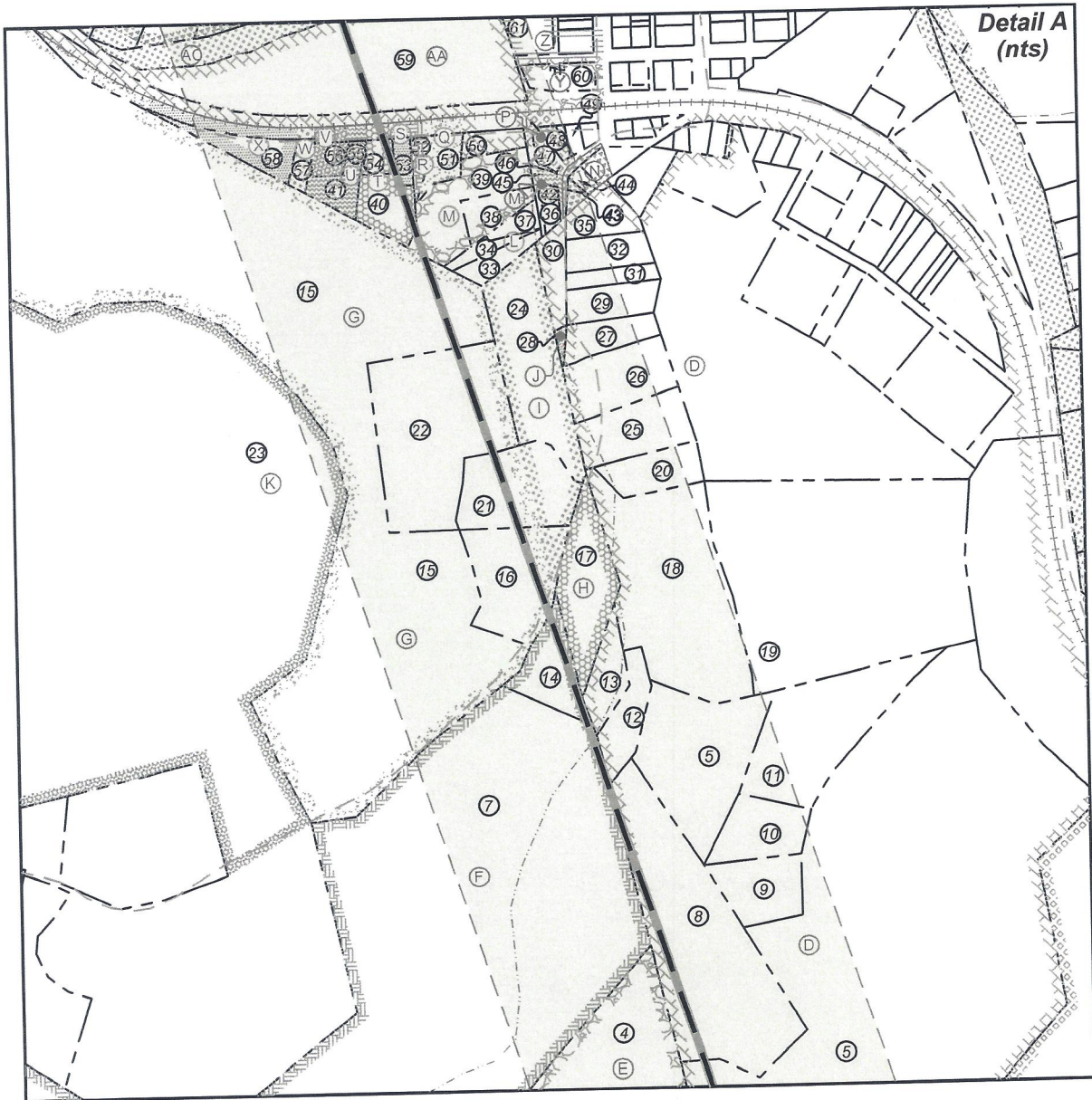
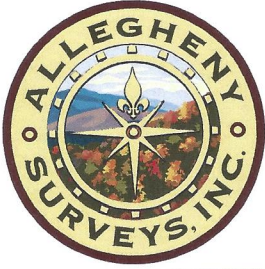

FILE NO: 27-34-G-18  
DRAWING NO: Viewer Unit 2H Well Plat  
SCALE: 1" = 2000'  
MINIMUM DEGREE OF ACCURACY:  
Submeter  
PROVEN SOURCE OF ELEVATION:  
WVDOT, Harrisville, WV

**STATE OF WEST VIRGINIA**  
DEPARTMENT OF ENVIRONMENTAL PROTECTION  
**OIL AND GAS DIVISION**



DATE: May 31 2023  
OPERATOR'S WELL NO. Viewer Unit 2H  
API WELL NO  
47 - 103 - 03590  
STATE COUNTY PERMIT

WELL TYPE:  OIL  GAS  LIQUID INJECTION  WASTE DISPOSAL  
(IF GAS) PRODUCTION:  STORAGE  DEEP  SHALLOW

LOCATION: ELEVATION: As-Built 1,211' WATERSHED: Fishing Creek QUADRANGLE: Pine Grove 0.18720; 0.5; 0.125;  
DISTRICT: Green Antero Belinda A. Henderson; Brenda Ellen Glasscock; Stanley J. Ashcraft, Jr.; Thelma Jean Tennant; COUNTY: Wayne 0.48210; 0.950; 0.91802;  
SURFACE OWNER: Resources Corp. Margaret Lancaster, et vir; Nancy B. Hatfield, et al; James D. Highley, et ux; Thomas R. Yost, Sr. (2); ACREAGE: 58.1 1,96875; 1.1590; 79.46;  
ROYALTY OWNER: James Allen Sell; William R. Stalnaker; George Neason Myers, et ux; Antero Minerals, LLC (2); LEASE NO: ACREAGE: 4.6875; 48.00; 453; 6; 629.38833; 1.42; 42.11;  
42; 23.95; 85.5; 39.396;  
3.58; 11.86; 49.25; 9.79;

PROPOSED WORK:  DRILL  CONVERT  DRILL DEEPER  FRACTURE OR STIMULATE  PLUG OFF OLD FORMATION  
 PERFORATE NEW FORMATION  OTHER PHYSICAL CHANGE IN WELL (SPECIFY) \_\_\_\_\_ 7,500' TVD  
 PLUG AND ABANDON  CLEAN OUT AND REPLUG TARGET FORMATION: Marcellus Shale ESTIMATED DEPTH: 22,800' MD

WELL OPERATOR: Antero Resources Corporation DESIGNATED AGENT: Kevin Ellis  
ADDRESS: 1615 Wynkoop Street ADDRESS: 535 White Oaks Blvd.  
Denver, CO 80202 Bridgeport, WV 26330



**Antero Resources  
Well No. Viewer 2H**

Antero Resources Corporation

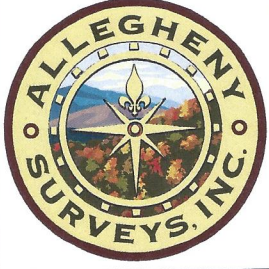

Leases	
A	James Allen Sell
B	William R. Stalnaker
C	Marilyn Halley Seeley
D	Antero Minerals, LLC
E	George Neason Myers, et ux
F	Antero Minerals, LLC
G	Dean H. Bucher
H	Dean H. Bucher
I	Dean H. Bucher
J	Dean H. Bucher
K	Dean H. Bucher
L	Faith Fellowship Ministries
M	David P. Lancaster, et ux
N	Robert P. Willoughby
O	Pearl Lynn Larimore
P	John S. Starkey

Leases	
Q	Belinda A. Henderson
R	Thomas R. Yost Sr., et ux
S	Thomas R. Yost Sr., et ux
T	Stanley J. Ashcraft, Jr.
U	Brenda Ellen Glasscock
V	Patrick B. Glasscock, et ux
W	Brenda Ellen Glascock
X	Kenneth Calvin Willard
Y	William E. Duke, et ux
Z	Daniel S. Brown, et ux
AA	Ruby Lynn Price
AB	Thomas S. Haught, et ux
AC	WVDNR
AD	Shiben Estates Inc.
AE	Nola Jean Parks
AF	Howard D. Bucher, et ux
AG	Thelma Jean Tennant

Leases	
AH	Kimberly K. McCale
AI	Bryan J. Lemasters, et ux
AJ	Daniel W. Henderson, et ux
AK	Michael Paul Melott, et ux
AL	Jack E. Daken, et ux
AM	Chesapeake Appalachia, LLC
AN	Margaret Lancaster, et vir
AO	Mary E. Snider
AP	Shiben Estates Inc.
AQ	Barbara Anne Amos King
AR	Lillian Priscilla Grimm
AS	Valerie Preat
AT	Valerie Preat
AU	James D. Highley, et ux
AV	Nancy B. Hatfield, et al
AW	Maria Delia Estrada
AX	Nancy B. Hatfield, et al

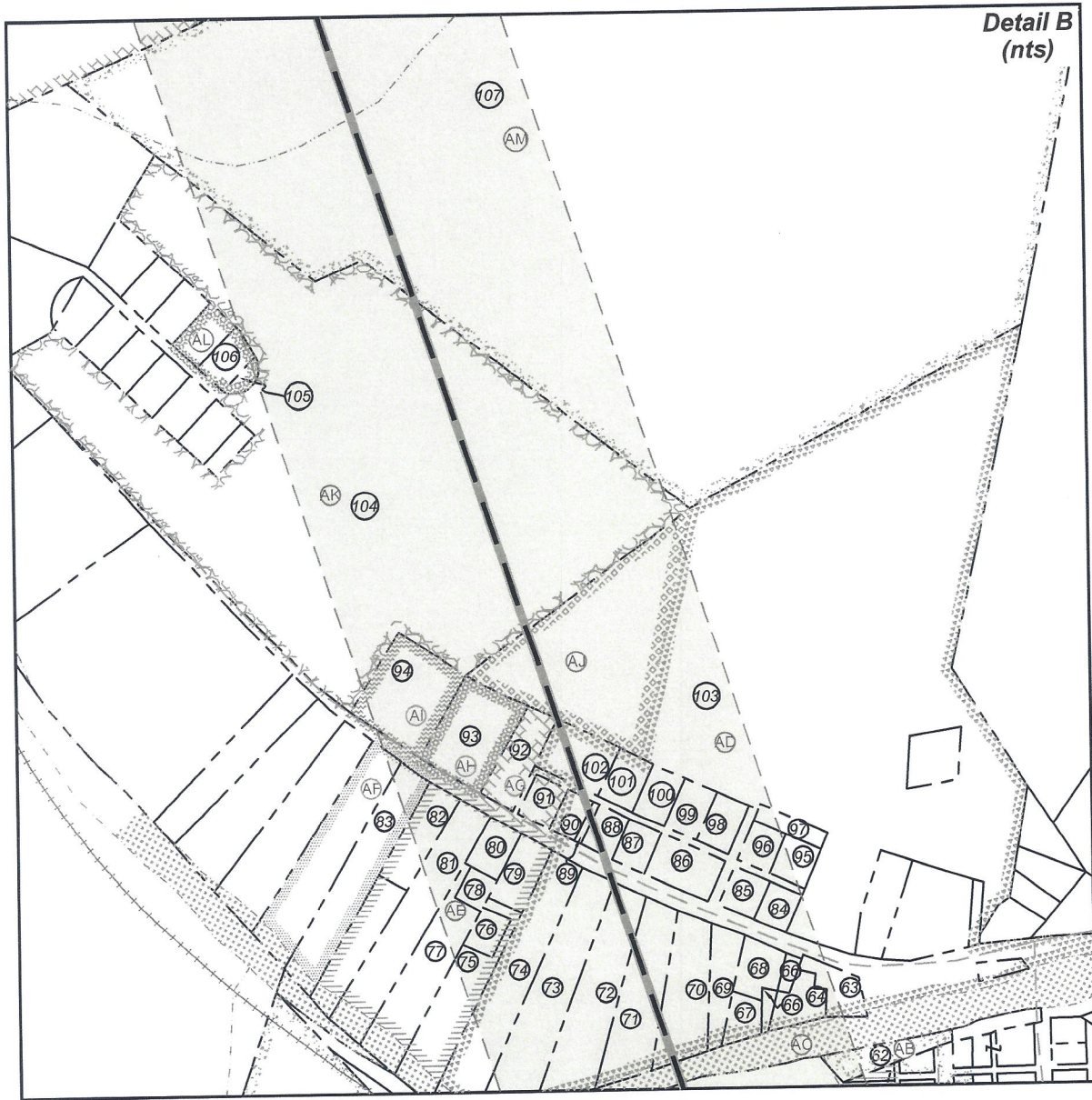

FILE NO: 27-34-G-18  
 DRAWING NO: Viewer Unit 2H Well Plat  
 SCALE: 1" = 2000'  
 MINIMUM DEGREE OF ACCURACY: Submeter  
 PROVEN SOURCE OF ELEVATION: WVDOT, Harrisville, WV

**STATE OF WEST VIRGINIA**  
 DEPARTMENT OF ENVIRONMENTAL PROTECTION  
**OIL AND GAS DIVISION**



DATE: May 31 2023  
 OPERATOR'S WELL NO. Viewer Unit 2H  
 API WELL NO  
 47 - 103 - 03596  
 STATE COUNTY PERMIT

WELL TYPE:  OIL  GAS  LIQUID INJECTION  WASTE DISPOSAL  
 (IF GAS) PRODUCTION:  STORAGE  DEEP  SHALLOW

LOCATION: ELEVATION: As-Built 1,211' WATERSHED: Fishing Creek QUADRANGLE: Pine Grove  
 DISTRICT: Green COUNTY: Wetzell  
 SURFACE OWNER: Antero Resources Corp. ACREAGE: 58.1  
 ROYALTY OWNER: James Allen Sell; William R. Stalnaker, George Neason Myers, et ux; Antero Minerals, LLC (2); LEASE NO: ACREAGE: 3.58; 11.86; 49.25; 9.79;  
 PROPOSED WORK:  DRILL  CONVERT  DRILL DEEPER  FRACTURE OR STIMULATE  PLUG OFF OLD FORMATION  
 PERFORATE NEW FORMATION  OTHER PHYSICAL CHANGE IN WELL (SPECIFY) 7,500' TVD  
 PLUG AND ABANDON  CLEAN OUT AND REPLUG TARGET FORMATION: Marcellus Shale ESTIMATED DEPTH: 22,800' MD

WELL OPERATOR: Antero Resources Corporation DESIGNATED AGENT: Kevin Ellis  
 ADDRESS: 1615 Wynkoop Street ADDRESS: 535 White Oaks Blvd.  
 Denver, CO 80202 Bridgeport, WV 26330



**Antero Resources  
Well No. Viewer 2H**

Antero Resources Corporation

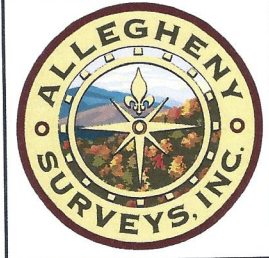

ID	TM-Par	Owner	Bk/Pg	Acres
1	17-12	Antero Resources Corp.	483/888	58.10
2	17-60	Ross Bucher	411/765	79.00
3	17-1	Antero Resources Corp	483/888	15.35
4	13-69.1	Donald L. Mason	410/759	14.00
5	13-70	Doris Ruth Haught, et al	AP112/912	33.78
6	13-71	Charles R. & Kay L. Blair	387/577	63.11
7	13-69	Donald L. Mason	410/759	69.61
8	13-70.1	Clark B. & Linda J. Haught	422/525	4.75
9	13-70.2	Cory R. & Mary L. Haught	449/135	1.04
10	13-70.4	Adriene N. Derby	459/95	0.93
11	13-70.3	Tom & Betty C. Haught	303/65	2.59
12	13-59	Douglas A. & Shirley J. Bucher	460/929	0.75
13	13-58	Douglas A. & Shirley J. Bucher	363/292	0.85
14	13-57	Carol S. Bishop	433/306	0.89
15	13-90	Coastal Forest Resources Co.	444/105	36.13
16	13-44	Nicholas Lee Henderson	421/85	1.75
17	13-45	Janet Lee Higginbotham	368/196	1.25
18	13-46.1	Douglas A. & Shirley J. Bucher	300/188	4.42
19	29-69.1	Donald L. II & Cshawn L. Smith	350/465	8.80
20	13-46	Carol Knapp Revocable Trust	437/796	0.70
21	13-84	Nathan L. Anderson	359/611	5.12
22	13-91	Coastal Forest Resources Co.	444/105	3.47
23	13-43	John R. & Johnna S. Harter	437/867	46.25
24	13-45.1	Faith Fellowship Ministries Church	398/491	2.58
25	29-68	Carol Knapp Revocable Trust	437/796	1.30
26	29-67	Carol Knapp Revocable Trust	437/796	1.33
27	29-67.1	Tully S. Vanwinkle	68/379	0.57
28	29-40	Faith Fellowship Ministries	477/796	0.19
29	29-66	Tully S. Vanwinkle	68/379	0.63
30	29-41	Faith Fellowship Ministries	477/796	0.45
31	29-65	Tully S. Vanwinkle	68/379	0.31
32	29-64	Tully S. Vanwinkle	68/379	0.59
33	29-39	Faith Fellowship Ministries	477/796	0.20
34	29-38	Faith Fellowship Ministries	477/796	0.20
35	29-61	Pearl Lynn Larrimore	403/430	0.81
36	29-42	Faith Fellowship Ministries	477/786	0.09
37	29-33	Faith Fellowship Ministries	477/796	0.15
38	29-32	David & Debra Lancaster	261/469	0.47
39	29-31	David & Debra Lancaster	333/167	1.50
40	28-48	Stanley J. Ashcraft, Jr. & Suzanna L. Miller	469/840	0.70
41	28-41	Brenda Ellen Taylor & Patrick Wayne Glasscock	442/539	0.38
42	29-43	Jami Barnes	442/231	0.06
43	29-60	Pearl Lynn Larrimore	403/430	0.03
44	29-59	Pearl Lynn Larrimore	403/430	0.08
45	29-44	Jami Barnes	442/231	0.06
46	29-45	William Leccese	484/153	0.01
47	29-46	William Leccese	484/153	0.19
48	29-47	William Leccese	484/153	0.12
49	29-47.1	Rhonda Thomas	431/798	0.09
50	29-30	Sara Larrimore, et al	AP107/99	0.20
51	28-40	Belinda Ann Gump	404/403	0.50
52	28-39	Thomas R. Yost, Sr., et al	361/125	0.17
53	28-38	Thomas R. & Billie Jo Yost	397/286	0.19
54	28-36	Stanley J. Ashcraft, Jr. & Suzanna L. Miller	469/840	0.25
55	28-37	Brenda Ellen Taylor & Patrick Wayne Glasscock	442/539	0.11
56	28-35	Brenda Ellen Taylor & Patrick Wayne Glasscock	442/758	0.23
57	28-34	Brenda Ellen Taylor & Patrick Wayne Glasscock	442/736	0.17
58	28-42	George Keck	71/258	0.50
59	28-25	Sara Larrimore, et al	AP107/99	4.50

ID	TM-Par	Owner	Bk/Pg	Acres
60	28-31	Ricky L. & Amy F. Bassett	481/782	0.36
61	28-27	Daniel S. & Leah M. Brown	411/328	0.38
62	28-26	Thomas S. & Betty C. Haught	415/521	0.99
63	28-33.1	Robin D. Stillwagner	467/508	0.45
64	28-33.2	Thomas L. & Emily Marie Gifford	421/20	0.37
65	28-32.1	Benjamin J. Dotson	447/881	0.10
66	28-33	Benjamin J. Dotson	447/881	0.18
67	28-24.1	Joetta Cain	436/186	0.31
68	28-24	Benjamin J. Dotson	447/881	0.34
69	28-23	Cathy D. Brown	431/594	0.55
70	28-22	Justin D. Carter	452/12	1.23
71	28-21	Ronnie Robinson	392/14	1.48
72	28-20	Thelma L. Brideman	MS10/131	1.82
73	28-19	Ricky L. & Cindy S. Wade	420/441	2.07
74	28-18	Ronald S. Anderson	417/63	2.14
75	28-17.2	Darel L. & Joyce A. Ueltschy	424/365	1.33
76	28-17.1	Darel L. & Joyce A. Ueltschy	424/365	0.25
77	28-15	Nathan D. & Jacqueline Johnson	404/399	1.46
78	28-16	Nathan D. & Jacqueline Johnson	404/399	0.20
79	28-17	Sharyn D. Utt	360/348	0.49
80	28-15.1	Christopher David Thomas	365/112	0.35
81	28-14	Benjamin F. & Ruth Kocher	242/14	1.83
82	28-12	Benjamin F. Kocher	202/264	0.67
83	28-11	Howard D. & Clara Mae Bucher	285/483	1.62
84	28-44	David Lewis Anderson	242/483	---
85	28-3	David Anderson, et al	WB57/511	---
86	28-4	Valerie D. Piatt	423/422	---
87	28-5	Alex M. Henderson	471/165	---
88	28-2.1	Michael A. Briggs	454/625	---
89	28-2.8	Michael A. Briggs	454/625	---
90	28-2.2	Toy L. & Thelma Jean Tennant	219/111	---
91	28-6	Toy L. & Thelma Jean Tennant	408/326	---
92	28-2.7	Toy L. & Thelma Jean Tennant	228/265	---
93	28-2.6	Phillip Bassett	440/61	---
94	28-1	Bryan J. & Christina D. Lemasters	315/335	---
95	28-46	David Lewis Anderson	WB57/511	---
96	28-45	David Lewis Anderson	WB57/511	---
97	28-47	David Lewis Anderson	WB57/511	---
98	28-2.5	Robert L. Yoho	452/434	---
99	28-2.4	Robert L. Yoho	452/434	---
100	28-2.3	Michael A. Briggs	454/625	---
101	28-2	Michael A. Briggs	454/625	---
102	28-2.9	Toy L. & Thelma Jean Tennant	253/20	---
103	13-21	Daniel W. & Ruth A. Henderson	244/111	30.95
104	13-19.1	Michael Paul & Tamatha Lynn Melott	379/128	23.95
105	13A-28	Jack E. & Constance D. Dakan	354/503	0.10
106	13A-27	Jack E. & Constance D. Dakan	268/88	0.34
107	13-13	Linda M. Headley	385/209	85.5
108	13-6	Margaret Lancaster	333/440	39.39
109	8-43	Debra Key Fluharty, et al	368/559	35.00
110	8-28	Nancy B. Hatfield	474/48/1	449.48
111	8-34	Peter S. & Marietta A. Florea	420/915	42.00
112	8-33	Lloyd L. King	319/55	20.35
113	8-31	Valerie Preat	416/599	32.5
114	8-27	Valerie Preat	416/599	16.80
115	8-32	Valerie Preat	416/599	---
116	8-26.1	James D. & Julie M. Highley	360/318	9.79
117	8-48	James D. Highley Jr.	472/167	41.00
118	8-22	John D. & Connie J. Morgan	417/944	40.00

FILE NO: 27-34-G-18

DRAWING NO: Viewer Unit 2H Well Plat

SCALE: 1" = 2000'

MINIMUM DEGREE OF ACCURACY:  
Submeter

PROVEN SOURCE OF ELEVATION:  
WVDOT, Harrisville, WV

**STATE OF WEST VIRGINIA**  
DEPARTMENT OF ENVIRONMENTAL PROTECTION  
**OIL AND GAS DIVISION**



DATE: May 31 2023

OPERATOR'S WELL NO. Viewer Unit 2H

API WELL NO. :

47 - 103 - 03590  
STATE COUNTY PERMIT

WELL TYPE:  OIL  GAS  LIQUID INJECTION  WASTE DISPOSAL  
(IF GAS) PRODUCTION:  STORAGE  DEEP  SHALLOW

LOCATION: ELEVATION: As-Built 1,211' WATERSHED: Fishing Creek QUADRANGLE: Pine Grove 0.18720; 0.5; 0.125; 0.48210; 0.950; 0.91802; 1.96875; 1.1590; 79.46;

DISTRICT: Green COUNTY: Wayne 591/531/16/9/14; 75.6; 1/2/50/3/12; 42.11; 4.6875; 48.00; 453; 6;

SURFACE OWNER: Antero Resources Corp. ACREAGE: 58.1 42; 23.95; 85.5; 39.396; 4.6875; 48.00; 453; 6; 42; 23.95; 85.5; 39.396;

ROYALTY OWNER: James Allen Sell; William R. Stalnaker, George Neason Myers, et ux; Antero Minerals, LLC (2); LEASE NO: ACREAGE: 3.58; 11.86; 49.25; 9.79;

PROPOSED WORK:  DRILL  CONVERT  DRILL DEEPER  FRACTURE OR STIMULATE  PLUG OFF OLD FORMATION

PERFORATE NEW FORMATION  OTHER PHYSICAL CHANGE IN WELL (SPECIFY) 7,500' TVD

PLUG AND ABANDON  CLEAN OUT AND REPLUG TARGET FORMATION: Marcellus Shale ESTIMATED DEPTH: 22,800' MD

WELL OPERATOR: Antero Resources Corporation DESIGNATED AGENT: Kevin Ellis

ADDRESS: 1615 Wynkoop Street ADDRESS: 535 White Oaks Blvd.

Denver, CO 80202 Bridgeport, WV 26330