

LATITUDE 39°35'00"

6,441'

LATITUDE 39°37'30"

11,648' TO BOTTOM HOLE

4,355'

3,195' TO BOTTOM HOLE LONGITUDE 80°47'30"

LONGITUDE 80°47'30"

COUNTY NAME PERMIT

Antero Resources Corporation Well No. Galarraga #1H

MAGNOLIA DISTRICT	13-23.7	BARRY KIRKLAND	1-17.1	CHRISTOPHER HOWELL	
12-119	NANCY LASURE	13-23.8	JEROME SANDS	1-18	JUANITA DIXON
13-13	RUTH BLAKE	13-23.9	RICHARD JOY	1-21	JEFFERY BROWN
13-13.1	WSD PROPERTIES LLC	13-23.10	WILLIAM FLETCHER	1-22	GREGORY BRIFITH
13-14	WYDOH	13-23.11	BARRY KIRKLAND	1-23	SHERWIN TOOTHMAN
13-21	WSD PROPERTIES LLC		GREEN DISTRICT	1-24	DIANE VASQUEZ
13-21.1	WYDOH	1-11	STEVEN HOWELL	1-25	RONALD MILLER
13-23	TH EXPLORATION II LLC	1-15	JACOB MORGAN	1-26	DEBRA MASON
13-23.1	ROBERT GORBY	1-16	MARK HOWELL	1-27	LLOYD DENNIS JR
13-23.6	ROBERT GORBY	1-17	EDGAR HOWELL	1-28	VINCENT GREENE

AS DRILLED DATA:
 WELL 1H TOP HOLE INFORMATION:
 N: 392,930ft E: 1,629,455ft
 LAT: 39°34'16.97" LON: 80°48'52.25"
 BOTTOM HOLE INFORMATION:
 N: 409,340ft E: 1,624,483ft
 LAT: 39°36'58.42" LON: 80°49'58.85"
 WEST VIRGINIA COORDINATE SYSTEM OF 1927 NORTH ZONE. ZONE WAS DERIVED FROM MEASUREMENTS TAKEN WITH TRIMBLE GEOXT SUBMETER MAPPING GRADE GPS UNIT, PLAT ORIENTATION, CORNER, AND WELL REFERENCE TIE LINES ARE BASED ON GRID NORTH.

(NAD) 83 (UTM) ZONE 17 COORDS:
 WELL 1H TOP HOLE INFORMATION:
 N: 4,380,212m E: 515,947m
 BOTTOM HOLE INFORMATION:
 N: 4,385,186m E: 514,349m

(NAD) 27 (UTM) ZONE 17 COORDS:
 WELL 1H TOP HOLE INFORMATION:
 N: 14,370,029ft E: 1,692,687ft
 POINT OF ENTRY INFORMATION:
 N: 14,370,472ft E: 1,692,930ft
 BOTTOM HOLE INFORMATION:
 N: 14,386,348ft E: 1,687,444ft

A1	LILLIE BLANCHE SMITH TESTAMENTARY TRUST
A2	LILLIE BLANCHE SMITH TESTAMENTARY TRUST
B1	BRC APPALACHIAN MINERALS I, LLC
B2	BRC APPALACHIAN MINERALS I, LLC
B3	BRC APPALACHIAN MINERALS I, LLC
C	WILLIAM W. FLETCHER, JR., ET AL
D	LILLIE BLANCHE SMITH TESTAMENTARY TRUST
E	WYNOR
F	LILLIE BLANCHE SMITH TESTAMENTARY TRUST
G	SHIBEN ESTATES, INC.
H	NANCY LOU O'NEIL LASURE
I	OSK TRANSPORTATION, INC.
J1	WILL E. MORRIS HEIRS TRUST
J2	WILL E. MORRIS HEIRS TRUST
J3	WILL E. MORRIS HEIRS TRUST
J4	WILL E. MORRIS HEIRS TRUST
K	DAVID L. SHREVE AND ESTER SHREVE
L	JEFFERY T. BROWN AND CYNTHIA J. BROWN
M1	J. WELLS BARN, ET AL
M2	J. WELLS BARN, ET AL
N	LAWRENCE P. LEMON AND ANITA M. LEMON
O	CHL PHILLIPS TRINSON
P	BENJAMIN R. YOHO
Q	STONE HILL MINERALS HOLDINGS, LLC
R	COASTAL FOREST RESOURCES COMPANY
S	BENJAMIN R. YOHO
T1	TOMMEY J. CUMP AND JEAN ANN CUMP
T2	TOMMEY J. CUMP AND JEAN ANN CUMP
U	JOHN MATHEW STALDY
V	DAVID LEE SMITH
W	MICHAEL RICHARD SMITH
AA	DAVID LEE SMITH
AB	ROBERT HARRY MYERS, SR.
AC	JOHN MATHEW STALDY

1H BOTTOM HOLE

1H TOP HOLE

WV NORTH ZONE GRID NORTH

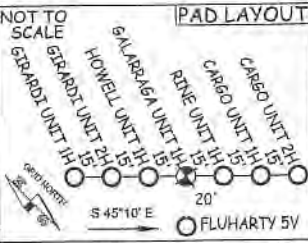
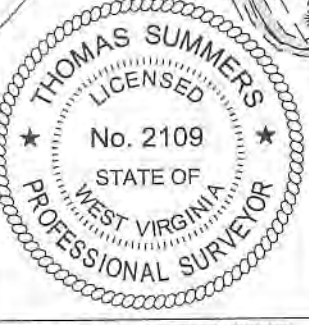
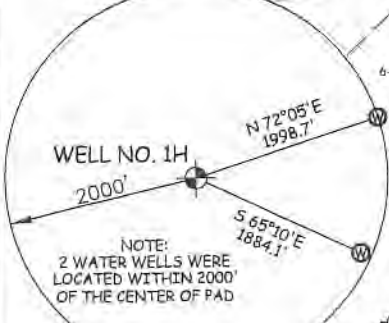

I, THE UNDERSIGNED, HEREBY CERTIFY THAT THIS PLAT IS CORRECT TO THE BEST OF MY KNOWLEDGE AND BELIEF AND SHOWS ALL THE INFORMATION REQUIRED BY LAW AND THE RULES ISSUED AND PRESCRIBED BY THE DEPARTMENT OF ENVIRONMENTAL PROTECTION.



STATE OF WEST VIRGINIA, DIVISION OF ENVIRONMENTAL PROTECTION, OFFICE OF OIL AND GAS
 WILLOW LAND SURVEYING PLLC
 220 MASONIC AVE. PENNSBORO WEST VIRGINIA 26415

1-29	DAVID SHREVE
1-30.9	KATLYN MARCEL
6-2	DALTON BAKER
6-2.1	MICHAEL MCDIFFETT
6-2.2	LAWRENCE LEMON
6-2.3	JODELL RITCHEA
6-2.4	JODELL RITCHEA
6-2.5	JODELL RITCHEA
6-2.6	FREDDIE LANDERS
6-2.7	BERNARD BUTTS
6-2.8	DENNIS WICHTERMAN
6-2.9	JOHN CAMPBELL
6-2.10	STANIS YOHO
6-2.11	STEPHANIE FAHNEUSER
6-2.12	BERNARD BUTTS
6-9.2	ALLEN LONG
6-19.1	BENJAMIN YOHO
6-19.2	BENJAMIN YOHO
6-19.3	BENJAMIN YOHO
6-28	COASTAL FOREST RESOURCES CO.
7-45	JOYCE SALAZER
11-7.1	DENNIS LYDICK
11-13	KENNETH RINE EST.
11-16	MICHAEL SMITH
11-21	FLUHARTY FAMILY TRUST

JOB # 21-011WA
 DRAWING # GALARRAGA1HAD
 SCALE 1" = 2000'
 MINIMUM DEGREE OF ACCURACY SUBMETER
 PROVEN SOURCE OF ELEV. SUBMETER MAPPING GRADE GPS
 STATE OF WEST VIRGINIA DEPARTMENT OF ENERGY DIVISION OF OIL AND GAS

LEGEND
 - - - Surface Owner Boundary Lines +/-
 --- Interior Surface Tracts +/-
 ○ Proposed Well Path
 ⊗ As Drilled Well Path
 THOMAS SUMMERS P.S. 2109
 DATE 11/22/24
 OPERATOR'S WELL# GALARRAGA UNIT #1H
 47 - 103 - 03633
 STATE COUNTY PERMIT

- NOTE
- NO OCCUPIED DWELLINGS OR BUILDINGS TWO THOUSAND FIVE HUNDRED (2,500) SQUARE FEET OR LARGER USED TO HOUSE OR SHELTER DAIRY CATTLE OR POULTRY HUSBANDRY ARE LOCATED WITHIN SIX HUNDRED TWENTY-FIVE (625) FEET OF THE CENTER OF THE WELL PAD.
 - TOP HOLE DATA SHOWN HEREON WAS PROVIDED BY ANTERO RESOURCES CORPORATION.
 - AS DRILLED DATA WAS PROVIDED BY ANTERO RESOURCES CORPORATION.
 - WLS IS NOT CERTIFYING THE DATA AND INFORMATION PROVIDED LISTED IN NOTES 2 AND 3, ONLY THE RELATIONSHIP TO THE DATA AND INFORMATION PROVIDED TO THE LEASE BOUNDARIES.
 - WLS IS BY NO MEANS RESPONSIBLE FOR ANY ERRORS OR INACCURACIES WITH THE DATA AND INFORMATION THAT HAS BEEN PROVIDED.

WELL TYPE: OIL GAS X LIQUID INJECTION WASTE DISPOSAL
 (IF "GAS") PRODUCTION X STORAGE DEEP SHALLOW X
 LOCATION: ELEVATION 1,181' WATERSHED FISHING CREEK
 QUADRANGLE PORTER FALLS 7.5' DISTRICT GREEN COUNTY WETZEL
 SURFACE OWNER ANTERO RESOURCES CORPORATION ACREAGE 46.95 ACRES±
 OIL & GAS ROYALTY OWNER DAVID L. SMITH LEASE ACREAGE 67 ACRES±
 PROPOSED WORK: DRILL CONVERT DRILL DEEPER REDRILL FRACTURE OR STIMULATE
 PLUG OFF OLD FORMATION PERFORATE NEW FORMATION OTHER PHYSICAL CHANGE IN WELL
 (SPECIFY) AS DRILLED PLUG & ABANDON CLEAN OUT & REPLUG
 TARGET FORMATION MARCELLUS ESTIMATED DEPTH 6,778' TVD 23,804' MD
 WELL OPERATOR ANTERO RESOURCES CORP. DESIGNATED AGENT KEVIN ELLIS
 ADDRESS 1615 WYNKOOP ST. ADDRESS 535 WHITE OAK BLVD.
 DENVER, CO 80202 BRIDGEPORT, WV 26330