

Antero Resources Corporation
 Appalachian Basin
 Lincoln Pad
 Wetzel County

RECEIVED
 Oil and Gas
 RECEIVED
 JUL 30 2024
 Department of
 Environmental Protection

Quadrangle: Pine Grove
 Watershed: Fishing Creek
 District: Green
 Date: 2-07-2023

08/30/2024

**Antero Resources
Well No. Skewed 2H**

Antero Resources Corporation



Notes
West Virginia Coordinate System of 1927, North Zone based upon Differential GPS Measurements.
Well No. Skewed Unit 2H Top Hole coordinates are
N: 373,504.40' Latitude: 39°31'07.89"
E: 1,650,139.93' Longitude: 80°44'24.69"
Bottom Hole coordinates are
N: 373,658.33' Latitude: 39°31'09.56"
E: 1,651,196.01' Longitude: 80°44'11.24"
UTM Zone 17, NAD 1983
Top Hole Coordinates Bottom Hole Coordinates
N: 4,374,398.623m N: 4,374,450.897m
E: 522,347.124m E: 522,668.091m
Plat orientation and corner and well references are based upon the grid north meridian.
Well location references are based upon the magnetic meridian.

Notes:
Well No. Skewed Unit 2H UTM Zone 17, NAD 1927
Top Hole Coordinates
N: 14,350,957.48'
E: 1,713,686.20'
Point of Entry Coordinates
N: 14,351,601.98'
E: 1,714,577.72'
Bottom Hole Coordinates
N: 14,351,128.95'
E: 1,714,739.21'

I, the undersigned, hereby certify that this plat is correct to the best of my knowledge and belief and shows all the information required by law and the rules issued and prescribed by the Department of Environmental Protection.

Bradley D. Miller
Bradley D. Miller, P.S. 2167

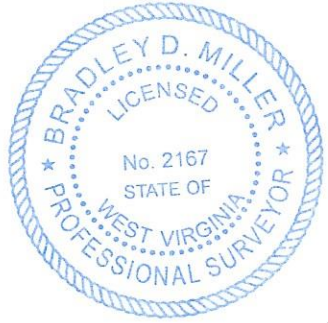

	Bearing	Dist.
L1	N 18°36' E	962.2'
L2	N 36°02' W	1,326.5'
L3	S 81°52' W	1,119.7'
L4	S 89°09' E	2,649.4'
L5	N 55°06' E	1,100.5'

Leases

ID	TM-Par	Owner	Bk/Pg	Acres
1	20-23	Antero Midstream, LLC	465/156	33.30
2	19-49	Antero Midstream, LLC	465/156	32.30
3	19-48	Antero Midstream, LLC	465/156	51.00
4	20-16	Coastal Forest Resources Company	444/105	75.50
5	20-24	Michael L. & Teresa L. Bassett	493/424	89.00
6	20-30	Antero Midstream, LLC	472/1	21.50
7	20-29	Antero Midstream, LLC	465/153	20.90
8	20-40	Antero Midstream, LLC	472/1	3.50

Note: Five water wells were found within 2000' of proposed well. No occupied dwellings or buildings 2,500 square feet or larger used to house or shelter dairy cattle or poultry husbandry are located within 625' of the center of the well pad.

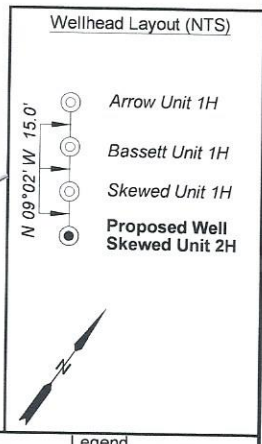
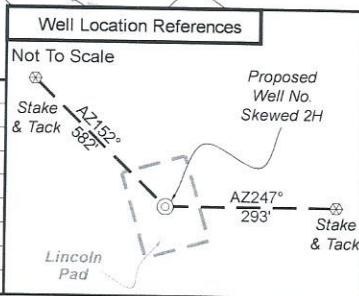
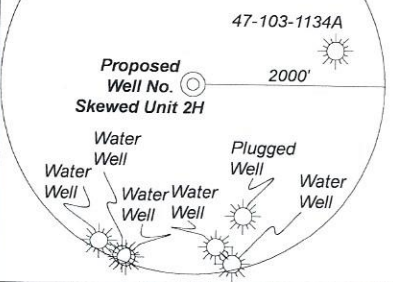

- Legend**
- Proposed gas well
 - Monument, as noted
 - Existing Well, as noted
 - Digitized Well, as noted
 - Creek or Drain
 - Road
 - Surface boundary (approx.)
 - Interior surface tracts (approx.)
 - District Line

FILE NO: 130-34-G-18
DRAWING NO: Skewed 2H Short Well Plat
SCALE: 1" = 2000'
MINIMUM DEGREE OF ACCURACY: Submeter
PROVEN SOURCE OF ELEVATION: WVDOT, Harrisville, WV

**STATE OF WEST VIRGINIA
DEPARTMENT OF ENVIRONMENTAL PROTECTION
OIL AND GAS DIVISION**

DATE: July 24 20 24
OPERATOR'S WELL NO. Skewed 2H
API WELL NO
47 - 103 - 03678
STATE COUNTY PERMIT

WELL TYPE: OIL GAS LIQUID INJECTION WASTE DISPOSAL
(IF GAS) PRODUCTION: STORAGE DEEP SHALLOW

LOCATION: ELEVATION: Proposed Elev. 1,260' Existing Elev. 1,290' WATERSHED: Fishing Creek QUADRANGLE: Pine Grove
DISTRICT: Green COUNTY: Wetzel 08/30/2024
SURFACE OWNER: Antero Midstream, LLC ACREAGE: 33.25
ROYALTY OWNER: Melinda A. Debner LEASE NO: ACREAGE: 33.25
PROPOSED WORK: DRILL CONVERT DRILL DEEPER FRACTURE OR STIMULATE PLUG OFF OLD FORMATION
 PERFORATE NEW FORMATION OTHER PHYSICAL CHANGE IN WELL (SPECIFY) _____
 PLUG AND ABANDON CLEAN OUT AND REPLUG TARGET FORMATION: Marcellus Shale ESTIMATED DEPTH: 7,600' TVD 9,900' MD

WELL OPERATOR: Antero Resources Corporation DESIGNATED AGENT: Kevin Ellis
ADDRESS: 1615 Wynkoop Street ADDRESS: 535 White Oaks Blvd.
Denver, CO 80202 Bridgeport, WV 26330