

- NOTES ON SURVEY**
- COORDINATES SYSTEM IS UTM, NAD 83 DATUM, ZONE 17, U.S. FOOT AND WELL COORDINATES ESTABLISHED USING SURVEY GRADE GPS.
 - SURFACE AND ROYALTY OWNER INFORMATION AND THEIR BOUNDARIES SHOWN HEREON WERE PLOTTED FROM DEEDS AND/OR TAX PARCEL MAPS PROVIDED BY CLIENT AND FIELD LOCATIONS.
 - THIS PLAT DOES NOT REPRESENT A BOUNDARY SURVEY OF THE PARCELS SHOWN HEREON.
 - NO DWELLINGS AND BUILDINGS WITHIN 625 FEET OF PROPOSED OF CENTER OF PAD.
 - NO WATER WELLS OR DEVELOPED SPRINGS WITHIN 250 FEET OF PROPOSED WELL.
 - NO PERENNIAL STREAMS, LAKES, PONDS, RESERVOIRS OR WETLANDS WITHIN 100 FEET OF THE LIMITS OF DISTURBANCE.
 - NO NATURALLY PRODUCING TROUT STREAM WITHIN 300 FEET OF LIMITS OF DISTURBANCE.

- LEGEND**
- Active Well Location
 - Plugged Well Location
 - Abandoned Well
 - Surface Tract Identification
 - Proposed Gas Well
 - Located Corner, as noted
 - Surface Tract Lines (Surveyed)
 - Surface Tract Lines (Tax Map)
 - Reference Line
 - Lease Boundary
 - Creek or Drain
 - WV County Route
 - WV State Route
- (⊕) Denotes Location of Well on United States Topographic Maps



I, the undersigned, hereby certify that this plat is correct to the best of my knowledge and belief and shows all the information required by law and the regulations issued and prescribed by the Department of Environmental Protection.

T. Rowe 09/03/2024
L. L. S. 2394



FILE NO: _____
DRAWING NO: _____
SCALE: 1" = 2000'
MINIMUM DEGREE OF ACCURACY: 1:2500
PROVEN SOURCE OF ELEVATION: NGS CORS Station



DATE: JULY 30 20 24
OPERATORS WELL NO: Mr Skilling 31H
API WELL NO: 47 - 103 - 03683
STATE COUNTY PERMIT

WELL TYPE: OIL GAS LIQUID INJECTION WASTE DISPOSAL
 (IF GAS) PRODUCTION: STORAGE DEEP SHALLOW
 LOCATION ELEVATION: 1515' WATERSHED: West Virginia Fork Fish Creek QUADRANGLE: Hundred
 DISTRICT: Church COUNTY: Wetzel
 SURFACE OWNER: EQT Production Company and Wolfpen Knob Development Co ACREAGE: 58.7 ±
 ROYALTY OWNER: Robert L. Lemmon, et al. LEASE NO: 124459000 ACREAGE: 162.00 ±
 PROPOSED WORK: DRILL CONVERT DRILL DEEPER FRACTURE OR STIMULATE PLUG OFF OLD FORMATION
 PERFORATE NEW FORMATION OTHER PHYSICAL CHANGE IN WELL (SPECIFY)
 PLUG AND ABANDON CLEAN OUT AND REPLUG TARGET FORMATION: Marcellus ESTIMATED DEPTH: 7,972'

WELL OPERATOR: EQT Production Company DESIGNATED AGENT: Joseph C Mallow
 ADDRESS: 400 Woodcliff Drive ADDRESS: 427 Midstate Drive
 Canonsburg, PA 15317 Clarksburg, WV 26301

Mr Skilling 31H						
Mr Skilling						
EQT Production Company						
Tract ID.	Tax Map No.	Parcel No.	County	District	Surface Tract Owner	Acres
1	5	48.0	Wetzel	Church	EQT Production Company and Wolfpen Knob Development Co	58.70
Lease		Owner			Acres	
124459000		Robert L. Lemmon, et al.			162 ac	

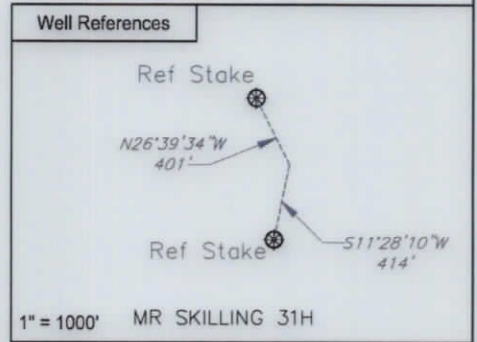
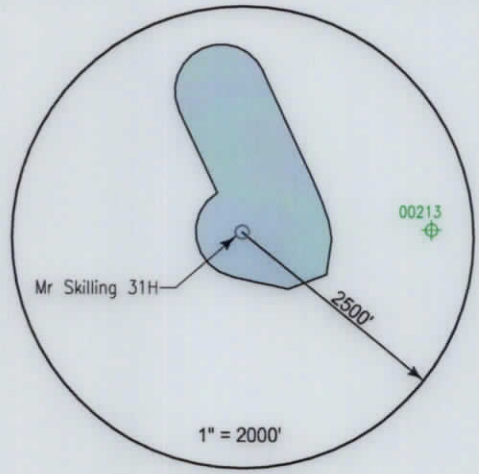

Notes:
 MR SKILLING 31H coordinates are
 NAD 27 N: 433,284,882 E: 1,744,190,528
 NAD 27 Lat: 39.686063 Long: -80.408970
 NAD 83 UTM N: 4,393,090.304 E: 550,697.618

MR SKILLING 31H Landing Point coordinates are
 NAD 27 N: 433,785,595 E: 1,744,436,117
 NAD 27 Lat: 39.687444 Long: -80.408116
 NAD 83 UTM N: 4,393,244.103 E: 550,769,898

MR SKILLING 31H Bottom Hole coordinates are
 NAD 27 N: 434,808,219 E: 1,743,959,211
 NAD 27 Lat: 39.690238 Long: -80.409847
 NAD 83 UTM N: 4,393,553.236 E: 550,619,409

West Virginia Coordinates system of 1927 (North Zone)
 based upon Differential GPS Measurements
 Plat orientation, Corner and well ties are based upon
 the grid north meridian
 Well location references are based upon the grid north
 meridian.
 UTM coordinates are NAD83, Zone 17, Meters.

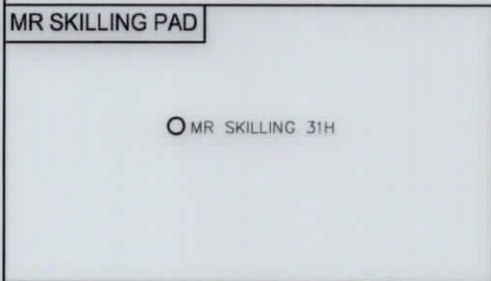

I, the undersigned, hereby certify that this plat is correct to the best of my knowledge and belief and shows all the information required by law and the regulations issued and prescribed by the Department of Environmental Protection.

T. Rowe 09/03/2024
 L. L. S. 2394



FILE NO: _____
 DRAWING NO: _____
 SCALE: 1" = 1000'
 MINIMUM DEGREE OF ACCURACY: 1:2500
 PROVEN SOURCE OF ELEVATION: NGS CORS Station



DATE: JULY 30 20 24
 OPERATORS WELL NO: Mr Skilling 31H
 API WELL NO: 47 - 103 - 03683
 STATE COUNTY PERMIT

WELL TYPE: OIL GAS LIQUID INJECTION WASTE DISPOSAL
 (IF GAS) PRODUCTION: STORAGE DEEP SHALLOW

LOCATION ELEVATION: 1515' WATERSHED: West Virginia Fork Fish Creek QUADRANGLE: Hundred
 DISTRICT: Church COUNTY: Wetzel

SURFACE OWNER: EQT Production Company and Wolfpen Knob Development Co ACREAGE: 58.7 ±
 ROYALTY OWNER: Robert L. Lemmon, et al. LEASE NO: 124459000 ACREAGE: 162.00 ±

PROPOSED WORK: DRILL CONVERT DRILL DEEPER FRACTURE OR STIMULATE PLUG OFF OLD FORMATION
 PERFORATE NEW FORMATION OTHER PHYSICAL CHANGE IN WELL (SPECIFY)

PLUG AND ABANDON CLEAN OUT AND REPLUG TARGET FORMATION: Marcellus ESTIMATED DEPTH: 7,972'

WELL OPERATOR: EQT Production Company DESIGNATED AGENT: Joseph C Mallow
 ADDRESS: 400 Woodcliff Drive ADDRESS: 427 Midstate Drive
 Canonsburg, PA 15317 Clarksburg, WV 26301