

I hereby certify that this map is a true and correct copy of the original as the same appears on the books of the recorder of the mining laws of the State of Nevada.

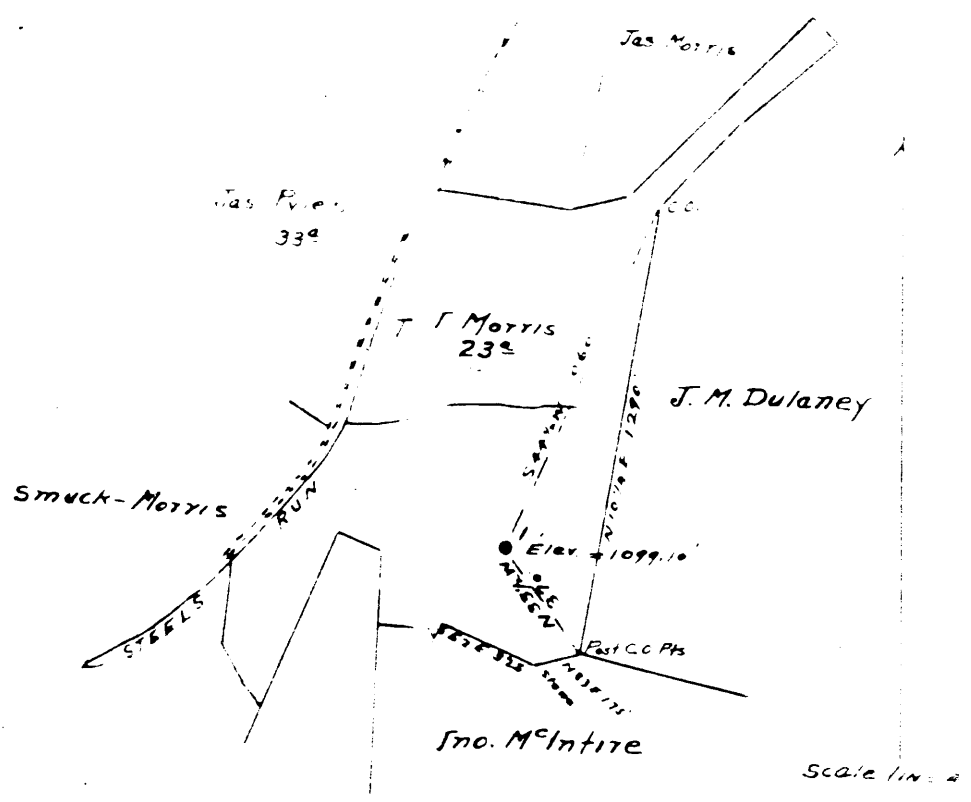

STATE OF WEST VIRGINIA
DEPARTMENT OF MINES
OIL AND GAS DIVISION

813

WELL RECORD

Permit No. 338A

Oil or Gas Well OIL
(KIND)

Company South Penn Natural Gas Company,
 Address Union Trust Bldg. Parkersburg, W. Va.
 Farm T. J. Morris Acres 20
 Location (waters) -----
 Well No. 1 Elev. 1097.10'
 District Center County Wetzel
 The surface of tract is owned in fee by R.A. Henderson,
 Address Wileyville, W. Va.
 Mineral rights are owned by Telluric Co., et al.,
 Address Morgantown, W. Va.
 Drilling commenced Nov. 3, 1902
 Drilling completed Jan. 31, 1903
 Date shot 9-21-03 20qt. Depth of shot -----
9-17-04 30qt.
 Open Flow /10ths Water in Inch
/10ths Merc. in Inch
 Volume --- Cu. Ft.
 Rock Pressure -- lbs. -- hrs.
 Oil 115 bbls., 1st 24 hrs.
 Fresh water - feet - feet
 Salt water 1860 - feet - feet

Casing and Tubing	Used in Drilling	Left in Well	Packers
Size			
16			Kind of Packer <u>--</u>
13			<u>-</u>
10	<u>1275' (Pulled)</u>		Size of <u>-</u>
8 1/4	<u>1537' (Pulled)</u>		<u>-</u>
6 5/8	<u>1999'</u>		Depth set <u>-</u>
5 3/16	<u>2400'</u>		<u>-</u>
3			Perf. top <u>-</u>
2			Perf. bottom <u>-</u>
Liners Used			Perf. top <u>-</u>
Cond. <u>16'</u>			Perf. bottom <u>-</u>

CASING CEMENTED 9 SIZE - No. Ft. - Date -
 COAL WAS ENCOUNTERED AT 1020 FEET 120 INCHES
- FEET - INCHES - FEET - INCHES
- FEET - INCHES - FEET - INCHES

Formation	Color	Hard or Soft	Top	Bottom	Oil, Gas or Water	Depth Found	Remarks
Pittsburgh Coal			1020	1030			
Big Dunkard Sand			1485	1715			
Gas Sand			1750	1800			
Salt Sand			1845	1940			
Maxon Sand			1970	2065	Water	1860	
Pencil Cave			2165	2180			
Big Lime			2180	2230			
Big Injun Sand			2230	2475			
Stray			3059				
Gordon			3076		Oil & Gas	3069	
Total Depth				3096			

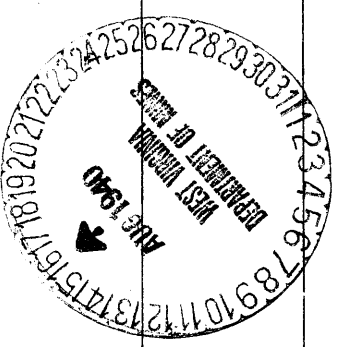

Formation	Color	Hard or Soft	Top	Bottom	Oil, Gas or Water	Depth Found	Remarks

Date **August 14,** 194**0.**

APPROVED **SOUTH PENN NATURAL GAS COMPANY**, Owner

By *Elton R Young* Land Agent

(Pencil notation on
record; "not abandoned".)

Center District, Wetzel County, W. Va.

By South Penn Oil Co., Drawer 1255, Pittsburgh, Pa.

Abandoned under permit Wet-21.

On 23 acres, surface owned by Harrison Melett and H. B. Melett,

New Martinsville, W. Va., and minerals by T. A. Deveney,

Fairmont, W. Va., and Wm. H. Manley et al., Grafton, W. Va.

Elevation, 1099.10' L.

10" casing, 1275'; 8", 1537'; 6", 1999'; 2", 2400'.

Coal was encountered at 1020-1030'.

Abandonment? reported to Dept. of Mines July 3, 1930.

Salt water at 1860'.

Record to RPT from Mrs. Griffith Sept. 10, 1935.

	Top.	Bottom.
Conductor	0	16
Pittsburgh Coal	1020	1030
Big Bankard Sand	1485	1715
Gas Sand	1750	1800
Salt Sand (water, 1860')	1845	1940
Horton Sand	1970	2065
Pencil Cave	2165	2180
Big Mine	2180	2230
Big Injun Sand	2230	2475
Strey Sand (oil and gas, 3069')	3059
Gordon Sand	3076
Total depth		3090