

Latitude

Longitude

⊕
1.94s
.77w

Topo Location

7.5' Loc. _____ 15' Loc. _____
_____ (calc.) _____

Company South Penn Oil Co

Farm HL PETERSON # 55

15' Quad _____
(sec.)

7.5' Quad Big Run

District GRANT

WELL LOCATION PLAT

County 103 **Permit** 30034

information to the best of my knowledge and belief as required by the oil and gas section of the mining laws of West Virginia.

H. K. Cooper
H. K. Cooper

30034

Cooper & Stewart
2000

#55

S.W. Smith
170-92

H. L. Smith
147-92

W.E. Carlin
692

H.E. Smith
2000

H.E. Smith
1

H.E. Smith

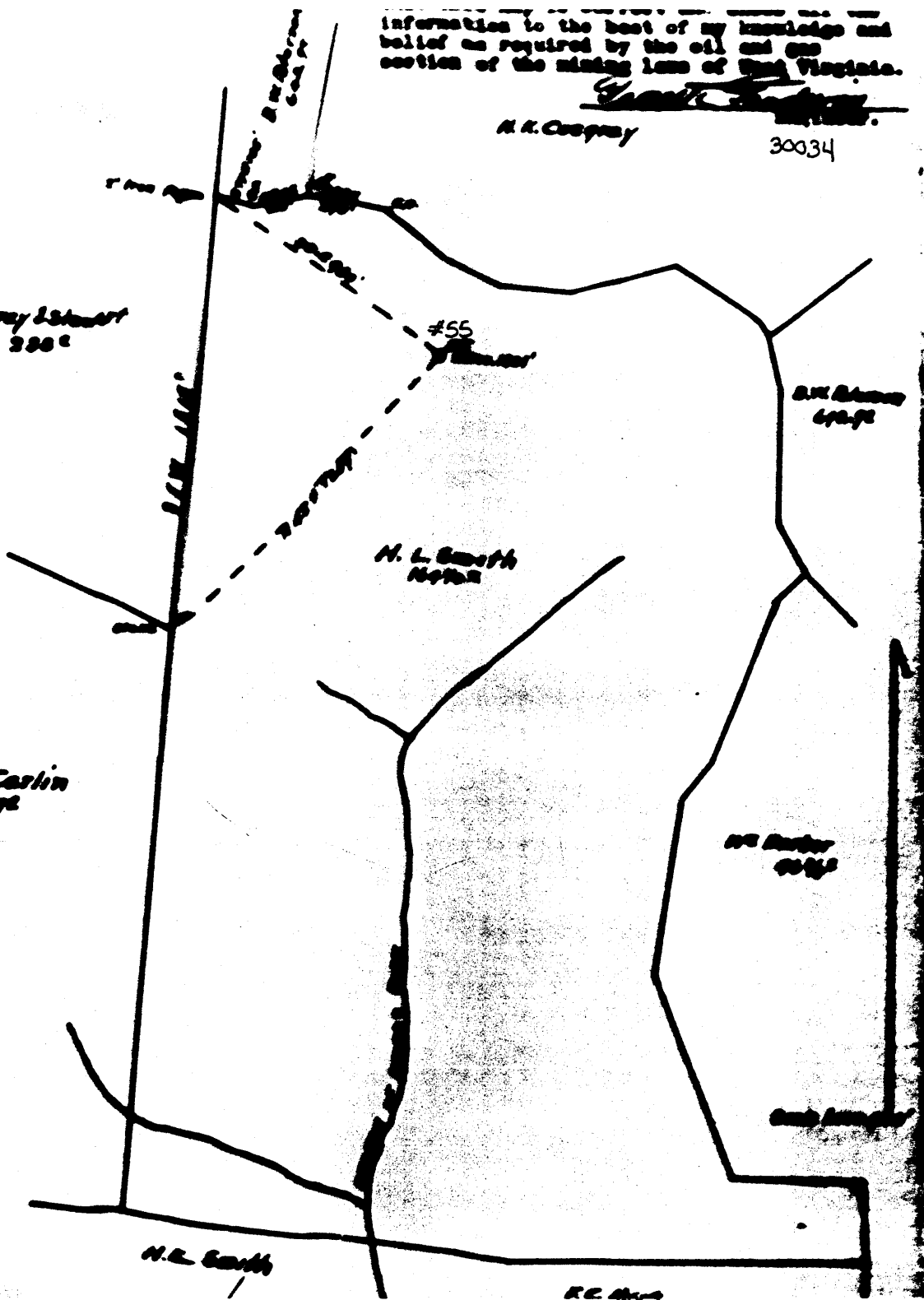

WET-34-A

Grant District, Wetzel County, W. Va.

By South Penn Oil Co., P. O. Drawer 1255, Pittsburgh, Pa.

On 16 $\frac{1}{4}$ acres, surface and mineral rights owned by H. Laurie
Smith, 300 Law Bldg., Richmond, Virginia.

Elevation, 1301' L.

16" conductor; 10" casing, 439'; 8 $\frac{1}{2}$ ", 1633' 2"; 6-5/8", 2349' 5";
5-3/16", 2608' 8".

Coal was encountered at 1095-1105'.

Abandonment reported to Dept. of Mines Jan. 15, 1931.

Oil well.

	Top.	Bottom.
Conductor	0	16
Pittsburgh Coal	1095	1105
Little Dunkard Sand	1420	1432
Big Dunkard Sand	1640	1660
Gas Sand	1750	1810
Salt Sand	1900	2155
Pencil Cave	2300	2315
Big Line	2315	2378
Big Injun Sand	2378	2575
50-Ft. Sand	2900	2920
Stray Sand	3185	3200
Gordon Sand (oil, 3210')	3207	3220
Fifth Sand	3316	3325
Total depth		3562