

30101
GRANT

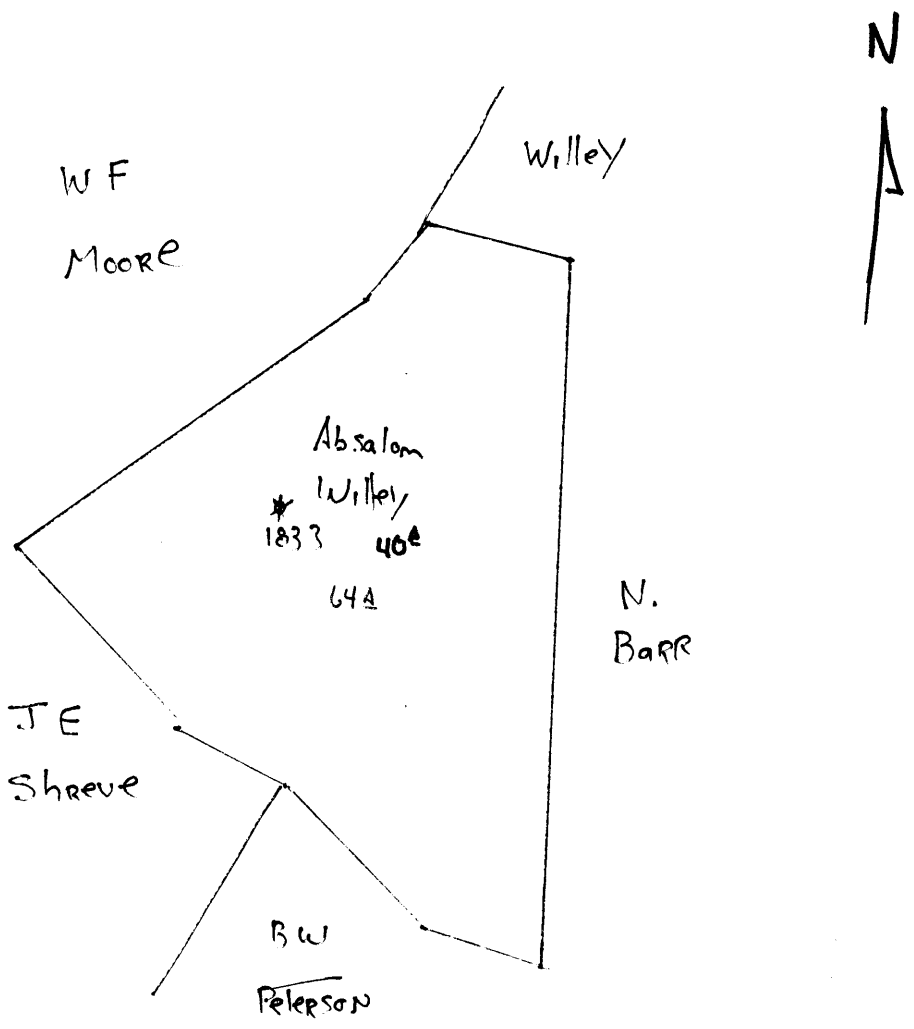

Surface owned by John Barr

WET-101-A

Grant District, Wetzel County, W. Va.
 By Hope Natural Gas Co., 445 W. Main St., Clarksburg, W. Va.
 On 64 acres, surface owned by John Barr, Pine Grove, W. Va.;
 owner of mineral rights, unknown.

Elevation, 1119' L.

10" casing, 855'; 6-5/8", 2044'.

Coal was encountered at 365-368, 735-740, and 820-828'.

Abandonment reported to Dept. of Mines April 12, 1933.

Well was shot at 2907'.

No record of fresh water; salt water at 1619'.

Gas well; now exhausted to extent that it is no longer commercially productive.

	Top.	Bottom.	Thickness.
Native coal	365	- 368	3
Mapletown (Sewickley) Coal	735	- 740	5
Pittsburgh Coal	820	- 828	8
Big Dunkard Sand	1306	- 1346	40
Gas Sand	1465	- 1545	80
First Salt Sand (gas, 1604'; water, 1619')	1600	- 1672	72
Second Salt Sand	1720	- 1862	142
Haxton Sand	1955	- 1985	30
Little Lime	1993	- 2008	15
Pencil Cave	2008	- 2014	6
Big Lime	2014	- 2085	71
Big Injun Sand (gas, 2132')	2085	- 2305	225
Gants? Sand	2425	- 2445	20
Gordon Stray Sand	2867	- 2890	23
Gordon Sand (gas, 2907')	2891	- 2914	23
Fourth Sand	2959	- 2966	7
Total depth		2979	