

30114
GREEN

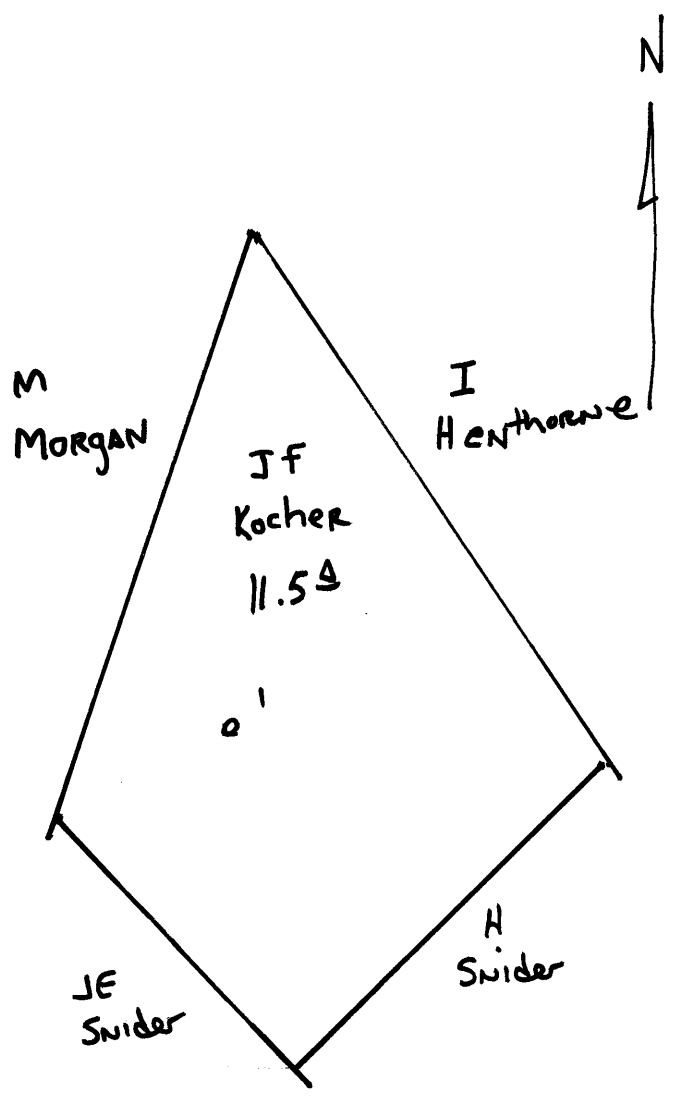

Green District, Wetsel County, W. Va.
 By Raw Bros., New Martinsville, W. Va. (T. C. Raw).
 On 11.5 acres, at Porters Falls, on waters of Big Fishing Creek;
 surface owned by J. F. Kocher, Porters Falls, W. Va., and
 mineral rights by Mrs C. Long, Pine Grove, W. Va.
 Drilled June 5, 1928.
 Elevation, 797.48' L.
 13" conductor, 16"; 10" casing, 25 1/2"; 8 1/2", 1085'; 6-5/8", 1717'.
 Larkin packer, 6-5/8, set at 1559'.
 Casing perforated at 1585-1595'.
 Coal was encountered at 110-111 1/2, 595' (showing).
 No liner used.
 Abandonment reported to Dept. of Mines May 7, 1934.
 Well was shot. Fresh water at 80'. Gas well.

WET-114-A

	Top.	Bottom.
Red rock	0	80
Slate, dark (fresh water at 80')	80	110
Coal, dark	110	111 1/2
Slate, dark	111 1/2	156
Red rock	156	205
Line, dark	205	265
Red rock	265	350
Slate, dark	350	545
Line	545	563
Showing of coal	563	
Slate, dark	563	593
Coal	593	594
Slate, dark	594	625
Sand	625	644
No record	644	916
Grit line	916	926
Slate and shells	926	1075
Red rock	1075	1090
Shale	1090	1170
Slate	1170	1180
Sand and line	1180	1199
Slate	1199	1230
Line	1230	1260
Slate	1260	1350
Sand	1350	1410
Slate and gritty line	1410	1458
Slate, light	1458	1505
Sand, dark (gas, 1577-1585')	1505	1595
Slate, dark	1595	1690
Little Line	1690	1698
Pencil Cove, dark	1698	1715
Big line (gas, 1774-1784')	1715	1774
Total depth		1788

1789?