

Latitude

Longitude

+
 2.77s
 2.11w

Topo Location

7.5' Loc. _____ 15' Loc. _____
 _____ (calc.) _____

Company Donald Lillinger

Farm Daniel Kubens #1023

15' Quad _____
(sec.)

7.5' Quad Littleton

District Center

WELL LOCATION PLAT

County 103 Permit 30173

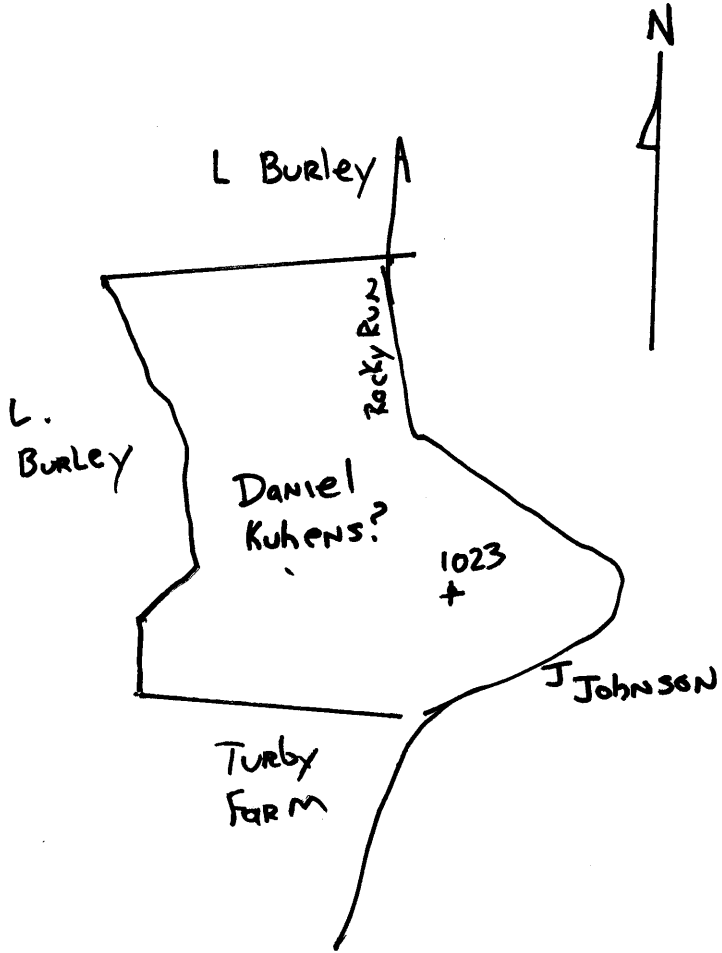

Center District, Wetzel County, W. Va.

By Donald Billinger, Knob Fork, W. Va.

Abandoned under permit Net-173.

On 15 acres S.W. 1/4, surface and minerals owned by Daniel Ruhensf,
Silver Hill, W. Va.

No permit required when drilled.

Elevation, 890' B.

8 1/2" casing, 1337'; 6", 2033'; 5", 2797'; 2" tubing, 2859'.

Coal was encountered at 675-678 and 790-795'.

Abandonment reported to Dept. of Mines Aug. 17, 1935.

Oil well.

Record to BOT from Mrs. Griffith Sept. 10, 1938.

	Top.	Bottom.	Thickness.
Native coal	675	- 678	3
Pittsburgh Coal	790	- 795	5
Little Darkard Sand	1190	- 1230	40
Big Darkard Sand	1283	- 1308	25
Gas Sand	1415	- 1487	72
2nd Gas Sand (water, 1545')	1505	- 1545	40
First Salt Sand	1582	- 1618	36
2nd Salt Sand	1638	- 1686	48
Third Salt Sand	1700	- 1720	20
Little lime	1906	- 1939	33
Pencil Gave	1959	- 1963	4
Big lime	1963	- 1994	31
Big Injun Sand	1994	- 2245	251
Thirty-foot Sand	2780	- 2806	26
Gordon Stray Sand (oil, 2856')	2844	- 2859	15
Gordon Sand	2859	- 2870	11
Fourth Sand	2907	- 2915	8
Hole filled up to		2859	