

Latitude 39° 45'

Longitude 80° 25'

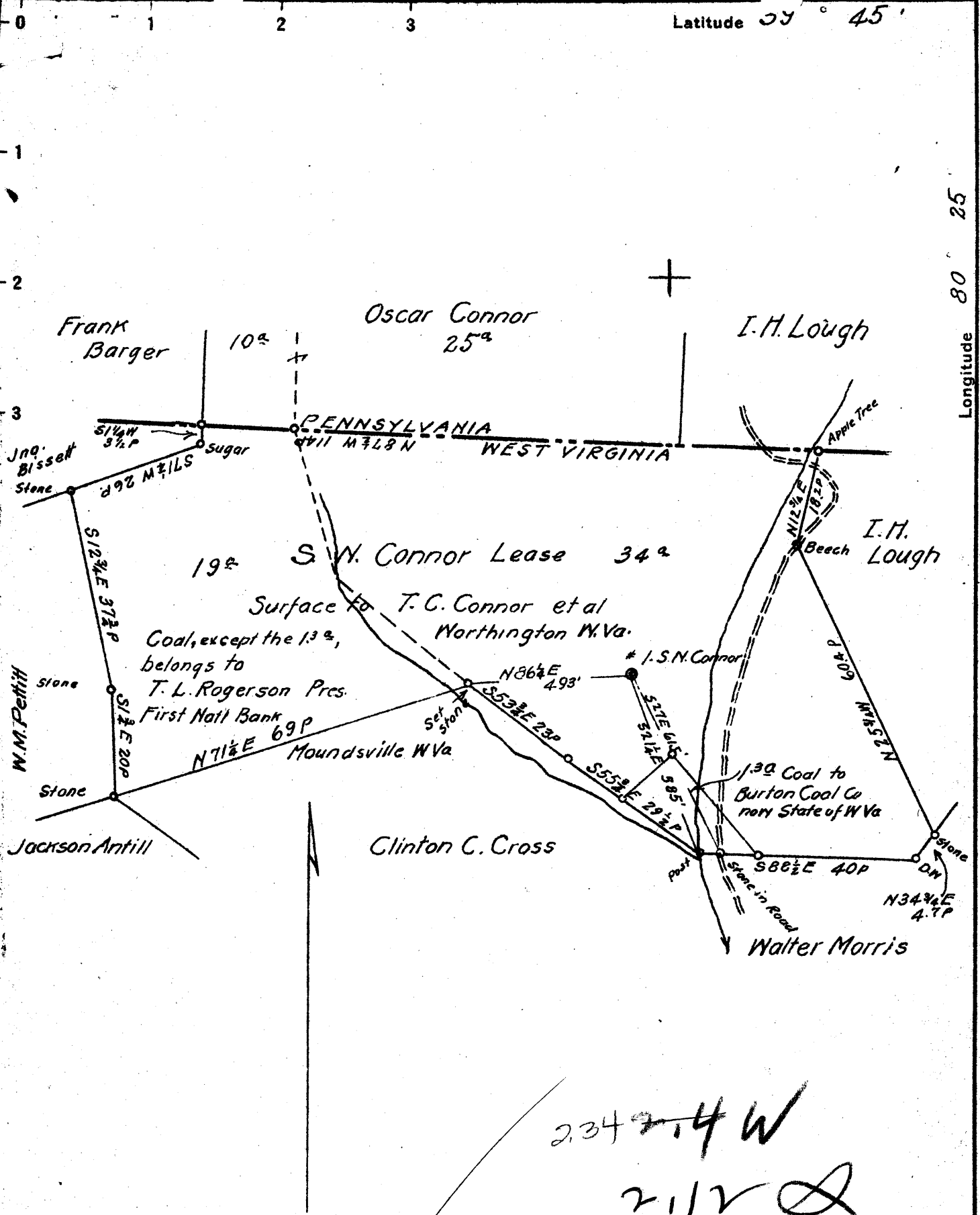

234 2.4 W
 2112 Q

New Location
 Drill Deeper
 Abandonment

JUN - 8 1942
 519-E10

Company South Penn Natural Gas Co
 Address Parkersburg W. Va.
 Farm S. N. Connor
 Tract _____ Acres 56 Lease No. 26467
 Well (Farm) No. 1 Serial No. _____
 Elevation (Spirit Level) 1230.42 Ground
 Quadrangle Mannington
 County Netzel District Church
 Engineer Emmon Haines
 Engineer's Registration No. _____
 File No. _____ Drawing No. _____
 Date 3-11-42 Scale 1" = 400'

STATE OF WEST VIRGINIA
 DEPARTMENT OF MINES
 OIL AND GAS DIVISION
 CHARLESTON

WELL LOCATION MAP
 FILE NO. WET-416-A

+ Denotes location of well on United States Topographic Maps, scale 1 to 62,500, latitude and longitude lines being represented by border lines as shown.
 - Denotes one inch spaces on border line of original tracing.

STATE OF WEST VIRGINIA
DEPARTMENT OF MINES
OIL AND GAS DIVISION

884

WELL RECORD

416A
Permit No. _____

Oil or Gas Well OIL
(KIND)

Company South Penn Natural Gas Company
Address Union Trust Bldg. Parkersburg, W. Va.
Farm S. N. Conner Acres 56
Location (waters) Rock Camp
Well No. 1 Elev. 1230.42
District Church County Wetzel
The surface of tract is owned in fee by T.C. Conner et al
Worthington, Address W. Va.
Mineral rights are owned by Emeline Conner Estate/
T.C. Conner, Exr. RD/1 Address Worthington, W. Va.
Drilling commenced May 13, 1903
Drilling completed July 2, 1903
Date Shot 7-6-03-12 qt. To 9-21-04-20 qt.
With _____

Casing and Tubing	Used in Drilling	Left in Well	Packers
Size			
16			Kind of Packer -
13			-
10	198' 1"		Size of -
8 1/4	1330' 2"		-
6 1/2	2197' 2"		Depth set -
5 3/16	2830' 2"		-
3			Perf. top -
2			Perf. bottom -
Liners Used			Perf. top -
			Perf. bottom -

Open Flow /10ths Water in. --- Inch
/10ths Merc. in. --- Inch
Volume --- Cu. Ft.
Rock Pressure --- lbs. --- hrs.
Oil --- 15 bbls., 1st 24 hrs.
Fresh water --- feet --- feet
Salt water --- feet --- feet

CASING CEMENTED - SIZE - No. Ft. - Date
COAL WAS ENCOUNTERED AT 932 FEET 72 INCHES
- FEET - INCHES - FEET - INCHES
- FEET - INCHES - FEET - INCHES

Formation	Color	Hard or Soft	Top	Bottom	Oil, Gas or Water	Depth Found	Remarks
Pittsburgh Coal			932	938			
Big Dunkard Sand			1467	1520			
Gas Sand			1532	1582			
Salt Sand			1720	1942			
Salvation Sand			2012	2072	Gas	1790	
Big Lime			2082	2162			
Big Injun			2162	2432			
50 Foot Sand			2912	2957			
Gordon Sand			2985	3003	1st Pay	2996	
Total Depth				3007			

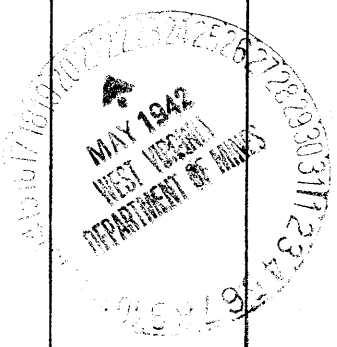

Formation	Color	Hard or Soft	Top	Bottom	Oil, Gas or Water	Depth Found	Remarks

Date **May 20, 1942.**, 194

APPROVED **SOUTH PENN NATURAL GAS COMPANY**, Owner

By *Elton Elving* Land Agent
(Title)