

AMANDA KENNEDY

JOHN

LUCRETIA WINLAND

JOHN LANCASTER

C.M. WINLAND HRS.
13 AC. 30 PER.

W.V. HOGE

J.E. HIGGINS

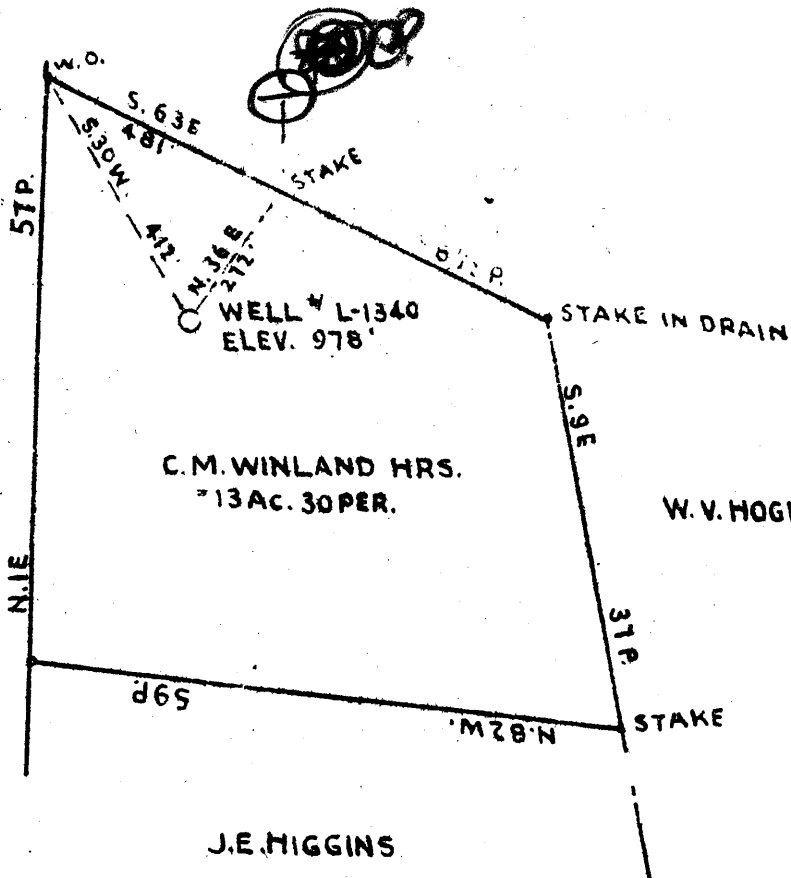

COAL OWNED BY DOLLY J. WHITEMAN EST. % P.E. WHITEMAN AND C.M. WINLAND

VIEW LOCATION
DRILL DEEPER
ABANDONMENT

4.23 4.78 W
3.62 7.67 9
JUL - 3 1945

COMPANY THE MANUFACTURERS LIGHT AND HEAT CO.

ADDRESS 800 UNION TRUST BLDG. PITTSBURGH PA.

NAME C.M. WINLAND HEIRS

TRACT ACRES 13 AC. 30 P LEASE NO 3017

WELL (FARM) NO. 1 SERIAL NO. 1340

ELEVATION (SPIRIT LEVEL) 978'

TOWNSHIP LITTLETON

COUNTY WETZEL DISTRICT GREEN

ENGINEER J. L. Mercer

ENGINEER'S REGISTRATION NO. _____

FILE NO. _____ DRAWING NO Y-11-145

DATE JUNE 5, 1945 SCALE 1" = 930'

STATE OF WEST VIRGINIA
DEPARTMENT OF MINES
OIL AND GAS DIVISION
CHARLESTON

WELL LOCATION MAP

FILE NO. WET-499-A

* DENOTES LOCATION OF WELL ON UNITED STATES TOPOGRAPHIC MAPS (SCALE 1 TO 62,500). LATITUDE AND LONGITUDE LINES BEING REPRESENTED BY BORDER LINES AS SHOWN.

ONE INCH SPACES ON BORDER LINE OF ORIGINAL

C.M. WINLAND HRS. NO. 1 (1340) - M, L. & H, Co. - WET-499-A



STATE OF WEST VIRGINIA
DEPARTMENT OF MINES
OIL AND GAS DIVISION

961

Ad 499-A
Permit No. DRILLED IN 1904

WELL RECORD

Oil or Gas Well Gas
(KIND)

Company The Manufacturers Light & Heat Company
Address 800 Union Trust Bldg., Pittsburgh, Pa.
Farm C. M. Winland Acres 14
Location (waters) _____
Well No. 1 - 1310 Elev. 978 ft
District Green County Wetzel
The surface of tract is owned in fee by C. M. Winland
R. D. 2 Address Sistersville, W Va
Mineral rights are owned by The Mfrs Light & Heat Co.
800 Union Trust Bldg Address Pittsburgh, Pa.
Drilling commenced 11/18/04 10/20/05
Drilling completed 12/18/04 11/20/05
Date Shot 2/5/24 & 4/23/24 from 2552 To 2560 and
well from 2580 to 2590 (20 qts each)
Open Flow 2 /10ths Water in _____ Inch
_____ /10ths Merc. in _____ Inch
Volume _____ Cu. Ft.
Rock Pressure 275 lbs _____ hrs.
Oil _____ bbls., 1st 24 hrs.
Fresh water _____ feet _____ feet
Salt water _____ feet _____ feet

Casing and Tubing	Used in Drilling	Left in Well	Packers
Size			
16			Kind of Packer
18			
10	<u>211'</u>	<u>211'</u>	Size of
8 1/2	<u>988'</u>	<u>988'</u>	
6 1/2		<u>1749'</u>	Depth set
5 3/16	<u>1867'</u>	<u>1867'</u>	<u>1749 ft.</u>
3			Perf. top
2			Perf. bottom
Liners Used			Perf. top
			Perf. bottom

CASING CEMENTED _____ SIZE _____ No. Ft. _____ Date _____
COAL WAS ENCOUNTERED AT 504 FEET ? INCHES
_____ FEET _____ INCHES _____ FEET _____ INCHES
_____ FEET _____ INCHES _____ FEET _____ INCHES

Formation	Color	Hard or Soft	Top	Bottom	Oil, Gas or Water	Depth Found	Remarks
Pittsburgh Coal			504				
Little Dunkard			880	900			
Big Dunkard			880	1000			
Gas Sand			1125	1205			
Salt Sand			1355	1500			
Second Salt Sand			1460	1550			
Blue Monday			1680	1705			
Big Line			1705	1760			
Big Injun			1760		Pay gas 1770		
Total depth				1789			
DRILLED DEEPER FROM INJUN TO GORDON 10/20/05							
Bottom of Big Injun			1787	1995			
Gordon			2581	2604	Gas 2586-2598		
Total depth				2604			

Formation	Color	Hard or Soft	Top	Bottom	Oil, Gas or Water	Depth Found	Remarks

Date June 6th, _____, 194 5

APPROVED THE MANUFACTURERS LIGHT & HEAT CO., Owner

By Jerry H. Foulke
 Land Dept. (Title) Office Manager.

