

39°42'30"

80°35'00"

Latitude

.225
.14w

Longitude

Topo Location

7.5' Loc. _____ 15' Loc. _____
(calc.) _____

Company Hope Natural Gas Co

Farm C.E BROWN # 6203

15' Quad _____
(sec.)

7.5' Quad Littleton

District Center

WELL LOCATION PLAT

County 103 **Permit** 30830

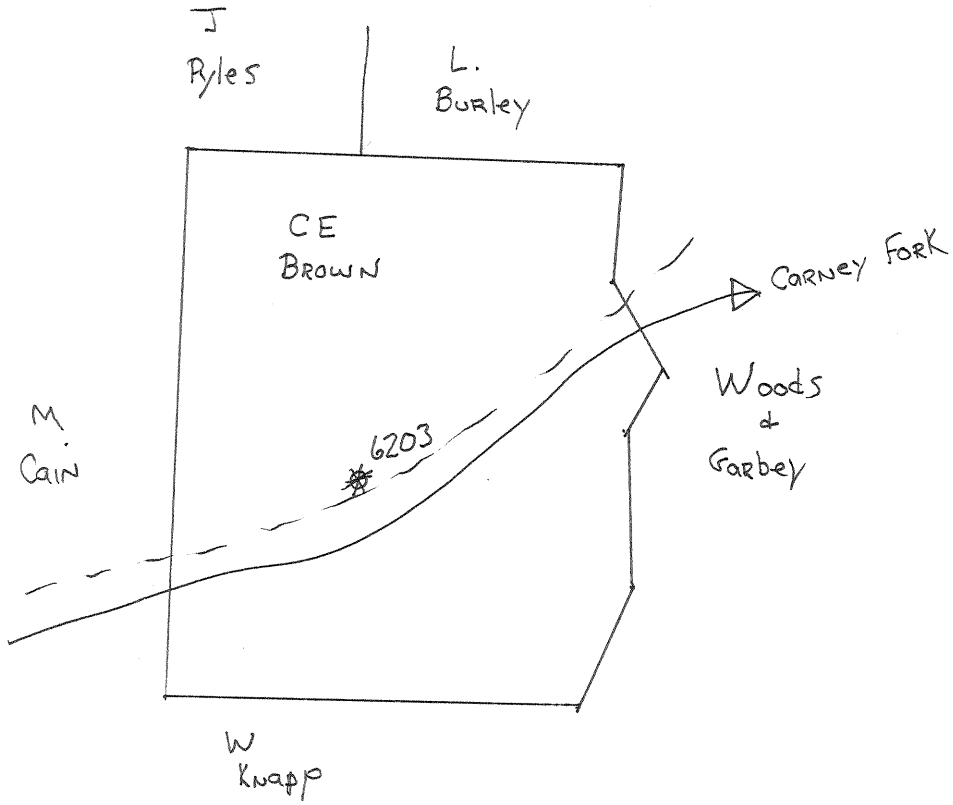



STATE OF WEST VIRGINIA
DEPARTMENT OF MINES
OIL AND GAS DIVISION

1270

WELL RECORD

Permit No. 830 A

Oil or Gas Well _____
(KIND)

Company Hope Natural Gas Company.
 Address 445 West Main St. Clarksburg, W. Va.
 Farm C.E. Brown Acres 43
 Location (waters) _____
 Well No. 6203 Elev. 911
 District Center County Wetzel
 The surface of tract is owned in fee by _____
 Address _____
 Mineral rights are owned by _____
 Address _____
 Drilling commenced October 11, 1922
 Drilling completed December 25, 1922
 Date Shot _____ From _____ To _____
 With _____
 Open Flow _____ /10ths Water in _____ Inch
 _____ /10ths Merc. in _____ Inch
 Volume _____ Cu. Ft.
 Rock Pressure _____ lbs. _____ hrs.
 Oil _____ bbls., 1st 24 hrs.
 Fresh water _____ feet _____ feet
 Salt water 1670 feet _____ feet

Casing and Tubing	Used in Drilling	Left in Well	Packers
Size			Kind of Packer
16			
13			
10	175	175	Size of
8 1/4	1153	1153	
6 5/8	1818	1818	Depth set
5 3/16	1923	1923	
3			Perf. top
2			Perf. bottom
Liners Used			Perf. top
			Perf. bottom

CASING CEMENTED _____ NOT _____ SIZE _____ No. Ft. _____ Date _____

COAL WAS ENCOUNTERED AT 420 FEET 48 INCHES
635 FEET 60 INCHES 745 FEET 84 INCHES
 _____ FEET _____ INCHES _____ FEET _____ INCHES

Formation	Color	Hard or Soft	Top	Bottom	Oil, Gas or Water	Depth Found	Remarks
Native coal			420	424			
Mapletown Coal			635	640	show gas	635	
Pittsburgh Coal			745	752			
Sand			1070	1082	show gas	1075	
Little Dunkard			1095	1110			
Big Dunkard			1210	1310			
Gas sand			1400	1475			
First Salt			1508	1555			
Second Salt			1600	1790	water 1670	show gas 1640	
Maxon			1800	1846	gas	1811 1818	
Little Lime			1860	1905			
Pencil cave			1905	1911			
Big Lime			1911	1940			
Big Injun			1940		gas	1957 to 1959	
Total depth				1983			



