

Latitude

Longitude

+ 1.94s
.39w

Topo Location

7.5' Loc. _____ 15' Loc. _____
_____ (calc.) _____

Company Valley Steel Prods. Co

Farm TJ MORRIS #2

15' Quad _____
(sec.)

7.5' Quad Wileyville

District Center

WELL LOCATION PLAT

County 103 **Permit** 30893

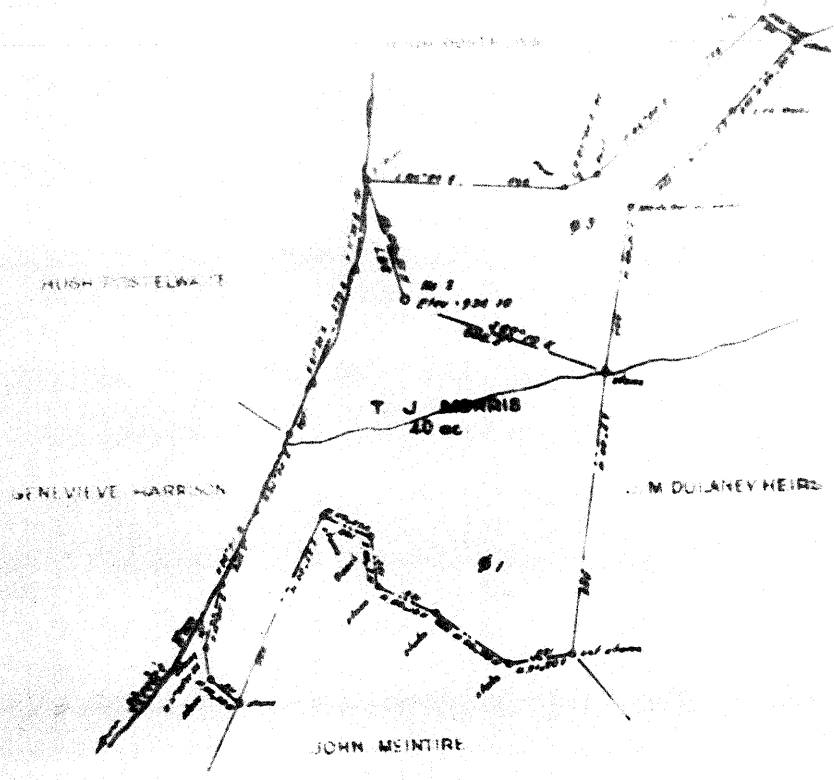

NOTE: Surface is owned by Miss Genevieve Harrison
 postoffice address is Wileyville, Mingo County, W. Va.
 Coal ownership is supposedly vested in the
 Virginia, purchased by the state for taxes

New Location
 Drill Deeper
 Abandonment

South Penn Map N-28 North 14, West 1

Company	<u>VALLEY STEEL PRODUCTS CO.</u>
Address	<u>St. Louis, Mo.</u>
Farm	<u>T. J. Morris</u>
Tract	Acres <u>10</u> Lease No. _____
Well (Farm) No.	<u>100</u> Serial No. _____
Elevation (Spirit Level)	<u>926.10'</u>
Quadrangle	<u>Littleton</u>
County	<u>Mingo</u> District <u>Center</u>

STATE OF WEST VIRGINIA
 DEPARTMENT OF MINES
 OIL AND GAS DIVISION
 CHARLESTON

WELL LOCATION
 FILE NO. Wet-893

⊕ Denotes location of well on U.S.
 Topographic Maps, scale 1 to 62,500
 Meridian and longitude lines being

WELL RECORD

Permit No. _____ Oil or Gas Well Oil
(RMP)

Company Valley Steel Products Company
 Address St. Louis, Mo.
 Farm T. d. Morris Acres 20
 Location (waters) _____
 Well No. 8 Elev. _____
 District Center County Missouri
 The surface of tract is owned in fee by _____
 Address _____
 Mineral rights are owned by _____
 Address _____
 Drilling commenced _____
 Drilling completed _____
 Date Shot From _____ To _____
 With _____
 Open Flow /10ths Water in _____ Inch
 /10ths Merc. in _____ Inch
 Volume _____ Cu. Ft.
 Rock Pressure _____ lbs. hrs.
 Oil 70 bbls bbls. 1st 24 hrs.
 Fresh water _____ feet
 Salt water _____ feet

Casing and Tubing	Used in Drilling	Left in Well	Packers
Size			
18			Kind of Packer _____
15			
10			Size of _____
8 1/2			
6 1/2	<u>2155</u>	<u>2155</u>	Depth set _____
5 1/2	<u>2310</u>	<u>2310</u>	
5			Perf. top _____
4			Perf. bottom _____
Liners Used			Perf. top _____
			Perf. bottom _____

CASING CEMENTED _____ SIZE _____ No. Ft. _____ Date _____

COAL WAS ENCOUNTERED AT _____ FEET _____ INCHES
 _____ FEET _____ INCHES FEET _____ INCHES
 _____ FEET _____ INCHES FEET _____ INCHES

Formation	Color	Hard or Soft	Top	Bottom	Oil, Gas or Water	Depth Found	Remarks
Pittsburgh Coal			2800	2800			
Big Lime			2015	2065			
Fencil Cove			2085	2015			
Big Injun			2085	2365			
Stray			2085				
Gas			2085				
First Pay			2085				
Total Depth				2915			
SHOT RECORD							
6/18/1948							
10/7/1948							
10/19/1948							



WELL OPERATOR AND THE PROPERTY ADDRESS...

Not known

LOCAL OPERATOR OF OWNER

ADDRESS

LOCAL OPERATOR OF OWNER

ADDRESS

LEASE OR PROPERTY OWNER

ADDRESS

STATE INSPECTOR SUPERVISING PLUGGING Oliver J. ...

O H I O
STATE OF WEST VIRGINIA-

AFFIDAVIT

County of WASHINGTON

Ivan Blauger

and Walter ...

being first duly sworn according to law deposit and say that ...
plugging and filling oil and gas wells and were employed by ...
well operator, and participated in the work of plugging and ...
was commenced on the 31st day of January 1951
and filled in the following manner

BAND OR ZONE RECORD	FILLING MATERIAL	
	FORMATION	DEPTH
STREY SAND	Wooden Plug	2672 - 2867
	2 Sacks neat cement & 5' crushed stone	
	filled with clay to 2550'	
	Neat cement from 2550 to 2540'	
	crushed stone and cement on top of plug	
	Set permanent bridge at 2380'	
	5' crushed rock on bridge-	
	30' below 6-5/8" Casing--Neat cement	
	5' crushed stone on cement	
	completely below the 6-5/8" casing	
COAL BEAMS	Set bridge at 1550' -2 sacks	
	crushed stone--filled with clay	
	Neat cement 1200' to 1190'	
	on cement plug. Set permanent bridge at 1000'	
	30' below Pittsburgh Coal	
	20' above coal. 5' crushed stone	
	cement plug and filled with clay to 1100'	
	(NAME)	to 240' & 5' crushed stone or cement
	(NAME)	to surface with clay
	(NAME)	

and that the work of plugging and filling said well was completed on the

February 1951

And further deponents say: not

Sworn to and subscribed before me this 17th day of February 1951

[Signature]
1951