

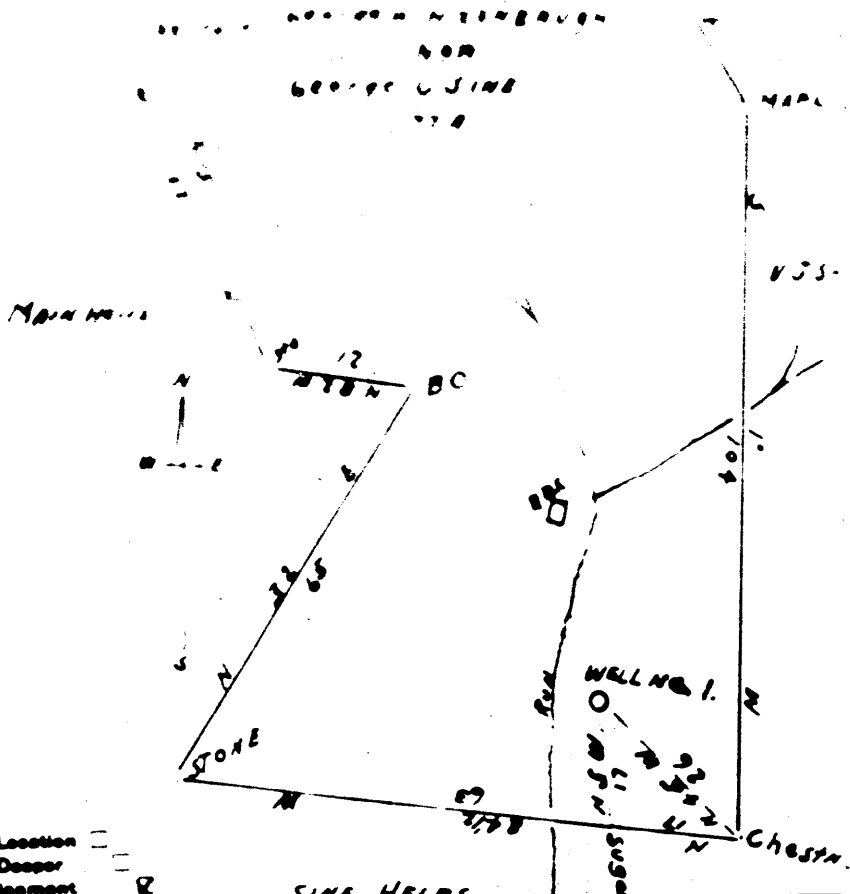

Sine HRS

39045A

80° 15' 11"



New Location =  
 Drill Desser =  
 Abandonment R

Company Cochran, and Cochran,  
 Address Farkersburg, West Virginia:  
 Farm George W. Hixenbaugh,  
 Tract One Acres 77 Lease No. \_\_\_\_\_  
 Well (Farm) No. 1, Serial No. \_\_\_\_\_  
 Elevation (Bench Level) 1149.4 feet  
 Quadrangle Mannington,  
 County Wetzel District Church  
 Engineer J.M. Cochran  
 Engineer's Registration No. \_\_\_\_\_ (C): Surveyor.

STATE OF WEST VIRGINIA  
 DEPARTMENT OF MINES  
 OIL AND GAS DIVISION  
 CHARLESTON

**WELL LOCATION**  
 FILE NO. Wet. 923

† Denotes location of well on Unit.  
 Topographic Map, scale 1 to 62  
 Mide and longitude lines being re-  
 by border lines as shown.

Company \_\_\_\_\_  
 Address \_\_\_\_\_  
 Farm \_\_\_\_\_ Acres \_\_\_\_\_  
 Location (waters) \_\_\_\_\_  
 Well No. \_\_\_\_\_ Elev. \_\_\_\_\_  
 District Church \_\_\_\_\_ County \_\_\_\_\_  
 The surface of tract is owned in fee by \_\_\_\_\_  
 Address \_\_\_\_\_  
 Mineral rights are owned by \_\_\_\_\_  
 Address \_\_\_\_\_  
 Drilling commenced \_\_\_\_\_  
 Drilling completed \_\_\_\_\_  
 Date shut \_\_\_\_\_ To \_\_\_\_\_  
 With \_\_\_\_\_ gals  
 Open Flow \_\_\_\_\_ /10ths Water in \_\_\_\_\_  
 \_\_\_\_\_ /10ths Merc. in \_\_\_\_\_  
 Volume \_\_\_\_\_ Cu Ft  
 Rock Pressure \_\_\_\_\_ lbs  
 Oil \_\_\_\_\_ bbls. 1st 24 hrs  
 Fresh water \_\_\_\_\_ feet  
 Salt water \_\_\_\_\_ feet

Casing and Tubing \_\_\_\_\_  
 Used in Drilling \_\_\_\_\_  
 Left in Well \_\_\_\_\_  
 Features \_\_\_\_\_

Kind of Packer \_\_\_\_\_  
 Size of \_\_\_\_\_  
 Depth set \_\_\_\_\_  
 Perf. top \_\_\_\_\_  
 Perf. bottom \_\_\_\_\_  
 Perf. top \_\_\_\_\_  
 Perf. bottom \_\_\_\_\_

CASING CEMENTED \_\_\_\_\_ SIZE \_\_\_\_\_ No. Ft. \_\_\_\_\_ Date \_\_\_\_\_

COAL WAS ENCOUNTERED AT 315 FEET \_\_\_\_\_ INCHES \_\_\_\_\_  
 315 FEET \_\_\_\_\_ INCHES \_\_\_\_\_ FEET \_\_\_\_\_ INCHES  
 FEET \_\_\_\_\_ INCHES \_\_\_\_\_ FEET \_\_\_\_\_ INCHES

Formation	Color	Hard or Soft	Top	Bottom	Oil, Gas or Water	Depth Found	Remarks
Lapletown Coal			935	Not recorded			
Pittsburg Coal			945	" "			
Dunkard sand			1500	1500			
Gas sand			1600	1670			
Salt sand			1700	2000			
L'axon			2045	2105			
Big Lime			2105	2105			
Big Injun			2105	2435			
30 Ft Sand			2750	2750			
50 Ft Sand			2900	2975			
Stray sand			2985	3018			
Gordon sand			3015	3030			
4th Sand			3095	3130			
Total depth			3136		Oil 0.126 Gas .005		

This is all the information recorded on this well

AUG 1951  
WEST VIRGINIA

