

Latitude 39° 35'

Longitude 80° 25'

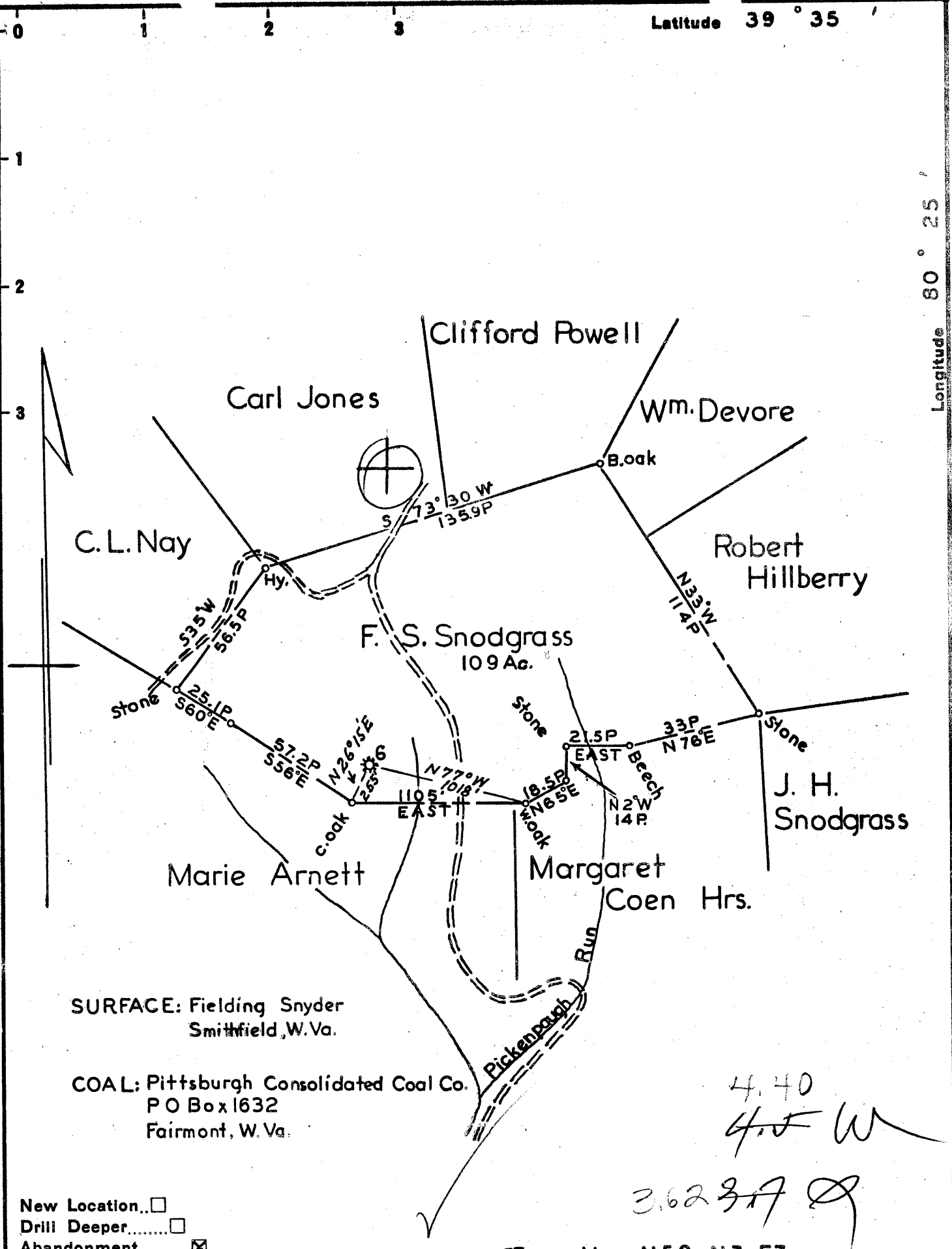

SURFACE: Fielding Snyder  
Smithfield, W. Va.

COAL: Pittsburgh Consolidated Coal Co.  
P O Box 1632  
Fairmont, W. Va.

- New Location...
- Drill Deeper.....
- Abandonment.....

MAY 20 1957

Map N 59 N 7 E 7

Company	South Penn Natural Gas Co.
Address	Parkersburg, West Virginia.
Farm	F. S. Snodgrass
Tract	Acres 109 Lease No. 48908
Well (Farm) No.	6 Serial No.
Elevation (Spirit Level)	1301.30 Casinghead
Quadrangle	Mannington
County	Wetzel District Grant
Engineer	Wm. S. Hayes
Engineer's Registration No.	1429
File No.	Drawing No.
Date	April 23, 1957 Scale 1" 800'

STATE OF WEST VIRGINIA  
DEPARTMENT OF MINES  
OIL AND GAS DIVISION  
CHARLESTON

WELL LOCATION MAP  
FILE NO. Wet-1055-A

+ Denotes location of well on United States Topographic Maps, scale 1 to 62,500, latitude and longitude lines being represented by border lines as shown.

- Denotes one inch spaces on border line of original tracing.



STATE OF WEST VIRGINIA  
DEPARTMENT OF MINES  
OIL AND GAS DIVISION

*227*  
*1498*

*Manington*  
Permit No. *1055-A*

WELL RECORD

Oil or Gas Well Gas  
(KIND)

Company SOUTH PENN NATURAL GAS COMPANY  
Address P. O. Box 1280, Parkersburg, W. Va.  
Farm F. S. Snodgrass Acres 109  
Location (waters) \_\_\_\_\_  
Well No. 6 Elev. 2342.30  
District Grant County Netual  
The surface of tract is owned in fee by Fielden Snider  
Address Smithfield, W. Va.  
Mineral rights are owned by Fielden H. Snider, et al.  
Address Smithfield, W. Va.  
Drilling commenced Dec. 22, 1898  
Drilling completed Mar. 21, 1899  
Date Shot Various From \_\_\_\_\_ To \_\_\_\_\_  
With Timon  
Open Flow /10ths Water in \_\_\_\_\_ Inch  
/10ths Merc. in \_\_\_\_\_ Inch  
Volume \_\_\_\_\_ Cu. Ft.  
Rock Pressure \_\_\_\_\_ lbs. \_\_\_\_\_ hrs.  
Oil \_\_\_\_\_ bbls., 1st 24 hrs.  
Fresh water \_\_\_\_\_ feet \_\_\_\_\_ feet  
Salt water \_\_\_\_\_ feet \_\_\_\_\_ feet

Casing and Tubing	Used in Drilling	Left in Well	Packers
Size			Kind of Packer
16			<u>Drummer Gas</u>
13			Size of <u>5 3/16" x 2"</u>
10			Depth set <u>3130'</u>
8 1/4			
6 5/8	<u>2015'</u>	<u>2015'</u>	
5 3/16	<u>2462'-3"</u>	<u>2462'-3"</u>	
3			Perf. top
2 Tubing	<u>3118</u>	<u>3118</u>	Perf. bottom
Liners Used			Perf. top
			Perf. bottom

CASING CEMENTED \_\_\_\_\_ SIZE \_\_\_\_\_ No. Ft. \_\_\_\_\_ Date \_\_\_\_\_  
COAL WAS ENCOUNTERED AT 1065 FEET ? INCHES  
FEET INCHES FEET INCHES  
FEET INCHES FEET INCHES

Formation	Color	Hard or Soft	Top	Bottom	Oil, Gas or Water	Depth Found	Remarks
Fgh. Coal			1065				
Dunkard			1965				
Gas Sand			1815	1920			
Salt Sand			1990	2130			
Pencil Cove			2265	2270			
Big Linn			2270	2350			
Big Injun (Top)			2350				
Total Depth				2443			
Big Injun (Bottom)			2525	2535			
Fifty Foot Sand			2980	2994			
Boulder Sand			3070	3095			
Stony Sand			3130	3170			
Garden			3175	3195			
Fourth Sand			3202	3219			
Breken Sand			3260	3280	Gas	3216	
Total Depth				3710			
PRESSENT TOTAL DEPTH				3218			

RECEIVED  
WEST VIRGINIA  
DEPT. OF MINES  
DEC 18 1897

RECEIVED  
WEST VIRGINIA  
DEPT. OF MINES  
APR 18 1897

DEC 6 1897

Formation	Color	Hard or Soft	Top	Bottom	Oil, Gas or Water	Depth Found	Remarks

Date April 24, 1957, 19\_\_\_

APPROVED SOUTH PENN NATURAL GAS COMPANY, Owner

By George W. Wilmond  
 George W. Wilmond, Land Agent