

1  
2  
3  
FOOT

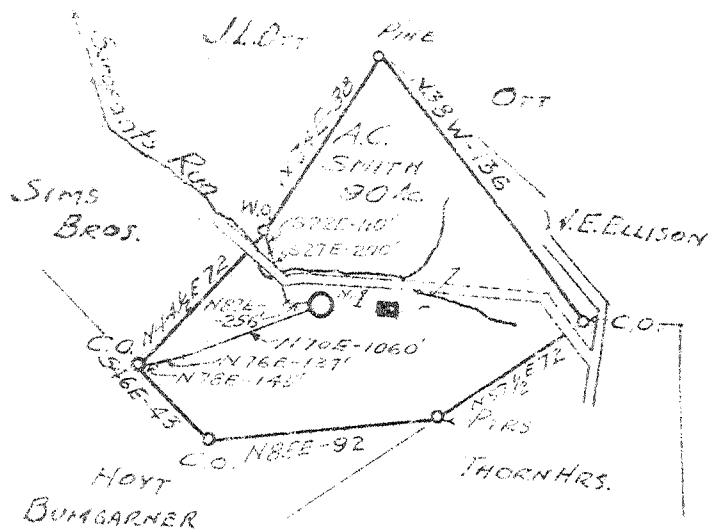

1.32-S  
~~1.30 S of 39 00'~~  
~~60 W of 81 25'~~  
 0.54-W  
 3 NE (H6)

New Location

Drill Deeper

Abandonment

Corr. 4'

- 120

Company GLEN W. ROBERTS AGENT

Address ELIZABETH, WEST VIRGINIA

Farm A. CARTER SMITH

Tract \_\_\_\_\_ Acres 90 Lease No. \_\_\_\_\_

Well (Farm) No. ONE Serial No. \_\_\_\_\_

Elevation (Spirit Level) 830

Quadrangle SPENCER

**NW**

County WIRT District REEDY

Engineer Glen W. Roberts

Engineer's Registration No. 860

File No. \_\_\_\_\_ Drawing No. \_\_\_\_\_

Date 3-20-46 Scale 1"=80 FEET

STATE OF WEST VIRGINIA  
 DEPARTMENT OF MINES  
 OIL AND GAS DIVISION  
 CHARLESTON

WELL LOCATION MAP  
 FILE NO. WIRT-218

+ Denotes location of well on United States Topographic Maps, scale 1 to 62,500, latitude and longitude lines being represented by border lines as shown.

- Denotes one inch spaces on border line of original tracing.

Deep well

WEST VIRGINIA DEPARTMENT OF MINES  
OIL & GAS DIVISION  
W E L L R E C O R D

Permit No. Wirt 218  
Spencer Quad.

Dry Hole  
CASING & TUBING

Company	United Carbon Company * see note			
Address	Box 1913, Charleston 27, W.Va.	16	17	17
Farm	A. Carter Smith Acres 90	13 3/8	47	47
Location	Sergeant Run	10 1/2	662	662
Well No.	1 (1429) Elev. 830'	8 5/8	1044	1044
District	Roody Wirt County	7 OD	1999	1999
Surface		5 1/2	5402	5402
Mineral	A.C. Smith et al, Route 27, Parkersburg, W.Va.			
Commenced	March 15, 1946			
Completed	Jan. 14, 1947			
Not shot				
Volume	Dry Hole			
Fresh Water	34' H.F.			
Salt Water	1755' H.F.			

Casing cemented:  
5 1/2 10 bags

Surface	0	6	Slate	1607	1610
Slate Blue	6	57	Lime	1610	1640
Red Rock	57	63	Slate & Shells	1640	1595
Slate Wh	63	80	Sand	1695	1945
Red Rock	80	94	Slate	1945	1964
Sand	94	105	Lime Gritty	1964	1974
Red Rock	105	119	Slate & Shells	1974	1995
Slate Sandy	119	165	Lime Gritty	1995	2073
Red Rock	165	170	Slate & Shells	2073	2356
Slate Blue	170	190	Berea Sand	2356	2358
Red Rock	190	205	Berea-Broken	2358	2364
Slate Blue	205	215	Slate & Shells	2364	2484
Red Rock	215	230	Total Depth Drilled by Glen Roberts Agt.		
Slate Sandy	230	270	REMAINDER DRILLED BY		
Red Rock	270	285	UNITED CARBON COMPANY		
Slate Blue	285	300	Slate & Shells	2484	3650
Red Rock	300	325	Shale Brown	3650	3718
Slate	325	332	Slate & Shells	3718	3728
Lime	332	336	Shale Brown	3728	3750
Red Rock	336	360	Slate & Shells	3750	4020
Slate	360	375	Slate	4020	4061
Sand	375	390	Shale Brown	4061	4180
Red Rock	390	405	Slate White	2180	4264
Slate Blue	405	423	Shale Brown	4264	4488
Sand	423	430	Slate White	4488	4988
Slate Blue	430	460	Shale Brown	4988	5045
Red Rock	460	470	Slate White	5045	5093
Slate Blue	470	515	Shale Brown	5093	5140
Sand	515	548	Slate White	5140	5185
Slate Black	548	575	Shale Black	5185	5303
Sand	575	600	Slate White	5303	5325
Slate	600	605	Shale Black - <i>Marcellus</i>	5325	5392
Red Rock	605	620	✓ Corniferous Lime	5392	5621
Sand Broken	620	645	✓ Oriskany Sand	5621	5662
Slate White	645	656	✓ Lime	5662	5675
Slate White	662	700	Sand	5675	5696
Sand	700	775	Lime Gray } <i>Helderberg</i>	5696	5700
Slate White	775	785	Total Depth		5700
Red Rock	785	857	Gas 4448' Smell		
Slate	857	900			
Red Rock	900	955			
Slate White	955	970			
Sand	970	980			
Slate White	980	1040			
Sand	1040	1053			
Slate Break	1053	1055			
Sand	1055	1150			
Slate	1150	1190			
Lime	1190	1204			
Slate	1204	1290			
Sand	1290	1347			
Slate	1347	1375			
Sand	1375	1440			
Slate & Shells	1440	1530			
Lime	1530	1560			
Sand	1560	1607			

5392      5621  
830      830  
-----  
-4562      -4791

5696  
830  
-----  
4866

485