

LATITUDE 39° 05'

LONGITUDE 81° 10'

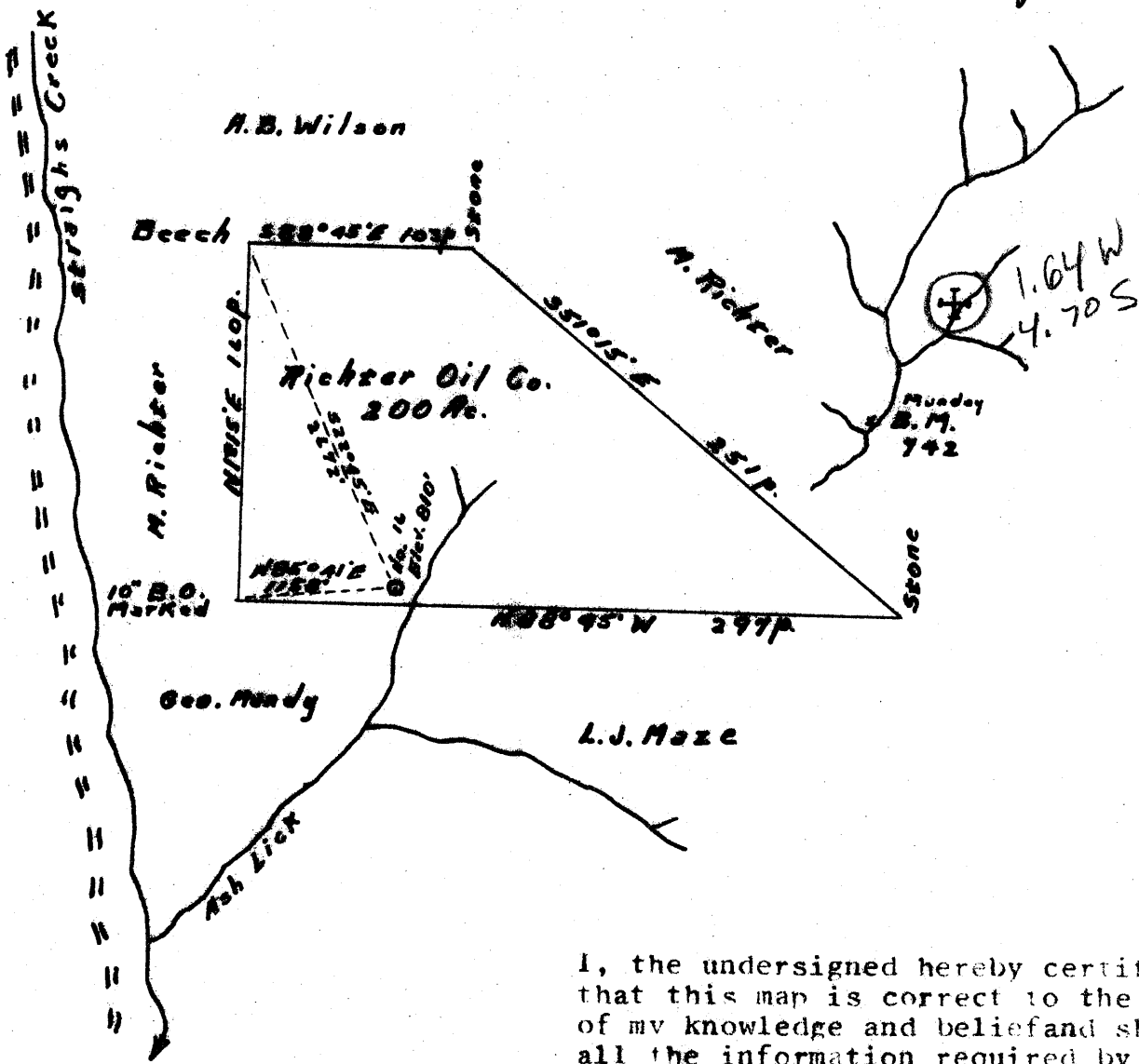

I, the undersigned hereby certify that this map is correct to the best of my knowledge and belief and shows all the information required by paragraph 6 of the rules and regulations of the oil and gas section of the mining laws of West Virginia.

MINIMUM ERROR OF CLOSURE 1" IN 200'.

New Location
 Drill Deeper
 Abandonment

Company Richter Oil Co.
 Address Brohard, W. Va.
 Farm M. Richter
 Tract Acres 200 Lease No. _____
 Well (Farm) No. 16 Serial No. _____
 Elevation (Spirit Level) 810'
 Quadrangle Parisville - SW
 County Wirt District Learning Springs
 Engineer Fogor McW...
 Engineer's Registration No. 610
 File No. _____ Drawing No. _____
 Date 10-21-65 Scale 1" = 1320'

STATE OF WEST VIRGINIA
 DEPARTMENT OF MINES
 OIL AND GAS DIVISION
 CHARLESTON

WELL LOCATION MAP
 FILE NO. WIRT-514-D

+ Denotes location of well on United States Topographic Maps, scale 1 to 62,500, latitude and longitude lines being represented by border lines as shown.

- Denotes one inch spaces on border line of original tracing.