

LATITUDE 39° 05'

LONGITUDE 81° 10'

N.

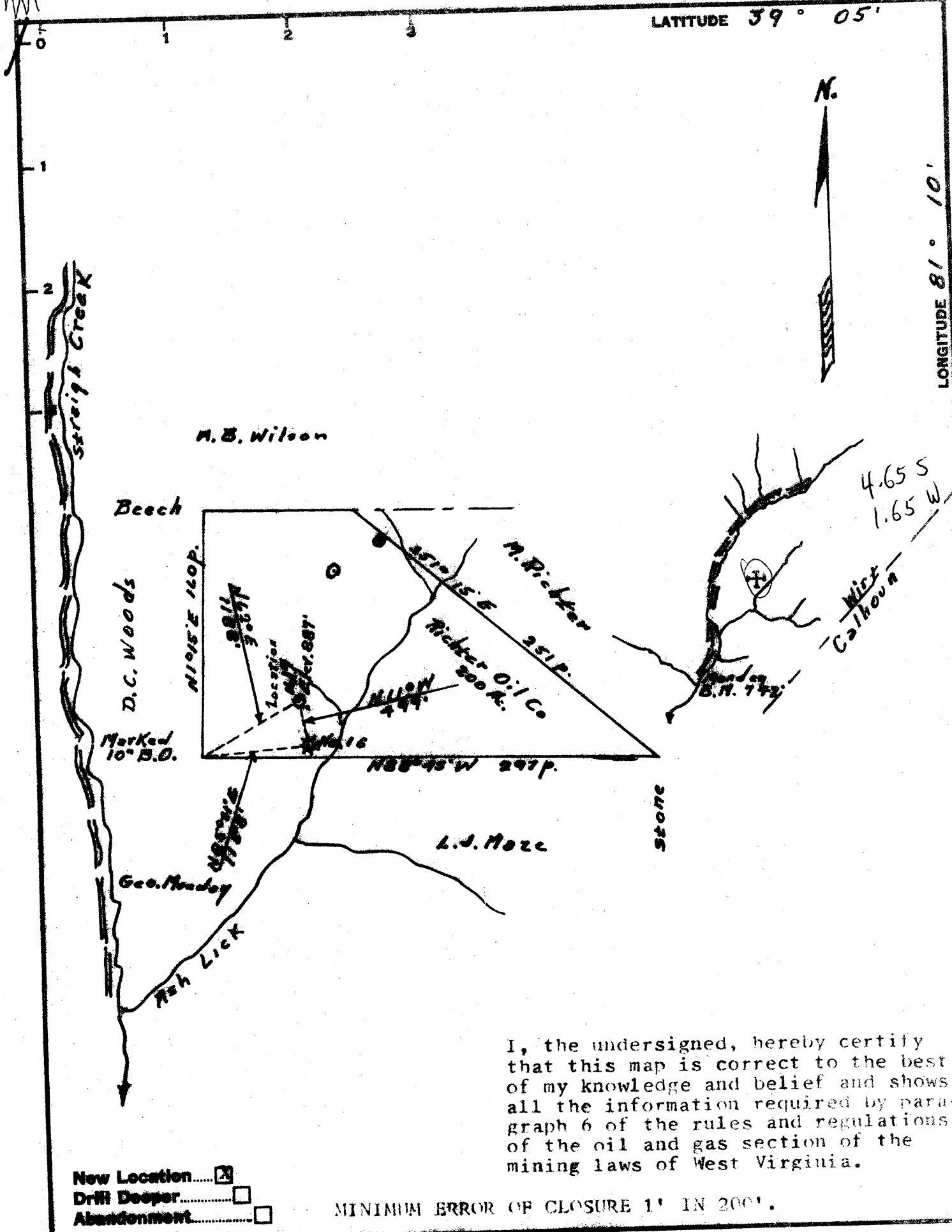

I, the undersigned, hereby certify that this map is correct to the best of my knowledge and belief and shows all the information required by paragraph 6 of the rules and regulations of the oil and gas section of the mining laws of West Virginia.

New Location.....

Drift Deeper.....

Abandonment.....

MINIMUM ERROR OF CLOSURE 1' IN 200'.

Company Richter Oil Co.

Address Grantsville, W.Va. c/o Stanley D'Orizio

Farm Richter Oil Co.

Tract Acres 200 Lease No. _____

Well (Farm) No. 10 Serial No. _____

Elevation (Spirit Level) 887'

Quadrangle Harrisville - SW
burning Springs

County Wirt District _____

Engineer Lagon McDonald

Engineer's Registration No. 610

File No. _____ Drawing No. _____

Date 5-31-66 Scale 1" = 1320'

STATE OF WEST VIRGINIA
DEPARTMENT OF MINES
OIL AND GAS DIVISION
CHARLESTON

WELL LOCATION MAP
FILE NO. Wirt - 525 525

+ Denotes location of well on United States Topographic Maps, scale 1 to 62,500, latitude and longitude lines being represented by border lines as shown.

- Denotes one inch spaces on border line of original tracing.



STATE OF WEST VIRGINIA
DEPARTMENT OF MINES
OIL AND GAS DIVISION

Rotary
Spudder
Cable Tools
Storage

Quadrangle

WELL RECORD

Permit No. Wirt 526

Oil or Gas Well **Comb.**
(KIND)

Company Richter Oil Co.
Address Grantsville, W. Va.
Farm M. Richter heirs Acres 200
Location (waters)
Well No. 20 Elev. 1120'
District Burning Springs County Wirt
The surface of tract is owned in fee by
Address
Mineral rights are owned by
Address
Drilling commenced 8/11/66
Drilling completed 9/11/66
Date Shot From To

Casing and Tubing	Used in Drilling	Left in Well	Packers
Size			Kind of Packer
16	25'	25'	
13			Size of
10	250'		
8 1/4	1125'		Depth set
6 3/4			
5 3/16			
4 1/2		2245'	Perf. top <u>2255'-61'</u>
3			Perf. bottom <u>2195'-2200'</u>
2		2150'	
Liners Used			Perf. top
			Perf. bottom

Open Flow /10ths Water in Inch
/10ths Merc. in Inch
Volume Cu. Ft.
Rock Pressure lbs. hrs.
Oil bbls., 1st 24 hrs.

Attach copy of cementing record.
CASING CEMENTED SIZE 4 1/2 No. Ft. 2245' Date

WELL ACIDIZED (DETAILS)
WELL FRACTURED (DETAILS) 1000 barrels water, 40,000 pounds # 20/40 frack sand and 1000 gallons 10% acid.

Amount of cement used (bags) 75 bags
Name of Service Co. Dowell
COAL WAS ENCOUNTERED AT FEET INCHES
..... FEET INCHES
..... FEET INCHES

RESULT AFTER TREATMENT (Initial open flow or bbls.) 300 lbs. 1,000,000 G.F.G. Two barrels oil per day 24 hours
ROCK PRESSURE AFTER TREATMENT HOURS
Fresh Water Feet Salt Water Feet
Producing Sand inju Depth

Formation	Color	Hard or Soft	Top	Bottom	OIL, Gas or Water	Depth	Remarks
surface	red	soft	000	5			
red rock	red	soft	5	20			
slate	blue	soft	20	40			
red rock	red	soft	20	75			
slate	blue	soft	75	92			
red rock	red	soft	92	116			
slate	blue	soft	116	132			
red rock	red	soft	132	150			
slate	blue	soft	150	185			
red rock	red	soft	185	202			
slate	blue	soft	202	225			
red rock	red	soft	225	260			
slate	blue	soft	260	321			
sand	white	soft	321	342			
slate	blue	soft	342	372			
red rock	red	soft	372	405			
slate	blue	soft	405	420			
sand	white	soft	420	445			
red rock	red	soft	445	502			
slate	blue	soft	502	545			
red rock	red	soft	545	555			
lime	white	hard	555	580			
slate	blue	soft	580	622			
red rock	red	soft	622	631			
slate	blue	soft	631	695			
red rock	red	soft	695	701			
sand	white	hard	701	734			
slate	blue	soft	734	760			
red rock	red	soft	760	780			

