



WELL RECORD, FORM OG-10, MUST BE SUBMITTED TO OBTAIN RELEASE OF WELL UNDER BOND.

8

STATE OF WEST VIRGINIA DEPARTMENT OF MINES OIL AND GAS DIVISION

NOTICE OF PROPOSED LOCATION OF OIL AND GAS WELL

To THE DEPARTMENT OF MINES, Charleston, W. Va.

NONE COAL OPERATOR OR COAL OWNER

Belco Petroleum Corporation NAME OF WELL OPERATOR

ADDRESS

630 Third Avenue, New York, N.Y. 10017 COMPLETE ADDRESS

COAL OPERATOR OR COAL OWNER

April 26, 1967 PROPOSED LOCATION

ADDRESS

Spring Creek District Wirt County

OWNER OF MINERAL RIGHTS

Well No. 1

ADDRESS

Glen W. Roberts et al. Farm Elevation 1118.31 Acres 312

GENTLEMEN:

The undersigned well operator is entitled to drill upon the above named farm or tract of land for oil and gas, having fee title thereto, (or as the case may be) under grant or lease dated July 25 1963, made by Glen W. Roberts et al., to Glen W. Roberts, and recorded on the 1st day of March, 1965, in the office of the County Clerk for said County in Book 112, page 191.

The enclosed plat was prepared by a competent engineer and shows the proposed location of a well to be drilled for oil and gas by the undersigned well operator on the farm and in the Magisterial District and County above named, determined by survey and courses and distances from two permanent points, or land marks.

The undersigned well operator is informed and believes there are no coal operators operating beds of coal beneath said farm or tract of land on which said well is located, or within 500 feet of the boundaries of the same, who have mapped their workings and filed their maps as required by law, excepting the coal operators or coal owners (if any) above named as addressees.

The above named coal operators or coal owners (if any) are notified that any objections they may desire to make to such proposed location, or which they are required to make by Section 3 of said Code, if the drilling of a well at said proposed location will cause a dangerous condition in or about their respective coal mines, must be received by, or filed with the Department of Mines within ten* days from the receipt of a copy of this notice and accompanying plat by said Department. Said coal operators are further notified that forms for use in making such objections will be furnished to them by the Department of Mines promptly on request and that all such objections must set forth as definitely as is reasonably possible the ground or grounds on which such objections are based and indicate the direction and distance the proposed location should be moved to overcome same.

(The next paragraph is to be completed only in Department's copy.)

Copies of this notice and the enclosed plat were mailed by registered mail, or delivered to the above named coal operators or coal owners at their above shown respective address day before, or on the same day with the mailing or delivery of this copy to the Department of Mines at Charleston, West Virginia.

Very truly yours, BELCO PETROLEUM CORPORATION

(Sign Name) By: Robert E. Dippel WELL OPERATOR

630 Third Avenue

STREET

New York

CITY OR TOWN

New York, 10017

STATE

01/19/2024

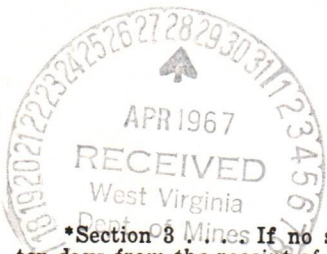

Address of Well Operator

*Section 8 Mines If no such objections be filed or be found by the department of mines, within said period of ten days from the receipt of said notice and plat by the department of mines, to said proposed location, the department shall forthwith issue to the well operator a drilling permit reciting the filing of such plat, that no objections have been made by the coal operators to the location, or found thereto by the department, and that the same is approved and the well operator authorized to proceed to drill at said location.

WIRT-537 PERMIT NUMBER

BLANKET BOND

537

1/22/24

UNITED STATES DEPARTMENT OF JUSTICE
FEDERAL BUREAU OF INVESTIGATION

MEMORANDUM FOR THE DIRECTOR



NOTICE OF PROCEEDINGS

TO: [Name]

FROM: [Name]

RE: [Subject]

DATE: [Date]

1. [Text]

2. [Text]

3. [Text]

4. [Text]

5. [Text]

6. [Text]

7. [Text]

8. [Text]

9. [Text]

10. [Text]

11. [Text]

12. [Text]

01/19/2024

A-11

BELCO PETROLEUM
CORPORATION

630 THIRD AVENUE NEW YORK, N. Y. 10017
TELEPHONE YUKON 6-8191
CABLE: BELCOPETE

③

April 27, 1967

State of West Virginia
Department of Mines
Oil and Gas Division
Charleston 5, West Virginia

Attention: Mr. Gurmer Wamock

Gentlemen:

Enclosed for your further handling please find the original and one copy of Belco's Notice of Proposed Location for its number one Glen Roberts, et al., Spring Creek, Wirt County, West Virginia.

Your early action on issuing the Permit would be appreciated. To my knowledge there are no coal operators in this area.

Very truly yours,

BELCO PETROLEUM CORPORATION

Robert E. Dippe
Robert E. Dippe

RED:mh
Enclosure



01/19/2024



Faint, illegible text at the top of the page, possibly a header or title.

Second block of faint, illegible text in the upper middle section.

Third block of faint, illegible text in the middle section.

Fourth block of faint, illegible text in the lower middle section.

Fifth block of faint, illegible text in the lower section.

Sixth block of faint, illegible text near the bottom of the page.

A-12



State of West Virginia

Department of Mines
Oil and Gas Division

Charleston 25305
May 5, 1967

ELMER C. WORKMAN
DIRECTOR

GURMER WAMOCK
DEPUTY DIRECTOR

Belco Petroleum Corporation
630 Third Avenue
New York, New York 10017

Att: Mr. Robert E. Dippo

In Re: Permit WIRT-537
Farm Glen W. Roberts, et al
Well No. 1
District Spring Creek
County Wirt

Gentlemen:

Enclosed is Permit for drilling the above described well.

Please post one copy of permit at the well site and send us two copies of the well record when drilling has been completed.

Very truly yours,

GURMER WAMOCK
DEPUTY DIRECTOR

GW/⁹⁹
Enclosures

cc:

West Virginia Geological & Economic Survey
Mr. Arthur Null, Inspector Box 296 Hundred, W. Va. Phone:
775-5611

bc: Mr. C. A. Washburn, Deputy
Securities Commission

01/19/2024

B-1



STATE OF WEST VIRGINIA
DEPARTMENT OF MINES
OIL AND GAS DIVISION

Rotary
Spudder
Cable Tools
Storage

Quadrangle.....

Permit No. 537-WIR

WELL RECORD

Oil or Gas Well Dry
(KIND)

Company <u>Belco Petroleum Corporation</u>	Casing and Tubing	Used in Drilling	Left in Well	Packers
Address <u>630 Third Ave., New York, N. Y. 10017</u>	Size			
Farm <u>Glenn W. Roberts</u> Acres <u>312</u>	16.....			Kind of Packer.....
Location (waters).....	13 <u>3/8"</u>	<u>35'</u>	<u>35'</u>	Size of.....
Well No. <u>1</u> Elev. <u>1118.3'</u>	18 <u>9 5/8"</u>	<u>2026'</u>	<u>2026'</u>	Depth set.....
District <u>Spring Creek</u> County <u>Wirt</u>	8 1/4.....			Perf. top.....
The surface of tract is owned in fee by <u>Glenn W. Roberts</u>	6 5/8.....			Perf. bottom.....
Address <u>Elizabeth, W. Va.</u>	5 3/16.....			Perf. top.....
Mineral rights are owned by <u>Glenn W. Roberts</u>	4 1/2.....			Perf. bottom.....
Address <u>Elizabeth, W. Va.</u>	3.....			
Drilling commenced <u>July 11, 1967</u>	2.....			
Drilling completed <u>July 17, 1967</u>	Liners Used.....			
Date Shot..... From..... To.....				
With.....				

Open Flow /10ths Water in..... Inch

Attach copy of cementing record.

CASING CEMENTED..... SIZE..... No. Ft..... Date

Volume None Cu. Ft.

Amount of cement used (bags).....

Rock Pressure..... lbs..... hrs.

Name of Service Co.....

Oil..... bbls., 1st 24 hrs.

COAL WAS ENCOUNTERED AT..... FEET..... INCHES

..... FEET..... INCHES..... FEET..... INCHES

..... FEET..... INCHES..... FEET..... INCHES

WELL ACIDIZED (DETAILS).....

WELL FRACTURED (DETAILS) No

RESULT AFTER TREATMENT (Initial open Flow or bbls.).....

ROCK PRESSURE AFTER TREATMENT..... HOURS

Fresh Water..... Feet..... Salt Water 1930-1936 Feet 5920-5925

Producing Sand..... Depth.....

Formation	Color	Hard or Soft	Top	Bottom	Oil, Gas or Water	Depth	Remarks
Red Shale			0	1620	Salt Sand	1618'	(log)
White Sand			1620	1810	Greenbrier	1812'	(log)
Limestone & Sandstone			1810	1890	Big Injun	1886'	(log)
White Sand			1890	1910	Little Injun	1910'	(log) - trace of gas & water
Sand Silt			1910	1936			
Shale - Gray			1936	2320			
Shale - Brown			2320	2330			
Shale - Gray & Interbedded Siltstone - Gray			2330	5630			
Shale - Dark Brown to Black			5630	5657	Marcellus	5634'	
Limestone - White			5657	5720	Corniferus	5698'	
Limestone & Chert			5720	5910			
Sandstone - White			5910	6010	Oriskany	5911'	- trace of oil and water
Limestone - Shale - Anhydrite			6010	6088 TD	Helderberg	6000'	

Ran - Induction, Density and Gamma Neutron Logs

01/19/2024

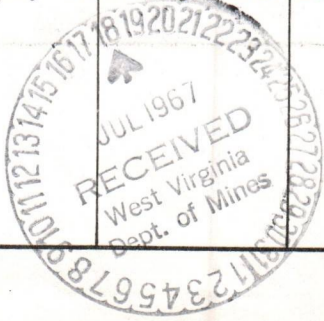

B-2

STATE OF WEST VIRGINIA
DEPARTMENT OF MINES
OIL AND GAS DIVISION

INSPECTOR'S WELL REPORT

Permit No. WTR-537

Oil or Gas Well _____
(KIND)

Company <u>BELCO PETROLEUM</u>	CASING AND TUBING	USED IN DRILLING	LEFT IN WELL	PACKERS
	Address <u>630-THIRD AVE. - NEW YORK, N.Y. - 10017</u>	Size		
Farm <u>GLEN W. ROBERTS ET AL.</u>	16			
Well No. <u>I.</u>	13 <u>3/8</u>	<u>35'</u>		
District <u>SPRING CREEK</u> County <u>WIAT</u>	10			Size of
Drilling commenced <u>7-11-67</u>	<u>9 5/8 100 CEN. 8 3/4 ONS.</u>	<u>2026'</u>		
Drilling completed _____ Total depth _____	6 5/8			Depth set
Date shot _____ Depth of shot _____	5 3/16			
Initial open flow _____ /10ths Water in _____ Inch	3			Perf. top
Open flow after tubing _____ /10ths Merc. in _____ Inch	2			Perf. bottom
Volume _____ Cu. Ft.	Liners Used			Perf. top
Rock pressure _____ lbs. _____ hrs.				Perf. bottom
Oil _____ bbls., 1st 24 hrs.	CASING CEMENTED _____ SIZE _____ No. FT. _____ Date _____			
Fresh water _____ feet _____ feet	NAME OF SERVICE COMPANY _____			
Salt water <u>1775</u> feet <u>SALT SAND</u> feet	COAL WAS ENCOUNTERED AT _____ FEET _____ INCHES			
	_____ FEET _____ INCHES _____ FEET _____ INCHES			
	_____ FEET _____ INCHES _____ FEET _____ INCHES			

Drillers' Names W.C. LYONS, U.D. PARSONS - W.C. GOODWIN (MILFORD SHOFFNER - FOREMAN - RIPLEY

Remarks: RTLG 5945' IN ORISKANY RAYBROS. CONTR. - ROTARY

7-17-67
DATE



Henry C. Ripley
DISTRICT WELL INSPECTOR

01/19/2024

STATE OF WEST VIRGINIA
DEPARTMENT OF MINES
OIL AND GAS DIVISION
INSPECTOR'S PLUGGING REPORT

Permit No. _____

Well No. _____

COMPANY _____ ADDRESS _____

FARM _____ DISTRICT _____ COUNTY _____

Filling Material Used _____

Liner			Location	Amount	Packer	Location		
PLUGS USED AND DEPTH PLACED			BRIDGES			CASING AND TUBING		
CEMENT-THICKNESS	WOOD-SIZE	LEAD	CONSTRUCTION-LOCATION			RECOVERED	SIZE	LOST

Drillers' Names _____

Remarks: _____

_____ I hereby certify I visited the above well on this date.
DATE

B-3

STATE OF WEST VIRGINIA
DEPARTMENT OF MINES
OIL AND GAS DIVISION
INSPECTOR'S PLUGGING REPORT

Permit No. WIA-537-P

Well No. I.

COMPANY BELCO PETROLEUM CORPORATION ADDRESS 630 THIRD AVE. NEW YORK, N.Y. 10017

FARM GLEN W. ROBERTS DISTRICT SPRING CREEK COUNTY WIAT

Filling Material Used 6% BENTONITE MUD (GEL) + CEMENT. (85 BAGS)

Liner			Location	Amount	Packer	Location
CEMENT-THICKNESS			WOOD-SIZE	LEAD	CONSTRUCTION-LOCATION	RECOVERED SIZE LOST
7.0--6088'						
GEL TO SURFACE						13 3/8" 35'
30' CEM. PLUGS AT:-						
5880'						CEM. IN WITH 100 BAGS 9 5/8" 2026'
5600'						
4700'						
2025'						
CEM. 50' TO 0						

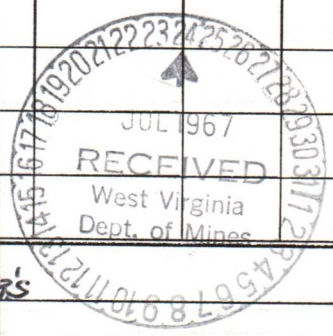

Drillers' Names MILFORD SHOFFNER - DRILL SUPT. FOR RAY BROS. CONTRS

Remarks: PLUGGING BY POWELL
DAWELL 7-18-67 - 2:30 P.M. TO 10 P.M.
13 3/8" X 2' NIPPLE SET ON TOP OF 13 3/8" + CEMENTED.

7-18-67 I hereby certify I visited the above well on this date.
DATE

Henry A. Holliday

DISTRICT WELL NUMBER 011192024

STATE OF WEST VIRGINIA
DEPARTMENT OF MINES
OIL AND GAS DIVISION

INSPECTOR'S WELL REPORT

Permit No. 12119 JPP

Oil or Gas Well _____
(KIND)

Company _____ Address _____ Farm _____ Well No. _____ District _____ County _____ Drilling commenced _____ Drilling completed _____ Total depth _____ Date shot _____ Depth of shot _____ Initial open flow _____ /10ths Water in _____ Inch Open flow after tubing _____ /10ths Merc. in _____ Inch Volume _____ Cu. Ft. Rock pressure _____ lbs. _____ hrs. Oil _____ bbls., 1st 24 hrs. Fresh water _____ feet _____ feet Salt water _____ feet _____ feet	CASING AND TUBING	USED IN DRILLING	LEFT IN WELL	PACKERS
	Size _____ 16 _____ 13 _____ 10 _____ 8 1/4 _____ 6 5/8 _____ 5 3/16 _____ 3 _____ 2 _____ Liners Used _____			
CASING CEMENTED _____ SIZE _____ No. FT. _____ Date _____ NAME OF SERVICE COMPANY _____ COAL WAS ENCOUNTERED AT _____ FEET _____ INCHES _____ FEET _____ INCHES _____ FEET _____ INCHES _____ FEET _____ INCHES _____ FEET _____ INCHES				

Drillers' Names _____

Remarks: _____

PROPOSED MANNER OF PLUGGING AND FILLING WELL

(REQUIRED BY RULES AND REGULATIONS)

WEST VIRGINIA DEPARTMENT OF MINES

OIL AND GAS DIVISION

WORK ORDER

Well to be plugged and filled as follows:

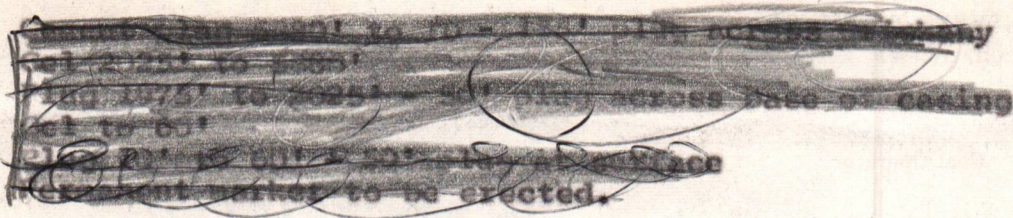

Service Company will perform plugging in conjunction with contractor.

Total Depth of Well - 6888'

Fill hole with 6% Bentonite Mud (gel)

Place 20' cement plugs at the following depths:

- 5880'
- 5600'
- 4200'
- 2025'
- 1860'
- 1650'
- 1200'
- 750'
- 200'

Erect marker in accordance to Rule 12 of the Oil and Gas Regulations.

To the Department of Mines
Coal Owner or Operator,
Lease or Property Owner.

Gentlemen:

This "work order" is submitted for your approval and concurrence and unless notified of your disapproval or non-concurrence, the undersigned will proceed with the plugging and filling of said well in the above described manner on the date inspector is notified after permit is issued.

Very truly yours,

Belco Petroleum Corporation

, Agent
Well Operator

No objections have been filed by the coal owner or coal operator, or any available adjacent lease or property owners or interposed by the Department of Mines to the manner herein described for the plugging and filling of the well above mentioned. Therefore, the same is hereby approved this

18th day of July, 1967. 01/19/2024

DEPARTMENT OF MINES
Oil and Gas Division

By: _____
Guernsey Wainock

NOTE: This "work order" shall be filed in triplicate, one copy for the files of the Department of Mines; one to be approved or corrected and returned to the well operator as his authority for plugging said well; and one for the well inspector.



STATE OF WEST VIRGINIA
DEPARTMENT OF MINES
OIL AND GAS DIVISION

NOTICE OF INTENTION TO PLUG AND ABANDON WELL

(REQUIRED BY SECTION 9, ARTICLE 4, CHAPTER 22 OF THE CODE)

TO THE DEPARTMENT OF MINES,
Charleston, W. Va.

None Coal Operator Belco Petroleum Corporation Name of Well Operator
630 Third Avenue Complete Address
New York, N. Y. 10017
 Address Complete Address
July 18, 1967 Date
 Coal Owner
 WELL TO BE ABANDONED
Spring Creek District
 Address
Wirt County
Glenn W. Roberts Lease or Property Owner
 Well No. 1
Elizabeth, W. Va. Address
Glenn W. Roberts Farm
 Inspector to be notified Harry Holiday Grantsville Telephone Number 354-6145

Gentlemen:— **24 HOURS IN ADVANCE OF PLUGGING**

The undersigned well operator is about to abandon the above described well and will commence the work of plugging and abandoning said well on the date inspector is notified (which date shall not be less than five days after the day on which this notice so mailed is received, or in due course should be received by the Department of Mines).

This notice is given you in order that your respective representatives may be present at the plugging and filling of said well. You are further notified that whether you are represented or not represented the undersigned will proceed on that date, or shortly thereafter, to plug and fill said well in the manner required by Section 10, Article 4, Chapter 22 of the Code and given in detail on the reverse side of this notice, in "Work Order."

This notice is being mailed by registered mail to each of you at the above addresses on the above date.

Very truly yours,
Belco Petroleum Corporation
James S Ray, Agent
Well Operator

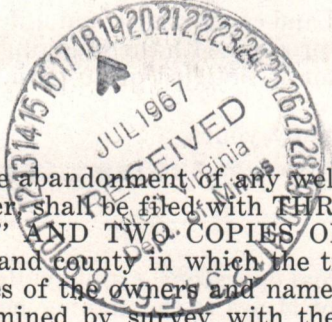

NOTE: Upon the abandonment of any well drilled prior to June 1, 1929, a plat prepared by a registered engineer shall be filed with THREE COPIES OF APPLICATION, (OG-9) AND "WORK ORDER" AND TWO COPIES OF THE WELL RECORD, (OG-10). The map must show the district and county in which the tract of land is located, the name and acreage of same, the name or names of the owners and names of adjacent tracts and the location of the well to be abandoned, determined by survey with the courses and distances of such well from two permanent points or landmarks on said tract.

01/19/2024

NOTE: In case plugging is not commenced within four months from the date of permit, same shall expire and be of no further force or effect.

NOTE: PERMIT IS NOT TRANSFERABLE.

WIRT-537-P
Permit Number

STATE OF WEST VIRGINIA
DEPARTMENT OF MINES
OIL AND GAS DIVISION

RECEIVED

JAN 31 1972

OIL & GAS DIVISION
DEPT. OF MINES

AFFIDAVIT OF PLUGGING AND FILLING WELL

AFFIDAVIT SHOULD BE MADE IN TRIPPLICATE, ONE COPY MAILED TO THE DEPARTMENT, ONE COPY TO BE RETAINED BY THE WELL OPERATOR AND THE THIRD COPY (AND EXTRA COPIES IF REQUIRED) SHOULD BE MAILED TO EACH COAL OPERATOR AT THEIR RESPECTIVE ADDRESSES.

None
COAL OPERATOR OR OWNER
ADDRESS
COAL OPERATOR OR OWNER
ADDRESS
Glenn W. Roberts
LEASE OR PROPERTY OWNER
Elizabeth, W. Va.
ADDRESS

Belco Petroleum Corporation, c/o James
NAME OF WELL OPERATOR S. Ray, Agent
630 Commerce Square, Charleston, W. Va. 25301
COMPLETE ADDRESS
January 21, 19 72
WELL AND LOCATION
Spring Creek District
Wirt County
Well No. 1
Glenn W. Roberts Farm

STATE INSPECTOR SUPERVISING PLUGGING.....

AFFIDAVIT

STATE OF WEST VIRGINIA, }
County of KANAWHA } ss:

M. M. Shoffner and James S. Ray
being first duly sworn according to law depose and say that they are experienced in the work of plugging and filling oil and gas wells and were employed by Belco Petroleum well operator, and participated in the work of plugging and filling the above well, that said work was commenced on the 18th day of July, 1967, and that the well was plugged and filled in the following manner:

SAND OR ZONE RECORD FORMATION	FILLING MATERIAL	PLUGS USED SIZE & KIND	CASING	
			CSG PULLED	CSG LEFT IN
	Hole filled with 6% Gel from T.D. (6,088') to Surface		None	9-5/8" @ 2,026' (cmtd. in)
LM - Conf.	Cement Plug - 15 sx	5865 - 5895'		13-3/8"
Shale - Dev.	Cement Plug - 15 sx	5585 - 5615'		@ 35' (cmtd. in)
Shale - Dev.	Cement Plug - 15 sx	4185 - 4215'		
Shale - (9-5/8" csg.)	Cement Plug - 15 sx	2010 - 2040'		
9-5/8" Csg.	Cement Plug - 25 sx	Surf. - 50'		
COAL SEAMS (NAME) None			DESCRIPTION OF MONUMENT 7" Casing cmtd. 3' above ground level.	
(NAME)				
(NAME)				
(NAME)				

and that the work of plugging and filling said well was completed on the 18th day of July, 19 67.

And further deponents saith not.

Sworn to and subscribed before me this 28th day of January, 19 72

My commission expires: August 8, 1978

X *M. M. Shoffner*
X *James S. Ray* 01/19/2024
Helen Mae Brodgrass
Notary Public.
Permit No. WIR-537P

STATE OF WEST VIRGINIA
DEPARTMENT OF MINES
OIL AND GAS WELLS DIVISION

RECEIVED

APR 18 1972

OIL & GAS DIVISION
DEPT. OF MINES

INSPECTOR'S WELL REPORT

Permit No. WIRT-537-P

Oil or Gas Well Gas
(KIND)

Company <u>Belco Petroleum Corporation</u>	CASING AND TUBING	USED IN DRILLING	LEFT IN WELL	PACKERS
Address <u>New York City</u>	Size			Kind of Packer
Farm <u>Glenn W. Roberts</u>	16			
Well No. <u>1</u>	13			
District <u>Spring Creek</u> County <u>Wirt</u>	10			Size of
Drilling commenced	8 1/4			
Drilling completed	6 5/8			Depth set
Date shot	5 3/16			
Initial open flow	3			Perf. top
Open flow after tubing	2			Perf. bottom
Volume	Liners Used			Perf. top
Rock pressure				Perf. bottom
Oil	CASING CEMENTED	SIZE	No. FT.	Date
Fresh water	NAME OF SERVICE COMPANY			
Salt water	COAL WAS ENCOUNTERED AT			
	FEET	INCHES	FEET	INCHES
	FEET	INCHES	FEET	INCHES
	FEET	INCHES	FEET	INCHES

Drillers' Names _____

Remarks: Final inspection has been made for bond release.

BOND CANCELLED
RETURNED TO WELL OPERATOR AND/OR PRINCIPAL

April 18 1972

4/14/72
DATE

Fred B. ...
DISTRICT WELL INSPECTOR

01/19/2024

STATE OF WEST VIRGINIA
 DEPARTMENT OF MINES
 OIL AND GAS WELLS DIVISION
INSPECTOR'S PLUGGING REPORT

Permit No. _____

Well No. _____

COMPANY _____ ADDRESS _____

FARM _____ DISTRICT _____ COUNTY _____

Filling Material Used _____

Liner	Location	Amount	Packer	Location		
PLUGS USED AND DEPTH PLACED			BRIDGES	CASING AND TUBING		
CEMENT-THICKNESS	WOOD-SIZE	LEAD	CONSTRUCTION-LOCATION	RECOVERED	SIZE	LOST

Drillers' Names _____

Remarks:

_____ I hereby certify I visited the above well on this date.
DATE

 DISTRICT WELL INSPECTOR
01/19/2024

B-12



State of West Virginia

Department of Mines
Oil and Gas Division
Charleston 5

April 18, 1972

Belco Petroleum Corp.
c/o Mr. James S. Ray, Agt.
630 Commerce Square
Charleston, W.Va. 25301

In Re: Permit No. WIRT-537-P
Farm Glenn W. Roberts
Well No. 1
District Spring Creek
County Wirt

Gentlemen:

The final inspection report for the well which is described above has been received in this office. ONLY the column checked below applies.

~~xxx~~ The bond which is covered by the above permit number has been released under your Blanket Bond.

Please return the enclosed cancelled bond to the Surety Company that executed said bond in your behalf, in order that they may give you credit on their records.

Very truly yours,

Deputy Director
Oil & Gas Division

RLD/cc /f

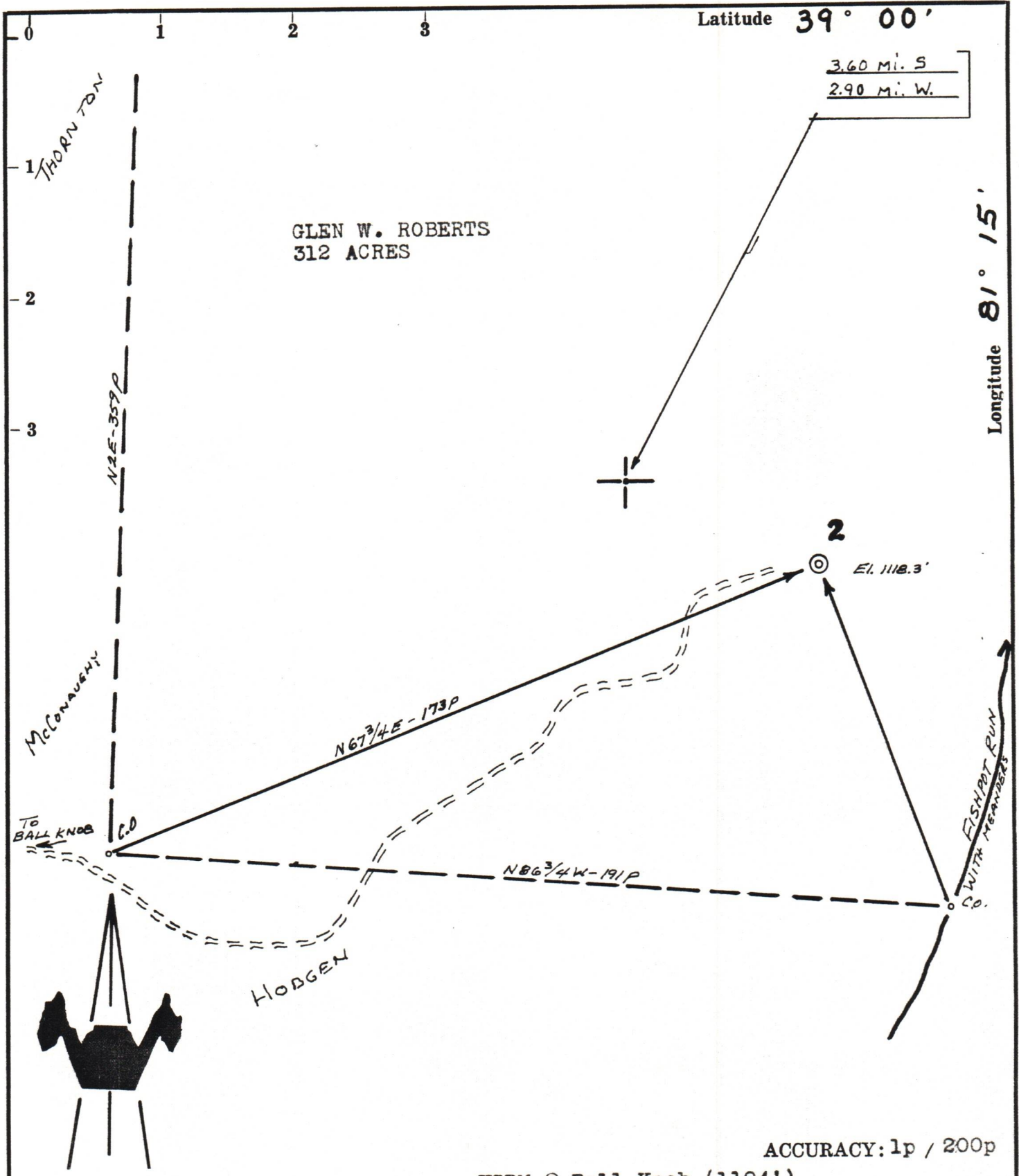

ACCURACY: 1p / 200p

Source of Elevation USBM @ Ball Knob (1194')

- New Location
- Drill Deeper
- Abandonment
- Fracture
- Redrill

I, the undersigned, hereby certify that this map is correct to the best of my knowledge and belief and shows all the information required by paragraph 6 of the rules and regulations of the oil and gas section of the mining laws of West Virginia.

Chet Waterman

Company	BELCO PETROLEUM CORPORATION		
Address	NEW YORK CITY		
Farm	GLEN W. ROBERTS		
Tract	Acres	312	Lease No.
Well (Farm) No.	1	Serial No.	
Elevation (Spirit Level)	1118.3'		
Quadrangle	BURNING SPRINGS SPENCER		
County	WIRT	District	SPRING CREEK
Engineer	CHET WATERMAN		
Engineer's Registration No.	3788		
File No.	67003-34	Drawing No.	
Date	4/11/67	Scale	1" = 30p

STATE OF WEST VIRGINIA
DEPARTMENT OF MINES
OIL AND GAS DIVISION
CHARLESTON

WELL LOCATION MAP

FILE NO. WIRT 537-P 01/19/2024

+ Denotes location of well on United States Topographic Maps, scale 1 to 62,500, latitude and longitude lines being represented by border lines as shown.

— Denotes one inch spaces on border line of original tracing.