



STATE OF WEST VIRGINIA
DEPARTMENT OF MINES

C87 on incorrect form attached
RECEIVED
OCT 20 1972
OIL & GAS DIVISION
DEPT. OF MINES

Oil and Gas Division
OIL AND GAS WELL PERMIT APPLICATION

TO THE DEPARTMENT OF MINES,
Charleston, W. Va.

DATE October 20, 1972

Surface Owner West Vaco

Company National Petroleum Corporation

Address _____

Address 6161 Busch Blvd., Columbus, O. 43229

Mineral Owner Nella Thorn

Farm Westvaco Acres 86

Address _____

Location (waters) Thorns Run of Reedy Creek

Coal Owner No Coal

Well No. 1 Elevation 720'

Address _____

District Reedy County Wirt

Coal Operator _____

Quadrangle Spencer

Address _____

INSPECTOR TO BE NOTIFIED Mr. Fred Burdette
Box 190 PH: 984-9263

THIS PERMIT MUST BE POSTED AT THE WELL SITE

All provisions being in accordance with Chapter 22, of the W. Va. Code, the location is hereby approved for drilling. This permit shall expire if operations have not commenced by 2-20-73

Robert L. Todd
Deputy Director - Oil & Gas Division

Cigerone Route
Sissonville
W. Va. 25185

GENTLEMEN:

The undersigned well operator is entitled to drill upon the above named farm or tract of land for oil and gas, having fee title thereto, (or as the case may be) under grant or lease dated October 12, 1972 by Glen W. Roberts made to National Pet. Corp. and recorded on the _____ day of _____ 19____, in _____ County, Book _____ Page _____

XX NEW WELL _____ DRILL DEEPER _____ REDRILL _____ FRACTURE OR STIMULATE _____ OIL AND GAS WELL ORIGINALLY DRILLED BEFORE JUNE 5, 1969.

The enclosed plat was prepared by a registered engineer or licensed land surveyor and all coal owners and/or operators have been notified as of the above date.

The above named coal owners and/or operator are hereby notified that any objection they wish to make, or are required to make by Section 3 of the Code, must be received by, or filed with the Department of Mines within ten (10) days. *

Copies of this notice and the enclosed plat were mailed by registered mail, or delivered to the above named coal operators or coal owners at their above shown respective address _____ day _____ before, or on the same day with the mailing or delivery of this copy to the Department of Mines at Charleston, West Virginia.

Very truly yours, for National Petroleum Corporation
(Sign Name) Kenneth W. Priest - Agent
Well Operator

Address
of
Well Operator

6161 Busch Boulevard
Street
Columbus
City or Town
Ohio 43229
State

01/26/2024

*SECTION 3 If no objections are filed or found by the Department of mines, within said period of ten days from the receipt of notice and plat by the department of mines, to said proposed location, the department shall forthwith issue to the well operator a permit reciting the filing of such plat, that no objections have been made by the coal operators or found thereto by the department and that the same is approved and the well operator authorized to proceed.

BOND DRILL

WIR-605

PERMIT NUMBER

**THIS IS AN ESTIMATE ONLY
ACTUAL INFORMATION WILL BE SUBMITTED ON OG-10 UPON COMPLETION**

PROPOSED WORK ORDER TO XX DRILL _____ DEEPEN _____ FRACTURE-STIMULATE _____
 DRILLING CONTRACTOR: (If Known) RESPONSIBLE AGENT:
 NAME - - (F. W. A.) _____ NAME Kenneth Priest - - Box 246
 ADDRESS _____ ADDRESS Charleston, West Virginia
 TELEPHONE 965-5201 TELEPHONE 343-5984
 ESTIMATED DEPTH OF COMPLETED WELL: 2550' ROTARY _____ CABLE TOOLS _____
 PROPOSED GEOLOGICAL FORMATION: Berea
 TYPE OF WELL: OIL _____ GAS XX COMB. _____ STORAGE _____ DISPOSAL _____
 RECYCLING _____ WATER FLOOD _____ OTHER _____

TENTATIVE CASING PROGRAM:

CASING AND TUBING SIZE	USED FOR DRILLING	LEFT IN WELL	CEMENT FILL UP OR SACKS - CUBIC FT.
20 - 16			
13 - 10			
9 - 5/8			
8 - 5/8	150	150	50 bags
7			
5 1/2		2550	75 bags
4 1/2			
3			Perf. Top
2			Perf. Bottom
Liners			Perf. Top
			Perf. Bottom

APPROXIMATE FRESH WATER DEPTHS 50' FEET _____ SALT WATER _____ FEET _____
 APPROXIMATE COAL DEPTHS None _____
 IS COAL BEING MINED IN THE AREA? No BY WHOM? _____

TO DRILL:
 SUBMIT FIVE (5) COPIES OF OG - 1, \$100.00 PERMIT FEE, PERFORMANCE BOND AND PERMANENT COPY OF PLAT.

TO DRILL DEEPER OR REDRILL:
 SUBMIT FIVE (5) COPIES OF OG - 1, SHOWING ORIGINAL PERMIT NUMBER AND PERFORMANCE BOND. ON WELLS DRILLED PRIOR TO 1929, A PERMANENT COPY OF THE PLAT AND THE ORIGINAL WELL RECORD MUST ALSO BE SUBMITTED.

TO FRACTURE - STIMULATE:
 OIL AND/OR GAS WELL ORIGINALLY DRILLED BEFORE JUNE 5, 1929, FIVE (5) COPIES OG - 1, PERFORMANCE BOND, PERMANENT PLAT AND ORIGINAL WELL RECORD.
 OIL AND/OR GAS WELL ORIGINALLY DRILLED ON AND/OR AFTER JUNE 5, 1929, FIVE COPIES OG - 1, SHOWING ORIGINAL PERMIT NUMBER, AND PERFORMANCE BOND.

Required forms must be filed within ninety (90) days of completion for bond release. Inspector to be notified twenty-four (24) hours in advance.

The following waiver must be completed by the coal operator if the permit is to be issued within ten days of receipt thereof.

WAIVER: I the undersigned, Agent for _____ Coal Company, Owner or Operator of the coal under this lease have examined and place on our mine maps this proposed well location. 01/26/2024

We the _____ Coal Company have no objections to said well being drilled at this location, providing operator has complied with all rules and regulations in Articles 4, 5, and 7, Chapter 22 of the West Virginia Code.

 For Coal Company

 Official Title



WELL RECORD, FORM OG-10, MUST BE SUBMITTED TO OBTAIN RELEASE OF WELL UNDER BOND.

STATE OF WEST VIRGINIA DEPARTMENT OF MINES OIL AND GAS WELLS DIVISION

NOTICE OF PROPOSED LOCATION OF OIL AND GAS WELL

To THE DEPARTMENT OF MINES, Charleston, W. Va.

No Coal COAL OPERATOR OR COAL OWNER

ADDRESS

No Coal COAL OPERATOR OR COAL OWNER

ADDRESS

Nella Thorn OWNER OF MINERAL RIGHTS

431 Goodwin Ave., Salem, Virginia 24153 ADDRESS

National Petroleum Corp. NAME OF WELL OPERATOR

6161 Busch Blvd. Columbus, Ohio 43229 COMPLETE ADDRESS

October 16, 1972 PROPOSED LOCATION

Reedy District

Wirt County

Well No. One Waters - Thorns Run of Reedy Cr.

Westvaco-Nella Thorn Farm

Elevation 920 feet Acres 86

GENTLEMEN:

The undersigned well operator is entitled to drill upon the above named farm or tract of land for oil and gas, having fee title thereto, (or as the case may be) under grant or lease dated October 12, 1972, made by Glen W. Roberts, to National Petroleum Corp., and recorded on the day of in the office of the County Clerk for said County in Book, page.

The enclosed plat was prepared by a competent engineer and shows the proposed location of a well to be drilled for oil and gas by the undersigned well operator on the farm and in the Magisterial District and County above named, determined by survey and courses and distances from two permanent points, or land marks.

The undersigned well operator is informed and believes there are no coal operators operating beds of coal beneath said farm or tract of land on which said well is located, or within 500 feet of the boundaries of the same, who have mapped their workings and filed their maps as required by law, excepting the coal operators or coal owners (if any) above named as addressees.

The above named coal operators or coal owners (if any) are notified that any objections they may desire to make to such proposed location, or which they are required to make by Section 3 of said Code, if the drilling of a well at said proposed location will cause a dangerous condition in or about their respective coal mines, must be received by, or filed with the Department of Mines within ten* days from the receipt of a copy of this notice and accompanying plat by said Department. Said coal operators are further notified that forms for use in making such objections will be furnished to them by the Department of Mines promptly on request and that all such objections must set forth as definitely as is reasonably possible the ground or grounds on which such objections are based and indicate the direction and distance the proposed location should be moved to overcome same.

(The next paragraph is to be completed only in Department's copy.)

Copies of this notice and the enclosed plat were mailed by registered mail, or delivered to the above named coal operators or coal owners at their above shown respective address day before, or on the same day with the mailing or delivery of this copy to the Department of Mines at Charleston, West Virginia.

Very truly yours,

(Sign Name)

Address of Well Operator

Handwritten signature and address fields for the well operator, including Well Operator, Street, City or Town, and State.

01/26/2024

*Section 3 If no such objections be filed or be found by the department of mines, within said period of ten days from the receipt of said notice and plat by the department of mines, to said proposed location, the department shall forthwith issue to the well operator a drilling permit reciting the filing of such plat, that no objections have been made by the coal operators to the location, or found thereto by the department, and that the same is approved and the well operator authorized to proceed to drill at said location.

THIS IS AN ESTIMATE ONLY
ACTUAL INFORMATION WILL BE SUBMITTED ON OG-10 UPON COMPLETION

PROPOSED WORK ORDER TO: X DRILL DEEPEN FRACTURE WELL

WELL OPERATOR
NAME National Petroleum Corp.
ADDRESS 6161 Busch Blvd. Columbus, Ohio 43229
TELEPHONE Area Code 614-888-4641

RESPONSIBLE AGENT:
NAME Kenneth Priest
ADDRESS Box 246 Charleston, West Virginia
TELEPHONE 343-5984

DRILLING CONTRACTOR: (IF KNOWN)
NAME F.W.A.
TELEPHONE 965-5201

LAND OWNER:
NAME Nella Thorn
TELEPHONE

ESTIMATED DEPTH OF COMPLETED WELL: 2550'

ROTARY X

PROPOSED GEOLOGICAL FORMATION: Berea

CABLE TOOLS

TYPE OF WELL: OIL GAS X COMB. STORAGE DISPOSAL
TYPE WASTE RECYCLING WATER FLOOD OTHER

TENTATIVE CASING PROGRAM:

CASING AND TUBING	CEMENT TO BE USED	FOR DRILLING	TO BE LEFT
20	<u> </u>	<u> </u>	<u> </u>
16	<u> </u>	<u> </u>	<u> </u>
13 3/8	<u> </u>	<u> </u>	<u> </u>
11 3/4	<u> </u>	<u> </u>	<u> </u>
10 3/4	<u> </u>	<u> </u>	<u> </u>
9 5/8	<u> </u>	<u> </u>	<u> </u>
8 5/8	<u> 50 bags </u>	<u> 150 ft. </u>	<u> 150 ft. </u>
7	<u> </u>	<u> </u>	<u> </u>
5 1/2	<u> </u>	<u> </u>	<u> </u>
4 1/2	<u> 75 bags </u>	<u> </u>	<u> 2550 ft. </u>
3 1/2	<u> </u>	<u> </u>	<u> </u>
2 3/8	<u> </u>	<u> </u>	<u> </u>
LINERS USED	<u> </u>	<u> </u>	<u> </u>

APPROXIMATE DEPTHS OF EXPECTED POTABLE WATER STRATA 50 ft. , 200 ft. , ,

APPROXIMATE DEPTHS OF EXPECTED WORKABLE COAL SEAMS? None , , ,

IS COAL BEING MINED IN THE AREA? No

WAIVER: I the undersigned, Agent for Coal Company, owner or operator of the coal under this lease have examined and placed on our mine maps this proposed well location.

We the Coal Company have no objections to said well being drilled at this location, providing operator has complied with all rules and regulations in Articles 4, 5, and 7, Chapter 22 of the West Virginia Code.

For Coal Company 01/26/2024

Official Title

A-10

Ken

Suggest to
Bob Dodd that
where Westvaco
owns surface
Identifying name
be given on permit
too. as they own so much

Glen

10/16/72



STATE OF WEST VIRGINIA
DEPARTMENT OF MINES
Oil and Gas Division
WELL RECORD

RECEIVED
JAN 11 1974

OIL & GAS DIVISION
DEPT. OF MINES

Rotary _____ Oil _____
Cable _____ Gas _____
Recycling _____ Comb. _____
Water Flood _____ Storage _____
Disposal _____ Canc.
(Kind) C. NOLL

Quadrangle Spencer
Permit No. WIR 605

39-00
⑨ 1-24

Company National Petroleum Corporation
Address _____
Farm Westvaco Acres 86
Location (waters) Thorns Run of Reedy Creek
Well No. 1 Elev. 720'
District Reedy County Wirt
The surface of tract is owned in fee by Westvaco

Casing and Tubing	Used in Drilling	Left in Well	Cement fill up Cu. ft. (Sks.)
Size			
20-16			
Cond.			
13-10"			
9 5/8			
8 5/8			
7			
5 1/2			
4 1/2			
3			
2			
Liners Used			

Address _____
Mineral rights are owned by Nella Thorn
Address _____
Drilling Commenced WELL WAS NOT DRILLED
Drilling Completed _____
Initial open flow _____ cu. ft. _____ bbls.
Final production _____ cu. ft. per day _____ bbls.
Well open _____ hrs. before test _____ RP.
Well treatment details:

Attach copy of cementing record.

Coal was encountered at _____ Feet _____ Inches
Fresh water _____ Feet _____ Salt Water _____ Feet _____
Producing Sand _____ Depth _____

Formation	Color	Hard or Soft	Top Feet	Bottom Feet	Oil, Gas or Water	* Remarks
LOCATION ONLY WELL WAS NOT DRILLED.						

01/26/2024

(over)

* Indicates Electric Log tops in the remarks section.

Formation	Color	Hard or Soft	Top Feet	Bottom Feet	Oil, Gas or Water	* Remarks

01/26/2024

Date December 27, 1973
 NATIONAL PETROLEUM CORPORATION

APPROVED *John C. Hawbaker*, Owner

By John C. Hawbaker, President
 (Title)

B-2



State of West Virginia

Department of Mines
Oil and Gas Division

Charleston 25305

January 11, 1974

K. Paul Goodnight
Smithville, W.Va.

In Re:	PERMIT	<u>WIRT-605</u>
	COMPANY	<u>Nat'l Petroleum Corp.</u>
	FARM	<u>Westvaco</u>
	WELL NO.	<u>1</u>
	DISTRICT	<u>Reedy</u>
	COUNTY	<u>Wirt</u>

Dear Sir:

The well operator has asked for cancellation of the permit assigned for the above described well.

Please make an on site inspection to ascertain that the well has not been drilled on this subject tract of land, and make a report to us as soon as possible in order that the bond may be released covering this well.

Very truly yours,

Robert L. Dodd
Deputy Director
Oil & Gas Division

RLD/

01/26/2024

B-11

STATE OF WEST VIRGINIA
DEPARTMENT OF MINES
OIL AND GAS WELLS DIVISION

RECEIVED

JAN 23 1974

OIL & GAS DIVISION
DEPT. OF MINES

INSPECTOR'S WELL REPORT

Permit No. W11-605

Oil or Gas Well _____
(KIND)

Company	CASING AND TUBING	USED IN DRILLING	LEFT IN WELL	PACKERS
<u>Nat'l Petroleum Corp</u>	Size			
Address _____	16			Kind of Packer _____
Farm <u>Westvaco</u>	13			
Well No. <u>ONE</u>	10			Size of _____
District <u>Reedy</u> County <u>Wirt</u>	8 1/4			
Drilling commenced _____	6 5/8			Depth set _____
Drilling completed _____ Total depth _____	5 3/16			
Date shot _____ Depth of shot _____	3			Perf. top _____
Initial open flow _____ /10ths Water in _____ Inch	2			Perf. bottom _____
	Liners Used			Perf. top _____

Open flow after tubing _____ /10ths Me

Volume _____

Rock pressure _____ lbs.

Oil _____

Fresh water _____ feet

Salt water _____ feet

Drillers' Names _____

SENDER: Be sure to follow instructions on other side

PLEASE FURNISH SERVICE(S) INDICATED BY CHECKED BLOCK(S)
(Additional charges required for these services)

Show to whom, date and address where delivered Deliver ONLY to addressee

RECEIPT
Received the numbered article described below

REGISTERED NO. 81383 SIGNATURE OR NAME OF ADDRESSEE *(Must always be filled in)* Nat'l Petroleum

CERTIFIED NO. 1 SIGNATURE OF ADDRESSEE'S AGENT, IF ANY Susie Fitcham

INSURED NO. 2

DATE DELIVERED 1-28-74 SHOW WHERE DELIVERED *(Only if requested, and include ZIP Code)* 3

Remarks:

Made on site inspection - No well has been drilled

OK. Rel.

01/26/2024

STATE OF WEST VIRGINIA
DEPARTMENT OF MINES
OIL AND GAS WELLS DIVISION
INSPECTOR'S PLUGGING REPORT

Permit No. _____ Well No. _____

COMPANY _____ ADDRESS _____

FARM _____ DISTRICT _____ COUNTY _____

Filling Material Used _____

Liner			Location		Amount		Packer		Location		
PLUGS USED AND DEPTH PLACED			BRIDGES			CASING AND TUBING					
CEMENT-THICKNESS	WOOD-SIZE	LEAD	CONSTRUCTION-LOCATION		RECOVERED	SIZE	LOST				

Drillers' Names _____

Remarks: _____

_____ I hereby certify I visited the above well on this date.
DATE

DISTRICT WELL INSPECTOR
01/26/2024

B-12



State of West Virginia

Department of Mines
Oil and Gas Division
Charleston 25305

January 24, 1974

National Petroleum Corporation
6161 Busch Boulevard
Columbus, Ohio 43229

In Re: Permit No. WIRT-605
Farm Westvaco
Well No. 1
District Reedy
County Wirt

Gentlemen:

The final inspection report for the well which is described above has been received in this office. Only the column checked below applies.

 The bond covering the well designated by the above permit number has been released under your Blanket Bond.

~~XXXXX~~ Please return the enclosed cancelled bond which covered the well designated by the above permit number to the Surety Company who executed said bond in your behalf, in order that they may give you credit on their records. **(Never Drilled - Cancelled)**

Very truly yours,

Deputy Director
Oil and Gas Division

RLD/cc
Enclosure:

Bond Dated 10-17-72

01/26/2024

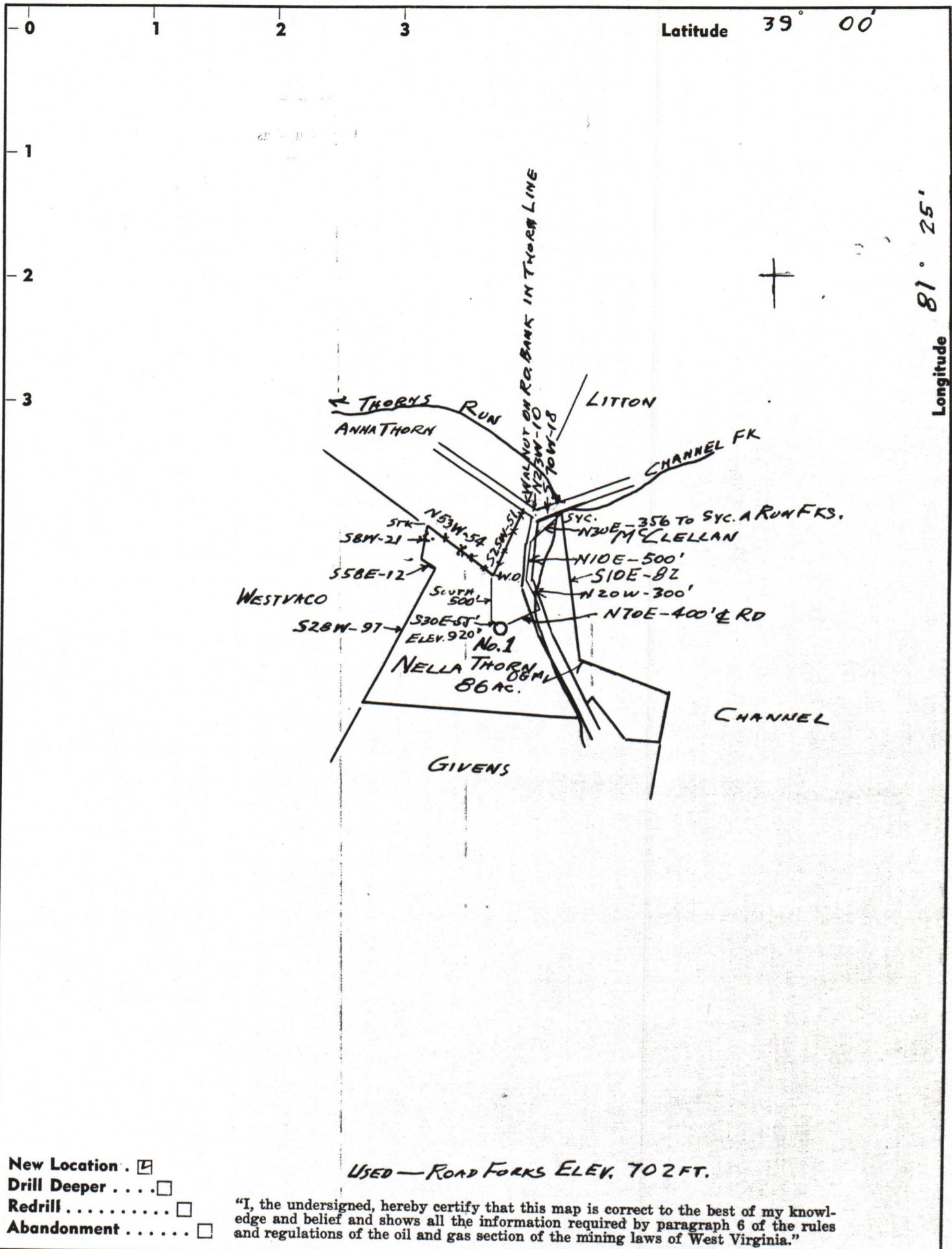

- New Location .
- Drill Deeper
- Redrill
- Abandonment

"I, the undersigned, hereby certify that this map is correct to the best of my knowledge and belief and shows all the information required by paragraph 6 of the rules and regulations of the oil and gas section of the mining laws of West Virginia."

Company NATIONAL PETROLEUM CORP.

Address 6161 BUSCH BLVD - COLUMBUS, OHIO 43229

Farm WESTVACO (SUR) NELLA THORN (O.G.M.)

Tract 86 Acres 86 Lease No. _____

Well (Farm) No. ONE Serial No. _____

Elevation (Spirit Level) 720 FT.

Quadrangle SPENCER

County WIRT District REEDY

Engineer Glen W. Roberts

Engineer's Registration No. 860

File No. _____ Drawing No. _____

Date OCT. 16, 1972 Scale 1 IN = 80 POLES

STATE OF WEST VIRGINIA
DEPARTMENT OF MINES
OIL AND GAS DIVISION
CHARLESTON

WELL LOCATION MAP

FILE NO. Win-605 01/25/2024

Cancelled - Never Drilled

+ Denotes location of well on United States Topographic Maps, scale 1 to 62,500, latitude and longitude lines being represented by border lines as shown.

- Denotes one inch spaces on border line of original tracing.

47-105