

A-1



STATE OF WEST VIRGINIA
DEPARTMENT OF MINES

RECEIVED
JUN 4 1973 - CEN

OIL & GAS DIVISION
DEPT. OF MINES

Oil and Gas Division

OIL AND GAS WELL PERMIT APPLICATION

TO THE DEPARTMENT OF MINES,
Charleston, W. Va.

DATE May 24, 1973

Surface Owner Warren and Earl Campbell Company Halbert & Prough
 Address Mt. Zion, West Virginia DePue Estate Address 317 Bank of Commerce, Abaline, Tex
 Mineral Owner Warren & Earl Campbell & Farm Warren Campbell Acres 49
 Address Mt. Zion, West Virginia Location (waters) Little Kanawha River
 Coal Owner _____ Well No. One Elevation 786
 Address _____ District Spring Creek County Wirt
 Coal Operator _____ Quadrangle Spencer
 Address _____

THIS PERMIT MUST BE POSTED AT THE WELL SITE

All provisions being in accordance with Chapter 22, of the W. Va. Code, the location is hereby approved for drilling. This permit shall expire if operations have not commenced by 10-4-73.

Deputy Director - Oil & Gas Division

INSPECTOR TO BE NOTIFIED Harry Holliday
Box 221
Grantsville, WV. PH: 354-6731

GENTLEMEN:

The undersigned well operator is entitled to drill upon the above named farm or tract of land for oil and gas, having fee title thereto, (or as the case may be) under grant or lease dated March 1, 1973, by Campbell's and DePue Estate made to Halbert and Prough and recorded on the _____ day of March 1973 in Wirt County, Book _____ Page _____

NEW WELL _____ DRILL DEEPER _____ REDRILL _____ FRACTURE OR STIMULATE
_____ OIL AND GAS WELL ORIGINALLY DRILLED BEFORE JUNE 5, 1969.

The enclosed plat was prepared by a registered engineer or licensed land surveyor and all coal owners and/or operators have been notified as of the above date.

The above named coal owners and/or operator are hereby notified that any objection they wish to make, or are required to make by Section 3 of the Code, must be received by, or filed with the Department of Mines within ten (10) days. *

Copies of this notice and the enclosed plat were mailed by registered mail, or delivered to the above named coal operators or coal owners at their above shown respective address _____ day _____ before, or on the same day with the mailing or delivery of this copy to the Department of Mines at Charleston, West Virginia.

Very truly yours,

(Sign Name) A.T. Halbert
Well Operator

Address
of
Well Operator

317 Bank of Commerce Building

Street

Abaline

City or Town

Texas

State

01/26/2024

*SECTION 3 If no objections are filed or found by the Department of mines, within said period of ten days from the receipt of notice and plat by the department of mines, to said proposed location, the department shall forthwith issue to the well operator a permit reciting the filing of such plat, that no objections have been made by the coal operators or found thereto by the department and that the same is approved and the well operator authorized to proceed.

BOND DRILL

WIR-630

PERMIT NUMBER

47-105

WEST VIRGINIA DEPARTMENT OF MINES
CHARLESTON, WEST VIRGINIA
INTER-OFFICE MEMORANDUM

A-10

TO: Interstate Drilling, Inc.

DATE: April 1, 1981

FROM: Charlotte Milam

SUBJECT: Revised Approved Reclamation Plan IV-

PLEASE SUBMIT THE APPROVED IV'9 (RECLAMATION PLAN) approved by the Soil Conservation Office:

WELL NO:	<u>1</u>	WELL NO:	<u>2</u>
COUNTY :	<u>GIL-2274-P</u>	COUNTY:	<u>GIL-2275-P</u>
DISTRICT:	<u>Troy /</u>	DISTRICT:	<u>Troy</u>
FARM NAME:	<u>Bennett Heirs</u>	FARM NAME	<u>Bennett Heirs</u>

WEST VIRGINIA DEPARTMENT OF MINES
CHARLESTON, WEST VIRGINIA
INTER-OFFICE MEMORANDUM

TO: INTERSTATE DRILLING, INC.

DATE: APRIL 1, 1981

FROM: Charlotte Milam

SUBJECT: Revised Approved Reclamation Plan IV-

PLEASE SUBMIT THE APPROVED IV'9 (RECLAMATION PLAN) approved by the Soil Conservation Office:

WELL NO:	<u>1</u>	WELL NO:	<u>1</u>
COUNTY :	<u>GIL-2277-P</u>	COUNTY:	<u>WIRT-630-P</u>
DISTRICT:	<u>Troy</u>	DISTRICT:	<u>Spring Creek</u>
FARM NAME:	<u>Dora Heckert</u>	FARM NAME:	<u>Campbell Depue</u>

Mr. Jarrell:

We are returning the above (4) captioned OG-9's (Work Orders) whenever the proper IV-9's Reclamations are approved, please return them to our office.....

01/26/2024

卍

卍

卍

卍

01/26/2024



RECEIVED

APR 11 1974

OIL & GAS DIVISION
DEPT. OF MINES

STATE OF WEST VIRGINIA
DEPARTMENT OF MINES

Oil and Gas Division

WELL RECORD

Rotary Oil _____
Cable _____ Gas _____
Recycling _____ Comb.
Water Flood _____ Storage _____
Disposal _____ (Kind) _____

Quadrangle Spencer

Permit No. Wir-630

Company Halbert & Prough
Address Abilene, Texas
Farm Warren & Earl Campbell Acres _____
Location (waters) Little Kanawha River
Well No. One (1) Elev. 773 KB
District Spring Creek County Wirt
The surface of tract is owned in fee by Warren & Earl Campbell and DePue Estate
Address Mt. Zion, W. Va.
Mineral rights are owned by Same
Address _____
Drilling Commenced 6/4/73
Drilling Completed 6/10/73
Initial open flow No test cu. ft. _____ bbls.
Final production 200m cu. ft. per day 2 bbls.
Well open 24 hrs. before test 750 RP.
Well treatment details:

Casing and Tubing	Used in Drilling	Left in Well	Cement fill up Cu. ft. (Sks.)
Size 20-16			
Cond. 13-10"			
9 5/8			
8 5/8	167	167	55 Sx.
7			
5 1/2			
4 1/2	1913	1913	75 Sx.
3			
2			
Liners Used			

Attach copy of cementing record.

Perf. 1754' to 1806 12 holes

Sand fracture 600 bbl. water 300 cwt 10/20 sand 100 cwt 20/40 sand
300 cwt propping agent and 500 gal. 15% acid

Coal was encountered at None Feet _____ Inches _____
Fresh water _____ Feet _____ Salt Water _____ Feet _____
Producing Sand Big Injun Depth 1754 - 1806

Formation	Color	Hard or Soft	Top Feet	Bottom Feet	Oil, Gas or Water	* Remarks
Shale & Sand			0	210		
Sand			210	248		
Shale			248	306		
Sand			306	322		
Shale w/Sand Stringers			322	962		
Sand			962	976		
Shale			976	1164		
Sand			1164	1228		
Shale			1228	1420		
Sand			1420	1462		
Shale			1462	1482		
Sand			1482	1566		
Shale			1566	1600		
Sand			1600	1630		
Little Lime - Pencil Cave			1630	1665		
Big Lime			1665	1754		
Big Injun			1754	1806		
Shale			1806	1924		
				1924 TOTAL DEPTH		

01/26/2024

(over)

* Indicates Electric Log tops in the remarks section.

Formation	Color	Hard or Soft	Top Feet	Bottom Feet	Oil, Gas or Water	* Remarks

Date April 10, 19 74 01/26/2024

APPROVED Halbert & Pouch, Owner

By H. V. Farrell, Jr.
(Title)

STATE OF WEST VIRGINIA
DEPARTMENT OF MINES
OIL AND GAS WELLS DIVISION

RECEIVED

NOV 26 1973

OIL & GAS DIVISION
DEPT. OF MINES

B-2

INSPECTOR'S WELL REPORT

Permit No. W19-630

Oil or Gas Well Oil
(KIND)

Company	Address	Farm	Well No.	District	Drilling commenced	Drilling completed	Date shot	Initial open flow	Open flow after tubing	Volume	Rock pressure	Oil	Fresh water	Salt water	CASING AND TUBING	USED IN DRILLING	LEFT IN WELL	PACKERS					
															Size			Kind of Packer					
<u>HALBERT & PROUGH</u>	<u>AGALINE, TEXAS</u>	<u>WARREN CAMPBELL</u>	<u>F</u>	<u>SPRING CREEK</u> County <u>WEST</u>	<u>6-4-73</u>	<u>6-10-73</u> Total depth <u>1924'</u>	<u>FRAG ROWELL</u> <u>10-13-73</u> Depth of shot <u>10' UN'</u>	_____/10ths Water in ____ Inch	_____/10ths Merc. in ____ Inch	____ Cu. Ft.	____ lbs. ____ hrs.	____ bbls., 1st 24 hrs.	<u>9 DRILLON MUD</u> feet ____ feet	<u>DRILLON MUD</u> feet ____ feet	<u>100 SPP - 9 5/8" - 200' - 6-4-73</u> <u>170 SPP - 10 1/2" - 1924' - 6-10-73</u>	<u>200'</u>	<u>200'</u>	<u>CEM</u>	<u>4 1/2"</u> SIZE <u>1924'</u> No. FT. <u>6-10-73</u> Date	____	____	____	____
NAME OF SERVICE COMPANY <u>MSWCO</u>															COAL WAS ENCOUNTERED AT <u>NONE</u> FEET ____ INCHES								
															____ FEET ____ INCHES ____ FEET ____ INCHES								
															____ FEET ____ INCHES ____ FEET ____ INCHES								

Drillers' Names MCOWLEY - H. E. PINSON - R. BRIGGERS

Remarks:

WELL FRAG 10-13-73

F. W. A. POT. MUD

11-23-73

DATE

Harry A. Keady

DISTRICT WELL INSPECTOR

01/26/2024

B-4

STATE OF WEST VIRGINIA
DEPARTMENT OF MINES
OIL AND GAS WELLS DIVISION

RECEIVED

JUN 11 1973

OIL & GAS DIVISION
DEPT. OF MINES

INSPECTOR'S WELL REPORT

Permit No. WER-630

Oil or Gas Well _____
(KIND)

Company <u>HALBERT & PROUSH</u>	CASING AND TUBING	USED IN DRILLING	LEFT IN WELL	PACKERS
	Address <u>ABILENE, TEXAS</u>	Size		
Farm <u>WARREN CAMPBELL</u>	16			
Well No. <u>I</u>	13			
District <u>SPRINGCREEK</u> County <u>WIRT</u>	10			Size of
Drilling commenced <u>6-4-73</u>	8 1/4 <u>CEM</u>	<u>200</u>		Depth set
Drilling completed _____ Total depth _____	6 5/8			
Date shot _____ Depth of shot _____	5 3/16			Perf. top
Initial open flow _____ /10ths Water in _____ Inch	3			Perf. bottom
Open flow after tubing _____ /10ths Merc. in _____ Inch	2			Perf. top
Volume _____ Cu. Ft.	Liners Used			Perf. bottom
Rock pressure _____ lbs. _____ hrs.	<u>106 SRS</u> CASING CEMENTED <u>8 5/8</u> SIZE <u>200</u> No. FT. <u>643</u> Date _____ NAME OF SERVICE COMPANY <u>A.C.W.CO.</u> COAL WAS ENCOUNTERED AT <u>200</u> FEET _____ INCHES _____ FEET _____ INCHES _____ FEET _____ INCHES _____ FEET _____ INCHES _____ FEET _____ INCHES			
Oil _____ bbls., 1st 24 hrs.				
Fresh water <u>3 MILLION GAL</u> _____ feet _____ feet				
Salt water <u>3 MILLION GAL</u> _____ feet _____ feet				

Drillers' Names R. CONLEY - M. J. PINSON - R. G. HIGGINS

Remarks: FISH AT 1730' (W. RESOURCES INSP. SANDY NOTIFIED)

6-7-73
DATE

H. C. Hollidge
DISTRICT SUPERVISOR
01/26/2024

STATE OF WEST VIRGINIA
DEPARTMENT OF MINES
OIL AND GAS WELLS DIVISION

RECEIVED

JUN 11 1973

OIL & GAS DIVISION
INSPECTOR'S WELL REPORT DEPT. OF MINES

Permit No. WIR-630

Oil or Gas Well _____
(KIND)

Company <u>HALBERT & PROUGH</u>	CASING AND TUBING	USED IN DRILLING	LEFT IN WELL	PACKERS
	Address <u>ABILENE, TEXAS</u>	Size		
Farm <u>WARREN CAMPBELL</u>	16			
Well No. <u>I</u>	13			
District <u>SPRING CREEK</u> County <u>WIRT</u>	10			Size of
Drilling commenced <u>6-4-73</u>	8 1/4 <u>CEM</u>	<u>200'</u>		Depth set
Drilling completed _____ Total depth _____	6 5/8			
Date shot _____ Depth of shot _____	5 3/16			Perf. top
Initial open flow _____ /10ths Water in _____ Inch	3			Perf. bottom
Open flow after tubing _____ /10ths Merc. in _____ Inch	2			Perf. top
Volume _____ Cu. Ft.	Liners Used			Perf. bottom
Rock pressure _____ lbs. _____ hrs.	100 SWS CASING CEMENTED <u>8 7/8"</u> SIZE <u>200'</u> No. FT. <u>6-4-73</u> Date			
Oil _____ bbls., 1st 24 hrs.	NAME OF SERVICE COMPANY <u>H. G. W. CO.</u>			
Fresh water <u>1</u> <u>DRILL ON MUD</u> feet _____ feet	COAL WAS ENCOUNTERED AT <u>100</u> FEET _____ INCHES			
Salt water <u>?</u> <u>DRILL ON MUD</u> feet _____ feet	_____ FEET _____ INCHES	_____ FEET _____ INCHES	_____ FEET _____ INCHES	_____ FEET _____ INCHES

Drillers' Names A. CONLEY - H. E. PARSON - A. GRIGGERS

Remarks: F. W. R. POT. - MUD
FISH AT 1730'

6-8-73
DATE

H. G. W. CO.
DISTRICT WELL INSPECTOR

6-13-73
DATE

H. G. W. CO.
DISTRICT WELL INSPECTOR

01/26/2024



State of West Virginia

Department of State

Charleston, West Virginia

February 1, 2024

Dear Mr. [Name]:

Reference is made to your letter of January 25, 2024,

concerning the [Subject].

The [Subject] is currently being reviewed by the

[Department/Agency].

We appreciate your patience and will contact you again

as soon as a final decision has been reached.

Sincerely,

[Signature]

[Title]

[Department/Agency]

Charleston, West Virginia

Enclosure

cc: [Name]

cc: [Name]

cc: [Name]

cc: [Name]

cc: [Name]

cc: [Name]

cc: [Name]

cc: [Name]

cc: [Name]

cc: [Name]

cc: [Name]

cc: [Name]

cc: [Name]

cc: [Name]

cc: [Name]

cc: [Name]

cc: [Name]

cc: [Name]

cc: [Name]

cc: [Name]

cc: [Name]

cc: [Name]

cc: [Name]

1.0 API well number: (If not available, leave blank. 14 digits.)	<u>47-105-630</u>															
2.0 Type of determination being sought: (Use the codes found on the front of this form.)	<u>108</u> Section of NGPA Category Code															
3.0 Depth of the deepest completion location: (Only needed if sections 103 or 107 in 2.0 above.)	_____ feet															
4.0 Name, address and code number of applicant: (35 letters per line maximum. If code number not available, leave blank.)	<u>Interstate Drilling Inc.</u> <u>007917</u> Seller Code <u>500 Comm St.</u> <u>Charleston</u> <u>WV</u> <u>25301</u> City State Zip Code															
5.0 Location of this well: [Complete (a) or (b).] (a) For onshore wells (35 letters maximum for field name.)	<u>CRESTON</u> Field Name <u>WIRT</u> <u>WV</u> County State															
(b) For OCS wells:	Area Name _____ Block Number _____ Date of Lease: _____ Mo. Day Yr. OCS Lease Number _____															
(c) Name and identification number of this well: (35 letters and digits maximum.)	<u>Campbell Depue 47-105-630</u>															
(d) If code 4 or 5 in 2.0 above, name of the reservoir: (35 letters maximum.)	_____															
6.0 (a) Name and code number of the purchaser: (35 letters and digits maximum. If code number not available, leave blank.)	<u>Columbia Gas TRANS</u> <u>004030</u> Buyer Code Name															
(b) Date of the contract:	<u>5 12 1974</u> Mo. Day Yr.															
(c) Estimated annual production:	<u>1.034</u> MMcf.															
	<table border="1" style="width:100%; border-collapse: collapse;"> <thead> <tr> <th style="width:25%;"></th> <th style="width:15%;">(a) Base Price (\$/MMBTU)</th> <th style="width:15%;">(b) Tax</th> <th style="width:15%;">(c) All Other Prices [Indicate (+) or (-).]</th> <th style="width:20%;">(d) Total of (a), (b) and (c)</th> </tr> </thead> <tbody> <tr> <td style="padding: 5px;">7.0 Contract price: (As of filing date. Complete to 3 decimal places.)</td> <td style="text-align: center;"><u>2.264</u> 2.243</td> <td style="text-align: center;"><u>0.357</u></td> <td style="text-align: center;">- - - - -</td> <td style="text-align: center;"><u>2.621</u> 2.600</td> </tr> <tr> <td style="padding: 5px;">8.0 Maximum lawful rate: (As of filing date. Complete to 3 decimal places.)</td> <td style="text-align: center;"><u>2.264</u> 2.243</td> <td style="text-align: center;"><u>0.357</u></td> <td style="text-align: center;">- - - - -</td> <td style="text-align: center;"><u>2.621</u> 2.600</td> </tr> </tbody> </table>		(a) Base Price (\$/MMBTU)	(b) Tax	(c) All Other Prices [Indicate (+) or (-).]	(d) Total of (a), (b) and (c)	7.0 Contract price: (As of filing date. Complete to 3 decimal places.)	<u>2.264</u> 2.243	<u>0.357</u>	- - - - -	<u>2.621</u> 2.600	8.0 Maximum lawful rate: (As of filing date. Complete to 3 decimal places.)	<u>2.264</u> 2.243	<u>0.357</u>	- - - - -	<u>2.621</u> 2.600
	(a) Base Price (\$/MMBTU)	(b) Tax	(c) All Other Prices [Indicate (+) or (-).]	(d) Total of (a), (b) and (c)												
7.0 Contract price: (As of filing date. Complete to 3 decimal places.)	<u>2.264</u> 2.243	<u>0.357</u>	- - - - -	<u>2.621</u> 2.600												
8.0 Maximum lawful rate: (As of filing date. Complete to 3 decimal places.)	<u>2.264</u> 2.243	<u>0.357</u>	- - - - -	<u>2.621</u> 2.600												
9.0 Person responsible for this application:	<table border="1" style="width:100%; border-collapse: collapse;"> <tr> <td style="width:25%; padding: 5px;">Agency Use Only</td> <td style="padding: 5px;"><u>Edward H. V. Jamell</u> Name</td> <td style="padding: 5px;"><u>Sec Treas</u> Title</td> </tr> <tr> <td style="padding: 5px;">Date Received by Juris. Agency</td> <td colspan="2" style="padding: 5px;"><u>EW Jamell</u> Signature</td> </tr> <tr> <td style="padding: 5px;">Date Received by FERC</td> <td style="padding: 5px;"><u>2-5-79</u> Date Application is Completed</td> <td style="padding: 5px;"><u>343-0179</u> Phone Number</td> </tr> </table>	Agency Use Only	<u>Edward H. V. Jamell</u> Name	<u>Sec Treas</u> Title	Date Received by Juris. Agency	<u>EW Jamell</u> Signature		Date Received by FERC	<u>2-5-79</u> Date Application is Completed	<u>343-0179</u> Phone Number						
Agency Use Only	<u>Edward H. V. Jamell</u> Name	<u>Sec Treas</u> Title														
Date Received by Juris. Agency	<u>EW Jamell</u> Signature															
Date Received by FERC	<u>2-5-79</u> Date Application is Completed	<u>343-0179</u> Phone Number														

FT7900806

01/26/2024

INTERSTATE DRILLING INC.

023090

FIRST PURCHASER: COLUMBIA GAS TRANSMISSION Corp.

004030

OTHER:

W. Va. Department of Mines, Oil & Gas Division
 WELL DETERMINATION FILE NUMBER
790216-108-105-0630
 Use Above File Number on all Communications
 Relating to Determination of this Well

*Qualified Section 108. stopped well
 (Signature)
 New Prod 6/13/80 P.L.*

CHECK EACH ITEM AS COMPLETE OR NOTE WHAT IS MISSING

EM 380-

- 1 FERC-121 Items not completed - Line No. _____
- 2 IV-1 - Agent H. V. SARRELL
- 3 IV-2 - Well Permit
- 4 IV-3 - Well Plat
- 5 IV-3B - Well Record Drilling Repairs _____
- 6 IV-3C - Gas-Oil Tests. Gas Only 2.8 Gas Oil Ratio of .29 Ratio _____
- 7 IV-3D - Annual Production 1 ~~yr.~~
- 8 IV-4 - 90 Day Production 92 Days off line: _____
- 9 IV-4B - Application for Certification. Complete?
- 17 IV Form #51 - 52 - 53 - 54 - 55 - (56) - 57 - 58. Complete Affidavit Signed
- 28 Other: Survey _____ Logs _____ Geological Charts _____ Structure Map _____
 1:4000 Map _____ Well Measurements _____ Gas Analyses _____
- (5) Date Commenced: 6-4-73
6-10-73 DRILLED Deepened _____
- (5) Production Depth: 1754-1806
- (5) Production Formation: Big Injun
- (5) Final Open Flow: 200 mcf
 Initial Production _____
- (5) Final Rock Pressure: 750#
 Static Rock Pressure _____
- (6) Other Gas Test: _____
- (7) Avg. Daily Gas from Annual Production: Gas- $\frac{2040}{365} = 6 \text{ mcf}$; $\frac{120}{365} = 3 \text{ BBL}$
- (8) Avg. Daily Gas from 90-day cond. w/1-120 days $\frac{807}{92} = 9 \text{ mcf}$; $\frac{30}{92} = 3 \text{ BBL}$
- (8) Line Pressure: 18# PSIG from Daily Report
- (5) Oil Production: _____ From Completion Report _____
- 17) Does lease inventory indicate extended recovery being done: NO 01/26/2024
- 17) Is affidavit signed? Notarized?
- Is official well record with the Department contains the submitted information? yes
- Additional Information: _____ Was computer program used? _____

PL

SR

DM

IV-39-WC

STATE OF WEST VIRGINIA
DEPARTMENT - MINES
DIVISION - OIL AND GAS

OPERATOR

YEAR 1979

REPORT OF MONTHLY PRODUCTION
GAS VOLUMES IN MCF @ 14.73
OIL IN BARRELS @ 60 DEGREES

REPORT DATE

01/26/2024

~~FARM Campbell Dague COUNTY W. Va~~

API	FARM	COUNTY	W. Va	AVG. FLOW PRESSURE	SHUT-IN PRESSURE	TOTALS
GAS MCF	71	67	115	116	138	210
OIL BBL	J-12	F-10	M-10	A-10	M-10	J-10
DAYS ON LINE	31	28	31	30	31	31
YEAR 1979						
TOTALS				18	300	2090
GAS						1220
OIL						870

API	FARM	COUNTY	W. Va	AVG. FLOW PRESSURE	SHUT-IN PRESSURE	TOTALS
GAS MCF	133	152	145	136	154	120
OIL BBL	J-0	F-0	M-0	A-0	M-0	J-0
DAYS ON LINE	31	28	31	30	31	31
YEAR 1979						
TOTALS				18	300	1257
GAS						0
OIL						315

SUMMARIZATION SCHEDULE
Section 271.804 (b)

In accordance with Section 271.804 (b) please list all other wells which are to be used in determining this well classification under Part 271 Subpart H.

API NUMBERS

RECEIVED

MAR 25 1980

OIL & GAS DIVISION
DEPT. OF MINES

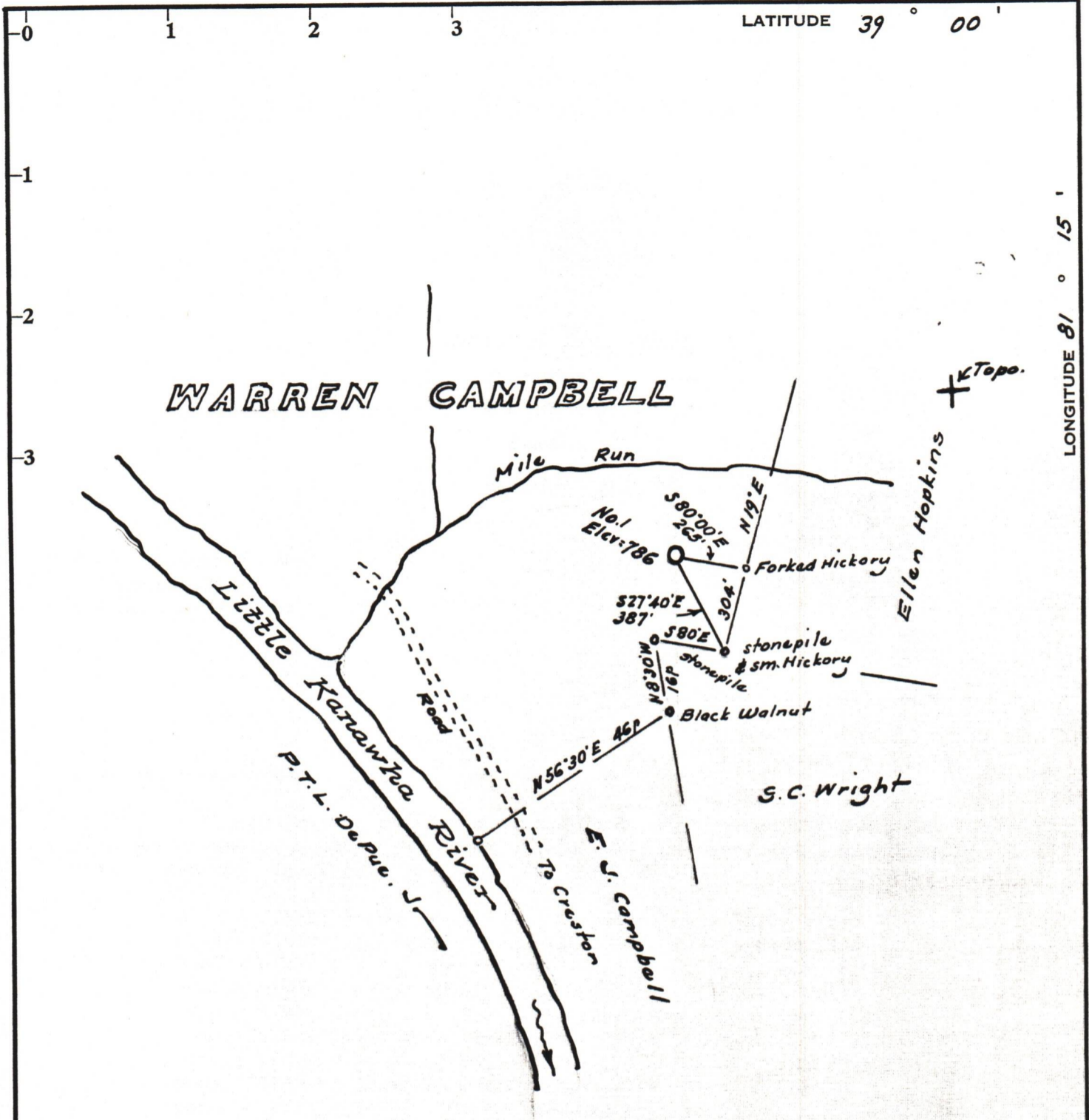

Minimum Error of Closure 1 in 200'

Source of Elevation Elev. E. J. Campbell No 1 = 869'

I, the undersigned, hereby certify that this map is correct to the best of my knowledge and belief and shows all the information required by paragraph 6 of the rules and regulations of the oil and gas section of the mining laws of West Virginia.

- Fracture.....
- New Location.....
- Drill Deeper.....
- Abandonment.....

Signed: [Signature]
Squares: N S E W

Map No.

Company Halbert & Prough
 Address 317 Bank of Commerce, Abilene, Texas
 Farm Warren Campbell
 Tract _____ Acres 49 Lease No. _____
 Well (Farm) No. One Serial No. _____
 Elevation (Spirit Level) 786
 Quadrangle Spencer
 County Wirt District Spring Creek
 Engineer [Signature]
 Engineer's Registration No. 1277
 File No. _____ Drawing No. _____
 Date May 3, 1973 Scale 1" = 300' = 495'

STATE OF WEST VIRGINIA
DEPARTMENT OF MINES
OIL AND GAS DIVISION
CHARLESTON

WELL LOCATION MAP.

FILE NO. Wir-630 01/26/2024

+ Denotes location of well on United States Topographic Maps, scale 1 to 62,500, latitude and longitude lines being represented by border lines as shown.

- Denotes one inch spaces on border line of original tracing.



01/26/2024

A 11



RECEIVED

OCT 28 1975

OIL & GAS DIVISION
DEPT. OF MINES

PATTERSON, BELL & CRANE COMPANY

October 23, 1975

Mr. Robert L. Dodd, Director
Oil & Gas Division, Department of Mines
1204 Kanawha Boulevard, East
Charleston, West Virginia

RE: INTERSTATE DRILLING, INC.

Dear Mr. Dodd:

Permission is granted to add to Interstate Drilling, Inc., blanket bond the following wells which were originally under the name of Halbert & Prough.

<u>PERMIT NO.</u>	<u>WELL NAME</u>	<u>COUNTY</u>	<u>DISTRICT</u>
CAL-2509	Mary Davis	Calhoun	Sheridan
GIL-2263	W. H. Simmons #2	Gilmer	Troy
GIL-2264	W. H. Simmons #3	Gilmer	Troy
GIL-2265	Gut Simmons	Gilmer	Troy
GIL-2272	W. H. Simmons #4	Gilmer	Troy
GIL-2274	Bennett Heirs #1	Gilmer	Troy
GIL-2275	Bennett Heirs #2	Gilmer	Troy
GIL-2277	Dora Heckert #1	Gilmer	Troy
GIL-2279	Simmons-West #1	Gilmer	Troy
GIL-2314	Newlon-Goff	Gilmer	Troy
LEW-1885	Russell Woofter #1	Lewis	Freemans Creek
LEW-1886	Russell Woofter #2	Lewis	Freemans Creek
LEW-1887	Russell Woofter # H&P1	Lewis	Freemans Creek
LEW-1888	Russell Woofter #1B	Lewis	Freemans Creek
LEW-1890	Dale W. Groves #1	Lewis	Freemans Creek
LEW-1956	Dale W. Groves #2	Lewis	Freemans Creek
LEW-1962	Russell Woofter #3	Lewis	Freemans Creek
WIR-604	E. J. Campbell No. 1	Wirt	Spring Creek
WIR-621	E. J. Campbell No. 2	Wirt	Spring Creek
WIR-630	Warren Campbell No. 1	Wirt	Spring Creek
WIR-636	Jewel Boyce No. 1	Wirt	Burnings Springs
WIR-638	Campbell-DePue 1A	Wirt	Burnings Springs
WIR-639	Gordon Cooper No. 3	Wirt	Spring Creek

Very truly yours
UNITED STATES FIDELITY & GUARANTY COMPANY

E. D. Ziegler
Attorney-in-Fact

EDZ:rc

01/26/2024



State of West Virginia

Department of Mines
Oil and Gas Division

Charleston 25305

~~April 11, 1974~~

March 29, 1977

JOHN ASHCRAFT
Director

ROBERT L. DODD
Deputy Director

Paul Goodnight
Smithville, W.Va.

PERMIT	WIRT-630
COMPANY	Halbert & Prough
FARM	Warren Campbell
WELL NO	1
DISTRICT	Spring Creek
COUNTY	Wirt

Dear Sir:

Please make a final inspection of the well described above.

Very truly yours,

Robert L. Dodd

RLD/cc

(Plat enclosed)

01/26/2024

STATE OF WEST VIRGINIA
DEPARTMENT OF MINES
OIL AND GAS WELLS DIVISION

RECEIVED

JUN 14 1973

OIL & GAS DIVISION
DEPT. OF MINES

INSPECTOR'S WELL REPORT

Permit No. WIA-630

Oil or Gas Well _____
(KIND)

Company <u>HALBERT & PROUGH</u>	CASING AND TUBING	USED IN DRILLING	LEFT IN WELL	PACKERS
	Address <u>ABALINE, TEXAS</u>	Size		
Farm <u>WARREN CAMPBELL</u>	16			Size of _____
Well No. <u>I</u>	13			Depth set _____
District <u>SPRING CREEK</u> County <u>WIRT</u>	10			Perf. top _____
Drilling commenced <u>6-4-73</u>	8 1/4 <u>CEM</u>	<u>200'</u>	<u>200'</u>	Perf. bottom _____
Drilling completed <u>6-10-73</u> Total depth <u>1924'</u>	6 5/8			Perf. top _____
Date shot _____ Depth of shot _____	5 3/16			Perf. bottom _____
Initial open flow _____ /10ths Water in _____ Inch	<u>2 4 1/2</u>		<u>1924'</u>	Perf. top _____
Open flow after tubing _____ /10ths Merc. in _____ Inch	2			Perf. bottom _____
Volume _____ Cu. Ft.	Liners Used			Perf. top _____
Rock pressure _____ lbs. _____ hrs.				Perf. bottom _____
Oil _____ bbls., 1st 24 hrs.	<u>100 SPS - 8 5/8 - 200' - 6-4-73</u> CASING CEMENTED <u>120 SPS 2 1/2</u> SIZE <u>1924</u> No. FT. <u>61073</u> Date			
Fresh water <u>? DRILL ON MUD</u> _____ feet	NAME OF SERVICE COMPANY <u>H.O.W.CO.</u>			
Salt water <u>? DRILL ON MUD</u> _____ feet	COAL WAS ENCOUNTERED AT <u>1000</u> FEET _____ INCHES			
	_____ FEET	_____ INCHES	_____ FEET	_____ INCHES
	_____ FEET	_____ INCHES	_____ FEET	_____ INCHES

Drillers' Names R. CONLEY - M.T. PINSON - P. GRIGGERS

Remarks: F.W.A. - POT. MUD
WELL COMP. TO F.P.A.

6-13-73
DATE

H.A. Holliday
DISTRICT WELL INSPECTOR

01/26/2024



State of West Virginia

Department of Mines

Oil and Gas Division

Charleston 25305

November 19, 1975

E & B Insurance Agency
212 Court Street
Spencer, W.Va. 25276

Attn: Richard H. Brumbaugh

In Re: Halbert & Prough
Single Bonds

Dear Mr. Brumbaugh:

Enclosed are the following single bonds for Halbert & Prough, 317 Bank of Commerce Building, Abilene, Texas 79604. All of these wells have been transferred to: Interstate Drilling, Inc., 1527 Skyline Road, Charleston, W.Va.

- Bond # 621065 dated 8-13-73 (CAL-2509 - Mary Davis # 1)
Bond # 618384 dated 10-17-72 (GIL-2263 - W.H. Simmons # 2)
Bond # 618383 dated 10-17-72 (GIL-2264 - W. H. Simmons # 3)
Bond # 618387 dated 10-27-72 (GIL-2265 - Guy Simmons # 1)
Bond # 618389 dated 11-3-72 (GIL-2272 - W. H. Simmons # 4)
Bond # 618390 dated 11-13-72 (GIL-2274 - Bennett Hrs. # 1)
Bond # 618391 dated 11-13-72 (GIL-2275 - Bennett Hrs. # 2)
Bond # 618392 dated 11-20-72 (GIL-2277) - Dora Heckert # 1)
Bond # 618397 dated 12-4-72 (GIL-2279 - Simmons-West # 1)
Bond # 618398 dated 12-4-72 (LEW-1885 - Russell Woofter # 1)
Bond # 618403 dated 12-29-72 (LEW-1886 - Russell Woofter # 2)
Bond # 618404 dated 1-5-73 (LEW-1887 - Russell Woofter - H & P # 1)
Bond # 618406 dated 1-17-73 (LEW-1888 - H & P # 1-B)
Bond # 618409 dated 1-26-73 (LEW-1890 - Dale W. Groves # 1)
Bond # 634382 dated 4-5-74 (Dale W. Groves # 2) LEW-1956
Bond # 634388 dated 5-30-74 (LEW-1962 - Russell Woofter # 3)
Bond # 618382 dated 10-6-72 (WIRT-604 - J. E. Campbell # 1)
Bond # 618385 dated 10-17-72 (WIRT-621 - E. J. Campbell # 2)
Bond # 618439 dated 5-24-73 (WIRT-630 - Warren Campbell # 1)
Bond # 612063 dated 7-31-73 (WIRT-639 - Campbell-DePue-Woodring # 1)

The following bonds have been released:

- Bond # 618425 dated 3-30-73 (GIL-2314 - Newlon & Goff # 1) Released-8-6-75
Bond # 621057 dated 7-13-73 (WIRT-636 - Jewel Boyce # 1) Released - 11-4-75
Bond # 621061 dated 7-26-73 (WIRT-638 - Campell - DePue # 1) Released -11-4-75

Very truly yours
Robert L. Dodd

01/26/2024