

TWYMAN GEORGE WD

ID: 53-02-0006-0018-0000
API# 47-105-01449

Legend



39.137451, -81.323468

47

04/17/2026

Google Earth



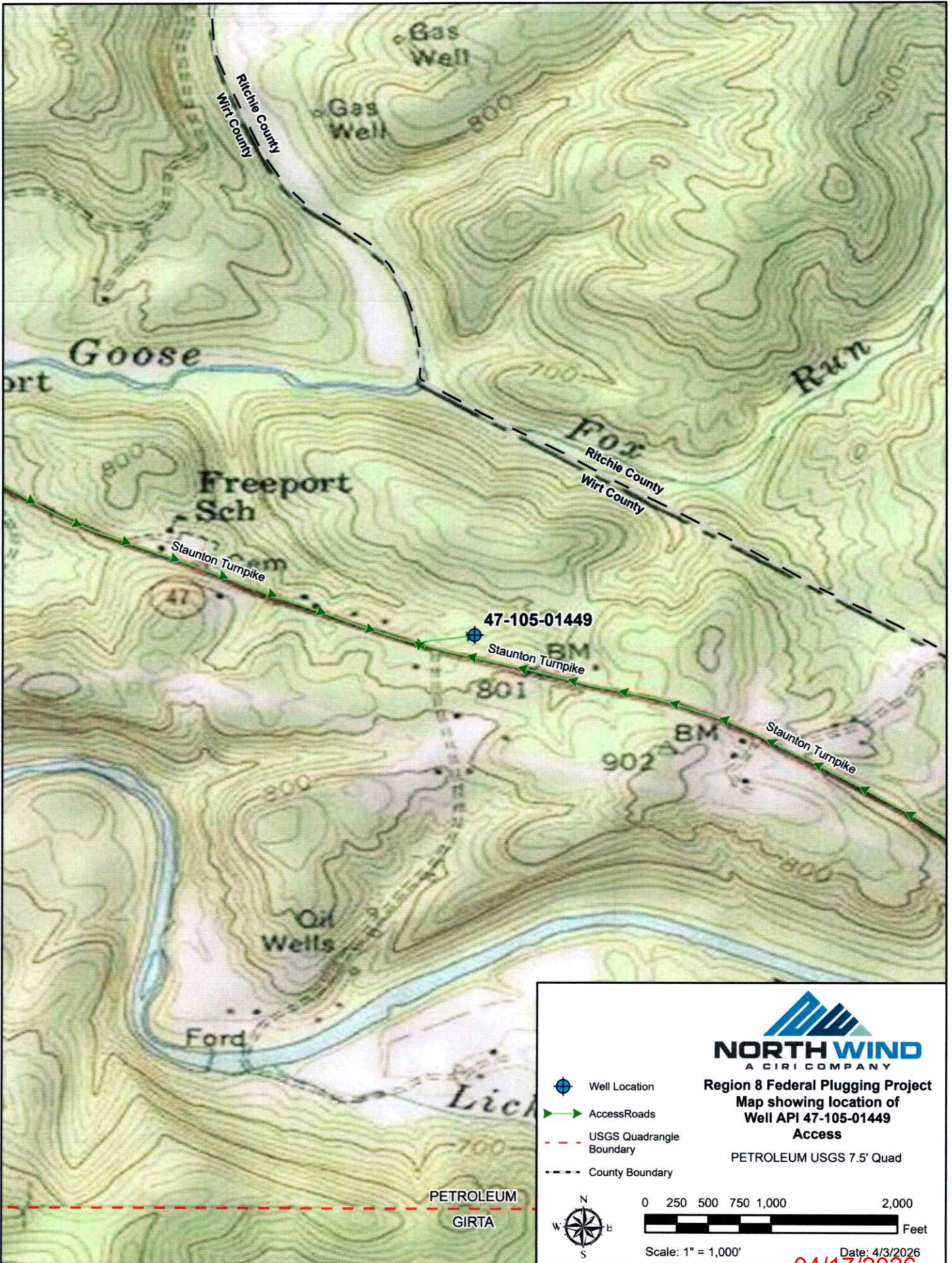

NORTH WIND
A GIRI COMPANY

Region 8 Federal Plugging Project
Map showing location of
Well API 47-105-01449
Access

PETROLEUM USGS 7.5' Quad

- Well Location
- Access Roads
- USGS Quadrangle Boundary
- County Boundary

0 250 500 750 1,000 2,000 Feet

Scale: 1" = 1,000'

Date: 4/3/2026

04/17/2026

WW-7
8-30-06



West Virginia Department of Environmental Protection
Office of Oil and Gas
WELL LOCATION FORM: GPS

API: 47-105-01449 WELL NO.: _____

FARM NAME: _____

RESPONSIBLE PARTY NAME: _____

COUNTY: Wirt DISTRICT: Clay

QUADRANGLE: Petroleum

SURFACE OWNER: Twyman George WD

ROYALTY OWNER: _____

UTM GPS NORTHING: 4332079.66

UTM GPS EASTING: 472044.58 GPS ELEVATION: 762

The Responsible Party named above has chosen to submit GPS coordinates in lieu of preparing a new well location plat for a plugging permit or assigned API number on the above well. The Office of Oil and Gas will not accept GPS coordinates that do not meet the following requirements:

1. Datum: NAD 1983, Zone: 17 North, Coordinate Units: meters, Altitude: height above mean sea level (MSL) – meters
2. Accuracy to Datum – 3.05 meters
3. Data Collection Method:
Survey grade GPS _____: Post Processed Differential _____
Real-Time Differential _____
Mapping Grade GPS _____: Post Processed Differential _____
Real-Time Differential _____

4. Letter size copy of the topography map showing the well location.

I the undersigned, hereby certify this data is correct to the best of my knowledge and belief and shows all the information required by law and the regulations issued and prescribed by the Office of Oil and Gas.

J. Allison Walker

Signature

President

Title

3/26/2026

Date 04/17/2026