

NOTICE OF PROPOSED LOCATION OF OIL AND GAS WELL

(REQUIRED BY SECTION 2, CHAPTER 22, CODE 1931)

WEST VIRGINIA DEPARTMENT OF MINES

OIL AND GAS SECTION

To THE DEPARTMENT OF MINES,
Charleston, W. Va.

None
COAL OPERATOR OR COAL OWNER

P. E. Deem
NAME OF WELL OPERATOR

ADDRESS

*1807 Avery St
Parkersburg W. Va.*
COMPLETE ADDRESS

None
COAL OPERATOR OR COAL OWNER

193.....
PROPOSED LOCATION

ADDRESS

Union District

OWNER OF MINERAL RIGHTS

Wood County

D. C. Little
ADDRESS
Waverly, W. Va. Route 1

Well No. *1* *39° 20'* *81° 20'* *32 ac*
D. C. Little Farm

GENTLEMEN:

The undersigned well operator is entitled to drill upon the above named farm or tract of land for oil and gas, having fee title thereto, (or as the case may be) under grant or lease dated.....

Nov. 19, 1937, made by *D. C. Little*, to

P. E. Deem, and recorded on the *15* day

of *December 1937*, in the office of the County Clerk for said County in

Book *218*, page *396*

The enclosed plat was prepared by a competent engineer and shows the proposed location of a well to be drilled for oil and gas by the undersigned well operator on the farm and in the Magisterial District and County above named, determined by survey and courses and distances from two permanent points, or land marks.

The undersigned well operator is informed and believes there are no coal operators operating beds of coal beneath said farm or tract of land on which said well is located, or within 500 feet of the boundaries of the same, who have mapped their workings and filed their maps as required by law, excepting the coal operators or coal owners (if any) above named as addressees.

The above named coal operators or coal owners (if any) are notified that any objections they may desire to make to such proposed location, or which they are required to make by Section 3 of said Code, if the drilling of a well at said proposed location will cause a dangerous condition in or about their respective coal mines, must be received by, or filed with the Department of Mines within ten* days from the receipt of a copy of this notice and accompanying plat by said Department. Said coal operators are further notified that forms for use in making such objections will be furnished to them by the Department of Mines promptly on request and that all such objections must set forth as definitely as is reasonably possible the ground or grounds on which such objections are based and indicate the direction and distance the proposed location should be moved to overcome same.

(The next paragraph is to be completed only in Department's copy.)

Copies of this notice and the enclosed plat were mailed by registered mail, or delivered to the above named coal operators or coal owners at their above shown respective address.....day.... before, or on the same day with the mailing or delivery of this copy to the Department of Mines at Charleston, West Virginia.

Very truly yours,

P. E. Deem
WELL OPERATOR

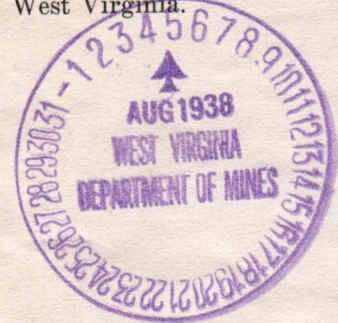

Address of Well Operator }

1807 Avery St
STREET

Parkersburg
CITY OR TOWN

West Virginia
STATE

01/05/2024

*Section 3 If no such objections be filed, or be found by the department of mines, within said period of ten days from the receipt of said notice and plat by the department of mines, to said proposed location, the department shall forthwith issue to the well operator a drilling permit reciting the filing of such plat, that no objections have been made by the coal operators to the location, or found thereto by the department, and that the same is approved and the well operator authorized to proceed to drill at said location.



NOTICE OF PROPOSED LOCATION OF OIL AND GAS WELL

WEST VIRGINIA DEPARTMENT OF MINES

OIL AND GAS SECTION

To the Department of Mines
Charleston, W. Va.

NAME OF WELL OPERATOR

NAME OF WELL OPERATOR

ADDRESS

193

PROPOSED LOCATION

NAME OF MINERAL RIGHTS

District

ADDRESS

County

NAME OF MINERAL RIGHTS

Well No. 1

Section 12

The undersigned well operator is entitled to drill upon the above named land or tract of land for

oil and gas having the same interest as the same may be in the tract or tract of land named

to

and recorded on the

in the case of the County Clerk for said County in

The undersigned well operator is informed and believes that there are no coal or oil or gas deposits in the tract or tract of land named above and that the same is not owned or controlled by any person or persons who are entitled to the same.

The undersigned well operator is informed and believes that there are no coal or oil or gas deposits in the tract or tract of land named above and that the same is not owned or controlled by any person or persons who are entitled to the same.

The undersigned well operator is informed and believes that there are no coal or oil or gas deposits in the tract or tract of land named above and that the same is not owned or controlled by any person or persons who are entitled to the same.

The undersigned well operator is informed and believes that there are no coal or oil or gas deposits in the tract or tract of land named above and that the same is not owned or controlled by any person or persons who are entitled to the same.

The undersigned well operator is informed and believes that there are no coal or oil or gas deposits in the tract or tract of land named above and that the same is not owned or controlled by any person or persons who are entitled to the same.

The undersigned well operator is informed and believes that there are no coal or oil or gas deposits in the tract or tract of land named above and that the same is not owned or controlled by any person or persons who are entitled to the same.

WELL OPERATOR

ADDRESS

CITY OR TOWN

ADDRESS

CITY OR TOWN

01/05/2024

The undersigned well operator is informed and believes that there are no coal or oil or gas deposits in the tract or tract of land named above and that the same is not owned or controlled by any person or persons who are entitled to the same.

A-10

August 5, 1938

Mr. D. C. Little
Route No. 1
Waverly, W. Va.

Dear Sir:

A notice of proposed location of Well No. 1, on the D. C. Little Farm, Union District, Wood County, has been received from P. E. Deem, Parkersburg, West Virginia. A copy of the notice and location plat should have been mailed you by the well operator.

If you have any objections to the proposed location, please file same not later than August 15, 1938.

Very truly yours,

Secretary
OIL AND GAS DIVISION

MG/ar

01/05/2024

A-11

August 15, 1938

Mr. P. E. Deem
1807 Avery Street
Parkersburg, West Virginia

Dear Sir:

Permit Woc-78 to drill Well No. 1 on the
D. C. Little Farm, Union District, Wood County,
is enclosed.

Duplicate permit shall be posted on the rig.

Please keep an accurate and complete record
of the well and file when completed on our Form OG-10
which is enclosed.

Very truly yours,

Secretary
OIL AND GAS DIVISION.

MG:g
encl

Lat 39d-20'
Long 81d-20'

01/05/2024

A 12

December 7, 1938

Mr. P. E. Deem
1807 Avery Street
Parkersburg, West Virginia

Dear Sir:

In order to complete the files for 1938 and expedite the issuing of our final report for the year, we would appreciate your sending the record for Well No. 1 on the D. C. Little Farm, Union District, Wood County, our File No. Wco-78.

Blank forms OG-10 are enclosed for an immediate reply.

Very truly yours,

Secretary
OIL AND GAS DIVISION

MG/ar
enc-2

01/05/2024

B-1

WEST VIRGINIA DEPARTMENT OF MINES

OIL AND GAS DIVISION

PRELIMINARY DATA SHEET No. 1

File No. Little Oil Well No. -1-
Company, of Rt. #1 Parkersburg, W. Va.
on the D.C. Little Farm
containing 33 acres. Location Worthington Creek
Union District, in Wood County, West Virginia

The surface of the above tract is owned in fee by D.C. Little
of Waverly, West Virginia address, and the mineral rights are owned by
D.C. Little of Waverly, West Virginia.

The oil and gas privileges are held under lease by the above named company, and this well is drilled under permit
No. Woo-78 issued by the West Virginia Department of Mines, Oil and Gas Division
Aug. 15 1938

Elevation of surface at top of well, 820.5 Spirit Barometric.

The number of feet of the different sized casings used in the well.

About 10 feet 16" size. Wood conductor.
325 feet 10" size, csg. _____ sized csg.
1090 feet 8" size, csg. _____ sized csg.
1806 feet 6 5/8" size, csg. _____ sized csg.

_____ packer of _____ size, set at _____
_____ packer of _____ size, set at _____

_____, in casing perforated at _____ feet to _____ feet.
_____, in casing perforated at _____ feet to _____ feet.

Coal was encountered at no coal feet; thickness _____ inches, and at _____
feet; thickness _____ inches; and at _____ feet; thickness _____ inches.

Liners were used as follows: (Give details) no liners.

May 16-1940.

Date. _____
Approved Little Oil Corp. 01/05/2024
By J.H. Shuman - Treas.
(TITLE)

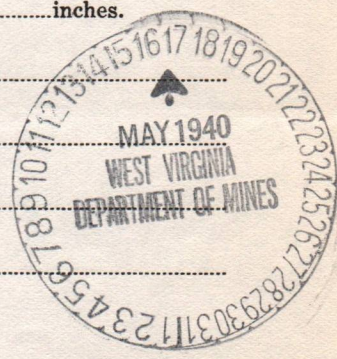

B-2

Little Oil Company
 Rt. #1, Parkersburg, W. Va. Address
 Well No. -1-

COMPLETION DATA SHEET
 No. 2
 FORMATION RECORD

Name	Color	Character	Oil, Gas or Water	Top	Bottom	Thickness	Total Depth	Remarks
		Shale + Shells			750	750		No Record,
Big Red	Red	Big Red		750	835	85		
		lime		835	880	45		
		Little Red		880	925	45		
Little Downward		Sand		925	960	35		
		Red Rock		960	985	25		
	White	Slate		985	1055	75		
		Boulder		1055	1062	7		
		Black		1062	1077	15		
		Pink Rock		1077	1085	8		
Big Downward		Sand		1085	1112	27		
		Slate + Shells		1112	1270	158		
		Sand		1270	1284	14		
		Slate		1284	1320	36		
		Sand		1320	1340	20		
		Slate		1340	1385	45		
		Sand		1385	1425	40		
		Slate		1425	1620	195		
Marion		Sand		1620	1650	30		
		Slate		1650	1670	20		
Injun		Sand		1670	1806	136		
		Slate		1806	1807	1		
		lime		1807	1828	21		
		Slate + Shells		1828	2192	364		
		Sand		2192	2202	10		
Berea		lime		2202	2210	8		
	Black	Shale		2210	2212	2		
		Total Depth		2212				

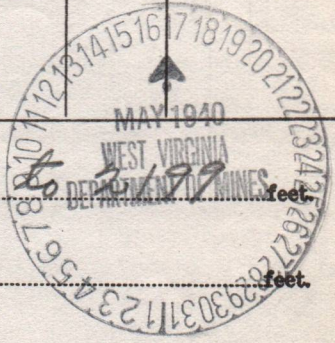

Well was ~~not~~ shot at 2194 to 2204 feet; well was shot at 2193 to 2199 feet.
 Salt fresh water at _____ feet; salt fresh water at _____ feet.

producing
 Well was Small hole.
 May 16-1940
 Date

Approved Little Oil Company 01/05/2024
 By J.N. Shuman - Treasurer

NOTE: All bottom formations must be noted as indicated above and all key-rocks and oil and gas sands must be recorded under their proper geological names in the district as well as any local names commonly used in the district for such strata.

COMPLETION DATA SHEET
 No. 2
 FORMATION RECORD

Well No. 1-1
 Field No. 1111
 Company

Remarks	Depth	Thickness	Top	Bottom	On Gas or Water	Character	Color	Notes
No. 1	150	150	150	150		Sandstone		
	152	2	152	150		Red Sand	Red	Big Red
	154	2	154	152		fine		
	156	2	156	154		fine		
	158	2	158	156		fine		
	160	2	160	158		fine		
	162	2	162	160		fine		
	164	2	164	162		fine		
	166	2	166	164		fine		
	168	2	168	166		fine		
	170	2	170	168		fine		
	172	2	172	170		fine		
	174	2	174	172		fine		
	176	2	176	174		fine		
	178	2	178	176		fine		
	180	2	180	178		fine		
	182	2	182	180		fine		
	184	2	184	182		fine		
	186	2	186	184		fine		
	188	2	188	186		fine		
	190	2	190	188		fine		
	192	2	192	190		fine		
	194	2	194	192		fine		
	196	2	196	194		fine		
	198	2	198	196		fine		
	200	2	200	198		fine		
	202	2	202	200		fine		
	204	2	204	202		fine		
	206	2	206	204		fine		
	208	2	208	206		fine		
	210	2	210	208		fine		
	212	2	212	210		fine		

Well was shut at 212' 2 1/2" ...
 Fresh water at ...
 Well was ...
 Approved: [Signature]
 Date: 01/05/2024
 NOTE: All bottom thicknesses must be noted as indicated above and all ...
 their proper geological names in the district as well as any local name ...

Marietta

B-3

STATE OF WEST VIRGINIA
DEPARTMENT OF MINES
OIL AND GAS DIVISION

WELL RECORD

Permit No. W00-78

Oil or Gas Well Oil
(Kind)

Company Little Oil Co.
 Address 1807 Avery St., Parkersburg W. Va.
 Farm A. C. Little Acres 132
 Location (waters) Charthampton Creek
 Well No. 1 Elev. 830
 District Union County Wood
 The surface of tract is owned in fee by A. C. Little
 Address Haverly, W. Va.
 Mineral rights are owned by A. C. Little
 Address same
 Drilling commenced August 8th. 1938
 Drilling completed September 9th. 1938
 Date shot Sept. 9th. Depth of shot 2202 ft.
 Open Flow /10ths Water in _____ Inch
 /10ths Merc. in _____ Inch
 Volume _____ Cu. Ft.
 Rock Pressure _____ lbs. _____ hrs.
 Oil Ferrous (5) bbls., 1st 24 hrs.
 Fresh water _____ feet _____ feet
 Salt water 1730 feet _____ feet

Casing and Tubing	Used in Drilling	Left in Well	Packers
Size			
16.			Kind of Packer
13.			
10.	<u>325</u>		Size of
8 1/4.	<u>1090</u>		
6 5/8.	<u>1806</u>	<u>1806</u>	Depth set
5 3/16.			
3.			Perf. top
2.		<u>2207</u>	Perf. bottom
Liners Used			Perf. top
			Perf. bottom

CASING CEMENTED _____ SIZE _____ No. FT. _____ Date _____
 COAL WAS ENCOUNTERED AT _____ FEET _____ INCHES
 _____ FEET _____ INCHES FEET _____ INCHES
 _____ FEET _____ INCHES FEET _____ INCHES

Formation	Color	Hard or Soft	Top	Bottom	Oil Gas or Water	Depth Found	Remarks
Clay	yellow	soft	0	10 ft.			
slate	white	soft	10	95			
Red rock	red	soft	95	145			
slate	white	"	145	300			
Red rock	red	"	300	325			
slate + shells	white	hard	325	520			
Red rock	red	soft	520	573			
slate + shells	white	hard	573	750			
Big red	red	soft	750	835			
Lime	white	hard	835	880			
Little red	red	soft	880	925			
Little A.	white	hard	925	960			
Red-rock	red	soft	960	985			
slate	white	"	985	1055			
Lime	"	hard	1055	1062			
slate	black	soft	1062	1077			
Red-rock	Red	"	1077	1085			
Big D.	white	hard	1085	1112			
slate + shells	white	hard	1112	1270			
Sand	white	hard	1270	1284			
slate	"	soft	1284	1320			
Sand	"	hard	1320	1340			
slate	"	soft	1340	1385			
sand	"	hard	1385	1425			
slate	Black	soft	1425	1620			
sand	white	hard	1620	1650			
slate	"	soft	1650	1670			
sand	"	hard	1670	1806			
slate + shells	"	"	1806	1828			
Berea Sand	"	"	1828	2192			
Lime	"	"	2192	2202			
Shale	Black	soft	2202	2210			
			2210	2212			



Water - 1730

Oil



B-4



STATE OF WEST VIRGINIA
DEPARTMENT OF MINES
OIL AND GAS DIVISION

Quadrangle _____

Permit No. _____

WELL RECORD

Oil or Gas Well _____
(KIND)

Company C. R. Feick & C. T. Feick
Address Rt. 2, Walker, W. Va.
Farm D. C. Little Acres 32
Location (waters) Branch of Worthington
Well No. 1 Elev. _____
District Union County Wood
The surface of tract is owned in fee by Robt. Smith
Address Waverly, W. Va.
Mineral rights are owned by _____
Address _____

Drilling commenced _____
Drilling completed 1938
Date Shot 9-12-38 From 2194 To 2204
With 50 qts.
Open Flow /10ths Water in _____ Inch
/10ths Merc. in _____ Inch
Volume _____ Cu. Ft.
Rock Pressure _____ lbs. _____ hrs.
Oil _____ bbls., 1st 24 hrs.
WELL ACIDIZED _____
WELL FRACTURED _____

Casing and Tubing	Used in Drilling	Left in Well	Packers
Size			Kind of Packer _____
16			
13			
10			Size of _____
8 1/4	1806	1806	
6 5/8			Depth set _____
5 3/16			
3			Perf. top _____
2		2200	Perf. bottom _____
Liners Used			Perf. top _____
			Perf. bottom _____

CASING CEMENTED _____ SIZE _____ No. Ft. _____ Date _____

COAL WAS ENCOUNTERED AT _____ FEET _____ INCHES
_____ FEET _____ INCHES _____ FEET _____ INCHES
_____ FEET _____ INCHES _____ FEET _____ INCHES

RESULT AFTER TREATMENT _____
ROCK PRESSURE AFTER TREATMENT _____
Fresh Water _____ Feet Salt Water _____ Feet

Formation	Color	Hard or Soft	Top	Bottom	Oil, Gas or Water	Depth	Remarks
Berea Sand	Grey	Hard	2192	2202	Oil		
							Total Depth 2212'

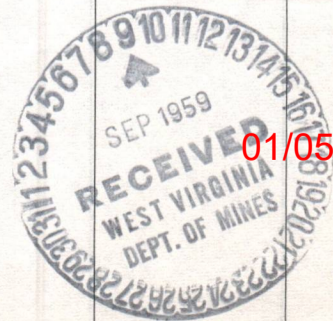

01/05/2024

B-5

STATE OF WEST VIRGINIA
 DEPARTMENT OF MINES
 OIL AND GAS DIVISION
INSPECTOR'S PLUGGING REPORT

Permit No. Woo-78P Well No. 1

COMPANY C.F. & C.T. Feick ADDRESS Walker, W.Va.

FARM D.C. Little DISTRICT Union COUNTY Wood

Filling Material Used Clay, stone & cement

Liner			Location	Amount	Packer	Location		
PLUGS USED AND DEPTH PLACED			BRIDGES			CASING AND TUBING		
CEMENT-THICKNESS	WOOD-SIZE	LEAD	CONSTRUCTION-LOCATION			RECOVERED	SIZE	LOST
						2200	2	None

Drillers' Names W.T. Honn & C.T. Feick

Remarks:
Filled from 2212 to 2158. Bridged here with stone & cement, filled and bridging at 1850 today.

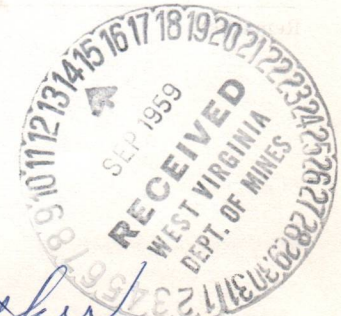

Sept. 11, 1959 I hereby certify I visited the above well on this date.
DATE

John G. Lawther
 DISTRICT WELL INSPECTOR

01/05/2024

**STATE OF WEST VIRGINIA
DEPARTMENT OF MINES
OIL AND GAS DIVISION**

INSPECTOR'S WELL REPORT

Permit No. _____

Oil or Gas Well _____
(KIND)

Company _____ Address _____ Farm _____ Well No. _____ District _____ County _____ Drilling commenced _____ Drilling completed _____ Total depth _____ Date shot _____ Depth of shot _____ Initial open flow _____/10ths Water in _____ Inch Open flow after tubing _____/10ths Merc. in _____ Inch Volume _____ Cu. Ft. Rock pressure _____ lbs. _____ hrs. Oil _____ bbls., 1st 24 hrs. Fresh water _____ feet _____ feet Salt water _____ feet _____ feet	CASING AND TUBING	USED IN DRILLING	LEFT IN WELL	PACKERS
	Size			
	16			Kind of Packer _____
	13			
	10			Size of _____
	8 1/4			
	6 5/8			Depth set _____
	5 3/16			
	3			Perf. top _____
	2			Perf. bottom _____
	Liners Used			Perf. top _____
				Perf. bottom _____
	CASING CEMENTED _____ SIZE _____ No. FT. _____ Date _____			
	COAL WAS ENCOUNTERED AT _____ FEET _____ INCHES			
	_____ FEET	_____ INCHES	_____ FEET	_____ INCHES
	_____ FEET	_____ INCHES	_____ FEET	_____ INCHES

Drillers' Names _____

Remarks:

DATE

DISTRICT WELL INSPECTOR

01/05/2024

B-6

STATE OF WEST VIRGINIA
DEPARTMENT OF MINES
OIL AND GAS DIVISION

INSPECTOR'S PLUGGING REPORT

Permit No. Woo-78P

Well No. 1

COMPANY C.R. & C.T. Feick ADDRESS Walker, W.Va.

FARM D.C. Little DISTRICT Union COUNTY Wood

Filling Material Used Clay, stone & cement

Liner	Location	Amount	Packer	Location			
PLUGS USED AND DEPTH PLACED			BRIDGES		CASING AND TUBING		
CEMENT-THICKNESS	WOOD-SIZE	LEAD	CONSTRUCTION-LOCATION		RECOVERED	SIZE	LOST
					2200	2	None
					1786	6 5/8	20

Drillers' Names C.T. Feick & W.T. Hoon

Remarks:
Completed, report by mail

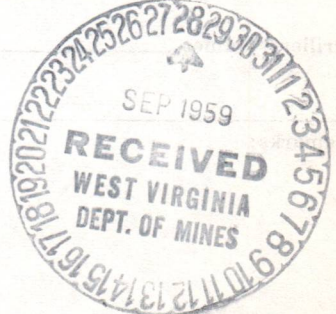

Sept. 21, 1959 I hereby certify I visited the above well on this date.
DATE

John C. Lowther
DISTRICT WELL INSPECTOR
01/05/2024

STATE OF WEST VIRGINIA
DEPARTMENT OF MINES
OIL AND GAS DIVISION

INSPECTOR'S WELL REPORT

Permit No. _____ Oil or Gas Well _____
(KIND)

	CASING AND TUBING	USED IN DRILLING	LEFT IN WELL	PACKERS
Company _____	Size _____			Kind of Packer _____
Address _____	16 _____			
Farm _____	13 _____			
Well No. _____	10 _____			Size of _____
District _____ County _____	8 1/4 _____			
Drilling commenced _____	6 5/8 _____			Depth set _____
Drilling completed _____ Total depth _____	5 3/16 _____			
Date shot _____ Depth of shot _____	3 _____			Perf. top _____
Initial open flow _____ /10ths Water in _____ Inch	2 _____			Perf. bottom _____
Open flow after tubing _____ /10ths Merc. in _____ Inch	Liners Used _____			Perf. top _____
Volume _____ Cu. Ft.				Perf. bottom _____
Rock pressure _____ lbs. _____ hrs.	CASING CEMENTED _____ SIZE _____ No. FT. _____ Date _____			
Oil _____ bbls., 1st 24 hrs.	COAL WAS ENCOUNTERED AT _____ FEET _____ INCHES			
Fresh water _____ feet _____ feet	_____ FEET _____ INCHES _____ FEET _____ INCHES			
Salt water _____ feet _____ feet	_____ FEET _____ INCHES _____ FEET _____ INCHES			

Drillers' Names _____

Remarks: _____

DATE

DISTRICT WELL INSPECTOR

01/05/2024

B-8

FORM G-9

NOTICE OF INTENTION TO PLUG AND ABANDON WELL

(REQUIRED BY SECTION 9, ARTICLE 4, CHAPTER 22 OF THE CODE)

WEST VIRGINIA DEPARTMENT OF MINES

OIL AND GAS DIVISION

To THE DEPARTMENT OF MINES,
Charleston, W. Va.

COAL OPERATOR OR COAL OWNER

ADDRESS

COAL OPERATOR OR COAL OWNER

ADDRESS

LEASE OR PROPERTY OWNER

ADDRESS

Little Oil Company

NAME OF WELL OPERATOR

Rt. #1, Parkersburg, W. Va.

COMPLETE ADDRESS

May 16th 1940

WELL TO BE ABANDONED

Union District

Wood County

Well No. - 1 -

P.C. Little Farm

Gentlemen:—

The undersigned well operator is about to abandon the above described well and will commence the work of plugging and abandoning said well on the 27 day of May, 1940, (which date shall not be less than five days after the day on which this notice so mailed is received, or in due course should be received by the Department of Mines).

This notice is given you in order that your respective representatives may be present at the plugging and filling of said well. You are further notified that whether you are represented or not represented the undersigned will proceed on that date, or shortly thereafter, to plug and fill said well in the manner required by Section 10, Article 4, Chapter 22 of the Code and given in detail on the reverse side of this notice, in "Work Order."

This notice is being mailed by registered mail to each of you at the above addresses on the above date.

Very truly yours,

Little Oil Company

Well Operator.

By J.H. Shuman - Treas.



NOTE: Upon the abandonment of all wells drilled prior to June 1, 1929, a plat prepared by a competent engineer, showing the district and county in which the tract of land is located, the name and acreage of the tract, names of the owners of adjacent tracts, and the location of the about to be abandoned well, determined by survey, and the courses and distances of such well from two permanent points or landmarks on said tract, shall be submitted with this notice.

01/05/2024

(Over)

B-9

PROPOSED MANNER OF PLUGGING AND FILLING WELL

(REQUIRED BY RULES AND REGULATIONS)

WEST VIRGINIA DEPARTMENT OF MINES

OIL AND GAS DIVISION

WORK ORDER

Well to be plugged and filled as follows:

Total Depth	2212 ft.
Fill, Clay + rock ,	2212 - 2170 "
Wood plug,	2170 - 2165 "
Cement on plug,	
Fill, Clay + rock ,	2165 - 1815 "
Wood plug,	1815 - 1810 "
Cement on plug,	
Pull 6 5/8" casing, <i>as balance of hole is filled + plugged</i>	1810 - 1650 "
Fill, Clay + Rock,	1650 - 1645 "
Wood plug + Cement,	1600 -
Good bridge,	
Sack Cement on bridge,	
Fill, Red Clay,	1600 - 1250 "
Wood plug,	1250 - 1245 "
Cement on plug,	
Fill, Red Clay + Rock,	1245 - 1100 " <i>1065' - 20' above Big Bankard</i>
Wood plug + Cement	1100 - 1095 " <i>1065' - 1052'</i>
8" casing has been pulled - no 8" in hole.	
Bridge + Cement,	335 -
Red Clay + Rock to surface + set marker as per law.	

To the Department of Mines,
Coal Owner or Operator,
Lease or Property Owner.

Gentlemen:

This "work order" is submitted for your approval and concurrence and unless notified of your disapproval or non-concurrence, the undersigned will proceed with the plugging and filling of said well in the above described manner on the date stated in the notice of intention to plug and abandon the said well on opposite side of this sheet.

Very truly yours,

Little Oil Company
By *J.N. Skuman*, Well Operator.

No objections have been filed by the coal owner or coal operator, or any available adjacent lease or property owners or interposed by the Department of Mines to the manner herein described for the plugging and filling of the well above mentioned. Therefore, the same is hereby approved this 20th day

of *May*, 193*4*.

DEPARTMENT OF MINES
Oil and Gas Division

01/05/2024

By:

NOTE: This "work order" must be filed in duplicate, one copy for the files of the Department of Mines and the other to be approved or corrected and returned to the well operator as his authority for plugging said well.

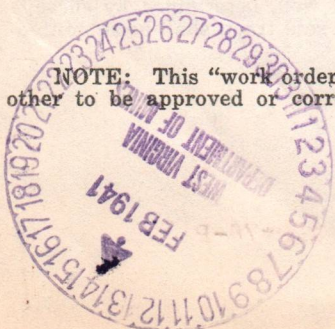

B-10

STATE OF WEST VIRGINIA
DEPARTMENT OF MINES
OIL AND GAS DIVISION

AFFIDAVIT OF PLUGGING AND FILLING WELL

AFFIDAVIT SHOULD BE MADE IN TRIPLICATE, ONE COPY MAILED TO THE DEPARTMENT, ONE COPY TO BE RETAINED BY THE WELL OPERATOR AND THE THIRD COPY (AND EXTRA COPIES IF REQUIRED) SHOULD BE MAILED TO EACH COAL OPERATOR AT THEIR RESPECTIVE ADDRESSES.

COAL OPERATOR OR OWNER	C. R. Feick & C. T. Feick
ADDRESS	Rt. 2, Walker, W. Va.
COAL OPERATOR OR OWNER	Sept. 17 19 59
ADDRESS	WELL AND LOCATION
LEASE OR PROPERTY OWNER	Union District
ADDRESS	Wood County
	Well No. 1
	D. C. Little Farm

STATE INSPECTOR SUPERVISING PLUGGING John E. Lowther

AFFIDAVIT

STATE OF WEST VIRGINIA,

County of Wood } SS:

C. R. Feick and W. T. Hoon

being first duly sworn according to law depose and say that they are experienced in the work of plugging and filling oil and gas wells and were employed by C. R. Feick & C. T. Feick, well operator, and participated in the work of plugging and filling the above well, that said work was commenced on the 9th day of Sept., 19 59, and that the well was plugged and filled in the following manner:

SAND OR ZONE RECORD	FILLING MATERIAL			PLUGS USED	CASING	
	FORMATION	CONTENT	FROM TO		SIZE & KIND	CSG PULLED
Berea	Clay	2217	2158	2" tubing	2210	
	Cement	2158	2148			
	Stone	2148	2143			
	Bridge	1850		6-5/8"	1786	20
	Cement	1850	1840			
	Stone	1840	1835			
	Clay	1835	1500			
	Cement	1500	1490			
	Bridge	1100				
	Cement	1100	1090			
	Stone	1090	1085			
	Clay	1085	1000			
	Cement	1000	990			
	Bridge	200				
	Cement	200	190			
	COAL SEAMS	Stone	190	185	DESCRIPTION OF MONUMENT	
Clay		185	0			
(NAME)				Cemented in piece of casing and let extend above surface.		
(NAME)						
(NAME)						
(NAME)						

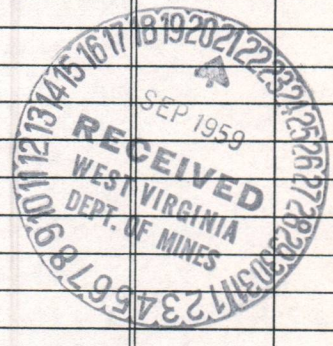

and that the work of plugging and filling said well was completed on the 16th day of September, 19 59.

And further deponents saith not.

Sworn to and subscribed before me this 19th day of Sept 19 59.

My commission expires:

March 22, 1962

W T Hoon
C R Feick
Notary Public.
Permit No. W00-78-P

01/05/2024

Permit No. W00-78-P



STATE OF WEST VIRGINIA
DEPARTMENT OF MINES
OIL AND GAS DIVISION

NOTICE OF INTENTION TO PLUG AND ABANDON WELL

(REQUIRED BY SECTION 9, ARTICLE 4, CHAPTER 22 OF THE CODE)

To THE DEPARTMENT OF MINES,
Charleston, W. Va.

Coal Operator	C. R. Feick & C. T. Feick
Address	Rt. #2, Walker, W. Va.
Coal Owner	Sept. 7, 1959
Address	WELL TO BE ABANDONED
Lease or Property Owner	Union _____ District
Address	Wood _____ County
	Well No. 1
	D. C. Little _____ Farm
	Harrisville, W. Va.
Inspector to be notified	John E. Lowther, Telephone Number NI 42335
	24 hrs. in advance of plugging date

Gentlemen:—

The undersigned well operator is about to abandon the above described well and will commence the work of plugging and abandoning said well on the date inspector is notified (which date shall not be less than five days after the day on which this notice so mailed is received, or in due course should be received by the Department of Mines).

This notice is given you in order that your respective representatives may be present at the plugging and filling of said well. You are further notified that whether you are represented or not represented the undersigned will proceed on that date, or shortly thereafter, to plug and fill said well in the manner required by Section 10, Article 4, Chapter 22 of the Code and given in detail on the reverse side of this notice, in "Work Order."

This notice is being mailed by registered mail to each of you at the above addresses on the above date.

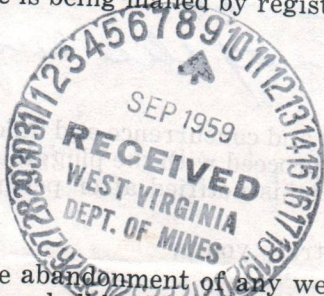

Very truly yours,

C R Feick
Well Operator

NOTE: Upon the abandonment of any well drilled prior to June 1, 1929, a plat prepared by a registered engineer, shall be filed with THREE COPIES OF APPLICATION, (OG-9) AND "WORK ORDER" AND TWO COPIES OF THE WELL RECORD, (OG-10). The map must show the district and county in which the tract of land is located, the name and acreage of same, the name or names of the owners and names of adjacent tracts and the location of the well to be abandoned, determined by survey with the courses and distances of such well from two permanent points or landmarks on said tract.

NOTE: In case plugging is not commenced within four months from the date of permit, same shall expire and be of no further force or effect.

NOTE: PERMIT IS NOT TRANSFERABLE.

01/05/2024

WOO-78-P

Permit Number

C-9



PROPOSED MANNER OF PLUGGING AND FILLING WELL

(REQUIRED BY RULES AND REGULATIONS)

WEST VIRGINIA DEPARTMENT OF MINES

OIL AND GAS DIVISION

WORK ORDER

Well to be plugged and filled as follows:

Total Depth 2212' ✓

Fill with clay from total depth to ^{2172'} 2000' neat cement from ~~2000'~~ 1990', 5' crushed stone on cement.

Set permanent bridge at ^{1850'} 1100' 2 sacks neat cement and 5' crushed stone on bridge. - Bull 6 5/8" casing as hole is filled

Fill with clay to ^{1500'} 1000' neat cement 1500'-1490' - see below and plugged.

Set permanent bridge at 200' 2 sacks neat cement and 5' crushed stone on bridge.

Fill with clay to surface.

Erect marker in compliance with Rul3 18, 1931 Regulations.

Note by Department of Mines

in additions to corrections above to 1490'

set a permanent bridge at 1100' & 2 sacks neat cement & 5' crushed stone on cement

Fill with clay to 1000' neat cement 1000' 990'

complete as stated in original work order

To the Department of Mines
Coal Owner or Operator,
Lease or Property Owner.

Do not short casing unless permitted by the inspector

Gentlemen:

This "work order" is submitted for your approval and concurrence and unless notified of your disapproval or non-concurrence, the undersigned will proceed with the plugging and filling of said well in the above described manner on the date inspector is notified after permit is issued.

Very truly yours,

Well Operator

No objections have been filed by the coal owner or coal operator, or any available adjacent lease or property owners or interposed by the Department of Mines to the manner herein described for the plugging and filling of the well above mentioned. Therefore, the same is hereby approved this

9th day of Sept., 19 59

01/05/2024

DEPARTMENT OF MINES
Oil and Gas Division

By: *W. E. Giffith*

NOTE: This "work order" shall be filed in triplicate, one copy for the files of the Department of Mines; one to be approved or corrected and returned to the well operator as his authority for plugging said well; and one for the well inspector.

E-6

Rt. #1

Parkersburg, W. Va.
5-16-46

Dept of Mines:

Messrs: Am mailing you papers
as required by law for plugging and
abandoning well.

Please mail me blanks
as required by law to notify adjoining
farm owners, oil companies, etc., of our
intention to plug said well. I do not
happen to have said blanks. Please give
this prompt attention as we want to get
this work done as soon as possible.

Very Truly Yours
Little Oil Company
By J. H. Shuman.

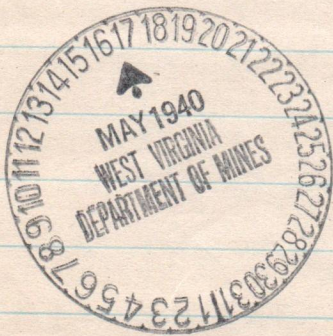

E-7

May 20, 1940

J. D. Shuman, Treas.
Little Oil Company
R. F. D. No. 1
Parkersburg, West Virginia

Dear Sir:

Enclosed is approved Work Order for the plugging and abandoning of Well No. 1 on the D. C. Little Farm, Union District, Wood County.

Enclosed are several additional blanks as requested by you to notify the adjoining lease holders, etc. Please copy the Work Order as modified by the Department and fill in as you have made application to this office. This constitutes the regular notice.

Very truly yours,

Secretary
OIL AND GAS DIVISION

MG/am
encl.

01/05/2024

E-8



STATE OF WEST VIRGINIA
DEPARTMENT OF MINES
CHARLESTON

N. P. RHINEHART
CHIEF



January 31, 1941

*Cancel WOO-78-P
on file*

Little Oil Company
Route No. 1
Parkersburg, West Virginia

Attention: J. H. Shuman, Treasurer

Gentlemen:

Please forward affidavit for Well No. 1 on the
D. C. Little Farm, Union District, Wood County, permit
WOO-78-P.

Blanks are enclosed and your prompt compliance
with this request will be appreciated.

Very truly yours,

Marie E. Griffith
Secretary
OIL AND GAS DIVISION

MG/am
enc-3

*U.B. After securing the inclosed plugging permit, the
company decided not to plug above well, so am
returning "Work Order", Etc. yours
J. H. Shuman*

01/05/2024

Latitude 39° 20'

Longitude 81° 20'

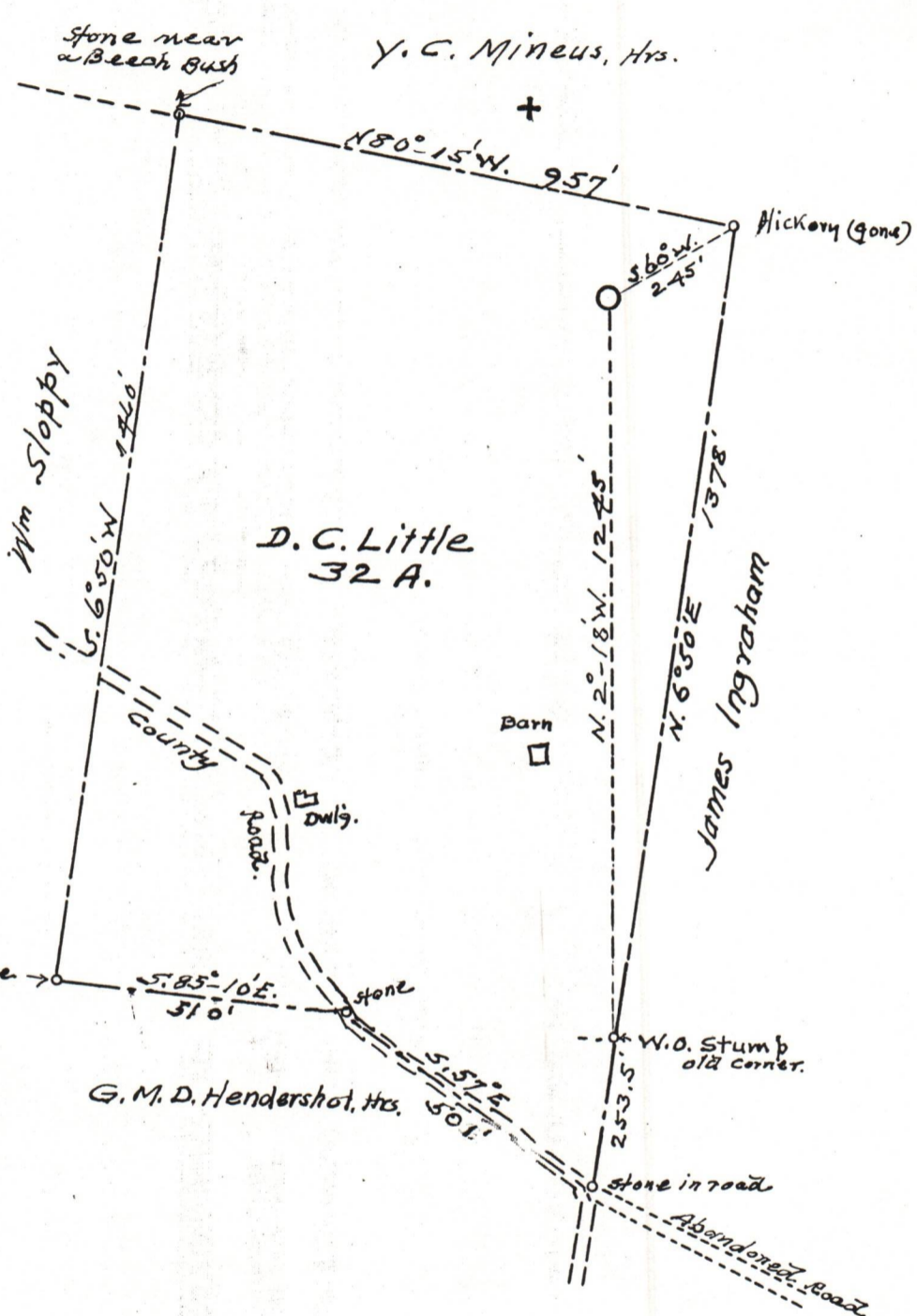

New Location
 Drill Deeper
 Abandonment

Company P. E. Deem
 Address 1807 Avery St. Parkersburg, W. Va.
 Farm D. C. Little
 Tract _____ Acres 32 Lease No. _____
 Well (Farm) No. 1 Serial No. _____
 Elevation (Spirit Level) 820.5
 Quadrangle Marietta
 County Wood District Union
 Engineer J. V. Dunbar
 Engineer's Registration No. 65
 File No. C-23-L Drawing No. _____
 Date July 28, 1938 Scale 1" = 300 Ft.

STATE OF WEST VIRGINIA
 DEPARTMENT OF MINES
 OIL AND GAS DIVISION
 CHARLESTON

WELL LOCATION MAP

FILE NO. Woo-78

01/05/2024

+ Denotes location of well on United States Topographic Maps, scale 1 to 62,500, latitude and longitude lines being represented by border lines as shown.

- Denotes one inch spaces on border line of original tracing.