

1 2 3

LATITUDE 39° 10'

LONGITUDE 81° 30'

1

2

3

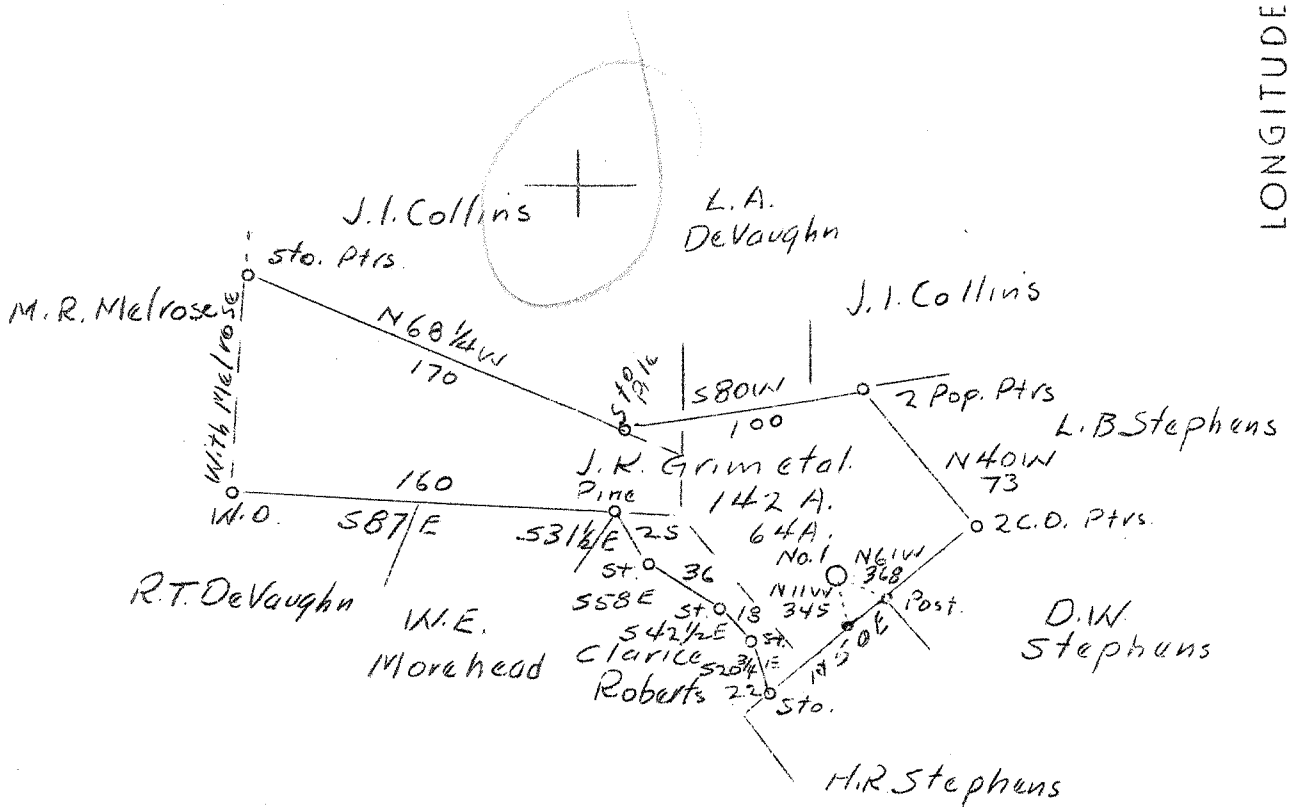

3.77-W  
~~W 3.80~~  
 S 2.52  
 2.49-S  
 6 WC (6-5)

*ADD*  
*4/47*

New Location

See Vol. XVI, P. 713

Company	United Carbon Co.	STATE OF WEST VIRGINIA Department of Mines OIL & GAS DIVISION Charleston  WELL LOCATION MAP  File No. <u>W 00-90</u>  x Denotes location of well on U. S. Topographic Maps, scale 1 to 62,500, latitude and longitude lines being represented by border lines as shown.  - Denotes one inch spaces on border line of original tracing.
Address	Charleston, W. Va.	
Firm	J. K. Grimm et al	
Acres	142	
Lease No.	3581	
Well (Farm) No.	1	
Section No.	811	
Elevation (SL)	750	
Quadrangle	Belloville <b>EC</b>	
County	Wood	
District	Steel	
Supervisor	Glen W. Roberts	
Eng. Reg. No.	860	
Date	Sept. 26, 1939	
Scale	1" = 1320'	

Deep Well

WEST VIRGINIA DEPARTMENT OF MINES  
OIL & GAS DIVISION  
WELL RECORD

Permit No. W-90  
Belloville Quad.

Gas Well

Company	United Carbon Co.	16	16	16
Address	Charleston, W. Va.	13	404	404
Farm	J. K. Groom, et al. ACRES 142	10	1095	1095
Location	Stephens Fork	8-1/4	1912	1912
Well No.	311 ELEV. 750	7	4647	4647
District	Stoole - Wood County			
Surface & Mineral	J. K. Groom, et al, Parkersburg, W. Va.			
Commenced	10/9/39 - completed 2/17/40			
Shot	2/21/40 - depth 4751-4781			
Open Flow				
Volume	110,000 cu. ft			
Rock Pressure	1800 lbs. 72 hrs.			
Fresh Water	710			
Salt Water	1175, 1821 and 1860			

CASING & TUBING

CASING CEMENTED:  
7" OD 4647' - 20 bags  
February 21, 1940

Clay	0	15		Sand - black	1246	1263	
Red Rock	15	60		Slate - white	1263	1289	
Sand	60	75		Slate - black	1289	1306	
Red Rock	75	95		Sand	1306	1329	
Slate	95	105		Slate - black	1329	1366	
Sand	105	150		Sand	1366	1395	
Red Rock	150	160		Slate - black	1395	1442	
Sand - blue	160	165		Sand Shell	1442	1450	
Red Rock	165	230		Slate	1450	1469	
Sand - blue	230	240		Sand	1469	1549	
Red rock	240	250		Slate - break	1549	1558	
Slate - white	250	295		Sand	1558	1564	
Red rock	295	314		Slate	1564	1576	
Slate - white	314	370		Sand	1576	1625	
Red rock	370	388		Slate break	1625	1658	
Slate - white	388	393		Sand	1658	1875	W 1821
Red rock	393	404		Slate	1875	1900	1860
Sand	404	410		Lime	1860	1894	
Slate - white	410	440		Slate	1894	1908	
Red rock	440	470		Lime Shell	1908	1916	
Slate	470	485		Slate	1916	1923	
Red rock	485	520		Limey Sand	1923	1940	
Slate - white	520	535		Slate	1940	2020	
Red rock	535	550		Lime sandy	2020	2030	
Slate - white	550	575		Shale sandy	2030	2110	
Shale - black	575	630		Slate black	2110	2180	
Slate	630	660		Shale sandy	2180	2290	- Area internal
Red rock	660	670		Slate & Shells	2290	2413	
Slate	670	680		Slate - brown	2413	2500	
Shale - sandy	680	710	W 710 -6	Slate & Shells	2500	2635	
Sand	710	750	blns. hr.	Shale - brown	2635	2950	
Slate - white	750	756		Shale - grey	2950	3350	
Red rock	756	806		Shale - brown	3350	3380	
Shale	806	826		Shale - grey	3380	3439	
Red Rock	826	836		Shells - grey	3439	3450	
Slate	836	865		Shale & Slate - grey	3450	3546	
Red Rock	865	900		Shale - brown	3546	3580	
Slate	900	905		Slate - grey	3580	3670	
Red Rock	905	930		Shale - brown	3670	4100	
Sandy Shell	930	950		Slate - grey	4100	4340	
Slate	950	965		Shale - brown	4340	4450	
Red Rock	965	972		Shale - brown	4450	4510	
Slate & Shells	972	990		Shale - brown	4510	4625	
Sand Shell	990	1007		Lime - Onondaga	4625	4746	
Slate - black	1007	1033		Oriskany Sand	4746	4780	
Slate - white	1033	1095		Lime - gritty 2 1/2" held	4780	4809	
Sand	1095	1135		Lime - dark large plates	4809	4816	TD
Slate	1135	1170					
Slate - black	1170	1175	HPW 1175	Gas smell at 4480			
Sand	1175	1208	Lt. sh. Oil	First show of gas 4751			
Slate - white	1208	1246	1190	110,000 at 4754			

4625 4746 4780  
750  
3875 3996 4030

(485)