



STATE OF WEST VIRGINIA
DEPARTMENT OF MINES
OIL AND GAS DIVISION

NOTICE OF PROPOSED LOCATION OF OIL AND GAS WELL

To THE DEPARTMENT OF MINES,
Charleston, W. Va.

Not Operated
COAL OPERATOR OR COAL OWNER

Godfrey L. Cabot, Inc.
NAME OF WELL OPERATOR

ADDRESS

900 Union Building, Charleston, W. Va.
COMPLETE ADDRESS

COAL OPERATOR OR COAL OWNER

March 26, 19 48

PROPOSED LOCATION

ADDRESS

Steele District

Godfrey L. Cabot, Inc.
OWNER OF MINERAL RIGHTS

Wood County

900 Union Bldg., Charleston, W. Va.
ADDRESS

Well No. 1 S-1282 39° 05'
81° 30'

Jacob Gates Farm

GENTLEMEN:

The undersigned well operator is entitled to drill upon the above named farm or tract of land for oil and gas, having fee title thereto, (or as the case may be) under grant or lease dated May 15, 1906, made by Jacob Gates, to Godfrey L. Cabot, Inc., and recorded on the 23rd day of May, 1906, in the office of the County Clerk for said County in Book 140, page 217.

The enclosed plat was prepared by a competent engineer and shows the proposed location of a well to be drilled for oil and gas by the undersigned well operator on the farm and in the Magisterial District and County above named, determined by survey and courses and distances from two permanent points, or land marks.

The undersigned well operator is informed and believes there are no coal operators operating beds of coal beneath said farm or tract of land on which said well is located, or within 500 feet of the boundaries of the same, who have mapped their workings and filed their maps as required by law, excepting the coal operators or coal owners (if any) above named as addressees.

The above named coal operators or coal owners (if any) are notified that any objections they may desire to make to such proposed location, or which they are required to make by Section 3 of said Code, if the drilling of a well at said proposed location will cause a dangerous condition in or about their respective coal mines, must be received by, or filed with the Department of Mines within ten* days from the receipt of a copy of this notice and accompanying plat by said Department. Said coal operators are further notified that forms for use in making such objections will be furnished to them by the Department of Mines promptly on request and that all such objections must set forth as definitely as is reasonably possible the ground or grounds on which such objections are based and indicate the direction and distance the proposed location should be moved to overcome same.

(The next paragraph is to be completed only in Department's copy.)

Copies of this notice and the enclosed plat were mailed by registered mail, or delivered to the above named coal operators or coal owners at their above shown respective address _____ day _____ before, or on the same day with the mailing or delivery of this copy to the Department of Mines at Charleston, West Virginia.

Very truly yours,

Godfrey L. Cabot, Inc.

WELL OPERATOR

900 Union Building

STREET

Charleston

CITY OR TOWN

West Virginia

STATE

12/15/2023

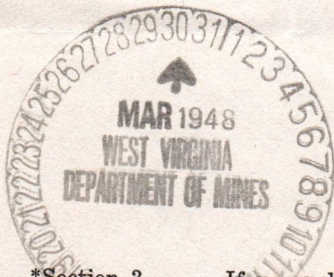

Address of Well Operator }

*Section 3 If no such objections be filed or be found by the department of mines, within said period of ten days from the receipt of said notice and plat by the department of mines, to said proposed location, the department shall forthwith issue to the well operator a drilling permit reciting the filing of such plat, that no objections have been made by the coal operators to the location, or found thereto by the department, and that the same is approved and the well operator authorized to proceed to drill at said location.

A-10

April 9, 1948

Godfrey L. Cabot, Inc.,
900 Union Building
Charleston, West Virginia

Gentlemen:

Enclosed is permit WOO-²648 for the drilling of
Well No. 1, Serial 1282 on the Jacob Gates Farm, Steele
District, Wood County.

Very truly yours,

Administrative Assistant
OIL AND GAS DIVISION

MG:g
encl

cc: O. C. Howard, Inspector
R. C. Tucker, Ass't State Geologist

12/15/2023

A-11

GODFREY L. CABOT, INC.

NATURAL GAS

900 UNION BUILDING



BOX 1473

CHARLESTON 25, W. VA.

L. J. MORRIS

Eastern Production Mgr.

West Virginia Division

WILLARD P. SMITH

General Sup't.

March 29, 1948

West Virginia Department of Mines
Oil and Gas Division
Charleston, West Virginia

Gentlemen:

We enclose one copy of notice of proposed location of our Jacob Gates well #1, Serial 1282, located in Steele District, Wood County, West Virginia.

We are sending you under separate cover tracing and location plat showing the position of the above well.

Yours very truly,

bw

Enc.

cc: CLGyberg, w/ copy of notice and plat.

C. Williams, w/ " " "

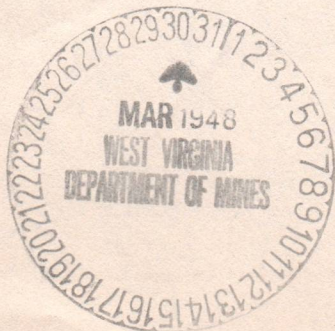

12/15/2023

Redhill
W-248

B-2

GODFREY L. CABOT, INC.

WELL RECORD

SERIAL NO. 1282 OPERATING DISTRICT Wirt Map Square Lot No. Warrant No. 62-37
 FARM Jacob Gates (G.L.C. fee). NO. 1 LEASE NO.
 COUNTY Wood TAX DISTRICT TOWNSHIP Steele STATE W. Va.
 DRILLING COMMENCED October 7, 1948 DRILLING COMPLETED March 3, 1949
 CONTRACTOR Company Tools ADDRESS Charleston, West Virginia

ROCK PRESSURE RECORD

Oriskany	Sand	1600	lbs., in	36	hrs.
	Sand		lbs., in		hrs.
	Sand		lbs., in		hrs.

PRODUCING SAND RECORD

Oriskany	Sand, from	5225 ^{to}	5270	Init. Prod.	365*	M. C. F. Gas
	Sand, from		to	Init. Prod.		M. C. F. Gas
	Sand, from		to	Init. Prod.		M. C. F. Gas

OPEN FLOW
 Time, Condition: 1 hour after shot.
 32 Waretex
 10ths Mercury in 3" inch opening
 Volume 1,980 M. C. F.
 24 HOUR PRODUCTION TEST AFTER TUBING
 M. C. F. Line Pressure
 Bbls. Oil in 24 Hours
 TUBED AND SHUT IN Date
 Packer, Size Kind
 Set, Depth Size Anchor
 Perf. Top Bottom
 Perf. Top Bottom

CASING RECORD

SIZE	WEIGHT	USED IN DRILLING	LEFT IN WELL	HOW CASING SET
13-5/8"	48#	258	258	
10"	25.75	1091	1091	
8"	24#	1993	1253	
7"	24#	2127	2127	
5 1/2"	20#	5137	5137	
2"	3.75			

ELEVATION: 1035.3

SHOOTING RECORD
 Shot with ~~Acid~~ 40 qts. from 5,223 to 5,243 Date March 3, 1949
 Gauge Before ~~Acid~~ Shot 189 Mcf. Gauge 1 Hrs. After ~~Acid~~ Shot 1,980 Mcf.

FORMATION	COLOR	TOP	BOTTOM	STEEL LINE MEASUREMENTS	HARD OR SOFT	OIL, GAS OR WATER	DEPTH FOUND	REMARKS
Surface		0	20					* See other side for gauge in Oriskany.
Redrock		20	135					
Lime Shell		135	145					
Redrock		145	255					
Lime Shell		255	300					
Sand		300	325					
Redrock		325	341					
Sand		341	358					
Redrock		358	415					
Lime		415	425					
Redrock		425	491					
Lime - Blue		491	523					
Redrock		523	535					
Lime		535	545					
White Slate		545	556					
Redrock		556	562					
Slate & Shells		562	601					
Redrock		601	640					
Lime		640	660					
Pink Rock		660	682					
Lime - Blue		682	692					
Sand - White		692	713					
Lime		713	730					
Redrock		730	771					
Slate - White		771	783					

12/15/2023
 MAR 1949
 WEST VIRGINIA
 DEPARTMENT OF MINES

23-1

FORMATION	COLOR	TOP	BOTTOM	STEEL LINE MEASUREMENTS	HARD OR SOFT	OIL, GAS OR WATER	DEPTH FOUND	REMARKS
Lime - Blue		783	800					
Redrock		800	828					
Slate - Blue		828	883					
Sand - White		883	935			Water	890	3 bailers per hour.
Slate - White		935	1009					
Sand		1009	1031					
Lime		1031	1036					
Redrock		1036	1091					
Gray Lime		1091	1105					
Redrock		1105	1158					
Gray Lime		1158	1170					
Redrock		1170	1176					
Gray Lime		1176	1188					
Slate		1188	1217					
Redrock		1217	1223					
Lime		1223	1256					
Redrock		1256	1273					
Lime		1273	1343					
Slate		1343	1350					
Lime		1350	1385					
Sand		1385	1452			Water	1415	1-1/2 bailers per hour.
Slate		1452	1492					
Lime		1492	1504					
Sand		1504	1517					
Slate & Shells		1517	1566					
Lime		1566	1577					
Sand - White		1577	1604					
Slate		1604	1662					
Lime		1662	1702					
Sand		1702	1805			Water	1722	4 bailers per hour.
Slate		1805	1820					
Sand		1820	1860					
Lime		1860	1900					
Slate		1900	1931					
Sand		1931	2085			Water	1965	Hole full.
Lime		2085	2230					
Slate & Shells		2230	4100			Gas	2872	Smell.
Slate & Shell		4100	4409					<u>GAUGES IN ORISKANY:</u>
Slate		4409	4750			Gas	5226	395 Mcf. *
Brown Shale		4750	4938			Gas	5236	119 Mcf.
Black Shale		4938	5114	5114		Gas	5238	365 Mcf. *
Corniferous		5114	5225			Gas	5245	310 Mcf.
Oriskany		5225	5270	5225		Gas	5269	189 Mcf.
								* Gas Pay. (Gas froze off).
TOTAL DEPTH			5270					

12/15/2023

DATE _____

APPROVED _____

FOREMAN

Handwritten notes:
 12/15/23
 12/15/23

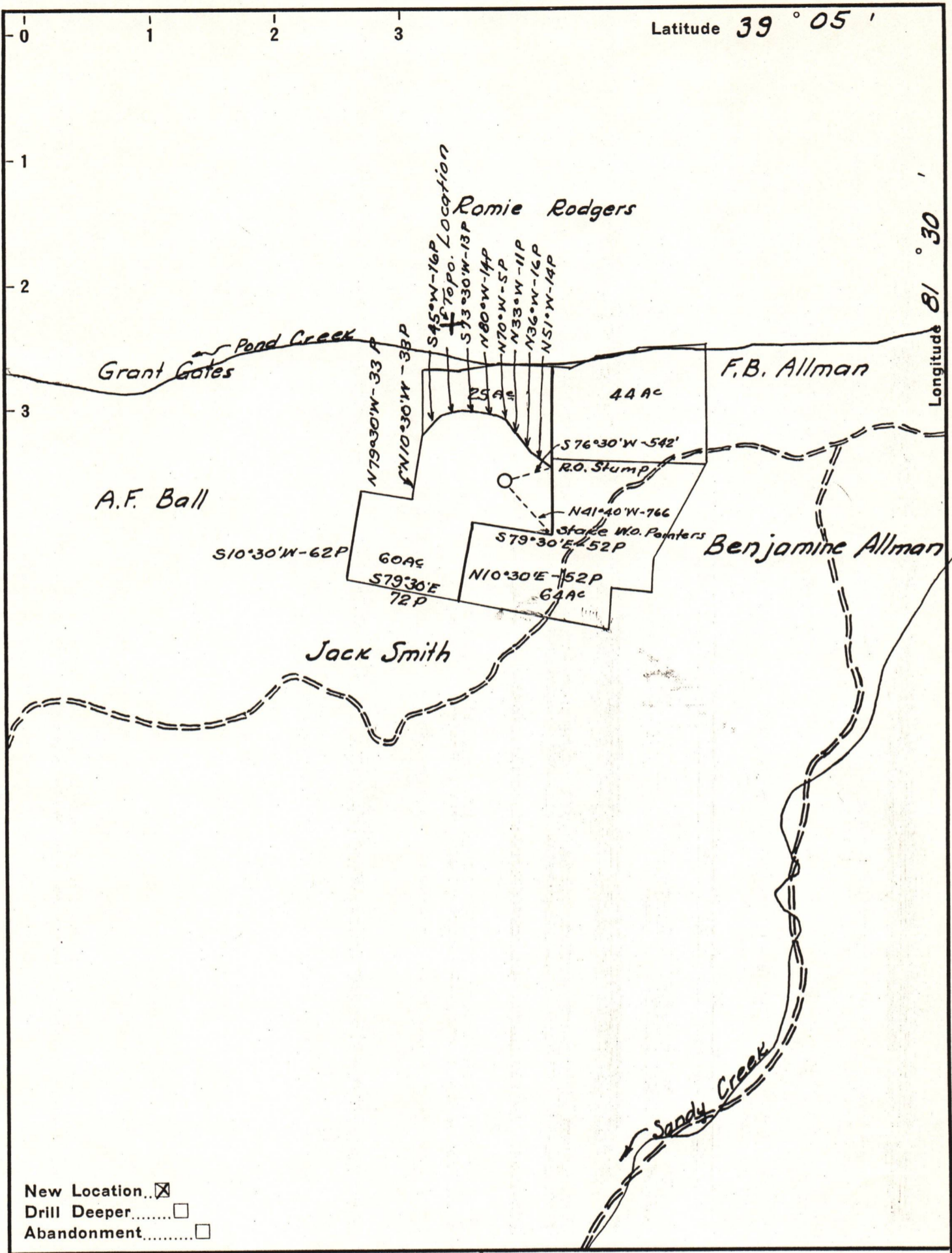

New Location..
 Drill Deeper.....
 Abandonment.....

Company Godfrey L. Cabot Inc.
 Address 300 Union Bldg. Charleston W. Va
 Farm Jacob Gates (GLC. O&G)
 Tract _____ Acres 60 Lease No. 2-110'
 Well (Farm) No. 1 Serial No. 1282
 Elevation (Spirit Level) 1035.30
 Quadrangle Belleville
 County Wood District Steele
 Engineer Roy Beaton
 Engineer's Registration No. _____
 File No. _____ Drawing No. _____
 Date 3-26-48 Scale 1" = 1320'

STATE OF WEST VIRGINIA
 DEPARTMENT OF MINES
 OIL AND GAS DIVISION
 CHARLESTON

WELL LOCATION MAP
 FILE NO. W00-248 12/15/2023

+ Denotes location of well on United States Topographic Maps, scale 1 to 62,500, latitude and longitude lines being represented by border lines as shown.
 - Denotes one inch spaces on border line of original tracing.