

NOTICE OF PROPOSED LOCATION OF OIL AND GAS WELL
(REQUIRED BY SECTION 2, CHAPTER 22, CODE 1931)
WEST VIRGINIA DEPARTMENT OF MINES
OIL AND GAS SECTION

To THE DEPARTMENT OF MINES,
Charleston, W. Va.

No ~~gas~~ No coal

COAL OPERATOR OR COAL OWNER

ADDRESS

COAL OPERATOR OR COAL OWNER

ADDRESS

OWNER OF MINERAL RIGHTS

ADDRESS

J. O. Moore & Jasper E. Leach

NAME OF WELL OPERATOR

1503 Liberty Street, Parkersburg,
W. Va.

COMPLETE ADDRESS

April 23, 1948

193

PROPOSED LOCATION

Harris

District

Wood

County

Well No. 1

39°10'
81°40'

Moore & Leach

Farm

GENTLEMEN:

The undersigned well operator is entitled to drill upon the above named farm or tract of land for oil and gas, having fee title thereto, (or as the case may be) under grant or lease dated _____

~~April 19, 1948~~ _____, made by J. O. Moore et al _____, to

J. O. Moore & Jasper E. Leach _____, and recorded on the 22nd day

of April, 1948 _____, in the office of the County Clerk for said County in

Book 308 _____, page 468 _____.

The enclosed plat was prepared by a competent engineer and shows the proposed location of a well to be drilled for oil and gas by the undersigned well operator on the farm and in the Magisterial District and County above named, determined by survey and courses and distances from two permanent points, or land marks.

The undersigned well operator is informed and believes there are no coal operators operating beds of coal beneath said farm or tract of land on which said well is located, or within 500 feet of the boundaries of the same, who have mapped their workings and filed their maps as required by law, excepting the coal operators or coal owners (if any) above named as addressees.

The above named coal operators or coal owners (if any) are notified that any objections they may desire to make to such proposed location, or which they are required to make by Section 3 of said Code, if the drilling of a well at said proposed location will cause a dangerous condition in or about their respective coal mines, must be received by, or filed with the Department of Mines within ten* days from the receipt of a copy of this notice and accompanying plat by said Department. Said coal operators are further notified that forms for use in making such objections will be furnished to them by the Department of Mines promptly on request and that all such objections must set forth as definitely as is reasonably possible the ground or grounds on which such objections are based and indicate the direction and distance the proposed location should be moved to overcome same.

(The next paragraph is to be completed only in Department's copy.)

Copies of this notice and the enclosed plat were mailed by registered mail, or delivered to the above named coal operators or coal owners at their above shown respective address _____ day _____ before, or on the same day with the mailing or delivery of this copy to the Department of Mines at Charleston, West Virginia.

Very truly yours,

Moore & Leach

Jasper E. Leach

WELL OPERATOR

1503 Liberty St.

STREET

Parkersburg, West Va.

CITY OR TOWN

West Virginia

STATE

12/15/2023

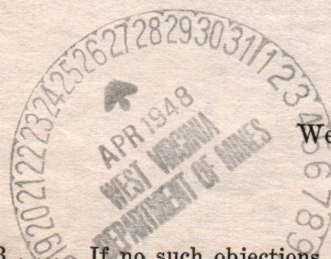

Address of Well Operator }

*Section 3. If no such objections be filed, or be found by the department of mines, within said period of ten days from the receipt of said notice and plat by the department of mines, to said proposed location, the department shall forthwith issue to the well operator a drilling permit reciting the filing of such plat, that no objections have been made by the coal operators to the location, or found thereto by the department, and that the same is approved and the well operator authorized to proceed to drill at said location.

NOTICE OF PROPOSED LOCATION OF OIL AND GAS WELL
WEST VIRGINIA DEPARTMENT OF MINES
OIL AND GAS SECTION

To The Department of Mines
Charleston, W. Va.

No. 1234567890

J. O. Moore & Company, Inc.

COAL OPERATOR OR COAL OWNER

NAME OF WELL OPERATOR

ADDRESS

COMPLETE ADDRESS

PROPOSED LOCATION

PROPOSED LOCATION

ADDRESS

ADDRESS

NAME OF MINES OPERATOR

ADDRESS

Moore & Co. Inc.

The undersigned well operator is advised that upon the above named land or tract of land there is a coal seam which is being mined by the undersigned coal owner and that the proposed location of the well is in the same coal seam and that the proposed location of the well is in the same coal seam as the coal seam being mined by the undersigned coal owner. The undersigned well operator is advised that the proposed location of the well is in the same coal seam as the coal seam being mined by the undersigned coal owner and that the proposed location of the well is in the same coal seam as the coal seam being mined by the undersigned coal owner.

The undersigned well operator is advised that the proposed location of the well is in the same coal seam as the coal seam being mined by the undersigned coal owner and that the proposed location of the well is in the same coal seam as the coal seam being mined by the undersigned coal owner. The undersigned well operator is advised that the proposed location of the well is in the same coal seam as the coal seam being mined by the undersigned coal owner and that the proposed location of the well is in the same coal seam as the coal seam being mined by the undersigned coal owner.

Very truly yours,
J. O. Moore & Company, Inc.
By *[Signature]*
12345 Liberty St.
Parkersburg
West Virginia

Section 301, Chapter 20, Code of West Virginia, provides that the proposed location of the well is in the same coal seam as the coal seam being mined by the undersigned coal owner and that the proposed location of the well is in the same coal seam as the coal seam being mined by the undersigned coal owner.

12/15/2023

PROPOSED MANNER OF PLUGGING AND FILLING WELL

(REQUIRED BY RULES AND REGULATIONS)

WEST VIRGINIA DEPARTMENT OF MINES

OIL AND GAS DIVISION

WORK ORDER

Well to be plugged and filled as follows:

WORK ORDER PREPARED BY THE DEPARTMENT OF MINES

Total Depth 2160'

Fill with clay from bottom 2160' - 2100' - 20' above Berea Sand

Neat Cement 2100' - 2090'

5' crushed stone on cement plug - sealing hole above Berea Sand

SET A PERMANENT BRIDGE AT 1780'

2 sacks neat cement and 5' crushed stone on bridge

Fill with clay to 1740'

Pull 5-3/16" casing and

Continue filling with clay to 1530' - 30' below 6-5/8" casing

Neat Cement 1530' - 1520'

5' crushed stone on cement plug

Pull 6-5/8" casing

SET A PERMANENT BRIDGE AT 830' - 30' below 8-1/4" casing

2 sacks neat cement and 5' crushed stone on bridge

Pull 8-1/4" casing and

Continue filling with clay to 700'

Neat Cement 700' - 690'

SET A PERMANENT BRIDGE AT 330' - 30' below 10" casing

2 sacks neat cement and 5' crushed stone on bridge

Pull 10" casing and

Fill with clay to surface

Erect marker such as is described in Rule 18, 1931 Regulations

To the Department of Mines
Coal Owner or Operator,
Lease or Property Owner.

Gentlemen:

This "work order" is submitted for your approval and concurrence and unless notified of your disapproval or non-concurrence, the undersigned will proceed with the plugging and filling of said well in the above described manner on the date stated in the notice of intention to plug and abandon the said well on opposite side of this sheet.

Very truly yours,

J. E. Leach

Well Operator.

No objections have been filed by the coal owner or coal operator, or any available adjacent lease or property owners or interposed by the Department of Mines to the manner herein described for the plugging and filling of the well above mentioned. Therefore, the same is hereby approved this

19th day of AUGUST, 1948, 19 ____

DEPARTMENT OF MINES
Oil and Gas Division

By: _____

NOTE: This "work order" shall be filed in triplicate, one copy for the files of the Department of Mines; one to be approved or corrected and returned to the well operator as his authority for plugging said well; and one for the well inspector.



STATE OF WEST VIRGINIA
DEPARTMENT OF MINES
OIL AND GAS DIVISION

NOTICE OF INTENTION TO PLUG AND ABANDON WELL

(REQUIRED BY SECTION 9, ARTICLE 4, CHAPTER 22 OF THE CODE)

To THE DEPARTMENT OF MINES,
Charleston, W. Va.

None	J. O. Moore & Jasper E. Leach
----- COAL OPERATOR OR COAL OWNER	----- NAME OF WELL OPERATOR
----- ADDRESS	1503 Liberty St. Parkersburg, W.V. ----- COMPLETE ADDRESS
----- COAL OPERATOR OR COAL OWNER	August 18 19 48
----- ADDRESS	WELL TO BE ABANDONED
----- LEASE OR PROPERTY OWNER	Harris District
----- ADDRESS	Wood County
----- LEASE OR PROPERTY OWNER	Well No. 1
----- ADDRESS	MOORE & LEACH Farm

Gentlemen:—

The undersigned well operator is about to abandon the above described well and will commence the work of plugging and abandoning said well on the 23rd day of August, 19 48, (which date shall not be less than five days after the day on which this notice so mailed is received, or in due course should be received by the Department of Mines.)

This notice is given you in order that your respective representatives may be present at the plugging and filling of said well. You are further notified that whether you are represented or not represented the undersigned will proceed on that date, or shortly thereafter, to plug and fill said well in the manner required by Section 10, Article 4, Chapter 22 of the Code and given in detail on the reverse side of this notice, in "Work Order."

This notice is being mailed by registered mail to each of you at the above addresses on the above date.

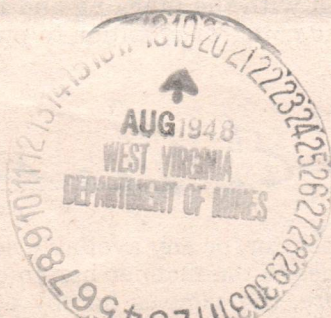

Very truly yours, Moore & Leach

By J. E. Leach
Well Operator.

12/15/2023

NOTE: Upon the abandonment of all wells drilled prior to June 1, 1929, a plat prepared by a competent engineer, showing the district and county in which the tract of land is located, the name and acreage of same, the names of the owners and adjacent tracts, and the location of the about to be abandoned well, determined by survey, and the courses and distances of such well from two permanent points or landmarks on said tract, shall be submitted with this notice.

(Over)

Woo-251-P

PERMIT NUMBER

STATE OF WEST VIRGINIA
DEPARTMENT OF MINES
OIL AND GAS DIVISION

INSPECTOR'S PLUGGING REPORT

Permit No. Woo 267P Well No. 1

COMPANY J B More & Joseph C Leach ADDRESS Parkersburg W^a

FARM More & Leach DISTRICT Harris COUNTY Wood

Filling Material Used Clay and cement

Liner Location Amount Packer Location

PLUGS USED AND DEPTH PLACED			BRIDGES	CASING AND TUBING		
CEMENT-THICKNESS	WOOD-SIZE	LEAD	CONSTRUCTION-LOCATION	RECOVERED	SIZE	LOST
	<u>Complete Aug 31-1948</u>					
	<u>No inspection</u>					

Drillers' Names _____

Remarks: _____

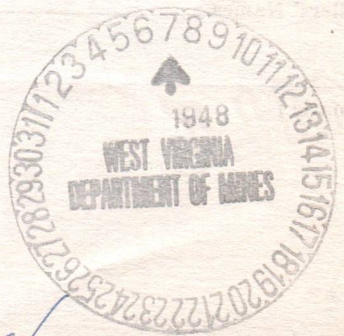

8/31-1948 I hereby certify I visited the above well on this date.
DATE

Ab Steward
DISTRICT WELL INSPECTOR

12/15/2023

STATE OF WEST VIRGINIA
DEPARTMENT OF MINES
OIL AND GAS DIVISION

INSPECTOR'S WELL REPORT

Permit No. _____

Oil or Gas Well _____
(KIND)

Company _____ Address _____ Farm _____ Well No. _____ District _____ County _____ Drilling commenced _____ Drilling completed _____ Total depth _____ Date shot _____ Depth of shot _____ Initial open flow _____ /10ths Water in _____ Inch Open flow after tubing _____ /10ths Merc. in _____ Inch Volume _____ Cu. Ft. Rock pressure _____ lbs. _____ hrs. Oil _____ bbls., 1st 24 hrs. Fresh water _____ feet _____ feet Salt water _____ feet _____ feet	CASING AND TUBING	USED IN DRILLING	LEFT IN WELL	PACKERS
	Size 16 13 10 8 1/4 6 5/8 5 3/16 3 2 Liners Used			
CASING CEMENTED _____ SIZE _____ No. FT. _____ Date _____				
COAL WAS ENCOUNTERED AT _____ FEET _____ INCHES				
_____ FEET _____ INCHES _____ FEET _____ INCHES				
_____ FEET _____ INCHES _____ FEET _____ INCHES				

Drillers' Names _____

Remarks:

DATE

DISTRICT WELL INSPECTOR

12/15/2023



Formation	Color	Hard or Soft	Top	Bottom	Oil, Gas or Water	Depth Found	Remarks
			8120	8120			
			8180	8180			
			8190	8190			
			8200	8200			
			8210	8210			
			8220	8220			
			8230	8230			
			8240	8240			
			8250	8250			
			8260	8260			
			8270	8270			
			8280	8280			
			8290	8290			
			8300	8300			
			8310	8310			
			8320	8320			
			8330	8330			
			8340	8340			
			8350	8350			
			8360	8360			
			8370	8370			
			8380	8380			
			8390	8390			
			8400	8400			

6/11/2023

12/15/2023

Date Aug 18, 1978
 APPROVED Moore & Leach, Owner
 By J.E. Leach (Title) Mag.





STATE OF WEST VIRGINIA
DEPARTMENT OF MINES
OIL AND GAS DIVISION

251

Beelville

WELL RECORD

Permit No. W00-251

Oil or Gas Well dry
(KIND)

Company J.O. Moore & Jasper E. Leach
 Address 1503 Liberty St. Parkersburg, W. Va.
 Farm Moore & Leach Acres 51
 Location (waters) Middle Fork Lee Creek
 Well No. 1 Elev. 820
 District Harris County Wood
 The surface of tract is owned in fee by Moore & Leach
 Address Parkersburg, W. Va.
 Mineral rights are owned by same
 Address _____
 Drilling commenced June 1948
 Drilling completed Aug. 16, 1948
 Date Shot VVVVV From _____ To _____
 With _____

Casing and Tubing	Used in Drilling	Left in Well	Packers
Size			
16			Kind of Packer
13			
10	300	300	Size of
8 1/4	800	800	
	1500	1500	Depth set
6 3/8	1720	1720	
3			Perf. top
2			Perf. bottom
Liners Used			Perf. top
			Perf. bottom

Open Flow _____ /10ths Water in _____ Inch
 _____ /10ths Merc. in _____ Inch
 Volume _____ Cu. Ft.
 Rock Pressure _____ lbs. _____ hrs.
 Oil _____ bbls., 1st 24 hrs.
 Fresh water _____ feet _____ feet
 Salt water _____ feet _____ feet

CASING CEMENTED	SIZE	No. Ft.	Date
COAL WAS ENCOUNTERED AT			
		FEET	INCHES
		FEET	INCHES
		FEET	INCHES

Formation	Color	Hard or Soft	Top	Bottom	Oil, Gas or Water	Depth Found	Remarks
Clay	Red rock	slate	00000	150			
Lime			150	160			
Red rock			160	220			
Sand-water			220	240			
Slate			240	265			
Sand, slate sand			265	400			
Red rock, lime & slate			400	505			
Sand			505	515			
Slate and sand			515	700			
Red rock, sand, slate			700	805			
Shale red rock, white sand etc.			805	950			
Lime			950	975			
Slate & sand			975	1720			
Sand, shells			1720	1750			
Slate, white, blue & brown			1750	2120			
Berea sand			2120	2130			
Lime-gritty			2130	2160			
					Bottom of hole-	dry	

Plugged
9/4/48

12/15/2023

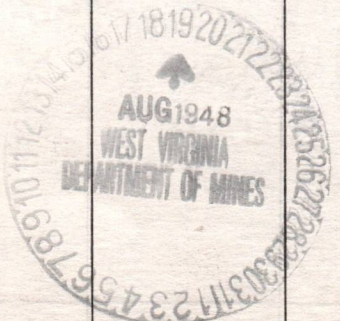

STATE OF WEST VIRGINIA
DEPARTMENT OF MINES
OIL AND GAS DIVISION

AFFIDAVIT OF PLUGGING AND FILLING WELL

AFFIDAVIT SHOULD BE MADE IN TRIPLICATE, ONE COPY MAILED TO THE DEPARTMENT, ONE COPY TO BE RETAINED BY THE WELL OPERATOR AND THE THIRD COPY (AND EXTRA COPIES IF REQUIRED) SHOULD BE MAILED TO EACH COAL OPERATOR AT THEIR RESPECTIVE ADDRESSES.

J.D. Moss of Leach to reach
J. E. Leach

COAL OPERATOR OR OWNER: _____ NAME OF WELL OPERATOR: *J. E. Leach*

ADDRESS: _____ COMPLETE ADDRESS: *1503 Liberty St. Parkersburg, W. Va.*

COAL OPERATOR OR OWNER: _____ WELL AND LOCATION: *Aug 18 1948*

ADDRESS: _____ DISTRICT: *Harris*

LEASE OR PROPERTY OWNER: _____ COUNTY: *Wood*

ADDRESS: _____ Well No.: *1*

_____ Farm: *Moss of Leach*

STATE INSPECTOR SUPERVISING PLUGGING: _____

AFFIDAVIT

STATE OF WEST VIRGINIA,

County of *Kitakee*

SS:

C. L. Bachelor

and

J. D. Brown

being first duly sworn according to law depose and say that they are experienced in the work of plugging and filling oil and gas wells and were employed by _____, well operator, and participated in the work of plugging and filling the above well, that said work was commenced on the *23* day of *August*, 1948, and that the well was plugged and filled in the following manner:

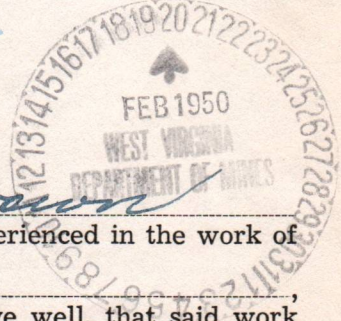

SAND OR ZONE RECORD	FILLING MATERIAL				PLUGS USED	CASING	
	FORMATION	CONTENT	FROM	TO		CSG PULLED	CSG LEFT IN
	<i>Filled with Clay from Bottom</i>	<i>2100 - 2100</i>					
	<i>Cement</i>	<i>2100 - 2090</i>					
	<i>5' crushed stone on cement plug above Berea sand</i>						
	<i>Set permanent bridge at</i>			<i>1780</i>			
	<i>2 sacks of cement and 5' crushed stone on bridge</i>						
	<i>Filled with Clay to</i>			<i>1740</i>			
	<i>Continued filling Clay to</i>			<i>1530</i>			
	<i>2 sacks of cement and 5' of crushed stone on cement plug</i>						
	<i>Pulled 6 3/8 casing</i>						
	<i>Set a permanent bridge at</i>			<i>830 - 30'</i>			
	<i>2 sacks of cement and 5' crushed stone on bridge</i>						
	<i>pulled 8 1/2" casing and continued filling to</i>			<i>700</i>			
	<i>Set permanent bridge at</i>			<i>330 - 30'</i>			
	<i>2 sacks cement and 5' of crushed stone on bridge</i>						
	<i>pulled 10" casing and filled with clay to surface</i>						
COAL SEAMS					DESCRIPTION OF MONUMENT		
(NAME)					<i>Pipe filled with</i>		
(NAME)					<i>Cement</i>		
(NAME)							
(NAME)							

and that the work of plugging and filling said well was completed on the *4th* day of *September*, 1948.

And further deponents saith not.

C. L. Bachelor
J. D. Brown

12/15/2023

Sworn to and subscribed before me this *17* day of *February*, 1948.

J. H. Raymond
Notary Public.

My commission expires: *Feb. 14, 1954*

Permit No. *Woo 951-P*

AFFIDAVIT OF PLUGGING AND FILLING WELL

AFFIDAVIT SHOULD BE MADE IN TRIPLICATE. ONE COPY MADE TO THE REGISTRAR, ONE COPY TO BE KEPT BY THE WELL OPERATOR AND THE THIRD COPY (THIS COPY) SHALL BE KEPT BY THE OIL AND GAS DIVISION. THIS AFFIDAVIT SHALL BE FILED AT THE OFFICE OF THE REGISTRAR.

NAME OF WELL OPERATOR: _____
 ADDRESS OF WELL OPERATOR: _____
 COMPLETE ADDRESS: _____
 WELL AND LOCATION: _____
 COUNTY: _____
 ADDRESS: _____
 STATE INSPECTOR SUPERVISING PLUGGING: _____

AFFIDAVIT

STATE OF WEST VIRGINIA

I, _____, do hereby certify that _____ and _____ were employed by _____ and participated in the work of plugging and filling the above well, that said work was commenced on the _____ day of _____, 19____, and that the well was plugged and filled in the following manner:

FORMATION	CONTENTS	FROM	TO	SIZE OF PIPE	FEET IN	COAL BEAMS	DESCRIPTION OF MUDS

and the work of plugging and filling said well was completed on the _____ day of _____, 19____.

My commission expires _____

Notary Public



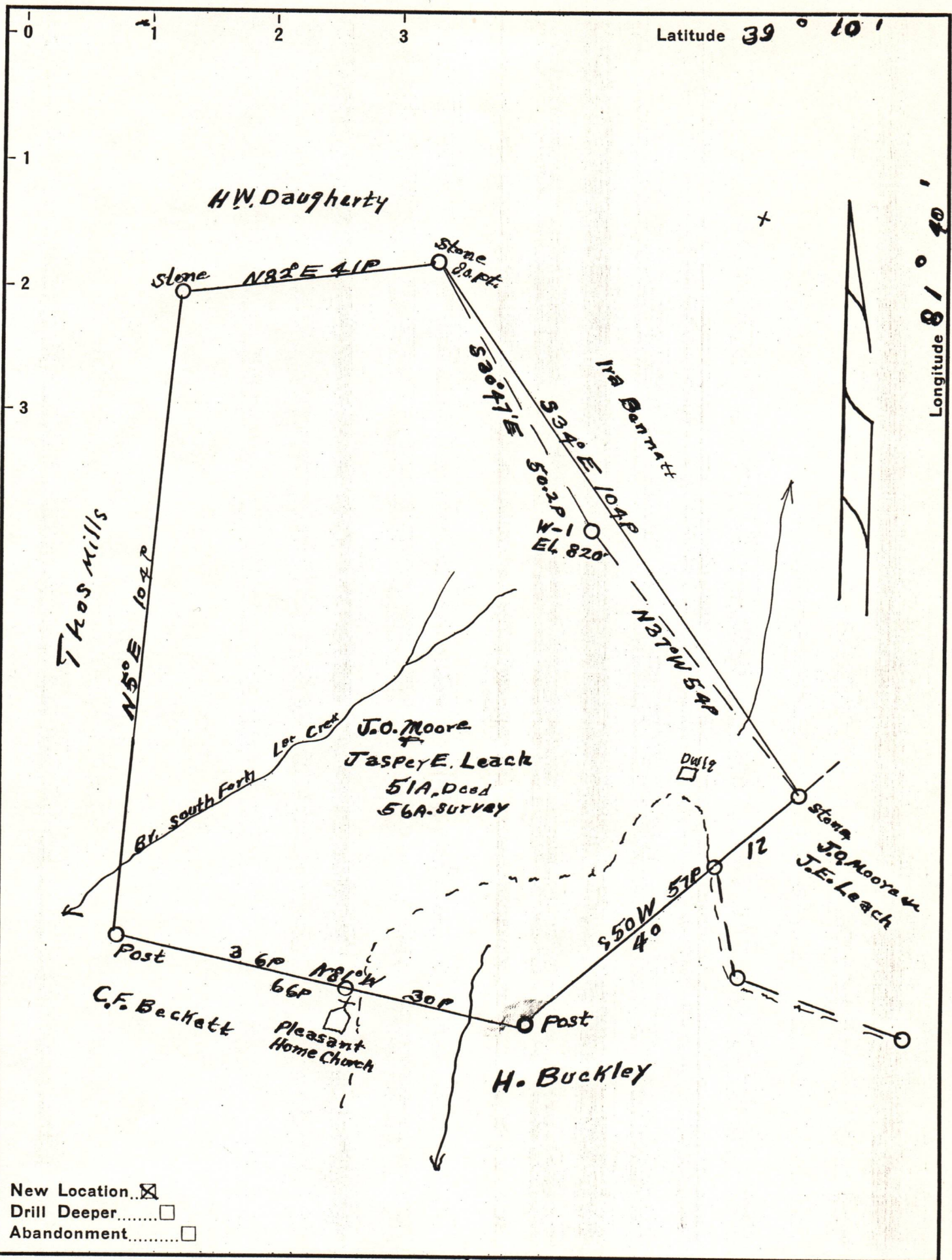

Company J.O. Moore - Jasper E. Leach

Address Parkersburg, W.Va.

Farm Moore & Leach

Tract 1 Acres 51 Lease No. _____

Well (Farm) No. 1 Serial No. _____

Elevation (Spirit Level) 820'

Quadrangle Belleville

County Wood District Harris

Engineer J.E. Anderson, Wood County

Engineer's Registration No. Surveyor

File No. _____ Drawing No. _____

Date Apr 23, 48 Scale 1 in = 20 Feet

STATE OF WEST VIRGINIA
DEPARTMENT OF MINES
OIL AND GAS DIVISION
CHARLESTON

WELL LOCATION MAP

FILE NO. W00-251 12/15/2023

+ Denotes location of well on United States Topographic Maps, scale 1 to 62,500, latitude and longitude lines being represented by border lines as shown.

- Denotes one inch spaces on border line of original tracing.