

NOTES:  
 This Map Is For Well Location Only & Does Not Represent A Complete Property Survey.

(+) DENOTES LOCATION OF WELL ON UNITED STATES TOPOGRAPHIC MAPS (7 1/2")

FILE NO. \_\_\_\_\_  
 DRAWING NO. 7238  
 SCALE 1" = 400'  
 MINIMUM DEGREE OF ACCURACY 1/200  
 PROVEN SOURCE OF ELEVATION EXISTING WELL  
Pad

I THE UNDERSIGNED, HEREBY CERTIFY THAT THIS PLAT IS CORRECT TO THE BEST OF MY KNOWLEDGE AND BELIEF AND SHOWS ALL THE INFORMATION REQUIRED BY LAW AND THE REGULATIONS ISSUED AND PRESCRIBED BY THE DEPARTMENT OF ENERGY.

(SIGNED) Edith [Signature]  
 R.P.E. 9936 L.L.S. 798

PLACE SEAL HERE

STATE OF WEST VIRGINIA  
 DIVISION OF ENVIRONMENTAL PROTECTION  
 SECTION OF OIL & GAS

DATE May 18, 1998  
 OPERATOR'S WELL NO. 7238  
 API WELL NO. 47 107 00322-7  
 STATE 47 COUNTY 107 PERMIT 00322-7

WELL TYPE: OIL  GAS  LIQUID INJECTION  WASTE DISPOSAL   
 (IF "GAS,") PRODUCTION  STORAGE  DEEP  SHALLOW

LOCATION: ELEVATION 788 WATER SHED Tygart Creek  
 DISTRICT Steele COUNTY Wood  
 QUADRANGLE Rockport, WV COORDINATES LAT: 39°04'00" LONG: 81°33'04"

SURFACE OWNER Columbia Gas Transmission Corporation ACREAGE 37.77  
 OIL & GAS ROYALTY OWNER Cabot Oil Company LEASE ACREAGE 98.75  
 COAL OWNER Columbia Gas Transmission Corporation LEASE NO. 1051823

PROPOSED WORK: DRILL  CONVERT  DRILL DEEPER  REDRILL  FRACTURE OR STIMULATE  PLUG OFF OLD FORMATION  PERFORATE NEW FORMATION  OTHER PHYSICAL CHANGE IN WELL (SPECIFY) Storage Recondition

PLUG AND ABANDON  CLEAN OUT AND REPLUG

TARGET FORMATION Oriskany ESTIMATED DEPTH 5024

WELL OPERATOR COLUMBIA GAS TRANSMISSION CORP DESIGNATED AGENT Richard L. Coly  
 ADDRESS PO Box 1273, Charleston, WV 25325-1273 ADDRESS PO Box 1273, Charleston, WV 25325-1273

WOOD COUNTY NAME  
 PERMIT 00322

DEEP well

4

P

Latitude 39 05

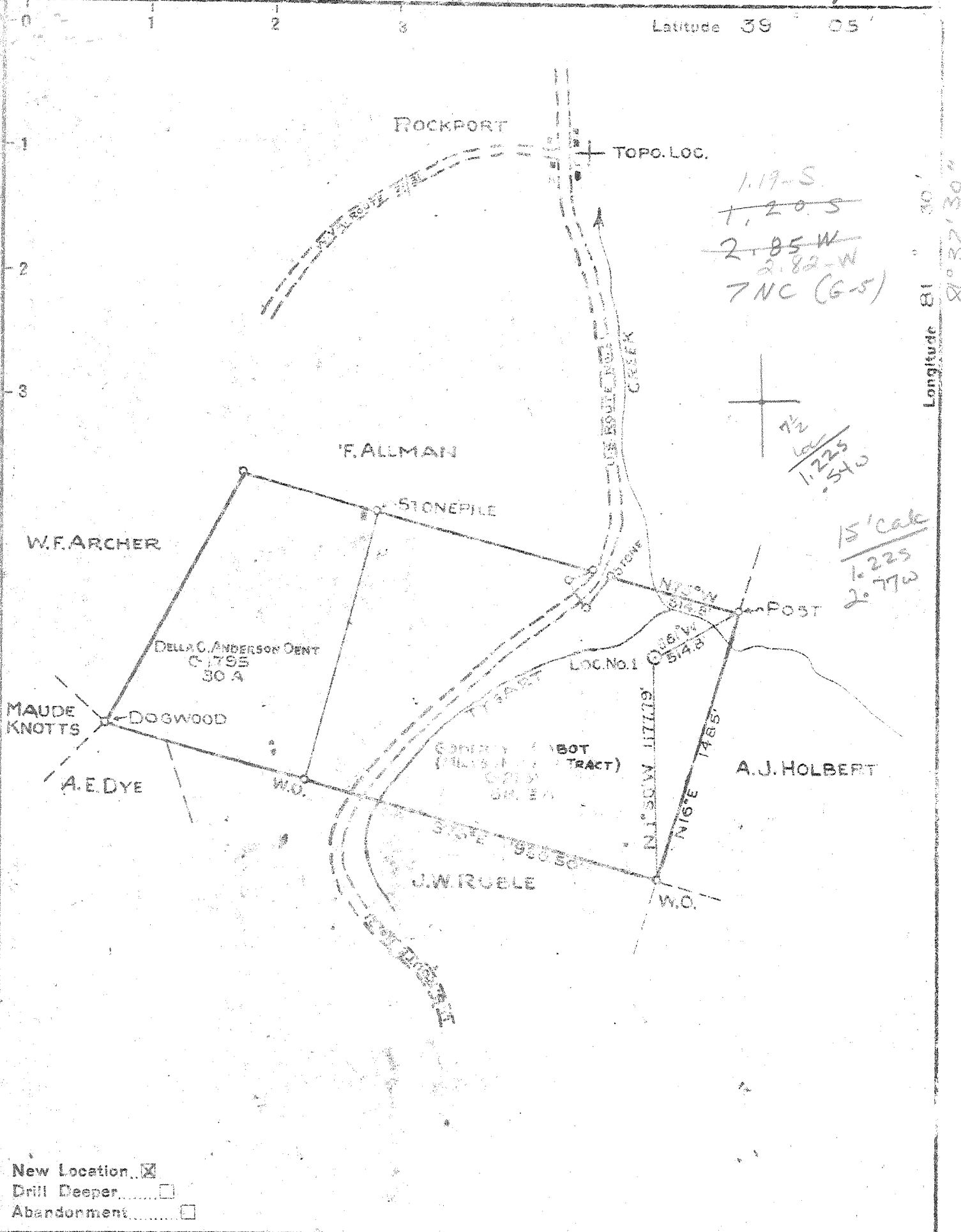

Company COLUMBIAN CARLON COMPANY  
 Address Box 373 CHARLESTON W. VA.  
 Farm GODFREY L. CABOT (MILTON MCLANE TRACT)  
 Tract Acres 93.25 Lease No. 2169  
 Well (Farm) No. 1 Serial no. SW1148  
 Elevation (Spirit Level) 789.35  
 Quadrangle BELLEVILLE T. SE 3120 W 222  
 County WOOD District STEELE  
 Engineer R. B. Anderson  
 Engineer's Registration No. 2074  
 File No. W-650 Ord. No. W-650  
 Date MAY 5 1930 Scale 1" = 650'

STATE OF WEST VIRGINIA  
 DEPARTMENT OF MINES  
 OIL AND GAS DIVISION  
 CHARLESTON

WELL LOCATION MAP  
 FILE NO. W-650-322-1

+ Denotes location of well on United States Topographic Maps, scale 1 to 62,500, latitude and longitude lines being represented by border lines as shown  
 - Denotes one inch spaces on border line of original tracing.

Samples 5-K (0-5028) 5-6-279 Deep Well

WEST VIRGINIA DEPARTMENT OF MINES  
OIL & GAS DIVISION  
W E L L R E C O R D

Permit No. Woo-322  
Belleville Quad.

Gas Well

CASING & TUBING

Company	Columbian Carbon Co.	16"	24"	24"
Address	Box 873, Charleston, 23, W. Va.	13-3/8	765'9"	Pulled
Farm	G. L. Cabot, Inc. (Milton McLane #1) Acres 98.75	10-3/4	1333'7"	Pulled
Location	Tygart Creek	8-1/4	2153'11"	Pulled
Well No.	1- GW-1148 Elev. 788.35.0	6-5/8	4953'7"	4953'7"
District	Steele County Wood	2-3/8	5048'2"	5048'2"
Surface	Hallie M. Gessell			
Mineral	Hallie M. Gessell et al			
Commenced	5/16/50			Midget Bottom Hole Packer
completed	8/8/50			6-5/8"
Not Shot				Set 4927' SLM
Open Flow	24/10ths Merc. in 7" 23#			Coal at 960 feet 24 inches
Volume	7,715,000 c.f.			
Rock Pressure	1025 lbs. 48 hrs.			
Salt water	1280' 1500' 1735' 1770'			

Top Soil	0	14	Sand	1408	1430
Slate & Red Rock	14	90	Slate & Shells	1430	1478
Blue Lime	90	150	Sand	1478	1530
Red Rock	150	207	Slate & Shells	1530	1648
Blue Lime	207	236	Sand	1648	1971
Red Rock & Slate	236	341	Lime	1971	2190
Blue Lime	341	371	Slate & Shells	2190	3858 Gas show 3732
Red Rock	371	415	Brown Shale	3858	3955
Sand	415	442	White Slate	3955	4037
Blue Lime	442	460	Brown Shale	4037	4179
Sand	460	476	White Slate	4179	4454
Red Rock	476	489	Slate & Shells	4454	4598
Lime	489	511	Brown Shale	4598	4890' DLM
Red Rock	511	533			4898' SLM
Lime	533	569	Black Lime	4890' DLM	
Red Lime	569	586		4898' SLM	4912' SLM
Slate	586	614	✓ Corniferous Lime	4912 SLM	5026' DLM
Sand & Slate	614	751	4919' DLM-4927' SLM		
Sandy Lime	751	761			5015' SLM
Sand & Slate	761	800	✓ Oriskany Sand	5026' DLM	
Red Rock	800	913	5015' SLM-5026'	5015' SLM	5024'
Slate	913	960	DLM		
Coal	960	962	Total Depth		5024'
Slate	962	970			(475)
Red Rock	970	986	Gas Pay:		
Sand	986	1009			
Slate	1009	1015	5017-24' 26/10 M.7" 23# -		8,029 M
Red Rock	1015	1032			
Slate & Shells	1032	1141			
Sand	1141	1224			
Lime	1224	1262			
Sand & Slate	1262	1375			
Slate & Shells	1375	1408			

Casing Record

5/27/50 13-3/8" casing. Ran 19 bags of Aquagel. No circulation or returns.  
Columbian Carbon Co. Crew

6/5/50 10-3/4" casing. Ran 24 bags of Aquagel. Circulation and returns.  
Columbian Carbon Co. Crew

6/22/50 8-5/8" casing. Ran 25 bags of Aquagel. Circulation and returns.  
Columbian Carbon Co. Crew

7/29/50 6-5/8" casing. Ran 60 bags of Aquagel. Pipe floated in. Columbian  
Carbon Co. Crew

WR-35

09-Sep-98

API # 47-107-00322 F

State of West Virginia  
Division of Environmental Protection  
Section of Oil and Gas

Reviewed [Signature]

Well Operator's Report of Well Work

Farm name: COLUMBIA GAS TRANSMISSION Operator Well No.: 7238

LOCATION: Elevation: 788.00 Quadrangle: ROCKPORT

District: STEELE County: WOOD  
Latitude: 6400 Feet South of 39 Deg. 5 Min. 0 Sec.  
Longitude 2950 Feet West of 81 Deg. 32 Min. 30 Sec.

Company: COLUMBIA GAS TRANSMISSION  
P. O. BOX 1273  
CHARLESTON, WV 25325-1273

Agent: RICHARD L. COTY

Inspector: GLEN ROBINSON  
Permit Issued: 09/09/98  
Well work Commenced: 10/01/98  
Well work Completed: 10/15/98  
Verbal Plugging  
Permission granted on: \_\_\_\_\_  
Rotary Cable Rig  
Total Depth (feet) 5054'  
Fresh water depths (ft) N/A  
Salt water depths (ft) N/A

Casing & Tubing Size	Used in Drilling	Left in Well	Cement Fill Up Cu. Ft.
16"		24'	
7"		4955'	
3-1/2"		5024'	420 sx

Is coal being mined in area (Y/N)? N  
Coal Depths (ft): N/A

OPEN FLOW DATA

Producing formation Oriskany Storage Pay zone depth (ft) 5015' - 5024'  
 Gas: Initial open flow N/A MCF/d Oil: Initial open flow N/A Bbl/d  
 Final open flow N/A MCF/d Final open flow N/A Bbl/d  
 Time of open flow between initial and final tests N/A Hours  
 Static rock Pressure N/A psig (surface pressure) after N/A Hours

Second producing formation \_\_\_\_\_ Pay zone depth (ft) \_\_\_\_\_  
 Gas: Initial open flow \_\_\_\_\_ MCF/d Oil: Initial open flow \_\_\_\_\_ Bbl/d  
 Final open flow \_\_\_\_\_ MCF/d Final open flow \_\_\_\_\_ Bbl/d  
 Time of open flow between initial and final tests \_\_\_\_\_ Hours  
 Static rock Pressure \_\_\_\_\_ psig (surface pressure) after \_\_\_\_\_ Hours

NOTE: ON BACK OF THIS FORM PUT THE FOLLOWING: 1). DETAILS OF PERFORATED INTERVALS, FRACTURING OR STIMULATING, PHYSICAL CHANGE, ETC. 2). THE WELL LOG WHICH IS A SYSTEMATIC DETAILED GEOLOGICAL RECORD OF ALL FORMATIONS, INCLUDING COAL ENCOUNTERED BY THE WELLBORE.

RECEIVED  
Office of Oil & Gas  
Permitting

MAR 01 1999

WV Division of  
Environmental Protection

For: COLUMBIA GAS TRANSMISSION CORP.

By: [Signature]  
Date: 2/22/99

MAR 1 1999

WOOD 0322 F

10/15/98

Fractured Oriskany with N2 Assist Delta frac using 360 bbls of H2O, 83 mscf N2,  
13,600# 20/40 sand at 1 - 2 ppg.