



A-10

August 10, 1950

Mr. L. C. Horner  
2906 E. 7th Street  
Parkersburg, West Virginia

Dear Sir:

Enclosed is permit WOO-332 to drill Well  
No. 1 on the G. F. Stephens Farm, Walker District,  
Wood County.

Very truly yours,

Administrative Assistant  
OIL AND GAS DIVISION

GSH:K  
Encl-2

CC: Inspector O. G. Howard

12/15/2023

A-11

September 12, 1950

Mr. L. C. Horner  
2906 E. 7th Street  
Parkersburg, West Virginia

Dear Sir:

We are in receipt of your letter of September 11th and one copy of well log for location No. 1 on the C. F. Stephens Farm, Walker District, Wood County, requesting permit to abandon the well.

It will be necessary to file an additional copy of the well log and three application to plug and abandon the well before permit can be issued.

Blanks are enclosed.

Very truly yours,

Administrative Assistant  
OIL AND GAS DIVISION

MD:g  
encl

cc: O. C. Howard, Inspector

12/15/2023

B-1 Elizabeth



STATE OF WEST VIRGINIA  
DEPARTMENT OF MINES  
OIL AND GAS DIVISION

WELL RECORD

Permit No. W00-332

Oil or Gas Well Dry  
(KIND)

Company L. C. HORNER  
Address 2906 E. 7th Street - Parkersburg  
Farm C. F. Stephens Acres \_\_\_\_\_  
Location (waters) Walker Creek  
Well No. One Elev. \_\_\_\_\_  
District Walker County Wood  
The surface of tract is owned in fee by C. F. Stephens  
Address Walker, W.Va.  
Mineral rights are owned by C. F. Stephens  
Address Walker, W.Va.  
Drilling commenced August 13th, 1950  
Drilling completed September 11th, 1950  
Date Shot \_\_\_\_\_ From \_\_\_\_\_ To \_\_\_\_\_  
With \_\_\_\_\_  
Open Flow \_\_\_\_\_ /10ths Water in \_\_\_\_\_ Inch  
\_\_\_\_\_ /10ths Merc. in \_\_\_\_\_ Inch  
Volume \_\_\_\_\_ Cu. Ft.  
Rock Pressure \_\_\_\_\_ lbs. \_\_\_\_\_ hrs.  
Oil \_\_\_\_\_ bbls., 1st 24 hrs.  
Fresh water (7 Bailers) 50 feet \_\_\_\_\_ feet  
Salt water 890 feet 950 feet

Casing and Tubing	Used in Drilling	Left in Well	Packers
Size			Kind of Packer
16			
13			
10			Size of
8 1/4	203 ft	203 ft	Depth set
6 5/8	750 ft	750 ft	
5 3/16			
3			Perf. top
2			Perf. bottom
Liners Used			Perf. top
			Perf. bottom

CASING CEMENTED \_\_\_\_\_ SIZE \_\_\_\_\_ No. Ft. \_\_\_\_\_ Date \_\_\_\_\_  
COAL WAS ENCOUNTERED AT \_\_\_\_\_ FEET \_\_\_\_\_ INCHES  
\_\_\_\_\_ FEET \_\_\_\_\_ INCHES FEET \_\_\_\_\_ INCHES  
\_\_\_\_\_ FEET \_\_\_\_\_ INCHES FEET \_\_\_\_\_ INCHES

Formation	Color	Hard or Soft	Top	Bottom	Oil, Gas or Water	Depth Found	Remarks
Soil			0	25			
Slate & Lime			25	75			
Red Shale			75	97			
Slate & Lime			97	115			
Sand		Hard	115	127			
Red Shale			127	138			
Slate & Shells			138	145			
Red Shale			145	165			
Slate			165	195			
Sandy Lime			195	215			
Red Rock			215	245			
Slate & Shells			245	266			
Red Shale			266	295			
Sand		Hard	295	320			
Slate & Lime			320	332			
Lime			332	360			
Slate			360	370			
Sand			370	392			
Slate & Lime			392	428			
Red Shale			428	444			
Lime	Blue	Hard	444	453			
Sand			453	468			
Slate & Shells			468	486			
Red Shale			486	495			
Lime		Hard	495	506			
Slate			506	517			
Lime	Brown	Hard	517	535			
Red Shale			535	575			Cave
Sand		Hard	575	583			
Red Shale			583	631			Cave
Lime	Blue		631	654			
Red Shale			654	682			
Lime			682	693			
Slate			693	703			
Red Shale			703	735			
Slate & Shells			735	761			
Pink Rock			761	775			
Lime	Blue	Hard	775	784			



12/15/2023

B-2

Formation	Color	Hard or Soft	Top	Bottom	Oil, Gas or Water	Depth Found	Remarks
Slate & Pink rock			784	803			
Sandy Lime	Blue		803	812			
Slate			812	822			
Lime	Black	Hard	822	838			
Shale	Black		838	856			
Lime	Blue		856	863			
Slate & Lime			863	888			
Sandy Lime	Blue		888	899			
Shale	Pink		899	905			
Sandy Lime	Blue		905	924			
Sand	White		924	971			
Slate			971	976	(Total Depth)		2nd Cow Run

12/15/2023

Date Sept 11, 1950

APPROVED [Signature], Owner

By \_\_\_\_\_ (Title)



STATE OF WEST VIRGINIA  
DEPARTMENT OF MINES  
OIL AND GAS DIVISION

INSPECTOR'S WELL REPORT

Permit No. \_\_\_\_\_

Oil or Gas Well \_\_\_\_\_  
(KIND)

	CASING AND TUBING	USED IN DRILLING	LEFT IN WELL	PACKERS
Company _____	Size			
Address _____	16			Kind of Packer _____
Farm _____	13			
Well No. _____	10			Size of _____
District _____ County _____	8 1/4			
Drilling commenced _____	6 5/8			Depth set _____
Drilling completed _____ Total depth _____	5 3/16			
Date shot _____ Depth of shot _____	3			Perf. top _____
Initial open flow _____ /10ths Water in _____ Inch	2			Perf. bottom _____
Open flow after tubing _____ /10ths Merc. in _____ Inch	Liners Used			Perf. top _____
Volume _____ Cu. Ft.				Perf. bottom _____
Rock pressure _____ lbs. _____ hrs.	CASING CEMENTED _____ SIZE _____ No. FT. _____ Date _____			
Oil _____ bbls., 1st 24 hrs.	COAL WAS ENCOUNTERED AT _____ FEET _____ INCHES			
Fresh water _____ feet _____ feet	_____ FEET _____ INCHES _____ FEET _____ INCHES			
Salt water _____ feet _____ feet	_____ FEET _____ INCHES _____ FEET _____ INCHES			

Drillers' Names \_\_\_\_\_

Remarks:

DATE

DISTRICT WELL INSPECTOR

12/15/2023

B-4

STATE OF WEST VIRGINIA  
DEPARTMENT OF MINES  
OIL AND GAS DIVISION

INSPECTOR'S PLUGGING REPORT

Permit No. Woo 332 Well No. 1

COMPANY L & H Home ADDRESS Parkersburg W Va

FARM W. Stephens DISTRICT Walker COUNTY Wood

Filling Material Used Clay and cement

Liner Location Amount Packer Location

PLUGS USED AND DEPTH PLACED			BRIDGES	CASING AND TUBING		
CEMENT-THICKNESS	WOOD-SIZE	LEAD	CONSTRUCTION-LOCATION	RECOVERED	SIZE	LOST
	<u>Clay</u>		<u>916 - 920</u>			
<u>10'</u>	<u>5" stave</u>		<u>920 - 905</u>			
	<u>Clay</u>		<u>905 - 770</u>			
<u>10'</u>	<u>5" stave</u>		<u>770 - 755</u>			
	<u>Ready to full 6 7/8" casing</u>					

Drillers' Names L H Moore G A Moore

Remarks:

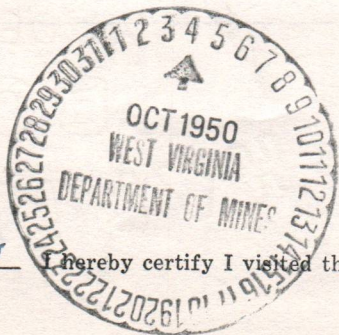

9/25-1948  
DATE

I hereby certify I visited the above well on this date.

Albert Howard

DISTRICT WELL INSPECTOR

12/15/2023



STATE OF WEST VIRGINIA  
DEPARTMENT OF MINES  
OIL AND GAS DIVISION

## INSPECTOR'S WELL REPORT

Permit No. \_\_\_\_\_

Oil or Gas Well \_\_\_\_\_  
(KIND)

	CASING AND TUBING	USED IN DRILLING	LEFT IN WELL	PACKERS
Company _____				
Address _____	Size			
Farm _____	16'			Kind of Packer _____
Well No. _____	13			
District _____ County _____	10			Size of _____
Drilling commenced _____	8 1/4			
Drilling completed _____ Total depth _____	6 5/8			Depth set _____
Date shot _____ Depth of shot _____	5 3/16			
Initial open flow _____ /10ths Water in _____ Inch	3			Perf. top _____
Open flow after tubing _____ /10ths Merc. in _____ Inch	2			Perf. bottom _____
Volume _____ Cu. Ft.	Liners Used			Perf. top _____
Rock pressure _____ lbs. _____ hrs.				Perf. bottom _____
Oil _____ bbls., 1st 24 hrs.	CASING CEMENTED _____ SIZE _____ No. FT. _____ Date _____			
Fresh water _____ feet _____ feet	COAL WAS ENCOUNTERED AT _____ FEET _____ INCHES			
Salt water _____ feet _____ feet	_____ FEET _____ INCHES _____ FEET _____ INCHES			
	_____ FEET _____ INCHES _____ FEET _____ INCHES			

Drillers' Names \_\_\_\_\_

Remarks:

DATE \_\_\_\_\_

DISTRICT WELL INSPECTOR

12/15/2023



STATE OF WEST VIRGINIA  
DEPARTMENT OF MINES  
OIL AND GAS DIVISION

INSPECTOR'S WELL REPORT

Permit No. \_\_\_\_\_

Oil or Gas Well \_\_\_\_\_  
(KIND)

	CASING AND TUBING	USED IN DRILLING	LEFT IN WELL	PACKERS
Company _____	Size			
Address _____	16			Kind of Packer _____
Farm _____	13			
Well No. _____	10			Size of _____
District _____ County _____	8 1/4			
Drilling commenced _____	6 5/8			Depth set _____
Drilling completed _____ Total depth _____	5 3/16			
Date shot _____ Depth of shot _____	3			Perf. top _____
Initial open flow _____ /10ths Water in _____ Inch	2			Perf. bottom _____
Open flow after tubing _____ /10ths Merc. in _____ Inch	Liners Used			Perf. top _____
Volume _____ Cu. Ft.				Perf. bottom _____
Rock pressure _____ lbs. _____ hrs.	CASING CEMENTED _____ SIZE _____ No. FT. _____ Date _____			
Oil _____ bbls., 1st 24 hrs.	COAL WAS ENCOUNTERED AT _____ FEET _____ INCHES			
Fresh water _____ feet _____ feet	_____ FEET _____ INCHES _____ FEET _____ INCHES			
Salt water _____ feet _____ feet	_____ FEET _____ INCHES _____ FEET _____ INCHES			

Drillers' Names \_\_\_\_\_

Remarks: \_\_\_\_\_

DATE

DISTRICT WELL INSPECTOR

12/15/2023

B-8



STATE OF WEST VIRGINIA  
DEPARTMENT OF MINES  
OIL AND GAS DIVISION

NOTICE OF INTENTION TO PLUG AND ABANDON WELL  
(REQUIRED BY SECTION 9, ARTICLE 4, CHAPTER 22 OF THE CODE)

To THE DEPARTMENT OF MINES,  
Charleston, W. Va.

No Coal Coal Operator or Coal Owner

L. C. Horner Name of Well Operator

2906-7th Street

Parkersburg, W. Va. Complete Address

September 13, 1950

Coal Operator or Coal Owner

Walker District

Address

Wood County

Lease or Property Owner

Well No. I

Address C. F. Stephens Farm

NOTIFY INSPECTOR O. C. HOWARD - GRANTSVILLE - TELEPHONE 108  
24 HOURS IN ADVANCE OF PLUGGING DATE

Gentlemen:—

The undersigned well operator is about to abandon the above described well and will commence

the work of plugging and abandoning said well on the 21 day of September, 1950,  
(which date shall not be less than five days after the day on which this notice so mailed is received,  
or in due course should be received by the Department of Mines.)

This notice is given you in order that your respective representatives may be present at the  
plugging and filling of said well. You are further notified that whether you are represented or not  
represented the undersigned will proceed on that date, or shortly thereafter, to plug and fill said  
well in the manner required by Section 10, Article 4, Chapter 22 of the Code and given in detail on the  
reverse side of this notice, in "Work Order."

This notice is being mailed by registered mail to each of you at the above addresses on the above  
date.

Very truly yours,

Well Operator.

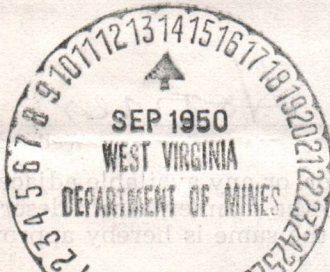

NOTE: Upon the abandonment of all wells drilled prior to June 1, 1929, a plat prepared by a competent  
engineer, showing the district and county in which the tract of land is located, the name and acreage of same,  
the names of the owners and adjacent tracts, and the location of the about to be abandoned well, determined by  
survey, and the courses and distances of such well from two permanent points or landmarks on said tract, shall  
be submitted with this notice.

12/15/2023

(Over)

PROPOSED MANNER OF PLUGGING AND FILLING WELL

(REQUIRED BY RULES AND REGULATIONS)

WEST VIRGINIA DEPARTMENT OF MINES

OIL AND GAS DIVISION

WORK ORDER

Well to be plugged and filled as follows:

Total depth---976 ft

8 $\frac{1}{4}$  Casing ---203 ft

6 5/8 Casing---750 ft

Fill with red clay 976 ft to 920ft.

Neat cement 920 ft to 910 ft.

5 ft crushed stone on cement plug, sealing off Second Cow Run Sand,

Fill with red clay 905 ft to 770 ft.

Neat cement 770 ft to 760 ft.

5 ft crushed stone on cement plug, thus sealing hole below 6 5/8 casing point.

Pull 2 joints 6 5/8 casing

Fill with red clay 755 ft to 745 ft

Neat cement 745 ft to 735 ft

5 ft crushed stone on top of cement plug, thus sealing hole above 6 5/8 casing point.

Continue to fill hole as balance of 6 5/8 casing is pulled, to 203 ft

Sit permanent bridge at 203 ft

Pull 8 $\frac{1}{4}$  casing and fill to surface.

Set marker as directed in regulations of 1931.

To the Department of Mines  
Coal Owner or Operator,  
Lease or Property Owner.

Gentlemen:

This "work order" is submitted for your approval and concurrence and unless notified of your disapproval or non-concurrence, the undersigned will proceed with the plugging and filling of said well in the above described manner on the date stated in the notice of intention to plug and abandon the said well on opposite side of this sheet.

Very truly yours,

*R. C. Horner*

Well Operator.

No objections have been filed by the coal owner or coal operator, or any available adjacent lease or property owners or interposed by the Department of Mines to the manner herein described for the plugging and filling of the well above mentioned. Therefore, the same is hereby approved this

14th day of September, 1950, 19

12/15/2023

DEPARTMENT OF MINES  
Oil and Gas Division

By: *C. H. Hall*

NOTE: This "work order" shall be filed in triplicate, one copy for the files of the Department of Mines; one to be approved or corrected and returned to the well operator as his authority for plugging said well; and one for the well inspector.

B-72  
FORM OG-8

STATE OF WEST VIRGINIA  
DEPARTMENT OF MINES  
OIL AND GAS DIVISION

AFFIDAVIT OF PLUGGING AND FILLING WELL

AFFIDAVIT SHOULD BE MADE IN TRIPLICATE, ONE COPY MAILED TO THE DEPARTMENT, ONE COPY TO BE RETAINED BY THE WELL OPERATOR AND THE THIRD COPY (AND EXTRA COPIES IF REQUIRED) SHOULD BE MAILED TO EACH COAL OPERATOR AT THEIR RESPECTIVE ADDRESSES.

No Coal

COAL OPERATOR OR OWNER: No Coal

ADDRESS: \_\_\_\_\_

COAL OPERATOR OR OWNER: L. C. Horner

NAME OF WELL OPERATOR: L. C. Horner

ADDRESS: 2906 - 7th Street  
Parkersburg, W. Va.

COMPLETE ADDRESS: \_\_\_\_\_

COAL OPERATOR OR OWNER: \_\_\_\_\_

ADDRESS: \_\_\_\_\_

COAL OPERATOR OR OWNER: \_\_\_\_\_

ADDRESS: \_\_\_\_\_

LEASE OR PROPERTY OWNER: \_\_\_\_\_

ADDRESS: \_\_\_\_\_

WELL AND LOCATION: September 27, 1950

WELL No. I

Walker District

Wood County

C. F. Stephens Farm

STATE INSPECTOR SUPERVISING PLUGGING: O. C. Howard

AFFIDAVIT

STATE OF WEST VIRGINIA,  
County of Wood } ss:

C. A. Moore and D. H. Moore  
being first duly sworn according to law depose and say that they are experienced in the work of plugging and filling oil and gas wells and were employed by L. C. Horner, well operator, and participated in the work of plugging and filling the above well, that said work was commenced on the 25 day of September, 19 50, and that the well was plugged and filled in the following manner:

SAND OR ZONE RECORD	FILLING MATERIAL			PLUGS USED	CASING	
	FORMATION	CONTENT	FROM TO		SIZE & KIND	CSG PULLED
2nd Cow Run Sand	Red Clay	976	920			
	Neat Cement	920	910			
	Crushed Stone	910	905	10	10	none
	Red Clay	905	770	8	203	none
	Neat Cement	770	760	6	751	none
	Crushed Stone	760	755			
	Red Clay	755	745			
	Neat Cement	745	735			
	Crushed Stone	735	730			
	Red Clay	730	203			
	Red Clay to Surface			Permanent bridge at 203		
COAL SEAMS				DESCRIPTION OF MONUMENT		
(NAME)				C.F. Stephens No. 1		
(NAME)				Permit W00-332-P		
(NAME)				L. C. Horner		
(NAME)				September 27, 1950		

and that the work of plugging and filling said well was completed on the 27th day of September, 19 50.

And further deponents saith not.

Sworn to and subscribed before me this 24th day of Oct., 19 50.

My commission expires: 12/15/2023

C. A. Moore  
D. H. Moore 12/15/2023  
O. C. Howard  
Notary Public.  
Permit No. W00-332-P

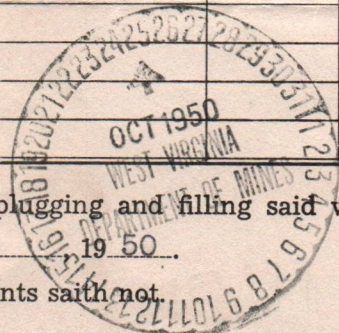
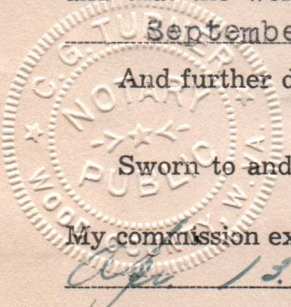

200 200  
 210 210  
 220 220  
 230 230  
 240 240  
 250 250  
 260 260  
 270 270  
 280 280  
 290 290  
 300 300  
 310 310  
 320 320  
 330 330  
 340 340  
 350 350  
 360 360  
 370 370  
 380 380  
 390 390  
 400 400  
 410 410  
 420 420  
 430 430  
 440 440  
 450 450  
 460 460  
 470 470  
 480 480  
 490 490  
 500 500

...  
 ...  
 ...  
 ...



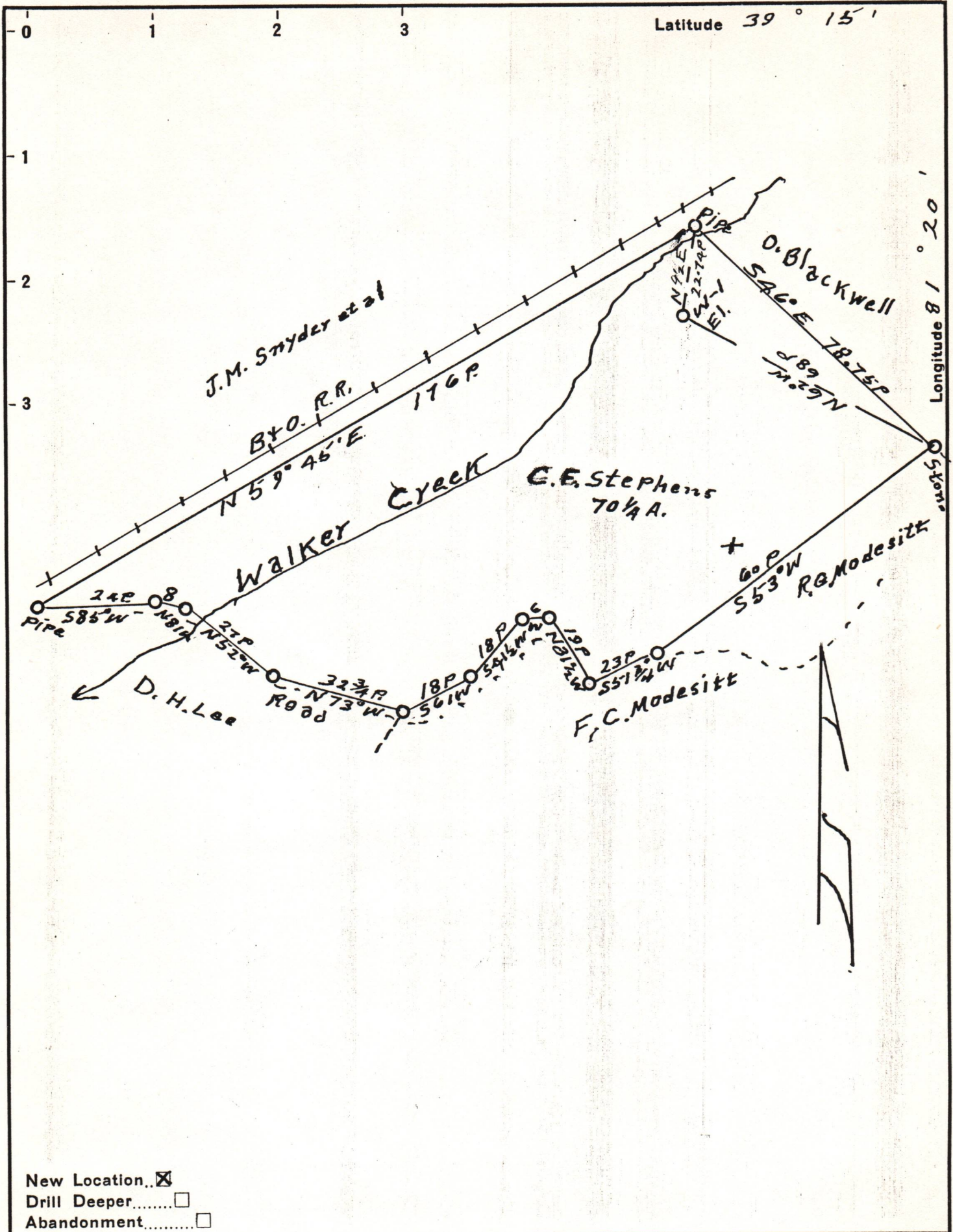

New Location..   
 Drill Deeper.....   
 Abandonment.....

Company L.C. HORNER  
 Address PARKERSBURG, W.Va.  
 Farm C.E. STEPHENS  
 Tract \_\_\_\_\_ Acres 70 1/4 Lease No. \_\_\_\_\_  
 Well (Farm) No. 1 Serial No. \_\_\_\_\_  
 Elevation (Spirit Level) 635'  
 Quadrangle ELIZABETH  
 County WOOD District WALKER  
 Engineer Robert R. Anderson  
BY SEA.  
 Engineer's Registration No. 296  
 File No. \_\_\_\_\_ Drawing No. \_\_\_\_\_  
 Date July 26, 1960 Scale 1 in = 30 Poles

STATE OF WEST VIRGINIA  
 DEPARTMENT OF MINES  
 OIL AND GAS DIVISION  
 CHARLESTON

WELL LOCATION MAP  
 FILE NO. WOOD-332

12/15/2023

+ Denotes location of well on United States Topographic Maps, scale 1 to 62,500, latitude and longitude lines being represented by border lines as shown.

- Denotes one inch spaces on border line of original tracing.