

0.50 S
3.8 W

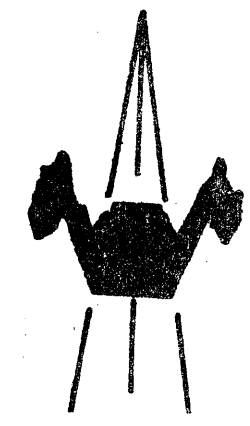

2560' SOUTH
3710' WEST

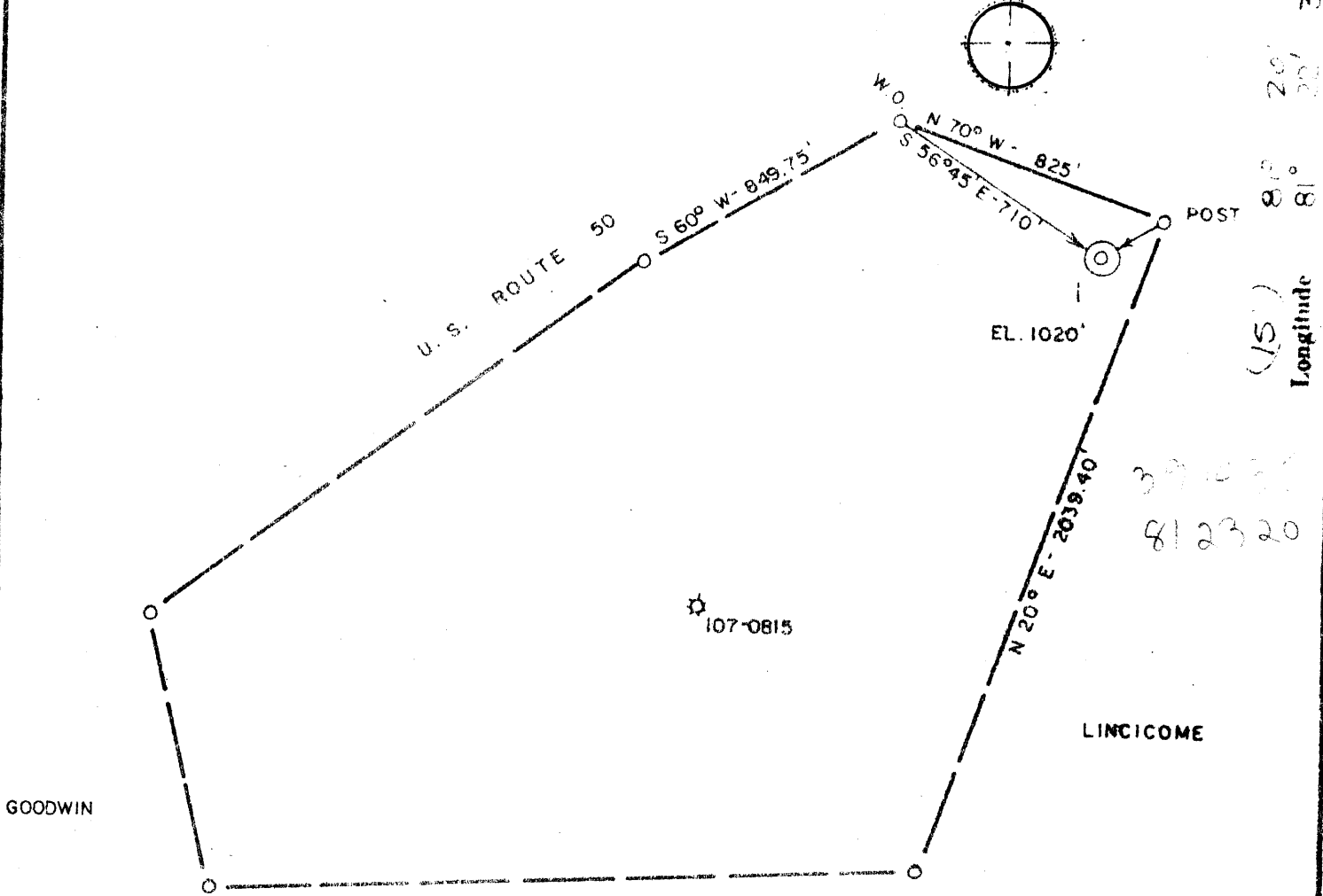

ACCURACY: 1' / 200'

- New Location
- Drill Deeper
- Abandonment
- Fracture
- Redrill
- Other

Formation BEREA
Est. Depth 2400'

Oil
Gas
Other

Source of Elevation DALLISON (692')
I, the undersigned, hereby certify that this map is correct to the best of my knowledge and belief and shows all the information required by paragraph 6 of the rules and regulations of the oil and gas section of the mining laws of West Virginia.

Chet Waterman

Company CLINT HURT & ASSOCIATES
 Address ELKVIEW, WV
 Surface Owner J. G. ROBINSON
 Mineral Owner " " "
 Well No. 1 Acres 100
 Elevation 1020' ELIZABETH NC
 Quadrangle KANAWHA Series 7.5'
 County WOOD District WALKER
 Date 7/29/80 Scale 1" = 500'

STATE OF WEST VIRGINIA
DEPARTMENT OF MINES
OIL AND GAS DIVISION
CHARLESTON

WELL LOCATION MAP
47 - 107 - 1071
STATE COUNTY PERMIT

+ Denotes location of well on United States Topographic Maps.
Engineer CHET WATERMAN
Engineer's Registration No. 3788 File No. 80-429



STATE OF WEST VIRGINIA
DEPARTMENT OF MINES
Oil and Gas Division
WELL RECORD

Quadrangle Little Kanawha
Permit No. 47-107-1071

Rotary XX Oil _____
Cable _____ Gas _____
Recycling _____ Comb. XX _____
Water Flood _____ Storage _____
Disposal _____ (Kind) _____

Company <u>Clint Hurt & Associates, Inc.</u>	Casing and Tubing	Used in Drilling	Left in Well	Cement fill up Cu. ft. (Sks.)
Address <u>P. O. Box 388; Elkview, W. Va.</u>	25071			
Farm <u>J. G. Robinson</u> Acres <u>100</u>	Size			
Location (waters) <u>Stillwell Creek</u>	20-16			
Well No. <u>#2</u> Elev. <u>1020'</u>	Cond.			
District <u>Walker</u> County <u>Wood</u>	13-10"			
The surface of tract is owned in fee by <u>J. G. Robinson</u>	9 5/8			
Address <u>Washington, D. C.</u>	8 5/8	279	279	To surface
Mineral rights are owned by <u>same</u>	7			
Address _____	5 1/2			
Drilling Commenced <u>10/30/80</u>	4 1/2 9.5# ERW		2471	125 sacks; 4% CaCl.
Drilling Completed <u>11/2/80</u>	3			
Initial open flow _____ cu. ft. show bbls.	2		2460	
Final production <u>125 M cu. ft</u> per day <u>2</u> bbls.	Liners Used			
Well open <u>6</u> hrs. before test <u>625</u> RP.				

Well treatment details: Attach copy of cementing record.
Perforated 12 holes 2381.5-2383.5; Fractured 11/17/80 w/30000#20/40 sand; 500 gallon 15% HCl; 28 gal Cla-Sta B; GBW-3 15#; 42 gal 15N; Breakdown 1200#; ISIP 800#; 15 min SIP 575#; Total Frac 635 BBL; Average Treating pressure 1795; Average rate 25.1 BPM.

Coal was encountered at None Feet _____ Inches
Fresh water _____ Feet _____ Salt Water _____ Feet _____
Producing Sand Berea Depth 2381

Formation	Color	Hard or Soft	Top Feet	Bottom Feet	Oil, Gas or Water	* Remarks
Surface			0	287		
Sand & Shale			287	425		
Shale			425	1025		
Sand & Shale			1025	2381		
<u>Berea</u>			2381	2386		
Shale			2386	2440		

RECEIVED
APR 16 1981
OIL & GAS DIVISION
DEPT. OF MINES

APR 28 1981



STATE OF WEST VIRGINIA
DEPARTMENT OF MINES

RECEIVED

SEP - 5 1980

Oil and Gas Division

OIL & GAS DIVISION
DEPT. OF MINES

OIL AND GAS WELL PERMIT APPLICATION

TO THE DEPARTMENT OF MINES,
Charleston, W. Va.

DATE 8/24/80

Surface Owner J. G. Robinson

Company Clint Hurt & Associates, Inc.

Address Washington, D. C.

Address P.O. Box 388, Elkview, W. Va. 25071

Mineral Owner J. G. Robinson

Farm J.G. Robinson Acres 100

Address Washington, D. C.

Location (waters) Lost Run

Coal Owner Same

Well No. 2 Elevation 1020'

Address _____

District Walker County Wood

Coal Operator Same

Quadrangle Kanawha

THIS PERMIT MUST BE POSTED AT THE WELL SITE
Address _____

All provisions being in accordance with Chapter 22, of the W. Va. Code, the location is hereby approved for drilling. This permit shall expire if operations have not commenced by 5-8-81.

INSPECTOR
TO BE NOTIFIED K. Paul Goodnight

ADDRESS Smithville, W. Va. 26178

PHONE 477-3660

J. G. Robinson
Deputy Director - Oil & Gas Division

GENTLEMEN:

The undersigned well operator is entitled to drill upon the above named farm or tract of land for oil and gas, having fee title thereto, (or as the case may be) under grant or lease dated August 9 1977 by J. G. Robinson made to North Hills Investment Co. and recorded on the 28 day of October 1977, in Wood County, Book 695 Page 534

xx NEW WELL _____ DRILL DEEPER _____ REDRILL _____ FRACTURE OR STIMULATE
_____ OIL AND GAS WELL ORIGINALLY DRILLED BEFORE JUNE 5, 1969.

The enclosed plat was prepared by a registered engineer or licensed land surveyor and all coal owners and/or operators have been notified as of the above date.

The above named coal owners and/or operator are hereby notified that any objection they wish to make, or are required to make by Section 3 of the Code, must be received by, or filed with the Department of Mines within ten (10) days. *

Copies of this notice and the enclosed plat were mailed by registered mail, or delivered to the above named coal operators or coal owners at their above shown respective address _____ day _____ before, or on the same day with the mailing or delivery of this copy to the Department of Mines at Charleston, West Virginia.

PLEASE SUBMIT COPIES OF ALL
GEOPHYSICAL LOGS DIRECTLY TO:

WEST VIRGINIA GEOLOGICAL AND
ECONOMIC SURVEY
P. O. BOX 879
MORGANTOWN, WEST VIRGINIA 26505
AC-304 - 292-6331

Address
of
Well Operator

Very truly yours, *Clint Hurt Associates, Inc*
(Sign Name) by David Buchanan
Well Operator

P. o. Box 388
Street
Elkview, W. Va. 25071
City or Town

State

*SECTION 3 If no objections are filed or found by the Department of mines, within said period of ten days from the receipt of notice and plat by the department of mines, to said proposed location, the department shall forthwith issue to the well operator a permit reciting the filing of such plat, that no objections have been made by the coal operators or found thereto by the department and that the same is approved and the well operator authorized to proceed.

BLANKET BOND

47-107-1071

PERMIT NUMBER

THIS IS AN ESTIMATE ONLY
ACTUAL INFORMATION WILL BE SUBMITTED ON OG-10 UPON COMPLETION

PROPOSED WORK ORDER TO xx DRILL _____ DEEPEN _____ FRACTURE-STIMULATE _____
 DRILLING CONTRACTOR: (If Known) RESPONSIBLE AGENT:
 NAME Clint Hurt & Associates NAME I. David Bartrem
 ADDRESS P. O. Box 388, Elkview, W. Va. 25071 ADDRESS P. O. Box 388, Elkview, W. Va. 25071
 TELEPHONE (304)344-2401 TELEPHONE (344-2401)
 ESTIMATED DEPTH OF COMPLETED WELL: 2450 ROTARY xx CABLE TOOLS _____
 PROPOSED GEOLOGICAL FORMATION: Berea Sand
 TYPE OF WELL: OIL _____ GAS _____ COMB. xx STORAGE _____ DISPOSAL _____
 RECYCLING _____ WATER FLOOD _____ OTHER _____

TENTATIVE CASING PROGRAM:

CASING AND TUBING SIZE	USED FOR DRILLING	LEFT IN WELL	CEMENT FILL UP OR SACKS - CUBIC FT.
20 - 16			
13 - 10			
9 - 5/8			
8 - 5/8	250	250	to surface
7			
5 1/2			
4 1/2	2450	2450	600' fillup
3			Perf. Top
2	2450	2450	Perf. Bottom
Liners			Perf. Top
Rods	2450	2450	Perf. Bottom

APPROXIMATE FRESH WATER DEPTHS _____ FEET 1800 SALT WATER _____ FEET
 APPROXIMATE COAL DEPTHS none
 IS COAL BEING MINED IN THE AREA? no BY WHOM? _____

TO DRILL:

SUBMIT FIVE (5) COPIES OF OG - 1, \$100.00 PERMIT FEE, PERFORMANCE BOND AND PERMANENT COPY OF PLAT.

TO DRILL DEEPER OR REDRILL:

SUBMIT FIVE (5) COPIES OF OG - 1, SHOWING ORIGINAL PERMIT NUMBER AND PERFORMANCE BOND. ON WELLS DRILLED PRIOR TO 1929, A PERMANENT COPY OF THE PLAT AND THE ORIGINAL WELL RECORD MUST ALSO BE SUBMITTED.

TO FRACTURE - STIMULATE:

OIL AND/OR GAS WELL ORIGINALLY DRILLED BEFORE JUNE 5, 1929, FIVE (5) COPIES OG - 1, PERFORMANCE BOND, PERMANENT PLAT AND ORIGINAL WELL RECORD.

OIL AND/OR GAS WELL ORIGINALLY DRILLED ON AND/OR AFTER JUNE 5, 1929, FIVE COPIES OG - 1, SHOWING ORIGINAL PERMIT NUMBER, AND PERFORMANCE BOND.

Required forms must be filed within ninety (90) days of completion for bond release. Inspector to be notified twenty-four (24) hours in advance.

The following waiver must be completed by the coal operator if the permit is to be issued within ten days of receipt thereof.

WAIVER: I the undersigned, Agent for _____ Coal Company, Owner or Operator of the coal under this lease have examined and place on our mine maps this proposed well location.

We the _____ Coal Company have no objections to said well being drilled at this location, providing operator has complied with all rules and regulations in Articles 4, 5, and 7, Chapter 22 of the West Virginia Code.

For Coal Company

Official Title