

Plot Cart. 000000

Latitude 39° 20' 00"

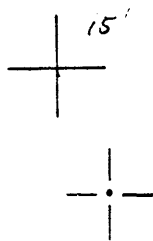

2030' SOUTH  
6720' WEST

Longitude 81° 22' 30"

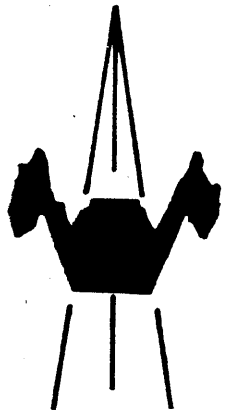
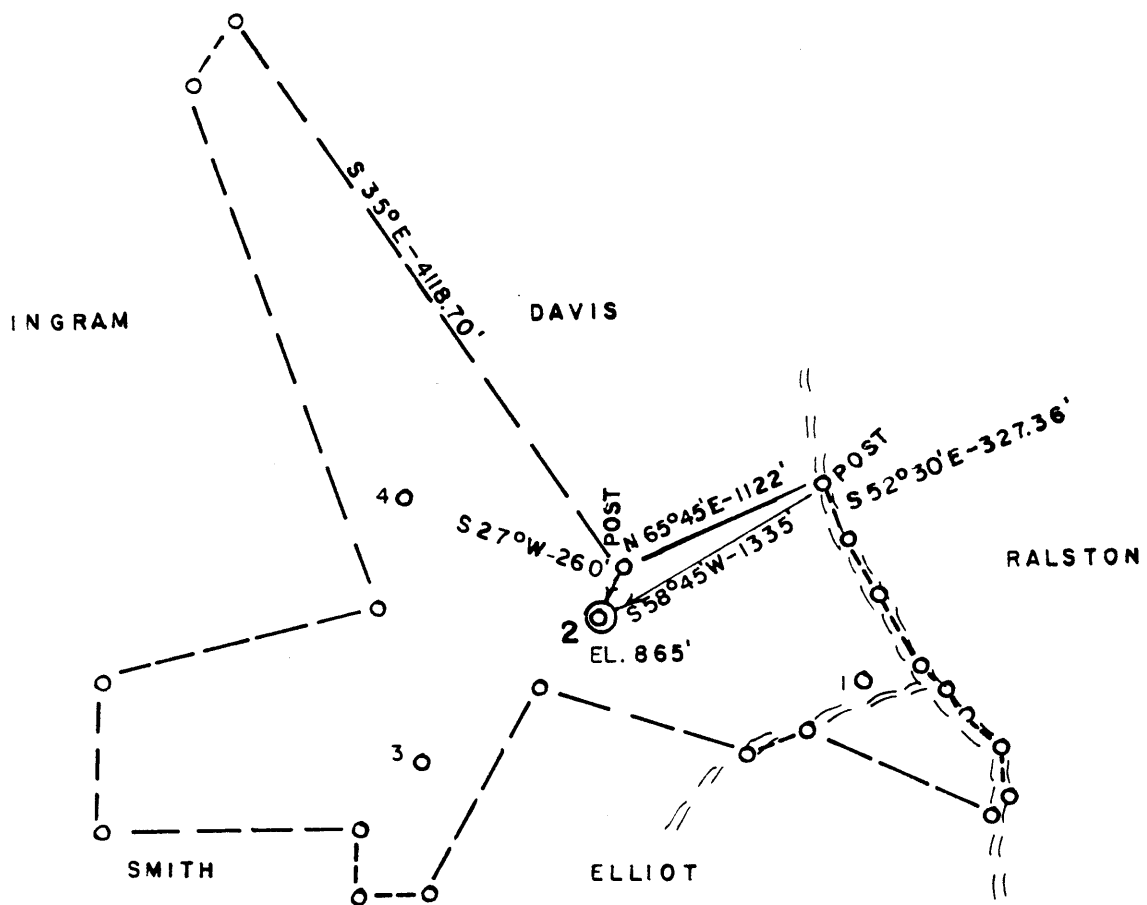

ACCURACY: 1 / 200

- New Location
- Drill Deeper
- Abandonment
- Fracture
- Redrill
- Other

Formation GORDON  
Est. Depth 2800'

Oil   
Gas   
Other

Source of Elevation ROUTE 2 (620')

I, the undersigned, hereby certify that this map is correct to the best of my knowledge and belief and shows all the information required by paragraph 10 of the rules and regulations of the oil and gas section of the mining laws of the State of West Virginia.

*Chet Waterman*

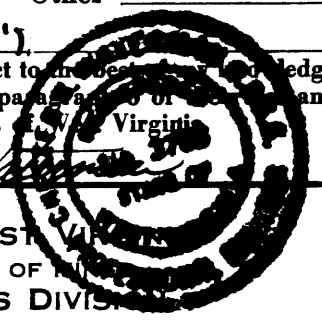

Company BEREA OIL & GAS CORP.  
Address CLARKSBURG, WV  
Surface Owner WILLIAM HIVELY  
Mineral Owner WILLIAM HIVELY

Well No. 2 Acres 104  
Elevation 865' *MT. 15'*  
Quadrangle VALLEY MILLS Series 7.5  
County WOOD District UNION  
Date 1/6/81 Scale 1" = 1000'

STATE OF WEST VIRGINIA  
DEPARTMENT OF MINERAL RESOURCES  
OIL AND GAS DIVISION  
CHARLESTON

WELL LOCATION MAP  
47 - 107 - 1136  
STATE COUNTY PERMIT

+ Denotes location of well on United States Topographic Maps.

Engineer CHET WATERMAN

Engineer's Registration No. 3788 File No. 81-005

*Con. called*  
MAR 12 1981

cl 1/22

Post Card CSD

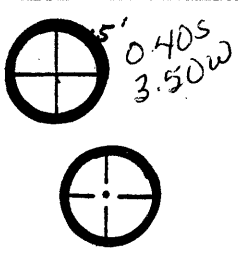

Latitude 39° 20' 00"

2030' SOUTH  
6720' WEST

Longitude 81° 20' 30"

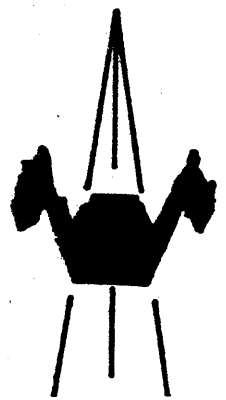
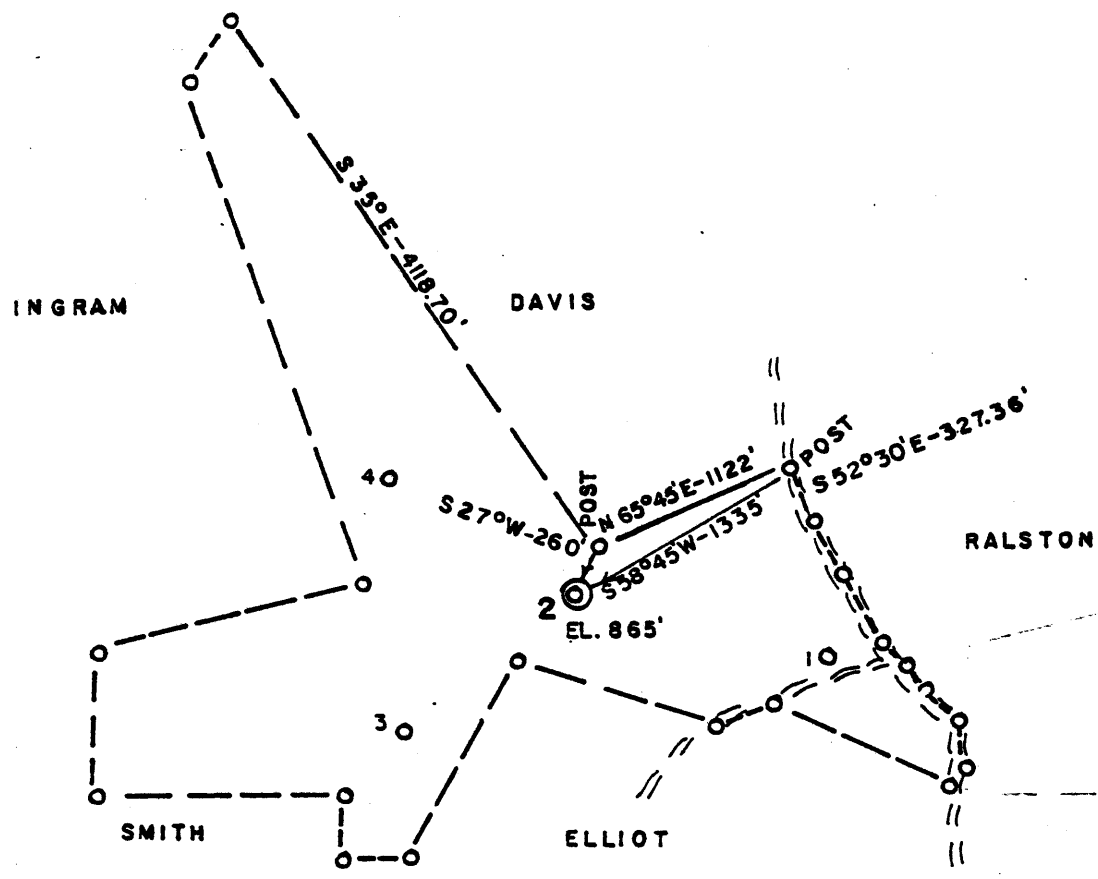

ACCURACY: 1 / 200

- New Location
- Drill Deeper
- Abandonment
- Fracture
- Redrill
- Other

Formation GORDON Oil   
 Est. Depth 2800' Gas   
 Other

Source of Elevation ROUTE 2 (620')  
 I, the undersigned, hereby certify that this map is correct to the best of my knowledge and belief and shows all the information required by paragraph 10 of the rules and regulations of the oil and gas section of the mining laws of West Virginia.

Company BEREA OIL & GAS CORP.  
 Address CLARKSBURG, WV  
 Surface Owner WILLIAM HIVELY  
 Mineral Owner WILLIAM HIVELY  
 Well No. 2 Acres 104  
 Elevation 865' MT. 15' SC  
 Quadrangle VALLEY MILLS Series 7.5  
 County WOOD District UNION  
 Date 1/6/81 Scale 1" = 1000'

STATE OF WEST VIRGINIA  
 DEPARTMENT OF MINES  
 OIL AND GAS DIVISION  
 CHARLESTON

WELL LOCATION MAP  
47 - 107 - 1136  
 STATE COUNTY PERMIT

+ Denotes location of well on United States Topographic Maps.  
 Engineer CHET WATERMAN  
 Engineer's Registration No. 3788 File No. 81-005

FEB 13 1981

STATE OF WEST VIRGINIA  
DEPARTMENT OF MINES

Oil and Gas Division

RECEIVED  
JAN 23 1981

OIL AND GAS WELL PERMIT APPLICATION  
OIL & GAS DIVISION  
DEPT. OF MINES

TO THE DEPARTMENT OF MINES,  
Charleston, W. Va.

DATE January 22, 1981  
Company Berea Oil and Gas Corporation  
Address 652 Empire Bank Bldg., Clarksburg, WV  
Farm W. Hively Acres 104 26301  
Location (waters) Carpenter Run  
Well No. 2 Elevation 865'  
District Union County Wood  
Quadrangle Valley Mills

Surface Owner William Hively  
Address Rt. 1, Box 281, Waverly, WV 26184  
Mineral Owner William Hively et ux & Wallace Patrick Malley  
Address Same  
Coal Owner William Hively et ux & Wallace Patrick Malley  
Address Same  
Coal Operator N/A  
Address \_\_\_\_\_

THIS PERMIT MUST BE POSTED AT THE WELL SITE

provisions being in accordance with Chapter 22, the W. Va. Code, the location is hereby approved for drilling. This permit shall expire if operations have not commenced by 9-26-81.

INSPECTOR  
TO BE NOTIFIED Paul Goodnight  
ADDRESS Smithville, WV 26178  
PHONE 304/477-3660

J. E. Murphy  
Deputy Director - Oil & Gas Division

GENTLEMEN:

The undersigned well operator is entitled to drill upon the above named farm or tract of land for oil and gas, having fee title thereto, (or in the case may be) under grant or lease dated November 21 19 80 by William H. Hively et ux made to Berea Oil & Gas Corp. and recorded on the 24th day of November 19 80 in Wood County, Book 748 Page 23

NEW WELL  DRILL DEEPER  REDRILL  FRACTURE OR STIMULATE  
OIL AND GAS WELL ORIGINALLY DRILLED BEFORE JUNE 5, 1969.

The enclosed plat was prepared by a registered engineer or licensed land surveyor and all coal owners and/or operators have been notified as of the above date.

The above named coal owners and/or operator are hereby notified that any objection they wish to make, or are required to make by section 3 of the Code, must be received by, or filed with the Department of Mines within ten (10) days. \*

Copies of this notice and the enclosed plat were mailed by registered mail, or delivered to the above named coal operators or coal owners at their above shown respective address \_\_\_\_\_ day \_\_\_\_\_ before, or on the same day with the mailing or delivery of this copy to the Department of Mines at Charleston, West Virginia.

PLEASE SUBMIT COPIES OF ALL GEOPHYSICAL LOGS DIRECTLY TO:

WEST VIRGINIA GEOLOGICAL AND ECONOMIC SURVEY  
P. O. BOX 879  
MORGANTOWN, WEST VIRGINIA 26505  
AC-304 - 292-6331

Very truly yours,  
(Sign Name) [Signature]  
Well Operator  
BEREA OIL AND GAS CORPORATION  
652 Empire Bank Bldg.  
Street  
Fourth and Main Streets  
Clarksburg  
City or Town  
West Virginia 26301  
State

Address  
of  
Well Operator

47-107-1136 PERMIT NUMBER

"I have read and understand the reclamation requirements as set forth in Chapter 22, Article 4 Section 12-b and will carry out the specified requirements."

Signed by \_\_\_\_\_

BLANKET BOND

[Signature]

**THIS IS AN ESTIMATE ONLY**  
**ACTUAL INFORMATION WILL BE SUBMITTED ON OG-10 UPON COMPLETION**

PROPOSED WORK ORDER TO XX DRILL \_\_\_\_\_ DEEPEN \_\_\_\_\_ FRACTURE STIMULATE \_\_\_\_\_  
 DRILLING CONTRACTOR: (If Known) \_\_\_\_\_ RESPONSIBLE AGENT: \_\_\_\_\_  
 NAME N/A \_\_\_\_\_ NAME Mark Schumacher \_\_\_\_\_  
 ADDRESS \_\_\_\_\_ ADDRESS 652 Empire Bank Bldg., Clarksburg, WV \_\_\_\_\_  
 TELEPHONE \_\_\_\_\_ TELEPHONE 304/624-6429 \_\_\_\_\_ 26301  
 ESTIMATED DEPTH OF COMPLETED WELL: 2800' \_\_\_\_\_ ROTARY XX CABLE TOOLS \_\_\_\_\_  
 PROPOSED GEOLOGICAL FORMATION: Gordon \_\_\_\_\_  
 TYPE OF WELL: OIL X GAS X COMB. X STORAGE \_\_\_\_\_ DISPOSAL \_\_\_\_\_  
 RECYCLING \_\_\_\_\_ WATER FLOOD \_\_\_\_\_ OTHER \_\_\_\_\_

TENTATIVE CASING PROGRAM:

| CASING AND TUBING SIZE | USED FOR DRILLING | LEFT IN WELL | CEMENT FILL UP OR SACKS - CUBIC FT. |
|------------------------|-------------------|--------------|-------------------------------------|
| 20 - 16                |                   |              |                                     |
| 13 - 10                |                   |              |                                     |
| 9 - 5,8                |                   |              |                                     |
| 8 - 5/8 <u>XX</u>      | <u>250'</u>       | <u>250'</u>  | <u>Surface</u>                      |
| 7                      |                   |              |                                     |
| 5 1/2                  |                   |              |                                     |
| 4 1/2 <u>XX</u>        | <u>T.D.</u>       | <u>T.D.</u>  | <u>400'</u>                         |
| 3                      |                   |              | Perf. Top                           |
| 2                      |                   |              | Perf. Bottom                        |
| Liners                 |                   |              | Perf. Top                           |
|                        |                   |              | Perf. Bottom                        |

APPROXIMATE FRESH WATER DEPTHS 150 FEET \_\_\_\_\_ SALT WATER 1500 FEET \_\_\_\_\_  
 APPROXIMATE COAL DEPTHS None \_\_\_\_\_  
 IS COAL BEING MINED IN THE AREA? No \_\_\_\_\_ BY WHOM? \_\_\_\_\_

TO DRILL:

SUBMIT FIVE (5) COPIES OF OG - 1, \$100.00 PERMIT FEE, PERFORMANCE BOND AND PERMANENT COPY OF PLAT.

TO DRILL DEEPER OR REDRILL:

SUBMIT FIVE (5) COPIES OF OG - 1, SHOWING ORIGINAL PERMIT NUMBER AND PERFORMANCE BOND. ON WELLS DRILLED PRIOR TO 1929, A PERMANENT COPY OF THE PLAT AND THE ORIGINAL WELL RECORD MUST ALSO BE SUBMITTED.

TO FRACTURE - STIMULATE:

OIL AND/OR GAS WELL ORIGINALLY DRILLED BEFORE JUNE 5, 1929, FIVE (5) COPIES OG - 1, PERFORMANCE BOND, PERMANENT PLAT AND ORIGINAL WELL RECORD.

OIL AND/OR GAS WELL ORIGINALLY DRILLED ON AND/OR AFTER JUNE 5, 1929, FIVE COPIES OG - 1, SHOWING ORIGINAL PERMIT NUMBER, AND PERFORMANCE BOND.

Required forms must be filed within ninety (90) days of completion for bond release. Inspector to be notified twenty-four (24) hours in advance.

The following waiver must be completed by the coal operator if the permit is to be issued within ten days of receipt thereof.

WAIVER: I the undersigned, Agent for \_\_\_\_\_ Coal Company, Owner or Operator of the coal under this lease have examined and place on our mine maps this proposed well location.

We the \_\_\_\_\_ Coal Company have no objections to said well being drilled at this location, providing operator has complied with all rules and regulations in Articles 4, 5, and 7, Chapter 22 of the West Virginia Code.

\_\_\_\_\_  
 For Coal Company

\_\_\_\_\_  
 Official Title