

FILE NO. 5-69
 DRAWING NO. _____
 SCALE 1" = 500'
 MINIMUM DEGREE OF ACCURACY 1:200
 PROVEN SOURCE OF ELEVATION INTER. OHIO RT. 124 AND GRAVEL RD. ELEV. = 594, 3,000' N.W. OF WELL

I THE UNDERSIGNED, HEREBY CERTIFY THAT THIS PLAT IS CORRECT TO THE BEST OF MY KNOWLEDGE AND BELIEF AND SHOWS ALL THE INFORMATION REQUIRED BY LAW AND THE REGULATIONS ISSUED AND PRESCRIBED BY THE DEPARTMENT OF MINES.
 (SIGNED) Vincent W. Wood
 R.P.E. _____ L.L.S. 664

PLACE SEAL HERE

STATE OF WEST VIRGINIA
 DEPARTMENT OF MINES
 OIL AND GAS DIVISION



DATE MARCH / 18, 19 83
 OPERATOR'S WELL NO. KEM 370
 API WELL NO. _____
47 - 107 - 1244
 STATE COUNTY PERMIT

(+) DENOTES LOCATION OF WELL ON UNITED STATES TOPOGRAPHIC MAPS
 WELL TYPE: OIL ___ GAS X LIQUID INJECTION ___ WASTE DISPOSAL ___
 (IF "GAS,") PRODUCTION X STORAGE ___ DEEP ___ SHALLOW X
 LOCATION: ELEVATION 692 WATER SHED OHIO RIVER
 DISTRICT HARRIS COUNTY WOOD
 QUADRANGLE LUBECK
 SURFACE OWNER ROGER D. GESSELL ACREAGE 48
 OIL & GAS ROYALTY OWNER ROGER D. GESSELL LEASE ACREAGE 48
 LEASE NO. 80-02-1254
 PROPOSED WORK: DRILL X CONVERT ___ DRILL DEEPER ___ REDRILL ___ FRACTURE OR STIMULATE ___ PLUG OFF OLD FORMATION ___ PERFORATE NEW FORMATION ___ OTHER PHYSICAL CHANGE IN WELL (SPECIFY) _____

CANCELLED

JAN 3 1984

PLUG AND ABANDON ___ CLEAN OUT AND REPLUG ___
 TARGET FORMATION DEVONIAN BROWN SHALE ESTIMATED DEPTH 4007'
 WELL OPERATOR KAISER EXPLOR. & MIN. CO. DESIGNATED AGENT KAISER EXPLORATION AND MINING CO.
 ADDRESS P.O. BOX 8 ADDRESS P.O. BOX 8
RAVENSWOOD, W.V. 26164 RAVENSWOOD, W.V. 26164

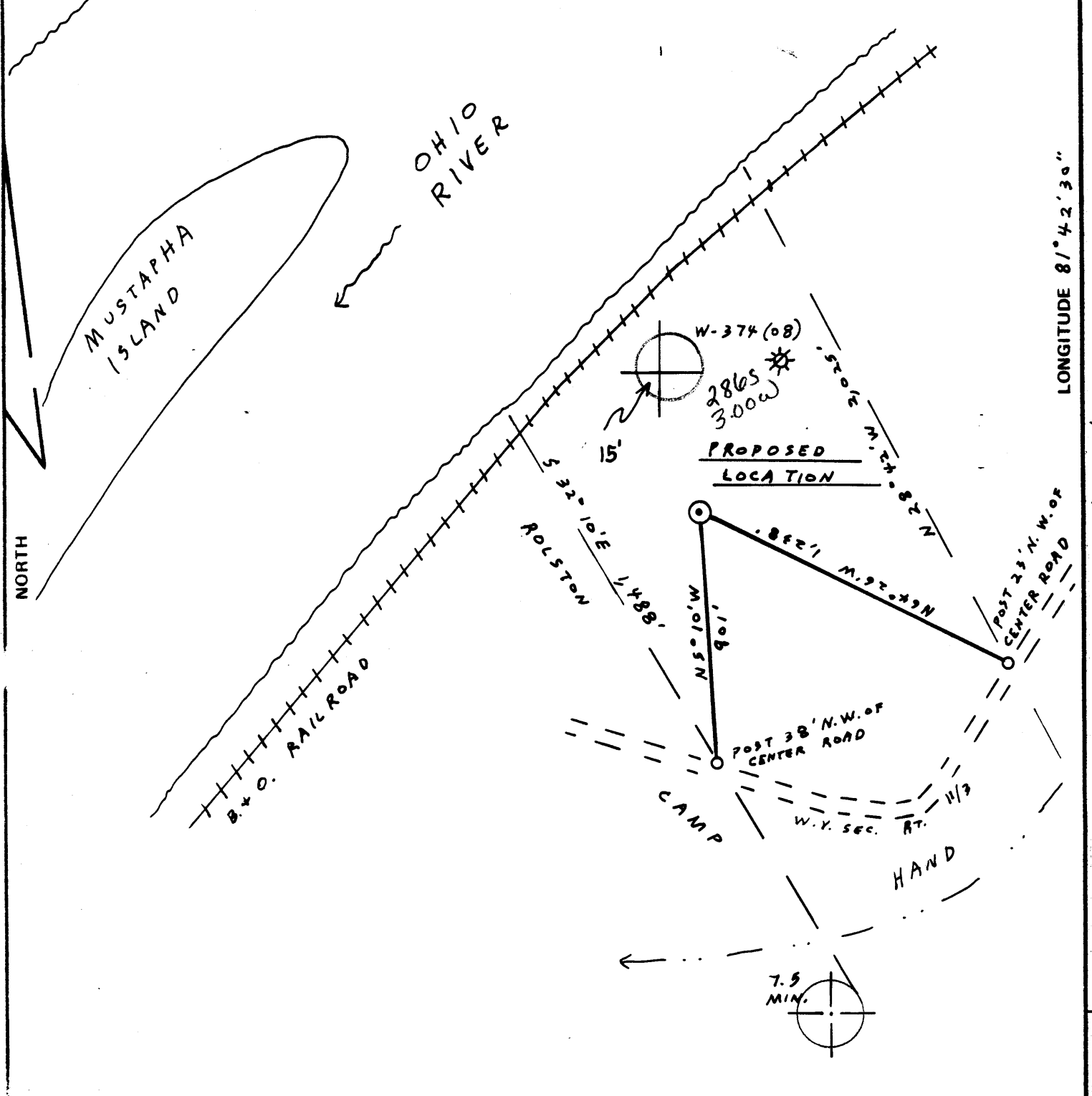

FILE NO. 5-69
 DRAWING NO. _____
 SCALE 1" = 500'
 MINIMUM DEGREE OF ACCURACY 1:200
 PROVEN SOURCE OF ELEVATION INTER. OHIO RT. 124 AND GRAVEL RD., ELEV. = 594, 3,000' N.W. OF WELL

I THE UNDERSIGNED, HEREBY CERTIFY THAT THIS PLAT IS CORRECT TO THE BEST OF MY KNOWLEDGE AND BELIEF AND SHOWS ALL THE INFORMATION REQUIRED BY LAW AND THE REGULATIONS ISSUED AND PRESCRIBED BY THE DEPARTMENT OF MINES
 (SIGNED) Vincent W. Wood
 R.P.E. _____ L.L.S. 664

PLACE SEAL HERE

STATE OF WEST VIRGINIA
 DEPARTMENT OF MINES
 OIL AND GAS DIVISION



DATE MARCH /8, 1983
 OPERATOR'S WELL NO. KEM 370
 API WELL NO. _____
47 - 107 - 1244
 STATE COUNTY PERMIT

(+) DENOTES LOCATION OF WELL ON UNITED STATES TOPOGRAPHIC MAPS
 WELL TYPE: OIL ___ GAS X LIQUID INJECTION ___ WASTE DISPOSAL ___
 (IF "GAS,") PRODUCTION X STORAGE ___ DEEP ___ SHALLOW X
 LOCATION: ELEVATION 693 WATERSHED OHIO RIVER
 DISTRICT HARRIS COUNTY WOOD
 QUADRANGLE LUBECK Belleville 15' NW
 SURFACE OWNER ROGER D. GESSSELL ACREAGE 48
 OIL & GAS ROYALTY OWNER ROGER D. GESSSELL LEASE ACREAGE 48
 LEASE NO. 80-02-1254
 PROPOSED WORK: DRILL X CONVERT ___ ORILL DEEPER ___ REDRILL ___ FRACTURE OR STIMULATE ___ PLUG OFF OLD FORMATION ___ PERFORATE NEW FORMATION ___ OTHER PHYSICAL CHANGE IN WELL (SPECIFY) _____

APR 4 1983

PLUG AND ABANDON ___ CLEAN OUT AND REPLUG ___
 TARGET FORMATION DEVONIAN BROWN SHALE ESTIMATED DEPTH 4007'
 WELL OPERATOR KAISER EXPLOR. & MIN. CO. DESIGNATED AGENT KAISER EXPLORATION AND MINING CO.
 ADDRESS P.O. BOX 8 ADDRESS P.O. BOX 8

FORM IV-6 (8-78)

WOOD 1244



1) Date: March 24, 1988
 2) Operator's Well No. KDS 4370
 3) API Well No. 47 State _____ County _____ Permit _____

DRILLING CONTRACTOR:
Clint Hurt & Associates
Elkhorn, WV

STATE OF WEST VIRGINIA
 DEPARTMENT OF MINES, OIL AND GAS DIVISION

OIL AND GAS WELL PERMIT APPLICATION

- 4) WELL TYPE: A Oil _____ / Gas _____ /
 B (If "Gas", Production _____ / Underground storage _____ / Deep _____ / Shallow _____)
- 5) LOCATION: Elevation: _____ Watershed: Ohio River
 District: Harris County: Wood Quadrangle: Lubock
- 6) WELL OPERATOR Kaiser Exploration and Mining Co. 11) DESIGNATED AGENT Jane
 Address P. O. Box 7 Address _____
Evanswood, WV 26034
- 7) OIL & GAS ROYALTY OWNER Roger D. Cassell 12) COAL OPERATOR None
 Address Box 7 Address _____
New England, WV 26104
- 8) SURFACE OWNER Same 13) COAL OWNER(S) WITH DECLARATION ON RECORD:
 Name _____ Address _____
 Name _____ Address _____
- 9) FIELD SALE (IF MADE) TO:
 Address _____
- 10) OIL & GAS INSPECTOR TO BE NOTIFIED 14) COAL LESSEE WITH DECLARATION ON RECORD:
 Name Samuel Hershak Name _____ Address _____
 Address P. O. Box 45 Address _____
Smithville, WV
- 15) PROPOSED WORK: Drill / Drill deeper _____ / Redrill _____ / Fracture or stimulate _____
 Plug off old formation _____ / Perforate new formation _____
 Other physical change in well (specify) _____
- 16) GEOLOGICAL TARGET FORMATION, Devonian Brown Shale
 17) Estimated depth of completed well, _____ feet
 18) Approximate water strata depths: Fresh, _____ feet; salt, _____ feet.
 19) Approximate coal seam depths: _____ Is coal being mined in the area? Yes _____ / No _____

20) CASING AND TUBING PROGRAM

CASING OR TUBING TYPE	SPECIFICATIONS					FOOTAGE INTERVALS		CEMENT FILL-UP OR SACKS (Cubic feet)	PACKERS
	Size	Grade	Weight per ft.	New	Used	For drilling	Left in well		
Conductor	11 3/4"			X		250	250	150 sbs class	Kinds to surface
Fresh water									
Coal	7"			X		1762	1762	65 sbs 50/100	Sizes 10/20/30
Intermediate								100 sbs 20/40	Depths set
Production	4 1/2"			X		4007	4007	200 sbs 20/40	
Tubing									
Liners									Perforations: Top Bottom

- 21) EXTRACTION RIGHTS
 Check and provide one of the following:
 Included is the lease or leases or other continuing contract or contracts by which I hold the right to extract oil or gas.
 The requirement of Code 22-4-1-(c) (1) through (4). (See reverse side for specifics.)
- 22) ROYALTY PROVISIONS
 Is the right to extract, produce or market the oil or gas based upon a lease or other continuing contract or contracts providing for flat well royalty or any similar provision for compensation to the owner of the oil or gas in place which is not inherently related to the volume of oil or gas so extracted, produced or marketed? Yes No
- If the answer above is No, nothing additional is needed. If the answer is Yes, you may use Affidavit Form IV-60.
- 23) Required Copies (See reverse side.)
- 24) Copies of this Permit Application and the enclosed plat and reclamation plan have been mailed by registered mail or delivered by hand to the above named coal operator, coal owner(s), and coal lessee on or before the day of the mailing or delivery of this Permit Application to the Department of Mines at Charleston, West Virginia.

Notary: _____ Signed: General Manager
 My Commission Expires _____ Its: _____

OFFICE USE ONLY
 DRILLING PERMIT

Permit number _____ Date _____

This permit covering the well operator and well location shown below is evidence of permission granted to drill in accordance with the pertinent legal requirements subject to the conditions contained herein and on the reverse hereof. Notification must be given to the District Oil and Gas Inspector. (Refer to No. 10) Prior to the construction of roads, locations and pits for any permitted work. In addition, the well operator or his contractor shall notify the proper district oil and gas inspector 24 hours before actual permitted work has commenced.)

Permit expires _____ unless drilling is commenced prior to that date and prosecuted with due diligence.

Bond:	Agent:	Plat:	Casing	Fee
-------	--------	-------	--------	-----

Administrator, Office of Oil and Gas

- 1) Date of Application
- 2) Your well name and number
- 3) To be filled out by office of oil & gas
- 4A) "Oil" means natural crude oil or petroleum and other hydrocarbons, regardless of gravity, which are produced at the well in liquid form by ordinary production methods and which are not the result of condensation of gas after it leaves underground reservoirs: "Gas" means all natural gas and all other fluid hydrocarbons not defined as oil.
- 4B) "Shallow well" means any well drilled and completed in a formation above the top of the uppermost member of the "Onondaga Group" or a depth less than six thousand feet, whichever is shallower.
"Deep well" means any well drilled and completed in a formation at or below the top of the uppermost member of the "Onondaga Group" or at a depth less than six thousand feet, whatever is shallower.
- 5) Where well is located
- 6) Before a permit can be issued in a corporation, company partnership, or fictitious name, the name must be registered with the Secretary of State Office
- 7) Use separate sheet if necessary
- 8) Present surface owner at time application is filed.
- 9) Optional
- 11) See Reg. 7.01 relating to code §22-4-1k
- 12) "Coal Operator" means any persons, firm, partnership, partnership association or corporation that proposes to or does operate a coal mine. See Note 24
- 13 & 14) As per §22-4-20; See Note 24
- 15) Work that will be attempted—A separate Form IV-2 shall not be required for fracturing or stimulating a well where fracturing or stimulating is to be part of the work for which a permit is sought and is noted as such on the Form IV-2 filed in connection therewith.
- 16) Anticipated formation for which well will be completed
- 17) Self explanatory
- 18) Depth to deepest freshwater, and shallowest salt water, taken from nearby wells corrected for differences in elevation
- 19) All coal seam depths
- 20) Proposed casing program and cementing refer to Code 22-4-5, 22-4-6, 22-4-7, 22-4-8, 22-4-8a Reg 9.01, 15.01, 15.02, 15.03, 15.04, 25.01, 25.02, 25.03, 25.04
- 21) Code 22-4-11(c) - In lieu of filing the lease or leases or other continuing contract or contracts, the applicant for a permit described herein may file the following:
 - (1) A brief description of the tract of land including the district and county wherein the tract is located;
 - (2) The identification of all parties to all leases or other continuing contractual agreements by which the right to extract, produce or market the oil or gas is claimed;
 - (3) The book and page number wherein each such lease or contract by which the right to extract, produce or market the oil or gas is recorded;
 - (4) A brief description of the royalty provisions of each such lease or contract.
- 22) Code 22-4-11(d) and 22-4-11(e).
- 23) Regulation 7.02 of the Department of Mines provides that the original and four copies of Form IV-2 must be filed with the Department, accompanied by (i) a plat in the form prescribed by Regulation 11, (ii) a bond in one of the forms prescribed by Regulation 12, or in lieu thereof the other security allowed by Code §22-4-2, (iii) Form IV-9, "Reclamation Plan", applicable to the reclamation required by Code §22-4-12b and Regulation 23, (iv) unless previously paid on the same well, the fee required by Code §22-4-12a, and (v) if applicable, the consent required by Code §22-4-8a from the owner of any water well or dwelling within 200 feet of the proposed well.
- 24) The above named coal operator, coal owner(s), and coal lessee are hereby notified that any objection they wish to make or are required to make by Code §22-4-3 must be filed with the Department of Mines within fifteen (15) days after the receipt of this Application by the Department.

The following waiver must be completed by the coal operator and by any coal owner or coal lessee who has recorded a declaration under Code 22-4-20, if the permit is to be issued within fifteen (15) days of receipt thereof.

WAIVER

The undersigned coal operator _____ / owner _____ / lessee _____ / of the coal under this well location has examined this proposed well location. If a mine map exists which covers the area of the well location, the well location has been added to the mine map. The undersigned has no objection to the work proposed to be done at this location, provided, the well operator has complied with all applicable requirements of the West Virginia Code and the governing regulations.

Date: _____, 19____

By _____

Its _____