

LATITUDE 39° 22' 30"

7.5' TOPO

LONGITUDE 81° 30' 00"

17934

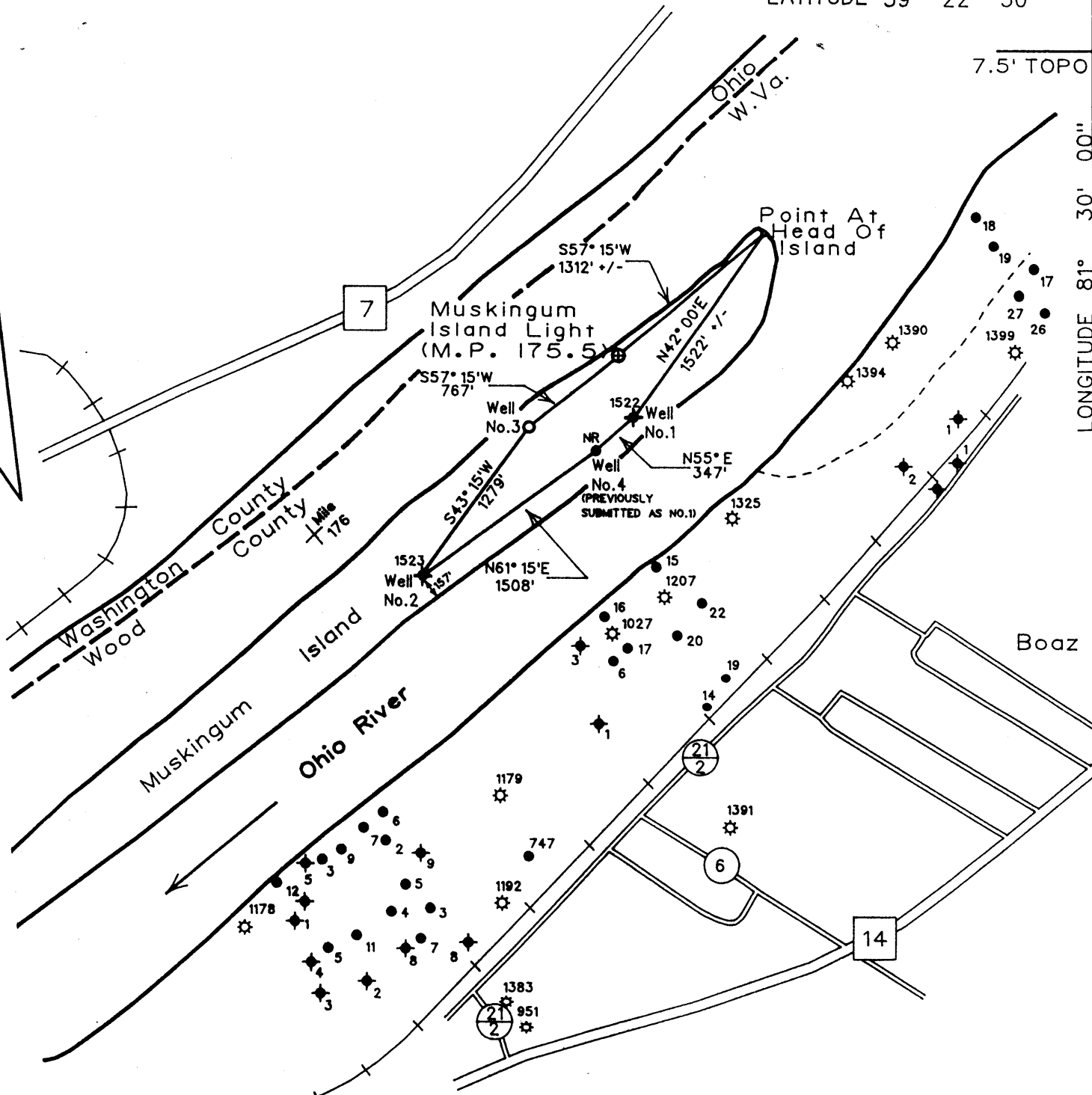

(H) DENOTES LOCATION OF WELL ON UNITED STATES TOPOGRAPHIC MAPS

FILE NO. 103-50  
 MAP NO. N30 N S 5 E W 47  
 SCALE 1"=1000'  
 MINIMUM DEGREE OF ACCURACY 1 in 200  
 PROVEN SOURCE OF ELEVATION Spot Elevation on Island = 607'

I THE UNDERSIGNED, HEREBY CERTIFY THAT THIS PLAT IS CORRECT TO THE BEST OF MY KNOWLEDGE AND BELIEF AND SHOWS ALL THE INFORMATION REQUIRED BY LAW AND THE REGULATIONS ISSUED AND PRESCRIBED BY THE DEPARTMENT OF MINES.

(SIGNED) *Timothy P. Roush*  
 TIMOTHY P. ROUSH PS 793

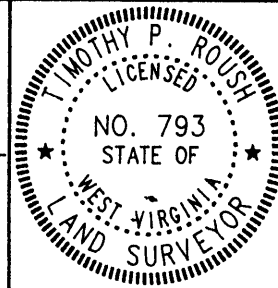

STATE OF WEST VIRGINIA  
 DIVISION OF ENERGY  
 OIL AND GAS SECTION



DATE August 10, 19 93  
 FARM Nature Conservancy NO. 3  
 API WELL NO. 47-107-1524-P

WELL TYPE: OIL  GAS  LIQUID INJECTION  WASTE DISPOSAL   
 (IF "GAS") PRODUCTION  STORAGE  DEEP  SHALLOW   
 LOCATION: ELEVATION 606' WATERSHED Ohio River  
 DISTRICT Williams COUNTY Wood  
 QUADRANGLE Parkersburg

SURFACE OWNER The Nature Conservancy ACREAGE 27.85 Ac.  
 OIL & GAS ROYALTY OWNER The Nature Conservancy LEASE ACREAGE 27.85 Ac.

LEASE NO. \_\_\_\_\_

PROPOSED WORK: DRILL  CONVERT  DRILL DEEPER  REDRILL  FRACTURE OR STIMULATE  PLUG OFF OLD FORMATION  PERFORATE NEW FORMATION  OTHER PHYSICAL CHANGE IN WELL (SPECIFY) \_\_\_\_\_

PLUG AND ABANDON  CLEAN OUT AND REPLUG

TARGET FORMATION Macksburg ESTIMATED DEPTH 995 +/-

WELL OPERATOR The Nature Conservancy DESIGNATED AGENT Mark Scott

ADDRESS P.O. Box 3754 ADDRESS P.O. Box 3754

SEP 10 1993

STATE OF WEST VIRGINIA  
DIVISION OF ENVIRONMENTAL PROTECTION  
SECTION OF OIL AND GAS

AFFIDAVIT OF PLUGGING AND FILLING WELL

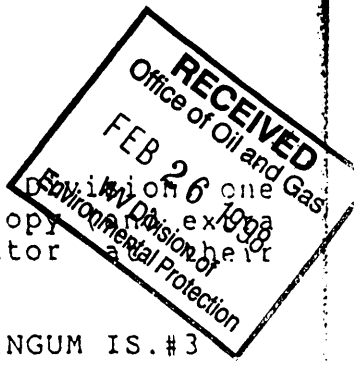

AFFIDAVIT SHOULD BE IN TRIPLICATE, one copy mailed to the [redacted] one copy to be retained by the Well Operator and the third copy (copies if required) should be mailed to each coal operator respective addresses.

Farm name: NATURE CONSERVANCY Operator Well No.: MUSKINGUM IS.#3

LOCATION: Elevation: 606.00 Quadrangle: PARKERSBURG  
District: WILLIAMS County: WOOD  
Latitude: 950 Feet South of 39 Deg. 22 Min. 30 Sec.  
Longitude 150 Feet West of 81 Deg. 30 Min. Sec.

Well Type: OIL X GAS

Company: The Nature Conservancy of WV  
723 Kanawha Blvd Suite 500  
Charleston, WV 25537

Coal Operator NO Coal  
or Owner

Agent: Mark Scott

Coal Operator NO Coal  
or Owner

Permit Issued: 09/09/93

AFFIDAVIT

STATE OF WEST VIRGINIA,  
County of \_\_\_\_\_ SS:

Bill Shreve and Kevin Shreve being first duly sworn according to law depose and say that they are experienced in the work of plugging and filling oil and gas wells and were employed by the above named well operator, and participated in the work of plugging and filling the above well, and Glen Robinson Oil and Gas Inspector representing the Director, say that said work was commenced on the 4 day of August, 1993, and that the well was plugged and filled in the following manner:

TYPE	FROM	TO	PIPE REMOVED	LEFT
Cement	995'	895'	1000' of 1" Tubing	
"	365'	265'	995' of 2" Tubing	
"	150'	Surface	365' of 6 7/8" Casing	
60% Gel Plugs between all Cement Plugs				

2/26/98

Description of monument: 6 5/8" Casing 20' in well + 60' above ground  
and that the work of plugging and filling said well was completed on the 9 day of August, 1993.

And further deponents saith not.

Bill Shreve

Sworn and subscribe before me this 27<sup>th</sup> day of January, 1994  
My commission expires: January 3, 2000

Sandra G. Wilson  
Notary Public



and Gas Inspector Glen Robinson