

POCAHONTAS LAND CORPORATION
ORDER BOOK 38/385

COORDINATES
279128.468
1844922.792
WV STATE PLANE
NAD 27 SOUTH

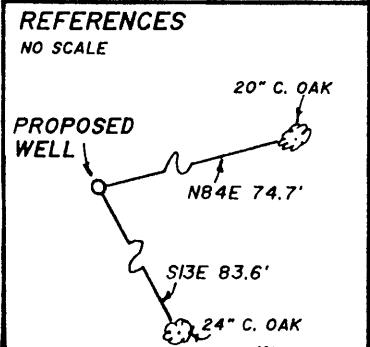

NO KNOWN WATER WELLS WITHIN 10 CO'

FILE NO. _____
DRAWING NO. _____
SCALE **1"=1000'**
MINIMUM DEGREE OF ACCURACY **1/10000**
PROVEN SOURCE OF ELEVATION **COPPER PLUG IN ROCK**
ELEVATION 2783.54

I THE UNDERSIGNED, HEREBY CERTIFY THAT THIS PLAT IS CORRECT TO THE BEST OF MY KNOWLEDGE AND BELIEF AND SHOWS ALL THE INFORMATION REQUIRED BY LAW AND THE REGULATIONS ISSUED AND PRESCRIBED BY THE DEPARTMENT OF MINES.
(SIGNED) Bryant W. Bowman
R. P. E. _____ L. L. S. **736**

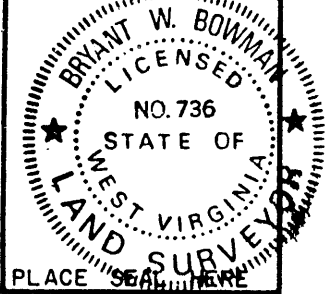

(+) DENOTES LOCATION OF WELL ON UNITED STATES TOPOGRAPHIC MAP
FORM IV-6 WEST VIRGINIA (8-78)
DIVISION OF ENVIRONMENTAL PROTECTION
OFFICE OF OIL AND GAS
#10 McJUNKIN ROAD
NITRO, WEST VIRGINIA 25143-2506

DATE **SEPTEMBER 29**, 19 **98**
OPERATOR'S WELL NO. **LC-120**
API WELL NO. **47-109-01786**
STATE COUNTY PERMIT

WELL TYPE: OIL ___ GAS **X** LIQUID INJECTION ___ WASTE DISPOSAL ___
(IF "GAS", PRODUCTION **X** STORAGE ___ DEEP ___ SHALLOW ___)
LOCATION: ELEVATION **3336** WATER SHED **TONEY FORK**
DISTRICT **OCEANA** COUNTY **WYOMING**
QUADRANGLE **PILOT KNOB, WV 7.5'**

SURFACE OWNER **POCAHONTAS LAND CORPORATION** ACREAGE **29500±**
OIL & GAS ROYALTY OWNER **POCAHONTAS LAND CORPORATION** LEASE ACREAGE **29500±**
LEASE NO. _____

PROPOSED WORK: DRILL **X** CONVERT ___ DRILL DEEPER ___ REDRILL ___ FRACTURE OR STIMULATE ___ PLUG OFF OLD FORMATION ___ PERFORATE NEW FORMATION ___ OTHER PHYSICAL CHANGE IN WELL (SPECIFY) **6-6 248**

PLUG AND ABANDON ___ CLEAN OUT AND REPLUG ___

TARGET FORMATION _____ ESTIMATED DEPTH _____

WELL OPERATOR **PENN VIRGINIA OIL & GAS CORP** DESIGNATED AGENT **MR. HARRY JEWEL**
ADDRESS **999 EXECUTIVE PARK BLVD., SUITE 300** ADDRESS **PO BOX 460**
KINGSPORT, TN 37660 **RAVENCLIFF, WV 25913**

PLACE SEAL HERE

WYO 1786

JAN 11 1999

ARLESTON BLUEPRINT 087163

WR-35

DATE:
API #: 47-109-01786

State of West Virginia
Division of Environmental Protection
Section of Oil and Gas

Reviewed BS

Well Operator's Report of Well Work

Farm name: Pocahontas Land Corporation Operator Well No.: LC-120

LOCATION: Elevation: 3336' Quadrangle: Pilot Knob

District: Oceana County: Wyoming
Latitude: 9620 Feet South of 37 Deg. 47 Min. 30 Sec.
Longitude 10450 Feet West of 81 Deg. 30 Min. 0 Sec.

Company:

Penn Virginia Oil & Gas Corporation

	Casing & Tubing	Used in drilling	Left in well	Cement fill up Cu. Ft.
Address: P.O. Box 387	13 3/8"	32'	32'	0
Duffield, VA 24244	9 5/8"	1054'	1054'	408
Agent: Harry Jewell	7"	2872'	2872'	597
Inspector: Ofie Helmick	4 1/2"	4615'	4615'	95
Date Permit Issued: 01/04/99				
Date Well Work Commenced: 01/19/00				
Date Well Work Completed: 03/21/00				
Verbal Plugging:				
Date Permission granted on:				
Rotary X Cable Rig				
Total Depth (feet): 4736'				
Fresh Water Depth (ft.): Damp at 45' & 2700'				
Salt Water Depth (ft.):				
Is coal being mined in area (N/Y)? N				
Coal Depths (ft.):				

OPEN FLOW DATA

Producing formation Big Lime Pay zone depth (ft) _____
Gas: Initial open flow _____ MCF/d Oil: Initial open flow _____ Bbl/d
Final open flow 212 MCF/d Final open flow _____ Bbl/d
Time of open flow between initial and final tests 4 Hours
Static rock Pressure 700 psig (surface pressure) after 24 Hours

Second producing formation _____ Pay zone depth (ft) _____
Gas: Initial open flow _____ MCF/d Oil: Initial open flow _____ Bbl/d
Final open flow _____ MCF/d Final open flow _____ Bbl/d
Time of open flow between initial and final tests _____ Hours
Static rock Pressure _____ psig (surface pressure) after _____ Hours

NOTE: ON BACK OF THIS FORM PUT THE FOLLOWING: 1). DETAILS OF PERFORATED INTERVALS, FRACTURING OR STIMULATING, PHYSICAL CHANGE, ETC. 2). THE WELL LOG WHICH IS A SYSTEMATIC DETAILED GEOLOGICAL RECORD OF ALL FORMATIONS, INCLUDING COAL ENCOUNTERED BY THE WELLBORE.

Signed:

By: William M. Ryan
Date: 5/17/00

JUN 9 2000

WYO 1786

FORM WR-35R
(REVERSE)

PERMIT #: 47-109-01786
WELL #: LC-120

LC-120

1st Stage: Big Lime (Denmar) Perforated from 4535' to 4544' with 27 holes.
Treated with 2500 gallons 15% HCL acid and
270000 SCF N2.
ISIP: 1950 psi ATR: 17.1 BPM ATP: 1817 psi

2nd Stage: Big Lime (Pickaway) Perforated from 4420' to 4428' with 24 holes. Treated
with 2000 gallons 15% HCL acid and 243000 SCF N2.
ISIP: 2030 psi ATR: 14.5 BPM ATP: 1881 psi

<u>FORMATIONS</u>	<u>TOP</u>	<u>BOTTOM</u>	<u>REMARKS</u>
Sand, Shale, & Coal	0	2860	Coals at 605-608, 637-640, 890-894, 1258-1262, 1266-1269, 1488-1492, 1804- 1806, 2801-2808, 2855-2858, open mine: 1000-1004
Sand & Shale	2860	3310	
Shale	3310	3358	
Sand & Shale	3358	3430	
Shale	3430	3436	
Ravencliff Sand	3436	3446	
Avis Limestone	3446	3480	
Shale & Red Rock	3480	3540	
Sand	3540	3580	
Sand, Shale & Red Rock	3580	4014	
Sand	4014	4070	
Shale	4070	4103	
Little Lime	4103	4180	
Lime & Shale	4180	4186	
Big Lime	4186	4610	
Shale	4610	4736	
TD	4736		No Shows Reported

