

COORDINATES
273954.482
1844292.416
WV SOUTH
NAD 27

LONGITUDE 81°30'00"

14800'

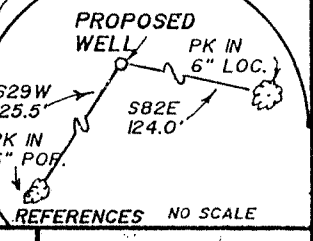

REFERENCES NO SCALE

FILE NO. _____
DRAWING NO. _____
SCALE 1"=2000'
MINIMUM DEGREE OF ACCURACY 1:7500
PROVEN SOURCE OF ELEVATION COPPER PLUG IN ROCK
ELEVATION 2783.54

I THE UNDERSIGNED, HEREBY CERTIFY THAT THIS PLAT IS CORRECT TO THE BEST OF MY KNOWLEDGE AND BELIEF AND SHOWS ALL THE INFORMATION REQUIRED BY LAW AND THE REGULATIONS ISSUED AND PRESCRIBED BY THE DEPARTMENT OF MINES.
(SIGNED) Suzanne Bonman
R. P. E. _____ L. L. S. 736

PLACE SEAL HERE

(+) DENOTES LOCATION OF WELL ON UNITED STATES TOPOGRAPHIC MAPS
FORM IV-6
(8-78)



DATE DECEMBER 19 20 00
OPERATOR'S WELL NO. LC-203
API WELL NO. 47-109-01986
STATE COUNTY PERMIT

Division of Environmental Protection
Office of Oil & Gas

WELL TYPE: OIL _____ GAS X LIQUID INJECTION _____ WASTE DISPOSAL _____
(IF "GAS", PRODUCTION X STORAGE _____ DEEP _____ SHALLOW _____)
LOCATION: ELEVATION 2134 WATER SHED CRANE FORK OF CLEAR FORK
DISTRICT OCEANA COUNTY WYOMING
QUADRANGLE PILOT KNOB AND ARNETT 7.5'
SURFACE OWNER POCAHONTAS LAND CORPORATION ACREAGE 29500±
OIL & GAS ROYALTY OWNER PENN VIRGINIA OIL & GAS LEASE ACREAGE 29500±
LEASE NO. _____
PROPOSED WORK: DRILL X CONVERT _____ DRILL DEEPER _____ REDRILL _____ FRACTURE OR STIMULATE _____ PLUG OFF OLD FORMATION _____ PERFORATE NEW FORMATION _____ OTHER PHYSICAL CHANGE IN WELL (SPECIFY) _____
PLUG AND ABANDON _____ CLEAN OUT AND REPLUG _____
TARGET FORMATION Pinnacle, Ravencliff, Binkling, Garden ESTIMATED DEPTH 4500
WELL OPERATOR PENN VIRGINIA OIL & GAS CORP DESIGNATED AGENT MR. HARRY JEWEL
ADDRESS PO BOX 387 ADDRESS PO BOX 460
DUFFIELD, VA 24244-0387 RAVENCLIFF, WV 25913

JAN 26 2001

6-6 248

Charleston WV

CHARLESTON: BLUEPRINT 092941

92861 07M

OK Act

State of West Virginia
Division of Environmental Protection
Section of Oil and Gas

Well Operator's Report of Well Work

Farm name: Pocahontas Land Corporation Operator Well No.: LC-203

LOCATION: Elevation: 2134 Quadrangle: Pilot Knob and Arnette 7.5

District: Oceana County: Wyoming
Latitude: 4480 Feet South of 37 Deg. 47 Min. 30 Sec.
Longitude 11100 Feet West of 81 Deg. 30 Min. 00 Sec.

Company:

Penn Virginia Oil & Gas Corporation

	Casing & Tubing	Used in drilling	Left in well	Cement fill up Cu. Ft.
Address: P.O. Box 387	13 3/8"	30'	30'	0
Duffield, VA 24244	7"	1802'	1802'	351
Agent: Harry Jewell	4 1/2"	3479'	3479'	295
Inspector: Ofie Helmick				
Date Permit Issued: 1-22-01				
Date Well Work Commenced: 2-5-01				
Date Well Work Completed: 4-2-01				
Verbal Plugging:				
Date Permission granted on:				
Rotary X Cable Rig				
Total Depth (feet): 4320'				
Fresh Water Depth (ft.): Damp @ 162'				
Salt Water Depth (ft.):				
Is coal being mined in area (N/Y)? N				
Coal Depths (ft.): 273-275, 493-495, 592-595, 917-918, 1500-1501, 1582-1593, 1706-1707				

RECEIVED
Office of Oil & Gas
Permitting
JUL 07 2001
WV Department of
Environmental Protection

OPEN FLOW DATA

Producing formation Princeton, Ravencliff, Big Lime Pay zone depth (ft) _____

Gas: Initial open flow _____ MCF/d Oil: Initial open flow _____ Bbl/d

Final open flow 278 MCF/d Final open flow _____ Bbl/d

Time of open flow between initial and final tests 4 Hours

Static rock Pressure 260 psig (surface pressure) after 48 Hours

Second producing formation _____ Pay zone depth (ft) _____

Gas: Initial open flow _____ MCF/d Oil: Initial open flow _____ Bbl/d

Final open flow _____ MCF/d Final open flow _____ Bbl/d

Time of open flow between initial and final tests _____ Hours

Static rock Pressure _____ psig (surface pressure) after _____ Hours

NOTE: ON BACK OF THIS FORM PUT THE FOLLOWING: 1). DETAILS OF PERFORATED INTERVALS, FRACTURING OR STIMULATING, PHYSICAL CHANGE, ETC. 2). THE WELL LOG WHICH IS A SYSTEMATIC DETAILED GEOLOGICAL RECORD OF ALL FORMATIONS, INCLUDING COAL ENCOUNTERED BY THE WELLBORE.

Signed:

By: William M. Ryan
Date: 6/28/01

JUL 06 2001

WV 0 1986

FORM WR-35R
(REVERSE)

PERMIT #: 47-109-01986
WELL #: LC-203

DETAILS OF PERFORATIONS, FRACTURING, OR PHYSICAL CHANGE, ETC.

Stage 1 – Big Lime – Perforated from 3344' to 3354' with 20 holes and from 3384' to 3388' with 4 holes. Breakdown with 500 gallons 15% HCL acid and water. Treated with 2000 gallons 15% HCL acid and 113000 SCF N2. ISIP: 1593 psi. ATP: 1640 psi. ATR:20 BPM.

Stage 2 – Ravencliff – Perforated from 2274' to 2282' with 16 holes. Breakdown with 250 gallons 15% HCL acid and N2. Treated with 118 bbls water, 20000 lbs 20/40 sand, and 261000 SCF N2. ISIP: 3630 psi. ATP: 3429 psi. ATR: 20 BPM.

Stage 3 – Princeton – Perforated from 2148' to 2156' with 16 holes. Breakdown with 250 gallons 15% HCL acid and N2. Treated with 160 barrels water, 35200 lbs 20/40 sand and 247000 SCF N2. ISIP: 2730 psi. ATP: 2816 psi. ATR: 20 BPM.

<u>FORMATIONS</u>	<u>TOP</u>	<u>BOTTOM</u>	<u>REMARKS</u>
Sand, Shale & Coal	0	1707	
Sand & Shale	1707	2129	
Princeton Sand	2129	2163	
Sand & Shale	2163	2252	Gas check @ 2213 - NS
Ravencliff Sand	2252	2283	
Avis Limestone	2283	2320	
Shale	2320	2440	Gas check @ 2432 - NS
Shale & Red Rock	2440	2674	
Sand	2674	2707	
Sand, Shale & Red Rock	2707	2950	
Little Lime	2950	3023	Gas check @ 2950 - NS
Shale & Lime	3023	3053	
Big Lime	3053	3418	
Shale	3418	3588	
Weir, Sand & Shale	3588	3621	
Shale	3621	3970	
Coffee Shale	3970	3982	
Shale	3982	4162	Gas check @ 4000 - NS
Gordon	4162	4180	
Shale	4180	4320	Gas check @ T.D. – 84MCF/D