

700080A

WW-7
8-30-06



West Virginia Department of Environmental Protection
Office of Oil and Gas
WELL LOCATION FORM: GPS

API: 47-007-00080 WELL NO.: WV 607695 (Fanny L. Hall P-7695)

FARM NAME: Clyde & Mary Lou Putnam

RESPONSIBLE PARTY NAME: EQT Production Company

COUNTY: Braxton DISTRICT: Birch

QUADRANGLE: Rosedale 7.5'

SURFACE OWNER: Clyde D. & Mary Lou Putnam

ROYALTY OWNER: TRW Mineral Account

UTM GPS NORTHING: 4282184

UTM GPS EASTING: 505208 GPS ELEVATION: 412 m (1352 ft)

The Responsible Party named above has chosen to submit GPS coordinates in lieu of preparing a new well location plat for a plugging permit or assigned API number on the above well. The Office of Oil and Gas will not accept GPS coordinates that do not meet the following requirements:

1. Datum: NAD 1983, Zone: 17 North, Coordinate Units: meters, Altitude: height above mean sea level (MSL) – meters.
2. Accuracy to Datum – 3.05 meters
3. Data Collection Method:

Survey grade GPS : Post Processed Differential
Real-Time Differential

Mapping Grade GPS X: Post Processed Differential X
Real-Time Differential

4. Letter size copy of the topography map showing the well location.

I the undersigned, hereby certify this data is correct to the best of my knowledge and belief and shows all the information required by law and the regulations issued and prescribed by the Office of Oil and Gas.

RECEIVED
Office of Oil and Gas

FEB 20 2015
WV Department of
Environmental Protection

Signature

PS # 2100
Title

1/21/15
Date

700080P

Topo Quad: Rosedale 7.5'

Scale: 1" = 2000'

County: Braxton

Date: January 20, 2015

District: Birch

Project No: 40-02-00-07

47-007-00080 WV 607695 (Fanny L. Hall P-7695)

Topo

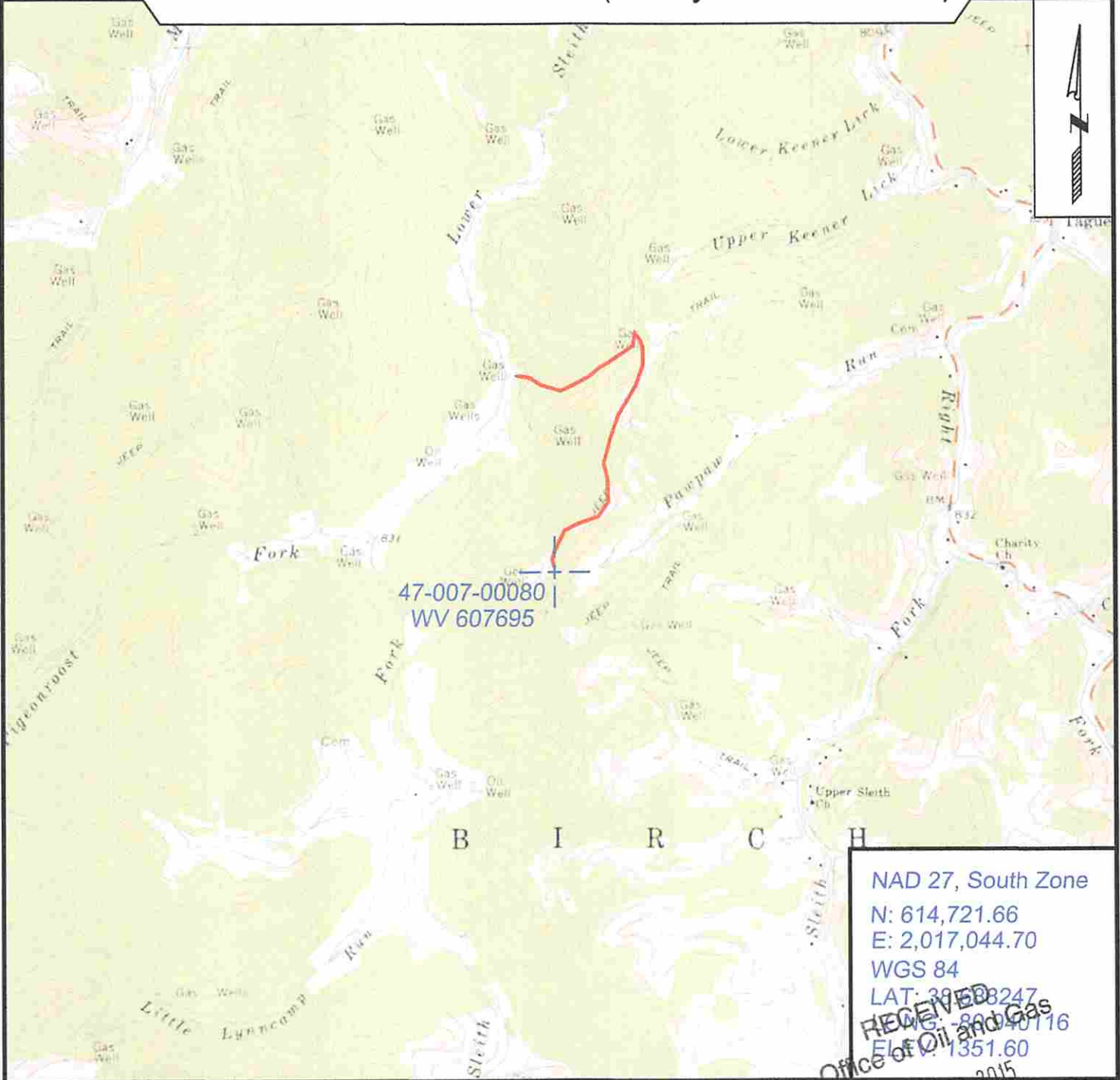

NAD 27, South Zone
 N: 614,721.66
 E: 2,017,044.70
 WGS 84
 LAT: 38° 48' 24"
 LONG: -80° 40' 16"
 ELEV: 1351.60

RECEIVED
 Office of Oil and Gas
 FEB 20 2015
 WV Department of Environmental Protection
 P.O. Box 280
 Bridgeport, WV 26330



SURVEYING AND MAPPING SERVICES PERFORMED BY:

ALLEGHENY SURVEYS, INC.

1-800-482-8606
 237 Birch River Road
 Birch River, WV 26610
 PH: (304) 649-8606
 FAX: (304) 649-8608

PREPARED FOR:

EQT Production Company
 WV Department of Environmental Protection