

2100547P

WW-7
8-30-06



West Virginia Department of Environmental Protection
Office of Oil and Gas
WELL LOCATION FORM: GPS

API: 47-021-00547 WELL NO.: WV 656186 (McDonald #1571)

FARM NAME: J. A. McDonald

RESPONSIBLE PARTY NAME: EQT Production Company

COUNTY: Gilmer DISTRICT: Center

QUADRANGLE: Tanner 7.5'

SURFACE OWNER: Danny Hayward Furr

ROYALTY OWNER: Marjorie O. Dobbins, et al.

UTM GPS NORTHING: 4307132

UTM GPS EASTING: 509484 GPS ELEVATION: 337 m (1105 ft)

The Responsible Party named above has chosen to submit GPS coordinates in lieu of preparing a new well location plat for a plugging permit or assigned API number on the above well. The Office of Oil and Gas will not accept GPS coordinates that do not meet the following requirements:

- Datum: NAD 1983, Zone: 17 North, Coordinate Units: meters, Altitude: height above mean sea level (MSL) – meters.
- Accuracy to Datum – 3.05 meters
- Data Collection Method:
Survey grade GPS : Post Processed Differential
Real-Time Differential
Mapping Grade GPS X: Post Processed Differential X
Real-Time Differential

4. Letter size copy of the topography map showing the well location.

I the undersigned, hereby certify this data is correct to the best of my knowledge and belief and shows all the information required by law and the regulations issued and prescribed by the Office of Oil and Gas.

RECEIVED
Office of Oil and Gas

[Signature]
Signature

PS#2180
Title

7/9/15
Date

JUL 15 2015

08/14/2015

Topo Quad: Tanner 7.5'

Scale: 1" = 2000'

County: Gilmer

Date: July 2, 2015

District: Center

Project No: 25-19-00-07

47-021-00547 WV 656186 (McDonald #1571)

Topo

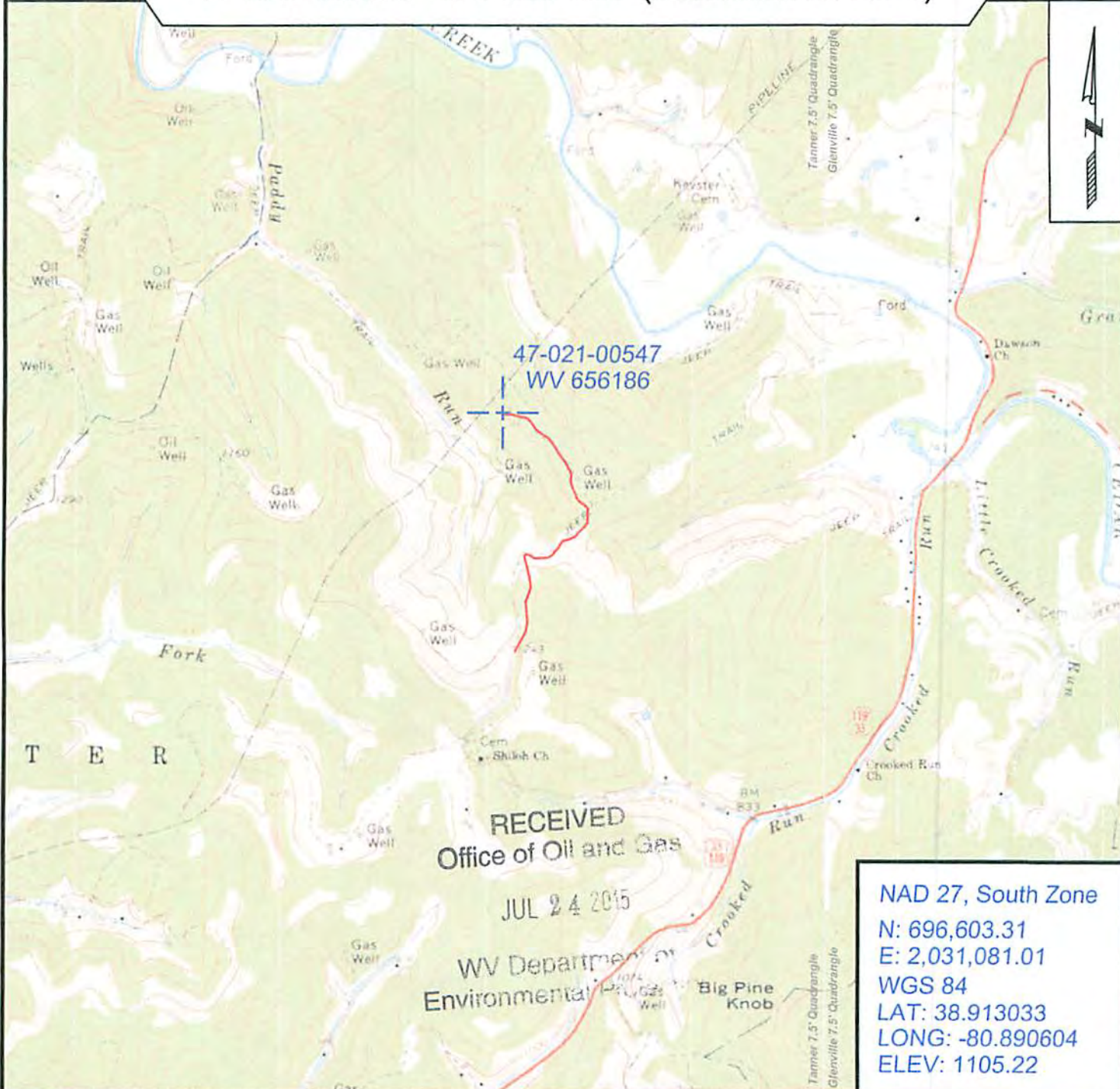

SURVEYING AND MAPPING SERVICES PERFORMED BY:
ALLEGHENY SURVEYS, INC.

1-800-482-8606
 237 Birch River Road
 Birch River, WV 26610
 PH: (304) 649-8606
 FAX: (304) 649-8608

PREPARED FOR:

EQT Production Company

P.O. Box 280
 Bridgeport, WV 26330

08/14/2015