

WW-7  
8-30-06



West Virginia Department of Environmental Protection  
Office of Oil and Gas  
**WELL LOCATION FORM: GPS**

API: 47-021-00916 WELL NO.: WV 656496 (Sumpter #1672)

FARM NAME: C. E. Sumpter, et al.

RESPONSIBLE PARTY NAME: EQT Production Company

COUNTY: Gilmer DISTRICT: Center

QUADRANGLE: Normantown 7.5'

SURFACE OWNER: Brenton C. & Bobby D. Beall

ROYALTY OWNER: Pamela D. Cain, et al.

UTM GPS NORTHING: 4299144

UTM GPS EASTING: 510401 GPS ELEVATION: 353 m (1158 ft)

The Responsible Party named above has chosen to submit GPS coordinates in lieu of preparing a new well location plat for a plugging permit or assigned API number on the above well. The Office of Oil and Gas will not accept GPS coordinates that do not meet the following requirements:

- Datum: NAD 1983, Zone: 17 North, Coordinate Units: meters, Altitude: height above mean sea level (MSL) – meters.
- Accuracy to Datum – 3.05 meters
- Data Collection Method:

Survey grade GPS     : Post Processed Differential       
Real-Time Differential     

Mapping Grade GPS X: Post Processed Differential X  
Real-Time Differential     

- Letter size copy of the topography map showing the well location.**

I the undersigned, hereby certify this data is correct to the best of my knowledge and belief and shows all the information required by law and the regulations issued and prescribed by the Office of Oil and Gas.

RECEIVED  
Office of Oil and Gas

AUG 17 2015

WV Department of  
Environmental Protection

[Signature]  
Signature

PS # 2180  
Title

7/15/15  
Date

Topo Quad: Normantown 7.5'

Scale: 1" = 2000'

County: Gilmer

Date: July 10, 2015

District: Center

Project No: 25-19-00-07

47-021-00916 WV 656496 (Sumpter #1672)

Topo

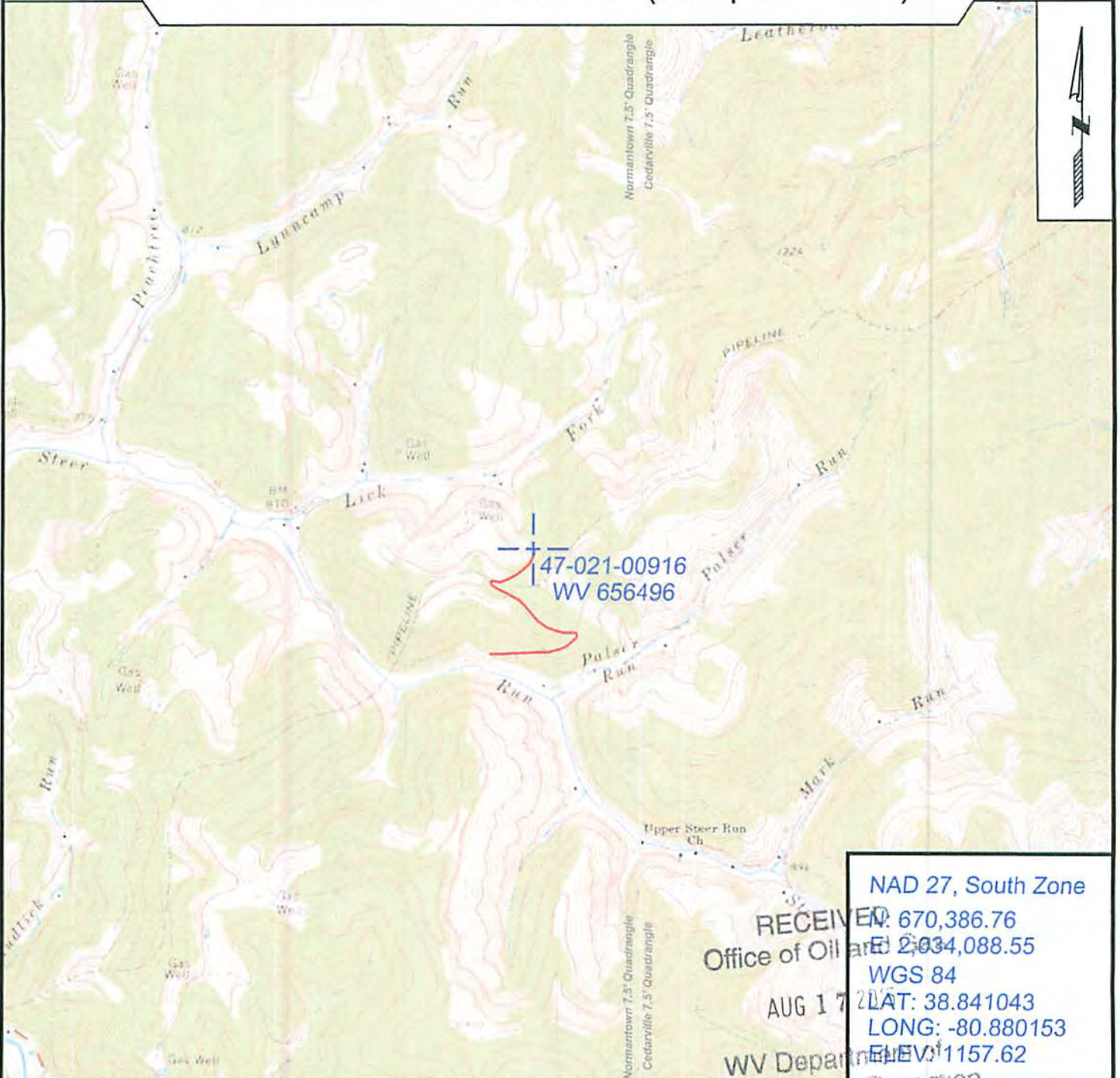

47-021-00916  
WV 656496

NAD 27, South Zone

RECEIVED  
Office of Oil and Gas

AUG 17 2015  
WV Department of Environmental Protection

E: 670,386.76

E: 2,034,088.55

WGS 84

LAT: 38.841043

LONG: -80.880153

ELEV: 1157.62



SURVEYING AND MAPPING SERVICES PERFORMED BY:

**ALLEGHENY SURVEYS, INC.**

1-800-482-8606  
237 Birch River Road  
Birch River, WV 26610  
PH: (304) 649-8606  
FAX: (304) 649-8608

PREPARED FOR

**EQT Production Company**

P.O. Box 280  
Bridgeport, WV 26330

9/18/2015