

Minimum Error of Closure 1' in 200'
 Source of Elevation LEVELS FROM CONSOLIDATED GAS SUPPLY CORP. WELL 11740 EL. 760'
 "I, the undersigned, hereby certify that this map is correct to the best of my knowledge and belief and shows all the information required by paragraph 9 of the rules and regulations of the oil and gas section of the mining laws of West Virginia."

Well Location
 Drill Deeper
 Abandonment

issued 7/29/74

MAP SHEET 96 S 43 W 23 FB-1698 PG. 38-40

Company CONSOLIDATED GAS SUPPLY CORP.
 Address CLARKSBURG, WVA.
 Farm LOUIS BENNETT
 Tract Acres 19,500 Lease No. 28170
 Well (Farm) No. _____ Serial No. 11837
 Elevation (Spirit Level) 1115'
 Quadrangle ARNOLDSBURG, WVA. **SE**
 County GILMER District CENTER
 Engineer Jackson, M. Jarvis
 Engineer's Registration No. 2397
 File No. _____ Drawing No. _____
 Date 6-10-74 Scale 1"=1320'

STATE OF WEST VIRGINIA
 DEPARTMENT OF MINES
 OIL AND GAS DIVISION
 CHARLESTON
 RECORDED
 BOOK 6
 PAGE 6
Gil-2486-P
 Denotes location obtained on United States Topographic Maps, scale 1" to 62,500', latitude and longitude lines being represented by border lines as shown.
 --- Denotes one inch spaces on border line of original tracing.
 47-021

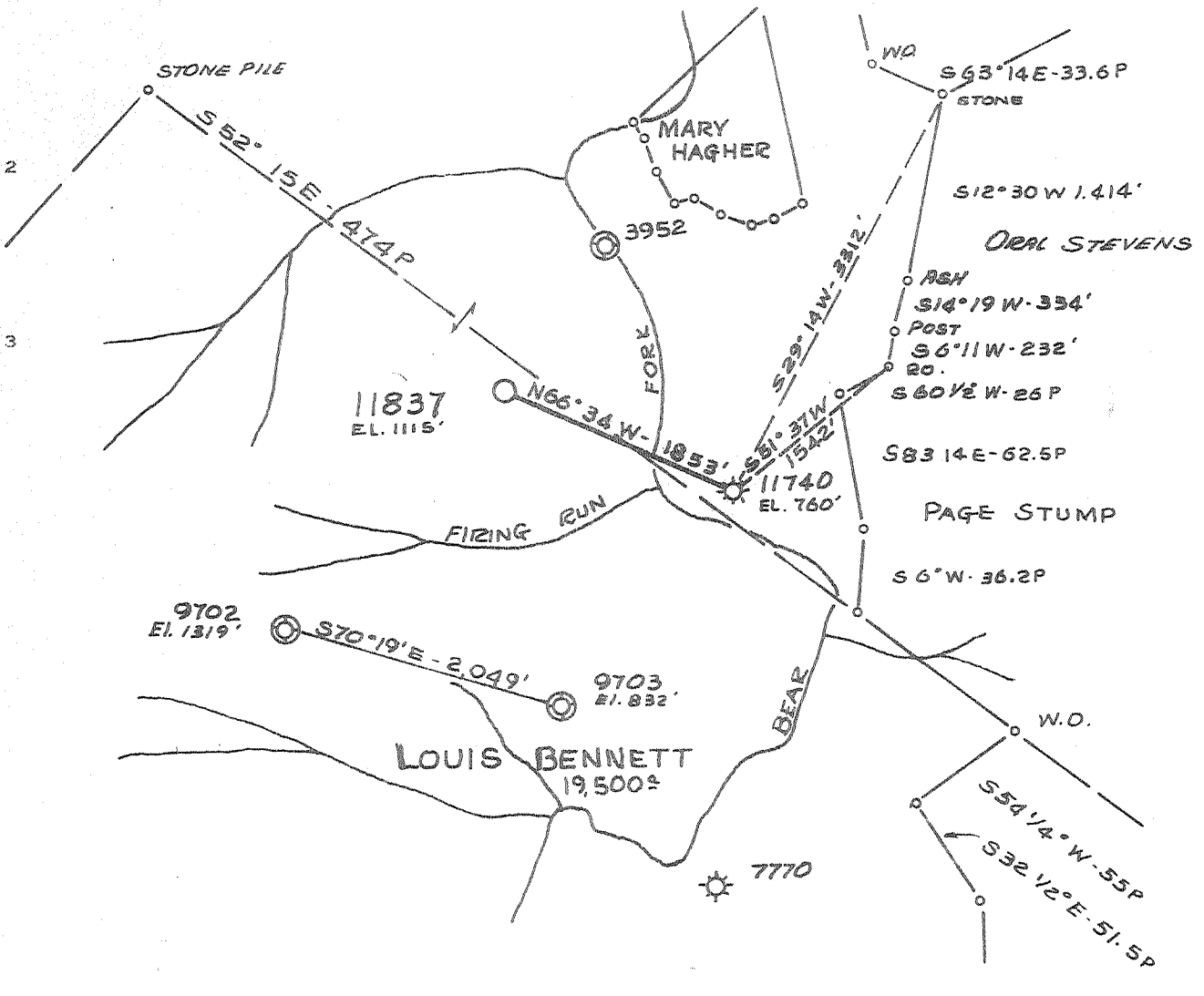

Minimum Error of Closure 1' in 200'
 Source of Elevation LEVELS FROM CONSOLIDATED GAS SUPPLY CORP. WELL 11740 EL. 760'
 "I, the undersigned, hereby certify that this map is correct to the best of my knowledge and belief and shows all the information required by paragraph 6 of the rules and regulations of the oil and gas section of the mining laws of West Virginia."

New Location
 Drill Deeper
 Abandonment

MAP SHEET 96 S 43 W 23 FB-1698 PG. 38-40

Company CONSOLIDATED GAS SUPPLY CORP.
 Address CLARKSBURG, WVA.
 Name LOUIS BENNETT
 Acres 19,500 Lease No. 28170
 Well Name No. 11837
 Elevation (Spirit Level) 1115'
 Quadrangle ARNOLDSBURG, WVA. **SE**
 County GILMER District CENTER
 Engineer Jackson, M. Jarvis
 Engineer's Registration No. 2397
 File No. _____ Drawing No. _____
 Date 6-10-74 Scale 1"=1320'

STATE OF WEST VIRGINIA
 DEPARTMENT OF MINES
 OIL AND GAS DIVISION
 CHARLESTON

WELL LOCATION MAP
 FILE NO. Gil-2486

Denotes location of well on United States Topographic Maps, scale 1 to 62,500, latitude and longitude lines being represented by border lines as shown

— Denotes one inch spaces on border line of original tracing.

47-021

AUG 26 1974

6664

Handwritten note: This is a Deep well



STATE OF WEST VIRGINIA
DEPARTMENT OF MINES

Oil and Gas Division

WELL RECORD

Quadrangle Arnoldsburg

Permit No. GIL-2486

Rotary X Oil _____
Cable _____ Gas Show
Recycling _____ Comb. _____
Water Flood _____ Storage _____
Disposal _____ Dry
(Kind)

| | | | | |
|---|-------------------|------------------|--------------|-------------------------------|
| Company <u>Consolidated</u> | Casing and Tubing | Used in Drilling | Left in Well | Cement fill up Cu. ft. (Sks.) |
| Address <u>Clarksburg, WV</u> | | | | |
| Farm <u>Louis Bennett</u> Acres <u>19,500</u> | Size | | | |
| Location (waters) <u>Bear Fork</u> | 20-16 | | | |
| Well No. <u>11837</u> Elev. <u>1115</u> | Cond. <u>20</u> | <u>20</u> | <u>20</u> | To Surface |
| District <u>Center</u> County <u>Gilmer</u> | 13-10" | <u>373</u> | <u>373</u> | 180 SKS |
| The surface of tract is owned in fee by <u>Pioneer Lumber Co.</u> | 9 5/8 | | | |
| Address <u>-</u> | 8 5/8 | <u>482</u> | <u>482</u> | 50 SKS |
| Mineral rights are owned by <u>H. M. Bennett</u> | 7 | | | |
| Address <u>Weston, WV</u> | 5 1/2 | | | |
| Drilling Commenced <u>7-17-74</u> | 4 1/2 | | | |
| Drilling Completed <u>7-29-74</u> | 3 | | | |
| Initial open flow _____ cu. ft. _____ bbls. | 2 | | | |
| Final production <u>381 M</u> cu. ft. per day _____ bbls. | Liners Used | | | |
| Well open _____ hrs. before test _____ RP. | | | | |

Well treatment details:

Attach copy of cementing record.

Shot Shale 7-28-74 from 5634-6204 with 6000# gelatin.

Coal was encountered at 1760 Feet 120 Inches
Fresh water 140 Feet Salt Water _____ Feet
Producing Sand Plugged and abandoned Depth _____

| Formation | Color | Hard or Soft | Top Feet | Bottom Feet | Oil, Gas or Water | * Remarks |
|--|-------|--------------|----------|-------------|-------------------|-----------|
| K.B. - G.L. | | | 0 | 11 | | |
| Red Rock | | | 11 | 55 | | |
| Sand | | | 55 | 170 | | |
| Red Rock | | | 170 | 190 | | |
| Sand & Shale | | | 190 | 1760 | | |
| Coal | | | 1760 | 1770 | | |
| Shale & Sand | | | 1770 | 1855 | | |
| Little Lime | | | 1855 | 1885 | | |
| Sand & Shale | | | 1885 | 1905 | | |
| Big Lime | | | 1905 | 1990 | | |
| Big Injun | | | 1990 | 2060 | | |
| Sand & Shale - <u>U. + M. Devonian Sh.</u> | | | 2060 | 6050 | | |
| Brown Shale - <u>marcellus</u> | | | 6050 | 6212 | | |
| Lime - <u>Onondaga</u> | | | 6212 | 6215 | | |
| Total Depth | | | | 6215 | | K.B. |

K.B. Measurement 11' above G.L.

(over)

* Indicates Electric Log tops in the remarks section.



STATE OF WEST VIRGINIA
DEPARTMENT OF MINES

RECEIVED
JUL 10 1974
OIL & GAS DIVISION
DEPT. OF MINES

Oil and Gas Division

OIL AND GAS WELL PERMIT APPLICATION

TO THE DEPARTMENT OF MINES,
Charleston, W. Va.

DATE July 9, 1974

Surface Owner _____

Company Consolidated Gas Supply Corporation

Address _____

Address Clarksburg, W. Va.

Mineral Owner Hunter M. Bennett

Farm Louis Bennett Acres 19.500

Address Weston, W. Va.

Location (waters) Bear Fork

Coal Owner No coal

Well No. 11937 Elevation 1115'

Address _____

District Center County Gilmer

Coal Operator No Operations

Quadrangle ARNOLDSBURG

Address _____

THIS PERMIT MUST BE POSTED AT THE WELL SITE

All provisions being in accordance with Chapter 22, of the W. Va. Code, the location is hereby approved for drilling. This permit shall expire if operations have not commenced by 11-17-74

Golbert
INSPECTOR TO BE NOTIFIED
Weston, W. Va. PH: 269-4846
26452

Daniel A. Houe
Deputy Director - Oil & Gas Division

GENTLEMEN:

The undersigned well operator is entitled to drill upon the above named farm or tract of land for oil and gas, having fee title thereto, (or as the case may be) under grant or lease dated 10-25-15 19 by Louis Bennett made to Hope Natural Gas Co. and recorded on the 22nd day of January 19 16, in Gilmer County, Book 55 Page 246

XXX NEW WELL _____ DRILL DEEPER _____ REDRILL _____ FRACTURE OR STIMULATE
_____ OIL AND GAS WELL ORIGINALLY DRILLED BEFORE JUNE 5, 1969.

The enclosed plat was prepared by a registered engineer or licensed land surveyor and all coal owners and/or operators have been notified as of the above date.

The above named coal owners and/or operator are hereby notified that any objection they wish to make, or are required to make by Section 3 of the Code, must be received by, or filed with the Department of Mines within ten (10) days. *

Copies of this notice and the enclosed plat were mailed by registered mail, or delivered to the above named coal operators or coal owners at their above shown respective address _____ day _____ before, or on the same day with the mailing or delivery of this copy to the Department of Mines at Charleston, West Virginia.

Very truly yours,
(Sign Name) Robert Wayne Manager of Prod.
Well Operator

PLEASE SUBMIT COPIES OF ALL
GEOPHYSICAL LOGS DIRECTLY TO:

West Virginia Geological and Economic Survey
P. O. Box 579
Morgantown, W. Va. 26505
AD 504-296-4461

Consolidated Gas Supply Corporation
Street
445 West Main Street
City or Town
Clarksburg, W. Va.
State

*SECTION 3 . . . If no objections are filed or found by the Department of mines, within said period of ten days from the receipt of notice and plat by the department of mines, to said proposed location, the department shall forthwith issue to the well operator a permit certifying the filing of such plat, that no objections have been made by the coal operators or found thereto by the department and that the same is approved and the well operator authorized to proceed.

BLANKET LOG

Gil-2486 PERMIT NUMBER

47-021

